

SONY

Cyber-shot

Digital Still Camera

Instruction Manual

DSC-G1

GB



MEMORY STICK™



InfoLITHIUM™ TYPE



CD-ROM
(supplied)

For details on the advanced operations, please access
“**Cyber-shot Handbook**” contained on the supplied
CD-ROM via a computer.

Operating Instructions

Before operating the unit, please read this manual thoroughly, and retain it for future reference.

Owner's Record

The model and serial numbers are located on the bottom. Record the serial number in the space provided below. Refer to these numbers whenever you call upon your Sony dealer regarding this product.

Model No. DSC-G1

Serial No. _____

© 2007 Sony Corporation

2-898-083-11(1)

DSC-G1
2-898-083-11(1)

WARNING

To reduce fire or shock hazard, do not expose the unit to rain or moisture.

For Customers in the U.S.A.

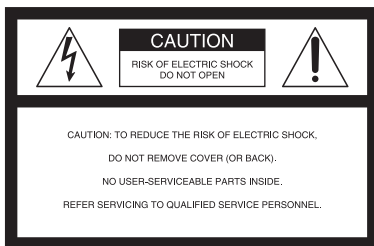

This symbol is intended to alert the user to the presence of uninsulated “dangerous voltage” within the product’s enclosure that may be of sufficient magnitude to constitute a risk of electric shock to persons.



This symbol is intended to alert the user to the presence of important operating and maintenance (servicing) instructions in the literature accompanying the appliance.

IMPORTANT SAFEGUARDS

For your protection, please read these safety instructions completely before operating the appliance, and keep this manual for future reference.

Carefully observe all warnings, precautions and instructions on the appliance, or the one described in the operating instructions and adhere to them.

Use

Power Sources

This set should be operated only from the type of power source indicated on the marking label. If you are not sure of the type of electrical power supplied to your home, consult your dealer or local power company. For those sets designed to operate from battery power, or other sources, refer to the operating instructions.

Polarization

This set may be equipped with a polarized ac power cord plug (a plug having one blade wider than the other).

This plug will fit into the power outlet only one way. This is a safety feature. If you are unable to insert the plug fully into the outlet, try reversing the plug. If the plug should still fail to fit, contact your electrician to have a suitable outlet installed. Do not defeat the safety purpose of the polarized plug by forcing it in.

Overloading

Do not overload wall outlets, extension cords or convenience receptacles beyond their capacity, since this can result in fire or electric shock.

Object and Liquid Entry

Never push objects of any kind into the set through openings as they may touch dangerous voltage points or short out parts that could result in a fire or electric shock. Never spill liquid of any kind on the set.

Attachments

Do not use attachments not recommended by the manufacturer, as they may cause hazards.

Cleaning

Unplug the set from the wall outlet before cleaning or polishing it. Do not use liquid cleaners or aerosol cleaners. Use a cloth lightly dampened with water for cleaning the exterior of the set.

Installation

Water and Moisture

Do not use power-line operated sets near water – for example, near a bathtub, washbowl, kitchen sink, or laundry tub, in a wet basement, or near a swimming pool, etc.

Power-Cord Protection

Route the power cord so that it is not likely to be walked on or pinched by items placed upon or against them, paying particular attention to the plugs, receptacles, and the point where the cord exits from the appliance.

Accessories

Do not place the set on an unstable cart, stand, tripod, bracket, or table. The set may fall, causing serious injury to a child or an adult, and serious damage to the set. Use only a cart, stand, tripod, bracket, or table recommended by the manufacturer.

Ventilation

The slots and openings in the cabinet are provided for necessary ventilation. To ensure reliable operation of the set, and to protect it from overheating, these slots and openings must never be blocked or covered.

- Never cover the slots and openings with a cloth or other materials.
- Never block the slots and openings by placing the set on a bed, sofa, rug, or other similar surface.
- Never place the set in a confined space, such as a bookcase, or built-in cabinet, unless proper ventilation is provided.
- Do not place the set near or over a radiator or heat register, or where it is exposed to direct sunlight.

Lightning

For added protection for this set during a lightning storm, or when it is left unattended and unused for

long periods of time, unplug it from the wall outlet and disconnect the antenna or cable system. This will prevent damage to the set due to lightning and power-line surges.

Service

Damage Requiring Service

Unplug the set from the wall outlet and refer servicing to qualified service personnel under the following conditions:

- When the power cord or plug is damaged or frayed.
- If liquid has been spilled or objects have fallen into the set.
- If the set has been exposed to rain or water.
- If the set has been subject to excessive shock by being dropped, or the cabinet has been damaged.
- If the set does not operate normally when following the operating instructions. Adjust only those controls that are specified in the operating instructions. Improper adjustment of other controls may result in damage and will often require extensive work by a qualified technician to restore the set to normal operation.
- When the set exhibits a distinct change in performance – this indicates a need for service.

Servicing

Do not attempt to service the set yourself as opening or removing covers may expose you to dangerous voltage or other hazards. Refer all servicing to qualified service personnel.

Replacement parts

When replacement parts are required, be sure the service technician has used replacement parts specified by the manufacturer that have the same characteristics as the original parts. Unauthorized substitutions may result in fire, electric shock, or other hazards.

Safety Check

Upon completion of any service or repairs to the set, ask the service technician to perform routine safety checks (as specified by the manufacturer) to determine that the set is in safe operating condition.

Read this first

CAUTION

Replace the battery with the specified type only. Otherwise, fire or injury may result.

For Customers in the U.S.A. and Canada

RECYCLING LITHIUM-ION BATTERIES

Lithium-Ion batteries are recyclable.

You can help preserve our environment by returning your used rechargeable batteries to the collection and recycling location nearest you.



For more information regarding recycling of rechargeable batteries, call toll free 1-800-822-8837, or visit <http://www.rbrbc.org/>

Caution: Do not handle damaged or leaking Lithium-Ion batteries.

This device complies with Part 15 of the FCC Rules and RSS-Gen of IC Rules. Operation is subject to the following two conditions: (1) This device may not cause harmful interference, and (2) this device must accept any interference received, including interference that may cause undesired operation.

IMPORTANT NOTE

To comply with FCC/IC RF exposure requirements, the following antenna installation and device operating configurations must be satisfied: the antenna has been installed by the manufacturer and no change can be made.

This device and its antenna(s) must not be co-located or operating in conjunction with any other antenna or transmitter.

For Customers in Canada

This Class B digital apparatus complies with Canadian ICES-003.

For Customers in the U.S.A.

If you have any questions about this product, you may call:

Sony Customer Information Services Center
1-800-222-SONY (7669)

The number below is for the FCC related matters only.

Regulatory Information

Declaration of Conformity

Trade Name: SONY
Model No.: DSC-G1
Responsible Party: Sony Electronics Inc.
Address: 16530 Via Esprillo,
San Diego, CA 92127U.S.A.
Telephone No.: 858-942-2230

This device complies with Part 15 of the FCC Rules. Operation is subject to the following two conditions: (1) This device may not cause harmful interference, and (2) this device must accept any interference received, including interference that may cause undesired operation.

Note: DSC-G1 is to be used with the Cyber-shot Station. Model UC-GA and AC Adaptor Model AC-LS5.

CAUTION

You are cautioned that any changes or modifications not expressly approved in this manual could void your authority to operate this equipment.

The available scientific evidence does not show that any health problems are associated with using low power wireless devices. There is no proof, however, that these low power wireless devices are absolutely safe. Low power Wireless devices emit low levels of radio frequency energy (RF) in the microwave range while being used. Whereas high levels of RF can produce health effects (by heating tissue), exposure to low-level RF that does not produce heating effects causes no known adverse health effects. Many studies of low-level RF exposures have not found any biological effects. Some studies have suggested that some biological effects might occur, but such findings have not been confirmed by additional research. DSC-G1 has been tested and found to comply with FCC radiation exposure limits set forth for an uncontrolled equipment and meets the FCC radio frequency (RF) Exposure Guidelines in Supplement C to OET65.

Note:

This equipment has been tested and found to comply with the limits for a Class B digital device, pursuant to Part 15 of the FCC Rules. These limits are designed to provide reasonable protection against harmful interference in a residential installation. This equipment generates, uses, and can radiate radio frequency energy and, if not installed and used in accordance with the instructions, may cause harmful interference to radio communications. However, there is no guarantee that interference will not occur in a particular installation. If this equipment does cause harmful interference to radio or television reception, which can be determined by turning the equipment off and on, the user is encouraged to try to correct the interference by one or more of the following measures:

- Reorient or relocate the receiving antenna.
- Increase the separation between the equipment and receiver.
- Connect the equipment into an outlet on a circuit different from that to which the receiver is connected.
- Consult the dealer or an experienced radio/TV technician for help.

The supplied interface cable must be used with the equipment in order to comply with the limits for a digital device pursuant to Subpart B of Part 15 of FCC Rules.

For the State of California, USA only

Perchlorate Material - special handling may apply, See www.dtsc.ca.gov/hazardouswaste/perchlorate
Perchlorate Material : Lithium battery contains perchlorate

For Customers in Europe

Hereby, Sony Corporation, declares that this DSC-G1 Digital Still Camera is in compliance with the essential requirements and other relevant provisions of the Directive 1999/5/EC. For details, please access the following URL:<http://www.compliance.sony.de/>



This product has been tested and found compliant with the limits set out in the EMC regulation for using connection cables shorter than 3 meters (9.8 feet).

Attention

The electromagnetic fields at the specific frequencies may influence the picture and sound of this camera.

Notice

If static electricity or electromagnetism causes data transfer to discontinue midway (fail), restart the application or disconnect and connect the communication cable (USB, etc.) again.

For use in Norway

Use of this radio equipment is not allowed in the geographical area within a radius of 20 km from the centre of Ny-Alesund, Svalbard.

Disposal of Old Electrical & Electronic Equipment (Applicable in the European Union and other European countries with separate collection systems)





This symbol on the product or on its packaging indicates that this product shall not be treated as household waste. Instead it shall be handed over to the applicable collection point for the recycling of electrical and electronic equipment. By ensuring this product is disposed of correctly, you will help prevent potential negative consequences for the environment and human health, which could otherwise be caused by inappropriate waste handling of this product. The recycling of materials will help to conserve natural resources. For more detailed information about recycling of this product, please contact your local Civic Office, your household waste disposal service or the shop where you purchased the product.

For Customers in Singapore

Complies with
IDA Standards
DB00353

Notice for customers in the United Kingdom

A moulded plug complying with BS 1363 is fitted to this equipment for your safety and convenience. Should the fuse in the plug supplied need to be replaced, a fuse of the same rating as the supplied one and approved by ASTA or BSI to BS 1362, (i.e., marked with an  or  mark) must be used.

If the plug supplied with this equipment has a detachable fuse cover, be sure to attach the fuse cover after you change the fuse. Never use the plug without the fuse cover. If you should lose the fuse cover, please contact your nearest Sony service station.

Notes on using your camera

Internal memory and “Memory Stick Duo” back up

Do not turn off the camera or remove the battery pack or “Memory Stick Duo” while the access lamp is lighted, as the internal memory data or “Memory Stick Duo” data may be destroyed. Always protect your data by making a back up copy.

Notes on recording/playback

- Before you record one-time events, make a trial recording to make sure that the camera is working correctly.
- This camera is neither dust-proof, nor splash-proof, nor water-proof. Read “Precautions” (page 37) before operating the camera.
- Be careful not to get the camera wet. Water entering the inside of the camera may cause malfunctions which in some cases may not be repairable.
- Do not aim the camera at the sun or other bright light. It may cause the malfunction of your camera.
- Do not use the camera near a location that generates strong radio waves or emits radiation. The camera may not be able to record or play back properly.
- Using the camera in sandy or dusty locations may cause malfunctions.
- If moisture condensation occurs, remove it before using the camera (page 37).
- Do not shake or strike the camera. In addition to malfunctions and an inability to record images, this may render the recording medium unusable, or cause image data breakdown, damage or loss.
- Clean the flash surface before use. The heat of flash emission may cause dirt on the flash surface to become discolored or to stick to the flash surface, resulting in insufficient light emission.

Notes on the LCD screen

- The LCD screen is manufactured using extremely high-precision technology so over 99.99% of the pixels are operational for effective use. However, there may be some tiny black points and/or bright points (white, red, blue or green in color) that constantly appear on the LCD screen. These points are normal in the manufacturing process and do not affect the recording in any way.

On image data compatibility

- This camera conforms with DCF (Design rule for Camera File system) universal standard established by JEITA (Japan Electronics and Information Technology Industries Association).
- Playback of images recorded with your camera on other equipment and playback of images recorded or edited with other equipment on your camera are not guaranteed.

Warning on copyright

Television programs, films, videotapes, and other materials may be copyrighted. Unauthorized recording of such materials may be contrary to the provisions of the copyright laws.

No compensation for contents of the recording

The contents of the recording cannot be compensated for if recording or playback is not possible due to a malfunction of your camera or recording media, etc.

Table of contents

IMPORTANT SAFEGUARDS	2
Read this first	4
Notes on using your camera	7
Getting started	10
Checking the accessories supplied	10
1 Inserting the battery pack	11
2 Charging the battery pack	13
3 Turning the camera on/setting the clock	15
4 Connecting the camera with your computer	16
 Viewing "Cyber-shot Handbook"	16
Installing the software	17
Shooting images easily (Auto adjustment mode)	18
Zoom/Flash/Macro/Self-timer/Image size	19
Viewing/deleting images	20
How to operate – home/menu	22
Using the home screen	22
The home menu list	24
Using menu items	26
Menu items	27
Enjoying the supplied software using your computer	28
"Album Editor"	28
"Picture Motion Browser"	28
Using the wireless LAN	29
Exchanging images among the DSC-G1s	29
Making your images public via an access point	29
Listening to music	30
Importing music files	30
Playing back music	30
Indicators on the screen	31
Battery life and memory capacity	33
Battery life and number of images that can be recorded/viewed	33
Number of still images and recording time of movies	34

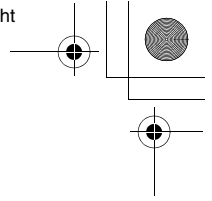
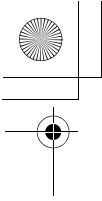

Troubleshooting	35
Battery pack and power	35
Shooting still images/movies	36
Viewing images	36
Precautions	37
Specifications	38

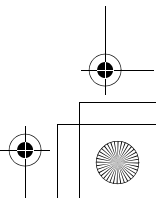
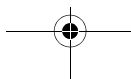
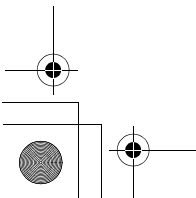
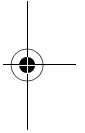
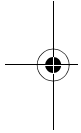

Getting started

Checking the accessories supplied

- Cyber-shot Station (1)

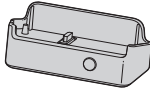

- AC Adaptor AC-LS5

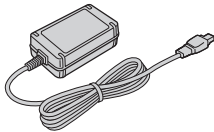

- Power cord (mains lead) (1)

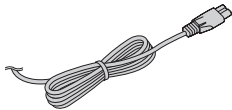

- Rechargeable battery pack NP-FR1 (1)/Battery case (1)

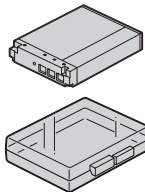

- USB cable (1)



- A/V cable (1)

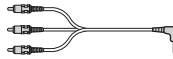

- Wrist strap (1)

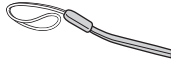

- CD-ROM (Cyber-shot application software/ "Cyber-shot Handbook") (1)
- Instruction Manual (this manual) (1)

Attach the strap to prevent the camera from damage by being dropped, etc.

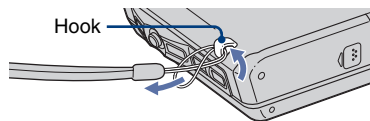

1 Inserting the battery pack

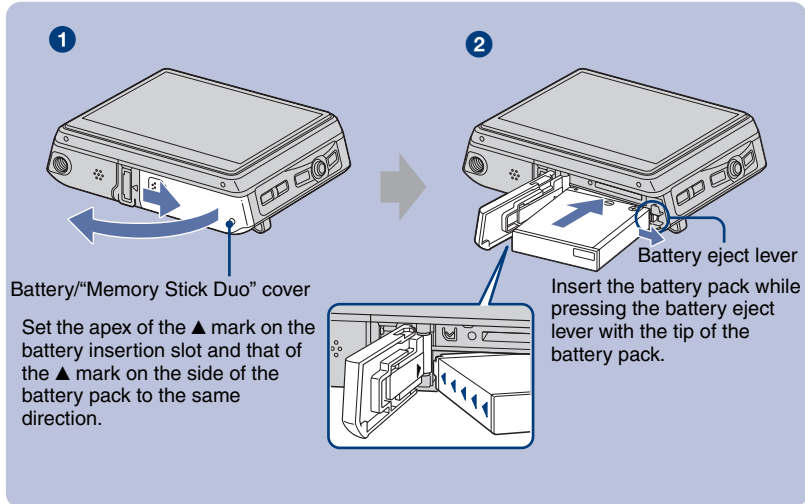

- 1** Open the battery/"Memory Stick Duo" cover.
- 2** Insert the battery pack.
- 3** Close the battery/"Memory Stick Duo" cover.

To remove the battery pack

Open the battery/"Memory Stick Duo" cover and remove the battery pack.

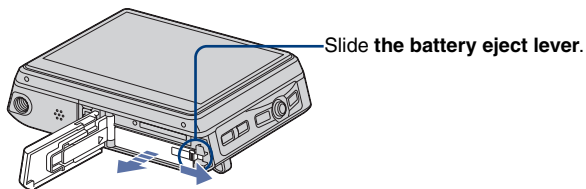

- Be sure not to drop the battery pack.
- Never remove the battery pack when the access lamp is lit. The data may be corrupted.

When recording in a “Memory Stick Duo” (not supplied)

You can also record images in a “Memory Stick Duo” (not supplied) instead of the internal memory.

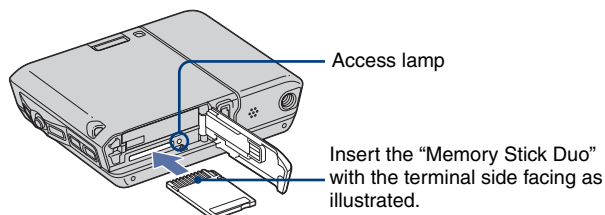

Push the “Memory Stick Duo” in once to remove the “Memory Stick Duo”.

- Never remove the “Memory Stick Duo” when the access lamp is lit. The data may be corrupted.
- When the [Default Media] is set to [Internal Memory], the images are recorded in the internal memory, although the “Memory Stick Duo” is being inserted (page 24).

2 Charging the battery pack

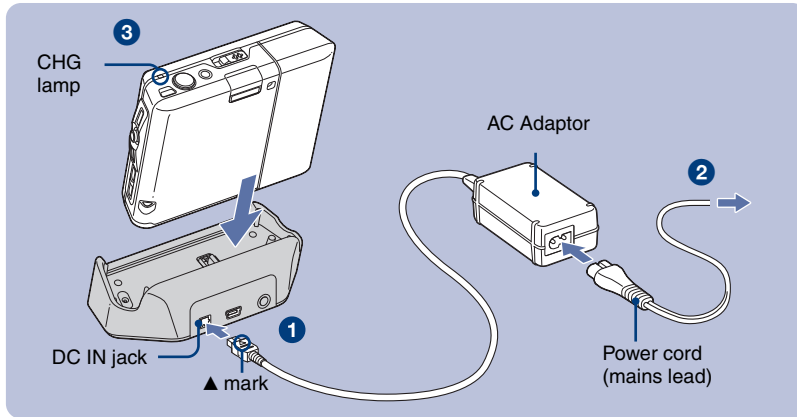

- 1 Connect the cable of the AC Adaptor (supplied) to the DC IN jack of the Cyber-shot Station (supplied).**
- 2 Connect the power cord (mains lead) to the AC Adaptor and plug the adaptor into the wall outlet (wall socket).**
- 3 Attach the camera on the Cyber-shot Station.**

The CHG lamp lights on, and charging starts.

When the CHG lamp turns off, charging is finished (Practical charge).

If you continue charging the battery pack for about one more hour (until it is fully charged), the charge will last slightly longer (Full charge).

Charging time

Full charge time	Practical charge time
Approx. XXX min.	Approx. XXX min.

- Time required to charge a fully depleted battery pack (supplied) at a temperature of 25°C (77°F). Charging may take longer under certain circumstances or conditions.
- For details on battery usable time, see page 33.
- Even if the CHG lamp is not lit, the camera is disconnected from the AC power source (mains) as long as it is connected to the wall outlet (wall socket). If any trouble occurs while using the adaptor, immediately shut off the power by disconnecting the plug from the wall outlet (wall socket).
- Do not use the AC Adaptor placed in a narrow space, such as between a wall and furniture.
- If you do not operate the camera for a long time, disconnect the AC Adaptor both from the DC IN jack of the Cyber-shot Station and from a wall outlet (wall socket).

To check the remaining battery time

Open the lens cover or press the POWER button to turn on and check the time on the LCD screen. When the remaining battery time is not indicated, switch the display by pressing the DISP (Screen display switch) button.

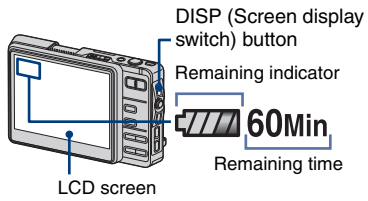

- It takes about one minute until the correct battery remaining time appears.
- Only  is indicated, depending on a mode.
- The displayed time remaining may not be correct under certain circumstances.
- When you turn on the power for the first time, the Clock Set screen appears (page 15).

3 Turning the camera on/setting the clock

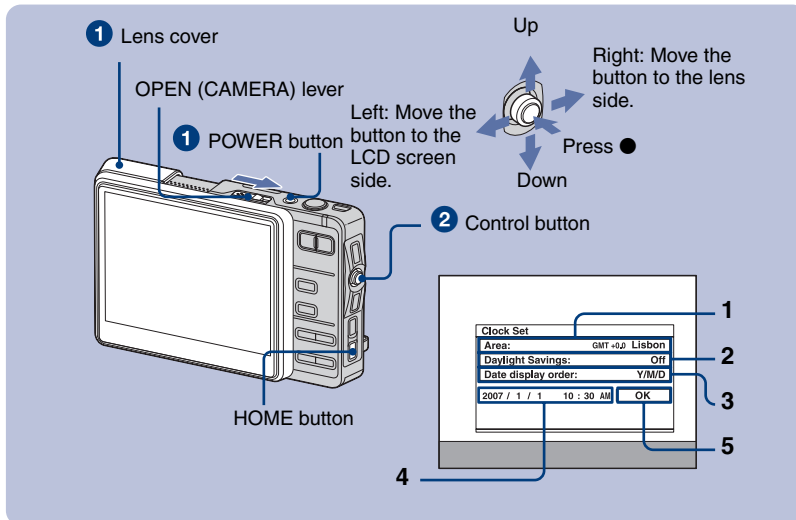

1 Press the **POWER** button or open the lens cover.

2 Set the clock with the control button.

- 1 -①Select [Area], then press ●.
-②Select the desired area, then press ●.
- 2 -①Select [Daylight Savings], then press ●.
-②Select [On] or [Off] of the daylight saving time, then press ●.
- 3 -①Select [Date display order], then press ●.
-②Select the desired order, then press ●.
- 4 -①Select each item and set the numeric value, then press ●.
-②Set up all the items.
- 5 Select [OK], then press ●.

I To change the date and time

Press the HOME button, and select [Settings] → [⌚ Clock Set] (page 26).

I When you turn on the power

- If the camera is running on battery power and you do not operate the camera for about three minutes, the camera turns off automatically to prevent wearing down the battery pack (Auto power-off function).

Installing the software

Supported Operating Systems for “Album Editor”, “Picture Motion Browser”

Application software “Album Editor”, “Picture Motion Browser”	Windows 2000 Professional SP4, Windows XP Home Edition or Windows XP Professional
---	---

- Must be installed with above OS at delivery.
- For further details on the operating environment of “Album Editor” and “Picture Motion Browser,” refer to “Cyber-shot Handbook.”

For Windows users only

- 1 Turn on your computer, and insert the CD-ROM (supplied) into the CD-ROM drive.
The screen below appears.



When you click the [Install] button, the “Choose Setup Language” screen appears.

- 2 Follow the instructions on the screen to complete the installation.
- 3 After the installation is complete, double-click the shortcut created on the desktop.

Shooting images easily (Auto adjustment mode)

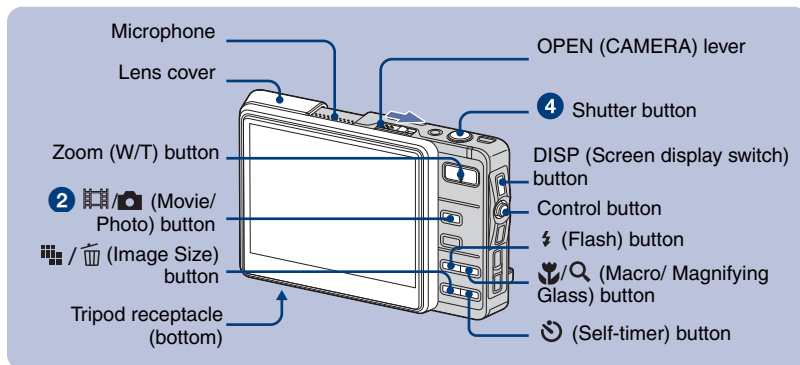

1 Open the lens cover by sliding the OPEN (CAMERA) lever.

Open until it clicks.

2 Select a mode with the [Movie/Photo] button.

Each time you press the [Movie/Photo] button, the mode changes between Movie and Photo.

3 Hold the camera steady, keeping your arm at your side.



Position the subject in the center of the LCD screen.

4 Shoot with the shutter button.

Aside from an original image, a small size album image is recorded in the internal memory.

Still image:

1 Press and hold the shutter button halfway down to focus.

The ● (AE/AF lock) indicator (green) flashes, a beep sounds, the indicator stops flashing and remains lit.

2 Press the shutter button fully down.

The shutter sounds.

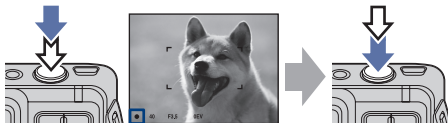

AE/AF lock indicator

Movie:

Press the shutter button fully down.

To stop recording, press the shutter button fully down again.

Using the zoom

Press the zoom button.

- When the zoom scale exceeds 3x, the camera uses the Digital Zoom function.

Flash (Selecting a flash mode for still images)

Press the  button repeatedly until the desired mode is selected.

 : Flash Auto

Strobes when there is insufficient light or backlight (default setting)

 : Flash forced on

 : Slow synchro (Flash forced on)

The shutter speed is slow in a dark place to clearly shoot the background that is out of flash light.

 : Flash forced off

Macro/Magnifying Glass (Shooting close-up)

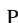
Press the  button repeatedly until the desired mode is selected.

 : Macro off (Default setting)

 : Macro on (W side: Approx. 8 cm or farther (3 1/4 inches or farther), T side: Approx. 25 cm or farther (9 7/8 inches or farther))

 : Magnifying Glass on (Locked to the W side: Approx. 1 to 20 cm (13/32 to 7 7/8 inches))

Using the self-timer

Press the  button repeatedly until the desired mode is selected.

 : Not using the self-timer

 : Setting the 10-second delay self-timer



 : Setting the 2-second delay self-timer



Press the shutter button, the self-timer lamp flashes, and a beep sounds until the shutter operates.

Self-timer lamp







To change the image size

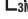
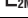

Press the  /  (Image Size) button, then select the size using the control button.

To turn off the Image Size menu, press the  /  button again.

Still images

Image size	Usage guidelines
 : 6M	For prints up to A4(8x10")
 : 3:2	Shoot with 3:2 aspect ratio
 : 3M	For prints up to 13x18 cm(5x7")
 : 2M	For prints up to 9x13 cm(3.5x5")
 : VGA	For emailing (640x480)
 : 16:9	Display On 16:9 HDTV

Movies

Image size	Usage guidelines
 : 640x480	Display on TV
 : 320x240	For emailing (320x240)

On the recordable number of still images and recordable time of movies

Recordable number of still images and recordable time of movies vary depending on the selected image size. Pressing the DISP (Screen display switch) button turns on the time indication.

Still images

Maximum number of recordable images



Movies

Maximum recordable time



- The number of recordable images and time can differ according to shooting conditions (page 34).

Viewing/deleting images

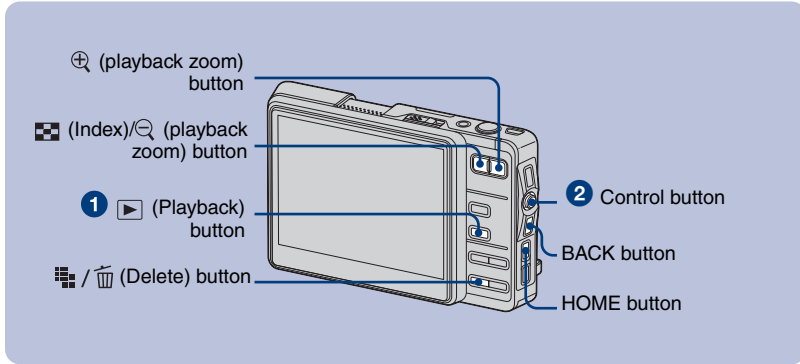

1 Press the (Playback) button.

- If you press (Playback) when the camera is powered off, the camera is turned on in playback mode. Pressing it again returns to the shooting mode.

2 Select an image by moving the control button to \leftarrow/\rightarrow .

Movie:

Press to play back a movie. (Press again to stop playback.)

Moving the control button to \leftarrow to rewind and to \rightarrow to fast forward. (Press to return to normal playback.)

Moving the control button to \uparrow/\downarrow to adjust the volume.

/ To delete images

- 1 Display the image you want to delete and press / (Delete).
- 2 Select [Original Image Only] or [Original & Album Images] with the control button, then press .

\leftarrow To view an enlarged image (playback zoom)

Press \leftarrow while displaying a still image.

To undo the zoom, press .

Adjust the portion: Moving the control button to $\uparrow/\downarrow/\leftarrow/\rightarrow$.

Cancel playback zoom: Press BACK.