

SONY

4-419-606-11(1)

Digital Still Camera

Instruction Manual

Cyber-shot



AVCHD
Progressive **HDMI**

DSC-HX20V/HX30/HX30V

DSC-HX20V/HX30/HX30V
4-419-606-11(1)

English

Learning more about the camera (“Cyber-shot User Guide”)



“Cyber-shot User Guide” is an on-line manual. Refer to it for in-depth instructions on the many functions of the camera.

- ① Access the Sony support page.
<http://www.sony.net/SonyInfo/Support/>
- ② Select your country or region.
- ③ Search for the model name of your camera within the support page.
 - Check the model name on the bottom of your camera.

Checking the supplied items

The number in parentheses indicates the number of pieces.

- Camera (1)
- Rechargeable battery pack NP-BG1 (1)/Battery case (1)
- Micro USB cable (1)
- AC Adaptor AC-UB10/UB10B (1)
- Power cord (mains lead) (not supplied in the USA and Canada) (1)
- Wrist strap (1)
- Instruction Manual (this manual) (1)

Owner's Record

The model and serial numbers are located on the bottom. Record the serial number in the space provided below. Refer to these numbers whenever you call your Sony dealer regarding this product.

Model No. DSC-HX20V/HX30/HX30V

Serial No. _____

Model No. AC-UB10/UB10B

Serial No. _____

WARNING

To reduce fire or shock hazard, do not expose the unit to rain or moisture.

IMPORTANT SAFETY INSTRUCTIONS -SAVE THESE INSTRUCTIONS DANGER

TO REDUCE THE RISK OF FIRE OR ELECTRIC SHOCK, CAREFULLY FOLLOW THESE INSTRUCTIONS

If the shape of the plug does not fit the power outlet, use an attachment plug adaptor of the proper configuration for the power outlet.

CAUTION**Battery pack**

If the battery pack is mishandled, the battery pack can burst, cause a fire or even chemical burns. Observe the following cautions.

- Do not disassemble.
- Do not crush and do not expose the battery pack to any shock or force such as hammering, dropping or stepping on it.
- Do not short circuit and do not allow metal objects to come into contact with the battery terminals.
- Do not expose to high temperature above 60°C (140°F) such as in direct sunlight or in a car parked in the sun.
- Do not incinerate or dispose of in fire.
- Do not handle damaged or leaking lithium ion batteries.

- Be sure to charge the battery pack using a genuine Sony battery charger or a device that can charge the battery pack.
- Keep the battery pack out of the reach of small children.
- Keep the battery pack dry.
- Replace only with the same or equivalent type recommended by Sony.
- Dispose of used battery packs promptly as described in the instructions.

AC Adaptor

Connect the AC Adaptor to the nearest wall outlet (wall socket).

If some trouble occurs while using the AC Adaptor, immediately shut off the power by disconnecting the plug from the wall outlet (wall socket).

The power cord (mains lead), if supplied, is designed specifically for use with this camera only, and should not be used with other electrical equipment.

For Customers in the U.S.A. and Canada

RECYCLING LITHIUM-ION BATTERIES

Lithium-Ion batteries are recyclable.

You can help preserve our environment by returning your used rechargeable batteries to the collection and recycling location nearest you.



For more information regarding recycling of rechargeable batteries, call toll free 1-800-822-8837, or visit <http://www.rbc.org/>

Caution: Do not handle damaged or leaking Lithium-Ion batteries.

Battery pack

This device complies with Part 15 of the FCC Rules. Operation is subject to the following two conditions:

(1) This device may not cause harmful interference, and (2) this device must accept any interference received, including interference that may cause undesired operation.

This Class B digital apparatus complies with Canadian ICES-003.

For Customers in the U.S.A.

UL is an internationally recognized safety organization.
The UL Mark on the product means it has been UL Listed.

If you have any questions about this product, you may call:

Sony Customer Information Center
1-800-222-SONY (7669).

The number below is for the FCC related matters only.

Regulatory Information

Declaration of Conformity

Trade Name: SONY
Model No.: DSC-HX20V
Responsible Party: Sony Electronics Inc.
Address: 16530 Via Esprillo,
San Diego, CA 92127 U.S.A.
Telephone No.: 858-942-2230

This device complies with Part15 of the FCC Rules. Operation is subject to the following two conditions: (1) This device may not cause harmful interference, and (2) this device must accept any interference received, including interference that may cause undesired operation.

Declaration of Conformity

Trade Name: SONY
Model No.: DSC-HX30V
Responsible Party: Sony Electronics Inc.
Address: 16530 Via Esprillo,
San Diego, CA 92127 U.S.A.
Telephone No.: 858-942-2230

This device complies with Part15 of the FCC Rules. Operation is subject to the following two conditions: (1) This device may not cause harmful interference, and (2) this device must accept any interference received, including interference that may cause undesired operation.

This equipment must not be co-located or operated in conjunction with any other antenna or transmitter.

The available scientific evidence does not show that any health problems are associated with using low power wireless devices. There is no proof, however, that these low power wireless devices are absolutely safe. Low power Wireless devices emit low levels of radio frequency energy (RF) in the microwave range while being used. Whereas high levels of RF can produce health effects (by heating tissue), exposure of low-level RF that does not produce heating effects causes no known adverse health effects. Many studies of low-level RF exposures have not found any biological effects. Some studies have suggested that some biological effects might occur, but such findings have not been confirmed by additional research. This equipment has been tested and found to comply with FCC radiation exposure limits set forth for an uncontrolled environment and meets the FCC radio frequency (RF) Exposure Guidelines in Supplement C to OET65 and RSS-102 of the IC radio frequency (RF) Exposure rules.

CAUTION

You are cautioned that any changes or modifications not expressly approved in this manual could void your authority to operate this equipment.

Note:

This equipment has been tested and found to comply with the limits for a Class B digital device, pursuant to Part 15 of the FCC Rules.

These limits are designed to provide reasonable protection against harmful interference in a residential installation. This equipment generates, uses, and can radiate radio frequency energy and, if not installed and used in accordance with the instructions, may cause harmful interference to radio communications. However, there is no guarantee that interference will not occur in a particular installation. If this equipment does cause harmful interference to radio or television reception, which can be determined by turning the equipment off and on, the user is encouraged to try to correct the interference by one or more of the following measures:

- Reorient or relocate the receiving antenna.
- Increase the separation between the equipment and receiver.
- Connect the equipment into an outlet on a circuit different from that to which the receiver is connected.
- Consult the dealer or an experienced radio/TV technician for help.

The supplied interface cable must be used with the equipment in order to comply with the limits for a digital device pursuant to Subpart B of Part 15 of FCC Rules.

For Customers in Canada

This device complies with RSS-310 of Industry Canada. Operation is subject to the condition that this device does not cause harmful interference.

This device complies with Industry Canada licence-exempt RSS standard(s). Operation is subject to the following two conditions: (1) this device may not cause interference, and (2) this device must accept any interference, including interference that may cause undesired operation of the device.

Under Industry Canada regulations, this radio transmitter may only operate using an antenna of a type and maximum (or lesser) gain approved for the transmitter by Industry Canada. To reduce potential radio interference to other users, the antenna type and its gain should be so chosen that the equivalent isotropically radiated power (e.i.r.p.) is not more than that necessary for successful communication.

For Customers in Europe



Hereby, Sony Corporation, declares that this DSC-HX20V/HX30V Digital Still Camera is in compliance with the essential requirements and other relevant provisions of the Directive 1999/5/EC. For details, please access the following URL:
<http://www.compliance.sony.de/>

Notice for the customers in the countries applying EU Directives

The manufacturer of this product is Sony Corporation, 1-7-1 Konan Minato-ku Tokyo, 108-0075 Japan. The Authorized Representative for EMC and product safety is Sony Deutschland GmbH, Hedelfinger Strasse 61, 70327 Stuttgart, Germany. For any service or guarantee matters please refer to the addresses given in separate service or guarantee documents.

This product has been tested and found compliant with the limits set out in the EMC regulation for using connection cables shorter than 3 meters (9.8 feet).

Attention

The electromagnetic fields at the specific frequencies may influence the picture and sound of this unit.

Notice

If static electricity or electromagnetism causes data transfer to discontinue midway (fail), restart the application or disconnect and connect the communication cable (USB, etc.) again.

! Disposal of Old Electrical & Electronic Equipment (Applicable in the European Union and other European countries with separate collection systems)



This symbol on the product or on its packaging indicates that this product shall not be treated as household waste. Instead it shall be handed over to the applicable collection point for the recycling of electrical and electronic equipment. By ensuring this product is disposed of correctly, you will help prevent potential negative consequences for the environment and human health, which could otherwise be caused by inappropriate waste handling of this product. The recycling of materials will help to conserve natural resources. For more detailed information about recycling of this product,

please contact your local Civic Office, your household waste disposal service or the shop where you purchased the product.

! Disposal of waste batteries (applicable in the European Union and other European countries with separate collection systems)



This symbol on the battery or on the packaging indicates that the battery provided with this product shall not be treated as household waste. On certain batteries this symbol might be used in combination with a chemical symbol. The chemical symbols for mercury (Hg) or lead (Pb) are added if the battery contains more than 0.0005% mercury or 0.004% lead.

By ensuring these batteries are disposed of correctly, you will help prevent potentially negative consequences for the environment and human health which could otherwise be caused by inappropriate waste handling of the battery. The recycling of the materials will help to conserve natural resources.

In case of products that for safety, performance or data integrity reasons require a permanent connection with an incorporated battery, this battery should be replaced by qualified service staff only. To ensure that the battery will be treated properly, hand over the product at end-of-life to the applicable collection point for the recycling of electrical and electronic equipment.



For all other batteries, please view the section on how to remove the battery from the product safely.

Hand the battery over to the applicable collection point for the recycling of waste batteries.

For more detailed information about recycling of this product or battery, please contact your local Civic Office, your household waste disposal service or the shop where you purchased the product.

Notice for customers in the United Kingdom

A moulded plug complying with BS 1363 is fitted to this equipment for your safety and convenience.

Should the fuse in the plug supplied need to be replaced, a fuse of the same rating as the supplied one and approved by ASTA or BSI to BS 1362, (i.e., marked with an  or  mark) must be used.

If the plug supplied with this equipment has a detachable fuse cover, be sure to attach the fuse cover after you change the fuse. Never use the plug without the fuse cover. If you should lose the fuse cover, please contact your nearest Sony service station.

For Customers in Italy

Use of the RLAN network is governed: - with respect to private use, by the Legislative Decree of 1.8.2003, no. 259 ("Code of Electronic Communications"). In particular Article 104 indicates when the prior obtainment of a general authorization is required and Art. 105 indicates when free use is permitted; - with respect to the supply to the public of the RLAN access to telecom networks and services, by the Ministerial Decree 28.5.2003, as amended, and Art. 25 (general authorization for electronic communications networks and services) of the Code of electronic communications.

For Customers in Norway

Use of this radio equipment is not allowed in the geographical area with in a radius of 20 km from the centre of Ny-Alesund, Svalbard.

Identifying parts

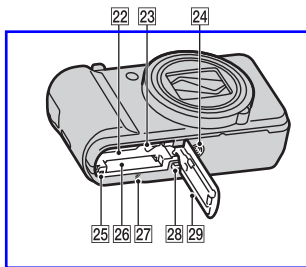
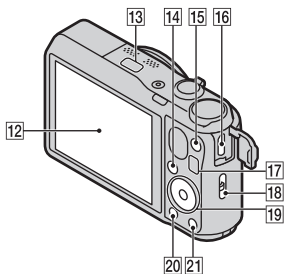
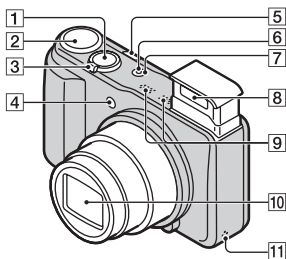

- 1 Shutter button
- 2 Mode dial
i (Intelligent Auto)/
i+ (Superior Auto)/
P (Program Auto)/**M** (Manual Exposure Shooting)/
MR (Memory recall mode)/
i (iSweep Panorama)/
MOVIE (Movie Mode)/**3D** (3D Shooting)/**SCN** (Scene Selection)/**AF** (Background Defocus)
- 3 For shooting: W/T (Zoom) lever
For viewing: **INDEX** (Index) lever/
Q (Playback zoom) lever
- 4 Self-timer lamp/Smile Shutter lamp/AF illuminator
- 5 CUSTOM (Custom) button
- 6 Power/Charge lamp
- 7 ON/OFF (Power) button
- 8 Flash
 - Do not hold your fingers near the flash.
 - When using the flash, the flash pops up automatically.
 - The flash goes down automatically when the power is turned off, the camera is switched to playback mode or the shooting mode is changed.
- 9 Microphone
- 10 Lens
- 11 Speaker
- 12 LCD screen
- 13 GPS sensor (built-in, DSC-HX20V/HX30V only)
- 14 **▶** (Playback) button
- 15 MOVIE (Movie) button

- 16 HDMI mini jack
- 17 Wi-Fi sensor (built-in, DSC-HX30/HX30V only)
- 18 Hook for wrist strap
- 19 Control wheel
- 20 MENU button
- 21 ?/⏏ (In-Camera Guide/Delete) button
- 22 Battery insertion slot
- 23 Battery eject lever
- 24 Tripod receptacle
 - Use a tripod with a screw less than 5.5 mm (7/32 inches) long. Otherwise, you cannot firmly secure the camera, and damage to the camera may occur.
- 25 Access lamp
- 26 Memory card slot
- 27  (TransferJet™) mark
- 28 Micro USB connector
- 29 Battery/memory card cover

Inserting the battery pack

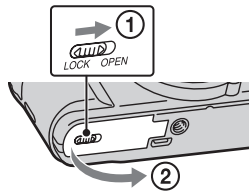

Battery eject lever

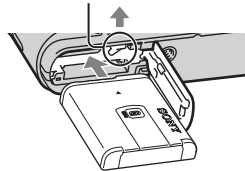

1 Open the cover.

2 Insert the battery pack.

- While pressing the battery eject lever, insert the battery pack as illustrated. Make sure that the battery eject lever locks after insertion.
- Closing the cover with the battery inserted incorrectly may damage the camera.

Charging the battery pack

**For customers in the USA
and Canada**

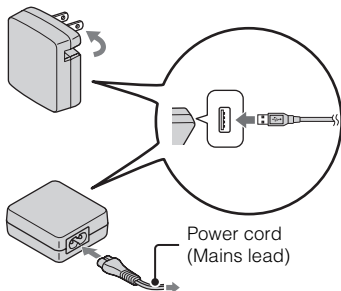

**For customers in countries/regions
other than the USA and Canada**

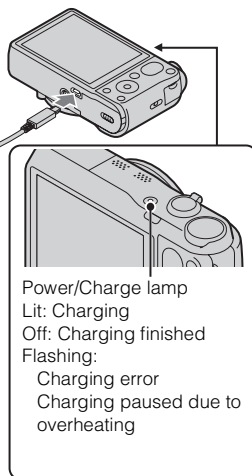

- 1 Connect the camera to the AC Adaptor (supplied), using the micro USB cable (supplied).
- 2 Connect the AC Adaptor to the wall outlet (wall socket).
The Power/Charge lamp lights orange, and charging starts.
 - Turn off the camera while charging the battery.
 - You can charge the battery pack even when it is partially charged.
 - When the Power/Charge lamp flashes and charging is not finished, remove and re-insert the battery pack.

Notes

- If the Power/Charge lamp on the camera flashes when the AC Adaptor is connected to the wall outlet (wall socket), this indicates that charging is temporarily stopped because the temperature is outside the recommended range. When the temperature gets back within the appropriate range, the charging resumes. We recommend charging the battery pack in an ambient temperature of between 10°C to 30°C (50°F to 86°F).
- The battery pack may not be effectively charged if the terminal section of the battery is dirty. In this case, wipe any dust off lightly using a soft cloth or a cotton swab to clean the terminal section of the battery.
- Connect the AC Adaptor (supplied) to the nearest wall outlet (wall socket). If malfunctions occur while using the AC Adaptor, disconnect the plug from the wall outlet (wall socket) immediately to disconnect from the power source.
- When charging is finished, disconnect the AC Adaptor from the wall outlet (wall socket).
- Be sure to use only genuine Sony brand battery packs, micro USB cable (supplied) and AC Adaptor (supplied).

■ Charging time (Full charge)

The charging time is approximately xx min. using the AC Adaptor (supplied).

Note

- The above charging time applies when charging a fully depleted battery pack at a temperature of 25°C (77°F). Charging may take longer depending on conditions of use and circumstances.

■ Charging by connecting to a computer

The battery pack can be charged by connecting the camera to a computer using a micro USB cable.

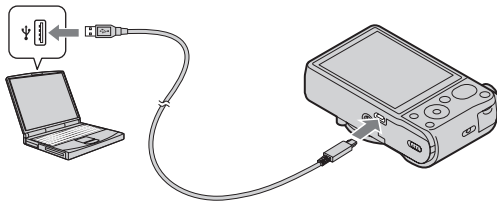

Note

- Note the following points when charging via a computer:
 - If the camera is connected to a laptop computer that is not connected to a power source, the laptop battery level decreases. Do not charge for an extended period of time.
 - Do not turn on/off or restart the computer, or wake the computer to resume from sleep mode when a USB connection has been established between the computer and the camera. The camera may cause a malfunction. Before turning on/off, or restarting the computer or waking the computer from sleep mode, disconnect the camera and the computer.
 - No guarantees are made for charging using a custom-built computer or a modified computer.

■ Battery life and number of images that can be recorded and played back

	Battery life	Number of images
Shooting (still images)	Approx. xx min.	Approx. xx images
Viewing (still images)	Approx. xx min.	Approx. xx images
Shooting (movies)	Approx. xx min.	—

Notes

- The above number of images applies when the battery pack is fully charged. The number of images may decrease depending on the conditions of use.
- The number of images that can be recorded is for shooting under the following conditions:
 - Using Sony “Memory Stick PRO Duo” (Mark2) media (sold separately)
 - The battery pack is used at an ambient temperature of 25°C (77°F).
 - [GPS setting] is set to [Off] (DSC-HX20V/HX30V only).
- The number for “Shooting (still images)” is based on the CIPA standard, and is for shooting under the following conditions:
 - (CIPA: Camera & Imaging Products Association)
 - DISP (Display Setting) is set to [ON].
 - Shooting once every 30 seconds.
 - The zoom is switched alternately between the W and T ends.
 - The flash strobes once every two times.
 - The power turns on and off once every ten times.
- The battery life for movies applies shooting under the following conditions:
 - Movie quality: AVC HD HQ
 - When continuous shooting ends because of set limits (page 27), press the MOVIE (Movie) button again and continue shooting. Shooting functions such as the zoom do not operate.

■ Supplying power

The camera can be supplied with power from the wall outlet (wall socket) by connecting to the AC Adaptor, using the micro USB cable (supplied).

You can import images to a computer without worrying about draining the battery pack by connecting the camera to a computer using the micro USB cable.

In addition, you can use the AC Adaptor AC-UD10 (sold separately) for shooting to supply power when shooting.

Notes

- Power cannot be supplied when the battery pack is not inserted in the camera.
- When the camera is connected directly to a computer or to a power outlet using the supplied AC Adaptor AC-UB10/UB10B, power supply is available only in playback mode. If the camera is in shooting mode or while you are changing the settings of the camera, power is not supplied even if you make a USB connection using the micro USB cable.
- If you connect the camera and a computer using the micro USB cable while the camera is in playback mode, the display on the camera will change from the playback screen to the USB connection screen. Press  (Playback) button to switch to the playback screen.

Inserting a memory card (sold separately)

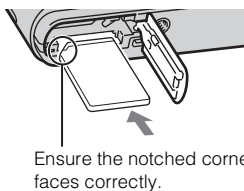
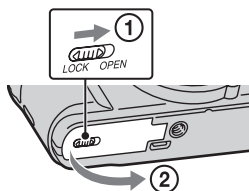

1 Open the cover.

2 Insert the memory card (sold separately).

- With the notched corner facing as illustrated, insert the memory card until it clicks into place.

3 Close the cover.

■ Memory cards that can be used

	Memory card	For still images	For movies
A	Memory Stick PRO Duo	○	○ (Mark2 only)
	Memory Stick PRO-HG Duo	○	○
	Memory Stick Duo	○	—
B	Memory Stick Micro (M2)	○	—
	Memory Stick Micro (Mark2)	○	○
C	SD memory card	○	○ (Class 4 or faster)
	SDHC memory card	○	○ (Class 4 or faster)
	SDXC memory card	○	○ (Class 4 or faster)
D	microSD memory card	○	○ (Class 4 or faster)
	microSDHC memory card	○	○ (Class 4 or faster)

- In this manual, the products in the table are collectively referred to as follows:
 - A:** “Memory Stick Duo” media
 - B:** “Memory Stick Micro” media
 - C:** SD card
 - D:** microSD memory card

Note

- When using “Memory Stick Micro” media or microSD memory cards with this camera, make sure to use with the appropriate adaptor.

■ To remove the memory card/battery pack

Memory card: Push the memory card in once to eject the memory card.

Battery pack: Slide the battery eject lever. Be sure not to drop the battery pack.

Note

- Never remove the memory card/battery pack when the access lamp (page 10) is lit. This may cause damage to data in the memory card/internal memory.

Setting the clock

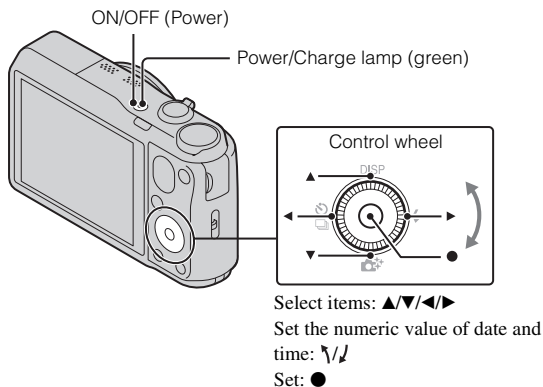

- 1 Press the ON/OFF (Power) button.
Date & Time setting is displayed when you turn on the camera for the first time.
 - It may take time for the power to turn on and allow operation.
- 2 Select a desired language.
- 3 Select a desired geographic location by following the on-screen instructions, then press ● on the control wheel.
- 4 Set [Date & Time Format], [Summer Time] and [Date & Time], then select [OK] → [OK].
 - Midnight is indicated as 12:00 AM, and noon as 12:00 PM.
- 5 Follow the instructions on the screen.
 - The battery pack will run out quickly when:
 - [GPS setting] is set to [On] (DSC-HX20V/HX30V only).
 - [Disp. Resolution] is set to [High].

Shooting still images/movies

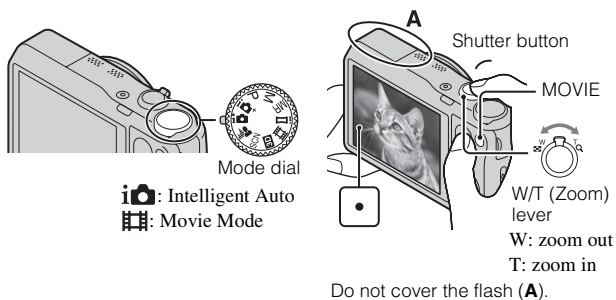

Shooting still images

- 1 Press the shutter button halfway down to focus.
When the image is in focus, a beep sounds and the ● indicator lights.
- 2 Press the shutter button fully down to shoot an image.

Shooting movies

- 1 Press the MOVIE (Movie) button to start recording.
 - Use the W/T (zoom) lever to change the zoom scale.
 - Press the shutter button to shoot still images while continuing to record the movie.
- 2 Press the MOVIE button again to stop recording.

Notes

- Do not push down or pull up the flash manually. This may cause a malfunction.
- The sound of the lens and lever operating will be recorded when the zoom function operates while shooting a movie. The sound of the MOVIE button operating may also be recorded when movie recording is finished.
- Continuous shooting is possible for approximately 29 minutes at one time at the camera's default settings and when the temperature is approximately 25°C (77°F). When movie recording is finished, you can restart recording by pressing the MOVIE button again. Recording may stop to protect the camera depending on the ambient temperature.

Viewing images

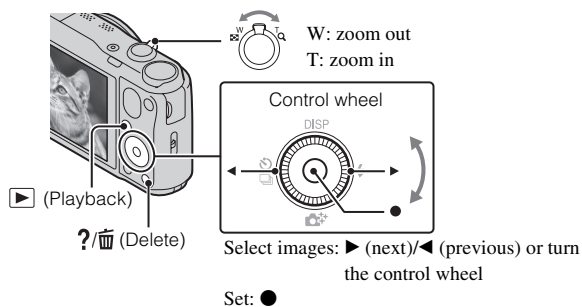

1 Press the ► (Playback) button.

- When images on a memory card recorded with other cameras are played back on this camera, the registration screen for the data file appears.

■ Selecting next/previous image

Select an image by pressing ► (next)/◄ (previous) on the control wheel or by turning the control wheel. Press ● in the center of the control wheel to view movies.

■ Deleting an image

- 1 Press ?/🗑️ (Delete) button.
- 2 Select [This Image] with ▲ on the control wheel, then press ●.

■ Returning to shooting images

Press the shutter button halfway down.

In-Camera Guide

This camera is equipped with a built-in instruction guide. This allows you to search the camera's functions according to your needs.

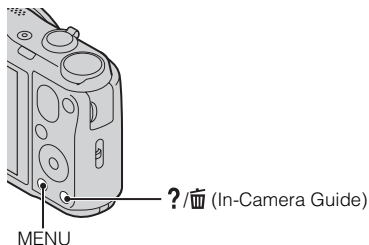

1 Press the MENU button.

2 Select the desired MENU item, then press the ?/▣ (In-Camera Guide) button.

The operation guide for the selected item is displayed.

- If you press the ?/▣ (In-Camera Guide) button when the MENU screen is not displayed, you can search the guide using keywords or icons.

Introduction of other functions

Other functions used when shooting or playing back can be operated using the control wheel or MENU button on the camera. This camera is equipped with a Function Guide that allows you to easily select from the functions. While displaying the guide, you can use various functions.

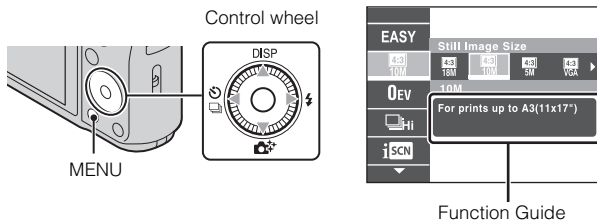

■ Control wheel

DISP (Display Setting): Allows you to change the screen display.

 (Cont. Shooting/Self-Timer): Allows you to use the self-timer and burst shooting mode.

 (Photo Creativity): Allows you to change [Brightness], [Color], [Vividness] and [Picture Effect] when shooting mode is set to [Intelligent Auto] or [Superior Auto].

 (Flash): Allows you to select a flash mode for still images.

Center button (Tracking focus): The camera tracks the subject and adjusts focus automatically even when the subject is moving.

■ Menu Items

Shooting

Movie shooting scene	Select movie recording mode.
3D Shooting	Select the 3D image shooting mode.
Scene Selection	Select pre-set settings to match various scene conditions.
Memory recall mode	Select a setting you want to recall when the mode dial is set to [Memory recall mode].
Picture Effect	Shoot a still image with an original texture according to the desired effect.
Easy Mode	Shoot still images using minimal functions.
Defocus Effect	Set the level of background defocus effect when shooting in Background Defocus mode.
Still Image Size (Dual Rec)	Set the still image size shot while recording a movie.
Still Image Size/ Panorama Image Size/ Movie Size/ Movie Quality	Select the image size and the quality for still images, panoramic images or movie files.
HDR Painting effect	When [HDR Painting] is selected in Picture Effect, sets the effect level.
Area of emphasis	When [Miniature] is selected in Picture Effect, sets the part to focus on.

Color hue	When [Toy camera] is selected in Picture Effect, sets the color hue.
Extracted Color	When [Partial Color] is selected in Picture Effect, selects the color to extract.
Watercolor Effect	When [Watercolor] is selected in Picture Effect, sets the effect level.
Illustration Effect	When [Illustration] is selected in Picture Effect, sets the effect level.
EV	Adjust the exposure manually.
ISO	Adjust the luminous sensitivity.
White Balance	Adjust color tones of an image.
White Balance Shift	Adjust color tones according to the adjusted value set based on the selected White Balance tone.
Focus	Select the focus method.
Metering Mode	Select the metering mode that sets which part of the subject to measure to determine the exposure.
Cont. Shooting Interval	Select the number of images taken per second for Burst shooting.
Bracket Setting	Set the type of the bracket shooting.
Scene Recognition	Set to automatically detect shooting conditions.
Soft Skin Effect	Set the Soft Skin Effect and the effect level.
Smile Shutter	Set to automatically release the shutter when a smile is detected.
Smile Detection Sensitivity	Set the Smile Shutter function sensitivity for detecting smiles.
Face Detection	Select to detect faces and adjust various settings automatically.
Color Mode	Select the vividness of the image, accompanied by effects.
Color Saturation	Adjust the vividness of the image.
Contrast	Adjust the contrast of the image.
Sharpness	Adjust the sharpness of the image.



Anti Blink	Set to automatically shoot two images and select image in which the eyes are not blinking.
Movie SteadyShot	Set the strength of SteadyShot in movie mode. If you change the setting for [Movie SteadyShot], the angle of view will change.
Position Information* ¹	Check the GPS triangulating status and update the position information.
GPS Log REC* ¹	Record the route taken while carrying the camera.
Register Setting	Register the desired modes or camera settings.
Send to Computer* ²	Back up images by transferring them to a computer connected to a network.
In-Camera Guide	Search the camera's functions according to your needs.

*¹ DSC-HX20V/HX30V only

*² DSC-HX30/HX30V only

Viewing



Slideshow	Select a method of continuous playback.
View on Smartphone*	Upload and transfer images to a smartphone.
View on TV*	View images on a network-enabled TV.
Send to Computer*	Back up images by transferring them to a computer connected to a network.
Send by TransferJet	Transfer data by closely aligning two products equipped with TransferJet.
Delete	Delete an image.
Retouch	Retouch an image using various effects.
Picture Effect	Add various texture on images.
3D Viewing	Set to play back images shot in 3D mode on a 3D TV.
View Mode	Select the display format for images.
Display Cont. Shooting Group	Select to display burst images in groups or display all images during playback.
Protect	Protect the images.
Print (DPOF)	Add a print order mark to a still image.





 Rotate	Rotate a still image to the left.
 In-Camera Guide	Search the camera's functions according to your needs.

* DSC-HX30/HX30V only

Setting items

If you press the MENU button while shooting or during playback,

 (Settings) is provided as a final selection. You can change the default settings on the  (Settings) screen.

 Shooting Settings	Movie format/AF Illuminator/Grid Line/Clear Image Zoom/Digital Zoom/Wind Noise Reduct./Micref Level/Red Eye Reduction/Blink Alert/Write Date/Expanded Focus/Custom Button/Disp. Resolution
 Main Settings	Beep/Panel Brightness/Language Setting/Display color/Demo Mode/Initialize/Function Guide/HDMI Resolution/CTRL FOR HDMI/Eco Mode/USB Connect Setting/USB Power Supply/LUN Setting/Download Music/Empty Music/Airplane Mode/GPS setting ^{*1} /GPS assist data ^{*1} /Dlt. GPS Log Data ^{*1} /TransferJet/Eye-Fi/Version
 Network Settings ^{*2}	WPS Push/Access point settings/Edit Device Name/View on Smartphone/Disp MAC Address
 Memory Card Tool ^{*3}	Format/Create REC.Folder/Change REC.Folder/Delete REC.Folder/Copy/File Number
 Clock Settings	Area Setting/Date & Time Setting/Auto Clock ADJ ^{*1} /Auto Area ADJ ^{*1}

^{*1} DSC-HX20V/HX30V only

^{*2} DSC-HX30/HX30V only

^{*3} If a memory card is not inserted,  (Internal Memory Tool) will be displayed and only [Format] can be selected.

Install PC application (Windows)

The built-in software “PlayMemories Home” allows you to import still images and movies to your computer and use them.

You can shoot or play back images on this camera even if you do not install “PlayMemories Home”, however, “PlayMemories Home” is required to import AVCHD movies to your computer.

- 1 Connect the camera to a computer.
- 2 Windows 7: [Computer] → camera icon → media icon → Double-click [PMHOME.EXE]
Windows XP/Vista: [Computer] (in Windows XP, [My Computer]) → [PMHOME] → Double-click [PMHOME.EXE]
- 3 Follow the instructions on the screen to complete the installation.

Note

- “PlayMemories Home” is not compatible to Mac OS. If you play back images on a Mac, use the applications that are installed on your Mac.
For details, see <http://www.sony.co.jp/imsoft/Mac/>

■ Features of “PlayMemories Home”

Below are examples of the functions available when you use “PlayMemories Home”. To take advantage of the various “PlayMemories Home” functions, connect to the Internet and install the “Expanded Feature”.

- You can import images shot with the camera to a computer and display them.
- You can display images stored on a computer by shooting date in a calendar display.
- You can correct (Red Eye Correction, etc.) still images, print the images, send images by e-mail, and change the shooting date and time.
- You can save and print images with the date.
- You can create a disc from AVCHD movies imported to a computer.
(Expanded Feature)

Number of still images and recordable time of movies

The number of still images and recordable time may vary depending on the shooting conditions and the memory card.

Still images

(Units: Images)

Size \ Capacity	Internal memory	Memory card
	Approx. 105 MB	2 GB
18M	x	xx
VGA	xx	xx
16:9(13M)	x	xx

Movies

The table below shows the approximate maximum recording times. These are the total times for all movie files. Continuous shooting is possible for approximately 29 minutes. The maximum size of an MP4-format movie file is up to approximately 2 GB.

(h (hour), m (minute))

Size \ Capacity	Internal memory	Memory card
	Approx. 105 MB	2 GB
AVC HD 28M (PS)	—	xx m (xx m)
AVC HD 24M (FX)	—	xx m (xx m)
AVC HD 9M (HQ)	—	xx m (xx m)
MP4 12M	—	xx m
MP4 3M	—	x h xx m

The number in () is the minimum recordable time.

- The recordable time of movies varies because the camera is equipped with VBR (Variable Bit Rate), which automatically adjusts image quality depending on the shooting scene. When you record a fast-moving subject, the image is clearer but the recordable time is shorter because more memory is required for recording. The recordable time also varies depending on the shooting conditions, the subject or the image quality/size settings.

Notes on using the camera

Functions built into this camera

- This manual describes each of the functions of TransferJet compatible/incompatible devices, 1080 60i-compatible devices and 1080 50i-compatible devices.
 - To determine whether your camera supports the GPS function, check the model name of your camera.
GPS-compatible: DSC-HX20V/HX30V
GPS-incompatible: DSC-HX30
 - To check if your camera supports the TransferJet function, and whether it is a 1080 60i-compatible device or 1080 50i-compatible device, check for the following marks on the bottom of the camera.
TransferJet-compatible device:  (TransferJet)
1080 60i-compatible device: 60i
1080 50i-compatible device: 50i

- While aboard an airplane, set [Airplane Mode] to [On].
- Do not watch 3D images shot with this camera for extended periods of time on 3D-compatible monitors.
- When you view 3D images shot with this camera on a 3D-compatible monitor, you may experience discomfort in the form of eye strain, fatigue, or nausea. To prevent these symptoms, we recommend that you take regular breaks. However, you need to determine for yourself the length and frequency of breaks you require, as they vary according to the individual. If you experience any type of discomfort, stop viewing the 3D images until you feel better, and consult a physician as necessary. Also refer to the operating instructions supplied with the device or software you have connected or are using with this camera. Note that a child's eyesight is still at the development stage (particularly children below the age of 6). Consult a pediatrician or ophthalmologist before letting your child view 3D images, and make sure he/she observes the above precautions when viewing such images.

On GPS-compatible devices (DSC-HX20V/HX30V only)

- Use GPS in accordance with regulations of countries and regions where you use it.
- If you do not record the direction or location information, set [GPS setting] to [Off].

On use and care

Avoid rough handling, disassembling, modifying, physical shock, or impact such as hammering, dropping, or stepping on the product. Be particularly careful of the lens.

GB
28

This camera is compatible with 1080 60p or 50p-format movies. Unlike standard recording modes up to now, which record in an interlacing method, this camera records using a progressive method. This increases the resolution, and provides a smoother, more realistic image.

CX63370から流用

Notes on recording/playback

- Before you start recording, make a trial recording to make sure that the camera is working correctly.
- The camera is neither dust-proof, nor splash-proof, nor water-proof.
- Avoid exposing the camera to water. If water enters inside the camera, a malfunction may occur. In some cases, the camera cannot be repaired.
- Do not aim the camera at the sun or other bright light. It may cause the malfunction of the camera.
- If moisture condensation occurs, remove it before using the camera.
- Do not shake or strike the camera. It may cause a malfunction and you may not be able to record images. Furthermore, the recording media may become unusable or image data may be damaged.

Do not use/store the camera in the following places

- In an extremely hot, cold or humid place
In places such as in a car parked in the sun, the camera body may become deformed and this may cause a malfunction.
- Under direct sunlight or near a heater
The camera body may become discolored or deformed, and this may cause a malfunction.
- In a location subject to rocking vibration
- Near a location that generates strong radio waves, emits radiation or is strongly magnetic place. Otherwise, the camera may not properly record or play back images.
- In sandy or dusty places
Be careful not to let sand or dust get into the camera. This may cause the camera to malfunction, and in some cases this malfunction cannot be repaired.

On carrying

Do not sit down in a chair or other place with the camera in the back pocket of your trousers or skirt, as this may cause malfunction or damage the camera.

Notes on the screen and lens

The screen is manufactured using extremely high-precision technology so over 99.99% of the pixels are operational for effective use. However, some tiny black and/or bright dots (white, red, blue or green) may appear on the screen. These dots are a normal result of the manufacturing process, and do not affect the recording.

Notes on the flash

- Do not carry the camera by the flash unit, or use excessive strength on it.
- If water, dust or sand get into the open flash unit, it may cause a malfunction.

On camera's temperature

Your camera and battery may get hot due to continuous use, but it is not a malfunction.

On the overheat protection

Depending on the camera and battery temperature, you may be unable to record movies or the power may turn off automatically to protect the camera.

A message will be displayed on the screen before the power turns off or you can no longer record movies. In this case, leave the power off and wait until the camera and battery temperature goes down. If you turn on the power without letting the camera and battery cool enough, the power may turn off again or you may be unable to record movies.

On charging the battery

If you charge a battery that has not been used for a long time, you may be unable to charge it to the proper capacity.

This is due to the battery characteristics, and is not a malfunction. Charge the battery again.

Warning on copyright

Television programs, films, videotapes, and other materials may be copyrighted. Unauthorized recording of such materials may be contrary to the provisions of the copyright laws.

No compensation for damaged content or recording failure

Sony cannot compensate for failure to record or loss or damage of recorded content due to a malfunction of the camera or recording media, etc.

Cleaning the camera surface

Clean the camera surface with a soft cloth slightly moistened with water, then wipe the surface with a dry cloth. To prevent damage to the finish or casing:

- Do not expose the camera to chemical products such as thinner, benzine, alcohol, disposable cloths, insect repellent, sunscreen or insecticide.

Specifications

Camera

[System]

Image device: 7.77 mm (1/2.3 type)

Exmor R CMOS sensor

Total pixel number of camera:

Approx. 16.8 Megapixels

Effective pixel number of camera:

Approx. 16.2 Megapixels

Lens: Sony G 10× zoom lens

f = 4.5 mm – 22.5 mm (25 mm –
125 mm (35 mm film equivalent))

F2.6 (W) – F6.3 (T)

While shooting movies (16:9):

29 mm – 145 mm*

While shooting movies (4:3):

36 mm – 180 mm*

* When [Movie SteadyShot] is set
to [Standard]

SteadyShot: Optical

Exposure control: Automatic exposure,
Manual exposure, Scene Selection
(15 modes)

White balance: Automatic, Daylight,

Cloudy, Fluorescent 1/2/3,

Incandescent, Flash, One Push

Signal format:

For 1080 50i: PAL color, CCIR
standards HDTV 1080/50i
specification

For 1080 60i: NTSC color, EIA
standards HDTV 1080/60i
specification

File format:

Still images: JPEG (DCF, Exif,
MPF Baseline) compliant, DPOF
compatible

3D still images: MPO (MPF
Extended (Disparity Image))
compliant

Movies (AVCHD format):
AVCHD format Ver. 2.0
compatible

Video: MPEG-4 AVC/H.264

Audio: Dolby Digital 2ch,
equipped with Dolby Digital Stereo
Creator

- Manufactured under license from
Dolby Laboratories.

Movies (MP4 format):

Video: MPEG-4 AVC/H.264

Audio: MPEG-4 AAC-LC 2ch

Recording media: Internal Memory
(Approx. 105 MB), “Memory Stick
Duo” media, SD cards, “Memory
Stick Micro” media, microSD
memory cards

Flash: Flash range (ISO sensitivity
(Recommended Exposure Index)
set to Auto):

Approx. 0.2 m to 5.3 m
(7 7/8 inches to 17 feet
4 3/4 inches) (W)

Approx. 1.0 m to 2.2 m
(3 feet 3 3/8 inches to 7 feet
2 5/8 inches) (T)

[Input and Output connectors]

HDMI connector: HDMI mini jack

Micro USB connector:

USB communication

USB communication: Hi-Speed USB
(USB 2.0)

[Screen]

LCD screen:

6.75 cm (2.7 type) TFT drive

Total number of dots:

460 800 dots

[Power, general]

Power: Rechargeable battery pack

NP-BG1, 3.6 V

NP-FG1 (sold separately), 3.6 V

AC Adaptor AC-UB10/UB10B,
5 V

Power consumption (during shooting):

1.0 W

Operating temperature: 0 °C to 40 °C

(32 °F to 104 °F)

Storage temperature: -20 °C to +60 °C

(-4 °F to +140 °F)

Dimensions (CIPA compliant):

92.2 mm × 52.0 mm × 19.1 mm

(3 3/4 inches × 2 1/8 inches ×

25/32 inches) (W/H/D)

Mass (CIPA compliant) (including NP-

BG1 battery pack, "Memory Stick
Duo" media):

Approx. 117 g (4.1 oz)

Microphone: Stereo

Speaker: Monaural

Exif Print: Compatible

PRINT Image Matching III:

Compatible

[Wireless LAN] (DSC-HX30/HX30V only)

Supported format: IEEE 802.11 b/g/n

AC Adaptor AC-UB10/UB10B

Power requirements: AC 100 V to
240 V, 50 Hz/60 Hz, 70 mA

Output voltage: DC 5 V, 0.5 A

Operating temperature: 0 °C to 40 °C
(32 °F to 104 °F)

Storage temperature: -20 °C to +60 °C
(-4 °F to +140 °F)

Dimensions:

Approx. 50 mm × 22 mm × 54 mm

(2 inches × 7/8 inches ×

2 1/4 inches) (W/H/D)

Mass:

For the USA and Canada: Approx.
48 g (1.7 oz)

For countries or regions other than
the USA and Canada: Approx. 43 g
(1.5 oz)

Rechargeable battery pack NP-BG1

Used battery: Lithium-ion battery

Maximum voltage: DC 4.2 V

Nominal voltage: DC 3.6 V

Maximum charge voltage: DC 4.2 V

Maximum charge current: 1.44 A

Capacity:

typical: 3.4 Wh (960 mAh)

minimum: 3.3 Wh (910 mAh)

Design and specifications are subject to
change without notice.

Trademarks

- The following marks are trademarks of Sony Corporation.
Cyber-shot, “Cyber-shot,” “Memory Stick PRO Duo,” “Memory Stick PRO-HG Duo,” “Memory Stick Duo,” “Memory Stick Micro”
- “AVCHD Progressive” and “AVCHD Progressive” logotype are trademarks of Panasonic Corporation and Sony Corporation.
- Windows is registered trademark of Microsoft Corporation in the United States and/or other countries.
- Mac is registered trademark of Apple Inc.
- SDXC logo is a trademark of SD-3C, LLC.
- “” and “PlayStation” are registered trademarks of Sony Computer Entertainment Inc.
- In addition, system and product names used in this manual are, in general, trademarks or registered trademarks of their respective developers or manufacturers. However, the ™ or ® marks are not used in all cases in this manual.



- Add further enjoyment with your PlayStation 3 by downloading the application for PlayStation 3 from PlayStation Store (where available.)
- The application for PlayStation 3 requires PlayStation Network account and application download. Accessible in areas where the PlayStation Store is available.

Additional information on this product and answers to frequently asked questions can be found at our Customer Support Website.

<http://www.sony.net/>

Printed using VOC (Volatile Organic Compound)-free vegetable oil based ink.

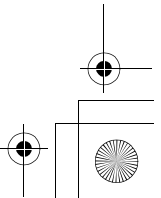
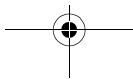
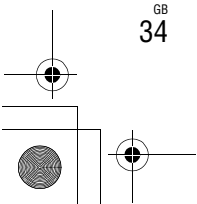
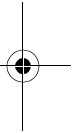
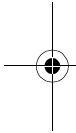
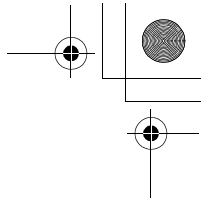
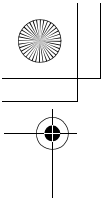

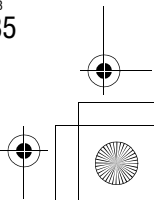
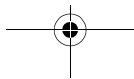
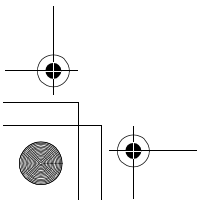
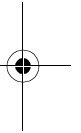
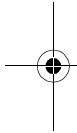
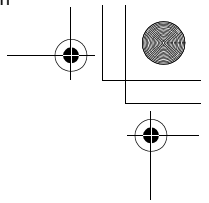
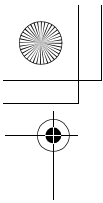

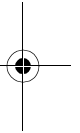
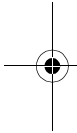
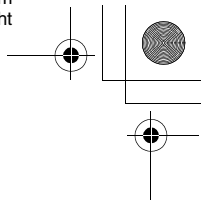
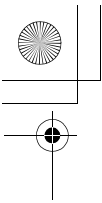

© 2012 Sony Corporation Printed in Thailand



4419606110

Japan

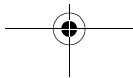
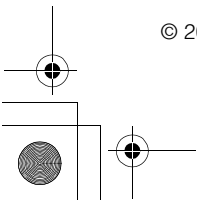

DSC-HX20V/HX30/HX30V
4-419-606-11(1)

