

SONY[®]

4-475-462-21(1)

FM/AM Digital Media Player

Operating Instructions **GB**

Manual de instrucciones **ES**

To switch the FM/AM tuning step, see page 7.
To cancel the demonstration (DEMO) display, see page 17.

Para cambiar el paso de sintonización de FM/AM, consulta la página 7.
Para cancelar la pantalla de demostración (DEMO), consulte la página 18.

 **Bluetooth**[®]

DSX-A55BT

Be sure to install this unit in the dashboard of the car for safety.
For installation and connections, see the supplied installation/connections manual.

Note on the lithium battery

Do not expose the battery to excessive heat such as direct sunlight, fire or the like.

Warning if your car's ignition has no ACC position

Be sure to set the AUTO OFF function (page 17). The unit will shut off completely and automatically in the set time after the unit is turned off, which prevents battery drain. If you do not set the AUTO OFF function, press and hold OFF until the display disappears each time you turn the ignition off.

Warning

This equipment has been tested and found to comply with the limits for a Class B digital device, pursuant to Part 15 of the FCC Rules. These limits are designed to provide reasonable protection against harmful interference in a residential installation. This equipment generates, uses, and can radiate radio frequency energy and, if not installed and used in accordance with the instructions, may cause harmful interference to radio communications. However, there is no guarantee that interference will not occur in a particular installation. If this equipment does cause harmful interference to radio or television reception, which can be determined by turning the equipment off and on, the user is encouraged to try to correct the interference by one or more of the following measures:

- Reorient or relocate the receiving antenna.
- Increase the separation between the equipment and receiver.
- Connect the equipment into an outlet on a circuit different from that to which the receiver is connected.
- Consult the dealer or an experienced radio/TV technician for help.

You are cautioned that any changes or modifications not expressly approved in this manual could void your authority to operate this equipment.

This device complies with Part 15 of the FCC Rules. Operation is subject to the following two conditions: (1) this device may not cause harmful interference, and (2) this device must accept any interference received, including interference that may cause undesired operation.

This transmitter must not be co-located or operated in conjunction with any other antenna or transmitter.

This equipment complies with FCC radiation exposure limits set forth for an uncontrolled environment and meets the FCC radio frequency (RF) Exposure Guidelines. This equipment has very low levels of RF energy that it deemed to comply without maximum permissive exposure evaluation (MPE). But it is desirable that it should be installed and operated keeping the radiator at least 20 cm or more away from person's body (excluding extremities: hands, wrists, feet and ankles).

For the State of California, USA only

Perchlorate Material – special handling may apply. See www.dtsc.ca.gov/hazardouswaste/perchlorate
Perchlorate Material: Lithium battery contains perchlorate

Notes on BLUETOOTH function

Caution

IN NO EVENT SHALL SONY BE LIABLE FOR ANY INCIDENTAL, INDIRECT OR CONSEQUENTIAL DAMAGES OR OTHER DAMAGES INCLUDING, WITHOUT LIMITATION, LOSS OF PROFITS, LOSS OF REVENUE, LOSS OF DATA, LOSS OF USE OF THE PRODUCT OR ANY ASSOCIATED EQUIPMENT, DOWNTIME, AND PURCHASER'S TIME RELATED TO OR ARISING OUT OF THE USE OF THIS PRODUCT, ITS HARDWARE AND/OR ITS SOFTWARE.

IMPORTANT NOTICE!

Safe and efficient use

Changes or modifications to this unit not expressly approved by Sony may void the user's authority to operate the equipment. Please check for exceptions, due to national requirement or limitations, in usage of BLUETOOTH equipment before using this product.

Driving

Check the laws and regulations on the use of cellular phones and handsfree equipment in the areas where you drive.

Always give full attention to driving and pull off the road and park before making or answering a call if driving conditions so require.

Connecting to other devices

When connecting to any other device, please read its user guide for detailed safety instructions.

Radio frequency exposure

RF signals may affect improperly installed or inadequately shielded electronic systems in cars, such as electronic fuel injection systems, electronic antiskid (antilock) braking systems, electronic speed control systems or air bag systems. For installation or service of this device, please consult with the manufacturer or its representative of your car. Faulty installation or service may be dangerous and may invalidate any warranty that may apply to this device.

Consult with the manufacturer of your car to ensure that the use of your cellular phone in the car will not affect its electronic system. Check regularly that all wireless device equipment in your car is mounted and operating properly.

Emergency calls

This BLUETOOTH car handsfree and the electronic device connected to the handsfree operate using radio signals, cellular, and landline networks as well as user-programmed function, which cannot guarantee connection under all conditions. Therefore do not rely solely upon any electronic device for essential communications (such as medical emergencies).

Remember, in order to make or receive calls, the handsfree and the electronic device connected to the handsfree must be switched on in a service area with adequate cellular signal strength.

Emergency calls may not be possible on all cellular phone networks or when certain network services and/or phone features are in use.

Check with your local service provider.

3GB

Table of Contents

Guide to Parts and Controls 5

Getting Started

Detaching the Front Panel 7
 Switching the FM/AM Tuning Step
 (for non-Argentine models) 7
 Setting the Clock 7
 Preparing a BLUETOOTH Device 8
 Connecting a USB Device 9
 Connecting Other Portable Audio
 Device 10

Listening to the Radio

Listening to the Radio 10
 Using Radio Data System (RDS) 11

Playback

Playing a USB Device 12
 Playing a BLUETOOTH Device 12
 Searching and Playing Tracks 13

Handsfree Calling

Receiving a Call 14
 Making a Call 15
 Available Operations during Call 16

Settings

Canceling the DEMO Mode 17
 Basic Setting Operation 17
 General Setup 17
 BT INIT (BLUETOOTH initialize) 18
 Sound Setup 18
 EQ3 PRST (EQ3 preset) 18
 EQ3 LOW, EQ3 MID, EQ3 HIGH 18
 BLUETOOTH Setup 19

Additional Information

Precautions 19
 Maintenance 21
 Specifications 22
 Troubleshooting 24

Guide to Parts and Controls

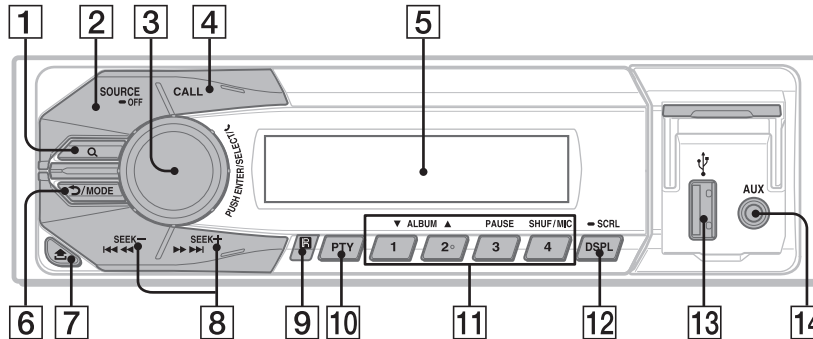

Main unit



The number 2/ALBUM ▲ button has a tactile dot.

- | | |
|--|--|
| <p>1 Q (browse) (page 13)
Enter the browse mode during playback.</p> <p>2 SOURCE
Turn on the power.
Change the source.
-OFF
Press and hold for 1 second to turn off the power.
Press and hold for more than 2 seconds to turn off the power and the display.
If the unit is turned off and the display disappears, it is unable you to operate with the remote.</p> | <p>3 Control dial
Rotate to adjust the volume.
ENTER
Enter the selected item.
SELECT
Enter sound setting.
Press and hold to open the general setup menu.
(handsfree)
Receive/end a call.</p> <p>4 CALL
Enter the call menu.
Press and hold more than 2 seconds to switch the BLUETOOTH signal.</p> <p>5 Display window</p> |
|--|--|

5GB

- 6**  (back)
Return to the previous display.
MODE (page 10, 16)
- 7**  (front panel release)
- 8** **SEEK +/-**
Tune in radio stations automatically.
Press and hold to tune manually.
◀◀/▶▶ (prev/next), **◀/▶**
(reverse/fast-forward)
- 9** **Receptor for the remote commander**
- 10** **PTY (program type)**
Select PTY in RDS.
- 11** **Number buttons**
Receive stored radio stations. Press and hold to store stations.
Call a stored phone number. Press and hold to store a phone number.
ALBUM ▼/▲
Skip an album for audio device. Press and hold to skip albums continuously.
PAUSE
SHUF (shuffle)
MIC (page 16)
- 12** **DSPL (display)**
Change display items.
-SCRL (scroll)
Press and hold to scroll a display item.
- 13** **USB port**
- 14** **AUX input jack**

RM-X231 Remote

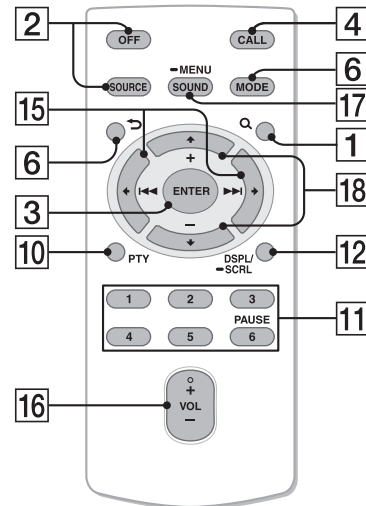

The VOL (volume) + button has a tactile dot.

Remove the insulation film before use.

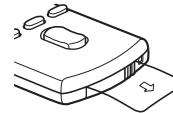

- 15** **◀ (◀◀)/▶ (▶▶)**
- 16** **VOL (volume) +/-**
- 17** **SOUND**
Open the sound setup menu directly.
-MENU
Press and hold to open the general setup menu.
- 18** **↑ (+)/↓ (-)**

Getting Started

Detaching the Front Panel

You can detach the front panel of this unit to prevent theft.

- 1 Press and hold OFF ①.
The unit is turned off.
- 2 Press  ②, then remove the panel by pulling it towards you.

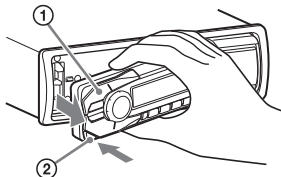

Caution alarm

If you turn the ignition switch to the OFF position without detaching the front panel, the caution alarm will sound for a few seconds. The alarm will only sound if the built-in amplifier is used.

Attaching the front panel

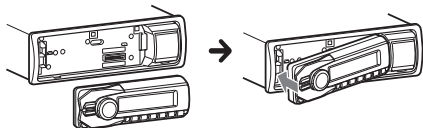

Switching the FM/AM Tuning Step (for non-Argentine models)

Set the FM/AM tuning step of your country. This setting appears when this unit is turned off.

- 1 Press and hold SELECT.
The setup display appears.
- 2 Rotate the control dial to select [TUNER-STP], then press it.
- 3 Rotate the control dial to select from [50K/9K], [100K/10K] or [200K/10K], then press it.

Setting the Clock

- 1 Press and hold SELECT.
The setup display appears.
- 2 Rotate the control dial to select [CLOCK-ADJ], then press it.
The hour indication flashes.
- 3 Rotate the control dial to set the hour and minute.
To move the digital indication, press SEEK +/-.

4 After setting the minute, press SELECT.

The setup is complete and the clock starts.

To display the clock, press DSPL.

Preparing a BLUETOOTH Device

You can enjoy music, or perform handsfree calling, by connecting a suitable BLUETOOTH device. For details on connecting, refer to the operating instructions supplied with the device.

Before connecting the device, turn down the volume of this unit; otherwise, loud sound may result.

Pairing and connecting with a BLUETOOTH device

When connecting a BLUETOOTH device (cellular phone, audio device, etc.) for the first time, mutual registration (called "pairing") is required. Pairing enables this unit and other devices to recognize each other.



1 Place the BLUETOOTH device within 1 m (3 ft) of this unit.

2 Press CALL, rotate the control dial to select [PAIRING], then press it.

flashes.

The unit enters pairing standby mode.

3 Perform pairing on the BLUETOOTH device so it detects this unit.

4 Select [Sony Automotive] shown in the display of the BLUETOOTH device.

If [Sony Automotive] does not appear, repeat from step 2.



5 If passkey* input is required on the BLUETOOTH device, input [0000].

* Passkey may be called "passcode," "PIN code," "PIN number" or "Password," etc., depending on the device.

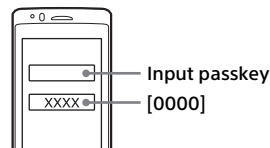

When pairing is made, stays lit.

6 Select this unit on the BLUETOOTH device to establish the BLUETOOTH connection.

or lights up when the connection is made.

Note

While connecting to a BLUETOOTH device, this unit cannot be detected from another device. To enable detection, enter the pairing mode and search for this unit from another device.

To cancel pairing

Perform step 2 to cancel the pairing mode after this unit and the BLUETOOTH device are paired.

Connecting with a paired BLUETOOTH device

To use a paired device, connection with this unit is required. Some paired devices will connect automatically.



- 1** Press CALL, rotate the control dial to select [BT SIGNL], then press it. Make sure that lights up.
- 2** Activate the BLUETOOTH function on the BLUETOOTH device.
- 3** Operate the BLUETOOTH device to connect to this unit. or lights up.

Icons in the display:

	Lights up when a cellular phone is connected to the unit.
	Lights up when an audio device is connected to the unit.

To connect the last-connected device from this unit

Activate the BLUETOOTH function on the BLUETOOTH device.

Press SOURCE.

Select [BT PHONE] or [BT AUDIO].

Press (handsfree) to connect with the cellular phone, or PAUSE to connect with the audio device.

Note

While streaming BLUETOOTH audio, you cannot connect from this unit to the cellular phone. Connect from the cellular phone to this unit instead.

Tip

With BLUETOOTH signal on: when the ignition is turned to on, this unit reconnects automatically to the last-connected cellular phone.

Connecting a USB Device

- 1** Turn down the volume on the unit.
- 2** Connect the USB device to the unit.

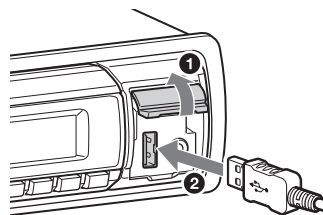

Connecting Other Portable Audio Device

- 1 Turn off the portable audio device.
- 2 Turn down the volume on the unit.
- 3 Connect the portable audio device to the AUX input jack (stereo mini jack) on the unit with a connecting cord (not supplied)*.

* Be sure to use a straight type plug.

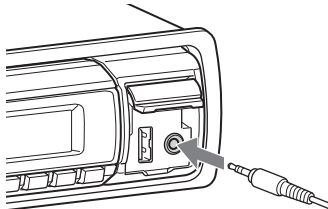

- 4 Press SOURCE to select [AUX].

To match the volume level of the connected device to other sources

Start playback of the portable audio device at a moderate volume, and set your usual listening volume on the unit.

Press SELECT, and rotate the control dial to select [AUX VOL] (page 18).

Listening to the Radio

Listening to the Radio

To listen to the radio, press SOURCE to select [TUNER].

Storing automatically (BTM)

- 1 Press MODE to change the band.
- 2 Press and hold SELECT (FM1, FM2, FM3, AM1 or AM2).
The setup display appears.
- 3 Rotate the control dial to select [BTM], then press it.
The unit stores stations in order of frequency on the number buttons.

Tuning

- 1 Press MODE to change the band (FM1, FM2, FM3, AM1 or AM2).
- 2 Perform tuning.
 - To tune manually**
Press and hold SEEK +/- to locate the approximate frequency, then press SEEK +/- repeatedly to fine adjust to the desired frequency.
 - To tune automatically**
Press SEEK +/-.
Scanning stops when the unit receives a station. Repeat this procedure until the desired station is received.

Storing manually

- 1 While receiving the station that you want to store, press and hold a number button (1 to 6) until [MEM] appears.

Receiving the stored stations

- 1 Select the band, then press a number button (1 to 6).

Using Radio Data System (RDS)

Selecting program types (PTY)

Use PTY to display or search for a desired program type.

- 1 Press PTY during FM reception.
- 2 Rotate the control dial until the desired program type appears, then press it.
The unit starts to search for a station broadcasting the selected program type.

Type of programs

NEWS (News), **AFFAIRS** (Current Affairs), **INFO** (Information), **SPORT** (Sports), **EDUCATE** (Education), **DRAMA** (Drama), **CULTURE** (Culture), **SCIENCE** (Science), **VARIED** (Varied), **POP M** (Pop Music), **ROCK M** (Rock Music), **EASY M** (M.O.R. Music), **LIGHT M** (Light classical), **CLASSICS** (Serious classical), **OTHER M** (Other Music), **WEATHER** (Weather), **FINANCE** (Finance), **CHILDREN** (Children's program), **SOCIAL A** (Social Affairs), **RELIGION** (Religion), **PHONE IN** (Phone In), **TRAVEL** (Travel), **LEISURE** (Leisure), **JAZZ** (Jazz Music), **COUNTRY** (Country Music), **NATION M** (National Music), **OLDIES** (Oldies Music), **FOLK M** (Folk Music), **DOCUMENT** (Documentary)

Setting clock time (CT)

The CT data from the RDS transmission sets the clock.

- 1 Set [CT-ON] in the general setup (page 17).

Playback

Playing a USB Device

MSC (Mass Storage Class)-type USB devices (such as a USB flash drive, digital media player, Android™ phone) compliant with the USB standard can be used.

Depending on the digital media player or Android phone, setting the USB connection mode to MSC is required.

Notes

- For details on the compatibility of your USB device, visit the support site on the back cover.
- Playback of the following MP3/WMA files is not supported.
 - lossless compression files
 - copyright-protected files
 - DRM (Digital Rights Management) files
 - Multi-channel audio files

1 Connect a USB device to the USB port (page 9).

Playback starts.

If a device is already connected, to start playback, press SOURCE to select [USB].

2 Adjust the volume on this unit.

To stop playback

Press and hold OFF for 1 second.

To remove the device

Stop playback, then remove the device.

12GB

Playing a BLUETOOTH Device

You can play contents on a connected device that supports BLUETOOTH A2DP (Advanced Audio Distribution Profile).



1 Make BLUETOOTH connection with the audio device (page 8).

2 Press SOURCE to select [BT AUDIO].

3 Operate the audio device to start playback.

4 Adjust the volume on this unit.

5 Press PAUSE to start playback.

Notes

- Depending on the audio device, information such as title, track number/time and playback status may not be displayed on this unit.
- Even if the source is changed on this unit, playback of the audio device does not stop.

To match the volume level of the BLUETOOTH device to other sources

Start playback of the BLUETOOTH audio device at a moderate volume, and set your usual listening volume on the unit. Press SELECT, and rotate the control dial to select [BTA VOL] (page 18).

Searching and Playing Tracks

Repeat play and shuffle play

Repeat play:

- 1 During playback, press and hold **SELECT**.
- 2 Rotate the control dial to select [**REPEAT**], then press it.
- 3 Rotate the control dial to select the desired play mode, then press it.
- 4 Press **↵** (back) to return to the previous display.

Shuffle play:

- 1 During playback, press **SHUF** repeatedly to select the desired play mode.
Playback in selected play mode may take time to start.

Available play modes differ depending on the selected sound source.

Searching a track by name (Quick-BrowZer™)

- 1 During USB playback, press **Q** (browse)* to display the list of search categories.
When the track list appears, press **↵** (back) repeatedly to display the desired search category.
* During playback, press **Q** (browse) for more than 2 seconds to directly return to the beginning of the category list.
- 2 Rotate the control dial to select the desired search category, then press it to confirm.
- 3 Repeat step 2 to search the desired track.
Playback starts.

To exit the Quick-BrowZer mode

Press **Q** (browse).

Searching by skipping items (Jump mode)

- 1 Press **Q** (browse).
- 2 Press **SEEK +**.
- 3 Rotate the control dial to select the item.
The list is jumped in steps of 10% of the total number of items.

4 Press ENTER to return to the Quick-BrowZer mode.

The selected item appears.

5 Rotate the control dial to select the desired item, then press it.

Playback starts.

Handsfree Calling

To use a cellular phone, connect it with this unit. For details, see "Preparing a BLUETOOTH Device" (page 8).



Receiving a Call

1 Press (handsfree) when a call is received with a ringtone.

The phone call starts.

Note

The ringtone and talker's voice are output only from the front speakers.

To reject the call

Press and hold OFF for 1 second.

To end the call

Press  (handsfree) again.

14GB

Making a Call

You can make a call from the phonebook or call history when a cellular phone supporting PBAP (Phone Book Access Profile) is connected.

Calling from the phonebook

- 1 Press **CALL**, rotate the control dial to select **[PH BOOK]**, then press it.
- 2 Rotate the control dial to select an initial from the initial list, then press it.
- 3 Rotate the control dial to select a name from the name list, then press it.
- 4 Rotate the control dial to select a number from the number list, then press it.
The phone call starts.

Calling from the call history

- 1 Press **CALL**, rotate the control dial to select **[RECENT]**, then press it.
A list of the call history appears.
- 2 Rotate the control dial to select a name or phone number from the call history, then press it.
The phone call starts.

Calling by phone number input

- 1 Press **CALL**, rotate the control dial to select **[DIAL NUM]**, then press it.
- 2 Rotate the control dial to enter the phone number, and lastly select **[]** (space), then press **☎** (handsfree)*.
The phone call starts.
* To move the digital indication, press **SEEK +/-**.

Note

[] appears instead of [#] on the display.

Calling by redial

- 1 Press **CALL**, rotate the control dial to select **[REDIAL]**, then press it.
The phone call starts.

Presetting phone numbers

You can store up to 6 contacts in the preset dial.

- 1 Select a phone number that you want to store in the preset dial, from the phonebook, call history or by inputting the phone number directly.
The phone number appears in the display of this unit.
- 2 Press and hold a number button (1 to 6) until **[MEM]** appears.
The contact is stored in the selected preset number.

Calling by preset number

- 1 Press CALL.
- 2 Press a number button (1 to 6) to select the contact you want to call.
- 3 Press  (handsfree).
The phone call starts.

Calling by voice tags

You can make a call by saying the voice tag stored in a connected cellular phone that has a voice dialing function.

- 1 Press CALL, rotate the control dial to select [VO DIAL], then press it.
- 2 Say the voice tag stored on the cellular phone.
Your voice is recognized, and the call is made.

Adjusting the ringtone volume:
Rotate the control dial while receiving a call.

Adjusting the talker's voice volume:
Rotate the control dial during a call.

To adjust the volume for the other party (Mic gain adjustment)

Press MIC.
Adjustable volume levels: [MIC-LOW], [MIC-MID], [MIC-HI].

To reduce echo and noise (Echo Canceled/Noise Canceled Mode)

Press and hold MIC.
Settable mode: [EC/NC-1], [EC/NC-2].

To transfer a call

In order to activate/deactivate the appropriate device (this unit/cellular phone), press MODE or use your cellular phone.

Note

Depending on the cellular phone, handsfree connection may be cut off when call transfer is attempted.

Available Operations during Call

To preset the volume of the ringtone and talker's voice

You can preset the volume level of the ringtone and talker's voice.

16GB

Settings

Canceling the DEMO Mode

You can cancel the demonstration display which appears while this unit is turned off.

- 1** Press and hold **SELECT**.
The setup display appears.
- 2** Rotate the control dial to select **[DEMO]**, then press it.
- 3** Rotate the control dial to select **[DEMO-OFF]**, then press it.
The setting is complete.
- 4** Press **↵** (back).
The display returns to normal reception/play mode.

Basic Setting Operation

You can set items in the menu to the following procedure.
The following items can be set depending on the source and setting.

- 1** Press **SELECT** for the sound setup, press and hold **SELECT** for the general setup, or press **CALL** for the **BLUETOOTH** setup.
- 2** Rotate the control dial to select the desired item, then press it.

- 3** Rotate the control dial to select the options, then press it.

To return to the previous display

Press **↵** (back).

General Setup

CLOCK-ADJ (clock adjust) (page 7)

TUNER-STP (tuner step) (page 7)
(Available only for non-Argentine models and when the unit is turned off.)

CT (clock time)
Activates the CT function: [ON], [OFF].

BEEP
Activates the beep sound: [ON], [OFF].

CAUT ALM (caution alarm)
Activates the caution alarm: [ON], [OFF] (page 7). (Available only when the unit is turned off.)

AUX-A (AUX audio)
Activates the AUX source display: [ON], [OFF]. (Available only when the unit is turned off.)

AUTO OFF
Shuts off automatically after a desired time when the unit is turned off: [NO], [30S] (30 seconds), [30M] (30 minutes), [60M] (60 minutes).

BLK OUT (black out)

Turns off the illumination automatically for any source (e.g., during radio reception, etc.) if no operation is performed for 5 seconds: [ON], [OFF].

To turn the light back on, press any button on the unit. (When activated, remote operation is unavailable.)

DEMO (demonstration)

Activates the demonstration: [ON], [OFF].

DIMMER

Changes the display brightness: [ON], [OFF].

AUTO SCR (auto scroll)

Scrolls long items automatically: [ON], [OFF].

REPEAT (page 13)

LOUDNESS (dynamic loudness)

Reinforces bass and treble for clear sound at low volume levels: [ON], [OFF].

BTM (page 10)

BT INIT (BLUETOOTH initialize)

Initializes all the BLUETOOTH related settings (pairing information, preset number, device information, etc.).

When disposing the unit, initialize all the settings. (Available only when the unit is turned off.)

Sound Setup

EQ3 PRST (EQ3 preset)

Selects an equalizer curve from 7 equalizer curves or off: [XPLD], [VOCAL], [EDGE], [CRUISE], [SPACE], [GRAVITY], [CUSTOM], [OFF].

The equalizer curve setting can be memorized for each source.

EQ3 LOW, EQ3 MID, EQ3 HIGH

Sets [CUSTOM] of EQ3.

Customizes the equalizer curve.

The volume level is adjustable in 1 dB steps, from -10 dB to +10 dB.

BALANCE

Adjusts the sound balance: [RIGHT-15 (R15)] – [CENTER (0)] – [LEFT-15 (L15)].

FADER

Adjusts the relative level: [FRONT-15 (F15)] – [CENTER (0)] – [REAR-15 (R15)].

AUX VOL (AUX volume level)

Adjusts the volume level for each connected auxiliary device: [+18 dB] – [0 dB] – [-8 dB].

This setting negates the need to adjust the volume level between sources.

BTA VOL (BLUETOOTH audio volume level)

Adjusts the volume level for each connected BLUETOOTH device: [+18 dB] – [0 dB] – [-8 dB].

This setting negates the need to adjust the volume level between sources.

BLUETOOTH Setup

PAIRING (page 8)

PH BOOK (phone book) (page 15)

REDIAL (page 15)

RECENT (recent call) (page 15)

VO DIAL (voice dial) (page 16)

DIAL NUM (dial number) (page 15)

RINGTONE

Selects whether this unit or the connected cellular phone outputs the ringtone: [1] (this unit), [2] (cellular phone).

AUTO ANS (auto answer)

Sets this unit to answer an incoming call automatically: [OFF], [1] (about 3 seconds), [2] (about 10 seconds).

BT SIGNAL (BLUETOOTH signal) (page 9)

Activates the BLUETOOTH function: [ON], [OFF].

Additional Information

Precautions

- Cool off the unit beforehand if your car has been parked in direct sunlight.
- Do not leave the front panel or audio devices brought in inside the car, or it may cause malfunction due to high temperature in direct sunlight.
- Power antenna (aerial) extends automatically.

To maintain high sound quality

Do not splash liquid onto the unit.

Playback order of MP3/WMA files

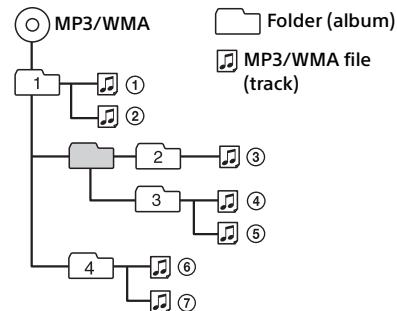

19_{GB}

About BLUETOOTH function

What is BLUETOOTH technology?

- BLUETOOTH wireless technology is a short-range wireless technology that enables wireless data communication between digital devices, such as a cellular phone and a headset. BLUETOOTH wireless technology operates within a range of about 10 m (33 ft). Connecting two devices is common, but some devices can be connected to multiple devices at the same time.
- You do not need to use a cable for connection since BLUETOOTH technology is a wireless technology, neither is it necessary for the devices to face one another, such is the case with infrared technology. For example, you can use such a device in a bag or pocket.
- BLUETOOTH technology is an international standard supported by millions of companies all over the world, and employed by various companies worldwide.

On BLUETOOTH communication

- BLUETOOTH wireless technology operates within a range of about 10 m (33 ft). Maximum communication range may vary depending on obstacles (person, metal, wall, etc.) or electromagnetic environment.
- The following conditions may affect the sensitivity of BLUETOOTH communication.
 - There is an obstacle such as a person, metal, or wall between this unit and BLUETOOTH device.
 - A device using 2.4 GHz frequency, such as a wireless LAN device, cordless telephone, or microwave oven, is in use near this unit.
- Because BLUETOOTH devices and wireless LAN (IEEE802.11b/g) use the same frequency, microwave interference may occur and result in communication speed deterioration, noise, or invalid connection if this unit is used near a wireless LAN device. In such as case, perform the following.
 - Use this unit at least 10 m (33 ft) away from the wireless LAN device.
 - If this unit is used within 10 m (33 ft) of a wireless LAN device, turn off the wireless LAN device.
 - Install this unit and BLUETOOTH device as near to each other as possible.
- Microwaves emitting from a BLUETOOTH device may affect the operation of electronic medical devices. Turn off this unit and other BLUETOOTH devices in the following locations, as it may cause an accident.
 - where inflammable gas is present, in a hospital, train, airplane, or petrol station
 - near automatic doors or a fire alarm
- This unit supports security capabilities that comply with the BLUETOOTH standard to provide a secure connection when the BLUETOOTH wireless technology is used, but security may not be enough depending on the setting. Be careful when communicating using BLUETOOTH wireless technology.
- We do not take any responsibility for the leakage of information during BLUETOOTH communication.
- Connection with all BLUETOOTH devices cannot be guaranteed.
 - A device featuring BLUETOOTH function is required to conform to the BLUETOOTH standard specified by BLUETOOTH SIG, and be authenticated.
 - Even if the connected device conforms to the above mentioned BLUETOOTH standard, some devices may not be

connected or work correctly, depending on the features or specifications of the device.

- While talking on the phone hands free, noise may occur, depending on the device or communication environment.
- Depending on the device to be connected, it may require some time to start communication.

Others

- Using the BLUETOOTH device may not function on cellular phones, depending on radio wave conditions and location where the equipment is being used.
- If you experience discomfort after using the BLUETOOTH device, stop using the BLUETOOTH device immediately. Should any problem persist, consult your nearest Sony dealer.

If you have any questions or problems concerning your unit that are not covered in this manual, consult your nearest Sony dealer.

Maintenance

Replacing the lithium battery of the remote commander

When the battery becomes weak, the range of the remote commander becomes shorter. Replace the battery with a new CR2025 lithium battery. Use of any other battery may present a risk of fire or explosion.

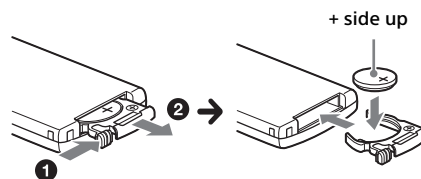

Notes on the lithium battery

- Keep the lithium battery out of the reach of children. Should the battery be swallowed, immediately consult a doctor.
- Wipe the battery with a dry cloth to assure a good contact.
- Be sure to observe the correct polarity when installing the battery.
- Do not hold the battery with metallic tweezers, otherwise a short-circuit may occur.

WARNING

Battery may explode if mistreated.
Do not recharge, disassemble, or dispose of in fire.

Cleaning the connectors

The unit may not function properly if the connectors between the unit and the front panel are not clean. In order to prevent this, detach the front panel (page 7) and clean the connectors with a cotton swab. Do not apply too much force. Otherwise, the connectors may be damaged.

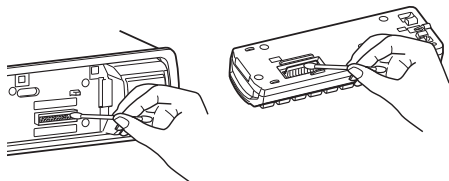

Notes

- For safety, turn off the ignition before cleaning the connectors, and remove the key from the ignition switch.
- Never touch the connectors directly with your fingers or with any metal device.

Specifications

Tuner section

FM

Tuning range:

For non-Argentine models:

87.5 – 108.0 MHz (at 50 kHz step)

87.5 – 108.0 MHz (at 100 kHz step)

87.5 – 107.9 MHz (at 200 kHz step)

For Argentine models:

87.5 – 107.9 MHz

FM tuning step (for non-Argentine models):

50 kHz/100 kHz/200 kHz switchable

Antenna (aerial) terminal:

External antenna (aerial) connector

Intermediate frequency: 25 kHz

Usable sensitivity: 8 dBf

Selectivity: 75 dB at 400 kHz

Signal-to-noise ratio: 80 dB (stereo)

Separation: 50 dB at 1 kHz

Frequency response: 20 – 15,000 Hz

AM

Tuning range:

For non-Argentine models:

531 – 1,602 kHz (at 9 kHz step)

530 – 1,710 kHz (at 10 kHz step)

For Argentine models:

530 – 1,710 kHz

AM tuning step (for non-Argentine models):

9 kHz/10 kHz switchable

Antenna (aerial) terminal:

External antenna (aerial) connector

Intermediate frequency:

For non-Argentine models:

9,124.5 kHz or 9,115.5 kHz/4.5 kHz (at 9 kHz step)

9,115 kHz or 9,125 kHz/5 kHz (at 10 kHz step)

For Argentine models:

9,115 kHz or 9,125 kHz/5 kHz

Sensitivity: 26 μ V

USB Player section

Interface: USB (Full-speed)

Maximum current: 1 A

The maximum number of recognizable data:

Folders (albums): 128

Files (tracks) per folder: 512

Corresponding codec:

MP3 (.mp3) and WMA (.wma)

Wireless Communication

Communication System:

BLUETOOTH Standard version 2.1 + EDR

Output:

BLUETOOTH Standard Power Class 2

(Max. +4 dBm)

Maximum communication range:

Line of sight approx. 10 m (33 ft)*1

Frequency band:

2.4 GHz band (2.4000 – 2.4835 GHz)

Modulation method: FHSS

Compatible BLUETOOTH Profiles*2:

A2DP (Advanced Audio Distribution Profile)

1.2

AVRCP (Audio Video Remote Control Profile)
1.3
HFP (Handsfree Profile) 1.5
PBAP (Phone Book Access Profile)

- *1 The actual range will vary depending on factors such as obstacles between devices, magnetic fields around a microwave oven, static electricity, reception sensitivity, antenna (aerial)'s performance, operating system, software application, etc.
- *2 BLUETOOTH standard profiles indicate the purpose of BLUETOOTH communication between devices.

Power amplifier section

Output: Speaker outputs
Speaker impedance: 4 – 8 ohms
Maximum power output: 55 W × 4 (at 4 ohms)

General

Outputs:

For non-Argentine models:
Audio outputs terminal (rear)
Power antenna (aerial)/Power amplifier control terminal (REM OUT)

For Argentine models:
Audio outputs terminal (rear)
Power antenna (aerial) relay control terminal
Power amplifier control terminal

Inputs:

Remote controller input terminal
Antenna (aerial) input terminal
AUX input jack (stereo mini jack)
USB port

Power requirements: 12 V DC car battery
(negative ground (earth))

Dimensions:

Approx. 178 mm × 50 mm × 120 mm
(7 1/8 in × 2 in × 4 7/8 in) (w/h/d)

Mounting dimensions:

Approx. 182 mm × 53 mm × 103 mm
(7 1/4 in × 2 1/8 in × 4 1/8 in) (w/h/d)

Mass: Approx. 0.7 kg (1 lb 9 oz)

Package contents:

Main unit (1)
Remote commander (1): RM-X231
Parts for installation and connections (1 set)

Your dealer may not handle some of the above listed accessories. Please ask the dealer for detailed information.

Design and specifications are subject to change without notice.

Copyrights

The Bluetooth® word mark and logos are owned by the Bluetooth SIG, Inc. and any use of such marks by Sony Corporation is under license. Other trademarks and trade names are those of their respective owners.

Windows Media is either a registered trademark or trademark of Microsoft Corporation in the United States and/or other countries.

This product is protected by certain intellectual property rights of Microsoft Corporation. Use or distribution of such technology outside of this product is prohibited without a license from Microsoft or an authorized Microsoft subsidiary.

MPEG Layer-3 audio coding technology and patents licensed from Fraunhofer IIS and Thomson.

Android is a trademark of Google Inc. Use of this trademark is subject to Google Permissions.

Troubleshooting

The following checklist will help you remedy problems you may encounter with your unit. Before going through the checklist below, check the connection and operating procedures.

For details on using the fuse and removing the unit from the dashboard, refer to the installation/connections manual supplied with this unit.

If the problem is not solved, visit the support site on the back cover.

General

No power is being supplied to the unit.

- If the unit is turned off and the display disappears, the unit cannot be operated with the remote commander.
 - Turn on the unit.

No sound.

- The position of the fader control [FADER] is not set for a 2-speaker system.

No beep sound.

- An optional power amplifier is connected and you are not using the built-in amplifier.

The contents of the memory have been erased.

- The power supply lead or battery has been disconnected or not connected properly.

Stored stations and correct time are erased.

The fuse has blown.

Makes a noise when the position of the ignition is switched.

- The leads are not matched correctly with the car's accessory power connector.

During playback or reception, the demonstration mode starts.

- If no operation is performed for 5 minutes with [DEMO-ON] set, the demonstration mode starts.
 - Set [DEMO-OFF] (page 18).

The display disappears from/does not appear in the display window.

- The dimmer is set to [DIM-ON] (page 18).
- The display disappears if you press and hold OFF.
 - Press OFF on the unit until the display appears.
- The connectors are dirty (page 21).

The display disappears while the unit is operating.

- The Black Out function is set to on (page 18).

Radio reception

Stations cannot be received.

The sound is hampered by noises.

- The connection is not correct.
 - If your car has built-in radio antenna (aerial) in the rear/side glass, connect an REM OUT lead (blue/white striped) or accessory power supply lead (red) to the power supply lead of a car's antenna (aerial) booster (for non-Argentine models).
 - Check the connection of the car antenna (aerial).
 - If the auto antenna (aerial) will not extend, check the connection of the power antenna (aerial) control lead.
- The tuning step setting has been erased.
 - Set the tuning step again (page 7).

Preset tuning is not possible.

- The broadcast signal is too weak.

RDS

PTY displays [- - - - -].

- The current station is not an RDS station.
- RDS data has not been received.
- The station does not specify the program type.

USB playback

You cannot play back items via a USB hub.

- This unit cannot recognize USB devices via a USB hub.

A USB device takes longer to play back.

- The USB device contains files with a complicated tree structure.

The sound is intermittent.

- The sound may be intermittent at a high-bit-rate of more than 320 kbps.

BLUETOOTH function

The connecting device cannot detect this unit.

- Before the pairing is made, set this unit to pairing standby mode.
- While connected to a BLUETOOTH device, this unit cannot be detected from another device.
 - Disconnect the current connection and search for this unit from another device.
- When the device pairing is made, set the BLUETOOTH signal output to on (page 9).

Connection is not possible.

- The connection is controlled from one side (this unit or BLUETOOTH device), but not both.
 - Connect to this unit from a BLUETOOTH device or vice versa.

The name of the detected device does not appear.

- Depending on the status of the other device, it may not be possible to obtain the name.

No ringtone.

- Adjust the volume by rotating the control dial while receiving a call.
- Depending on the connecting device, the ringtone may not be sent properly.
 - Set [RINGTONE] to [1] (page 19).
- The front speakers are not connected to the unit.
 - Connect the front speakers to the unit. The ringtone is output only from the front speakers.

The talker's voice cannot be heard.

- The front speakers are not connected to the unit.
 - Connect the front speakers to the unit. The talker's voice is output only from the front speakers.

A call partner says that the volume is too low or high.

- Adjust the volume accordingly using mic gain adjustment (page 16).

Echo or noise occurs in phone call conversations.

- Lower the volume.
- Set EC/NC Mode to [EC/NC-1] or [EC/NC-2] (page 16).
- If the ambient noise other than the phone call sound is loud, try reducing this noise.
 - E.g.: If a window is open and road noise, etc., is loud, shut the window. If an air conditioner is loud, lower the air conditioner.

The phone is not connected.

- When BLUETOOTH audio is played, the phone is not connected even if you press  (handsfree).
 - Connect from the phone.

The phone sound quality is poor.

- Phone sound quality depends on reception conditions of cellular phone.
 - Move your car to a place where you can enhance the cellular phone's signal if the reception is poor.

The volume of the connected audio device is low (high).

- Volume level will differ depending on the audio device.
 - Adjust the volume of the connected audio device or this unit.

The sound skips during playback of a BLUETOOTH audio device.

- Reduce the distance between the unit and the BLUETOOTH audio device.
- If the BLUETOOTH audio device is stored in a case which interrupts the signal, remove the audio device from the case during use.
- Several BLUETOOTH devices or other devices which emit radio waves are in use nearby.
 - Turn off the other devices.
 - Increase the distance from the other devices.
- The playback sound stops momentarily when the connection between this unit and the cellular phone is being made. This is not a malfunction.

The connected BLUETOOTH audio device cannot be controlled.

- Check that the connected BLUETOOTH audio device supports AVRCP.

Some functions do not work.

- Check if the connecting device supports the functions in question.

A call is answered unintentionally.

- The connecting phone is set to answer a call automatically.

Pairing failed due to time out.

- Depending on the connecting device, the time limit for pairing may be short.
 - Try completing the pairing within the time.

BLUETOOTH function cannot operate.

- Turn off the unit by pressing OFF for more than 2 seconds, then turn the unit on again.

No sound is output from the car speakers during handsfree call.

- If the sound is output from the cellular phone, set the cellular phone to output the sound from the car speakers.

Error displays/Messages**CHECKING**

- The unit is confirming the connection of a USB device.
 - Wait until confirming the connection is finished.

ERROR

- There may be an internal malfunction.
 - Press OFF for more than 2 seconds (the display disappears), then press OFF again.

ERROR-99

- There may be an internal malfunction.
 - Press OFF for more than 2 seconds (the display disappears), then press OFF again. If the error indication remains on in the display, consult your nearest Sony dealer.

NO MUSIC

- The USB device does not contain a music file.
 - Connect a USB device with a music file in it.

NO NAME

- An album/artist/track name is not written in the USB.

NO SUPRT (not supported)

- USB hub is not supported on this unit.
- The connected USB device is not supported. For details on the compatibility of your USB device, visit the support site on the back cover.

NO USB

- USB is selected as source without a USB device connected. A USB device or a USB cable has been disconnected during playback.
 - Be sure to connect a USB device and USB cable.

OVERLOAD

- USB device is overloaded.
 - Disconnect the USB device, then change the source by pressing OFF.
 - Indicates that the USB device is out of order, or an unsupported device is connected.

READ

- The unit is reading all track and album information on the USB device.
 - Wait until reading is complete and playback starts automatically. Depending on the USB device structure, it may take more than a minute.

For BLUETOOTH function:

BT BUSY (BLUETOOTH busy)

- The phonebook and the call history of the cellular phone are not accessible from this unit.
 - Wait for a while, and then try again.

ERROR

- BT Initialize failed.
- Phonebook access failed.
- Phonebook content was changed while accessing the cellular phone.
 - Access the phonebook in the cellular phone again.

MEM FAIL (memory failure)

- This unit failed to store the contact in the preset dial.
 - Make sure that the number you intend to store is correct (page 15).

NO BTA (no BLUETOOTH audio)

- BLUETOOTH audio source is selected without a BLUETOOTH audio device connected. A BLUETOOTH audio device has been disconnected during a call.
 - Be sure to connect a BLUETOOTH audio device.

NO BTP (no BLUETOOTH phone)

- BLUETOOTH phone source is selected without a cellular phone connected. A cellular phone has been disconnected during a call.
 - Be sure to connect a cellular phone.

NO INFO (no information)

- Network name and cellular phone name are not received with cellular phone connected.

NO SUPRT (not supported)

- The BLUETOOTH connected cellular phone does not support PBAP (Phone Book Access)

Profile). In this case, this unit cannot access to the cellular phone's phonebook or call history.

- The cellular phone is not supported by this unit, although the cellular phone supports PBAP (Phone Book Access Profile).
 - Check if the cellular phone is connected correctly. For details on the compatibility of your cellular phone, visit the support site.

P (preset number) EMPTY

- The preset dial is empty.

UNKNOWN

- Name or phone number cannot be displayed when browsing phonebook or call history.

WITHHELD

- Phone number is hidden by caller.

If these solutions do not help improve the situation, consult your nearest Sony dealer.

