

SONY

4-582-886-11(1)

Wireless Noise Canceling Stereo Headset

Casque stéréo sans fil réducteur de bruits

Auriculares estéreo inalámbricos con función de supresión de ruido



DIGITAL NC

Reference Guide table with columns for US, FR, ES



MDR-100ABN

©2016 Sony Corporation Printed in Malaysia

http://www.sony.net/

English

WARNING

To reduce the risk of electrical shock, do not open the cabinet. Refer servicing to qualified personnel only.

Information

FOR UNITED STATES CUSTOMERS. NOT APPLICABLE IN CANADA, INCLUDING IN THE PROVINCE OF QUEBEC.

POUR LES CONSOMMATEURS AUX ÉTATS-UNIS. NON APPLICABLE AU CANADA, Y COMPRIS LA PROVINCE DE QUÉBEC.

CAUTION: Risk of Fire and Burns. Do Not Open, Crush, Heat Above 140°F or Incinerate.

This device complies with Part 15 of the FCC Rules. Operation is subject to the following two conditions: (1) this device may not cause harmful interference, and (2) this device must accept any interference received, including interference that may cause undesired operation.

You are cautioned that any changes or modifications not expressly approved in this manual could void your authority to operate this equipment.

This equipment must not be co-located or operated in conjunction with any other antenna or transmitter.

Note: This equipment has been tested and found to comply with the limits for a Class B digital device, pursuant to Part 15 of the FCC Rules. These limits are designed to provide reasonable protection against harmful interference in a residential installation. This equipment generates, uses and can radiate radio frequency energy and, if not installed and used in accordance with the instructions, may cause harmful interference to radio communications. However, there is no guarantee that interference will not occur in a particular installation. If this equipment does cause harmful interference to radio or television reception, which can be determined by turning the equipment off and on, the user is encouraged to try to correct the interference by one or more of the following measures:

- Reorient or relocate the receiving antenna.
- Increase the separation between the equipment and receiver.
- Connect the equipment into an outlet on a circuit different from that to which the receiver is connected.
- Consult the dealer or an experienced radio/TV technician for help.

This device complies with Industry Canada's licence-exempt RSSs. Operation is subject to the following two conditions: (1) This device may not cause interference, and (2) This device must accept any interference; including interference that may cause undesired operation of the device.

This equipment complies with FCC/IC radiation exposure limits set forth for an uncontrolled environment and meets the FCC radio frequency (RF) Exposure Guidelines and RSS-102 of the IC radio frequency (RF) Exposure rules. This equipment has very low levels of RF energy that is deemed to comply without testing of specific absorption rate (SAR).

The LDAC™ name and logo is a trademark of Sony Corporation.

The Bluetooth® word mark and logos are registered trademarks owned by Bluetooth SIG, Inc. and any use of such marks by Sony Corporation is under license.

The N-Mark is a trademark or registered trademark of NFC Forum, Inc. in the United States and in other countries.

Microsoft, Windows and Windows Vista are registered trademarks or trademarks of Microsoft Corporation in the United States and/or other countries.

Mac and Mac OS are trademarks of Apple Inc., registered in the U.S. and other countries.

iPhone is a trademark of Apple Inc., registered in the U.S. and other countries.

The aptX® mark and the aptX logo are trademarks of CSR plc or one of its group companies and may be registered in one or more jurisdictions.

Other trademarks and trade names are those of their respective owners.

Precautions

On BLUETOOTH communications

- BLUETOOTH wireless technology operates within a range of about 10 m (30 feet). Maximum communication range may vary depending on obstacles (human body, metal, wall, etc.) or electromagnetic environment.
• The antenna is built into the unit as illustrated in the dotted line. The sensitivity of the BLUETOOTH communications will improve by turning the direction of the built-in antenna to the connected BLUETOOTH device. When obstacles are between the antenna of the connected device and the built-in antenna of this unit, noise or audio dropout may occur, or communications may be disabled.

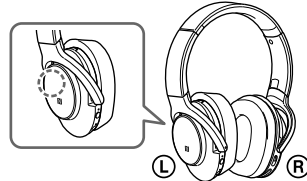

- BLUETOOTH communications may be disabled, or noise or audio dropout may occur under the following conditions:
- There is a human body between the unit and the BLUETOOTH device. This situation may be improved by placing the BLUETOOTH device facing the antenna of the unit.
- There is an obstacle, such as metal or wall, between the unit and the BLUETOOTH device.
- A device using 2.4 GHz frequency, such as a Wi-Fi device, cordless telephone, or microwave oven, is in use near this unit.
• Because BLUETOOTH devices and Wi-Fi (IEEE802.11b/g/n) use the same frequency (2.4 GHz), microwave interference may occur resulting in noise or audio dropout or communications being disabled if this unit is used near a Wi-Fi device. In such a case, perform the following.
- Use this unit at least 10 m (30 feet) away from the Wi-Fi device.
- If this unit is used within 10 m (30 feet) of a Wi-Fi device, turn off the Wi-Fi device.
- Install this unit and the BLUETOOTH device as near to each other as possible.

- Microwaves emitting from a BLUETOOTH device may affect the operation of electronic medical devices. Turn off this unit and other BLUETOOTH devices in the following locations, as it may cause an accident:
- where inflammable gas is present, in a hospital, or a petrol station
- near automatic doors or a fire alarm
• Do not use the unit on an airplane. Radio waves may affect instruments, causing an accident due to malfunction.
• Due to the characteristic of BLUETOOTH wireless technology, the sound played on this unit is slightly delayed from the sound played on the BLUETOOTH device during talking on the telephone or listening to the music.
• This unit supports security capabilities that comply with the BLUETOOTH standard to provide a secure connection when the BLUETOOTH wireless technology is used, but security may not be enough depending on the setting. Be careful when communicating using BLUETOOTH wireless technology.
• We do not take any responsibility for the leakage of information during BLUETOOTH communications.
• Connection with all BLUETOOTH devices cannot be guaranteed.
- A device featuring BLUETOOTH function is required to conform to the BLUETOOTH standard specified by Bluetooth SIG, Inc.

- and be authenticated.
- Even if the connected device conforms to the above mentioned BLUETOOTH standard, some devices may not be connected or work correctly, depending on the features or specifications of the device.
- While talking on the phone hands free, noise may occur, depending on the device or communication environment.
• Depending on the device to be connected, it may require some time to start communications.

Sound skips frequently during playback.

- The situation may be improved by setting the sound quality mode to "priority on sound quality." For details, refer to the Help Guide.
• The situation may be improved by changing the wireless playback quality settings or fixing the wireless playback mode to SBC on the transmitting device. For details, refer to the operating instructions supplied with the transmitting device.

On charging the unit

- This unit can be charged using USB only. Personal computer with USB port is required for charging.
• This unit cannot be turned on, nor can the BLUETOOTH and noise canceling functions be used, during charging.
• You can use the unit by connecting the supplied headphone cable, even while charging the unit.
• If you do not use the unit for a long time, the rechargeable battery may not be able to keep sufficient charge. The battery will be able to keep a charge properly after repeatedly discharging and charging several times.
• If you store the unit for a long time, charge the battery once every half year to prevent over-discharge.
• If the length of time you can use the unit became extremely short, the rechargeable battery should be replaced with a new one. Please contact your nearest Sony dealer for a battery replacement.

Note on static electricity

- Static electricity accumulated in the body may cause mild tingling in your ears. To minimize the effect, wear clothes made from natural materials.

If the unit does not operate properly

- Reset the unit. Press the and NC buttons simultaneously while charging. The unit will be reset. Pairing information is not deleted.
- Be careful not to drop the unit into a sink or other container filled with water.
- Do not use the unit in humid locations or bad weather, such as in the rain or snow.
- Do not get the unit wet. If you touch the unit with wet hands, or put the unit in a damp article of clothing, the unit may get wet and this may cause a malfunction of the unit.
• If you experience discomfort after using the unit, stop using the unit immediately.
• The earpads may deteriorate due to long-term storage or use.
• If you have any questions or problems concerning this unit that are not covered in this manual, please consult your nearest Sony dealer.

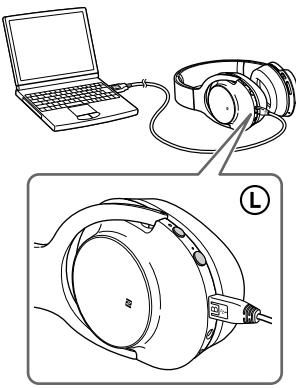

- noise may occur depending on street conditions.
- Mobile phones may cause interference and noise. Should this occur, locate the unit further away from the mobile phone.
- Do not cover the microphones of the headset (MIC) with your hands. The noise canceling function may not work properly.

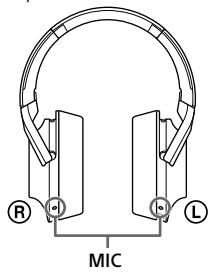

Others

- Be careful not to catch your finger in the unit when folding.
• When you use the unit as wired headphones, use the supplied headphone cable only. Make sure that the headphone cable is firmly inserted.
• Do not place this unit in a place exposed to humidity, dust, soot or steam, subject to direct sunlight, or in a car waiting at a traffic signal. It may cause a malfunction.
• Using the BLUETOOTH device may not function on mobile phones, depending on radio wave conditions and location where the equipment is being used.
• Listening with this unit at high volume may affect your hearing.
• For traffic safety, do not use this unit while driving or cycling.
• Do not use the unit in places where it would be dangerous if you are unable to hear ambient sound, such as at railroad crossings, train station platforms, and construction sites.
• Do not put weight or pressure on this unit as it may cause the unit to deform during long storage.
• Do not subject the unit to excessive shock.
• Clean the unit with a soft dry cloth.
• Do not expose the unit to water. The unit is not waterproof. Remember to follow the precautions below.
- Be careful not to drop the unit into a sink or other container filled with water.
- Do not use the unit in humid locations or bad weather, such as in the rain or snow.
- Do not get the unit wet. If you touch the unit with wet hands, or put the unit in a damp article of clothing, the unit may get wet and this may cause a malfunction of the unit.
• If you experience discomfort after using the unit, stop using the unit immediately.
• The earpads may deteriorate due to long-term storage or use.
• If you have any questions or problems concerning this unit that are not covered in this manual, please consult your nearest Sony dealer.

Optional replacement earpads can be ordered from your nearest Sony dealer.

Specifications

General

- Communication system: BLUETOOTH Specification version 4.0
Output: BLUETOOTH Specification Power Class 2
Maximum communication range: Line of sight approx. 10 m (30 ft)
Frequency band: 2.4 GHz band (2.4000 Hz - 2.4835 GHz)
Modulation method: FHSS
Compatible BLUETOOTH profiles*: A2DP (Advanced Audio Distribution Profile) AVRCP (Audio Video Remote Control Profile) HFP (Hands-free Profile) HSP (Headset Profile)
Supported Codec*: SBC*, AAC*, aptX, LDAC
Supported content protection method: SCMS-T
Transmission range (A2DP): 20 Hz - 20,000 Hz (Sampling frequency 44.1 kHz) 20 Hz - 40,000 Hz (Sampling frequency LDAC 96 kHz, 990 kbps)
Included items: Wireless noise canceling stereo headset (1) Micro-USB cable (approx. 50 cm (19 3/4

- in.)) (1) Headphone cable (approx. 1.2 m (47 1/4 in.)) (1) Carrying case (1) Reference Guide (this sheet) (1) Start Guide (1) Other documents (1 set)

- 1) The actual range will vary depending on factors such as obstacles between devices, magnetic fields around a microwave oven, static electricity, reception sensitivity, antenna's performance, operating system, software application, etc.
2) BLUETOOTH standard profiles indicate the purpose of BLUETOOTH communications between devices.
3) Codec: Audio signal compression and conversion format
4) Subband Codec
5) Advanced Audio Coding

Wireless noise canceling stereo headset

- Power source: DC 3.6 V: Built-in lithium-ion rechargeable battery DC 5 V: When charged using USB
Mass: Approx. 300 g (10.59 oz)
Operating temperature: 0 °C to 40 °C (32 °F to 104 °F)
Usage hours: When connecting via the BLUETOOTH device
Music playback time: Max. 20 hours (NC ON), Max. 20 hours (NC OFF)
Communication time: Max. 18 hours (NC ON), Max. 18 hours (NC OFF)
Standby time: Max. 20 hours (NC ON), Max. 100 hours (NC OFF)
When connecting via the headphone cable
Max. 20 hours (NC ON)
Note: Usage hours may be shorter depending on the Codec and the conditions of use.
Charging time: Approx. 6 hours
This unit can be used for ## hours after 1 hour charging.
Note: Charging hours may be different depending on the conditions of use.
Charging temperature: 5 °C to 35 °C (41 °F to 95 °F)

Receiver

- Type: Closed, Dynamic
Driver units: 40 mm
Frequency response: 5 Hz - 40,000 Hz (when using the headphone cable with NC ON)
Maximum input: 100 mW (when using the headphone cable)
Impedance: NC ON: ## Ω (1 kHz) (when using the headphone cable) NC OFF: ## Ω (1 kHz) (when using the headphone cable)
Sensitivity: NC ON: ## dB/mW (when using the headphone cable) NC OFF: ## dB/mW (when using the headphone cable)

Microphone

- Type: Electret condenser
Directivity: Omni directional
Effective frequency range: 100 Hz - 4,000 Hz

System requirements for battery charge using USB

Personal Computer with pre-installed with any of the following operating systems and USB port:

- Operating Systems (when using Windows) Windows® 10 Home / Windows® 10 Pro Windows® 8.1 / Windows® 8.1 Pro Windows® 8 / Windows® 8 Pro Windows® 7 Home Basic / Home Premium / Professional / Ultimate Windows Vista® (Service Pack 2 or later) Home Basic / Home Premium / Business / Ultimate (when using Mac) Mac OS X (version 10.3 or later)

Design and specifications are subject to change without notice.

Français

AVERTISSEMENT

Pour éviter tout risque d'électrocution, n'ouvrez pas le coffret. Ne confiez les réparations qu'à un technicien qualifié.

N'installez pas l'appareil dans un espace restreint, comme une bibliothèque ou un meuble encastré.

N'exposez pas les piles (piles rechargeables ou installées) à une chaleur excessive comme à la lumière du soleil, au feu ou à d'autres sources de chaleur pendant une période prolongée.

Information

Le présent appareil est conforme aux CNR d'Industrie Canada applicables aux appareils radio exempts de licence. L'exploitation est autorisée aux deux conditions suivantes: (1) l'appareil ne doit pas produire de brouillage, et (2) l'utilisateur de l'appareil doit accepter tout brouillage radioélectrique subi, même si le brouillage est susceptible d'en compromettre le fonctionnement.

Cet équipement est conforme aux limites d'exposition aux rayonnements énoncées pour un environnement non contrôlé et respecte les règles les radioélectriques (RF) de la FCC lignes directrices d'exposition et d'exposition aux fréquences radioélectriques (RF) CNR-102 de l'IC. Cet équipement émet une énergie RF très faible qui est considérée conforme sans évaluation du débit d'absorption spécifique (DAS).

La marque de mot BLUETOOTH et les logos sont la propriété de Bluetooth SIG, Inc. et l'utilisation de ces marques par Sony Corporation est effectuée sous licence.

N Mark est une marque commerciale ou une marque déposée de NFC Forum, Inc. aux États-Unis et dans d'autres pays.

Microsoft, Windows et Windows Vista sont des marques déposées ou des marques de commerce de Microsoft Corporation aux États-Unis et/ou dans les autres pays.

Mac et Mac OS sont des marques commerciales d'Apple Inc., déposées aux États-Unis et dans d'autres pays.

iPhone est une marque commerciale d'Apple Inc., déposée aux États-Unis et dans d'autres pays.

La marque aptX® et le logo aptX sont des marques commerciales de CSR plc ou d'une des sociétés de son groupe, et ils peuvent être déposés dans une ou plusieurs juridictions.

Les autres marques commerciales et noms commerciaux appartiennent à leurs propriétaires respectifs.

Précautions

Communications BLUETOOTH

- La technologie BLUETOOTH sans fil fonctionne dans un rayon d'environ 10 mètres (30 pieds). La portée de communication maximale peut varier en fonction des obstacles (personnes, éléments métalliques, mur, etc.) ou de l'environnement électromagnétique.
• L'illustration ci-dessous indique l'emplacement de l'antenne intégrée sur l'appareil cerclé en pointillés. La sensibilité des communications BLUETOOTH pourra être améliorée en orientant l'antenne intégrée vers le périphérique BLUETOOTH connecté. Lorsque des obstacles se trouvent entre l'antenne du périphérique connecté et l'antenne intégrée de cet appareil, des parasites ou des pertes de niveau audio peuvent se produire, ou les communications peuvent être désactivées.

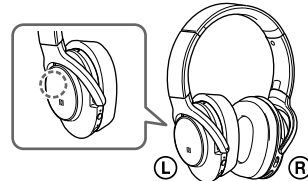

- Les communications BLUETOOTH peuvent être désactivées, ou bien des parasites ou des pertes de niveau audio peuvent se produire dans les conditions suivantes:
- Une personne se trouve entre l'appareil et le périphérique BLUETOOTH. Ce problème peut être résolu en plaçant le périphérique BLUETOOTH face à l'antenne de l'appareil.
- Un obstacle, par exemple un objet métallique ou un mur, se trouve entre

l'appareil et le périphérique BLUETOOTH.
- Un appareil utilisant une fréquence de 2,4 GHz, par exemple un périphérique Wi-Fi, un téléphone sans fil ou un four à micro-ondes, est utilisé à proximité de cet appareil.

- Comme les appareils BLUETOOTH et Wi-Fi (IEEE802.11b/g/n) utilisent la même fréquence (2,4 GHz), des interférences d'hyperfréquences peuvent se produire et entraîner des parasites, des pertes de niveau audio ou la désactivation des communications si cet appareil est utilisé près d'un périphérique Wi-Fi. En pareil cas, prenez les mesures suivantes.
- Utilisez cet appareil à au moins 10 mètres (30 pieds) du périphérique Wi-Fi.
- Si cet appareil est utilisé dans un rayon de 10 mètres (30 pieds) par rapport au périphérique Wi-Fi, mettez ce dernier hors tension.
- Installez cet appareil et le périphérique BLUETOOTH aussi près que possible l'un de l'autre.
• Les émissions d'hyperfréquences d'un périphérique BLUETOOTH peuvent perturber le fonctionnement des appareils médicaux électroniques. Mettez hors tension cet appareil et les autres périphériques BLUETOOTH situés dans les endroits suivants afin d'éviter tout accident:
- en présence de gaz inflammable, dans un hôpital ou une station essence
- à proximité de portes automatiques ou d'alarmes incendie

N'utilisez pas l'appareil dans un avion. Les ondes radio risquent de perturber les instruments, provoquant un accident en raison d'un dysfonctionnement.
• Cet appareil prend en charge les caractéristiques de sécurité conformes à la norme BLUETOOTH pour offrir une connexion sécurisée lors de l'utilisation de la technologie sans fil BLUETOOTH. Cependant, la sécurité peut être insuffisante selon le réglage. Soyez prudent lorsque vous communiquez au moyen de la technologie sans fil BLUETOOTH.

- Nous ne pouvons être tenu responsable de la fuite d'informations lors de communications BLUETOOTH.
• La connexion ne peut pas être garantie avec tous les périphériques BLUETOOTH.
- Un périphérique doté de la fonction BLUETOOTH est nécessaire pour la conformité à la norme BLUETOOTH spécifiée par Bluetooth SIG, Inc. et pour l'authentification.
- Même si le périphérique raccordé est conforme à la norme BLUETOOTH précédemment mentionnée, certains périphériques peuvent ne pas se connecter ou ne pas fonctionner correctement, selon leurs caractéristiques ou spécifications.
- Lors de communications téléphoniques mains libres, des parasites peuvent se produire, selon le périphérique ou l'environnement de communication.

• Selon le périphérique à connecter, le délai avant le début des communications peut être plus ou moins long.

- Chargement de l'appareil
• Cet appareil ne peut être chargé que par USB. Un ordinateur personnel avec port USB ou adaptateur CA de charge USB AC-UD10 (vendu séparément) est requis pour la charge.
• Lors du chargement, cet appareil ne peut pas être mis sous tension et les fonctions BLUETOOTH et de réduction des bruits ne peuvent pas être utilisées.
• Vous pouvez utiliser l'appareil en branchant le câble de casque d'écoute fourni, même pendant le chargement de l'appareil.
• Si vous n'utilisez pas l'appareil pendant une période de temps prolongée, la batterie rechargeable risque de ne pas garder une charge suffisante. La batterie pourra garder une charge correcte après l'avoir déchargée et chargée à maintes reprises.
• Si vous rangez l'appareil pendant une période de temps prolongée, chargez la batterie deux fois par an pour éviter la décharge totale.
• Si la durée d'utilisation de l'appareil devient très courte, vous devez remplacer la batterie rechargeable par une nouvelle. Veuillez contacter votre revendeur Sony le plus proche afin de remplacer la batterie.

Remarque sur l'électricité statique

- L'électricité statique qui s'accumule dans le corps peut causer de légers picotements dans les oreilles. Pour réduire cet effet, portez des vêtements fabriqués en matières naturelles.

Si l'appareil ne fonctionne pas

