

Wireless Stereo Headset

Reference Guide	US
Guide de référence	FR
Guía de referencia	ES

Casque stéréo sans fil

Auriculares estéreo inalámbricos



MDR-AS600BT

©2015 Sony Corporation Printed in China

http://www.sony.net/

English

WARNING

To reduce the risk of electrical shock, do not open the cabinet. Refer servicing to qualified personnel only.

Do not install the appliance in a confined space, such as a bookcase or built-in cabinet.

Do not expose the batteries (battery pack or batteries installed) to excessive heat such as sunshine, fire or the like for a long time.

Information

FOR UNITED STATES CUSTOMERS. NOT APPLICABLE IN CANADA, INCLUDING IN THE PROVINCE OF QUEBEC. POUR LES CONSOMMATEURS AUX ÉTATS-UNIS. NON APPLICABLE AU CANADA, Y COMPRIS LA PROVINCE DE QUÉBEC.

This device complies with Part 15 of the FCC Rules. Operation is subject to the following two conditions: (1) this device may not cause harmful interference, and (2) this device must accept any interference received, including interference that may cause undesired operation.

You are cautioned that any changes or modifications not expressly approved in this manual could void your authority to operate this equipment.

This equipment must not be co-located or operated in conjunction with any other antenna or transmitter.

Note

This equipment has been tested and found to comply with the limits for a Class B digital device, pursuant to Part 15 of the FCC Rules. These limits are designed to provide reasonable protection against harmful interference in a residential installation. This equipment generates, uses and can radiate radio frequency energy and, if not installed and used in accordance with the instructions, may cause harmful interference to radio communications. However, there is no guarantee that interference will not occur in a particular installation. If this equipment does cause harmful interference to radio or television reception, which can be determined by turning the equipment off and on, the user is encouraged to try to correct the interference by one or more of the following measures:

- Reorient or relocate the receiving antenna.
- Increase the separation between the equipment and receiver.
- Connect the equipment into an outlet on a circuit different from that to which the receiver is connected.
- Consult the dealer or an experienced radio/TV technician for help.

This device complies with Industry Canada licence-exempt RSS standard(s). Operation is subject to the following two conditions: (1) this device may not cause interference, and (2) this device must accept any interference, including interference that may cause undesired operation of the device.

This equipment complies with FCC/IC radiation exposure limits set forth for an uncontrolled environment and meets the FCC radio frequency (RF) Exposure Guidelines and RSS-102 of the IC radio frequency (RF) Exposure rules. This equipment has very low levels of RF energy that are deemed to comply without testing of specific absorption rate (SAR).

The BLUETOOTH word mark and logos are owned by the Bluetooth SIG, Inc. and any use of such marks by Sony Corporation is under license.

The N Mark is a trademark or registered trademark of NFC Forum, Inc. in the United States and in other countries.

Microsoft, Windows and Windows Vista are registered trademarks or trademarks of Microsoft Corporation in the United States and/or other countries.

Mac and Mac OS are trademarks of Apple Inc., registered in the U.S. and other countries.

iPhone is a trademark of Apple Inc., registered in the U.S. and other countries.

Other trademarks and trade names are those of their respective owners.

Precautions

On BLUETOOTH communications

- BLUETOOTH wireless technology operates within a range of about 10 m (30 feet). Maximum communication range may vary depending on obstacles (human body, metal, wall, etc.) or electromagnetic environment.
- The antenna is built into the unit as illustrated in the dotted line. The sensitivity of the BLUETOOTH communications will improve by turning the direction of the built-in antenna to

the connected BLUETOOTH device. When obstacles are between the antenna of the connected device and the built-in antenna of this unit, noise or audio dropout may occur, or communications may be disabled.

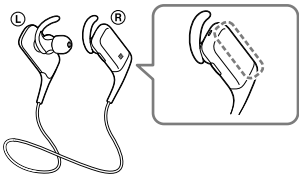

- BLUETOOTH communications may be disabled, or noise or audio dropout may occur under the following conditions.
 - There is a human body between the unit and the BLUETOOTH device. This situation may be improved by placing the BLUETOOTH device facing the antenna of the unit.
 - There is an obstacle, such as metal or wall, between the unit and the BLUETOOTH device.
 - A device using 2.4 GHz frequency, such as a Wi-Fi device, cordless telephone, or microwave oven, is in use near this unit.
- Because BLUETOOTH devices and Wi-Fi (IEEE802.11b/g/n) use the same frequency (2.4 GHz), microwave interference may occur resulting in noise or audio dropout or communications being disabled if this unit is used near a Wi-Fi device. In such a case, perform the following.
 - Use this unit at least 10 m (30 feet) away from the Wi-Fi device.
 - If this unit is used within 10 m (30 feet) of a Wi-Fi device, turn off the Wi-Fi device.
 - Install this unit and the BLUETOOTH device as near to each other as possible.
- Microwaves emitting from a BLUETOOTH device may affect the operation of electronic medical devices. Turn off this unit and other BLUETOOTH devices in the following locations, as it may cause an accident:
 - where inflammable gas is present, in a hospital, or a petrol station
 - near automatic doors or a fire alarm
- Do not use the unit on an airplane. Radio waves may affect instruments, causing an accident due to malfunction.
- This unit supports security capabilities that comply with the BLUETOOTH standard to provide a secure connection when the BLUETOOTH wireless technology is used, but security may not be enough depending on the setting. Be careful when communicating using BLUETOOTH wireless technology.
- We do not take any responsibility for the leakage of information during BLUETOOTH communications.
- Connection with all BLUETOOTH devices cannot be guaranteed.
 - A device featuring BLUETOOTH function is required to conform to the BLUETOOTH standard specified by Bluetooth SIG, Inc. and be authenticated.
 - Even if the connected device conforms to the above mentioned BLUETOOTH standard, some devices may not be connected or work correctly, depending on the features or specifications of the device.
 - While talking on the phone hands free, noise may occur, depending on the device or communication environment.
- Depending on the device to be connected, it may require some time to start communications.

On charging the unit

- This unit can be charged using USB only. Personal computer with USB port, or USB Charging AC Power Adaptor AC-UD20 (sold separately) is required for charging.
- This unit cannot be turned on, nor can the BLUETOOTH function be used, during charging.
- If you do not use the unit for a long time, the rechargeable battery may not be able to keep sufficient charge. The battery will be able to keep a charge properly after repeatedly discharging and charging several times.
- If you store the unit for a long time, charge the battery once every half year to prevent over-discharge.
- If the length of time you can use the unit became extremely short, the rechargeable battery should be replaced with a new one. Please contact your nearest Sony dealer for a battery replacement.

Note on static electricity

- Static electricity accumulated in the body may cause mild tingling in your ears. To minimize the effect, wear clothes made from natural materials.

If the unit does not operate properly

- Reset the unit. Push the RESET button with a pointed object, such as a pin, until you feel a click. The unit will be reset. Pairing information is not deleted.

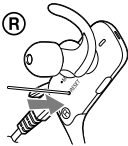

- If the problem persists even after the resetting operation above, initialize the unit as follows. Push the RESET button with a pointed object, such as a pin, for more than 15 seconds. The indicator (blue) flashes 4 times, and the unit is reset to the factory settings. All pairing information is deleted.
- After the unit is initialized, it may not connect to your iPhone or computer. In this case, delete the pairing information of the unit from the iPhone or computer, and then pair them again.

Water resistance performance

The water resistance specifications¹⁾ of this unit are equivalent to IPX4²⁾ in IEC 60529 "Degrees of protection against ingress of water (IP Code)", which specifies the degree of protection provided against the entry of water. However, the unit cannot be used in water. Unless the unit is used correctly, water may get into the unit and cause fire, electrocution, or malfunctions. Note the following cautions carefully and use the unit correctly.

Liquids that the water resistance performance specifications apply to

Applicable: Fresh water, tap water, perspiration
Not applicable: Liquids other than those above (examples: soapy water, detergent water, water with bath agents, shampoo, hot spring water, pool water, seawater, etc.)

- Make sure that the micro-USB port cover is closed securely when you use the unit.
- IPX4 (degree of protection against splashing water): Protected against water splashing from any direction.

Water resistance performance of the unit is based on Sony measurements under the conditions described above. Note that malfunctions as a result of water immersion caused by misuse by the customer are not covered by the warranty.

To maintain water resistance performance

Note the following cautions carefully and use the unit correctly.

- Do not drop the unit or expose it to mechanical shock. Doing so may deform or damage the unit, resulting in deterioration of water resistance performance.
- Do not put the unit in water or use it in a humid place such as a bathroom.
- The micro-USB port cover is important for maintaining water resistance performance. Make sure the micro-USB port cover is closed securely when you use the unit. If the cover has any foreign objects on it or is not completely closed, water resistance performance cannot be maintained. In addition, water may get into the unit and cause malfunctions.
- Do not splash water forcibly against the cylindrical part from which sound is emitted. Doing so may deteriorate the water resistance performance of the unit.
- Wipe off with a soft dry cloth any water that gets on the unit. If water remains in the earbud holes, the sound may seem low or not be audible at all. In this case, remove the earbuds, face the sound conduit downward, and shake the sound conduit a couple of times.

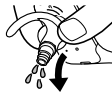

- Do not leave the unit with water on it in cold places as the water may freeze. In order to avoid malfunctions, make sure that you wipe off water after use.

Others

- Do not place this unit in a place exposed to humidity, dust, soot or steam, subject to direct sunlight, or in a car waiting at a traffic signal. It may cause a malfunction.
- Using the BLUETOOTH device may not function on mobile phones, depending on radio wave conditions and location where the equipment is being used.
- If you experience discomfort after using the BLUETOOTH device, stop using the BLUETOOTH device immediately. Should any problem persist, consult your nearest Sony dealer.
- Listening with this unit at high volume may affect your hearing. For traffic safety, do not use this unit while driving or cycling.
- Do not put weight or pressure on this unit as it may cause the unit to deform during long storage.
- Do not subject the unit to excessive shock.
- Clean the unit with a soft dry cloth.
- Do not use the unit with the cord wound around your neck. Doing so may lead to suffocation.
- Do not sleep while wearing the unit. The cord could wind around your neck and cause suffocation while you sleep.
- If you have any questions or problems concerning this unit that are not covered in this manual, please consult your nearest Sony dealer.

Optional replacement earbuds and arc supporters can be ordered from your nearest Sony dealer.

Specifications

General

Communication system: BLUETOOTH Specification version 3.0

Output: BLUETOOTH Specification Power Class 2

Maximum communication range: Line of sight approx. 10 m (30 ft)¹⁾

Frequency band: 2.4 GHz band (2.400 GHz - 2.4835 GHz)

Modulation method: FHSS

Compatible BLUETOOTH profiles²⁾:

- A2DP (Advanced Audio Distribution Profile)
- AVRCP (Audio Video Remote Control Profile)
- HFP (Hands-free Profile)
- HSP (Headset Profile)

Supported Code³⁾: SBC⁴⁾, AAC⁵⁾

Supported content protection method: SCMS-T

Transmission range (A2DP): 20 Hz - 20,000 Hz (Sampling frequency 44.1 kHz)

Included items:

- Wireless stereo headset (1)
 - Micro-USB cable (approx. 50 cm (19 3/4 in.)) (1)
 - Long Hybrid silicone rubber earbuds (S/S/M/L 2 each)
 - Arc supporters (S/M/L 2 each)
 - Reference Guide (this sheet) (1)
 - Quick Start Guide (1)
 - Other documents (1 set)
- Recommended accessory:**
- USB Charging AC Power Adaptor: AC-UD20 (sold separately)
 - Spare earbuds: EP-EX10A (sold separately)

¹⁾ The actual range will vary depending on factors such as obstacles between devices, magnetic fields around a microwave oven, static electricity, reception sensitivity, antenna's performance, operating system, software application, etc.

²⁾ BLUETOOTH standard profiles indicate the purpose of BLUETOOTH communications between devices.

³⁾ Codec: Audio signal compression and conversion format

⁴⁾ Subband Codec

⁵⁾ Advanced Audio Coding

Wireless stereo headset

Power source:

DC 3.7 V: Built-in lithium-ion rechargeable battery
DC 5 V: When charged using USB

Mass: Approx. 21 g (0.74 oz) (not including the arc supporters)

Operating temperature: 0 °C to 40 °C (32 °F to 104 °F)

Rated power consumption: 0.6 W

Usage hours:

When connecting via the BLUETOOTH device
Music playback time: Max. 8.5 hours
Communication time: Max. 8 hours
Standby time: Max. 250 hours

Note: Usage hours may be shorter depending on the Codec and the conditions of use.

Charging time:

Approx. 2.5 hours

Note: Charging hours may be different depending on the conditions of use.

Charging temperature: 5 °C to 35 °C (41 °F to 95 °F)

Receiver

Type: Closed, Dynamic

Driver units: 9 mm

Frequency response: 20 Hz - 20,000 Hz

Microphone

Type: Electret condenser

Directivity: Omni directional

Effective frequency range: 100 Hz - 4,000 Hz

System requirements for battery charge using USB

Personal Computer with pre-installed with any of the following operating systems and USB port:

Operating Systems

(when using Windows)

Windows® 8.1 / Windows® 8.1 Pro

Windows® 8 / Windows® 8 Pro

Windows® 7

Home Basic / Home Premium / Professional / Ultimate

Windows Vista® (Service Pack 2 or later)

Home Basic / Home Premium / Business / Ultimate

(when using Mac)

Mac OS X (version.10.3 or later)

Design and specifications are subject to change without notice.

AVERTISSEMENT

Pour éviter tout risque d'électrocution, n'ouvrez pas le coffret. Ne confiez les réparations qu'à un technicien qualifié.

N'installez pas l'appareil dans un espace restreint, comme une bibliothèque ou un meuble encastré.

N'exposez pas les piles (piles rechargeables ou installées) à une chaleur excessive comme à la lumière du soleil, au feu ou à d'autres sources de chaleur pendant une période prolongée.

Information

Le présent appareil est conforme aux CNR d'Industrie Canada applicable aux appareils radio exempts de licence.

L'exploitation est autorisée aux deux conditions suivantes : (1) l'appareil ne doit pas produire de brouillage, et (2) l'utilisateur de l'appareil doit accepter tout brouillage radioélectrique subi, même si le brouillage est susceptible d'en compromettre le fonctionnement.

Cet équipement est conforme aux limites d'exposition aux rayonnements énoncées pour un environnement non contrôlé et respecte les règles les radioélectriques (RF) de la FCC lignes directrices d'exposition et d'exposition aux fréquences radioélectriques (RF) CNR-102 de l'IC. Cet équipement émet une énergie RF très faible qui est considérée conforme sans évaluation du débit d'absorption spécifique (DAS).

La marque de mot BLUETOOTH et les logos sont la propriété de Bluetooth SIG, Inc. et l'utilisation de ces marques par Sony Corporation est effectuée sous licence.

N Mark est une marque commerciale ou une marque déposée de NFC Forum, Inc. aux États-Unis et dans d'autres pays.

Microsoft, Windows et Windows Vista sont des marques déposées ou des marques de commerce de Microsoft Corporation aux États-Unis et/ou dans les autres pays.

Mac et Mac OS sont des marques commerciales de Apple Inc., déposées aux États-Unis et dans d'autres pays.

iPhone est une marque commerciale de Apple Inc., déposée aux États-Unis et dans d'autres pays.

Les autres marques commerciales et noms commerciaux appartiennent à leurs propriétaires respectifs.

Précautions

Communications BLUETOOTH

- La technologie BLUETOOTH sans fil fonctionne dans un rayon d'environ 10 m (30 pieds). La portée de communication maximale peut varier en fonction des obstacles (personnes, éléments métalliques, mur, etc.) ou de l'environnement électromagnétique.
- L'illustration ci-dessous indique l'emplacement de l'antenne intégrée sur l'appareil. La sensibilité des communications BLUETOOTH pourra être améliorée en orientant l'antenne intégrée vers le périphérique BLUETOOTH connecté. Lorsque des obstacles se trouvent entre l'antenne du périphérique connecté et l'antenne intégrée de cet appareil, des parasites ou des pertes de niveau audio peuvent se produire, ou les communications peuvent être désactivées.

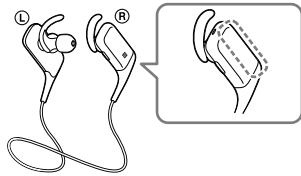

- Les communications BLUETOOTH peuvent être désactivées, ou bien des parasites ou des pertes de niveau audio peuvent se produire dans les conditions suivantes.
 - Une personne se trouve entre l'appareil et le périphérique BLUETOOTH. Ce problème peut être résolu en plaçant le périphérique BLUETOOTH face à l'antenne de l'appareil.
 - Un obstacle, par exemple un objet métallique ou un mur, se trouve entre l'appareil et le périphérique BLUETOOTH.
 - Un appareil utilisant une fréquence de 2,4 GHz, par exemple un périphérique Wi-Fi, un téléphone sans fil ou un four à micro-ondes, est utilisé à proximité de cet appareil.
- Comme les périphériques BLUETOOTH et Wi-Fi (IEEE802.11b/g/n) utilisent la même fréquence (2,4 GHz), des interférences de micro-ondes peuvent se produire et entraîner des parasites, des pertes de niveau audio ou la désactivation des communications si cet appareil est utilisé près d'un périphérique Wi-Fi. En pareil cas, prenez les mesures suivantes.
 - Utilisez cet appareil à au moins 10 m (30 pieds) du périphérique Wi-Fi.
 - Si cet appareil est utilisé dans un rayon de 10 m (30 pieds) par rapport au périphérique Wi-Fi, mettez ce dernier hors tension.
 - Installez cet appareil et le périphérique BLUETOOTH aussi près que possible l'un de l'autre.
- Les émissions hyperfréquences d'un périphérique BLUETOOTH peuvent perturber le fonctionnement des appareils médicaux électroniques. Mettez hors tension cet appareil et les autres périphériques BLUETOOTH situés dans les endroits suivants afin d'éviter tout accident :
 - en présence de gaz inflammable, dans un hôpital ou une station essence
 - à proximité de portes automatiques ou d'alarmes incendie
- N'utilisez pas l'appareil dans un avion. Les ondes radio risquent de perturber les instruments, provoquant un accident en raison d'un dysfonctionnement.
- Cet appareil prend en charge les caractéristiques de sécurité conformes à la norme BLUETOOTH pour offrir une connexion sécurisée lors de l'utilisation de la technologie sans fil BLUETOOTH. Cependant, la sécurité peut être insuffisante selon le réglage. Soyez prudent lorsque vous communiquez au moyen de la technologie sans fil BLUETOOTH.
- Nous ne pouvons être tenus responsables de la fuite d'informations lors de communications BLUETOOTH.
- La connexion ne peut pas être garantie avec tous les périphériques BLUETOOTH.
 - Un périphérique doté de la fonction BLUETOOTH est nécessaire pour la conformité à la norme BLUETOOTH spécifiée par Bluetooth SIG, Inc. et pour l'authentification.
 - Même si le périphérique raccordé est conforme à la norme BLUETOOTH précédemment mentionnée, certains périphériques peuvent ne pas se connecter ou ne pas fonctionner correctement, selon leurs caractéristiques ou spécifications.
- Lors de communications téléphoniques mains libres, des parasites peuvent se produire, selon le périphérique ou l'environnement de communication.
- Selon le périphérique à connecter, le délai avant le début des communications peut être plus ou moins long.

Chargement de l'appareil

- Cet appareil ne peut être chargé que par USB. Ordinateur personnel avec port USB ou adaptateur CA de charge USB AC-UD20 (vendu séparément) requis pour la charge.

- Lors du chargement, cet appareil ne peut pas être mis sous tension et la fonction BLUETOOTH ne peut pas être utilisée.

- Si vous n'utilisez pas l'appareil pendant une période de temps prolongée, la batterie rechargeable risque de ne pas garder une charge suffisante. La batterie pourra garder une charge correcte après l'avoir déchargée et chargée à maintes reprises.

- Si vous rangez l'appareil pendant une période de temps prolongée, chargez la batterie deux fois par an pour éviter la décharge totale.

- Si la durée d'utilisation de l'appareil devient très courte, vous devez remplacer la batterie rechargeable par une nouvelle. Veuillez contacter votre revendeur Sony le plus proche afin de remplacer la batterie.

