

Quick Setup Guide

Preparation

In the Box

- BD Player
- Active Media Controller
- Battery
- Quick Setup Guide
- Reference Guide
- Warranty Card
- HDMI Cable

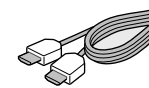

- IR Blaster Cable

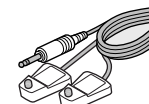

- AC Power Adaptor
- AC Power Cord

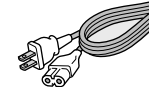

Inserting batteries

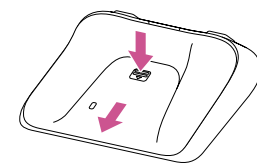

AA-size (R6)

Connection

Before connecting the BD player >>>>>>

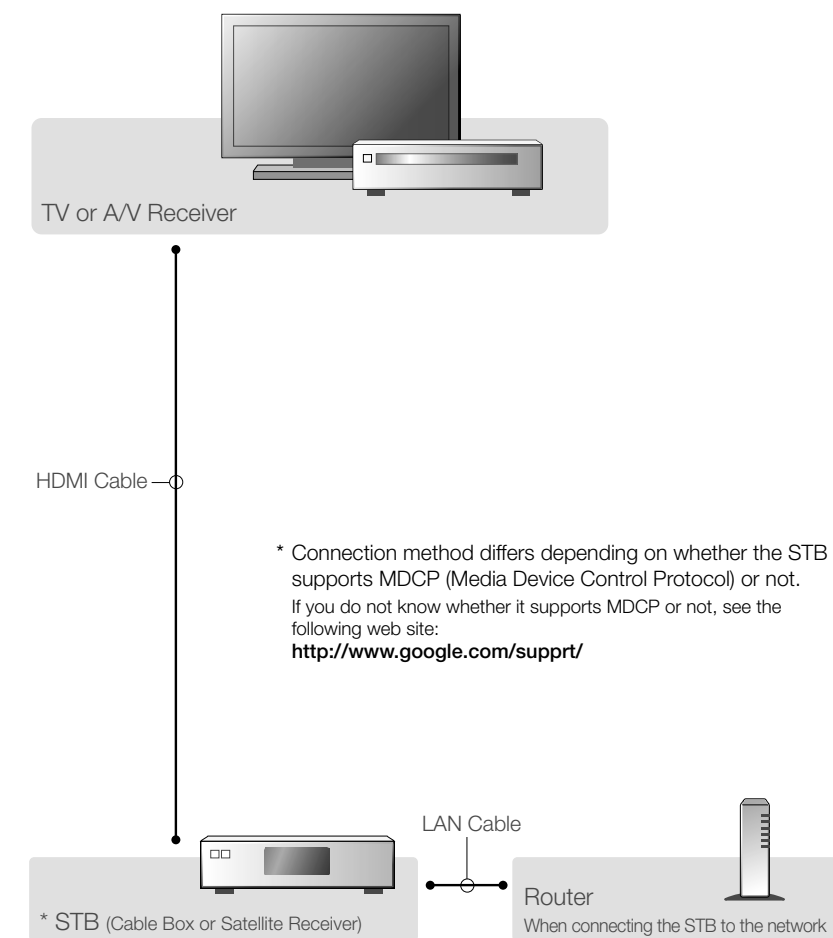

step 1 Connect to the A/V device

Disconnect the STB from the connected A/V device and then connect the BD player between the STB and A/V device. And connect the IR Blaster to the IR BLASTER port, and place the IR Blaster near the remote sensor of the STB.

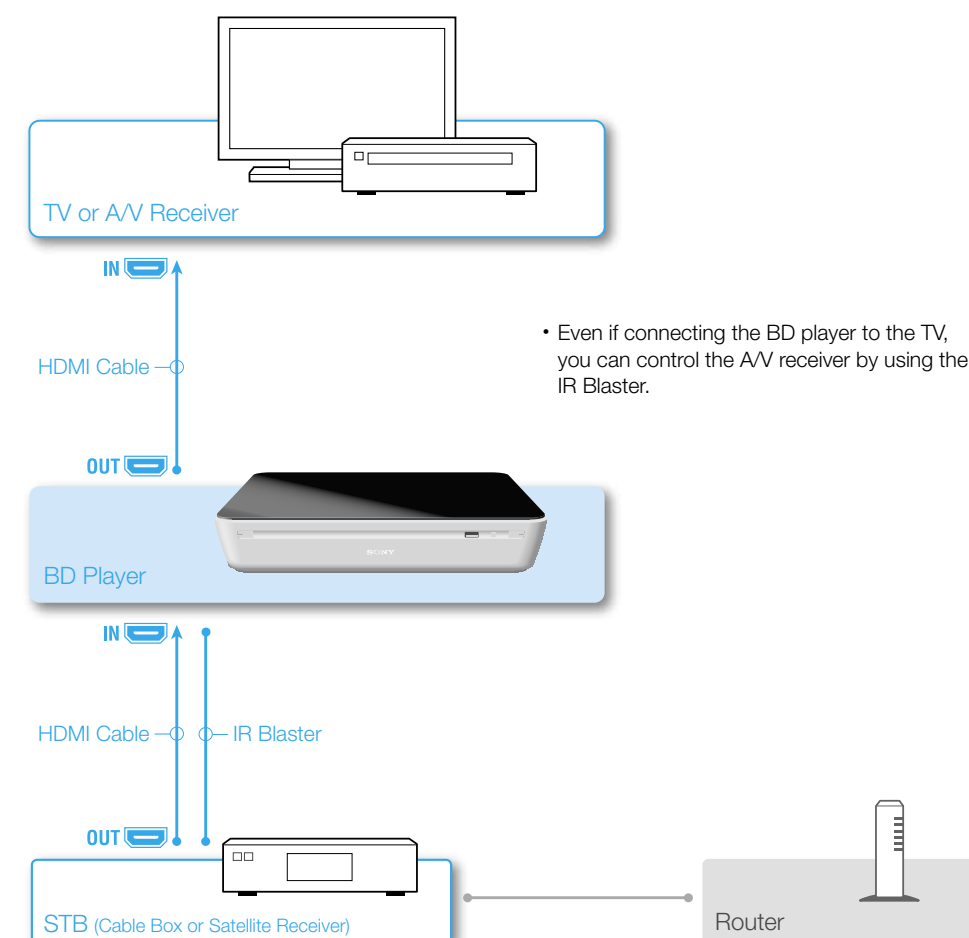
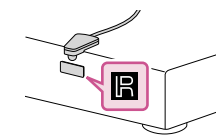

step 2 Connect to a network

Connect the BD player and a router with a LAN cable or Wireless LAN.
 • For details of network connection with the STB, see the operating instructions supplied with the STB.

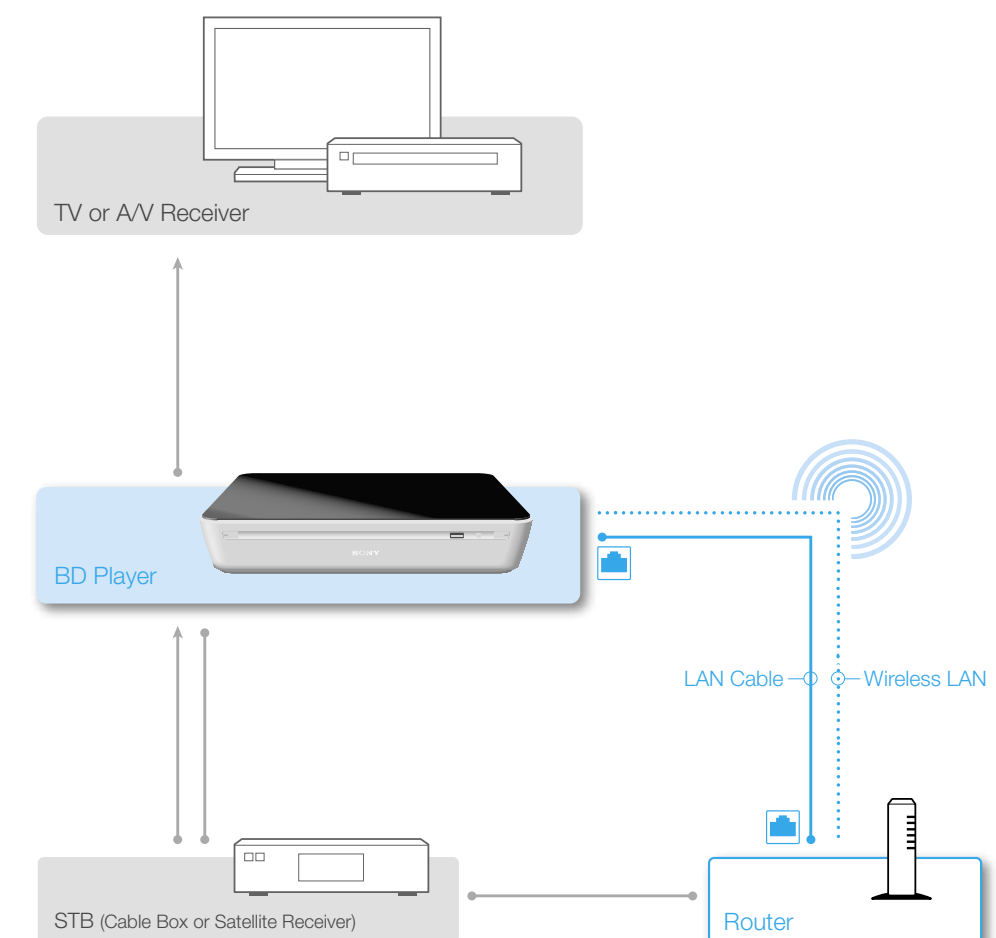

step 3 Connect to the power source

Connect the AC adaptor and the power cord to the BD player and the wall outlet.

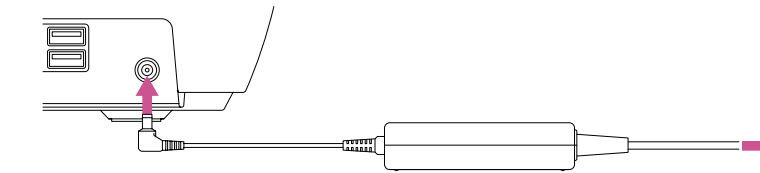

step 4 Change the display on your TV

Switch the input selector on your TV so that the signal from the player appears on your TV screen.

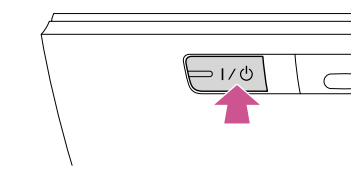

step 5 Press the I/O (on/standby) button

step 6 Set up the BD player

Follow the on-screen instructions of the Initial Setup wizard to set up the BD player.
 • It takes about 10 minutes to complete the Initial Setup.



Active Media Controller

Guide to the Active Media Controller

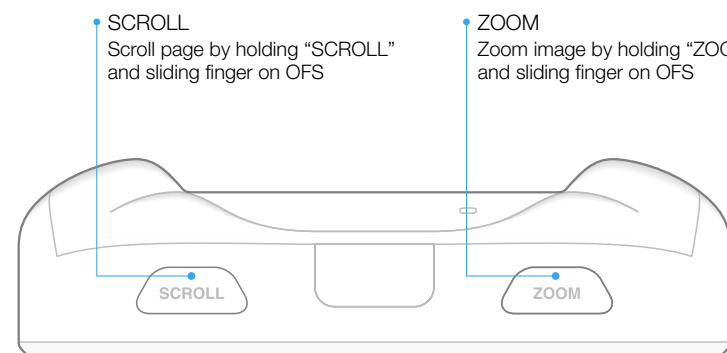

- Multi-task operation (WINDOW key)
Change display to PinP (Picture in Picture).
- Easy access to various contents (HOME key)
Display Home Menu.
Home can be customized.
- Intuitive manipulation (OFS)
Free cursor control sliding your finger on OFS.
- Seamless integration of devices (GUIDE key, TV key, DVR key)
Display any picture or menu.
TV : Displays Live TV
GUIDE : Displays TV Guide
DVR : Displays DVR menu
- Registration of your favorites (Bookmark key)
If you find your favorite contents, press it.
- Cross-media searching (Search key)
Search your interest from various media.

Web Guide

Find out more about BTV and have more fun!

Do you want to find out more about BTV and make the most of it? If that is the case, why don't you look into the Help Center, which gives you helpful information on the web? Whenever you have any trouble or problems about BTV, access the Help Center first.

You can see the following information in the Help Center:

- How to use the BTV
- Support information/FAQ
- Other helpful information

Two ways to get to the Help Center

From BTV

Select "Help Center" from the Applications list.
Or, just type in "help center" into the Nav bar.

From PC or other devices' Web Browser

Access the following URL:
<http://www.esupport.sony.com/btv/helpcenter>

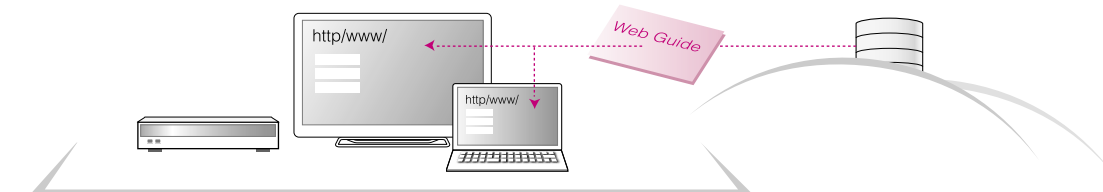

Troubleshooting

Frequently-asked questions (FAQ)

There is no picture (screen is dark).

- Check that the AC power cable is securely connected.
- Check that all the connecting cables are securely connected.
- Switch the input selector on your TV to display the signal from this unit.

The Multi Media Controller does not function (cannot be paired with the unit).

- Operate the Multi Media Controller near the unit.
- Check that batteries are inserted correctly.

The unit cannot connect to the Internet.

- Check if the LAN router is on.
- Check the settings of the LAN router. For details, see the operating instructions supplied with the LAN router.
- Check that the LAN cable is connected correctly when using a wired network connection.
- Confirm the settings by looking into "About Wireless Network Settings" when using a wireless network connection.

To get more information about the BTV.

- Access the Help Center (<http://www.esupport.sony.com/btv/helpcenter>).

You can get more information by accessing to the Web Guide on your PC.
If any problem persists even after applying the suggested solutions, consult your nearest Sony dealer.

About Wireless Network Settings

Additional Information

Parts and controls

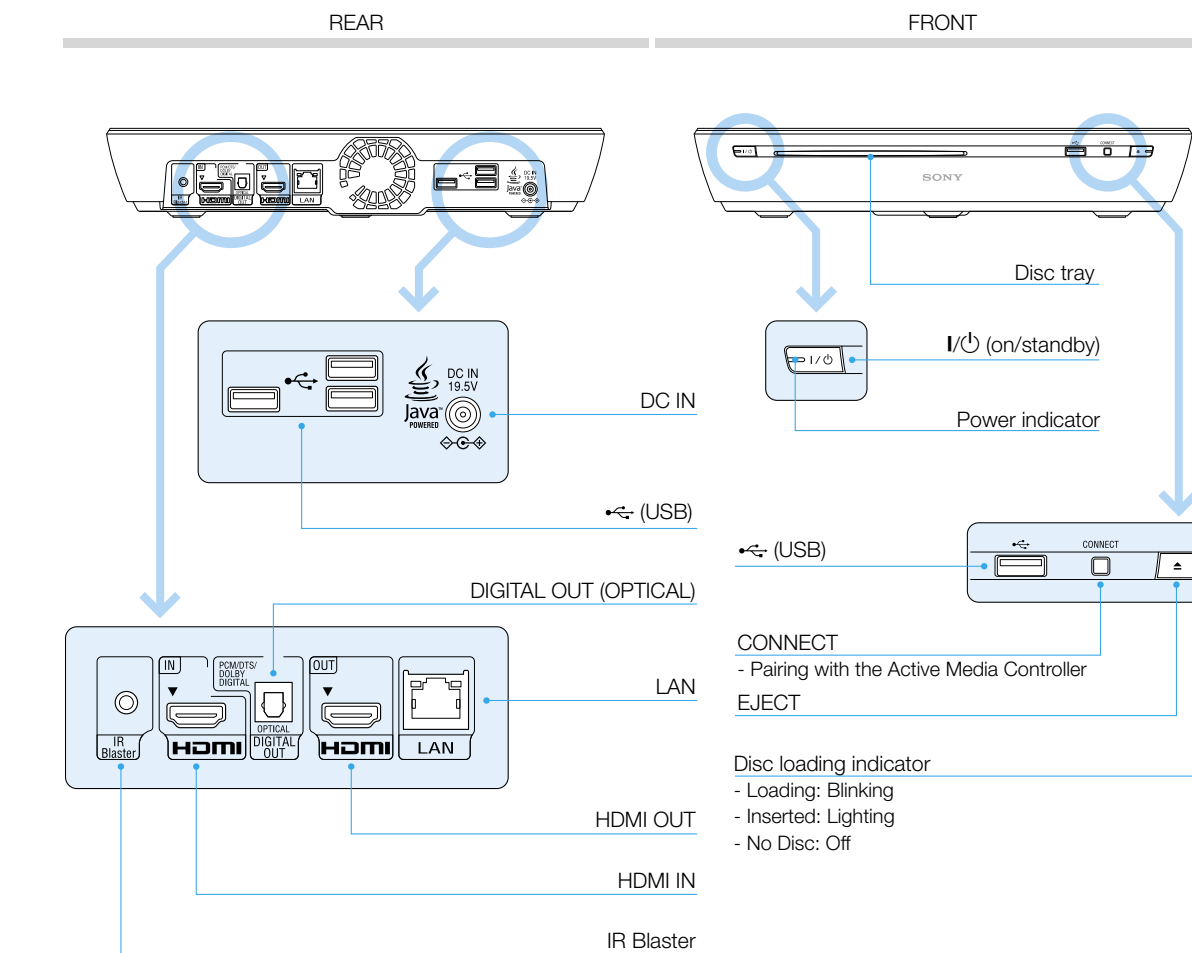

Sony Customer Support

U.S.A. : www.sony.com/tvsupport United States 1.800.222.SONY
Canada: www.sony.ca/support Canada 1.877.899.SONY

Please Do Not Return the Product to the Store