

**SONY**

4-672-272-11 (1)

# Read This First

## Operating Instructions

**1** Checking the package contents

**2** Setting your Sony CLIÉ™ handheld

**3** Basic operations of your Sony CLIÉ™ handheld

**4** Using your CLIÉ™ handheld with your computer

**5** Have a try

corrected

**6** Using applications

Additional information

Sony CLIÉ™ handheld components

Personal Entertainment Organizer

**PEG-TG50**

**CLiÉ™**

© 2003 Sony Corporation

 **Bluetooth**

  
MEMORY STICK

# Before use

## Caution

IN NO EVENT SHALL SONY BE LIABLE FOR ANY INCIDENTAL, INDIRECT OR CONSEQUENTIAL DAMAGES OR OTHER DAMAGES INCLUDING WITHOUT LIMITATION LOSS OF PROFITS, LOSS OF REVENUE, LOSS OF DATA, LOSS OF USE OF THE PRODUCT OR ANY ASSOCIATED EQUIPMENT, DOWNTIME, AND PURCHASER'S TIME RELATED TO OR ARISING OUT OF THE USE OF THIS PRODUCT, ITS HARDWARE AND/OR ITS SOFTWARE.

## On the supplied software

- Copyright laws prohibit reproducing the software or the software manual in whole or in part or renting the software without the permission of the copyright holder.
- In no event will SONY be liable for any financial damage or loss of profits, including claims made by third parties, arising out of the use of the software supplied with this product.
- In the event a problem occurs with this software as a result of defective manufacturing, SONY will replace it at SONY's option or issue a refund. However, SONY bears no other responsibility.
- The software provided with this product cannot be used with equipment other than that which it is designated for use with.
- Please note that, due to continued efforts to improve quality, the software specifications may be changed without notice.
- The software library incorporated in CLIÉ handheld is based in part on the work of the Independent JPEG Group.

## NOTES

- Sony does not support third-party add-on applications. If you are having a problem with a third-party application, please contact the developer or publisher of that software.
- The illustrations in this manual may differ from the actual software.
- Explanations in this manual assume that you are familiar with basic operations of Windows®. For how to use your computer and operating system, please refer to their respective manuals.

corrected

## CAUTION

Please contact your nearest Sony dealer regarding any problems you are experiencing with your Sony product.

## On the trademarks

Before using your CLIÉ handheld, be sure to read the accompanying End-User's License Agreement.

Sony, CLIÉ, "Memory Stick", "Memory Stick Duo", "Memory Stick PRO", "MagicGate Memory Stick", Jog Dial, PictureGear Studio and their logos are trademarks of Sony Corporation.

Palm OS, Graffiti, HotSync and the HotSync logo are registered trademarks of Palm, Inc. and its subsidiaries, and Palm, Palm Powered, Palm Desktop, the Palm logo, the Palm Powered logo and Palm OS5 logo are trademarks of Palm, Inc and its subsidiaries.

Microsoft and Windows are registered trademarks of Microsoft Corporation.

Pentium is registered trademarks of Intel Corporation.

Intellisync is a trademark of Pumatech, Inc.

Adobe and Acrobat are trademarks of Adobe Systems Incorporated.

Bluetooth is a trademark that is owned by the proprietor and used by Sony under license.

QuickTime and the QuickTime logo are trademarks of Apple Computer, Inc.

NetFront is a trademark of ACCESS CO, Ltd.

Picxel and the Picxel logo are trademarks of Picxel Technologies, Ltd.

Contains Macromedia® Flash™ Player technology by Macromedia, Inc., Copyright © 1995-2001 Macromedia, Inc. All rights reserved.

Macromedia, Flash and Macromedia Flash are trademarks or registered trademarks of Macromedia, Inc. in the United States and internationally.

This product includes fonts owned by TypeBank Co., Ltd. under license.

All other trademarks are trademarks of their respective owners.

Program © 2002 Sony Corporation, © 2002 Palm, Inc., or its subsidiaries. All rights reserved.

Documentation © 2002 Sony Corporation

## WARNING

- In some situations or environments, the use of the Bluetooth™ technology might be restricted by the proprietor of the building or responsible representatives of the organization, for example on board of airplanes, in hospitals or in any other environment where the risk of interference with other devices or services is perceived or identified as harmful.
  - If you are uncertain about the policy applying to the use of Bluetooth™ technology in a specific organization or environment, you are encouraged to first ask for authorization prior to switching it on.
  - Consult your physician or the manufacturer of personal medical devices (pacemakers, hearing aids, etc.) regarding any restrictions on the use of Bluetooth™ technology.
  - **The Bluetooth™ function equipped with CLIE handheld is valid only in those countries where CLIE handheld is sold.**
- added** • Turn off your CLIE handheld to quit using the Bluetooth™ function.

## Safety and Regulations

### WARNING

**To prevent fire or shock hazard, do not expose the unit to rain or moisture. To avoid electrical shock, do not open the cabinet. Refer servicing to qualified personnel only.**

**For customers in Australia, Hong Kong, Malaysia, Mexico, New Zealand, Singapore, Taiwan and Thailand**

The socket-outlet shall be installed near the equipment and shall be easily accessible.

### CAUTION

You are cautioned that any changes or modifications not expressly approved in this manual could void your warranty on this equipment.

### WARNING

Battery may explode if mistreated. Do not recharge, disassemble, or dispose of in fire.

**For customers in the U.S.A. and Canada**

**corrected**

### Owner's Record

The model number and serial number are located on the back of the product. Record the model number and the serial number in the space provided below. Refer to them whenever you call upon your Sony dealer regarding this product.

Model No. \_\_\_\_\_  
Serial No. \_\_\_\_\_

The socket-outlet shall be installed near the equipment and shall be easily accessible.

### CAUTION

You are cautioned that any changes or modifications not expressly approved in this manual could void your warranty on this equipment.

This Class B digital apparatus complies with Canadian ICES-003.

Cet appareil numérique de la classe B est conforme à la norme NMB-003 du Canada.

### NOTE

This equipment has been tested and found to comply with the limits for a Class B digital device, pursuant to Part 15 of the FCC Rules. These limits are designed to provide reasonable protection against harmful interference in a residential installation. This equipment generates, uses, and can radiate radio frequency energy and, if not installed and used in accordance with the instructions, may cause harmful interference to radio communications. However, there is no guarantee that interference will not occur in a particular installation. If this equipment does cause harmful interference to radio or television reception, which can be determined by rotating the equipment off and on, the user is encouraged to try to correct the interference using one or more of the following measures:

**Continued on next page**

\*\*\*\*\*

- Reorient or relocate the receiving antenna.
- Increase the separation between the equipment and receiver.
- Connect the equipment into an outlet on a circuit different from that to which the receiver is connected.
- Consult the dealer or an experienced radio/TV technician for help.

If you have a question about this product, call the Sony Customer Information Center at keep on next line 1-877-760-7669; or write to the Sony Customer Information Center at 12451 Gateway Boulevard, Fort Myers, FL 33913. The number below is for FCC-related matters only.

#### **Declaration of Conformity**

Trade Name: SONY

Model No.: PEG-TG50/U

Responsible Party: Sony Electronics Inc.

Address: 680 Kinderkamack Road, Oradell, NJ 07649 USA

Telephone No.: 201-930-6972

This device complies with part 15 of the FCC Rules.

Operation is subject to the following two conditions:

- (1) This device may not cause harmful interference, and
- (2) This device must accept any interference received, including interference that may cause undesired operation.

The supplied interface cable must be used with the equipment in order to comply with the limits for a digital device pursuant to Subpart B of Part 15 of FCC Rules.

#### **RECYCLING LITHIUM-ION BATTERIES**

Lithium-Ion batteries are recyclable.

You can help preserve our environment by returning your used rechargeable batteries to the collection and recycling location nearest you.

For more information regarding recycling of rechargeable batteries, call toll free 1-800-822-8837, or visit

<http://www.rbrc.org/>



Caution: Do not handle damaged or leaking lithium-ion batteries.

correcte

### **Radio-Frequency Exposure Statement**

This equipment generates and radiates radio-frequency energy. In order to comply with FCC radio-frequency radiation exposure guidelines for an uncontrolled environment, this equipment has to be installed and operated while maintaining a minimum body to antenna distance of 2.5 cm. Based on continuous exposure of 30 minutes.

Users are not permitted to make changes or modify the system in any way.

The term "IC:" before the radio certification number only signifies that Industry Canada technical specifications were met.

Le terme «IC» avant le numéro d'homologation ne signifie seulement que les normes d'Industrie Canada ont été respectées.

deleted

Operation is subject to the following two conditions: (1) this device may not cause interference, and (2) this device must accept any interference, including interference that may cause undesired operation of the device.

L'utilisation de ce dispositif est autorisée seulement aux conditions suivantes: (1) il ne doit pas produire de brouillage et (2) l'utilisateur du dispositif doit être prêt à accepter tout brouillage radioélectrique reçu, même si ce brouillage est susceptible de compromettre le fonctionnement du dispositif.

To prevent radio interference to the licensed service, this device is intended to be operated indoors and away from windows to provide maximum shielding. Equipment (or its transmit antenna) that is installed outdoors is subject to licensing.

Pour empêcher que cet appareil cause du brouillage au service faisant l'objet d'une licence, il doit être utilisé à l'intérieur et devrait être placé loin des fenêtres afin de fournir un écran de blindage maximal. Si le matériel (ou son antenne d'émission) est installé à l'extérieur, il doit faire l'objet d'une licence.

This device and its antenna(s) must not be co-located or operating in conjunction with any other antenna or transmitter. Users are not permitted to modify this transmitter device.

Any unauthorized modification made on this device could avoid the user's authority to operate the device.

added

The installer of this radio equipment must ensure that the antenna is located or pointed such that it does not emit RF field in excess of Health Canada limits for the general population; consult Safety Code 6, obtainable from Health Canada's website: [www.hc-sc.gc.ca/rpb](http://www.hc-sc.gc.ca/rpb)

L'installateur du présent matériel radio doit s'assurer que l'antenna est située ou pointée de manière à ce que cette dernière n'émette pas de champs radioélectriques supérieurs aux limites spécifiées par Santé Canada pour le grand public; consulter le Code de sécurité 6, disponible sur le site Web de Santé Canada, à l'adresse suivante: [www.hc-sc.gc.ca/rpb](http://www.hc-sc.gc.ca/rpb) added

## Recycling Lithium-Ion batteries

The following information for batteries recycle is ONLY intended for customers in the U.S.A. and Canada.

Lithium-Ion batteries are recyclable.

You can help preserve our environment by returning your used rechargeable batteries to the collection and recycling location nearest you.

For more information regarding recycling of rechargeable batteries, call toll free 1-800-822-8837, or visit the website (<http://www.rbrcc.org/>).

When you dispose of a CLIÉ handheld, remove the battery for recycling.

## How to remove a rechargeable button battery

- 1** Remove the screw from the side of the CLIÉ handheld with a Phillips screwdriver.
- 2** Remove the battery cover.

will be changed in next draft

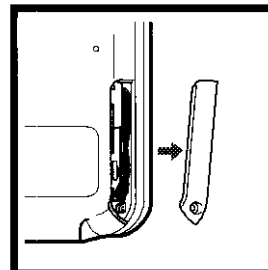
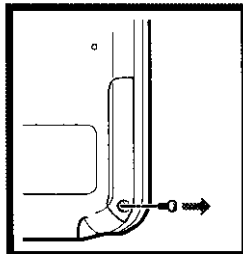

- 3** Remove the jack of the battery cord from your CLIÉ handheld.

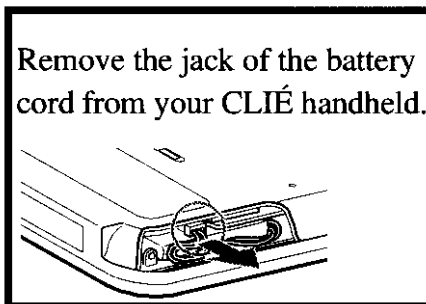

- 4** Pull the ribbon attached to the battery.

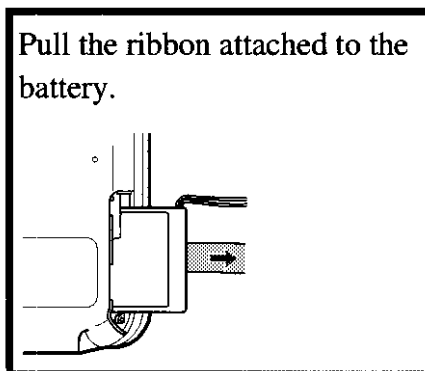

switched

# Table of Contents

<b>Checking the package contents</b> . . . . .	11	<b>Viewing computer documents on your CLIÉ handheld (Picxel Viewer for CLIE)</b> . . . . .	43
<b>Setting your Sony CLIÉ™ handheld</b> . . . . .	18	<b>Recording a voice memo (Voice Recorder)</b> . . . . .	45
<b>Charging your CLIÉ handheld</b> . . . . .	13	<b>Playing back handwriting memos, voice memos or image files</b> . . . . .	47
<b>Performing the initial settings after turning on</b> . . . . .	16	<b>Take image files or movie files created with other devices with your CLIÉ handheld</b> . . . . .	49
<b>Basic operations of your Sony CLIÉ™ handheld</b> . . . . .	21	<b>Take music with you</b> . . . . .	51
<b>Start an application</b> . . . . .	21	<b>Using the Bluetooth™ function</b> . . . . .	53
<b>Entering data</b> . . . . .	25	<b>Connecting to the Internet</b> . . . . .	59
<b>Restarting your Sony CLIÉ handheld</b> . . . . .	26	<b>Using applications</b> . . . . .	60
<b>Using your CLIÉ™ handheld with your computer</b> . . . . .	29	<b>Using CLIÉ Application Manual</b> . . . . .	60
<b>Install the software on your computer</b> . . . . .	29	<b>Installing applications you want on your CLIÉ handheld</b> . . . . .	62
<b>Connect the cradle to your computer</b> . . . . .	32	<b>Introducing add-on applications</b> . . . . .	64
<b>Enter a user name for your CLIÉ handheld</b> . . . . .	33	<b>Additional information</b> . . . . .	78
<b>Synchronizing data between your CLIÉ handheld and computer (HotSync®)</b> . . . . .	35	<b>Preventing problems</b> . . . . .	78
<b>Have a try</b> . . . . .	37	<b>Solving problems</b> . . . . .	79
<b>Managing schedules (Date Book)</b> . . . . .	37	<b>Customer Support and Customer Registration</b> . . . . .	80
<b>Managing addresses and telephone numbers (Address)</b> . . . . .	40	<b>Notes on use</b> . . . . .	81
<b>Exchanging Date Book and Address data between your CLIÉ handheld and computer</b> . . . . .	42	<b>Specifications</b> . . . . .	84

Continued on next page

\*\*\*\*\*

<b>Sony CLIE™ handheld components . . . . .</b>	<b>88</b>
<b>Front panel . . . . .</b>	<b>88</b>
<b>Side panel . . . . .</b>	<b>90</b>
<b>Back panel . . . . .</b>	<b>92</b>
<b>Upper panel . . . . .</b>	<b>92</b>

<b>Inserting/removing “Memory Stick” media . . . . .</b>	<b>93</b>
<b>Locating cradle components . . . . .</b>	<b>100</b>

<b>Index . . . . .</b>	<b>101</b>
------------------------	------------

---

## Notes on this manual

- Screen pictures in this manual may be different from the actual displays in the supplied software.
- Contents of this manual are written for users with knowledge of using Windows. For details about computer operation, refer to the manual for the computer.

## About display (LCD)

The LCD of your CLIE handheld is designed with precision technology. However, some pixels may not work or may be permanently lit in some cases. Also, brightness of the display may be inconsistent depending on the angle of view. These are caused by the nature of the LCD and do not indicate a malfunction.

Please note that Sony does not guarantee for replacement or return in cases like those. Do not keep the LCD directed toward the sun for long time. It may cause a malfunction. Please be careful when you locate it outdoors or next to a window.

## No guarantee for lost data or damaged data

Sony does not provide any guarantee for lost data or damaged data caused by improper operations.

## Copyrights

Television programs, films, video tapes, and other materials may be copyrighted. Unauthorized recording of such materials may be contrary to the provision of the copyright laws.



# Checking the package contents

Please check the accessories in the package before you start.

## CLiÉ handheld (1)

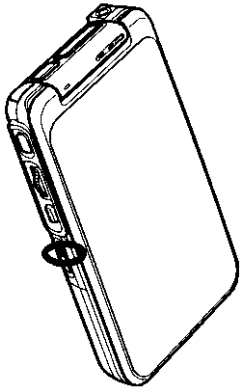

will be changed in next draft

For details on the protective cover, refer to page 99.

## AC power adapter (1: including AC cord)

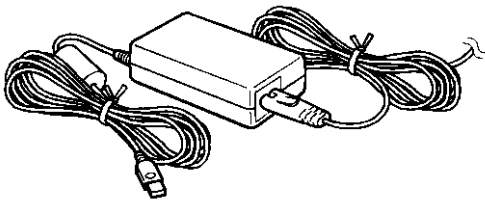

## Cradle (1)

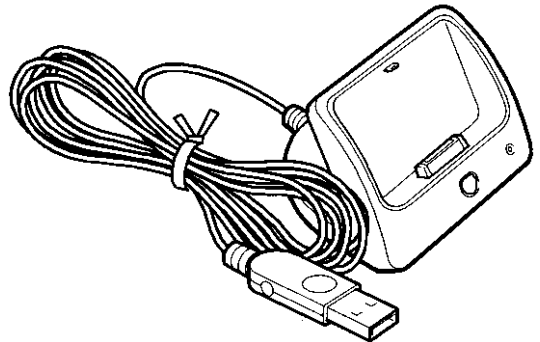

## Stylus (1)



The stylus is stored in your CLiÉ handheld at the factory.

## Installation CD-ROM

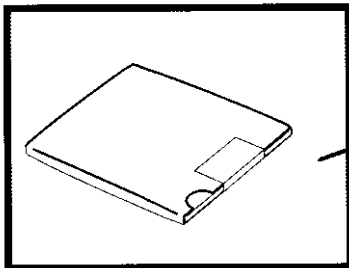

deleted

corrected

## Plug adapter (1)

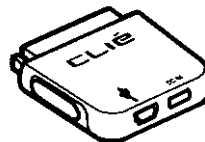

Continued on next page

## Plug adapter attachment (1)

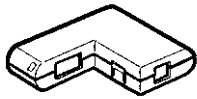

**Read This First - Operating Instructions (1, this manual)**

**Troubleshooting Q&A (1)**

**Customer Registration Guide (1)**

**Customer Registration card (Warranty)**

**Graffiti Card (1)**

**Software license agreement (1)**

**Other printed materials**

Make sure that the package contains all of the listed accessories. If any item is missing, contact the Sony Customer Information Service Center or a Sony dealer.

**Use the strap to avoid dropping your CLIÉ handheld**

### Attaching the strap

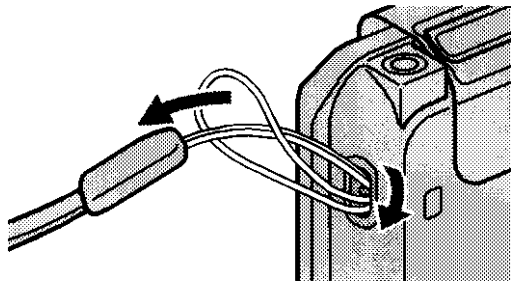

corrected to follow  
the Japanese version

# Setting your Sony CLIÉ™ handheld

Perform the following before setting your CLIÉ handheld.

- 1 Charging your CLIÉ handheld
- 2 Performing the initial setting after turning on

## Step 1: Charging your CLIÉ handheld

**Before you use your CLIÉ handheld for the first time, be sure to charge the battery.**

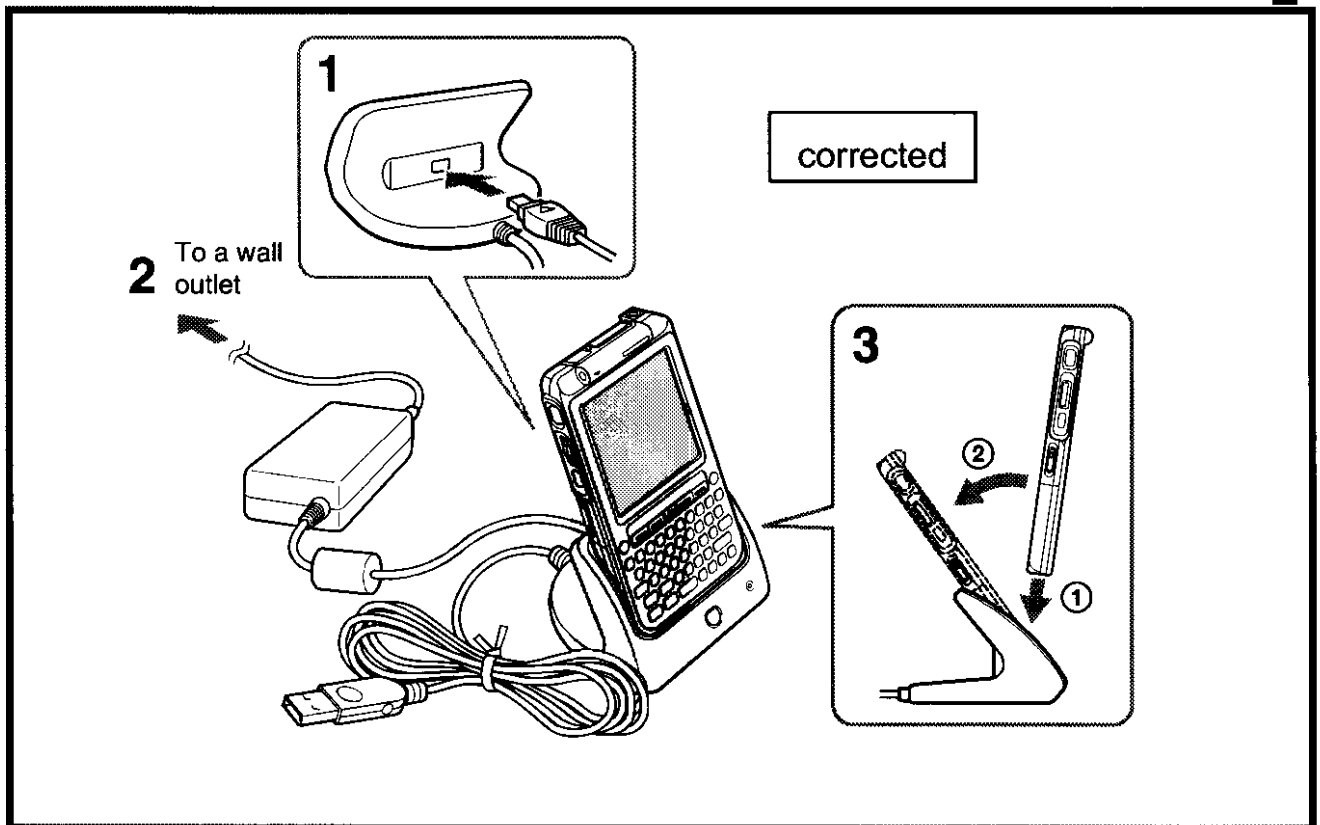

- 1** Connect the AC adapter to the cradle's AC adapter connector.
- 2** Connect the AC adapter to a wall outlet.
- 3** Insert your CLIÉ handheld at an angle into the cradle and lay it back to fit into place.

The CHG LED indicator of your CLIÉ handheld and the Cradle LED turn on and charging starts.

corrected

Also, the Battery icon turns to .

It takes about five hours for your CLIÉ handheld to be fully charged for the first time.

The CHG LED turns off when charging is complete, but the Cradle LED stays on.

The Battery icon turns to  when you disconnect your CLIÉ handheld from the cradle.

#### Tip

Subsequent charges will require less time if you charge your CLIÉ handheld frequently.

#### Notes

- If the battery of your CLIÉ handheld is fully discharged, all data stored on the memory in your CLIÉ handheld will be lost.
- While charging your CLIÉ handheld, do not connect external devices, such as a computer, to the headphone jack of your CLIÉ handheld, as a malfunction may occur.

## Charging your CLIÉ handheld without a cradle

You can charge your CLIÉ handheld using a plug adapter.

### Attaching the plug adapter

Connect the AC power adapter to the DC IN connector of the plug adapter (①), then connect the plug adapter to the interface connector of your CLIÉ handheld (②).

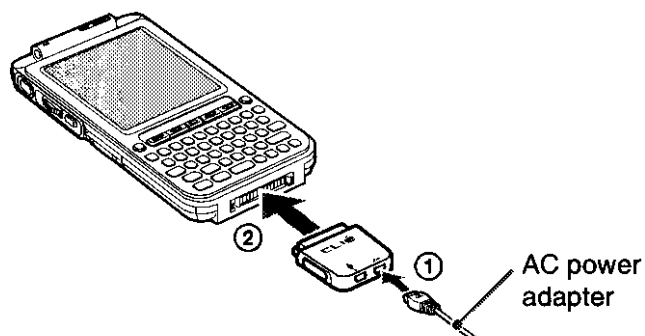

Secondly, connect the AC cord to the AC power adapter, then plug into the wall outlet.

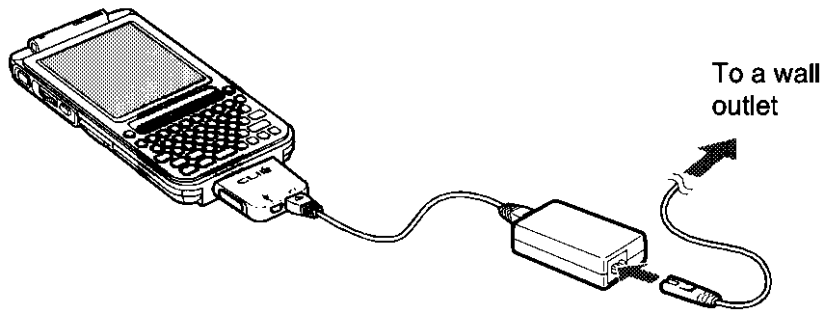

### Removing the plug adapter

Remove the plug adapter (2) pushing the both side of the plug adapter (1).

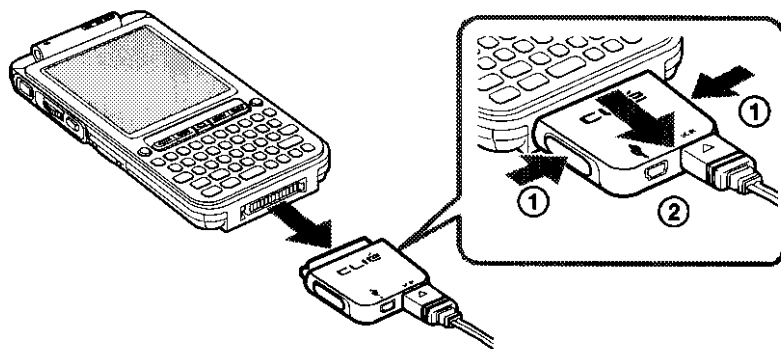

## ..... Using the supplied plug adapter attachment

### Attaching the plug adapter attachment

Follow the illustration to use the supplied plug adapter attachment.

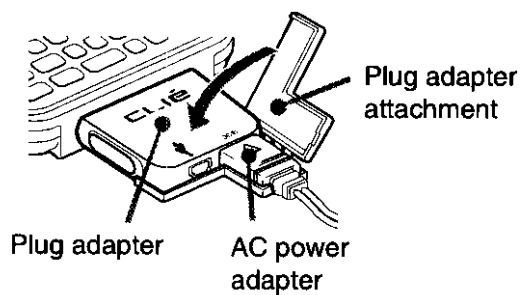

Continued on next page

\*\*\*\*\*

## Step 2: Performing the initial settings after turning on

The first time you turn on your CLIÉ handheld, you are required to make initial settings. Follow the on-screen instructions to configure the initial settings and to get accustomed to operations on your CLIÉ handheld.

- 1** Slide down the POWER/HOLD switch.  
Your CLIÉ handheld turns on, and the **Welcome** screen is displayed.

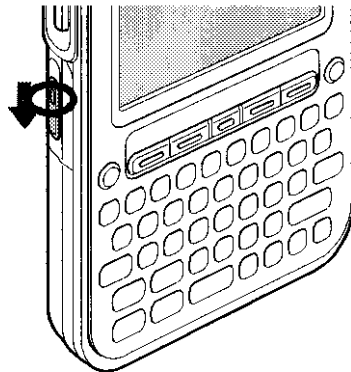

Slide down the POWER/HOLD switch

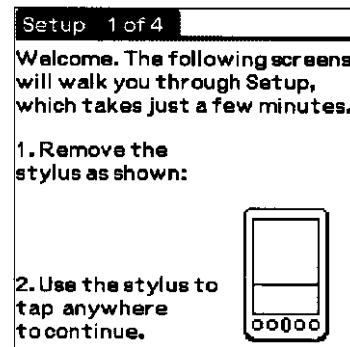

### Tip

#### If you cannot turn on your CLIÉ handheld

- Did you charge your CLIÉ handheld following the steps on page 13?
- For details, refer to the supplied manual “Troubleshooting Q&A.”
- If you cannot turn on your CLIÉ handheld even after charging it, perform a soft reset (page 26).

- 2** Take out the Stylus.  
You can use the stylus to enter data or to select applications.

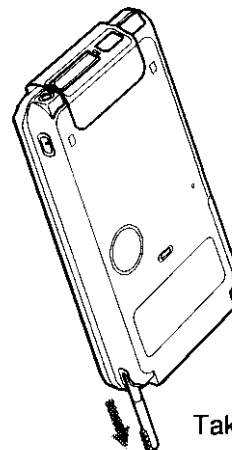

Take out the Stylus

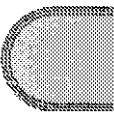

**Notes**

- Always use the point of the stylus for tapping or making strokes on the CLIÉ handheld screen. Never use a real pen, pencil, or other sharp object to write on the screen.
- When you put the stylus back in its holder, push it in until it clicks into place.

**3 Press lightly on the screen with the stylus.**

This action is called “tapping.”

The **Setup** screen for digitizer calibration is displayed.

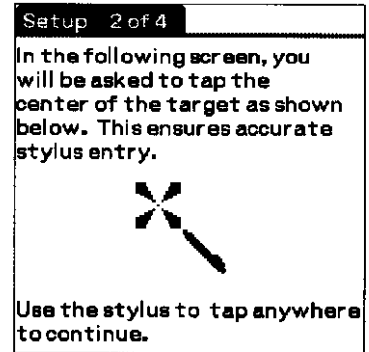
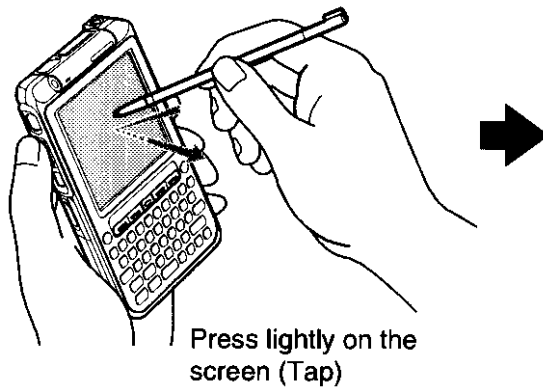

**4 Following the on-screen instruction, tap the center of the displayed mark.**

Also tap the center of the following displayed targets in the lower right corner and the center of the screen.

**Note**

If the digitizer is not configured correctly, the scroll bar may not operate properly, “tapping” may not work as expected, or other problems may occur. For re-configuring the digitizer, refer to “Customizing your Sony CLIÉ™ handheld (Preferences): Adjusting the Digitizer” in the “Handbook.”

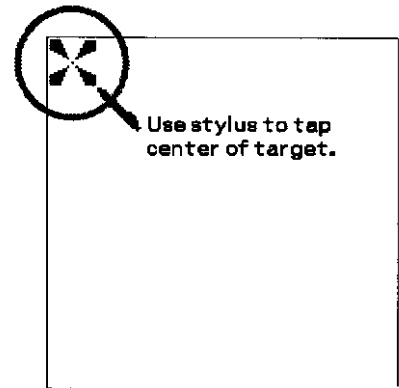

After calibration is completed, a screen for setting the time and date appears.

Continued on next page



- 5** Tap the **Set Time** box.  
The **Set Time** screen is displayed.

**Tip**

You can reconfigure the date and time settings in the **Preferences** screen.

- ➔ For details, refer to “Customizing your Sony CLIE™ handheld (Preferences): Setting the Date & Time preferences” in the “Handbook.”

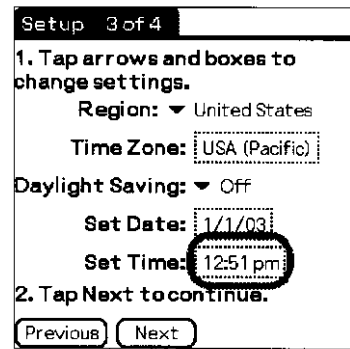

- 6** Tap the arrow ▲ or ▼ to set the current time.  
Tap each box to set the current hour and minute.

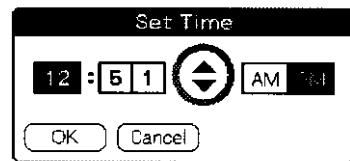

- 7** Tap **OK**.  
The current time is set and the **Setup** screen is displayed.

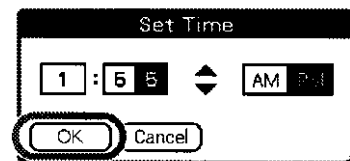

- 8** Tap the **Set Date** box.  
The **Set Date** screen is displayed.

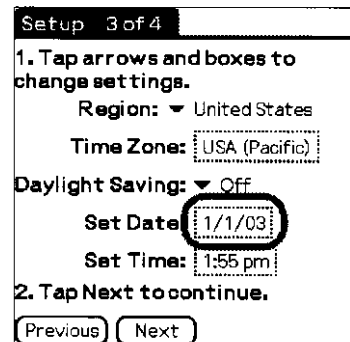



- 9** Tap the arrow ◀ or ▶ next to the year to select the current year.

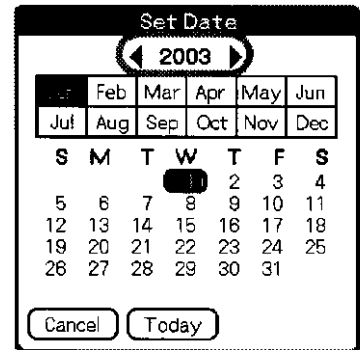

- 10** Tap the current month and then tap the current date.  
The **Set Date** screen closes.

- 11** Tap the **Time Zone** box.  
The **Set Time Zone** screen is displayed.

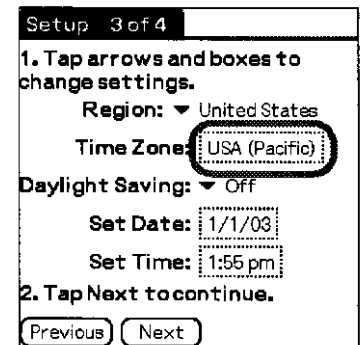

- 12** Tap the region to set the time zone and then tap **OK**.



Setting your Sony CLIE™ handheld

Continued on next page

**13** Tap the arrow ▼ next to **Daylight Saving** and select **On** or **Off**.

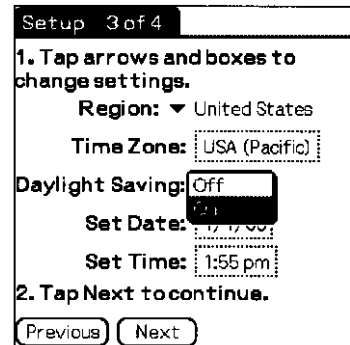

**14** Tap **Next**.

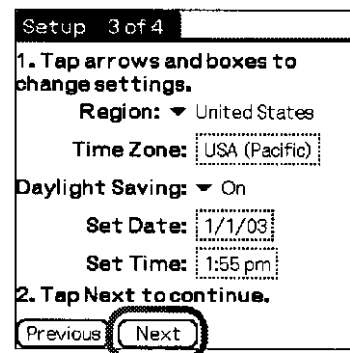

**15** Tap **Next** and **Done**.

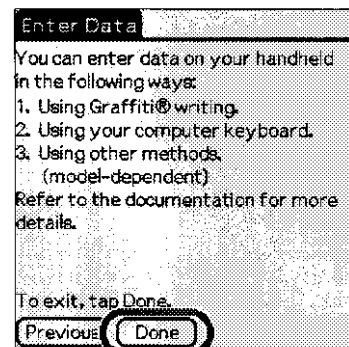
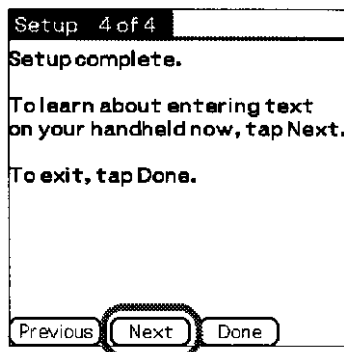

The initial settings are complete, and the CLIE Launcher screen is displayed.

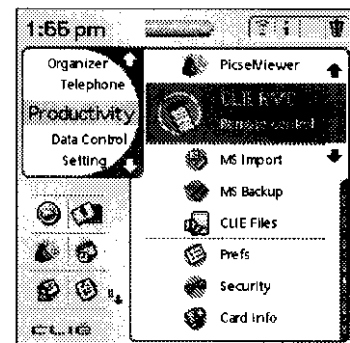

**Initial settings are complete.**

# Basic operations of your Sony CLIE™ handheld

## Start an application

To work with the CLIE handheld, you need to start “Applications.”  
The following explains the basic operation to start an application.

- 1 Display the CLIE Launcher screen
- 2 Selecting an application
- 3 Quitting the application

The following shows how to start applications from the CLIE Launcher screen using the Jog Dial™ navigator.



## Using the Jog Dial™ navigator

### 1 Display the CLIE Launcher screen

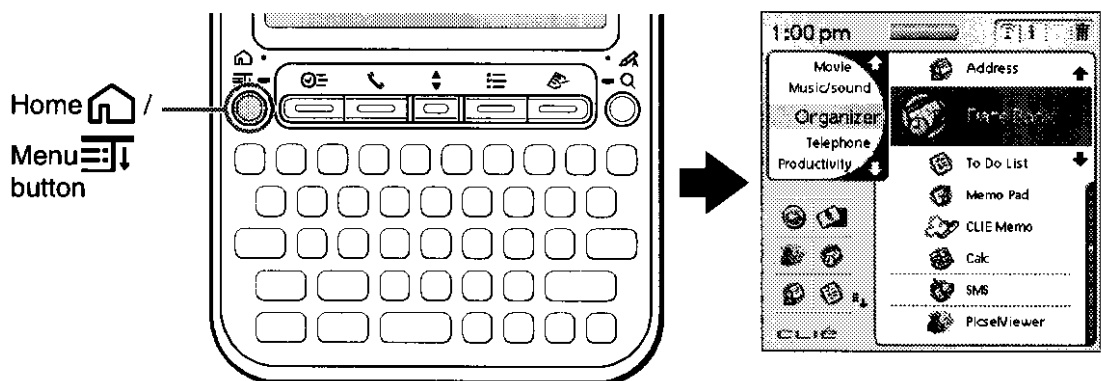
- 1 Press the Home  /Menu  button.  
The CLIE Launcher screen is displayed.



#### Tip

The Menu screen is displayed when you press and hold the Home  /Menu  button.

Continued on next page

## 2 Selecting an application

1 Rotate the Jog Dial™ navigator to select an application to start.

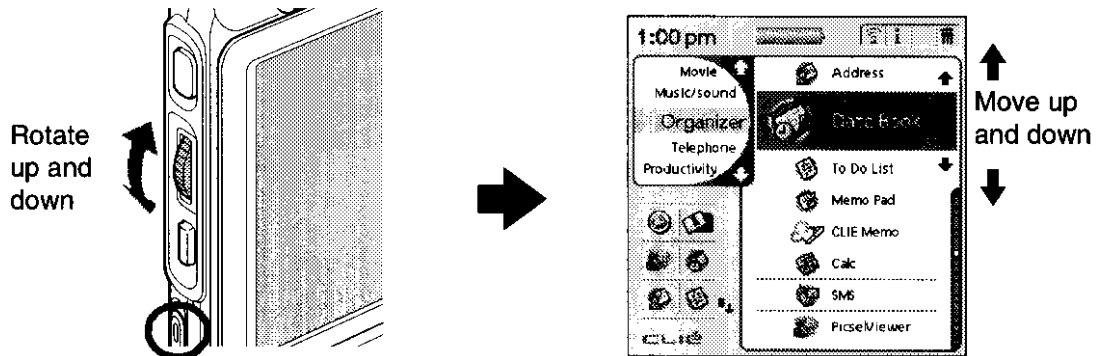

2 Press the Jog Dial™ navigator.  
The selected application starts.

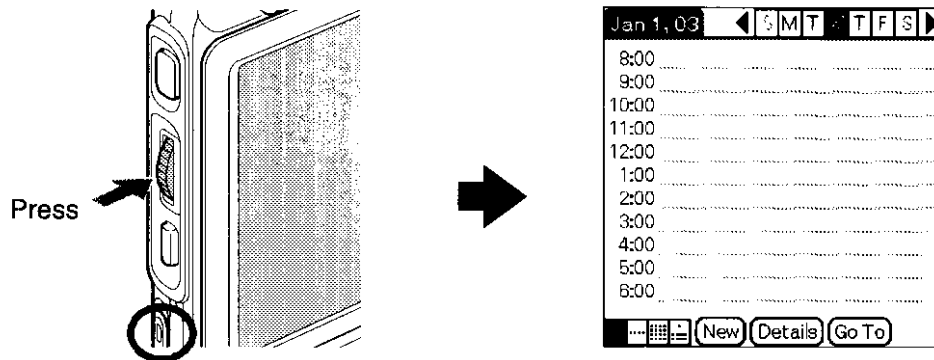

### Tip

#### To select each group

The group list is highlighted when you press the BACK button in the CLIE Launcher screen. You can also select an application by selecting the group first while rotating the Jog Dial™ navigator.

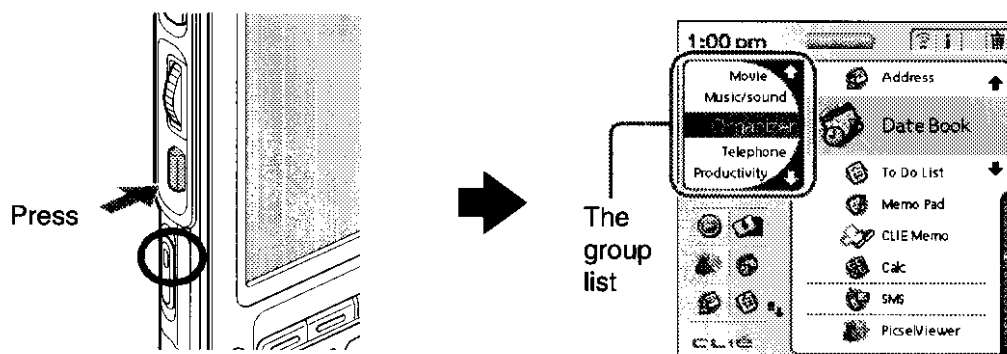



### ③ Quitting the application

You do not need to manually save data in the CLIE handheld like you do with the computer.

All the changes in the application that you are working on are automatically saved, and the last screen you worked on is displayed when you restart the application.

Display the CLIE Launcher screen to switch to another application while you are working on an application.

You can select one of the two methods to display the CLIE Launcher screen as follows.

■ **Return to the CLIE Launcher screen by pressing the Home  /Menu  button.**

■ **Return to the CLIE Launcher screen by pressing and holding the BACK button.**

#### Tip

You can switch the application to another application by pressing the Application button.

#### Note

For some applications, you need to operate Save.

➔ For details, refer to the “CLIE Application Manual” installed on your computer.

## ..... About other ways to start an application

You can also start an application with the supplied stylus or application buttons.

### Using the stylus

Start the application by pressing the screen directly with the supplied stylus.

1 Tap the  on the CLIE Launcher screen to display the application you want.

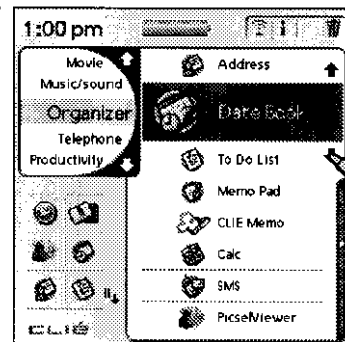

Continued on next page

- 2** Tap the application icon.  
The selected application starts.

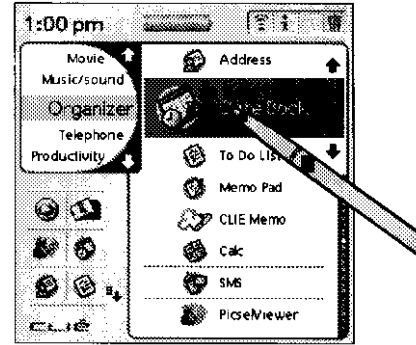

## Pressing the application buttons

You can also start the applications by pressing the application buttons.

The application buttons are set as follows at the default;

☑️ = Date Book, 📞 = Address, ☰ = To Do, 📄 = Memo

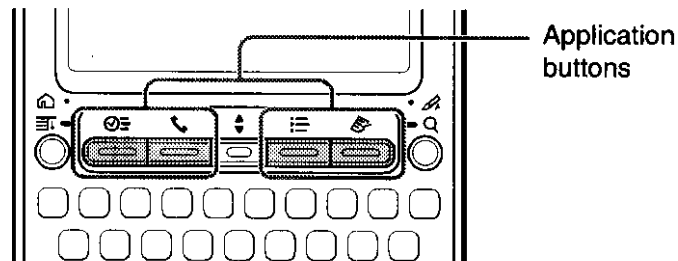

### Tip

- You can also start an application by pressing one of the application buttons even when your CLIÉ handheld is off.
- You can assign your favorite applications to the application buttons.
  - For details, refer to “Customizing your Sony CLIÉ™ handheld (Preferences): Assigning applications to application buttons”