

CLIE™ handheld components

This chapter explains each part of your CLIE handheld and the supplied accessories.

Front panel

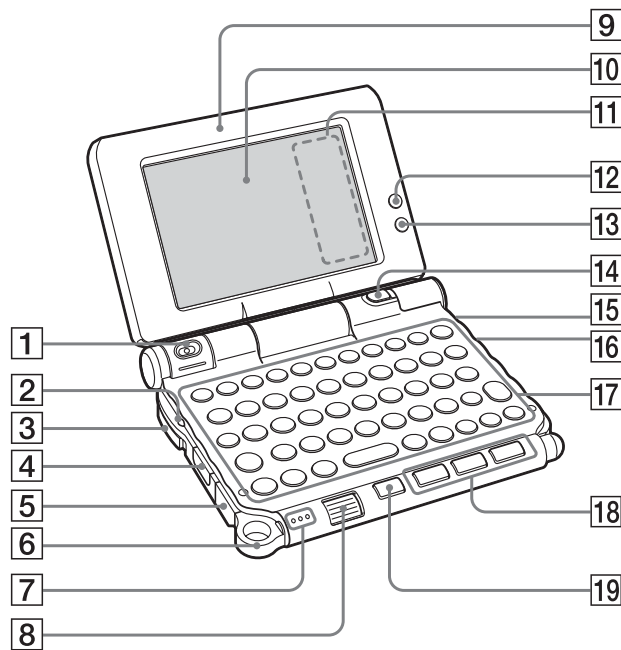

- 1 Camera Lens**
(Pages 48, 50)
- 2 POWER LED**
(Page 9)
Lights or blinks when turned on. The LED shows the status of your CLIÉ handheld by its color.
Lights green: The power is on. (It also lights in HOLD mode)
Blinks green: Blinks a few moments when you operate any button on your CLIÉ handheld in HOLD mode.
Lights orange: The battery is being charged.
Blinks orange: Alarm function that notifies you at a preset time if you have set an alarm in an application, such as **Date Book**.
OFF: The power is off.
- 3 POWER/HOLD Switch**
(Pages 11, 101)
Turns your CLIÉ handheld on and off, and sets your CLIÉ handheld to HOLD mode.
- 4 IR Port**
(Page 103)
You can beam data between your CLIÉ handheld and another CLIÉ handheld or Palm OS[®] PDA.
- 5 USB connector (Page 19)**
For connecting the supplied USB cable.
- 6 Strap Ring**
- 7 Microphone**
(Page 53)
Use this to record sounds.
- 8 Jog Dial™ navigator**
(Page 26)
Use to select and run applications or items. Depending on the application, unique features are assigned.
- 9 Display Panel**
(Page 9)
- 10 Screen**
(Page 106)
- 11 Silk Screen Area**
(Page 108)
- 12 Wireless LAN LED (for PEG-UX50 only)**
(Page 42)
- 13 Bluetooth LED**
(Page 68)
- 14 CAPTURE/REC Button**
Press the CAPTURE/REC button to take pictures, record movies (Pages 48, 51) or to record voice memos (Page 53).
- 15 REC LED**
(Page 53)
Lights when you are recording a voice memo.
- 16 "Memory Stick" LED**
(Page 102)
Blinks orange while your CLIÉ handheld is writing data to, or reading data from a "Memory Stick" media.
- 17 Hardware Keyboard**
(Page 103)
- 18 Application Buttons**
(Page 28)
Even when your CLIÉ handheld is turned off, pressing an application button turns on your CLIÉ handheld and starts that application.
- 19 BACK Button**
Cancels the selection of an item or an operation. Depending on the application, unique features such as restoring to the previous screen are assigned.

Back panel

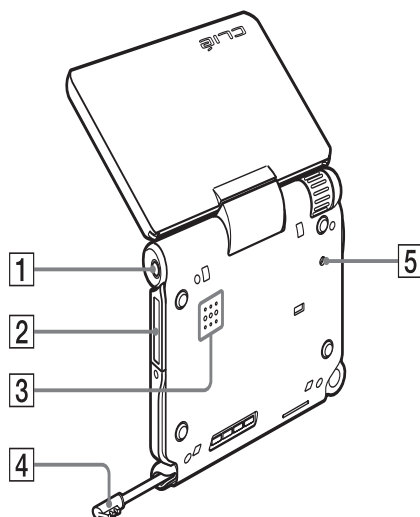

1 Headphone Jack

For connecting stereo mini-jack headphones sold separately.

2 "Memory Stick" Slot

(Page 102)
Insert a "Memory Stick" media into this slot.

3 Speaker

4 Stylus

(Page 11)
A pointed tool to operate your CLIÉ handheld by touching the screen with it.

5 RESET Button

(Pages 32, 33)
Press to restart your CLIÉ handheld.

POWER/HOLD switch

Turning on/off your CLIÉ handheld

Slide down the POWER/HOLD switch

The POWER/HOLD switch will return to the center position after being released. Your CLIÉ handheld powers on, the last screen viewed is displayed, and the POWER LED lights green. To turn off your CLIÉ handheld, slide down the POWER/HOLD switch again and then release.

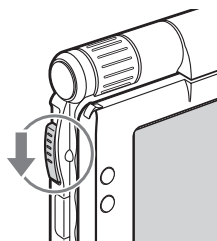

POWER/HOLD Switch

Turning on/off the LCD backlight

Slide down the POWER/HOLD switch and hold it for more than two seconds.

Turning on/off the HOLD mode

Slide up the POWER/HOLD switch

Putting your CLIÉ handheld in HOLD mode deactivates the touch screen. If you put the POWER/HOLD switch into the HOLD position while the power is on, the screen display turns off, even during an operation. To release the HOLD mode, slide up the POWER/HOLD switch again and then release.

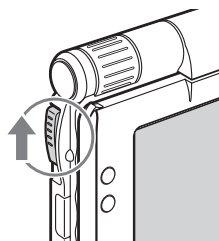

Using "Memory Stick" media

Inserting "Memory Stick" media

The "Memory Stick" LED blinks orange while your CLIÉ handheld is writing data to, or reading data from a "Memory Stick" media.

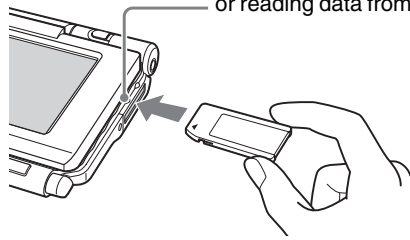

Note

Insert a "Memory Stick" media in the right direction. If you forcibly insert a "Memory Stick" media in the wrong direction, the "Memory Stick" slot may be damaged.

Removing "Memory Stick" media

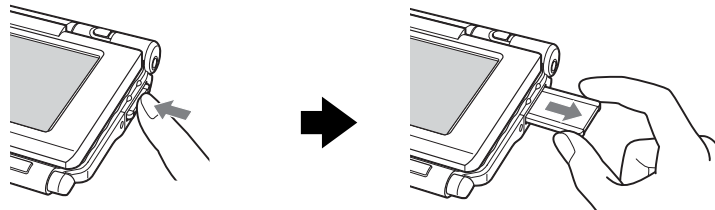

Push "Memory Stick" media in

Pull "Memory Stick" media out

Note

Make sure that your CLIÉ handheld is not writing files/data to, or reading files/data from, a "Memory Stick" media before removing it. (The "Memory Stick" LED blinks when it is reading or writing files/data.) If you remove a "Memory Stick" media while the "Memory Stick" LED is blinking, recorded files/data may be deleted or damaged.

IR port

You can beam data or applications between your CLIÉ handheld and another CLIÉ handheld or Palm OS® PDA.

➔ For details, refer to “Beaming” in the supplied “Handbook”.

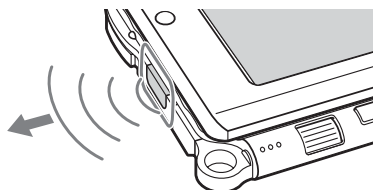

* Move your CLIÉ handheld gradually to find the most sensitive direction.

Hardware Keyboard

You can use the hardware keyboard in the same way as you would use the keyboard of your computer.

For details about the key arrangement, check your CLIÉ handheld.

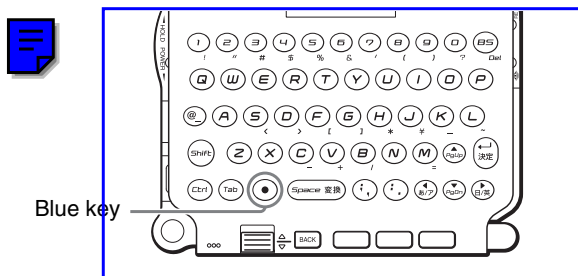

Input commands

You can perform commands using the hardware keys in combination.

Key combinations

Example: Ctrl + C → Hold down the Ctrl key and press the character C key.

Basic operations

Combination	Function
⦿ (Blue) + blue character	Types the characters in blue. To type them continuously, press ⦿ (Blue) twice to lock the shift, and press it again to unlock.
Shift	Types capital letters. To type capital letters continuously, press the Shift key twice to lock the shift, and press it again to unlock.

Continued on next page

Edit

Combination	Function
Ctrl + C	Copies the selected text.
Ctrl + D	Deletes the selected text.
Ctrl + V	Pastes the selected text.
Ctrl + X	Cuts the selected text.
Ctrl + Right/Left	Selects until the last/first letter of the word.
Shift + Right/Left	Selects a continuing/preceding text.

Functions

Combination	Function
Ctrl + G	Shows/hides the silk screen area.
Ctrl + H	Goes to the CLIE 3D Launcher.
Ctrl + L	Turns the backlight on/off.
Ctrl + M	Displays the menu.
Ctrl + O	Goes to the previous field.
Ctrl + P	Goes to the next field.
Ctrl + R	Performs a full-screen pen stroke.*

* You can change this function by selecting **Preferences** and tapping [Buttons] - [Pen].

Dialogs

Combination	Function
Ctrl + A	Displays the Adjust Volume dialog box.
Ctrl + B	Displays the Battery Information dialog box.
Ctrl + E	Displays the Media Info dialog box.
Ctrl + F	Displays the Find dialog box.
Ctrl + K	Displays the Keyboard Help dialog box.
Ctrl + T	Displays the command tool bar.

Button operations

Combination	Function
Ctrl + Up/Down	Same as Jog Dial Up/Down.
Ctrl + Enter	Same as pressing Jog Dial.
Ctrl + Enter (Long Push)	Same as holding down the Jog Dial.
Ctrl + BS	Same as pressing the BACK button.
Ctrl + BS (Long Push)	Same as holding down the BACK button.

More

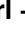
Combination	Function
Ctrl +  (Blue) + S	Turns off your CLIE handheld using Power Saving mode.

Tip

When you use a Palm OS application that assigns a function to the scroll buttons, the same function can be performed by using a key combination,  (Blue) + Up/Down.

Locating the components of the CLIE 3D Launcher

Tip

If a different screen is displayed, tap  (Home).

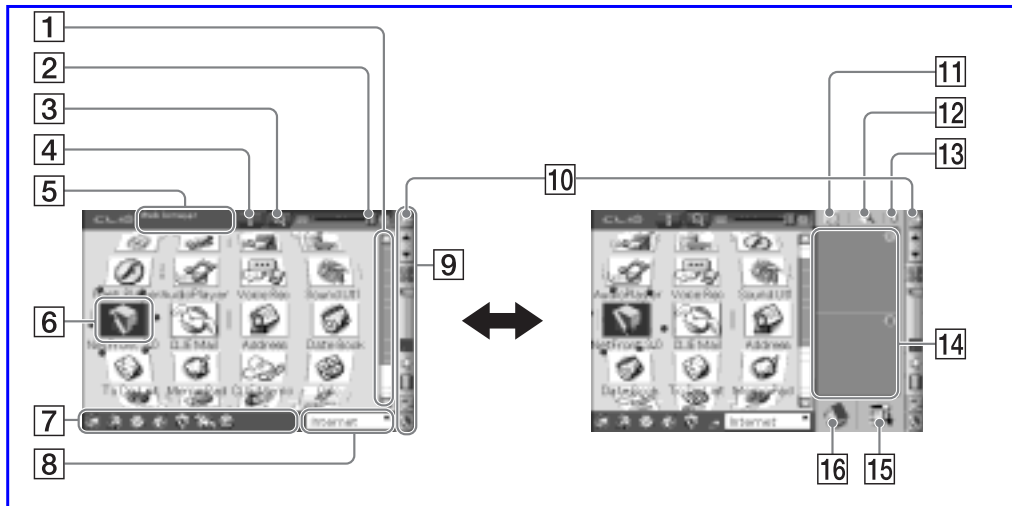

1 Scroll Bar

2 3D Adjust Bar

Scroll the bar with the stylus to adjust the 3D degree.

3 Resize Application Icon

Tap to change application icons to small or large.

4 Information Icon

Tap to display the information for a selected application icon.

5 Application Summary Area

Description of a selected application is displayed here

6 Application Icons

7 Favorite Applications (shortcuts)

You can create shortcuts to favorite applications.

8 CLIE 3D Launcher Groups List

The list of CLIE 3D Launcher groups is displayed.

9 Status Bar

(page 108)

10 Resize Icon

If you tap this icon, the screen view will be switched.

11 Calculator

Tap to display the on-screen Calculator.

12 Find Icon

Tap to display the dialog box finding data or applications.

13 Brightness Adjustment Icon

Tap to display the dialog box for adjusting brightness.

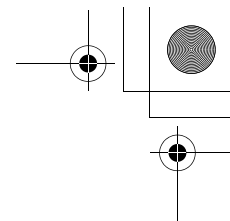
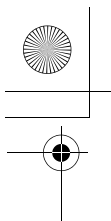

14 Graffiti 2 Writing Area

Write strokes of **Graffiti 2** here.
Decuma Input can be launched from this area.

For details, refer to “Entering text on your CLIE™ handheld: Using Decuma Input to enter text” in the supplied “Handbook”.

15 Menu Icon

Tap to display menu of the current application.

16 Home Icon

Tap to display the CLIE 3D Launcher or Palm OS Standard Screen.

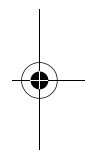
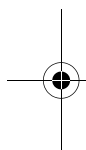

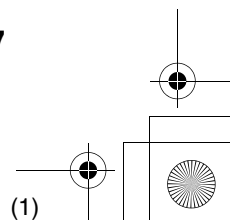
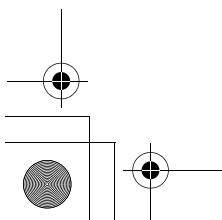

CLIE™ handheld components



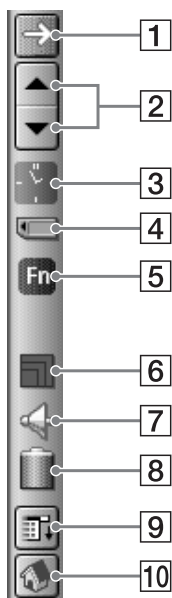





Status Bar



The status bar displays the following icons. Additional icons will be displayed according to the applications in use.

-
- 1**  Tap this icon to show or hide the silk screen area.
-
- 2**  Tap of scroll up/down the screen or select items of an application in use.
-
- 3**  Displays the current time. To change the display format, select **Preferences**, and tap [Formats]-[Time].
 ➔ For details, refer to “Customizing your CLIÉ™ handheld (Preferences): Setting up the Date & Time preferences” in the supplied “Handbook”.
-





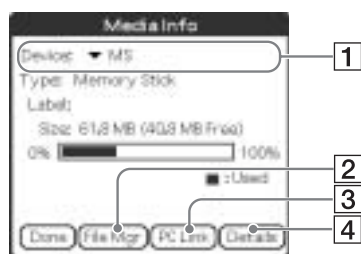



- 4  Each icon indicates the information on the “Memory Stick” media inserted into your CLIE handheld.
-  “Memory Stick” media is inserted
 -  “Memory Stick” media is not inserted
 -  “Memory Stick” media is write-protected
 -  “Memory Stick” media is not read correctly
 -  “Memory Stick” media is reading
 -  A “Memory Stick” compatible device is inserted

Tap the icon to display the **Media Info** dialog box when “Memory Stick” media is inserted.

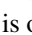

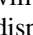
- 1 Media type
(You can choose another device from the ▼ list.)
- 2 Tap to display **CLIE Files**.
- 3 Tap to display **Data Import**.
- 4 Tap to display the **Device Detail** dialog box for information on the device or driver.

From the **Media Info** dialog box, tap  (Menu) and then tap [Preferences] from [Option] to select operations for “Memory Stick” media.



- 5  Displayed when  (Blue) is pressed while an application such as **Date Book** is open.  will be displayed when  (Blue) is pressed twice to lock the sift. Also,  is displayed when the Shift key is pressed, and  will be displayed when it is pressed twice to lock the sift.
➔ For details, refer to “Hardware Keyboard” on page 103.
- 6  Displays the reception level for the wireless LAN when your CLIE handheld is connected to the Wireless LAN. The reception levels are:  (level 1),  (level 2), and  (level 3)

Continued on next page

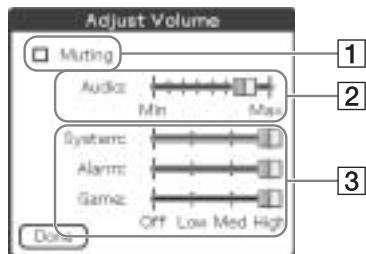
7  Tap to display the **Adjust Volume** dialog box.



- 1** Turns off the sound of your CLIE handheld. When Muting mode is selected,  is displayed in the status bar.
- 2** Adjusts the volume level for playing back audio files or movie files.
- 3** Adjusts the volume level for System sound, Alarm sound, and Game sound. This affects the [General] settings in **Preferences**.
 - ➔ For details, refer to “Customizing your CLIE™ handheld (Preferences): Setting sounds” in the supplied “Handbook.”

8  Displays the battery’s remaining charge.  is displayed while the battery is being charged. Tap to display the **Battery Information** dialog box.



Power: Power used
 Status: Battery status
 Remain: Remaining charge of the battery
 (This is not displayed while charging.)

Tap [Limits] to display the **Battery Limits** dialog box.

9  Tap to display the menus of the current application.

10  Tap to display the CLIE 3D Launcher or Palm OS Standard Screen.

Tip

When a screen like this is displayed

Tap the  icon to display tips and helpful advice.



Locating Charger Cradle components

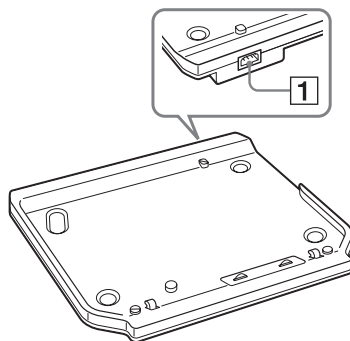

- 1 AC Power Adapter Connector**
(Page 8)

CLIE™ handheld components

INDEX

A

- AC power adapter 6, 8
- Address Book 61, 81
- Applications
 - Quitting 27
 - Starting 25
 - Using the CLIE Application Manual . . 72
- Audio Player 58, 79

B

- Backup 85
- Basic Operations 24
- Battery considerations 90

C

- Calculator 82
- Carrying style 9
- Charger Cradle 8, 111
- CLIE Album 56, 75
- CLIE Camera 74
- CLIE Files 83
- CLIE Mail 80
- CLIE Memo 82
- CLIE Viewer 55, 74
- Components 98

D

- Data Export 65, 84
- Data Import 65, 84
- Date Book 59, 81
- Decuma Input 29
- Display panel 9

E

- Entering text 29
- Exchanging Date Book and Address Book data 63

G

- Giga Pocket Plugin 78
- Graffiti[®] 2 29

H

- Hardware keyboard 103
- Have a try
 - Exchanging Date Book and Address Book data between your CLIE handheld and computer 63
 - Listening to music 57
 - Managing addresses and telephone numbers 61
 - Managing schedule events 59
 - Recording a voice memo 53
 - Using the Bluetooth[®] function 66
 - Viewing computer documents on your CLIE handheld 64
 - Viewing handwritten memos and image files, and playing back voice memos . . 55
- HotSync[®] operation 21

I

- Image Converter 76
- Image Files
 - Enjoying 49
 - Taking pictures 47
- Initial screen 106
- Initial setup 9
- Input commands 103
- Intellisync Lite 17, 84

IR port. 103

M

Macromedia Flash Player 5. 78
 Managing addresses and telephone numbers 61
 Managing **schedule events** 59
 Memo Pad 81
 "Memory Stick" LED. 102
 "Memory Stick" Slot. 102
 Movie Player. 77
 Movie Recorder 77
 Movies
 Enjoying 52
 Recording movies 50

N

NetFront v3.0 for CLIE 80

O

Opened style. 9
 Operating style. 9

P

Palm™ Desktop for CLIE 16
 Photo Editor 56, 76
 PhotoStand 56, 75
 Picstel Viewer for CLIE 64, 83
 PictureGear Studio 76
 Playing back music data 58

R

Recording a voice memo 53
 Remote Camera 75
 Restarting 32
 Hard reset 33
 Soft reset 32

S

Set date. 13
 Set time. 13
 Setting up 8
 SMS. 82
 SonicStage 57, 80
 Sound Utility 79
 Specifications 93
 Status bar 108
 Stylus 11

T

Tapping. 12
 Time zone 14
 To Do List 81
 Turned style 10

U

USB cable 19
 USB port 19
 Using applications. 72

V

Viewing computer documents 64
 Voice Recorder 53, 79

W

World Alarm Clock 83



On the trademarks

Before using your CLIE handheld, be sure to read the accompanying End-User's License Agreement.

Sony, CLIE, "Memory Stick", "Memory Stick Duo", "Memory Stick PRO", "MagicGate Memory Stick", Jog Dial, PictureGear Studio and their logos are trademarks of Sony Corporation.

Palm, Palm Powered, the Palm logo, the Palm Powered logo, Palm OS, Graffiti 2 powered by Jot®, HotSync and the HotSync logo are trademarks of PalmSource, Inc.

Microsoft and Windows are registered trademarks of Microsoft Corporation.

Pentium is registered trademarks of Intel Corporation.

Intellisync is a trademark of Pumatech, Inc.

Adobe and Acrobat are trademarks of Adobe Systems Incorporated.

QuickTime and the QuickTime logo are trademarks of Apple Computer, Inc.

NetFront is a trademark of ACCESS CO, Ltd.

Picxel and the Picxel logo are trademarks of Picxel Technologies, Ltd.

Contains Macromedia® Flash™ Player software by Macromedia, Inc.
Copyright © 1995-2003 Macromedia, Inc.

Macromedia and Flash are trademarks or registered trademarks of Macromedia, Inc. in the United States and internationally.

Decuma is a trademark of Decuma AB in the United States and other countries.

This product includes fonts owned by TypeBank Co., Ltd. under license.

CompactFlash is a U.S. registered trademark of SanDisk Corporation.

Bluetooth is a registered trademark that is owned by the proprietor and used by Sony under license.

All other trademarks are trademarks of their respective owners.

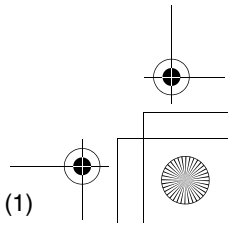
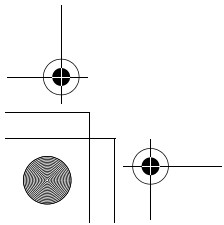
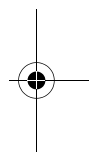
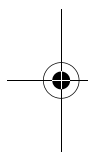
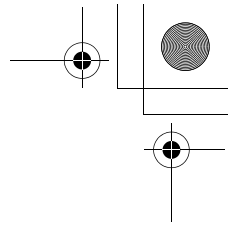
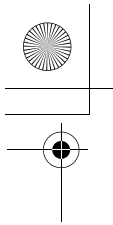

For the latest information on support
and accessories,
check our official Sony CLIÉ website

For customers in the U.S.A. and Canada
<http://www.sony.com/clie/>

For customers in Australia, Hong Kong, Malaysia,
Mexico, New Zealand, Singapore, Taiwan and Thailand
<http://vaio-online.sony.com/clie/>

<http://www.sony.net/>