

SIM card

Congratulations on your purchase of the Sony Ericsson W302. For additional phone content, go to www.sonyericsson.com/fun. Register now to get free online storage and special offers at www.sonyericsson.com/myphone. For product support, go to www.sonyericsson.com/support.

Instruction symbols

- The following appear in this User guide:
- > Use the selection key to scroll and select
 - ⊙ Press the centre selection key
 - ⤴ Press the navigation key up
 - ⤵ Press the navigation key down
 - ⤶ Press the navigation key to the left
 - ⤷ Press the navigation key to the right
 - ! Note
 - ⚡ Tip
 - ⚠ Warning
 - 📶 Indicates that a service or function is network- or subscription-dependent. All menus or functions may not be available in your phone. Consult your network operator for more information.

The SIM (Subscriber Identity Module) card, which you get from your network operator, contains information about your subscription. Always turn off your phone and detach the charger and the battery before you insert or remove the SIM card.

⚡ You can save contacts on the SIM card before removing it from your phone. You can also save contacts in the phone memory. See **Contacts** on page 27.

PIN code (SIM card lock)

The PIN (Personal Identification Number) code is a SIM card lock that protects your subscription, but not the phone itself. If the card is locked, you have to enter the PIN code when you turn on your phone. To change your PIN code, see **SIM card lock** on page 36.

Each PIN digit appears as *, unless it starts with emergency number digits, for example, 112 or 911. You can call an emergency number without entering a PIN.

⚡ If you enter the wrong PIN three times in a row, **PIN blocked** appears. To unblock it, you need to enter your PUK (Personal Unblocking Key).

Charging the battery



The phone battery is partly charged when you buy it. It takes approximately 2.5 hours to fully charge the battery.

To charge the battery

- 1 Connect the charger to the phone with the power icon on the charger facing upwards. Press a key to illuminate the screen and see the charging status.
- 2 To remove the charger, tilt the plug upwards.

⚡ The battery icon on the screen may not appear until the phone has charged for 30 minutes.

⚡ You can use the phone during charging. You can charge the battery for more or less than 2.5 hours. Interrupted charging will not damage the battery.

Memory Stick Micro™

Your phone supports Memory Stick Micro™ (M2™). A memory card adds more storage space to your phone, for music, ringtones, video clips, pictures and so on. You can share your saved information by moving or copying it to other memory card compatible devices.

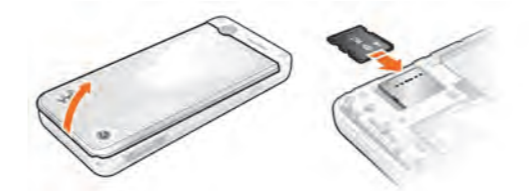

To insert a Memory Stick Micro™ (M2™)

- Open the cover and insert the memory card with the contacts facing down.

To remove a Memory Stick Micro™ (M2™)

- Press the edge to release and to remove.

Turning on the phone

To turn on the phone

- 1 Press and hold down **Power**.
- 2 Enter your SIM card PIN, if requested.
- 3 Select **Yes** to use the setup wizard.

⚡ If you make a mistake when you enter your PIN, you can press **Cancel** to delete numbers from the screen.

Standby

After you have turned on the phone and entered your PIN, the name of your operator appears on the screen. This is called standby. You can now make and receive calls.

To turn off the phone

- Press and hold down **Power**.

⚡ If your phone turns itself off when being transported, turn the automatic keylock on. This prevents things in your pocket or bag activating the on/off key accidentally.



Network coverage

The network bars show the strength of the GSM network in your area. Move to another location if you have problems calling and network coverage is poor. **No network** means you are not in range of a network.

- 📶 = Good network coverage
- 📶 = Average network coverage

Battery status

- 🔋 = The phone battery is fully charged
- 🔋 = The phone battery is empty

User guide

W302

Screen icons

These icons may appear on the screen.

Icon	Description
	Missed call
	Handsfree connected
	Phone set to silent
	Text message received
	Picture message received
	Email message received
	Predictive text input activated
	Voice message received
	Ongoing call
	FM radio playing
	Alarm activated
	Bluetooth function activated

Phone overview

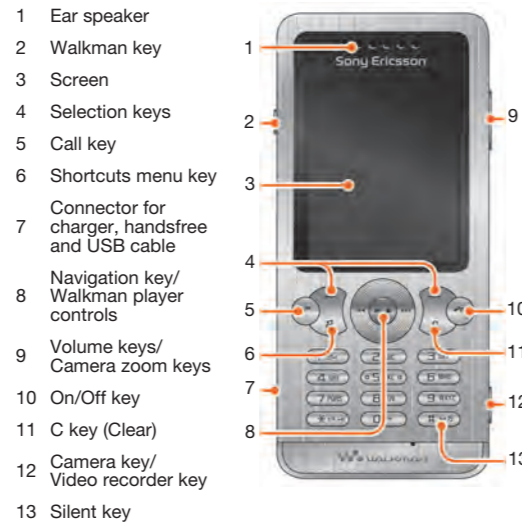

Key

	Go to the main menu or select items
	Scroll between the menus and tabs
	Select options shown immediately above these keys on the screen
	Delete items, such as pictures, sounds and contacts.
	Open the Walkman™ player. Press to move between the Walkman™ player and standby
	Stop, pause and play (music key). Press to mute or unmute the radio. Press up or down to search for preset channels.
	Skip to the previous track when using the Walkman™ player. Search for radio channels
	Skip to the next track when using the Walkman™ player. Search for radio channels
	My shortcuts – add your favourite functions to access them quickly
	Camera and video recorder
	Turn the phone on/off

Navigation

The main menus are shown as icons. Some submenus include tabs.

To navigate the phone menus

- 1 From standby select **Menu**.
- 2 Use the navigation key to move through the menus.

To scroll between the tabs

- Press the navigation key left or right.

To go back one step in the menu

- Select **Back**.

To return to standby

- Press **Power**.

To lock the keypad

- Press **Lock** and select **Lock**.

To unlock the keypad

- Press **Lock** and select **Unlock**.

To set the phone to silent

- Press and hold down **Power**.

To call your voicemail service

- Press and hold down **Power**.

To end a function

- Press **Power**.

Menu overview

	Homepage, Enter address, Bookmarks, History, Saved pages, Internet settings
	Games, TrackID™, Video player, Record sound
	Write new, Inbox, Email, Drafts, Outbox, Sent messages, Call voicemail, Templates, Settings
	WALKMAN
	All files, On mem. card, In phone
	New contact
	Radio
	All, Dialed, Missed, Answered
	Alarm, Applications, Calendar, Tasks, Synchronisation, Timer, Stopwatch, Calculator
	Organiser

Settings**

	Profiles, Time & date, Phone language, Shortcuts, Flight mode, Security, Phone status, Reset all
	Ring volume, Ringtone, Silent mode, Vibrating alert, Message alert, Key sound
	Wallpaper, Themes, Startup screen, Screensaver, Brightness
	Speed dial, Divert calls, Manage calls, Time & cost, Show/hide no. Handfree
	Bluetooth, USB, Synchronisation, Mobile networks, Internet settings

*Some menus are operator-, network- and subscription-dependent. ** You can use the navigation key to scroll between tabs in submenus. For more information, see **Navigation** on page 11.

Walkman™

The Walkman™ player is a music and video player. The file types supported are: MP3, MP4, 3GP, AAC, AMR, MIDI, IMY, EMY and WAV (16 kHz maximum sample rate). You can also use streamed files that are 3GPP compatible.

Transferring music

You can transfer music from your computer to your phone memory or Memory Stick Micro™ (M2™). There are two ways to connect the phone to a computer:

- using the USB cable that comes with the phone
 - with a Bluetooth wireless technology connection
- You can drag and drop files between your phone or memory card and a computer in Microsoft® Windows Explorer.

To connect your phone to a computer using the USB cable

- 1 Make sure your phone is turned on.
- 2 Connect the USB cable to your phone and the computer.
- 3 Phone: select **Mass storage**.
- 4 Computer: Wait for the drivers to be installed (this is done automatically). The first time you connect your phone to the computer, you may need to identify and name the phone.

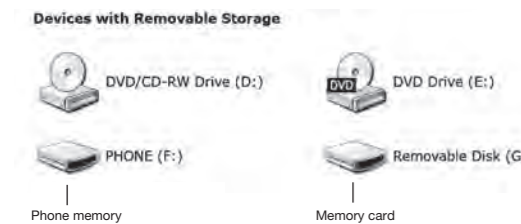

To transfer files in Mass storage mode

- 1 Connect the USB cable to the phone and the computer.
- 2 Phone: From standby select **Menu** > **Settings** > the **Connectivity** tab > **USB** > **Mass storage**.
- 3 Computer: Wait until the phone memory and memory card appear as external disks in Microsoft Windows Explorer.
- 4 Computer: On the computer desktop, double-click the **My Computer** icon.
- 5 Computer: To view the phone memory and memory card folders, double-click the icon representing your phone under **Devices with removable storage**.
- 6 Copy and paste your file, or drag and drop it, into the folder you want on your computer, in your phone memory or on your memory card.

⚡ Do not remove the USB cable from the phone or computer during transfer, as this may corrupt the memory card and the phone memory. You cannot view the transferred files in your phone until you have removed the USB cable from the phone.

⚡ To safely disconnect the USB cable in File transfer mode, right-click the **Removable Disk** icon in Windows Explorer and select **Eject**.

⚡ More information about transferring files to your Walkman™ phone is available at www.sonyericsson.com/support.

Playlists

To organise the media files that are saved in File manager, you can create playlists.

To create a playlist

- 1 From standby select **Menu** > **WALKMAN** > **Options** > **My music** > **My playlists** > **New playlist**.
- 2 Enter a name and select **OK**.
- 3 Scroll to a track and select **OK**.

To add files to a playlist

- 1 From standby select **Menu** > **WALKMAN** > **Options** > **My music** > **My playlists**.
- 2 Scroll to a playlist and select **Options** > **Add media**.
- 3 Scroll to a track and select **OK**.

To remove files from a playlist

- 1 From standby select **Menu** > **WALKMAN** > **Options** > **My music** > **My playlists**.
- 2 Scroll to and select a playlist, then select **Open**.
- 3 Select the file and press **Options** > **Delete** > **Yes**.

There are several ways to control the Walkman™ player:

- Press **Power** to open or minimise the Walkman™ player during playback.
- Press **Next** to go to the next music file.
- Press **Previous** to go to the previous music file.
- Press and hold down **Next** or **Previous** to fast forward or rewind when playing music files.
- Press **Next** or **Previous** to view and scroll files in the current playlist during playback.
- Press **Next** to select a highlighted file in a list.
- When in Now playing, press **Back** to go to the main menu.
- Press and hold down **Power** to exit.

To play music

- 1 From standby press **Power**.
- 2 Browse for songs by artist, track, or in playlists. Scroll to a list and select **Open**.
- 3 Scroll to a title select **Play**.

PlayNow™

With PlayNow you can preview, buy and download music via the Internet. You can find PlayNow in **Menu** > **PlayNow™**.

⚡ You need the correct Internet settings in your phone to use this function. See **Internet** on page 32.

TrackID™

TrackID™ is a music recognition service. You can search for song titles, artists and album names.

⚡ You need the correct Internet settings in your phone to use this function. See **Internet** on page 32.

To search for song information

- 1 When you hear a song through a loudspeaker, from standby select **Menu** > **Entertainment** > **TrackID™** > **Start**.
- 2 When the radio is playing select **Options** > **TrackID™**.

Radio

⚡ Do not use your phone as a radio in places where it is prohibited.

To listen to the radio

- 1 Connect the handsfree to the phone.
- 2 From standby select **Menu** > **Radio**.

To control the radio

- Press **Next** or **Previous** to search for FM radio channels.

To save an FM radio channel

- Select **Options** > **Save**.
- Scroll to a position and press **Select**.

To listen to a saved FM radio channel

- When the FM radio is on, press **Next** - **Previous**.

To exit the FM radio

- 1 Select **Back** or press **Power**.
- 2 **Minimise radio?** appears. Select **No**.

To turn the FM radio off when minimised

- 1 Select **Menu** > **Radio**.
- 2 Select **Back** or press **Power**.
- 3 **Minimise radio?** appears. Select **No**.

To view FM radio options

- When the FM radio is on, select **Options**.

Imaging

Camera and video recorder

You can take pictures and record video clips to view, save or send. You can find your saved pictures and video clips in **Menu** > **File manager** > **Camera album**.

- 1 Zoom in or out
- 2 Take pictures/ Record video

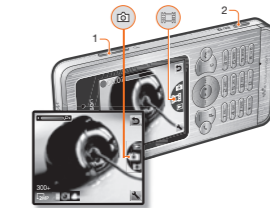

To take a picture

- 1 Press and hold down **Power** to activate the camera.
- 2 Press **Next** or **Previous** to scroll to **Picture**.
- 3 Press **Power** to take a picture. The picture is automatically saved on the memory card, if a memory card is inserted. If not, the picture is saved in the phone memory.

⚡ Do not record with a strong light source in the background.

⚡ To avoid a blurred picture, use a support or the self-timer.

To record a video clip

- 1 Press and hold down **Power** to activate the camera.
- 2 Press **Next** or **Previous** to scroll to **Video**.
- 3 Press **Power** fully down to start recording. The video clip is automatically saved on the memory card, if a memory card is inserted. If not, the video clip is saved in the phone memory.

To stop recording

- Press **Power**. The video clip is automatically saved on the memory card.

To zoom in or out

- Press the volume keys up or down.

To transfer pictures to and from your computer

You can use Bluetooth™ wireless technology and the USB cable to transfer pictures and video clips between your computer and phone. See **Bluetooth™** on page 30 and **To transfer files in Mass storage mode** on page 15 for more information.

Calling

You must turn on the phone and be within range of a network.

To make a call

- 1 From standby enter a phone number (with international country code and area code, if applicable).
- 2 Press **[Call]**.

You can call numbers from your contacts and call list. See **Contacts** on page 27, and **Call list** on page 23.

To end a call

- Press **[End Call]**.

To answer a call

- Press **[Call]**.

To reject a call

- Press **[End Call]**.

To change the ear speaker volume during a call

- Press the volume key up or down.

To turn the loudspeaker on during a call

- Select **Speaker**.

Do not hold the phone to your ear when using the loudspeaker. This could damage your hearing.

To make international calls

- 1 From standby press and hold down **[+]** until a + sign appears on the screen.
- 2 Enter the country code, area code (without the first zero) and phone number.
- 3 Press **[Call]**.

To view missed calls from standby

- When **Missed calls:** is displayed, select **View**. To call back scroll to the number and press **[Call]**.

Call list

You can view information about recent calls.

To call a number from the call list

- 1 From standby press **[Call]**.
- 2 Scroll to the name or number and press **[Call]**.

To delete a number from the call list

- 1 From standby press **[Call]**.
- 2 Scroll to the name or number and select **[Delete]** > **Yes**.

Speed dialling

Speed dialling lets you select nine contacts that you can dial quickly. The contacts can be saved in positions 2-9.

- ! Position 1 is set to the voicemail number.

To add contacts to speed dial numbers

- 1 From standby select **Menu** > **Settings** > the **Calls** tab > **Speed dial**.
- 2 Select a position number and press **[Add]**.
- 3 Enter a number or select **Contacts** > **OK**.
- 4 Scroll to a selection and select **OK** > **OK**.

To speed dial

- From standby press and hold the position number.

Emergency calls

Your phone supports international emergency numbers, for example, 112 and 911. These numbers can normally be used to make emergency calls in any country, with or without the SIM card inserted, if a GSM network is within range.

To make an emergency call

- From standby enter the international emergency number, for example, 112 and press **[Call]**.

In some countries, other emergency numbers may also be promoted. Your network operator may therefore have saved additional local emergency numbers on the SIM card.

Messaging

Text messages (SMS)

You must have a service centre number, which is supplied by your service provider and saved on the SIM card. You may have to enter the number yourself.

- ! Make sure you have a valid service centre number in your phone.

See **Entering text** on page 33.

To write and send a text message

- 1 From standby select **Menu** > **Messaging** > **Write new** > **Text message**.
- 2 Write the message and select **Cont.**
- 3 Select an option.
- 4 Select **OK** > **Send**.

To view a received text message

- 1 **New message from:** appears. Select **View**.
- 2 Select the unread message.

To view messages saved in the inbox

- Select **Menu** > **Messaging** > **Inbox**.

To get delivery status of a sent message

- 1 From standby select **Menu** > **Messaging** > **Settings** > **Text message** > **Delivery report**.
- 2 Select **On**. You will be notified when a message has been successfully delivered.

Picture messages (MMS)

Picture messages can contain text, sound and images. They are sent using MMS to a mobile phone. You need the correct Internet settings in your phone to use this function. See **Internet** on page 32.

To create a picture message

- 1 From standby select **Menu** > **Messaging** > **Write new** > **Picture msg.**
- 2 Select an option to create the message.

To send a picture message

- 1 When the message is ready, select **Cont.**
- 2 Select an option.
- 3 Select **OK** > **Send**.

Sending and receiving phones must have subscriptions that support picture messaging. Make sure you have a phone subscription that supports data transmission, and the correct settings in your phone.

Contacts

You can save contacts in the phone memory or on the SIM card. You can copy contacts from the phone memory to the SIM card or from the SIM card to the phone memory.

Default contacts

You can choose which contact information is shown as default. If Phone contacts is selected as default, your contacts show all the information saved in Contacts. If you select SIM contacts as default, your contacts show names and numbers saved on the SIM card.

To select default contacts

- 1 From standby select **Menu** > **Contacts** > **Options** > **More** > **Default contacts**.
- 2 Select an option.

See **Entering text** on page 33.

Phone contacts

Phone contacts can contain names, phone numbers and personal information. They are saved in the phone memory.

To add a phone contact

- 1 From standby select **Menu** > **Contacts** > **New contact**.
- 2 Scroll to **Last name:** and select **Add**.
- 3 Enter the name and select **OK**.
- 4 Scroll to **First name:** and select **Add**.
- 5 Enter the name and select **OK**.
- 6 Scroll to **New number:** and select **Add**.
- 7 Enter the number and select **OK**.
- 8 Select **Save**.

Enter the + sign and country code with all phonebook numbers. Then you can use them abroad or at home. See **To make international calls** on page 23.

To call a contact

- 1 From standby select **Menu** > **Contacts**.
- 2 Scroll to, or enter the first few letters of, the contact.
- 3 Press **[Call]**.

To edit a contact

- 1 From standby select **Menu** > **Contacts**.
- 2 Select a contact.
- 3 Select **Options** > **Edit contact**.
- 4 Edit the information and select **Save**.

22

23

24

25

26

27

28

Bluetooth™

To delete a contact

- 1 From standby select **Menu** > **Contacts**.
- 2 Select a contact.
- 3 Select **Options** > **Delete**.

To copy a contact to the SIM card

- 1 From standby select **Menu** > **Contacts**.
- 2 Scroll to a contact.
- 3 Select **Options** > **Options** > **Copy to SIM**.

To view your own phone number

- From standby select **Menu** > **Contacts** > **Options** > **My numbers**.

Contacts memory

The number of entries you can save in **Contacts** depends on the capacity of your SIM card.

To check the Contacts memory status

- From standby select **Menu** > **Contacts** > **Options** > **Memory status**.

Bluetooth™ wireless technology allows wireless connection to other Bluetooth devices, for example, a Bluetooth headset. You can connect to several devices at the same time or exchange items.

The recommended maximum distance between two Bluetooth devices is 10 metres (33 feet), with no solid objects in between.

To turn the Bluetooth function on

- From standby select **Menu** > **Settings** > the **Connectivity** tab > **Bluetooth** > **Turn on**.

Check if local laws or regulations restrict the use of Bluetooth wireless technology. If it is not allowed, you must ensure that the Bluetooth function is turned off.

To show or hide your phone

- From standby select **Menu** > **Settings** > the **Connectivity** tab > **Bluetooth** > **Visibility** > **Show phone** or **Hide phone**.

If the phone cannot be detected by other devices using Bluetooth wireless technology turn the Bluetooth function on. Make sure that the visibility is set to show phone. If set to hide, other devices will not be able to identify your phone using Bluetooth wireless technology.

29

30

31

32

33

34

35

Internet

You need the correct Internet settings in your phone. If the settings are not in your phone, you can:

- Get them in a text message from the network operator.
- On a computer, go to www.sonyericsson.com/support and request a text message with the settings.

Make sure you have a phone subscription that supports data transmission in your phone.

To select an Internet profile

- 1 From standby select **Menu** > **Internet** > **Internet settings** > **Accounts**.
- 2 Select an account.

To start browsing

- 1 From standby select **Menu** > **Internet**.
- 2 Select an option:

- **Homepage** – go to the predefined homepage.
- **Enter address** – enter a Web address.
- **Bookmarks** – go directly to a saved Web address.
- **History** – show previously visited pages.
- **Saved pages** – go directly to a saved Web page.
- **Internet settings** – select options such as accounts, connection time, white list.

To stop browsing

- When you are browsing, press and hold down **[Back]**.

More functions

Shortcuts

The shortcut menu gives you quick access to certain functions.

To open the shortcut menu

- Press **[Shortcut]**.

Entering text

There are two methods you can use to enter text: multitap or predictive text input.

By using predictive text input you only have to press each key once. Continue writing a word even if it appears to be wrong. The phone uses the dictionary to recognise the word when all letters are entered.

To enter text using predictive text input

- 1 For example, to write the word “Jane”, press **[J]**, **[A]**, **[N]**, **[E]**.
- 2 You now have several options:
 - If the word shown is the one you want, press **[Enter]** to accept and add a space. To accept a word without adding a space, press **[Space]**.
 - If the word shown is not the one you want, press **[Left]** or **[Right]** repeatedly to view alternative words. To accept a word and add a full space, press **[Space]**.
 - To enter full stops and commas, press **[Full Stop]** and then **[Comma]** repeatedly.

To enter text using multitap

- Press **[Letter]** – **[Letter]** until the character you want appears.
- Press **[Space]** to add a space.
- Press **[Full Stop]** to enter full stops and commas.
- Press **[Shift]** to shift between upper-case and lower-case letters.
- Press and hold down **[Number]** – **[Number]** to enter numbers.

To change text input methods

- When you write the message, press and hold down **[Input]**.

To add items in a text message

- When you write the message, select **Options** > **Insert item**.
- Select an option.

To delete characters

- Select **[Delete]**.

To change writing language

- When you write the message, press and hold down **[Language]**.

Automatic keypadlock

The keypad is locked after a short while.

To turn on the automatic keypadlock

- From standby select **Menu** > **Settings** > the **General** tab > **Security** > **Automatic keypadlock** > **On**.

Calls to the international emergency number 112 can still be made, even when the keypad is locked.

Voicemail

Callers can leave a voicemail message when you cannot answer. You can get your voicemail number from your network operator.

To enter your voicemail number

- 1 From standby select **Menu** > **Messaging** > **Settings** > **Voicemail no.**
- 2 Scroll to the voicemail number and select **OK**.
- 3 Enter the voicemail number that you get from your service provider and press **OK**.

To call your voicemail service

- From standby press and hold down **[Starkey]**.

Flight mode

In **Flight mode** the network and radio transceivers are turned off to prevent disturbance to sensitive equipment. When the flight mode menu is activated, you are asked to select a mode the next time you turn on your phone:

- **Normal** – full functionality.
- **Flight mode** – limited functionality. Only Walkman™ player.

To activate the flight mode menu

- From standby select **Menu** > **Settings** > the **General** tab > **Flight mode** > **Show at startup**.

www.sonyericsson.com

Sony Ericsson

Sony Ericsson Mobile Communications AB
SE-221 88 Lund, Sweden



1209-9241-9

Printed in XXXX

36

37

38

39

40

41

Declaration of conformity for W302

SIM card lock

Your PIN and PUK are supplied by your network operator.

If the message **Wrong PIN Attempts remaining:** appears when you edit your PIN, you entered the PIN or PIN2 incorrectly.

To unblock your SIM card

- 1 When **PIN blocked** is displayed, select **Unlock**.
- 2 Enter your PUK and select **OK**.
- 3 Enter a new PIN and select **OK**.
- 4 To confirm, re-enter the new PIN and select **OK**.

To turn on the SIM card lock

- 1 From standby select **Menu** > **Settings** > the **General** tab > **Security** > **Locks** > **SIM protection** > **Protection**.
- 2 Enter your PIN and select **OK**.
- 3 Select **On**.

To edit your PIN

- 1 From standby select **Menu** > **Settings** > the **General** tab > **Security** > **Locks** > **SIM protection** > **Change PIN**.
- 2 Enter your PIN and select **OK**.
- 3 Enter a new PIN and select **OK**.
- 4 To confirm, re-enter the new PIN and select **OK**.

Phone lock

The phone lock protects the phone against unauthorised use. You can change the phone lock code (0000 by default) to any four-digit code.

If the phone protection is set to **Off**, you do not need to enter your phone lock code unless a different SIM card is inserted in the phone.

To edit your phone lock code

- 1 From standby select **Menu** > **Settings** > the **General** tab > **Security** > **Locks** > **Phone protection** > **Change code**.
- 2 Enter the current code and select **OK**.
- 3 Enter a new code and select **OK**.
- 4 To confirm, re-enter the new code and select **OK**.

If you forget the new code, you have to take the phone to your local Sony Ericsson retailer.

To unlock the phone

- 1 From standby select **Menu** > **Settings** > the **General** tab > **Security** > **Locks** > **Phone protection** > **View code**.
- 2 Enter your phone lock code and select **OK**.
- 3 Select **Off**.

Master reset

If you experience problems with your phone, such as screen flickering, screen freezing, or navigation problems, you should reset the phone.

To reset the phone

- From standby select **Menu** > **Settings** > the **General** tab > **Reset all** > **Cont.** > **Cont.**

Reset all deletes all user data such as contacts, messages, pictures and sounds in your phone.

Restart your phone every day to free memory. Do a Master reset if you have problems with memory capacity or the phone is working slowly.

The Liquid Identity logo, PlayNow and TrackID are trademarks or registered trademarks of Sony Ericsson Mobile Communications AB. Sony, M2, Memory Stick Micro, and WALKMAN are trademarks or registered trademarks of Sony Corporation. Ericsson is a trademark or registered trademark of Telefonaktiebolaget LM Ericsson. All other trademarks are property of their respective owners. MPEG Layer-3 audio decoding technology licensed from Fraunhofer IIS and Thomson.

Export Regulations: This product, including any software or technical data contained in or accompanying the product, may be subject to U.S. export control laws, including the U.S. Export Administration Act and its associated regulations and the U.S. sanctions programs administered by the U.S. Treasury Department's Office of Foreign Assets Control, and may be additionally subject to export or import regulations in other countries. The user and any possessor of the product agrees to comply strictly with all such regulations and acknowledges that it is their responsibility to obtain any required licenses to export, re-export, or import this product. Without limitation this product, including any software contained therein, may not be downloaded, or otherwise exported or re-exported (i) into, or to a national or resident of, or an entity in, Cuba, Iraq, Iran, North Korea, Sudan, Syria (as such listing may be revised from time to time) or any country to which the U.S. has embargoed goods; and (ii) to any person or entity on the U.S. Treasury Department's list of Specially Designated Nationals or (iii) any person or entity on any other export prohibition list that may be maintained from time to time by the United States Government, including but not limited to the U.S. Commerce Department's Denied Persons List or Entity List, or the U.S. State Department's Nonproliferation Sanctions List.

We, Sony Ericsson Mobile Communications AB of Nyvattentorget SE-221 88 Lund, Sweden declare under our sole responsibility that our product Sony Ericsson type AAC-1052091-BV and in combination with our accessories, to which this declaration relates is in conformity with the appropriate standards EN 301 511-V9.0.2, EN 300 328-V1.7.1, EN 301 489-V1.3.1, EN 301 489-V1.2.1 and EN 60950-1:2006, following the provisions of, Radio Equipment and Telecommunication Terminal Equipment Directive 1999/5/EC, Lund, March 2008.

Shoji Nemoto, Head of Product Business Unit GSM/UMTS We fulfil the requirements of the R&TTE Directive (1999/5/EC).

FCC Statement
This device complies with Part 15 of the FCC rules. Operation is subject to the following two conditions:
(1) This device may not cause harmful interference, and
(2) This device must accept any interference received, including interference that may cause undesired operation.
Any change or modification not expressly approved by Sony Ericsson may void the user's authority to operate the equipment. This equipment generates, uses and can radiate radio frequency energy and, if not installed and used in accordance with the instructions, may cause harmful interference to radio communications. However, there is no guarantee that interference will not occur in a particular installation. If this equipment does cause harmful interference to radio or television reception, which can be determined by turning the equipment off and on, the user is encouraged to try to correct the interference by one or more of the following measures:
- Reorient or relocate the receiving antenna.
- Increase the separation between the equipment and receiver.
- Connect the equipment into an outlet on a circuit different from that to which the receiver is connected.
- Consult the dealer or an experienced radio/TV technician for help.

Industry Canada Statement
This device complies with RSS-210 of Industry Canada. Operation is subject to the following two conditions: (1) this device may not cause interference, and (2) this device must accept any interference, including interference that may cause undesired operation of the device. This Class B digital apparatus complies with Canadian ICES-003. Cet appareil numérique de la classe B est conforme à la norme NMB-003 du Canada.
Sony Ericsson W302 GSM 850/900/1800/190

Sony Ericsson

Important information

Sony Ericsson Consumer Web site

On www.sonyericsson.com/support there is a support section where help and tips are on a few clicks away. Here you will find the latest computer software updates and tips on how to use your product more efficiently.

Service and support

You have access to a portfolio of exclusive service advantages such as:

- Global and local Web sites providing support
- A global network of Call Centers
- An extensive network of Sony Ericsson service partners
- A warranty portal to learn more about the warranty conditions in its User guide.

On www.sonyericsson.com, you will find the latest support tools and information. For operator-specific services and features, please contact your network operator. You can also contact our Call Centers. If your country/region is not represented in the list below, please contact your local dealer. (Calls are charged according to national rates, including local taxes and/or a toll-free number). If you have a problem with your phone, you need service, please contact the dealer from whom it was purchased, or one of our service partners. For warranty claims, save proof of purchase.

Guidelines for Safe and Efficient Use

Please follow these guidelines. Failure to do so might entail a potential health risk or product malfunction. If in doubt as to how to properly function, have the product checked by a certified service partner before charging or using it.

Recommendations for care and safe use of our products

- Handle with care and keep in a clean and dust-free place.
- Warning! May contain mercury. Do not dispose of in household waste.
- Do not expose your product to liquid or moisture or excess humidity.
- Do not expose to extreme temperatures. Do not expose the battery to temperatures above +60°C (+140°F).
- Do not use the battery or to lit tobacco products.
- Do not drop, throw or try to bend your product.
- Do not paint or attempt to disassemble or modify your product. Only Sony Ericsson authorized personnel should perform service.
- Consult with authorized medical staff and the instructions of the medical device manufacturer before using your product near pacemakers or other medical devices or equipment.
- Discontinue use of electronic device or disable the radio transmitting functionality if the device when used causes interference with other electronic equipment.
- Do not use where a potentially explosive atmosphere exists.
- Do not place your product or install wireless equipment in the area above an air bag in your car.
- Do not use a cracked or broken displays may create sharp edges or splinters that could be harmful upon contact.
- Do not use your Bluetooth Headset in positions where it is uncomfortable or will be subjected to pressure.

Important information
Wichtige Informationen
Informazioni importanti
Belangrijke informatie

Informations importantes

Informazioni importanti

Informations importantes

Informazioni importanti

Informations importantes

Informazioni importanti

Informations importantes

Informazioni importanti

Informations importantes

Informazioni importanti

Informations importantes

Informazioni importanti

Informations importantes

Informazioni importanti

Informations importantes

Informazioni importanti

Informations importantes

Informazioni importanti

Informations importantes

Informazioni importanti

Informations importantes

Informazioni importanti

Informations importantes

Informazioni importanti

Informations importantes

Informazioni importanti

Informations importantes

Informazioni importanti

Informations importantes

Informazioni importanti

Informations importantes

Informazioni importanti

Informations importantes

Informazioni importanti

Informations importantes

Informazioni importanti

Informations importantes

Informazioni importanti

Informations importantes

Informazioni importanti

Informations importantes

Informazioni importanti

Informations importantes

Informazioni importanti

Informations importantes

Informazioni importanti

Informations importantes

Informazioni importanti

Informations importantes

Informazioni importanti

Informations importantes

Informazioni importanti

Informations importantes

Informazioni importanti

Informations importantes

Informazioni importanti

Informations importantes

Informazioni importanti

Informations importantes

Informazioni importanti

Informations importantes

Informazioni importanti

Informations importantes

Informazioni importanti

Informations importantes

Informazioni importanti

Informations importantes

Informazioni importanti

Informations importantes

Informazioni importanti

Informations importantes

Informazioni importanti

Informations importantes

Informazioni importanti

Informations importantes

Informazioni importanti

Informations importantes

Informazioni importanti

Informations importantes

Informazioni importanti

Informations importantes

Informazioni importanti

Informations importantes

Informazioni importanti

Informations importantes

Informazioni importanti

Informations importantes

Informazioni importanti

Informations importantes

Informazioni importanti

Informations importantes

Informazioni importanti

Informations importantes

Informazioni importanti

Informations importantes

Informazioni importanti

Informations importantes

Informazioni importanti

Informations importantes

Informazioni importanti

Informations importantes

Informazioni importanti

Informations importantes

Informazioni importanti

Informations importantes

Informazioni importanti

Informations importantes

Informazioni importanti

Informations importantes

Informazioni importanti

Informations importantes

Informazioni importanti

Informations importantes

Informazioni importanti

Informations importantes

Informazioni importanti

Informations importantes

Informazioni importanti

Informations importantes

Informazioni importanti

Informations importantes

Informazioni importanti

Informations importantes

Informazioni importanti

Informations importantes

Informazioni importanti

Informations importantes

Informazioni importanti

Informations importantes

Informazioni importanti

Informations importantes

Informazioni importanti

Informations importantes

Informazioni importanti

Informations importantes

Informazioni importanti

Informations importantes

Informazioni importanti

Informations importantes

Informazioni importanti

Informations importantes

Informazioni importanti

Informations importantes

Informazioni importanti

Informations importantes

Informazioni importanti

Informations importantes

Informazioni importanti

Informations importantes

Informazioni importanti

Informations importantes

Informazioni importanti

Informations importantes

Informazioni importanti

Informations importantes

Informazioni importanti

Informations importantes

Informazioni importanti

Informations importantes

Informazioni importanti

Informations importantes

Informazioni importanti

Informations importantes

Informazioni importanti

Informations importantes

Informazioni importanti

Informations importantes

Informazioni importanti

Informations importantes

Informazioni importanti

Informations importantes

Informazioni importanti

Informations importantes

Informazioni importanti

Informations importantes

Informazioni importanti

Informations importantes

Informazioni importanti

Informations importantes

Informazioni importanti

Informations importantes

Informazioni importanti

Informations importantes

Informazioni importanti

Informations importantes

Informazioni importanti

Informations importantes

Informazioni importanti

Informations importantes

Informazioni importanti

Informations importantes

Informazioni importanti

Informations importantes

Informazioni importanti

Informations importantes

Informazioni importanti

Informations importantes

Informazioni importanti

Informations importantes

Informazioni importanti

Informations importantes

Informazioni importanti

Informations importantes

Informazioni importanti

Informations importantes

Informazioni importanti

Informations importantes

Informazioni importanti

Informations importantes

Informazioni importanti

Informations importantes

Informazioni importanti

Informations importantes

Informazioni importanti

Informations importantes

Informazioni importanti

Informations importantes

Informazioni importanti

Informations importantes

Informazioni importanti

Informations importantes

Informazioni importanti

Informations importantes

Informazioni importanti

Informations importantes

Informazioni importanti

Informations importantes

Informazioni importanti

Informations importantes

Informazioni importanti

Informations importantes

Informazioni importanti

Informations importantes

Informazioni importanti

Informations importantes

Informazioni importanti

Informations importantes

Informazioni importanti

Informations importantes

Informazioni importanti

Informations importantes

Informazioni importanti

Informations importantes

Informazioni importanti

Informations importantes

Informazioni importanti

Informations importantes

Informazioni importanti

Informations importantes

Informazioni importanti

Informations importantes

Informazioni importanti

Informations importantes

Informazioni importanti

Informations importantes

Informazioni importanti

Informations importantes

Informazioni importanti

Informations importantes

Informazioni importanti

Informations importantes

