

SIM card

Thank you for purchasing a Sony Ericsson S302. For additional phone content, go to www.sonyericsson.com/fun. Register now to get free online storage and special offers at www.sonyericsson.com/myphone. For product support, go to www.sonyericsson.com/support.

Instruction symbols

The following appear in this User guide:

- > Use the navigation key to scroll and select

- Press the centre selection key
- ⬆️ Press the navigation key up
- ⬇️ Press the navigation key down
- ⬅️ Press the navigation key to the left
- ➡️ Press the navigation key to the right

! Note

💡 Tip

⚠️ Warning

📶 Indicates that a service or function is network- or subscription-dependent. All menus or functions may not be available in your phone. Consult your network operator for more information.

The SIM (Subscriber Identity Module) card, which you get from your network operator, contains information about your subscription. Always turn off your phone and detach the charger and the battery before you insert or remove the SIM card.

💡 You can save contacts on the SIM card before removing it from your phone. You can also save contacts in the phone memory. See *Contacts* on page 22.

PIN code (SIM card lock)

The PIN (Personal Identification Number) code is a SIM card lock that protects your subscription, but not the phone itself. If the card is locked, you have to enter the PIN code when you turn on your phone. To change your PIN code, see *SIM card lock* on page 36.

Each PIN digit appears as *, unless it starts with emergency number digits, for example, 112 or 911. You can call an emergency number without entering a PIN.

! If you enter the wrong PIN three times in a row, **PIN blocked** appears. To unblock it, you need to enter your PUK (Personal Unblocking Key).

Charging the battery



The phone battery is partly charged when you buy it. It takes approximately 2.5 hours to fully charge the battery.

To charge the battery

- 1 Connect the charger to the phone with the power icon on the charger facing upwards. Press a key to illuminate the screen and see the charging status.
- 2 To remove the charger, lift and pull the plug upwards.

! The battery icon on the screen may not appear until the phone has charged for 30 minutes.

💡 You can use the phone during charging. You can charge the battery for more or less than 2.5 hours. Interrupted charging will not damage the battery.

Memory Stick Micro™

Your phone supports Memory Stick Micro™ (M2™). A memory card adds more storage space to your phone, for example, music, ringtones, video clips and pictures. You can share your saved information by moving or copying it to other memory card compatible devices.

To insert Memory Stick Micro™ (M2™)

- Open the cover and insert the memory card (with the gold-coloured contacts facing down).



To remove a Memory Stick Micro™ (M2™)

- Press the edge to release and remove.

Turning on the phone

To turn on the phone

- 1 Press and hold down (⏻).
- 2 Enter your SIM card PIN, if requested.
- 3 Select **Yes** to use the setup wizard.

! If you make a mistake when you enter your PIN, you can press (⏻) to delete numbers from the screen.

Standby

After you have turned on the phone and entered your PIN, the name of your operator appears on the screen. This is called standby. You can now make and receive calls.

To turn the phone off

- Press and hold down (⏻).

! If your phone cannot turn on, attach the charger and charge the phone for 2.5 hours.

💡 If your phone turns itself off when being transported, turn the automatic keylock on. This prevents things in your pocket or bag from activating the on/off key accidentally.

Network coverage



The network bars show the strength of the GSM network in your area. Move to another location if you have problems calling and network coverage is poor. **No network** means you are not in range of a network.

📶 = Good network coverage

📶 = Average network coverage

Battery status

🔋 = The phone battery is fully charged

🔋 = The phone battery is empty

! If you cannot turn on the phone, attach the charger properly and try charging the phone until it has finished charging.

Screen icons

These icons may appear on the screen.

Icon	Description
	Ongoing call
	Missed call
	Handsfree connected
	Phone set to silent
	Predictive text input activated
	Text message received
	Picture message received
	Email message received
	Voice message received
	FM radio playing
	Alarm activated
	Bluetooth function activated

Phone overview



8

Key

	Go to the main menus or select items
	Scroll between the menus and tabs
	Select options shown immediately above these keys on the screen
	Delete items, such as pictures, sounds and contacts.
	On the side: Press to stop or play music when in the Music player mode Press to mute or unmute the radio. Works only if an audio accessory is connected Press to move between the Music player and standby
	My shortcuts – add your favourite functions to access them quickly
	From standby press to activate Camera and video recorder
	Press and hold down to turn the phone on/off Press to end a call
	Press to make a call after you gave entered the phone number

9

Navigation

The main menus are shown as icons. Some submenus include tabs.

To navigate the phone menus

- 1 From standby select **Menu**.
- 2 Use the navigation key to move through the menus.

To scroll between the tabs

- Press the navigation key left or right.

To go back one step in the menu

- Select **Back**.

To return to standby

- Press (⏻).

To lock the keypad

- Press (⏻) and select **Lock**.

To unlock the keypad

- Press (⏻) and select **Unlock**.

To set the phone to silent

- Press and hold down (⏻).

To call your voicemail service

- Press and hold down (1234).

To end a function

- Press (⏻).

Menu overview

	Homepage, Enter address, Bookmarks, History, Saved pages, Internet settings
	Games, TrackID™, Video player, Record sound
	Write new, Inbox, Email, Drafts, Outbox, Sent messages, Call voicemail, Templates, Settings
	Music player
	File manager** All files, On mem. card, In phone
	Contacts New contact
	Radio
	Calls**
	All Dialed Missed Answered
	Alarm, Applications, Calendar, Tasks, Synchronisation, Timer, Stopwatch, Light, Calculator

11

Settings**

	General Profiles Time & date Phone language Shortcuts Flight mode Security Phone status Reset all
	Sounds & alerts Ringtone Ringtone Silent mode Vibrating alert Message alert Key sound
	Display Wallpaper Themes Startup screen Screen saver Brightness
	Calls Speed dial Divert calls Manage calls Time & cost* Show/hide no. Handsfree
	Connectivity Bluetooth USB Synchronisation Mobile networks Internet settings

*Some menus are operator-, network- and subscription-dependent.
** You can use the navigation key to scroll between tabs in submenus. For more information, see *Navigation* on page 11.

12

Radio

! Do not use your phone as a radio in places where it is prohibited.

To listen to the radio

- 1 Connect the handsfree to the phone.
- 2 From standby select **Menu** > **Radio**.

To control the radio

- Press (⏻) or (⏻) to search for FM radio channels.

To save an FM radio channel

- Select **Options** > **Save**.
- Scroll to a position and press **Select**.

To listen to a saved FM radio channel

- When the FM radio is on, press (⏻) – (9).

To exit the FM radio

- 1 Select **Back** or press (⏻).
- 2 **Minimise radio?** appears. Select **No**.

To turn the FM radio off when minimised

- 1 Select **Menu** > **Radio**.
- 2 Select **Back** or press (⏻).
- 3 **Minimise radio?** appears. Select **No**.

To view FM radio options

- When the FM radio is on, select **Options**.

Imaging

Camera and video recorder

You can take pictures and record video clips to view, save or send. You can find your saved pictures and video clips in **Menu** > **File manager** > **Camera album**.

- 1 Zoom in or out, works only in VGA mode
- 2 Press to take another picture
- 3 Take pictures/Record video clips
- 4 Screen options

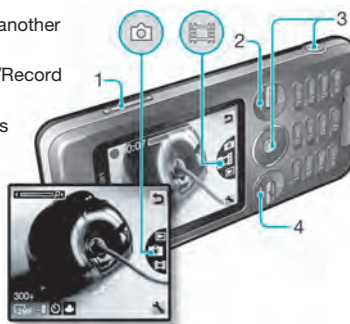

To take a picture

- 1 Activate the camera.
- 2 Use the navigation key to select
- 3 Press (⏻) to take a picture.
- 4 Select to take another picture.

To use the zoom

- Press the volume keys up or down.

! Do not record with a strong light source in the background. Use a support or the self-timer to avoid a blurred picture.

! When taking a picture, zoom is available in VGA mode only.

Camera settings

You can select different settings before you take a picture or record a video clip.

- 1 When the camera is activated, select
- 2 Use the navigation key to select camera settings.

! To use the camera light you must turn it on manually. To stop using the camera light you turn it off manually.

To record a video clip

- 1 Activate the camera.
- 2 Use the navigation key to select
- 3 Press (⏻) fully down to start recording. The video clip is automatically saved on the memory card, if a memory card is inserted. If not, the video clip is saved in the phone memory.

To stop recording

- Press (⏻). The video clip is automatically saved on the memory card.

15

To delete pictures and video clips

- 1 From standby select **Menu** > **File manager** > **Camera album**.
- 2 Scroll to an item and press (⏻).

Photo fix

You can improve an under-exposed picture with Photo fix.

To improve a picture with Photo fix

- 1 Activate the camera.
- 2 Take a picture.
- 3 Find the picture in **Camera album**.
- 4 Select **Options** > **Photo fix**.

Picture blog

A picture blog is a personal Web page. If your subscription supports this service, you can send pictures to a blog.

! Web services may require a separate license agreement between you and the service provider. Additional regulations and/or charges may apply. Contact your service provider.

To send camera pictures to a blog

- 1 From standby select **Menu** > **File manager** > **Camera album**.
- 2 Scroll to a picture and select **Options** > **Send** > **To blog**.
- 3 Add title and select **Edit**.
- 4 Add text and select **Edit**.
- 5 Select **OK** > **Publish**.

16

To go to a blog address from contacts

- 1 From standby select **Menu** > **Contacts**.
- 2 Select a contact.
- 3 Scroll to a Web address and select **Go to**.

To transfer pictures to and from your computer

You can use Bluetooth™ wireless technology and the USB cable to transfer pictures and video clips between your computer and phone. See *Bluetooth™* on page 31 and *To transfer files* on page 26 for more information.

Pictures and video clips

You can add a picture of a contact, use it during phone-start up, as a wallpaper in standby or as a screen saver.

To use pictures

- 1 From standby select **Menu** > **File manager** > **Pictures**.
- 2 Scroll to a picture and select **Options** > **Use as**.
- 3 Select an option.

! Make sure the receiving device supports the transfer method you select.

17

Calling

You must turn on the phone and be within range of a network.

To make a call

- 1 From standby enter a phone number (with international country code and area code, if applicable).
- 2 Press (⏻).

💡 You can call numbers from your contacts and call list. See *Contacts* on page 22, and *Call list* on page 20.

To end a call

- Press (⏻).

To answer a call

- Press (⏻).

To reject a call

- Press (⏻).

To change the ear speaker volume during a call

- Press the volume key up or down.

To turn the loudspeaker on during a call

- Select **Speaker**.

! Do not hold the phone to your ear when using the loudspeaker. This could damage your hearing.

18

To make international calls

- 1 From standby press and hold down (⏻) until a + sign appears on the screen.
- 2 Enter the country code, area code (without the first zero) and phone number.
- 3 Press (⏻).

To view missed calls from standby

- When **Missed calls:** is displayed, select **View**. To call back scroll to the number and press (⏻).

Call list

You can view information about recent calls.

To call a number from the call list

- 1 From standby press (⏻).
- 2 Scroll to the name or number and press (⏻).

To delete a number from the call list

- 1 From standby press (⏻).
- 2 Scroll to the name or number and press (⏻) > **Yes**.

19

You need the correct Internet settings in your phone. If the settings are not in your phone, you can:

- Get them in a text message from the network operator.
- On a computer, go to www.sonyericsson.com/support and request a text message with the settings.

To select an Internet profile

- 1 From standby select **Menu** > **Internet** > **Internet settings** > **Accounts**.
- 2 Select an account.

To start browsing

- 1 From standby select **Menu** > **Internet**.
- 2 Select an option:

Homepage – go to the predefined homepage.

Enter address – enter a Web address.

Bookmarks – go directly to a saved Web page.

History – show previously visited pages.

Saved pages – go directly to a saved Web page.

Internet settings – select options such as accounts, connection time, White list.

To stop browsing

- When you are browsing, press and hold down (⏻).

20

