

SIM card

Thank you for purchasing a Sony Ericsson S302. For additional phone content, go to www.sonyericsson.com/fun. Register now to get free online storage and special offers at www.sonyericsson.com/myphone. For product support, go to www.sonyericsson.com/support.

Instruction symbols

The following appear in this User guide:

> Use the navigation key to scroll and select

- Press the centre selection key
- ⬆ Press the navigation key up
- ⬇ Press the navigation key down
- ⬅ Press the navigation key to the left
- ➡ Press the navigation key to the right

! Note

💡 Tip

⚠ Warning

📶 Indicates that a service or function is network- or subscription-dependent. All menus or functions may not be available in your phone. Consult your network operator for more information.

The SIM (Subscriber Identity Module) card, which you get from your network operator, contains information about your subscription. Always turn off your phone and detach the charger and the battery before you insert or remove the SIM card.

💡 You can save contacts on the SIM card before removing it from your phone. You can also save contacts in the phone memory. See *Contacts* on page 22.

PIN code (SIM card lock)

The PIN (Personal Identification Number) code is a SIM card lock that protects your subscription, but not the phone itself. If the card is locked, you have to enter the PIN code when you turn on your phone. To change your PIN code, see *SIM card lock* on page 36.

Each PIN digit appears as *, unless it starts with emergency number digits, for example, 112 or 911. You can call an emergency number without entering a PIN.

! If you enter the wrong PIN three times in a row, **PIN blocked** appears. To unblock it, you need to enter your PUK (Personal Unblocking Key).

Charging the battery



The phone battery is partly charged when you buy it. It takes approximately 2.5 hours to fully charge the battery.

To charge the battery

- 1 Connect the charger to the phone with the power icon on the charger facing upwards. Press a key to illuminate the screen and see the charging status.
- 2 To remove the charger, lift and pull the plug upwards.

! The battery icon on the screen may not appear until the phone has charged for 30 minutes.

💡 You can use the phone during charging. You can charge the battery for more or less than 2.5 hours. Interrupted charging will not damage the battery.

Memory Stick Micro™

Your phone supports Memory Stick Micro™ (M2™). A memory card adds more storage space to your phone, for example, music, ringtones, video clips and pictures. You can share your saved information by moving or copying it to other memory card compatible devices.

To insert Memory Stick Micro™ (M2™)

• Open the cover and insert the memory card (with the gold-coloured contacts facing down).



To remove a Memory Stick Micro™ (M2™)

• Press the edge to release and remove.

Turning on the phone

To turn on the phone

- 1 Press and hold down (⏻).
- 2 Enter your SIM card PIN, if requested.
- 3 Select **Yes** to use the setup wizard.

! If you make a mistake when you enter your PIN, you can press (⏻) to delete numbers from the screen.

Standby

After you have turned on the phone and entered your PIN, the name of your operator appears on the screen. This is called standby. You can now make and receive calls.

To turn the phone off

• Press and hold down (⏻).

! If your phone cannot turn on, attach the charger and charge the phone for 2.5 hours.

💡 If your phone turns itself off when being transported, turn the automatic keylock on. This prevents things in your pocket or bag from activating the on/off key accidentally.

Network coverage



The network bars show the strength of the GSM network in your area. Move to another location if you have problems calling and network coverage is poor. **No network** means you are not in range of a network.

📶 = Good network coverage

📶 = Average network coverage

Battery status

🔋 = The phone battery is fully charged

🔋 = The phone battery is empty

! If you cannot turn on the phone, attach the charger properly and try charging the phone until it has finished charging.

Screen icons

These icons may appear on the screen.

Icon	Description
	Ongoing call
	Missed call
	Handsfree connected
	Phone set to silent
	Predictive text input activated
	Text message received
	Picture message received
	Email message received
	Voice message received
	FM radio playing
	Alarm activated
	Bluetooth function activated

Phone overview



Key

	Go to the main menus or select items
	Scroll between the menus and tabs
	Select options shown immediately above these keys on the screen
	Delete items, such as pictures, sounds and contacts.
	On the side: Press to stop or play music when in the Music player mode Press to mute or unmute the radio. Works only if an audio accessory is connected Press to move between the Music player and standby
	My shortcuts – add your favourite functions to access them quickly
	From standby press to activate Camera and video recorder
	Press and hold down to turn the phone on/off Press to end a call
	Press to make a call after you gave entered the phone number

Navigation

The main menus are shown as icons. Some submenus include tabs.

To navigate the phone menus

- 1 From standby select **Menu**.
- 2 Use the navigation key to move through the menus.

To scroll between the tabs

• Press the navigation key left or right.

To go back one step in the menu

• Select **Back**.

To return to standby

• Press (⏻).

To lock the keypad

• Press (⏻) and select **Lock**.

To unlock the keypad

• Press (⏻) and select **Unlock**.

To set the phone to silent

• Press and hold down (⏻).

To call your voicemail service

• Press and hold down (1234).

To end a function

• Press (⏻).

Menu overview

	Homepage, Enter address, Bookmarks, History, Saved pages, Internet settings
	Games, TrackID™, Video player, Record sound
	Write new, Inbox, Email, Drafts, Outbox, Sent messages, Call voicemail, Templates, Settings
	Music player
	File manager** All files, On mem. card, In phone
	Contacts New contact
	Radio
	Calls**
	All Dialed Missed Answered
	Alarm, Applications, Calendar, Tasks, Synchronisation, Timer, Stopwatch, Light, Calculator

Settings**

General Profiles	Sounds & alerts	Display
Time & date	Ringtone	Wallpaper
Phone language	Silent mode	Themes
Shortcuts	Vibrating alert	Startup screen
Flight mode	Message alert	Screen saver
Security	Key sound	Brightness
Phone status		
Reset all		
Calls	Connectivity	
Speed dial	Bluetooth	
Divert calls	USB	
Manage calls	Synchronisation	
Time & cost*	Mobile networks	
Show/hide no. Handsfree	Internet settings	

*Some menus are operator-, network- and subscription-dependent.
** You can use the navigation key to scroll between tabs in submenus. For more information, see *Navigation* on page 11.

Radio

! Do not use your phone as a radio in places where it is prohibited.

To listen to the radio

- 1 Connect the handsfree to the phone.
- 2 From standby select **Menu** > **Radio**.

To control the radio

• Press (⏻) or (⏻) to search for FM radio channels.

To save an FM radio channel

- Select **Options** > **Save**.
- Scroll to a position and press **Select**.

To listen to a saved FM radio channel

• When the FM radio is on, press (⏻) – (9).

To exit the FM radio

- 1 Select **Back** or press (⏻).
- 2 **Minimise radio?** appears. Select **No**.

To turn the FM radio off when minimised

- 1 Select **Menu** > **Radio**.
- 2 Select **Back** or press (⏻).
- 3 **Minimise radio?** appears. Select **No**.

To view FM radio options

• When the FM radio is on, select **Options**.

Imaging

Camera and video recorder

You can take pictures and record video clips to view, save or send. You can find your saved pictures and video clips in **Menu** > **File manager** > **Camera album**.

- 1 Zoom in or out, works only in VGA mode
- 2 Press to take another picture
- 3 Take pictures/Record video clips
- 4 Screen options

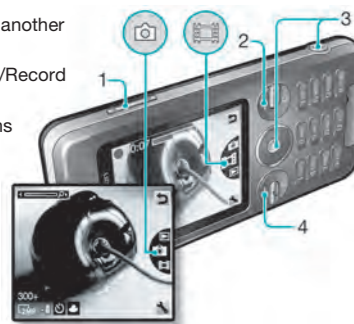

To take a picture

- 1 Activate the camera.
- 2 Use the navigation key to select
- 3 Press (⏻) to take a picture.
- 4 Select to take another picture.

To use the zoom

• Press the volume keys up or down.

! Do not record with a strong light source in the background. Use a support or the self-timer to avoid a blurred picture.

! When taking a picture, zoom is available in VGA mode only.

Camera settings

You can select different settings before you take a picture or record a video clip.

- 1 When the camera is activated, select
- 2 Use the navigation key to select camera settings.

! To use the camera light you must turn it on manually. To stop using the camera light you turn it off manually.

To record a video clip

- 1 Activate the camera.
- 2 Use the navigation key to select
- 3 Press (⏻) fully down to start recording. The video clip is automatically saved on the memory card, if a memory card is inserted. If not, the video clip is saved in the phone memory.

To stop recording

• Press (⏻). The video clip is automatically saved on the memory card.

To delete pictures and video clips

- 1 From standby select **Menu** > **File manager** > **Camera album**.
- 2 Scroll to an item and press (⏻).

Photo fix

You can improve an under-exposed picture with Photo fix.

To improve a picture with Photo fix

- 1 Activate the camera.
- 2 Take a picture.
- 3 Find the picture in **Camera album**.
- 4 Select **Options** > **Photo fix**.

Picture blog

A picture blog is a personal Web page. If your subscription supports this service, you can send pictures to a blog.

! Web services may require a separate license agreement between you and the service provider. Additional regulations and/or charges may apply. Contact your service provider.

To send camera pictures to a blog

- 1 From standby select **Menu** > **File manager** > **Camera album**.
- 2 Scroll to a picture and select **Options** > **Send** > **To blog**.
- 3 Add title and select **Edit**.
- 4 Add text and select **Edit**.
- 5 Select **OK** > **Publish**.

To go to a blog address from contacts

- 1 From standby select **Menu** > **Contacts**.
- 2 Select a contact.
- 3 Scroll to a Web address and select **Go to**.

To transfer pictures to and from your computer

You can use Bluetooth™ wireless technology and the USB cable to transfer pictures and video clips between your computer and phone. See *Bluetooth™* on page 31 and *To transfer files* on page 26 for more information.

Pictures and video clips

You can add a picture of a contact, use it during phone-start up, as a wallpaper in standby or as a screen saver.

To use pictures

- 1 From standby select **Menu** > **File manager** > **Pictures**.
- 2 Scroll to a picture and select **Options** > **Use as**.
- 3 Select an option.

! Make sure the receiving device supports the transfer method you select.

Calling

You must turn on the phone and be within range of a network.

To make a call

- 1 From standby enter a phone number (with international country code and area code, if applicable).
- 2 Press (⏻).

💡 You can call numbers from your contacts and call list. See *Contacts* on page 22, and *Call list* on page 20.

To end a call

• Press (⏻).

To answer a call

• Press (⏻).

To reject a call

• Press (⏻).

To change the ear speaker volume during a call

• Press the volume key up or down.

To turn the loudspeaker on during a call

• Select **Speaker**.

! Do not hold the phone to your ear when using the loudspeaker. This could damage your hearing.

To make international calls

- 1 From standby press and hold down (⏻) until a + sign appears on the screen.
- 2 Enter the country code, area code (without the first zero) and phone number.
- 3 Press (⏻).

To view missed calls from standby

• When **Missed calls:** is displayed, select **View**. To call back scroll to the number and press (⏻).

Call list

You can view information about recent calls.

To call a number from the call list

- 1 From standby press (⏻).
- 2 Scroll to the name or number and press (⏻).

To delete a number from the call list

- 1 From standby press (⏻).
- 2 Scroll to the name or number and press (⏻) > **Yes**.

You need the correct Internet settings in your phone. If the settings are not in your phone, you can:
• Get them in a text message from the network operator.
• On a computer, go to www.sonyericsson.com/support and request a text message with the settings.

To select an Internet profile

- 1 From standby select **Menu** > **Internet** > **Internet settings** > **Accounts**.
- 2 Select an account.

To start browsing

- 1 From standby select **Menu** > **Internet**.
- 2 Select an option:
Homepage – go to the predefined homepage.
Enter address – enter a Web address.
Bookmarks – go directly to a saved Web page.
History – show previously visited pages.
Saved pages – go directly to a saved Web page.
Internet settings – select options such as accounts, connection time, White list.

To stop browsing

• When you are browsing, press and hold down (⏻).

Contacts

You can save contacts in the phone memory or on the SIM card. You can copy contacts from the phone memory to the SIM card or from the SIM card to the phone memory.

Default contacts

You can choose which contact information is shown as default. If Phone contacts is selected as default, your contacts show all the information saved in Contacts. If you select SIM contacts as default, your contacts show names and numbers saved on the SIM card.

To select default contacts

- 1 From standby select **Menu > Contacts > Options > More > Default contacts.**
- 2 Select an option.

☞ See *Entering text on page 33.*

Contacts memory

The number of entries you can save in **Contacts** depends on the capacity of your SIM card.

To check the Contacts memory status

- From standby select **Menu > Contacts > Options > Memory status.**

Phone contacts

Phone contacts can contain names, phone numbers and personal information. They are saved in the phone memory.

To add a phone contact

- 1 From standby select **Menu > Contacts > New contact.**
- 2 Scroll to **Last name:** and select **Add.**
- 3 Enter the name and select **OK.**
- 4 Scroll to **First name:** and select **Add.**
- 5 Enter the name and select **OK.**
- 6 Scroll to **New number:** and select **Add.**
- 7 Enter the number and select **OK.**
- 8 Select **Save.**

☞ Enter the + sign and country code with all phonebook numbers. Then you can use them abroad or at home. See *To make international calls on page 20.*

To call a contact

- 1 From standby select **Menu > Contacts.**
- 2 Scroll to, or enter the first few letters of, the contact.
- 3 Press **(F).**

To edit a contact

- 1 From standby select **Menu > Contacts.**
- 2 Select a contact.
- 3 Select **Options > Edit contact.**
- 4 Edit the information and select **Save.**

To delete a contact

- 1 From standby select **Menu > Contacts.**
- 2 Select a contact.
- 3 Select **Options > Delete.**

To copy contacts to the SIM card

- 1 From standby select **Menu > Contacts.**
- 2 Scroll to a contact.
- 3 Select **Options > Options > Copy to SIM.**

To view your own phone number

- From standby select **Menu > Contacts > Options > My numbers.**

Emergency calls

Your phone supports international emergency numbers, for example, 112 and 911. These numbers can normally be used to make emergency calls in any country, with or without the SIM card inserted, if a GSM network is within range.

To make an emergency call

- From standby enter the international emergency number, for example 112 and press **(F).**

☞ In some countries, other emergency numbers may also be promoted. Your network operator may therefore have saved additional local emergency numbers on the SIM card.

Music player

The file types supported are: MP3, MP4, 3GP, AAC, AMR, MIDI, IMY, EMY and WAV (16 kHz maximum sample rate). You can also use streamed files that are 3GPP compatible.

Transferring music

You can transfer music from your computer to your phone memory or Memory Stick Micro™ (M2™). There are two ways to connect the phone to a computer:

- using a USB cable
 - with a Bluetooth wireless technology connection
- You can drag and drop files between your phone or memory card and a computer in Microsoft® Windows Explorer.

To connect your phone to a computer using a USB cable

- 1 Make sure your phone is turned on.
- 2 Connect the USB cable to your phone and the computer.
- 3 Phone: Select **Mass storage.**
- 4 Computer: Wait for the drivers to be installed (this is done automatically). The first time you connect your phone to the computer, you may need to identify and name the phone.

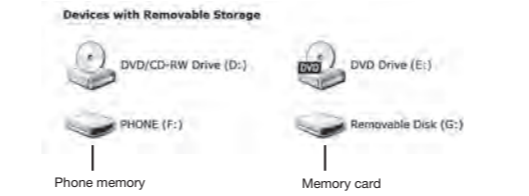

To transfer files

- 1 Connect the USB cable to the phone and the computer.
- 2 Phone: From standby select **Menu > Settings > the Connectivity tab > USB > Mass storage.**
- 3 Computer: Wait until the phone memory and memory card appear as external disks in Microsoft Windows Explorer.
- 4 Computer: On the computer desktop, double-click the My Computer icon.
- 5 Computer: To view the phone memory and memory card folders, double-click the icon representing your phone under **Devices with removable storage.** Double-click on the removable disk to view M2 folders.
- 6 Copy and paste your file, or drag and drop it, into the folder you want on your computer, in your phone memory or on your memory card.
- 7 To safely disconnect the USB cable in File transfer mode, right-click the Removable Disk icon in Windows Explorer and select Eject.

☞ Do not remove the USB cable from the phone or computer during transfer, as this may corrupt the memory card and the phone memory. You cannot view the transferred files in your phone until you have removed the USB cable from the phone.

☞ More information about transferring files to your phone is available at www.sonyericsson.com/support.

To Play Music

- 1 From standby select **Menu > Music player > Options > My music > Tracks.**
- 2 Scroll to a title and select **Play.**

To stop playing music

- Press the centre navigation key.

To move between track

- Press **(L)** or **(R).**

Browsing files

From standby select **Menu > Music player > Options > My music.** Music is saved and categorized:

- **Artists** – list music by artist.
- **Albums** – list music by album.
- **Tracks** – list all music tracks.
- **My playlists** – create own lists of tracks.
- **Onl.channels** – list of bookmarks with streaming video or music.

Playlists

To organise the media files that are saved in File manager, you can create playlists.

To create a playlist

- 1 From standby select **Menu > Music player > Options > My music > My playlists > New playlist.**
- 2 Enter a name and select **OK.**
- 3 Scroll to a track and select **OK.**

PlayNow™

With PlayNow™ you can preview, buy and download music via the Internet. You can find PlayNow™ in **Menu > PlayNow™.**

☞ You need the correct Internet settings in your phone to use this function. See *Internet on page 21.*

TrackID™

TrackID™ is a music recognition service. You can search for song titles, artists and album names.

☞ You need the correct Internet settings in your phone to use this function. See *Internet on page 21.*

To search for song information

- When you hear a song through a loudspeaker, from standby select **Menu > Entertainment > TrackID™ > Start.**
- When the radio is playing select **Options > TrackID™.**

Messaging

Text messages (SMS)

You must have a service centre number, which is supplied by your service provider and saved on the SIM card. You may have to enter the number yourself.

☞ Make sure you have a valid service centre number in your phone.

☞ See *Entering text on page 33.*

To write and send a text message

- 1 From standby select **Menu > Messaging > Write new > Text message.**
- 2 Write the message and select **Cont.**
- 3 Select an option.
- 4 Select **OK > Send.**

To view a received text message

- 1 **New message from:** appears. Select **View.**
- 2 Select the unread message.

To view messages saved in the inbox

- Select **Menu > Messaging > Inbox.**

To get delivery status of a sent message

- 1 From standby select **Menu > Messaging > Settings > Text message > Delivery report.**
- 2 Select **On.** You are notified when a message has been successfully delivered.

Picture messages (MMS)

Picture messages can contain text, sound and images. They are sent using MMS to a mobile phone. You need the correct Internet settings in your phone to use this function. See *Internet on page 21.*

To create a picture message

- 1 From standby select **Menu > Messaging > Write new > Picture msg.**
- 2 Select an option to create the message.

To send a picture message

- 1 When the message is ready, select **Cont.**
- 2 Select an option.
- 3 Select **OK > Send.**

☞ Sending and receiving phones must have subscriptions that support picture messaging. Make sure that you have a phone subscription that supports data transmission, and the correct settings in your phone.

Bluetooth™

Bluetooth™ wireless technology allows wireless connection to other Bluetooth devices, for example, a Bluetooth headset. You can:

- connect to several devices at the same time.
- exchange items.

☞ The recommended maximum distance between two Bluetooth devices is 10 metres (33 feet), with no solid objects in between.

To turn the Bluetooth function on

- From standby select **Menu > Settings > the Connectivity tab > Bluetooth > Turn on.**

☞ Check if local laws or regulations restrict the use of Bluetooth wireless technology. If it is not allowed, you must ensure that the Bluetooth function is turned off.

To show or hide your phone

- From standby select **Menu > Settings > the Connectivity tab > Bluetooth > Visibility > Show phone or Hide phone.**

☞ If the phone cannot be detected by other devices using Bluetooth wireless technology turned the Bluetooth functionality on. Make sure that the visibility is set to **Show phone.** If set to **Hide phone,** other device will not be able to identify your phone using Bluetooth wireless technology.

To pair a device with your phone

- 1 To search for available devices, from standby select **Menu > Settings > the Connectivity tab > Bluetooth > My devices > New device.**
- 2 Select a device from the list.
- 3 Enter a passcode, if required.

To pair your phone with a Bluetooth handsfree

- 1 To search for available handsfree devices, from standby select **Menu > Settings > the Connectivity tab > Bluetooth > My devices > New device.**
- 2 Scroll to a device and select **Yes.**
- 3 Enter a passcode, if required.

To receive an item

- 1 From standby select **Menu > Settings > the Connectivity tab > Bluetooth > Turn on.**
- 2 When you receive an item, follow the instructions that appear.

To send an item using Bluetooth

- 1 From standby select, for example, **Menu > File manager > Camera album.**
- 2 Scroll to a picture and select **Options > Send > Bluetooth.**

More functions

Shortcuts

The shortcut menu gives you quick access to certain functions.

To open the shortcut menu

- Press **(F).**

Entering text

There are two methods you can use to enter text: multitap or predictive text input.

☞ By using predictive text input you only have to press each key once. Continue writing a word even if it appears to be wrong. The phone uses the dictionary to recognise the word when all letters are entered.

To enter text using predictive text input

- 1 For example, write the word "Jane", press **(E)** **(A)** **(N)** **(E)**.
- 2 You now have several options:
 - If the word shown is the one you want, press **(=)** to accept and add a space.
 - To accept a word without adding a space, press **(=)**. If the word shown is not the one you want, press **(L)** or **(R)** repeatedly to view alternative words.
 - To accept a word and add a space, press **(=)**.
 - To enter full stops and commas, press **(=)** and then **(L)** or **(R)** repeatedly.

To enter text using multitap

- Press **(2)** – **(9)** until the character you want appears.
- Press **(=)** to add a space.
- Press **(=)** to enter full stops and commas.
- Press **(=)** to shift between upper-case and lower-case letters.
- Press and hold down **(0)** – **(9)** to enter numbers.

To change text input methods

- When you write the message, press and hold down **(=)**.

To add items in a text message

- When you write the message, select **Options > Insert item.**
- Select an option.

To delete characters

- Select **(C).**

To change writing language

- When you write the message, press and hold down **(=)**.

Automatic keylock

The keypad is locked after a short while.

To turn on the automatic keylock

- From standby select **Menu > Settings > the General tab > Security > Automatic keylock > On.**

☞ Calls to the international emergency number 112 can still be made, even when the keypad is locked.

Voicemail

Callers can leave a voicemail message when you cannot answer. You can get your voicemail number from your network operator.

To enter your voicemail number

- 1 From standby select **Menu > Messaging > Settings > Voicemail no.**
- 2 Scroll to the voicemail number and select **OK.**
- 3 Enter the voicemail number that you get from your service provider and press **OK.**

To call your voicemail service

- From standby press and hold down **(=)**.

Flight mode

In **Flight mode** the network and radio transceivers are turned off to prevent disturbance to sensitive equipment. When the flight mode menu is activated you are asked to select a mode the next time you turn on your phone:

- **Normal** – full functionality.
- **Flight mode** – limited functionality. Only Music player.

To activate the flight mode menu

- From standby select **Menu > Settings > the General tab > Flight mode > Show at startup.**

22

23

24

25

26

27

28

29

30

31

32

33

34

35

Declaration of conformity for S302

We, Sony Ericsson Mobile Communications AB of Nya Vattenornet SE-221 88 Lund, Sweden declare under our sole responsibility that our product Sony Ericsson type AAC-1052121-BV and in combination with our accessories, to which this declaration relates is in conformity with the appropriate standards EN 301 511/V9.0.2, EN 300 328/V1.7.1, EN 301 488-7/V1.3.1, EN 301 488-17/V1.2.1 and EN 60950-1:2006, following the provisions of, Radio Equipment and Telecommunication Terminal Equipment Directive 1999/5/EC. Lund, March 2008

Shoji Nemoto, Head of Product Business Unit GSM/UMTS We fulfil the requirements of the R&TTE Directive (1999/5/EC).

FCC Statement

This device complies with Part 15 of the FCC rules. Operation is subject to the following two conditions: (1) This device may not cause harmful interference, and (2) this device must accept any interference received, including interference that may cause undesired operation.

Any change or modification not expressly approved by Sony Ericsson may void the user's authority to operate the equipment. This equipment has been tested and found to comply with the limits for a Class B digital device, pursuant to Part 15 of the FCC Rules. These limits are designed to provide reasonable protection against harmful interference in a residential installation. This equipment generates, uses and can radiate radio frequency energy and, if not installed and used in accordance with the instructions, may cause harmful interference to radio communications. However, there is no guarantee that interference will not occur in a particular installation. If this equipment does cause harmful interference to radio or television reception, which can be determined by turning the equipment off and on, the user is encouraged to try to correct the interference by one or more of the following measures:

- Reorient or relocate the receiving antenna.
- Increase the separation between the equipment and receiver.
- Connect the equipment into an outlet on a circuit different from that to which the receiver is connected.
- Consult the dealer or an experienced radio/TV technician for help.

Industry Canada Statement

This device complies with RSS-210 of Industry Canada. Operation is subject to the following two conditions: (1) this device may not cause interference, and (2) this device must accept any interference, including interference that may cause undesired operation of the device. This Class B digital apparatus complies with Canadian ICES-003. Cet appareil numérique de la classe B est conforme à la norme NMB-003 du Canada. Sony Ericsson W902 GSM 850/900/1800/1900

This User guide is published by Sony Ericsson Mobile Communications AB or its local affiliated company, without any warranty. Improvements and changes to this User guide necessitated by typographical errors, inaccuracies of current information, or improvements to programs and/or equipment, may be made by Sony Ericsson Mobile Communications AB at any time and without notice. Such changes will, however, be incorporated into new editions of this User guide. All rights reserved.

© Sony Ericsson Mobile Communications AB, 2008 Please note: Some of the services in this User guide are not supported by all networks. This also applies to the GSM International Emergency Number 112. Please contact your network operator or service provider if you are in doubt whether you can use a particular service or not. Please read the **Important information** before you use your mobile phone. All illustrations are for illustration only and may not accurately depict the actual phone.

Your mobile phone has the capability to download, store and forward additional content, e.g., ringtones. The use of such content may be restricted or prohibited by rights of third parties, including but not limited to restriction under applicable copyright laws. You, and not Sony Ericsson, are entirely responsible for additional content that you download to or forward from your mobile phone. Prior to your use of any additional content, please verify that your intended use is properly licensed or is otherwise authorised. Sony Ericsson does not guarantee the accuracy, integrity or quality of any additional content or any other third party content. Under no circumstances will Sony Ericsson be liable in any way for your improper use of additional content or other third party content. The Predictive Text Technology is used under license from Zi Corporation. The Bluetooth word mark and logos are owned by the Bluetooth SIG, Inc. and any use of such marks by Sony Ericsson is under license. MPEG Layer-3 audio decoding technology licensed from Fraunhofer IIS and Thomson. Microsoft is registered trademark of Microsoft Corporation in the United States and/or other countries.

www.sonyericsson.com

Sony Ericsson

Sony Ericsson Mobile Communications AB SE-221 88 Lund, Sweden



1212-6360.1 Printed in XXXX

36

37

38

39

40

41