

Preparing the phone

Congratulations on your purchase of the Sony Ericsson F305. For additional phone content, go to www.sonyericsson.com/fun. Register now to get free online storage and special offers at www.sonyericsson.com/myphone. For product support, go to www.sonyericsson.com/support.

Instruction symbols

The following appear in this User guide:

- > Use the navigation key to scroll and select
- Press the navigation key centre
- ⌂ Press the navigation key up
- ⌄ Press the navigation key down
- ⌅ Press the navigation key to the left
- ⌆ Press the navigation key to the right

! Note

💡 Tip

⚠ Warning

📶 Indicates that a service or function is network- or subscription-dependent. All menus or functions may not be available in your phone. Consult your network operator for more information.

To insert the SIM card and battery



- Remove the battery cover and battery if inserted. Slide the SIM card into its holder with the contacts facing down.

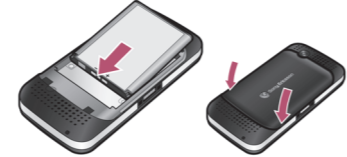

- Insert the battery with the label side up and the connectors facing each other. Replace the battery cover.

! Do not force the battery cover into place. Place the battery cover carefully onto the phone and close it.

SIM card

The SIM (Subscriber Identity Module) card, which you get from your network operator, contains information about your subscription. Always turn off your phone and detach the charger and the battery before you insert or remove the SIM card.

💡 You can save contacts on the SIM card before removing it from your phone. You can also save contacts in the phone memory. See *Contacts* on page 26.

PIN code

You may need a PIN (Personal Identification Number) to activate the services in your phone. Your PIN is supplied by your network operator. Each PIN digit appears as *, unless it starts with emergency number digits, for example, 112 or 911. You can call an emergency number without entering a PIN.

! If you enter the wrong PIN three times in a row, **PIN blocked** appears. To unblock it, you need to enter your PUK (Personal Unblocking Key).

Memory Stick Micro™

Your phone supports Memory Stick Micro™ (M2™). A memory card adds more storage space to your phone, for example, for music, ringtones, video clips and pictures. You can share your saved information by moving or copying it to other memory card compatible devices.

To insert a Memory Stick Micro™ (M2™)

- Open the cover and insert the memory card.
- To remove a M2™
 - Open the cover and press the edge of the memory card to release and remove it.

Charging the battery

The phone battery is partly charged when you buy it. It takes approximately 2.5 hours to fully charge the battery.

To charge the battery

- Connect the charger to the phone. Press a key to illuminate the screen and see the charging status.
- To remove the charger, tilt and pull the plug upwards.

💡 You can use the phone during charging. You can charge the battery for more or less than 2.5 hours. Interrupted charging does not damage the battery.

To turn on the phone

- Press and hold down **Power**.
- Enter your SIM card PIN, if requested.
- Select **Yes** to use the setup wizard to configure basic phone settings such as **Time & date**, **Phone language** and so on.

! In **Flight mode** the network and radio transceivers are turned off to prevent disturbance to sensitive equipment. You can play games and use media player, camera and Bluetooth function in **Flight mode**.

💡 If you make a mistake when you enter your PIN, you can press **Cancel** to delete numbers from the screen.

Standby

After you have turned on the phone and entered your PIN, the name of your operator appears on the screen. This is called standby. You can now make and receive calls.

To turn off the phone

- Press and hold down **Power**.



Network coverage

The network bars show the strength of the GSM network in your area. Move to another location if you have problems calling and network coverage is poor. **No network** means you are not in range of a network.

- 📶 = Good network coverage
- 📶 = Average network coverage

Battery status

- 🔋 = The phone battery is fully charged
- 🔋 = The phone battery is empty

Screen icons

These icons may appear on the screen.

Icon	Description
	Missed call
	Handsfree connected
	Phone set to silent
	Text message received
	Picture message received
	Email message received
	Predictive text input activated
	Voice message received
	Ongoing call
	FM radio playing
	Alarm activated
	Bluetooth function activated

Phone overview

- Circle gaming key
- Selection keys
- Call key
- Connector for charger, handsfree and USB cable
- Gaming shortcut key
- Navigation key, directional gaming keys
- Cross gaming key
- End key, on/off key
- C key (Clear)
- Centre selection key
- Silent key
- Main camera
- Strap holder
- Volume keys
- Camera key
- Memory card slot
- Stereo speakers

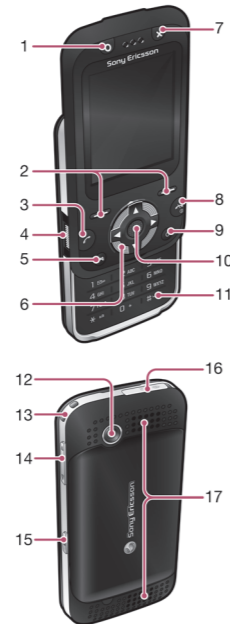

Navigation

The main menus are shown as icons. Some submenus include tabs.

To navigate the phone menus

- From standby select **Menu**.
- Use the navigation key to move through the menus.

To scroll between the tabs

- Press the navigation key left or right.

To go back one step in the menu

- Select **Back**.

To return to standby

- Press **End key**.

To set the phone to silent

- Press and hold down **Silent key**.

To call your voicemail service

- Press and hold down **Call key**.

To end a function

- Press **End key**.



Centre selection key

Menu overview

	PlayNow™	
	Internet*	Homepage, Enter address, Bookmarks, History, Saved pages, Internet settings
	Entertainment	Games, TrackID™, Video player, Record sound
	Camera	
	Messaging	Write new, Inbox, Email, Drafts, Outbox, Sent messages, IM, Call voicemail, Templates, Settings
	Music player	
	File manager**	Music, Camera album, Pictures, Videos, Other
	Contacts	New contact
	Radio	
	Calls**	
	Organiser	Alarms, Applications, Calendar, Tasks, Synchronisation, Timer, Stopwatch, Calculator

All	Dialled	Missed	Answered

*Some menus are operator-, network- and subscription-dependent.
**You can use the navigation key to scroll between tabs in submenus. For more information, see *Navigation* on page 10.

General	Sounds & alerts	Display	Connectivity
Profiles Time & date Phone language Shortcuts Flight mode Security Phone status Reset all	Ring volume Ringtone Silent mode Vibrating alert Message alert Key sound	Wallpaper Themes Startup screen Screen saver Brightness	Bluetooth USB Synchronisation Mobile networks

*Some menus are operator-, network- and subscription-dependent.
**You can use the navigation key to scroll between tabs in submenus. For more information, see *Navigation* on page 10.

Music Player

The file types supported are: MP3, MP4, 3GP, AAC, AMR, MIDI, IMY, EMY, WMA and WAV (16 kHz maximum sample rate).

To play music

- From standby select **Menu** > **Music player** > **Options** > **My music** > **Tracks**.
- Scroll to a title and select **Play**.

To stop playing music

- Press the centre navigation key.

Transferring music

You can transfer music from your computer to your phone memory or Memory Stick Micro™ (M2™). There are two ways to connect the phone to a computer:

- using a USB cable
 - with a Bluetooth wireless technology connection
- You can drag and drop files between your phone or memory card and a computer in Microsoft® Windows Explorer.

To connect your phone to a computer using a USB cable

- Make sure your phone is turned on.
- Connect the USB cable to your phone and the computer.
- Phone: select **Mass storage**.
- Computer: Wait for the drivers to be installed automatically.

! One of these operating systems is required:

- Microsoft® Windows® 2000
- Microsoft Windows XP (Pro or Home)
- Microsoft Windows Vista™ (All versions)

To transfer files in Mass storage mode

- Connect the USB cable to the phone and the computer.
- Phone: From standby select **Menu** > **Settings** > the **Connectivity** tab > **USB** > **Mass storage**.
- Computer: Wait until the phone memory and memory card appear as external disks in Microsoft Windows Explorer.

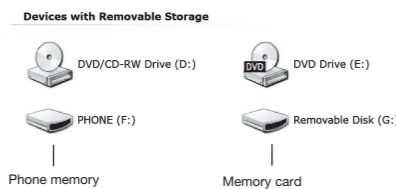

- Computer: On the computer desktop, double-click the **My Computer** icon.
- Computer: In the **My Computer** window, double-click the icon representing your phone under **Devices with removable storage** to view the phone memory and memory stick folders.
- Copy and paste your file, or drag and drop it, into a folder on your computer, in your phone memory or on your memory card.

! Do not remove the USB cable from the phone or computer during transfer, as this may corrupt the Memory Stick and the phone memory.

! You cannot view the transferred files in your phone until you have removed the USB cable from the phone. For safe disconnection of the USB cable in File transfer mode, right-click on the Removable Disk icon in Windows Explorer and select **Eject**.

! More information about transferring files to your phone is available at www.sonyericsson.com/support.

Playlists

You can create playlists to organise media files saved in file manager.

To create a playlist

- From standby select **Menu** > **Music player** > **Options** > **My music** > **My playlists** > **New playlist** > **Add**.
- Enter a name and select **OK**.
- Scroll to a track and select **OK**.

Radio

Your phone has a radio and the handsfree works as an antenna.

To listen to the radio

- Connect the handsfree to the phone.
- From standby select **Menu** > **Radio**.

! Do not use your phone as a radio in places where it is prohibited.

To control the radio

- Press **Left** or **Right** to search for FM radio channels.

To save an FM radio channel

- Select **Options** > **Save**.
- Press and hold down **Left** - **Right**. The FM radio channel is saved in **Options** > **Channels**.

To listen to a saved FM radio channel

- When the FM radio is on, press **Left** - **Right**.

To exit the FM radio

- Select **Back** or press **End key**.
- Minimize radio?** appears. Select **No**.

To turn off the FM radio when minimized

- Select **Menu** > **Radio**.
- Select **Back** or press **End key**.
- Minimize radio?** appears. Select **No**.

To view FM radio options

- When the FM radio is on, select **Options**.

Imaging

Camera and video recorder

You can take pictures and record video clips to view, save or send. You can find your saved pictures and video clips in **Menu** > **File manager** > **Camera album**.

- Take pictures/Record video clips
- Zoom in or out

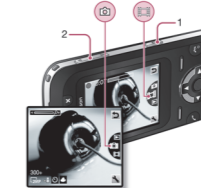

To take a picture

- From standby press **Camera key** to activate the camera.
- Press **Left** or **Right** to scroll to **Picture**.
- Press **Camera key** to take a picture.
- The picture is automatically saved.

! Do not record with a strong light source in the background. Use the self-timer or a support such as a tripod to avoid a blurred picture.

To record a video clip

- From standby press **Camera key** to activate the camera.
- Press **Left** or **Right** to scroll to **Video**.
- Press **Camera key** fully down to start recording.

To stop recording

- Press **Camera key**. The video clip is automatically saved.

To use zoom in or out

- Press the volume keys up or down.

! When you take a picture, zoom is only available in VGA mode.

Transferring pictures

You can use Bluetooth™ wireless technology and the USB cable to transfer pictures and video clips between your computer and phone. See *Bluetooth™ wireless technology* on page 29 and *To transfer files in Mass storage mode* on page 16 for more information.

Calling

You must turn on the phone and be within range of a network.

To make a call

- 1 From standby enter the area code, if applicable, and the phone number.
- 2 Press **☎**.

💡 You can call numbers from your contacts and call list. See *Contacts on page 26* and *Call list on page 23*.

To end a call

- Press **☎**.

To answer a call

- Press **☎**.

To reject a call

- Press **☎**.

To change the ear speaker volume during a call

- Press the volume key up or down.

To turn the loudspeaker on during a call

- Select **Speaker**.

⚠ Do not hold the phone to your ear when using the loudspeaker. This could damage your hearing.

To view missed calls from standby

- When **Missed calls**: is displayed, select **View**.



22

Messaging

Text messages (SMS)

You must have a service centre number, which is supplied by your service provider and saved on the SIM card. You may have to enter the number yourself.

💡 See *Entering text on page 32*.

To write and send a text message

- 1 From standby select **Menu > Messaging > Write new > Text message**.
- 2 Write the message and select **Cont.**
- 3 Select an option.
- 4 Select **OK > Send**.

To view a received text message

- 1 When **New message from**: appears, select **View**.
- 2 Select the unread message.

To view messages saved in the inbox

- Select **Menu > Messaging > Inbox**.

To get delivery status of a sent message

- 1 From standby select **Menu > Messaging > Settings > Text message > Delivery report**.
- 2 Select **On**. You are notified when a message has been successfully delivered.

To make international calls

- 1 From standby press and hold down **☎** until a + sign appears.
- 2 Enter the country code, area code (without the first zero) and phone number.
- 3 Press **☎**.

Call list

You can view information about recent calls.

To call a number from the call list

- 1 From standby press **☎**.
- 2 Scroll to a name or number and press **☎**.

To delete a number from the call list

- 1 From standby press **☎**.
- 2 Scroll to a name or number and select **Options > Delete**.

💡 Calls to the international emergency number 112 can still be made, even when the keypad is locked.

Emergency calls

Your phone supports international emergency numbers, for example, 112 and 911. These numbers can normally be used to make emergency calls in any country, with or without the SIM card inserted, if a GSM network is within range.

To make an emergency call

- From standby enter the international emergency number, for example, 112 and press **☎**.

23

Picture messages (MMS)

Picture messages can contain text, pictures, sound recordings, video clips and attachments.

💡 You must set an MMS profile and the address of your message server. If no MMS profile or message server exists, you can receive all the settings automatically from your network operator or at www.sonyericsson.com/support.

To create and send a picture message

- 1 From standby select **Menu > Messaging > Write new > Picture msg.**
- 2 Enter text. To add items to the message, press **☺**, scroll **☺** and select an item.
- 3 Select **Cont.**
- 4 Select an option.
- 5 Select **OK > Send**.

💡 Sending and receiving photos must have subscriptions that support picture messaging.

💡 See *Entering text on page 32*.

24

Contacts

You can save contacts in the phone memory or on the SIM card. You can copy contacts from the phone memory to the SIM card or from the SIM card to the phone memory.

Default contacts

You can choose which contact information is shown as default. If **Phone cont.** is selected as default, your contacts show all the information saved in the phone. If you select **SIM contacts** as default, your contacts show names and numbers saved on the SIM card.

To select default contacts

- 1 From standby select **Menu > Contacts > Options > More > Default contacts**.
- 2 Select an option.

💡 If you select **Phone & SIM** as Default contacts, you are asked to choose between **Phone** or **SIM card** when adding a new contact.

💡 See *Entering text on page 32*.

25

Phone contacts

To add a phone contact

- 1 From standby select **Menu > Contacts > New contact**.
- 2 Scroll to **Name**: and select **Add**.
- 3 Enter the name and select **OK**.
- 4 Scroll to **New number**: and select **Add**.
- 5 Enter the number and select **OK**.
- 6 Select a number option.
- 7 Scroll among tabs and select the fields to add information.
- 8 Select **Save**.

💡 Enter the + sign and country code with all phonebook numbers. Then you can use them abroad or at home. See *To make international calls on page 23*.

To call a contact

- 1 From standby select **Menu > Contacts**.
- 2 Scroll to or enter the first few letters of the contact.
- 3 Press **☎**.

To edit a contact

- 1 From standby select **Menu > Contacts**.
- 2 Select a contact.
- 3 Select **Options > Edit contact**.
- 4 Edit the information and select **Save**.

To delete a contact

- 1 From standby select **Menu > Contacts**.
- 2 Scroll to a contact.
- 3 Select **Options > Delete**.

To copy a contact to the SIM card

- 1 From standby select **Menu > Contacts**.
- 2 Scroll to a contact.
- 3 Select **Options > Options > Copy to SIM**.

Contacts memory

The number of entries you can save in **Contacts** depends on the capacity of your SIM card.

To check the contacts memory status

- From standby select **Menu > Contacts > Options > Memory status**.

26

More functions

Bluetooth™ wireless technology

Bluetooth™ wireless technology allows wireless connection to other Bluetooth devices. For example, you can:

- connect to handsfree devices.
- connect to several devices at the same time.
- exchange items.

💡 For Bluetooth communication, we recommend a maximum range of 10 metres (33 feet) with no solid objects in between.

To turn on the Bluetooth function

- From standby select **Menu > Settings > the Connectivity tab > Bluetooth > Turn on**.

💡 Make sure that the device you want to pair your phone with has the Bluetooth function activated and Bluetooth Visibility set to **Show phone**.

To pair a device with your phone

- 1 To search for available devices, from standby select **Menu > Settings > the Connectivity tab > Bluetooth > My devices > New device**.
- 2 Select a device from the list. Enter a passcode, if required.

To pair your phone with a Bluetooth handsfree

- 1 To search for available devices, from standby select **Menu > Settings > the Connectivity tab > Bluetooth > My devices > New device**.
- 2 Select a handsfree device. Enter a passcode, if required.

27

To receive an item

- 1 From standby select **Menu > Settings > the Connectivity tab > Bluetooth > Turn on**.
- 2 When you receive an item, follow the instructions that appear.

To send an item using Bluetooth

- 1 From standby select, for example, **Menu > File manager > Camera album**.
- 2 Scroll to a picture and select **Options > Send > Bluetooth**.

Internet

You need the correct Internet settings in your phone. If the settings are not in your phone, you can:

- Get them in a text message from the network operator.
- On a computer, go to www.sonyericsson.com/support and request a text message with the settings.

To select an Internet profile

- 1 From standby select **Menu > Internet > Internet settings > Accounts**.
- 2 Select an account.

To start browsing

- 1 From standby select **Menu > Internet**.
- 2 Select an option.

To stop browsing

- When you are browsing, press and hold down **☰**.

28

Themes and ringtones

You can change the appearance of your screen by selecting themes. You can also select ringtones.

To select a theme

- From standby select **Menu > Settings > the Display tab > Themes** and select a theme.

To select a ringtone

- From standby select **Menu > Settings > the Sounds & alerts tab > Ringtone** and select a ringtone.

Time and date

To set the time and date

- 1 From standby select **Menu > Settings > the General tab > Time & date > Time**.
- 2 Enter the date and select **OK**.
- 3 Enter the time and select **OK**.

Language

To change the phone language

- From standby select **Menu > Settings > the General tab > Phone language** and select a language.

29

File manager

You can handle files saved in the phone memory or on a memory card. You can create subfolders to move files to.

To move a file in the file manager

- 1 From standby select **Menu > File manager**.
- 2 Scroll to a file and select **Options > Move to folder**.
- 3 Open a folder and select **Paste**.

Entering text

There are two methods you can use to enter text: multitap or predictive text input.

💡 By using predictive text input you only have to press each key once. Continue writing a word even if it appears to be wrong. The phone uses the dictionary to recognise the word when all letters are entered.

To enter text using predictive text input

- 1 For example, to write the word "Jane", press **J**, **A**, **N**, **E**.
- 2 You now have several options:
 - If the word shown is the one you want, press **☺** to accept and add a space. To accept a word without adding a space, press **☺**.
 - If the word shown is not the one you want, press **⌂** or **☺** repeatedly to view alternative words.
 - To enter full stops and commas, press **,** and then **.** or **,** repeatedly.

30

To enter text using multitap

- Press **☺** - **☺** until the character you want appears.
- Press **☺** to add a space.
- Press **,** to enter full stops and commas.
- Press **,** to shift between upper and lower case letters.
- Press and hold down **☺** - **☺** to enter numbers.

To change text input methods

- When you write the message, press and hold down **☺**.

To delete characters

- Press **☺**.

To change writing language

- When you write the message, press and hold down **☺**.

Voicemail

Callers can leave a voicemail message when you cannot answer. You can get your voicemail number from your network operator.

To enter your voicemail number

- 1 From standby select **Menu > Messaging > Settings > Voicemail no**.
- 2 Scroll to the voicemail number and select **OK**.
- 3 Enter the voicemail number and select **OK**.

To call your voicemail service

- From standby press and hold down **,**.

31

SIM card lock

Your PIN and PUK are supplied by your network operator.

💡 If the message **Wrong PIN Attempts remaining**: appears when you edit your PIN, you entered the PIN or PIN2 incorrectly.

To unlock your SIM card

- 1 When **PIN blocked** is displayed, select **Unlock**.
- 2 Enter your PUK and select **OK**.
- 3 Enter a new PIN and select **OK**.
- 4 Re-enter the new PIN and select **OK**.

To turn on the SIM card lock

- 1 From standby select **Menu > Settings > the General tab > Security > Locks > SIM protection > Protection**.
- 2 Enter your PIN and select **OK**.
- 3 Select **On**.

To edit your PIN

- 1 From standby select **Menu > Settings > the General tab > Security > Locks > SIM protection > Change PIN**.
- 2 Enter your PIN and select **OK**.
- 3 Enter a new PIN and select **OK**.
- 4 Re-enter the new PIN and select **OK**.

32

Troubleshooting

Some problems require you to call your network operator. For more support go to www.sonyericsson.com/support.

Master reset

If you experience problems with your phone, such as screen flickering, screen freezing or navigation problems, you should reset the phone. If you select **Reset all**, all user data such as contacts, messages, pictures and sounds are deleted.

To reset all settings

- From standby select **Menu > Settings > the General tab > Reset all > Cont. > Cont**.

Error messages

PIN blocked

You have entered your PIN code incorrectly three times in a row. Your SIM is now locked. Unlock your SIM with your PUK code, which is provided together with your PIN code by your network operator.

To unlock the SIM card

- 1 Enter your PUK code and select **OK**.
- 2 Enter a new PIN and select **OK**.
- 3 Re-enter the new PIN and select **OK**.

Insert SIM

There is no SIM card in your phone or you may have inserted it incorrectly. Try one or more of the following:

- Remove the SIM card and insert it correctly.
- Clean the connectors on the SIM card and phone with a soft brush, a cloth or a cotton bud.

33

- Check if the SIM card is damaged.
- Contact your network operator to get a new SIM card.

I cannot turn on the phone

Try charging the phone until it has finished charging. Attach the charger (make sure the power icon on the charger is facing upwards) and charge the phone for 2.5 hours. The battery icon on the screen may not appear until the phone has charged for 30 minutes.

I cannot use Internet or MMS

Make sure you have a phone subscription that supports data transmission, and also the correct settings in your phone.

I cannot send text messages (SMS)

Make sure you have a valid service centre number in your phone.

The phone cannot be detected by other devices using Bluetooth wireless technology

You have not turned the Bluetooth function on. Make sure that the visibility is set to **Show phone**. See *To turn on the Bluetooth function on page 29*.

The phone turns off itself

If your phone turns off itself when being transported, something in your pocket or bag has activated the on/off key. You need to turn on the automatic keylock.

34

Declaration of conformity for F305

We, Sony Ericsson Mobile Communications AB of Nya Vattenornet SE-221 88 Lund, Sweden declare under our sole responsibility that our product **Sony Ericsson type AAC-1052161-BV** and in combination with our accessories, to which this declaration relates is in conformity with the appropriate standards EN 301 511:V9.0.2, EN 300 328:V1.7.1, EN 301 489-7:V1.3.1, EN 301 489-17:V1.2.1 and EN 60 950-1:2006, following the provisions of Radio Equipment and Telecommunication Terminal Equipment Directive 1999/5/EC. Lund, May 2008

CE 0682

Shoji Nemoto, Head of Product Business Unit GSM/UMTS

We fulfill the requirements of the R&TTE Directive (1999/5/EC).

FCC Statement

This device complies with Part 15 of the FCC rules. Operation is subject to the following conditions: (1) This device may not cause harmful interference, and (2) This device must accept any interference received, including interference that may cause undesired operation. Any change or modification not expressly approved by Sony Ericsson may void the user's authority to operate the equipment. This equipment has been tested and found to comply with the limits for a Class B digital device, pursuant to Part 15 of the FCC Rules. These limits are designed to provide reasonable protection against harmful interference in a residential installation.

FCC

35

This equipment generates, uses and can radiate radio frequency energy and, if not installed and used in accordance with the instructions, may cause harmful interference to radio communications. However, there is no guarantee that interference will not occur in a particular installation. If this equipment does cause harmful interference to radio or television reception, which can be determined by turning the equipment off and on, the user is encouraged to try to correct the interference by one or more of the following measures:

- Reorient or relocate the receiving antenna.
- Increase the separation between the equipment and receiver.
- Connect the equipment into an outlet on a circuit different from that to which the receiver is connected.
- Consult the dealer or an experienced radio/TV technician for help.

Industry Canada Statement

This device complies with RSS-210 of Industry Canada. Operation is subject to the following two conditions: (1) this device may not cause interference, and (2) this device must accept any interference, including interference that may cause undesired operation of the device. This Class B digital apparatus complies with Canadian ICES-003. Cet appareil numérique de la classe B est conforme à la norme NMB-003 du Canada.

Sony Ericsson F305

GSM 850/900/1800/1900 This User guide is published by Sony Ericsson Mobile Communications AB or its local affiliated company, without any warranty. Improvements and changes to this User guide necessitated by typographical errors, inaccuracies of current information, or improvements to programs and/or equipment, may be made by Sony Ericsson Mobile Communications AB at any time and without notice. Such changes will, however, be incorporated into new editions of this User guide. All rights reserved.

© Sony Ericsson Mobile Communications AB, 2008

Please note: Some of the services in this User guide are not supported by all networks. This also applies to the GSM International Emergency Number 112. Please contact your network operator or service provider if you are in doubt whether you can use a particular service or not.

36

Please read the *Important information* before you use your mobile phone. All illustrations are for illustration only and may not accurately depict the actual phone. Your mobile phone has the capability to download, store and forward additional content, e.g. ringtones. The use of such content may be restricted or prohibited by rights of third parties, including but not limited to restriction under applicable copyright laws. You, and not Sony Ericsson, are entirely responsible for additional content that you download to or forward from your mobile phone. Prior to your use of any additional content, please verify that your intended use is properly licensed or is otherwise authorized. Sony Ericsson does not guarantee the accuracy, integrity or quality of any additional content or any other third party content. Under no circumstances will Sony Ericsson be liable in any way for your improper use of additional content or other third party content. Sony, M2 and Memory Stick Micro are trademarks or registered trademarks of Sony Corporation. Ericsson is a trademark or registered trademark of Telefonaktiebolaget LM Ericsson. The Predictive Text Technology is used under license from Zi Corporation. Bluetooth is a trademark or a registered trademark of Bluetooth SIG Inc. and any use of such mark by Sony Ericsson is under license. The Liquid Identity logo, Style-Up, PlayNow and TrackID are trademarks or registered trademarks of Sony Ericsson Mobile Communications AB. TrackID™ music is powered by Gracenote Mobile. Microsoft, Windows and Vista are trademarks or registered trademarks of Microsoft Corporation in the United States and/or other countries. This product is protected by certain intellectual property rights of Microsoft. Use or distribution of such technology outside of this product is prohibited without a license from Microsoft. Java™ and all Java-based trademarks and logos are trademarks or registered trademarks of Sun Microsystems, Inc. in the United States and other countries. End-user license agreement for Sun™ Java™ J2ME™.

Export Regulations: This product, including any software or technical data contained in or accompanying the product, may be subject to U.S. export control laws, including the U.S. Export Administration Act and its associated regulations and the U.S. sanctions programs administered by the U.S. Treasury Department's Office of Foreign Assets Control, and may be additionally subject to export or import regulations in other countries. The user and any possessor of the product agrees to comply strictly with all such regulations and acknowledges that it is their responsibility to obtain any required licenses to export, re-export, or import this product. Without limitation this product, including any software contained therein, may not be downloaded, or otherwise exported or re-exported (i) into, or to a national or resident of, or an entity in, Cuba, Iraq, Iran, North Korea, Sudan, Syria (as such listing may be revised from time to time) or any country to which the U.S. has embargoed goods; or (ii) to any person or entity on the U.S. Treasury Department's list of Specially Designated Nationals or (iii) any person or entity on any other export prohibition list that may be maintained from time to time by the United States Government, including but not limited to the U.S. Commerce Department's Denied Persons List or Entity List, or the U.S. State Department's Nonproliferation Sanctions List. Restricted Rights: