

Personal Audio System

Operating Instructions



©2016 Sony Corporation Printed in China http://www.sony.net/

CFD-S70

WARNING

To reduce the risk of fire or electric shock, do not expose this apparatus to rain or moisture.

To reduce the risk of fire, do not cover the ventilation opening of the appliance with newspapers, tablecloths, curtains, etc. Do not expose the appliance to naked flame sources (for example, lighted candles).

To reduce the risk of fire or electric shock, do not expose this apparatus to dripping or splashing, and do not place objects filled with liquids, such as vases, on the apparatus.

As the main plug is used to disconnect the unit from the mains, connect the unit to an easily accessible AC outlet. Should you notice an abnormality in the unit, disconnect the main plug from the AC outlet immediately.

The unit is not disconnected from the AC power source (mains) as long as it is connected to the wall outlet, even if the unit itself has been turned off.

Do not install the appliance in a confined space, such as a bookcase or built-in cabinet.

Excessive sound pressure from earphones and headphones can cause hearing loss.

Do not expose the batteries (battery pack or batteries installed) to excessive heat such as sunshine, fire or the like for a long time.

The nameplate is located on the bottom exterior.

Owner's Record

The model and serial numbers are located on the bottom of the unit. Record these numbers in the space provided below. Refer to them whenever you call upon your Sony dealer regarding this product.

Model No. CF-D570
Serial No.

Important Safety Instructions

- 1) Read these instructions.
2) Keep these instructions.
3) Heed all warnings.
4) Follow all instructions.
5) Do not use this apparatus near water.
6) Clean only with dry cloth.
7) Do not block any ventilation openings.
8) Do not install near any heat sources such as radiators, heat registers, stoves, or other apparatus.
9) Do not defeat the safety purpose of the polarized or grounding-type plug.
10) Protect the power cord from being walked on or pinched.
11) Only use attachments/accessories specified by the manufacturer.
12) Use only with the cart, stand, tripod, bracket, or table specified by the manufacturer.
13) Unplug this apparatus during lightning storms or when unused for long periods of time.

- 14) Refer all servicing to qualified service personnel. Servicing is required when the apparatus has been damaged in any way, such as power-supply cord or plug is damaged, liquid has been spilled or objects have fallen into the apparatus, the apparatus has been exposed to rain or moisture, does not operate normally, or has been dropped.

The following FCC/IC statement applies only to the version of this model manufactured for sale in the USA and Canada. Other versions may not comply with FCC/IC technical regulations.

NOTE:

For United States customers. Not applicable in Canada, including in the province of Quebec. This equipment has been tested and found to comply with the limits for a Class B digital device, pursuant to Part 15 of the FCC Rules. These limits are designed to provide reasonable protection against harmful interference in a residential installation.

CAUTION

You are cautioned that any changes or modifications not expressly approved in this manual could void your authority to operate this equipment.



This symbol is intended to alert the user to the presence of uninsulated "dangerous voltage" within the product's enclosure that may be of sufficient magnitude to constitute a risk of electric shock to persons.

This symbol is intended to alert the user to the presence of important operating and maintenance (servicing) instructions in the literature accompanying the appliance.

This graphical symbol is located on the bottom of the unit.

Power Sources

Connect the AC power cord A, or insert six R14 (size C) batteries (not supplied) into the battery compartment B.

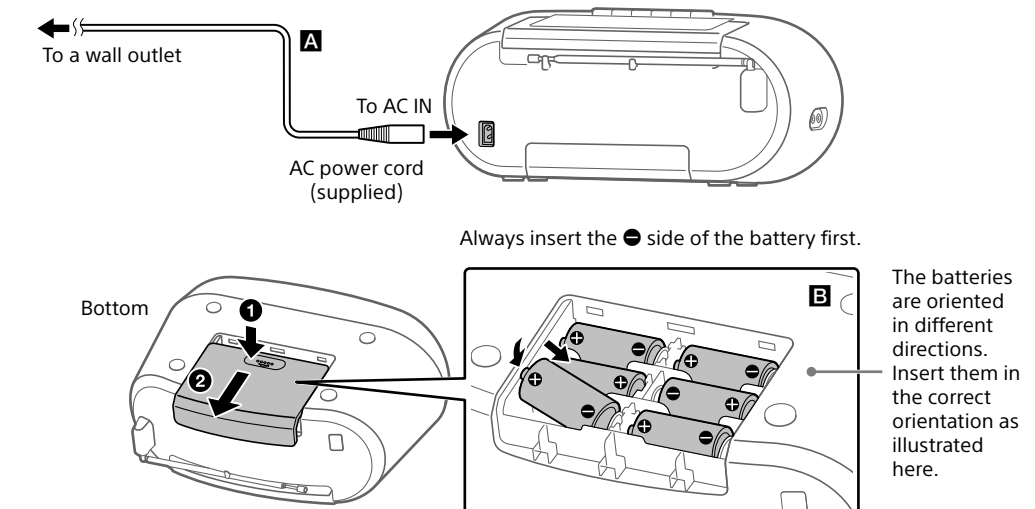

Press down on the battery compartment cover at 1 and slide it in the direction of the arrow 2.

Notes

- When the batteries are almost depleted, the alert message "LO-BATT" will flash.
When the AC power cord is disconnected or the batteries are removed, settings stored in the unit's memory will either be cleared or kept stored.
Before you replace the batteries, be sure to remove any CDs or tapes, disconnect any optional components from the unit, and store the FM telescopic antenna 17 in its original position if extended.

Basic Operations

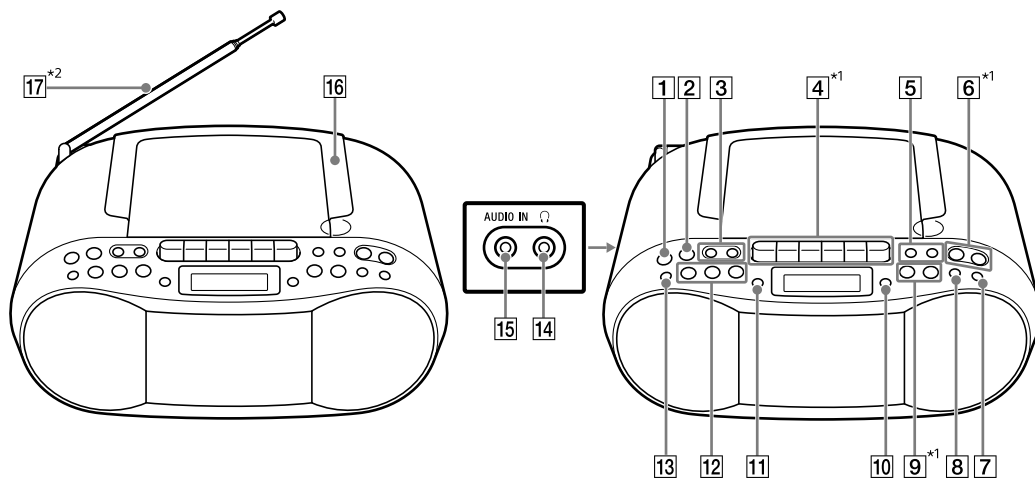

\*1 CD PLAY/PAUSE 9, VOLUME + 6 and < 4 have a tactile dot.
\*2 Extend the FM antenna 17 only when listening to FM radio (for AM radio, a ferrite bar antenna is built into the unit).

Before using the unit

To turn the power on or off
Press < (power) 1.

To adjust the volume
Press VOLUME + or - 6.

To listen through headphones
Connect headphones to the < (headphones) jack 14.

To turn the bass enhancement function on or off
Press MEGA BASS 7.

To play a music disc
Press CD PLAY/PAUSE 9.

To play an MP3 disc
Press TUNE/□ + or - 3.

Playing a music disc

- 1 Press < 1 to turn on the power of the unit.
2 Insert the tip of your finger into the opening tab to open the CD compartment cover.

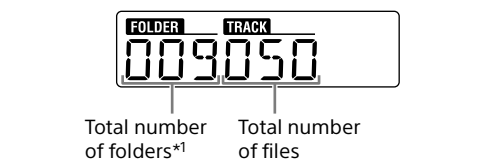
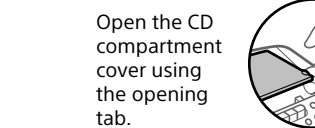

4 Press CD PLAY/PAUSE 9 to start playback.



- \*1 If MP3 files are present only in the root directory, "001" appears on the display.
\*2 If the playing time is longer than 100 minutes, "-:--:" appears on the display.
\*3 By pressing DISPLAY/ENTER 11, the playback screen changes between showing playing time and the current track number.

To switch to the CD function from other functions
Press CD PLAY/PAUSE 9.

If a previously played disc has been set, playback will start automatically. Press STOP 11 9 to stop playback if necessary.

Other operations

Table with 2 columns: To (Pause playback, Stop playback, Select a folder, Select a track/file, Find a point in a track/file) and Do this (Press CD PLAY/PAUSE 9, Press STOP 11 9, Press TUNE/□ + or - 3, Press << or >> 5, Hold down << or >> 5 during playback)

Note

Resume Play is cancelled in the following cases:
- When you open the CD compartment cover.
- When you turn off the power.

Example of folder structure and playing order
The playing order of the folders and files is as follows. However, the playing order may differ from the original order on the disc, depending on the recording method used.

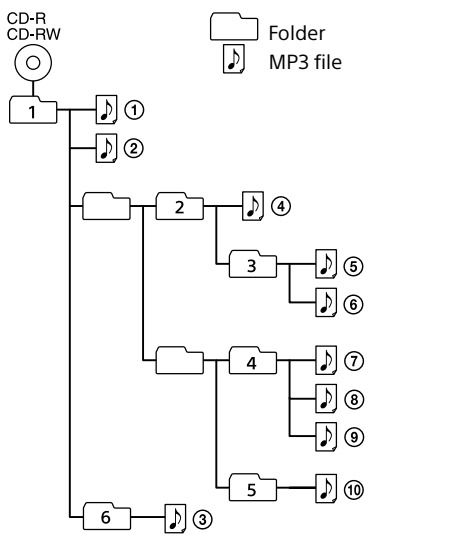

Notes on MP3 discs

- When a disc is loaded, the unit reads all the files on that disc. During this time, "READ" is flashing.
We recommend that non-MP3 files or unnecessary folders are excluded when creating MP3 discs.
During playback, audio files other than MP3 files are skipped even if those files are included in a folder.
This system can only play MP3 files that have a file extension of ".mp3".

Listening to the radio

- 1 Press < 1 to turn on the power of the unit.
2 Adjust the antenna for optimum reception.

FM

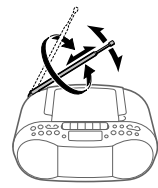

Extend the telescopic antenna 17 and adjust its length and angle for optimum reception.

AM

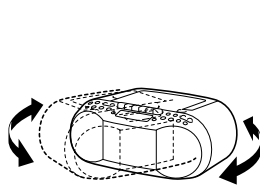

Reorient the unit itself for optimum reception (a ferrite bar antenna is built into the unit).

3 Press FM/AM 2 repeatedly to select the "FM" or "AM" band.

4 Hold down TUNE/□ + or - 3 until the frequency digits begin to change on the display. The unit automatically scans the radio frequencies and stops when it finds a clear station. If you cannot tune to a station using automatic tuning mode, press TUNE/□ + or - 3 repeatedly to change the frequency step by step.

- When an FM stereo broadcast is received, "ST" lights up on the display.
Tips: The unit of frequency of tuned stations is MHz for the FM band and kHz for the AM band. If the stereo FM reception is noisy, press PLAY MODE 10 repeatedly until "Mono" appears on the display. You will lose the stereo effect, but the reception will be improved.

To improve radio reception

Use the radio in a place where radio signals can be easily received such as near a window. Also, adjust the antenna (FM) or reorient the unit itself (AM) for good reception.

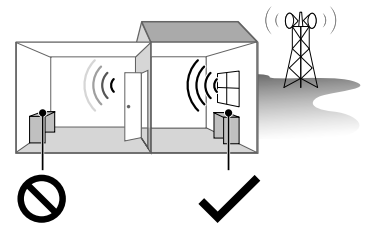

Areas with poor reception: Far from windows, etc.
Areas with good reception: Near windows, etc.

If the reception problem still persists, try changing the installation location. Avoid places such as the following:

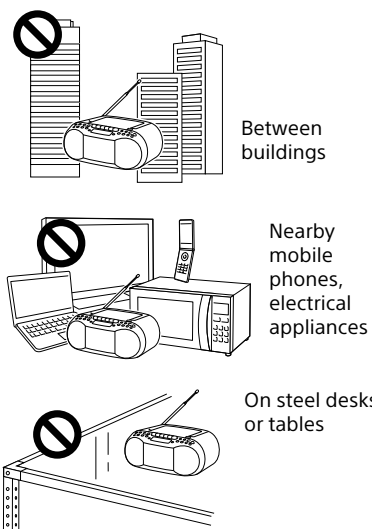

Presetting radio stations

You can store radio stations in the unit's memory. You can preset up to 30 radio stations, 20 for FM and 10 for AM.

- 1 Press < 1 to turn on the power of the unit.
2 Press FM/AM 2 repeatedly to select the "FM" or "AM" band.
3 Hold down FM/AM 2 until "AUTO" flashes on the display.



4 Press DISPLAY/ENTER 11 to store the station. The stations are stored in memory from lower frequencies to higher ones.

If a station cannot be preset automatically
You need to preset a station with a weak signal manually.

- 1 Press FM/AM 2 repeatedly to select a band.
2 Tune to the desired station.

3 Hold down DISPLAY/ENTER 11 until "FM-xx" or "AM-xx" flashes on the display. (Example: FM)



4 Press PRESET + or - 5 until the preset number for the station you want flashes on the display.

5 Press DISPLAY/ENTER 11 to store the station. If another station is already assigned to the selected preset number, that station is replaced by the new one. If you want to cancel presetting the station, press STOP 11 9.

Tip: The preset radio stations remain in the unit's memory even in the following situations.
-The AC power cord is unplugged.
-The batteries are removed.

Listening to preset radio stations

- 1 Press < 1 to turn on the power of the unit.
2 Press FM/AM 2 repeatedly to select the "FM" or "AM" band.
3 Press PRESET + or - 5 to select a stored preset number for the desired radio station.

Tip: By repeatedly pressing DISPLAY/ENTER 11 while listening to the radio, the radio information changes between showing the preset number and the frequency. The preset number display automatically returns to the frequency display after 2 seconds have elapsed.

Presetting stations to FAVORITE RADIO STATIONS buttons

You can preset up to three favorite stations to the three FAVORITE RADIO STATIONS (-SET) 12 buttons. Assign one FM or AM program for each button.

- 1 Press FM/AM 2 repeatedly to select the band "FM" or "AM."
2 Tune to the station you want to preset.
3 Press and hold the desired FAVORITE RADIO STATIONS (-SET) 12 until you hear a beep. The tuned station is preset to the selected button of FAVORITE RADIO STATIONS (-SET) 12 and the same number as that of the button will light up on the display.

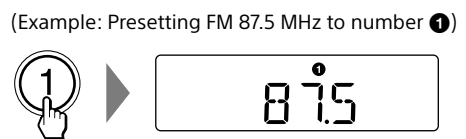

To change the preset station

Repeat steps 1 to 3. The preset station on the button will be replaced by the new one.

Listening to preset stations with FAVORITE RADIO STATIONS buttons

Press the desired FAVORITE RADIO STATIONS (-SET) 12 button.

Note: To prevent the preset from being changed by mistake, do not hold down the button. If doing so, the preset on the button will be replaced by the currently tuned station.

Playing a tape

Check the following items before starting operation.
Use Type I (normal) tapes only. Type II (high position), Type III (ferro-chrome) and Type IV (metal) tapes are not supported.
If there is tape slack, rewind the slack using a pencil to avoid damaging the tape or the unit.

- 1 Press MUTE 4, insert a cassette tape into the cassette tape compartment 2, and then close the compartment cover.

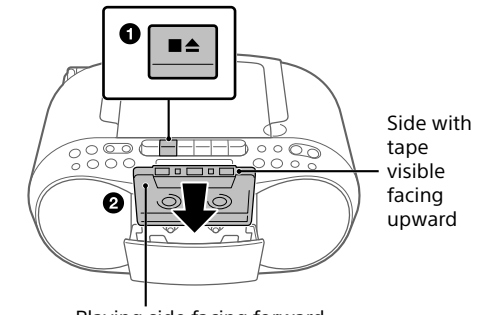

2 Press < 4 to start playback.

Other operations

Table with 2 columns: To (Stop playback, Pause playback, Fast-forward or rewind, Eject the cassette) and Do this (Press MUTE 4, Press II 4, Press << or >> 4, Press MUTE 4).

Notes

- Do not turn off the power during the tape playback. Doing so may cause malfunction.
If the tape is wound to the beginning or end and << 4 or >> 4 is not released, "STOP TAPE" will flash on the display.
"STOP TAPE" starts flashing 8 minutes after a fast-forward << 4 or rewind >> 4 operation.

Recording on a tape

Check the following items before starting operation.
Use Type I (normal) tapes only. Type II (high position), Type III (ferro-chrome) and Type IV (metal) tapes are not supported.
Make sure that the overwrite protection tab has not been removed.
Be sure to connect the AC power cord to avoid an unexpected recording failure.

- 1 Press < 1 to turn on the power of the unit, and then prepare the source you want to record.

To record CD-DA tracks or MP3 files on a disc
Place a disc in the CD compartment. Make sure not to start playback.

To record a radio program
Press FM/AM 2 repeatedly to select a band and tune to the desired station.

To record sound from a connected optional component
Press AUDIO IN 8 and connect an optional component such as a TV, portable digital music player, etc. to the AUDIO IN jack 15.

- 2 Press MUTE 4, insert a cassette tape into the cassette tape compartment 2, and then close the compartment cover.

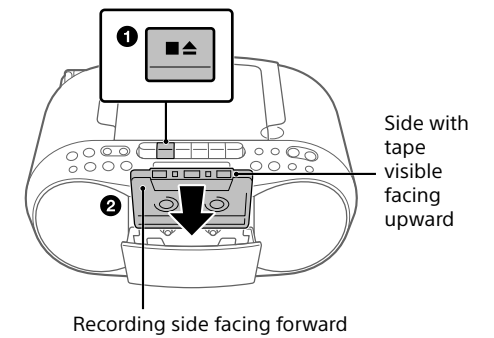

- 3 Press < 4 to start recording (the play button < 4 will depress automatically at the same time).

When recording from a disc

Playback starts automatically and recording of all the tracks/files on the disc proceeds from the first track/file.

When recording a radio program or sound from a connected optional component

Recording continues until the tape reaches the end.

Note: When the time set on the Sleep Timer has elapsed during recording, the "SLEEP" indicator will start flashing but the unit will not turn off.

Tips: Adjusting the volume or the audio emphasis will not affect the recording level. If the AM program makes whistling sound after you have selected the position of IS (Interference Suppress Switch) that may decrease the noise.

Other operations

Table with 2 columns: To (Stop recording, Pause recording) and Do this (Press MUTE 4, Press II 4).

