



Akono™ Headset HBH-300



User Guide
User Guide
User Guide
User Guide

FCC statement

This device complies with part 15 of the FCC rules. Operation is subject to the following two conditions: (1) This device may not cause harmful interference, and (2) This device must accept any interference received, including interference that may cause undesired operation.

Sony Ericsson HBH-300

First edition (March 2004)
This manual is published by Sony Ericsson Mobile Communications AB, without any warranty. Improvements and changes to this manual necessitated by typographical errors, inaccuracies of current information, or improvements to programs and/or equipment, may be made by Sony Ericsson Mobile Communications AB at any time and without notice. Such changes will, however, be incorporated into new editions of this manual. All rights reserved.

©Sony Ericsson Mobile Communications AB, 2004

Publication number: LZT 108 6882/X R1A

Some of the services in this manual are not supported by all networks. This also applies to the GSM International Emergency Number 112. Contact your network operator or service provider if you are in doubt whether you can use a particular service or not.

The Bluetooth word mark and logos are owned by the Bluetooth SIG, Inc. and any use of such marks by Sony Ericsson is under license.

Akono™ Headset
HBH-300

English
English
English
English

Introduction
Introduction
Introduction
Introduction

2

Akono™ Headset HBH-300
The Akono™ Headset HBH-300 can be connected to any device with Bluetooth wireless technology that supports the handsfree or headset profile. This user guide focuses on usage with a Sony Ericsson mobile phone.

Akono™ Headset HBH-300
The Akono™ Headset HBH-300 can be connected to any device with Bluetooth wireless technology that supports the handsfree or headset profile. This user guide focuses on usage with a Sony Ericsson mobile phone.

Akono™ Headset HBH-300
The Akono™ Headset HBH-300 can be connected to any device with Bluetooth wireless technology that supports the handsfree or headset profile. This user guide focuses on usage with a Sony Ericsson mobile phone.

Akono™ Headset HBH-300
The Akono™ Headset HBH-300 can be connected to any device with Bluetooth wireless technology that supports the handsfree or headset profile. This user guide focuses on usage with a Sony Ericsson mobile phone.

Front
Front
Front
Front

3

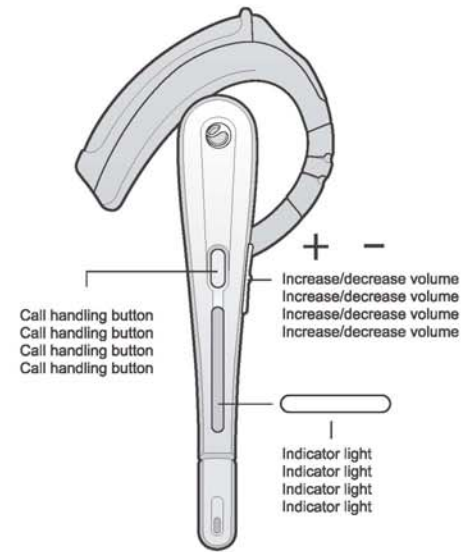

Back
Back
Back
Back

4

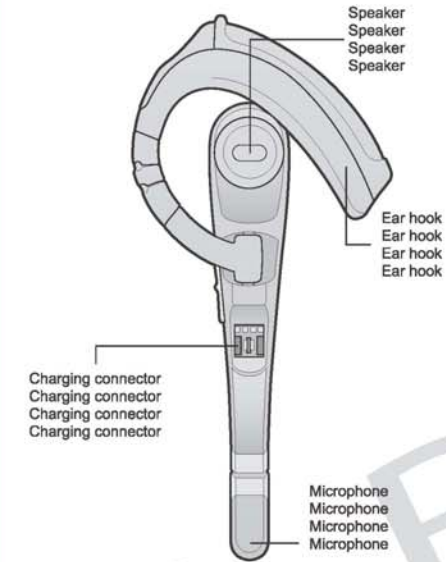

User Guide symbols
User Guide symbols
User Guide symbols
User Guide symbols

5

Press and release Press and release Press and release	Steady red light Steady red light Steady red light Steady red light
Press and hold Press and hold Press and hold	Long green flash Long green flash Long green flash Long green flash
Steady green light Steady green light Steady green light	Green flash Green flash Green flash Green flash
Steady green light Steady green light Steady green light	Red flash Red flash Red flash Red flash

Sony Ericsson

Getting started
Getting started
Getting started
Getting started

6

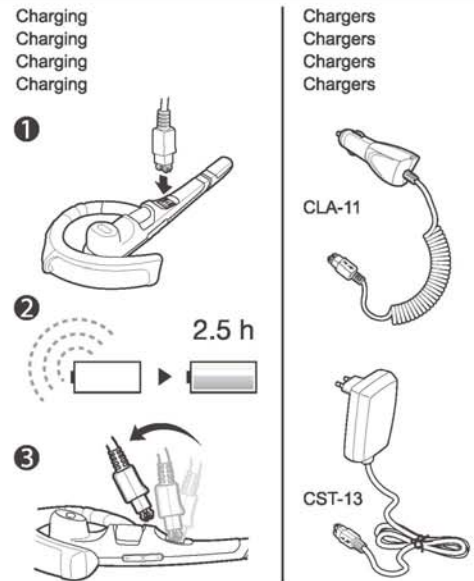

Adding the headset to the phone
Adding the headset to the phone
Adding the headset to the phone
Adding the headset to the phone

7

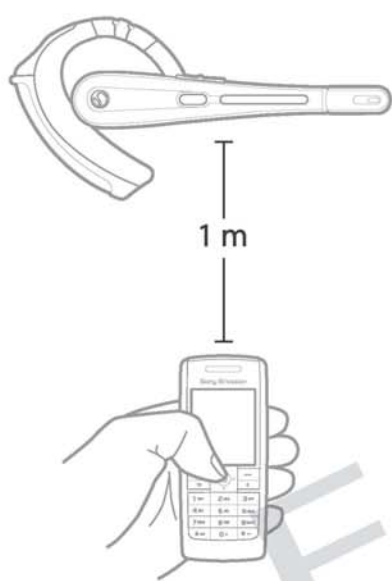

8

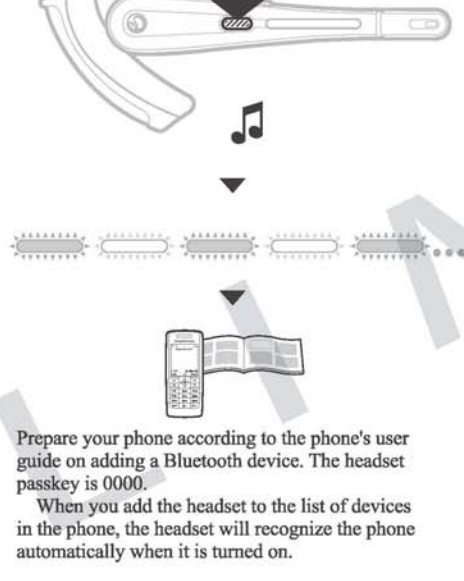

9

You only need to add the headset to the phone once. If you want to use the headset with a new phone, you need to add it to that phone. (See page 26.)

Prepare your phone according to the phone's user guide on adding a Bluetooth device. The headset passkey is 0000.

When you add the headset to the list of devices in the phone, the headset will recognize the phone automatically when it is turned on.

You only need to add the headset to the phone once. If you want to use the headset with a new phone, you need to add it to that phone. (See page 26.)

10

Prepare your phone according to the phone's user guide on adding a Bluetooth device. The headset passkey is 0000.

When you add the headset to the list of devices in the phone, the headset will recognize the phone automatically when it is turned on.

You only need to add the headset to the phone once. If you want to use the headset with a new phone, you need to add it to that phone. (See page 26.)

Range
Range
Range
Range

11

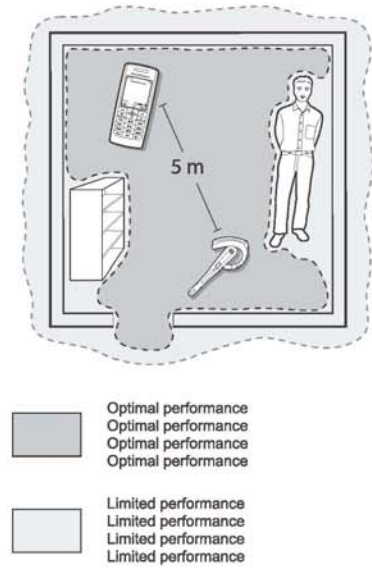

Putting the headset on
Putting the headset on
Putting the headset on
Putting the headset on

12

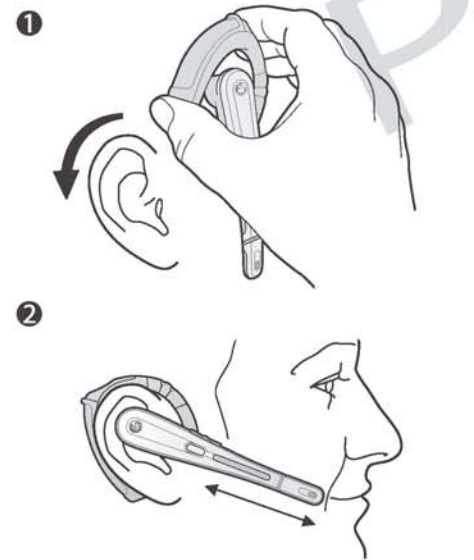

Left-ear use
Left-ear use
Left-ear use
Left-ear use

13

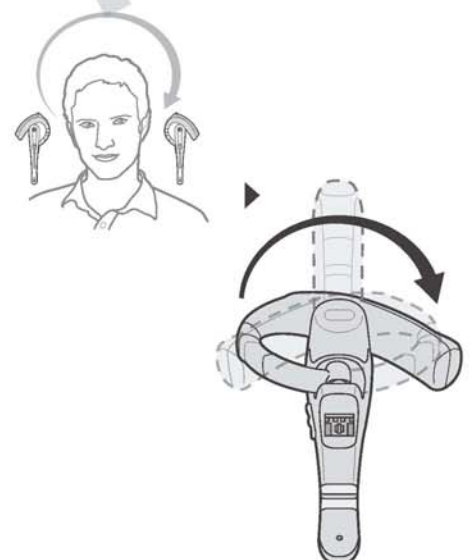

Calling
Calling
Calling
Calling

14

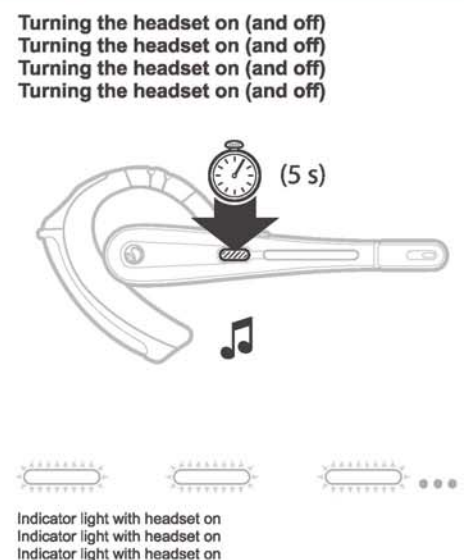

Answering a call
Answering a call
Answering a call
Answering a call

15

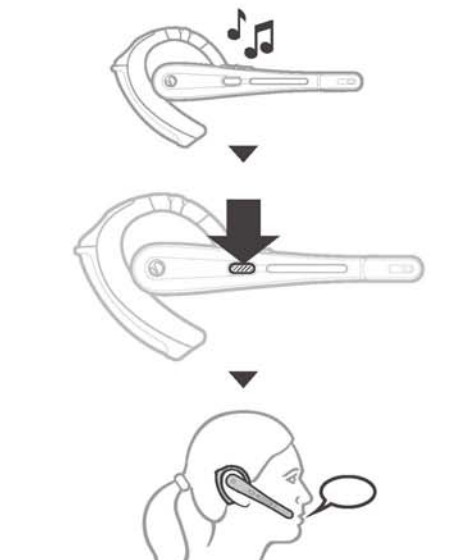

Making a call
Making a call
Making a call
Making a call

16

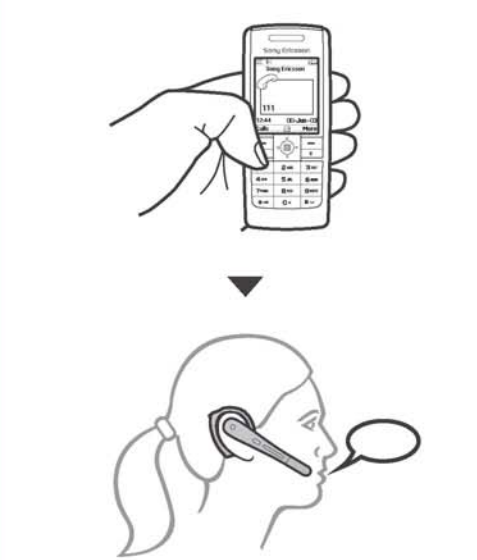

www.SonyEricsson.com



Sony Ericsson Mobile Communications AB
SE-221 88 Lund, Sweden

LZT 108 6882/X R1A
Printed in Hungary

Using voice commands
Using voice commands
Using voice commands
Using voice commands

17

Voice commands, such as dial, redial, answer and reject, can be very useful when you are using the headset. For more information on voice commands, refer to the phone's user guide.

Voice commands, such as dial, redial, answer and reject, can be very useful when you are using the headset. For more information on voice commands, refer to the phone's user guide.

Voice commands, such as dial, redial, answer and reject, can be very useful when you are using the headset. For more information on voice commands, refer to the phone's user guide.

Voice commands, such as dial, redial, answer and reject, can be very useful when you are using the headset. For more information on voice commands, refer to the phone's user guide.

Making a call using voice commands
Making a call using voice commands
Making a call using voice commands
Making a call using voice commands

18

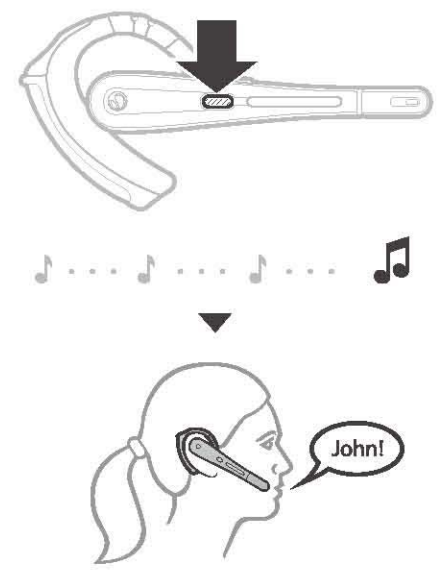

Transferring sound
Transferring sound
Transferring sound
Transferring sound

19

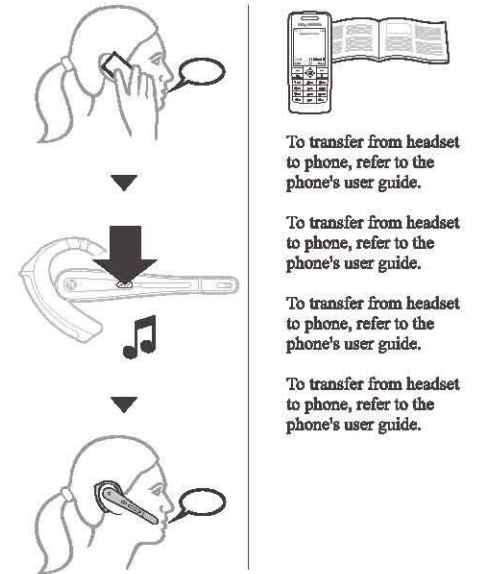

To transfer from headset to phone, refer to the phone's user guide.

To transfer from headset to phone, refer to the phone's user guide.

To transfer from headset to phone, refer to the phone's user guide.

To transfer from headset to phone, refer to the phone's user guide.

Ending a call
Ending a call
Ending a call
Ending a call

20

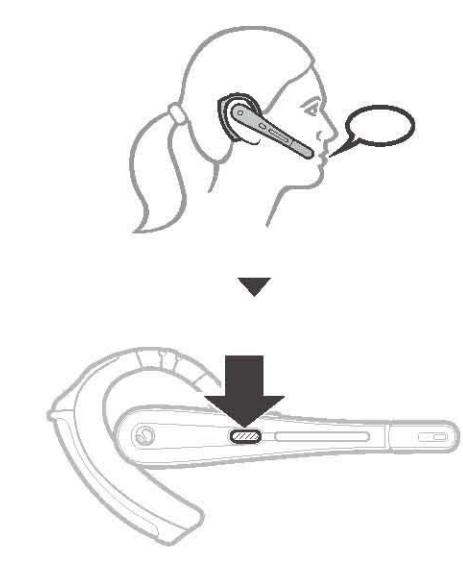

Rejecting a call
Rejecting a call
Rejecting a call
Rejecting a call

21

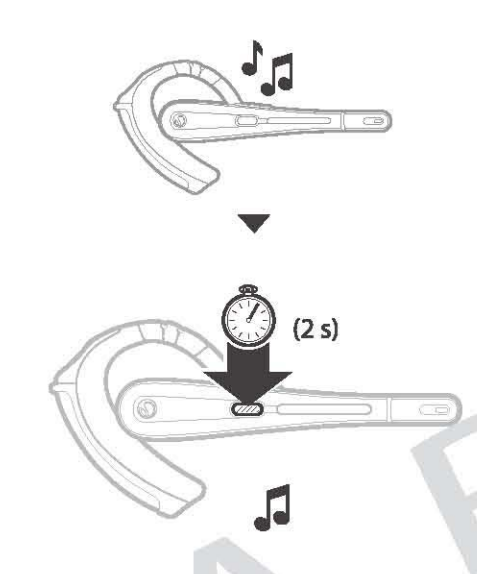

Turning the microphone off (and on)
Turning the microphone off (and on)
Turning the microphone off (and on)
Turning the microphone off (and on)

22

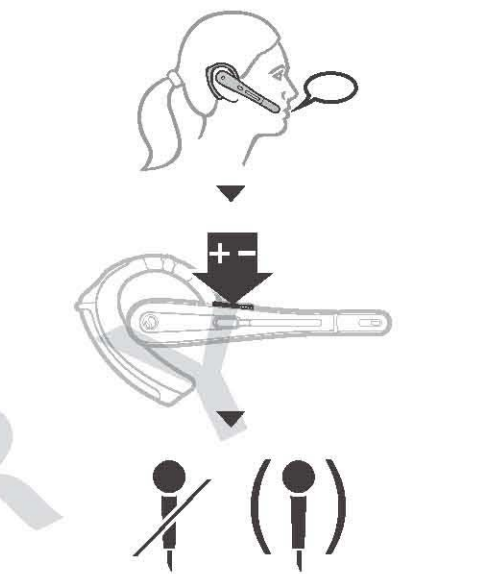

Settings
Settings
Settings
Settings

23

Battery status (in standby mode)
Battery status (in standby mode)
Battery status (in standby mode)
Battery status (in standby mode)

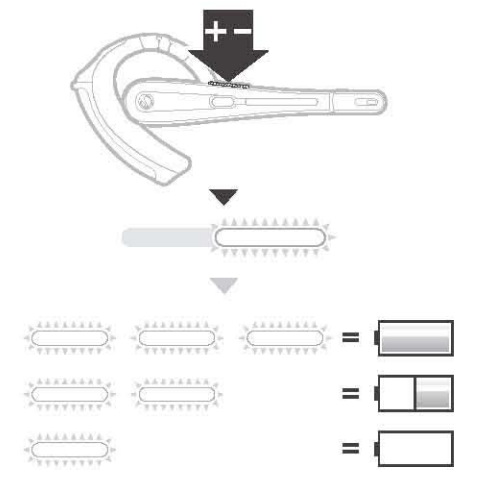

Adjusting ring volume (in standby mode)
Adjusting ring volume (in standby mode)
Adjusting ring volume (in standby mode)
Adjusting ring volume (in standby mode)

24

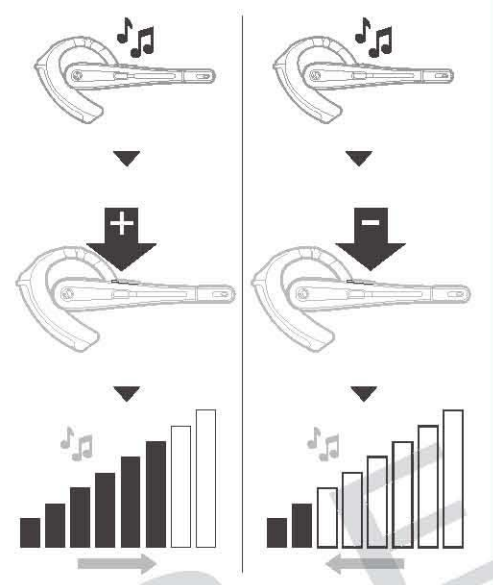

Adjusting speaker volume (during a call)
Adjusting speaker volume (during a call)
Adjusting speaker volume (during a call)
Adjusting speaker volume (during a call)

25

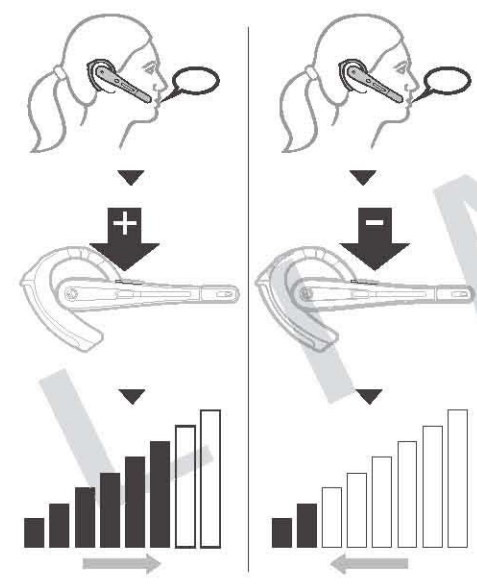

Adding the headset to a new phone
Adding the headset to a new phone
Adding the headset to a new phone
Adding the headset to a new phone

26

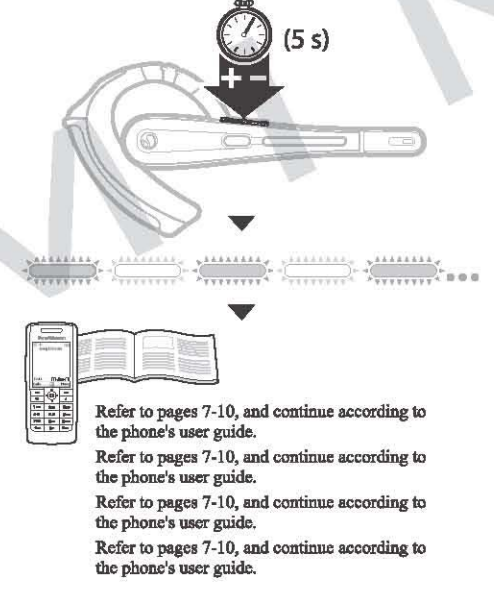

Refer to pages 7-10, and continue according to the phone's user guide.
Refer to pages 7-10, and continue according to the phone's user guide.
Refer to pages 7-10, and continue according to the phone's user guide.
Refer to pages 7-10, and continue according to the phone's user guide.

Resetting the headset
Resetting the headset
Resetting the headset
Resetting the headset

27

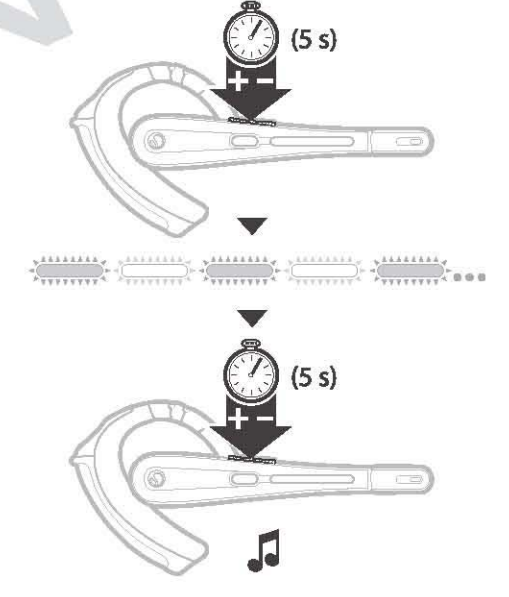

Attaching strap
Attaching strap
Attaching strap
Attaching strap

28

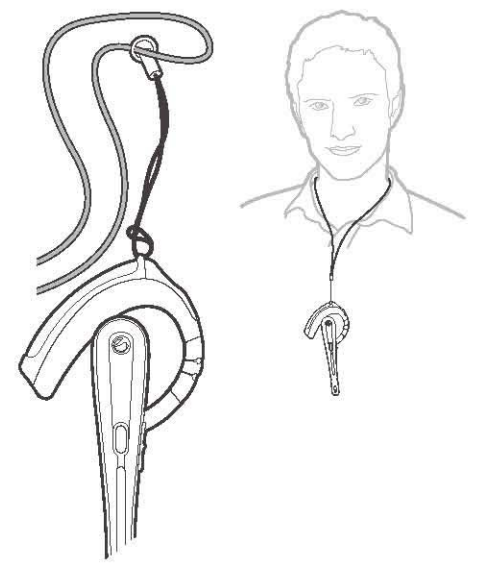

Troubleshooting
Troubleshooting
Troubleshooting
Troubleshooting

29

No connection to phone
Make sure that the headset is charged and within range of the phone. The settings in the phone may not be correct. Check or redo the settings in the phone for adding a Bluetooth device.

The headset is automatically switched off
• The battery is too low. The indicator light on the headset flashes red and you hear a low beep.
• The headset switches off if you do not add it to the phone within 10 minutes.

Nothing happens when connecting charger
It may take over 15 minutes before the indicator light shows that the headset is charging.

www.sonyericsson.com/support/

No connection to phone
Make sure that the headset is charged and within range of the phone. The settings in the phone may not be correct. Check or redo the settings in the phone for adding a Bluetooth device.

The headset is automatically switched off
• The battery is too low. The indicator light on the headset flashes red and you hear a low beep.
• The headset switches off if you do not add it to the phone within 10 minutes.

30

Nothing happens when connecting charger
It may take over 15 minutes before the indicator light shows that the headset is charging.

www.sonyericsson.com/support/

No connection to phone
Make sure that the headset is charged and within range of the phone. The settings in the phone may not be correct. Check or redo the settings in the phone for adding a Bluetooth device.

The headset is automatically switched off
• The battery is too low. The indicator light on the headset flashes red and you hear a low beep.
• The headset switches off if you do not add it to the phone within 10 minutes.

Nothing happens when connecting charger
It may take over 15 minutes before the indicator light shows that the headset is charging.

www.sonyericsson.com/support/

No connection to phone
Make sure that the headset is charged and within range of the phone. The settings in the phone may not be correct. Check or redo the settings in the phone for adding a Bluetooth device.

31

The headset is automatically switched off
• The battery is too low. The indicator light on the headset flashes red and you hear a low beep.
• The headset switches off if you do not add it to the phone within 10 minutes.

Nothing happens when connecting charger
It may take over 15 minutes before the indicator light shows that the headset is charging.

www.sonyericsson.com/support/

Indicator lights
Indicator lights
Indicator lights
Indicator lights

32

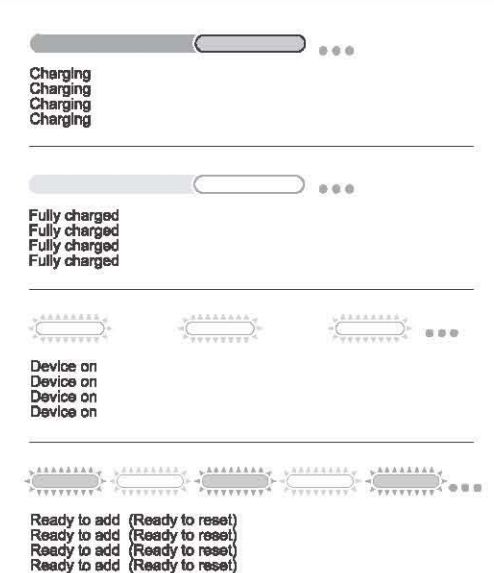

Declaration of conformity

33

We, Sony Ericsson Mobile Communications AB of Nya Vattentorget 221 88 Lund, Sweden

declare under our sole responsibility that our product

Sony Ericsson type DDA-0001003

to which this declaration relates is in conformity with the appropriate standards EN 300 328, EN 301 489-17, En 301 489-7 and EN 60950 following the provisions of Radio Equipment and Telecommunication Equipment directive 1995/5/EC with requirements covering EMC directive 89/336/EEC and Low Voltage directive 73/23/EEC.

Lund, March 2004

Ulf Persson CE 0682

Ulf Persson, Head of Product Business Unit Accessories