



## Bluetooth™ Headset HBH-610



User Guide  
Guía del usuario  
用户指南  
使用手册

### FCC statement

This device complies with part 15 of the FCC rules. Operation is subject to the following two conditions: (1) This device may not cause harmful interference, and (2) This device must accept any interference received, including interference that may cause undesired operation.

### Sony Ericsson HBH-610

First edition (May 2005)  
This manual is published by Sony Ericsson Mobile Communications AB, without any warranty. Improvements and changes to this manual necessitated by typographical errors, inaccuracies of current information, or improvements to programs and/or equipment, may be made by Sony Ericsson Mobile Communications AB at any time and without notice. Such changes will, however, be incorporated into new editions of this manual. All rights reserved.

©Sony Ericsson Mobile Communications AB, 2005

Publication number: LZT 108 7761/1 R1A

Some of the services in this manual are not supported by all networks. This also applies to the GSM International Emergency Number 112. Contact your network operator or service provider if you are in doubt whether you can use a particular service or not.

The Bluetooth word mark and logos are owned by the Bluetooth SIG, Inc. and any use of such marks by Sony Ericsson is under license.

This product is leadfree and halogenfree.

Bluetooth™ Headset  
HBH-610

English  
Español  
简体中文  
繁體中文

Sony Ericsson

User Guide symbols (continued)  
Símbolos de la guía del usuario (continuación)  
《用户指南》符号 (续)  
使用手册符号 (续前)

Green flash Flash verde 綠灯闪烁 閃綠燈	Ring signal Señal de timbre 响铃信号 鈴聲
Red flash Flash rojo 红灯闪烁 閃紅燈	Beep tone Tono de pitido 蜂鸣声 嗶聲

Getting started  
Introducción  
入门  
準備開始

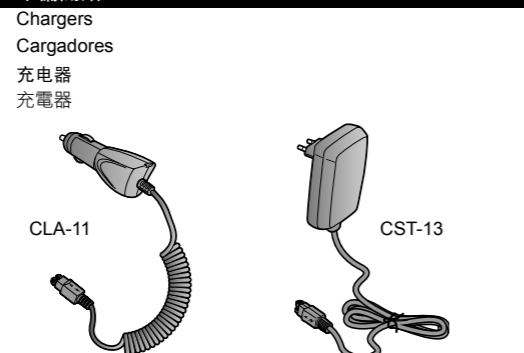

First time use: Charge approximately 8 hours before using the headset. (For battery capacity see p. 31.)

Utilización por primera vez: Carguelo aproximadamente durante 8 horas antes de utilizar el auricular. (Consulte en la p. 31 la capacidad de la batería.)

首次使用: 首次使用手机前, 请将电池充电约 8 小时。(有关电池容量的信息, 请参见第 31 页。)  
首次使用時: 使用耳機前, 請先充電 8 小時左右。(電池容量的說明, 見第 31 頁。)

A - Adding the headset for the first time or after a reset  
A - Añadir el auricular por primera vez o después de reiniciar  
A - 首次添加耳机, 或在重新设定后添加耳机  
A - 首次或重設後加入耳機

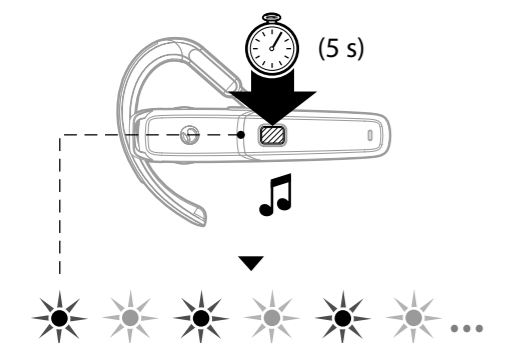

Make sure the indicator light flashes red/green. Asegúrese de que el indicador luminoso parpadea en rojo/verde.

B - Adding the headset again or to another phone  
B - Añadir el auricular de nuevo o añadirlo a otro teléfono  
B - 重新添加耳机, 或将耳机添加到另一手机  
B - 耳機再次加入或加入另一台手機  
Make sure the headset is turned on. (See p. 16.)  
Asegúrese de que el auricular está encendido. (Consulte la página 16.)  
确保耳机已开启。(请参见第 16 页)  
務請先將耳機開機。請參考第 16 頁。

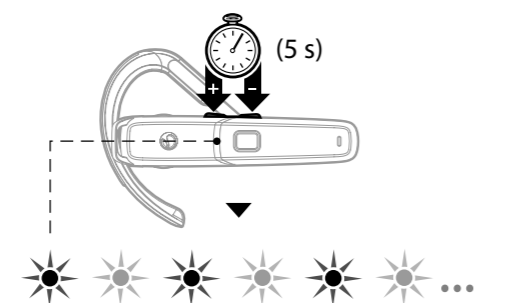

Ensure red / green indicator light flashes. 請檢查指示燈號碼為閃綠 / 紅燈。

Charging  
Carga  
充电  
充電

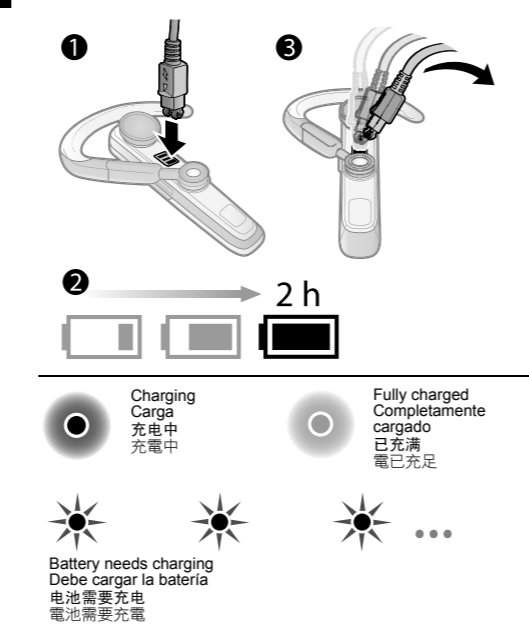

Range  
Alcance  
范围  
範圍

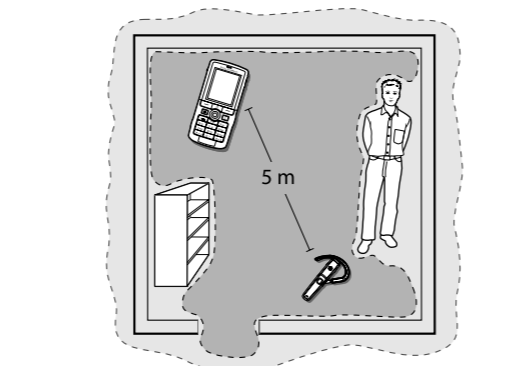

Optimal performance  
Rendimiento óptimo  
性能最佳  
最佳的作業範圍

Limited performance  
Rendimiento limitado  
性能受限制  
可接受的作業範圍

Front  
Parte delantera  
正面  
正面

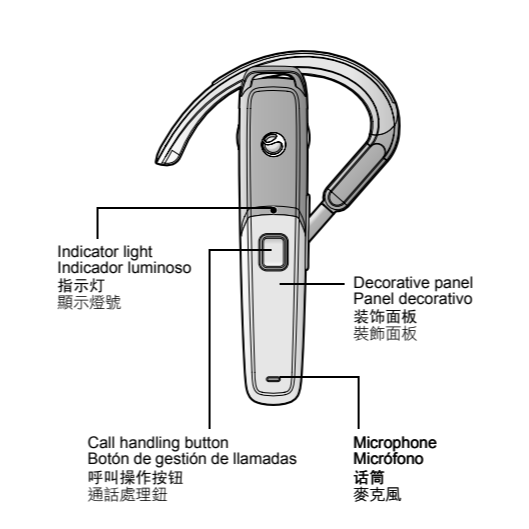

Back  
Parte posterior  
背面  
背面

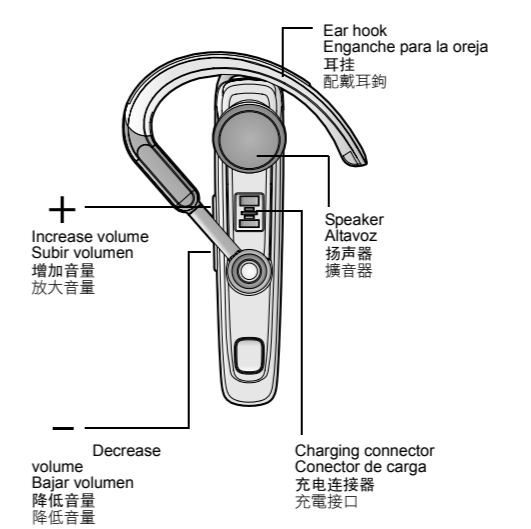

Adding the headset to the phone  
Añadir el auricular al teléfono  
将耳机添加到手机上  
將耳機連上手機

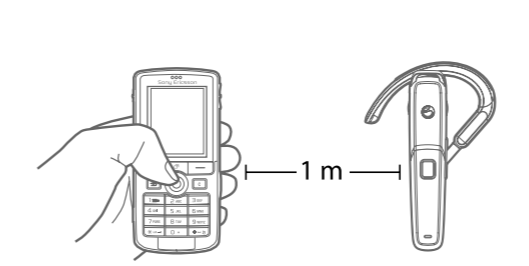

Before you can use your Bluetooth headset with your phone it has to be added once to the phone:

1. Prepare your headset according to A or B (see p. 12).
2. Follow the instructions from the phone user guide on how to turn on and then add a Bluetooth device to your phone. The passkey of the headset is 0000.

After you have added the headset to the list of Bluetooth devices in the phone, it will automatically connect to the phone as soon as it is turned on and within range.

Putting the headset on  
Forma de colocarse el auricular  
戴上耳机  
戴上耳機

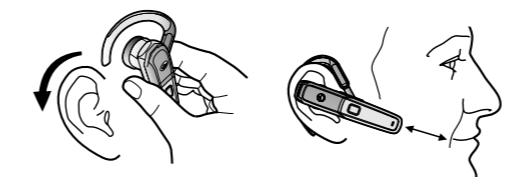

Left-ear use  
Utilización en la oreja izquierda  
使用左耳  
戴在左耳時

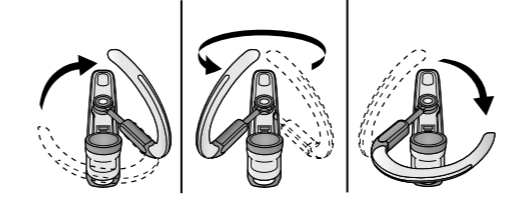

Para poder utilizar el auricular Bluetooth con el teléfono debe añadirlo al teléfono:

1. Prepare el auricular según A o B (consulte la p. 12).
2. Siga las instrucciones de la guía de usuario del teléfono sobre la forma de encender y posteriormente añadir un dispositivo Bluetooth a su teléfono. La clave maestra del auricular es 0000.

Después de añadir el auricular a la lista de dispositivos Bluetooth del teléfono, se conectará automáticamente al teléfono tan pronto como se encienda y dentro del alcance.

在将蓝牙耳机用于手机之前, 必须将它添加到手机上一次:

1. 依照 A 或 B (参见第 12 页) 将耳机准备好。
2. 按照手机用户指南中的说明, 正确开启蓝牙设备, 然后将它添加到手机上。耳机的识别码是 0000。

将耳机添加到手机的蓝牙设备列表中后, 耳机将在手机开启并处于服务区后自动连接手机。

Calling  
Llamadas  
拨叫  
通話

Turning the headset on (and off)  
Encender el auricular (y apagar)  
打开和关闭耳机  
開關耳機

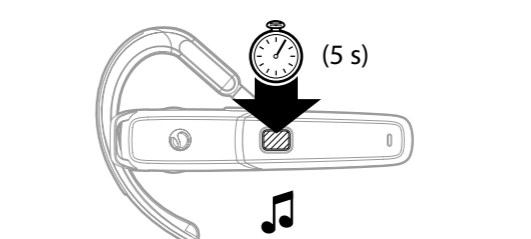

Indicator light when headset is on  
Indicador luminoso cuando el auricular está encendido  
耳机开启后, 指示灯亮  
耳機開機時的指示燈號

User Guide symbols  
Símbolos de la guía del usuario  
《用户指南》符号  
使用手册符号

Press and release Pulsar y soltar 按下后松开 壓放	Indicator light Indicador luminoso 指示灯 顯示燈號
Press and hold Mantener pulsado 按下并保持 按住	Steady red light Luz roja fija 持续红灯亮 持續的紅燈
Press simultaneously Pulsar simultáneamente 同时按住 同時按	Steady green light Luz verde fija 持续绿灯亮 持續的綠燈

Bluetooth (藍芽) 耳機可用於手機前, 需先加入手機一次, 方法如下:

1. 按第 12 頁 A 或 B 步驟, 將耳機準備好。(see p. 12).
2. 按手機使用手册的指令, 將 Bluetooth (藍芽) 裝置開啟並加入手機。耳機的識別碼為 0000。

將耳機加入手機的 Bluetooth (藍芽) 裝置清單後, 只要耳機開機且在有效範圍內, 就會自動連上手機。

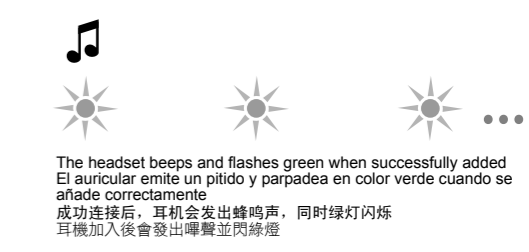

The headset beeps and flashes green when successfully added. El auricular emite un pitido y parpadea en color verde cuando se añade correctamente. 成功连接后, 耳机会发出蜂鸣声, 同时绿灯闪烁。耳機加入後會發出嗶聲並閃綠燈。

**Answering a call**  
**Contestar llamadas**  
接听电话  
受話

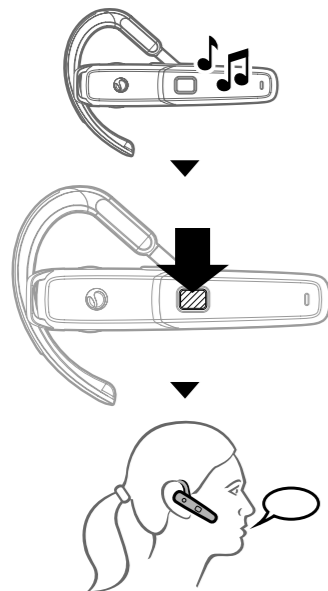

17 **Making a call**  
**Realizar llamadas**  
拨叫电话  
發話

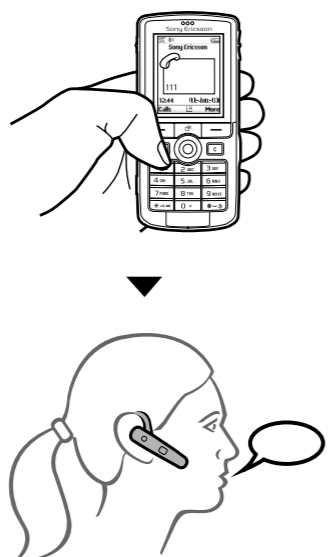

18 **Using voice commands**  
**Utilizar los comandos de voz**  
使用语音命令  
使用語音指令

Voice commands, such as dial, redial, answer and reject, can be very useful when you are using the headset. For more information on voice commands, and if your phone supports it, refer to the phone user guide.

Las funciones por comandos de voz, tales como marcar, remarcar, responder o rechazar una llamada, pueden ser muy útiles cuando se está utilizando el auricular. Si desea obtener más información sobre los comandos de voz, y si el teléfono lo admite, consulte la guía del usuario proporcionada con el teléfono.

语音命令如拨号、重拨、接听和拒绝等，在使用耳机时非常有用。有关语音命令的更多信息（如果手机支持），请参考手机的用户指南。

使用耳機時，撥號、重撥、接聽及拒絕等語音指令會非常有用。語音指令的詳細說明（手機支援語音指令時），請參考手機的使用手冊。

19 **Making a call using voice commands**  
**Realizar llamadas mediante comandos de voz**  
使用语音命令拨叫电话  
用語音指令發話

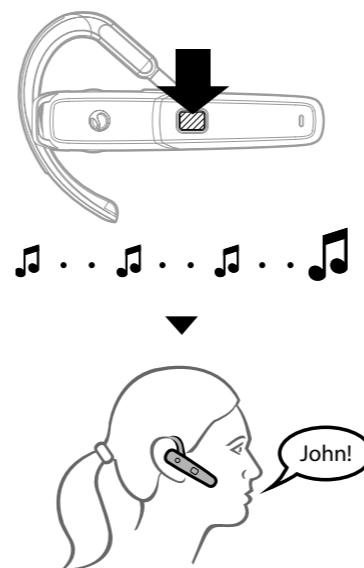

**Transferring sound**  
**Transferir sonidos**  
传送声音  
傳送聲音

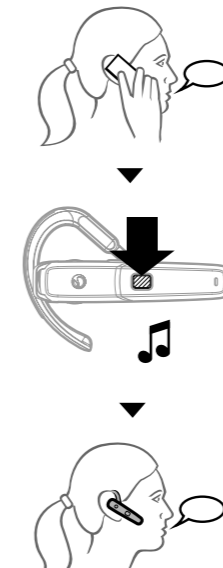

To transfer from headset to phone, refer to the phone user guide.

Si desea transferir sonidos del auricular al teléfono, consulte la guía del usuario.

要将声音从耳机传送到手机，请参考手机的用户指南。

將聲音自耳機轉到手機的方法，請參考手機的使用手冊。

21 **Ending a call**  
**Finalizar llamadas**  
挂断电话  
結束通話

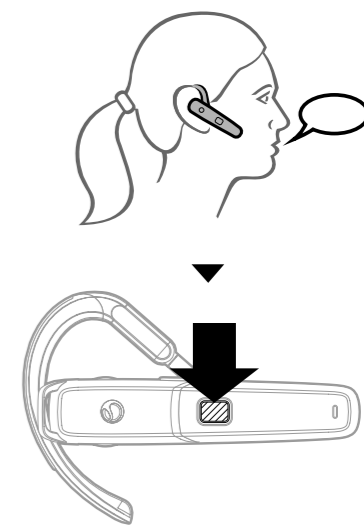

**Rejecting a call**  
**Rechazar llamadas**  
拒听电话  
拒接來電

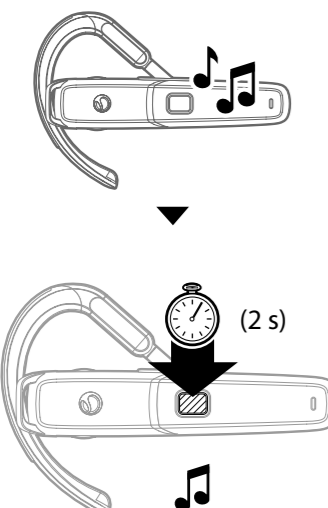

23 **Turning the microphone off (and on)**  
**Apagar (o encender) el micrófono**  
关闭和打开话筒  
開關麥克風

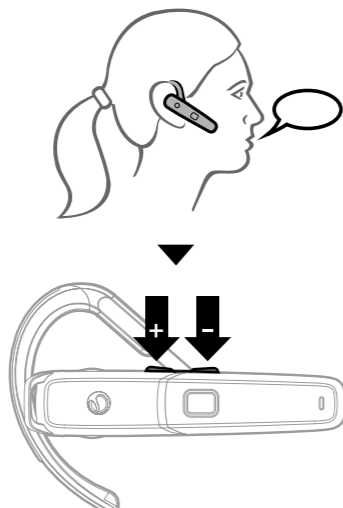

24 **Battery status**  
**Estado de la batería**  
电池状态  
電池狀態

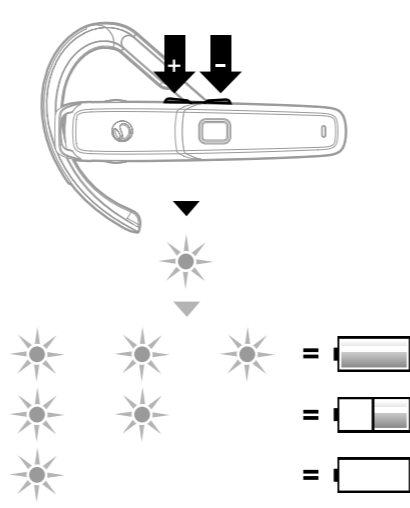

25 **Settings**  
**Preferencias**  
手机设定  
設定

**Adjusting ring volume (in standby mode)**  
**Ajustar el volumen del timbre (en modo de espera)**  
调整铃声音量（待机模式）  
待機模式下調整鈴聲音量

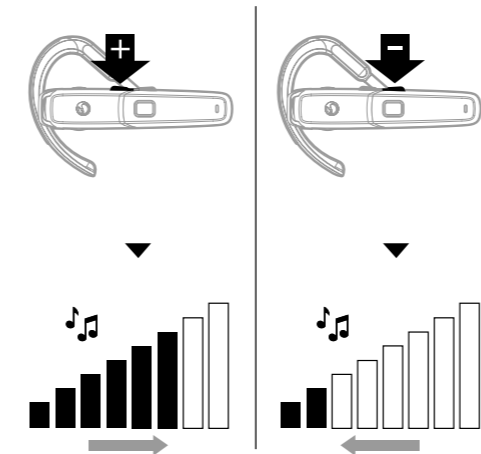

**Adjusting speaker volume**  
**Ajustar el volumen del altavoz**  
调整扬声器音量  
調整免持擴音的音量

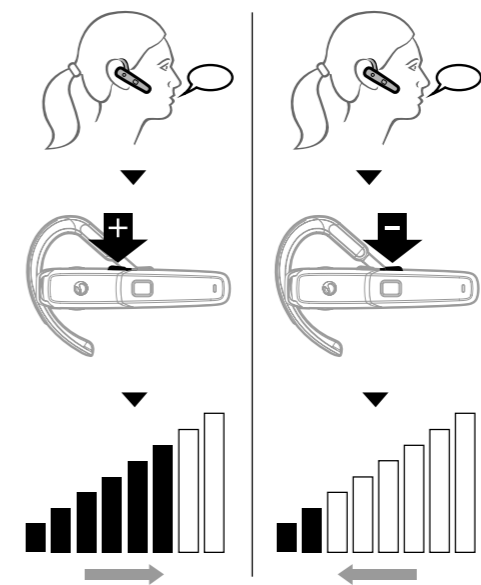

27 **Resetting the headset**  
**Reiniciar el auricular**  
重置耳机  
重設耳機

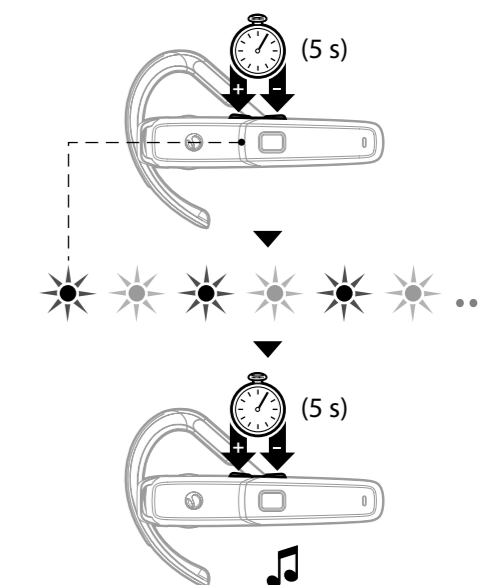

**Removing cover for regulatory information**  
**Extraer la cubierta para la información reguladora**  
取下显示一般信息的外壳  
取下護蓋，參考相關法規資訊

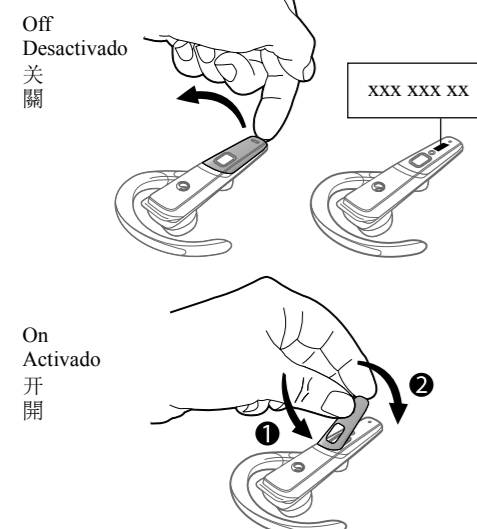

29 **Attaching strap**  
**Colocar el cordón**  
连接挂绳  
安裝吊帶

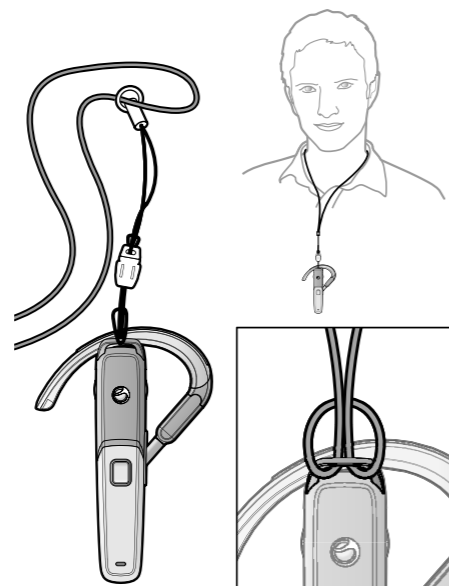

30 **Troubleshooting**  
**Resolución de problemas**  
疑难解答  
疑難排解

**No connection to phone**  
Make sure the headset is charged and within range of the phone. Check or redo the Bluetooth settings in the phone.

**The headset is automatically switched off**

- The battery is too low. The indicator light on the headset flashes red and you hear a low beep.
- The headset switches off if you do not add it to the phone within 10 minutes.

**Unexpected behaviour**  
Reset the headset (see p. 28).

**Battery capacity**  
A battery that has been infrequently used or a new one, could have reduced capacity. It may need to be recharged a number of times.

**No hay conexión con el teléfono**  
Asegúrese de que el manos libres esté cargado y dentro del alcance del teléfono. Compruebe los ajustes de Bluetooth o vuelva a configurarlos en el teléfono.

32 **El auricular se apaga solo**  
La batería tiene poca carga. El indicador luminoso del auricular parpadea en rojo y se oye un ligero pitido.  
El auricular se apaga si se tarda en enlazar un teléfono más de diez minutos.

**Comportamiento imprevisto**  
Reinicie al auricular (consulte la p. 28).

**Capacidad de la batería**  
Una batería que no se ha utilizado con frecuencia o una batería nueva pueden tener reducida la capacidad. Es posible que deba recargarla varias veces.

**无法与手机连接**  
确保耳机已充好电，并且在手机的有效范围内。检查或重新设定手机的蓝牙设置。

**耳机自动关闭**  
• 电池电量不足。耳机上的指示灯闪红灯，并可听到低蜂鸣音。  
• 如果 10 分钟内未将耳机添加到手机上，耳机将关闭。

**意外操作**  
重新设定耳机（请参见第 28 页）。

**电池容量**  
新电池或很久未用的电池可能达不到额定容量。它们可能需要多次充电。

**未連上手機**  
務請將耳機充電並置於手機的有效範圍內。檢查或重定手機的 Bluetooth（藍芽）設定。

**耳機自動關機**  
• 電池電量過低。耳機的顯示燈號閃紅燈且發出微嗶聲。  
• 耳機未在 10 分鐘內加入手機時即自動關機。

**非預期的現象**  
重設耳機，（請參考第 28 頁）。

**電池容量**  
新的或不常用的電池，電池容量可能較低。重複充電幾次後，可能有所改善。

33 **Declaration of conformity**

We, Sony Ericsson Mobile Communications AB of Nya Vattentornet 221 88 Lund, Sweden declare under our sole responsibility that our product **Sony Ericsson type DDA-0001006** to which this declaration relates is in conformity with the appropriate standards EN 300 328, EN 301 489-17, EN 301 489-7 and EN 60950 following the provisions of Radio Equipment and Telecommunication Equipment directive 1999/5/EC with requirements covering EMC directive 89/336/EEC and Low Voltage directive 73/23/EEC.  
Lund, May 2005

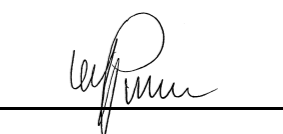
  
0682

Ulf Persson, Head of Product Business Unit Accessories  
We fulfill the requirements of the R&TTE Directive (99/5/EC).  
Cumplimos los requisitos de la Directiva R&TTE (99/5/EC)  
我们符合 R&TTE 指令 (99/5/EC) 要求。  
本公司符合 R&TTE Directive (99/5/EC) 中的規定。