

User guide

English
Language
Language
Language

MBS-100

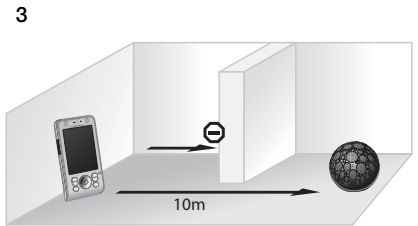
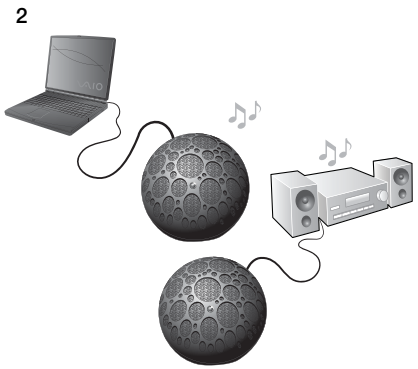

2

The speaker is powered on and in idle mode.
The speaker is powered on and in idle mode.

The battery charging is ready in power off mode.
The battery charging is ready in power off mode.

The speaker is in pairing mode.
The speaker is in pairing mode.

The speaker is in music mode.
The speaker is in music mode.

The battery is low
The battery is low

The speaker is powered on and in idle mode with low battery or charging.
The speaker is powered on and in idle mode with low battery or charging.

The speaker is in music mode. The battery is low or charging.
The speaker is in music mode. The battery is low or charging.

The battery is charging in power off mode.
The battery is charging in power off mode.

The battery charging is ready in power off mode.
The battery charging is ready in power off mode.

Language 1

Bluetooth™ portable speaker MBS-100
With the Bluetooth™ portable speaker MBS-100 you can enjoy wireless stereo audio from a phone or other Bluetooth device, such as a computer or a portable music player. When you receive or make a call, the music automatically pauses and starts playing again when the call ends. Your phone or other device should support the following Bluetooth profiles:

- Bluetooth Advanced Audio Distribution.
- Bluetooth Audio/Video Remote Control.

Product overview
Before using the speaker, see picture 1 for a product overview.

Charging
Before using your speaker for the first time, charge it with the supplied charger for 4 hours.

Turning the speaker on and off
To turn on the speaker
1. When the speaker is off, press the power key.
2. The speaker indicates power on. See picture 4.

To turn off the speaker
1. When the speaker is on, press the power key. See picture 1.
2. The speaker indicates power off. See picture 4.

Pairing the speaker
Before you can use your speaker with your phone it has to be paired with the phone. Follow the instructions in your phone User guide on how to turn on Bluetooth in the phone.
See your phone User guide on how to pair a Bluetooth device. If required, the speakers passcode is 0000.

Note: When you power on the speaker for the first time, it will automatically enter pairing mode.

To pair the speaker with the phone
1. Turn on Bluetooth in the phone.
2. Place the phone within 20 cm from the speaker.
3. Make sure the speaker is turned on. Press and hold down the Bluetooth key. See picture 1.
4. The speaker enters idle mode and flashes green when successfully paired. See picture 4.

Note: The speaker enters idle mode if you do not pair it with the phone within 10 minutes.

Range
When you have paired the speaker with your phone, you can listen to music as long as the speaker is turned on and within 10 metres (33 feet) of the phone, with no solid objects in between. Objects, walls and greater distance than five metres (16.5 feet) can affect the sound. See picture 3.

Listening to music
To listen to music
1. Start the media player in your phone to listen to music. If needed, follow the instructions from the phone User guide to select the music receiver.
2. The speaker indicates music mode. See picture 4.

Note: The music can only be controlled from the music source.

Adjusting volume
To adjust speaker volume
• The volume can only be adjusted from the music source. Follow the instructions from the source User guide.

Connecting to music equipment
To connect the speaker to other music equipment
• Connect other portable media players to line-in. See picture 2.
• Connect the speaker to other music equipment with line-out. See picture 2.

Note: The speaker exits pairing mode when the line-in cable is connected.

Battery
When the battery is too low, the indicator light flashes red. If you do not charge the speaker, it automatically turns off.

Troubleshooting
Unexpected behaviour
• Reset the speaker if it behaves unexpectedly.

Language 2

To reset the speaker
1. Power on the speaker
2. Press and hold the Bluetooth key to enter the pairing mode. The speaker starts to flash green and red.
3. Simultaneously press and hold both power key and Bluetooth key.
4. The speaker automatically turns off when the master reset is done.

The speaker is automatically turned off
1. The battery is too low. The indicator light on the speaker flashes red.
2. A battery that has been infrequently used or a new one, could have reduced capacity. It may need to be recharged a number of times.

No connection to the speaker
1. Make sure the speaker is charged and within range of the phone.
2. Check or redo the Bluetooth settings in the phone. See *Pairing the speaker*.

Reconnecting the speaker with the phone
To reconnect the speaker to the phone
1. Start the media player in your phone to listen to music. If needed, follow the instructions from the phone User guide to select the music receiver.
2. Press the Bluetooth key. The speaker reconnects to the last paired phone.
3. The speaker indicates music mode. See picture 4.

Pairing the speaker again or with another phone
To pair again or with another phone
1. Make sure the speaker is turned on.
1. Repeat the instruction for how to pair the speaker with a phone. See *To pair the speaker with the phone*.
2. 5 different streaming devices can be paired to speaker simultaneously. If a sixth device is paired to the speaker, it replaces the first device that has been paired to the speaker.

No sound in the connected music equipment
• Disconnect/connect the line-out connector

FCC statement
This device complies with part 15 of the FCC rules. Operation is subject to the following two conditions:
(1) This device may not cause harmful interference, and (2) This device must accept any interference received, including interference that may cause undesired operation.



Declaration of conformity MBS-100
We, Sony Ericsson Mobile Communications AB of Nya Vattentornet 221 88 Lund, Sweden declare under our sole responsibility that our product Sony Ericsson type DDA-0002015 to which this declaration relates is in conformity with the appropriate standards EN 300 328:V1.7.1, EN 301 489-17:V1.2.1, EN 301 489-7:V1.3.1 and EN 60950-1:2006 following the provisions of Radio Equipment and Telecommunication Equipment directive 1999/5/EC. Lund, September 2007

J. Sten **CE 0682**

Jacob Sten, Head of Product Business Unit Accessories
We fulfill the R&TTE Directive.
We fulfill the R&TTE Directive.



User guide
User guide
User guide
User guide

Sony Ericsson MBS-100
This User guide is published by Sony Ericsson Mobile Communications AB, without any warranty. Improvements and changes to this User guide necessitated by typographical errors, inaccuracies of current information, or improvements to programs and/or equipment, may be made by Sony Ericsson Mobile Communications AB at any time and without notice. Such changes will, however, be incorporated into new editions of this User guide. All rights reserved.

©Sony Ericsson Mobile Communications AB, 2007
Publication number: XXXX-XXXX.P1C

Some of the services in this User guide are not supported by all networks. This also applies to the GSM International Emergency Number 112. Contact your network operator or service provider if you are in doubt whether you can use a particular service or not.

The Bluetooth word mark and logos are owned by the Bluetooth SIG, Inc. and any use of such marks by Sony Ericsson is under license. Sony is a trademark or registered trademark of Sony Corporation. Ericsson is a trademark or registered trademark of Telefonaktiebolaget LM Ericsson.

This product is leadfree and halogenfree.

Disposal of electrical and electronic equipment

This symbol indicates that all electrical and electronic equipment included shall not be treated as household waste. Instead it shall be left at the appropriate collection point for recycling of electrical and electronic equipment. By ensuring this product is disposed of correctly, you will help prevent potential negative consequences for the environment and human health, which could otherwise be caused by inappropriate waste handling of this product. The recycling of materials will help to conserve natural resources. For more detailed information about recycling this product, please contact your local city office, your household waste disposal service or the shop where you purchased the product.



Indicator light

Bluetooth key On/off key
Bluetooth key On/off key

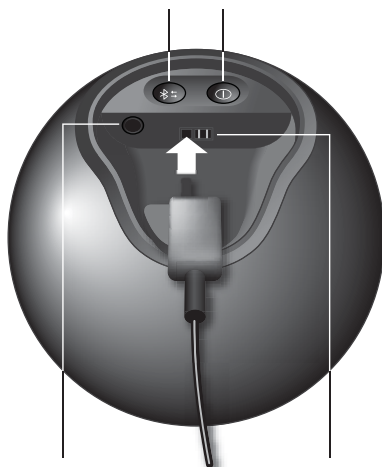

Line-in/line-out Power connector
Line-in/line-out Power connector

2

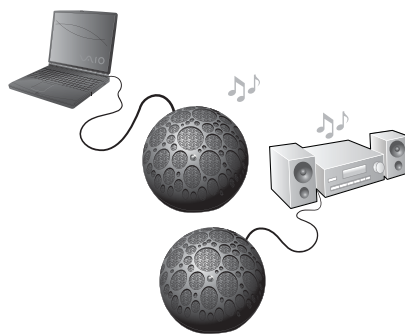

3

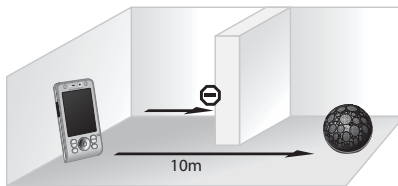

4

The speaker is powered on and in idle mode.
The speaker is powered on and in idle mode.



The battery charging is ready in power off mode.
The battery charging is ready in power off mode.



The speaker is in pairing mode.
The speaker is in pairing mode.



The speaker is in music mode.
The speaker is in music mode.



The battery is low
The battery is low



The speaker is powered on and in idle mode with low battery.
The speaker is powered on and in idle mode with low battery.



The speaker is in music mode. The battery is low or charging.
The speaker is in music mode. The battery is low or charging.



The battery is charging in power off mode.
The battery is charging in power off mode.



The battery charging is ready in power off mode.
The battery charging is ready in power off mode.

