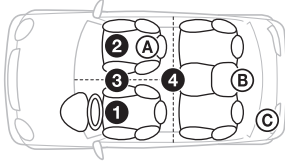

POSITION (listening position)**F/R POSITION** (front/rear position)

Simulates a natural sound field by delaying the sound output from speakers to suit your position:

- 1 [FRONT L] (front left),
- 2 [FRONT R] (front right),
- 3 [FRONT] (center front),
- 4 [ALL] (center of your car),
- [CUSTOM] (position set by "SongPal"),
- [OFF] (no position set)

ADJ POSITION* (adjust position)

Fine-tunes the listening position setting: [+3] – [CENTER] – [-3].

SW POSITION* (subwoofer position)

- A [NEAR] (near),
- B [NORMAL] (normal),
- C [FAR] (far)

BALANCE

Adjusts the sound balance: [RIGHT-15] – [CENTER] – [LEFT-15].

FADER

Adjusts the relative level: [FRONT-15] – [CENTER] – [REAR-15].

DSEE (digital sound enhancement engine)

Improves digitally compressed sound by restoring high frequencies lost in the compression process.

This setting can be memorized for each source other than the tuner.

Selects the DSEE mode: [ON], [OFF].

AAV (advanced auto volume)

Adjust the playback volume level of all playback sources to the optimum level: [ON], [OFF].

REARBAS ENH (rear bass enhancer)

Rear Bass Enhancer enhances the bass sound by applying a low pass filter setting to the rear speakers. This function allows the rear speakers to work as a subwoofer if one is not connected. (Available only when [SW DIREC] is set to [OFF].)

RBE MODE (rear bass enhancer mode)

Selects the rear bass enhancer mode: [1], [2], [3], [OFF].

LPF FREQ (low pass filter frequency)

Selects the subwoofer cut-off frequency: [50Hz], [60Hz], [80Hz], [100Hz], [120Hz].

LPF SLOPE (low pass filter slope)

Selects the LPF slope: [1], [2], [3].

SW DIREC (subwoofer direct connection)

You can use the subwoofer without a power amplifier when it is connected to the rear speaker lead. (Available only when [RBE MODE] is set to [OFF].)

Be sure to connect a 4 – 8 ohm subwoofer to either of the rear speaker leads. Do not connect a speaker to the other rear speaker lead.

SW MODE (subwoofer mode)

Selects the subwoofer mode: [1], [2], [3], [OFF].

SW PHASE (subwoofer phase)

Selects the subwoofer phase: [NORM], [REV].

SW POSITION* (subwoofer position)

Selects the subwoofer position: [NEAR], [NORMAL], [FAR].

LPF FREQ (low pass filter frequency)

Selects the subwoofer cut-off frequency: [50Hz], [60Hz], [80Hz], [100Hz], [120Hz].

LPF SLOPE (low pass filter slope)

Selects the LPF slope: [1], [2], [3].

SUB WOOFER (subwoofer)**SW LEVEL** (subwoofer level)

Adjusts the subwoofer volume level: [+10 dB] – [0 dB] – [-10 dB].

([ATT] is displayed at the lowest setting.)

SW PHASE (subwoofer phase)

Selects the subwoofer phase: [NORM], [REV].

SW POSITION* (subwoofer position)

Selects the subwoofer position: [NEAR], [NORMAL], [FAR].

LPF FREQ (low pass filter frequency)

Selects the subwoofer cut-off frequency: [50Hz], [60Hz], [80Hz], [100Hz], [120Hz].

LPF SLOPE (low pass filter slope)

Selects the LPF slope: [1], [2], [3].

HPF (high pass filter)**HPF FREQ** (high pass filter frequency)

Selects the front/rear speaker cut-off frequency: [OFF], [50Hz], [60Hz], [80Hz], [100Hz], [120Hz].

HPF SLOPE (high pass filter slope)

Selects the HPF slope (effective only when [HPF FREQ] is set to other than [OFF]): [1], [2], [3].

AUX VOLUME (AUX volume level)

Adjusts the volume level for each connected auxiliary device: [+18 dB] – [0 dB] – [-8 dB].

This setting negates the need to adjust the volume level between sources.

BTA VOLUME (BLUETOOTH audio volume level)

Adjusts the volume level for each connected BLUETOOTH device: [+6 dB] – [0 dB] – [-6 dB].

This setting negates the need to adjust the volume level between sources.

* Does not appear when [F/R POSITION] is set to [OFF].

Display Setup (DISPLAY)

DEMO (demonstration)

Activates the demonstration: [ON], [OFF].

DIMMER

Dims the display: [ON], [OFF], [AT] (auto)
([AT] is available only when the illumination control lead is connected, and turn on the head light).

SUB DISPLAY

Selects the item to display as sub information: [SOURCE], [CLOCK].
(Available only while the source is off and the clock is displayed.)

BUTTON COLOR

Sets a preset color or customized color for the buttons.

COLOR

Selects from 15 presets colors, 1 customized color.

CUSTOM COLOR

Registers a customized color for the buttons.

RGB RED, RGB GRN, RGB BLUE

Adjustable color range: [0] - [32] ([0] cannot be set for all color ranges).

DISP COLOR (display color)

Sets a preset color or customized color for the display.

COLOR

Selects from 15 presets colors, 1 customized color.

CUSTOM COLOR

Registers a customized color for the display.

RGB RED, RGB GRN, RGB BLUE

Adjustable color range: [0] - [32] ([0] cannot be set for all color ranges).

ALL COLOR

Sets a preset color or customized color for the display and buttons.

COLOR

Selects from 15 presets colors, 1 customized color.

CUSTOM COLOR

Registers a customized color for the display and buttons.

RGB RED, RGB GRN, RGB BLUE

Adjustable color range: [0] - [32] ([0] cannot be set for all color ranges).

SOUND SYNC (sound synchronization)

Selects the color with sound synchronization: [ON], [OFF].

WHITE MENU

You can display the menu more clearly (white) without concern for color setting: [ON], [OFF].

START WHITE

When SRC is pressed, the display and buttons on the main unit turn white once, then change to the customized color: [ON], [OFF].

MOTION DSPL (motion display)

Shows moving patterns: [ON], [OFF], [SA] (spectrum analyzer).
(Available only when [SOUND SYNC] is set to [OFF].)

AUTO SCROLL

Scrolls long items automatically: [ON], [OFF].
(Not available when the AUX or tuner is selected.)

BLUETOOTH Setup (BT)

PAIRING (page 8)

PHONEBOOK (page 15)

REDIAL (page 15)

RECENT CALL (page 15)

VOICE DIAL (page 16)

DIAL NUMBER (page 15)

RINGTONES

Selects whether this unit or the connected cellular phone outputs the ringtone: [1] (this unit), [2] (cellular phone).

AUTO ANSWER

Sets this unit to answer an incoming call automatically: [OFF], [1] (about 3 seconds), [2] (about 10 seconds).

AUTO PAIR

Start BLUETOOTH pairing automatically when iOS device version 5.0 or later is connected via USB: [ON], [OFF].

BT SIGNAL (BLUETOOTH signal) (page 9)

Activates/deactivates the BLUETOOTH function.

BT INIT (BLUETOOTH initialize)

Initializes all the BLUETOOTH related settings (pairing information, preset number, device information, etc.).
When disposing the unit, initialize all the settings.
(Available only while the source is off and the clock is displayed.)

SongPal Setup (SONGPAL)

Establish and terminate "SongPal" function (connection).

Additional Information

Updating the Firmware

You can update the firmware of this unit from the following support site:

<http://esupport.sony.com/>

To update the firmware, visit the support site, then follow the online instructions.

Precautions

- Cool off the unit beforehand if your car has been parked in direct sunlight.
- Do not leave the front panel or audio devices brought in inside the car, or it may cause malfunction due to high temperature in direct sunlight.
- Power antenna (aerial) extends automatically.

Moisture condensation

Should moisture condensation occur inside the unit, remove the disc and wait for about an hour for it to dry out; otherwise the unit will not operate properly.

To maintain high sound quality

Do not splash liquid onto the unit or discs.

Notes on discs

- Do not expose discs to direct sunlight or heat sources such as hot air ducts, nor leave it in a car parked in direct sunlight.
- Before playing, wipe the discs with a cleaning cloth from the center out. Do not use solvents such as benzine, thinner, commercially available cleaners.
- This unit is designed to play discs that conform to the Compact Disc (CD) standard. DualDiscs and some of the music discs encoded with copyright protection technologies do not conform to the Compact Disc (CD) standard, therefore, these discs may not be playable by this unit.
- Discs that this unit CANNOT play
 - Discs with labels, stickers, or sticky tape or paper attached. Doing so may cause a malfunction, or may ruin the disc.
 - Discs with non-standard shapes (e.g., heart, square, star). Attempting to do so may damage the unit.
 - 8 cm (3 1/4 in) discs.



Notes on CD-R/CD-RW discs

- If the multi-session disc begins with a CD-DA session, it is recognized as a CD-DA disc, and other sessions are not played.
- Discs that this unit CANNOT play
 - CD-R/CD-RW of poor recording quality.
 - CD-R/CD-RW recorded with an incompatible recording device.
 - CD-R/CD-RW which is finalized incorrectly.
 - CD-R/CD-RW other than those recorded in music CD format or MP3 format conforming to ISO9660 Level 1/Level 2, Joliet/Romeo or multi-session.

Playback order of MP3/WMA/AAC files

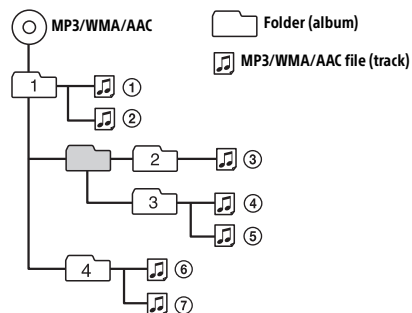

About iPod

- You can connect to the following iPod models. Update your iPod devices to the latest software before use.

Compatible iPhone/iPod models

Compatible Model	BLUETOOTH®	USB
iPhone 5s	○	○
iPhone 5c	○	○
iPhone 5	○	○
iPhone 4s	○	○
iPhone 4	○	○
iPhone 3GS	○	○
iPhone 3G*		○
iPod touch (5th generation)	○	○
iPod touch (4th generation)	○	○
iPod touch (3rd generation)*		○
iPod touch (2nd generation)*		○

Compatible Model	BLUETOOTH®	USB
iPod classic*		○
iPod nano (7th generation)*		○
iPod nano (6th generation)*		○
iPod nano (5th generation)*		○
iPod nano (4th generation)*		○
iPod nano (3rd generation)*		○

* "SongPal" does not support iPhone 3G, iPod touch (3rd generation), iPod touch (2nd generation), iPod classic and iPod nano.

- "Made for iPod," and "Made for iPhone," mean that an electronic accessory has been designed to connect specifically to iPod or iPhone, respectively, and has been certified by the developer to meet Apple performance standards. Apple is not responsible for the operation of this device or its compliance with safety and regulatory standards. Please note that the use of this accessory with iPod or iPhone may affect wireless performance.

If you have any questions or problems concerning your unit that are not covered in this manual, consult your nearest Sony dealer.

Maintenance

Replacing the lithium battery of the remote commander

Under normal conditions, the battery will last approximately 1 year. (The service life may be shorter, depending on the conditions of use.) When the battery becomes weak, the range of the remote commander becomes shorter.

CAUTION

Danger of explosion if battery is incorrectly replaced. Replaced only with the same or equivalent type.

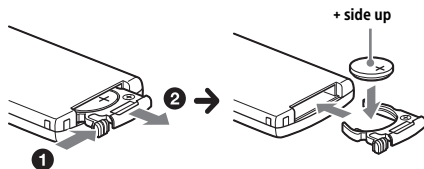

Notes on the lithium battery

- Keep the lithium battery out of the reach of children. Should the battery be swallowed, immediately consult a doctor.
- Wipe the battery with a dry cloth to ensure a good contact.
- Be sure to observe the correct polarity when installing the battery.
- Do not hold the battery with metallic tweezers, otherwise a short-circuit may occur.

Cleaning the connectors

The unit may not function properly if the connectors between the unit and the front panel are not clean. In order to prevent this, detach the front panel (page 7) and clean the connectors with a cotton swab. Do not apply too much force. Otherwise, the connectors may be damaged.

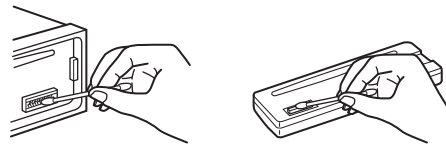

Notes

- For safety, turn off the ignition before cleaning the connectors, and remove the key from the ignition switch.
- Never touch the connectors directly with your fingers or with any metal device.

Specifications

FOR THE CUSTOMERS IN THE USA. NOT APPLICABLE IN CANADA, INCLUDING IN THE PROVINCE OF QUEBEC.

POUR LES CLIENTS AUX ÉTATS-UNIS. NON APPLICABLE AU CANADA, Y COMPRIS LA PROVINCE DE QUÉBEC.

AUDIO POWER SPECIFICATIONS



CEA2006 Standard
Power Output: 40 Watts RMS × 4 at 4 Ohms < 1% THD+N
SN Ratio: 80 dBA
(reference: 1 Watt into 4 Ohms)

Tuner section

FM

Tuning range: 87.5 – 107.9 MHz
Antenna (aerial) terminal:
External antenna (aerial) connector
Intermediate frequency:
FM CCIR: -1,956.5 to -487.3 kHz and +500.0 to +2,095.4 kHz
Usable sensitivity: 8 dBf
Selectivity: 75 dB at 400 kHz
Signal-to-noise ratio: 73 dB

Separation: 50 dB at 1 kHz
 Frequency response: 20 – 15,000 Hz

AM

Tuning range: 530 – 1,710 kHz
 Antenna (aerial) terminal:
 External antenna (aerial) connector
 Sensitivity: 26 μ V

CD Player section

Signal-to-noise ratio: 120 dB
 Frequency response: 10 – 20,000 Hz
 Wow and flutter: Below measurable limit
 The maximum number of: (CD-R/CD-RW only)
 – folders (albums): 150 (including root folder)
 – files (tracks) and folders: 300 (may less than 300
 if folder/file names contain many characters)
 – displayable characters for a folder/file name: 32
 (Joliet)/64 (Romeo)
 Corresponding codec: MP3 (.mp3), WMA (.wma)
 and AAC (.m4a)

USB Player section

Interface: USB (High-speed)
 Maximum current: 1.5 A
 The maximum number of recognizable tracks:
 – files (tracks) per folder: 10,000
 Corresponding codec:
 MP3 (.mp3), WMA (.wma), WAV (.wav), AAC
 (.m4a), AAC (.mp4) and FLAC (.flac)

Wireless Communication

Communication System:
 BLUETOOTH Standard version 3.0
 Output:
 BLUETOOTH Standard Power Class 2
 (Max. +4 dBm)
 Maximum communication range:
 Line of sight approx. 10 m (33 ft)*1
 Frequency band:
 2.4 GHz band (2.4000 – 2.4835 GHz)
 Modulation method: FHSS
 Compatible BLUETOOTH Profiles*2:
 A2DP (Advanced Audio Distribution Profile) 1.3
 AVRCP (Audio Video Remote Control Profile) 1.5
 HFP (Handsfree Profile) 1.6
 PBAP (Phone Book Access Profile)
 SPP (Serial Port Profile)
 MAP (Message Access Profile)
 HID (Human Interface Device Profile)
 Corresponding codec:
 SBC (.sbc) and AAC (.m4a)

*1 The actual range will vary depending on factors such as obstacles between devices, magnetic fields around a microwave oven, static electricity, reception sensitivity, antenna (aerial)'s performance, operating system, software application, etc.

*2 BLUETOOTH standard profiles indicate the purpose of BLUETOOTH communication between devices.

Power amplifier section

Output: Speaker outputs
 Speaker impedance: 4 – 8 ohms
 Maximum power output: 100 W \times 4 (at 4 ohms)

General

Outputs:
 Audio outputs terminal: front, rear, sub
 Power antenna (aerial)/Power amplifier control terminal (REM OUT)

Inputs:
 SiriusXM input terminal
 Remote controller input terminal
 Antenna (aerial) input terminal
 MIC input terminal
 AUX input jack (stereo mini jack)
 USB port
 Power requirements: 12 V DC car battery (negative ground (earth))
 Rated current consumption: 10 A

Dimensions:
 Approx. 178 mm \times 50 mm \times 178 mm
 (7 1/8 in \times 2 in \times 7 1/8 in) (w/h/d)

Mounting dimensions:
 Approx. 182 mm \times 53 mm \times 161 mm
 (7 1/4 in \times 2 1/8 in \times 6 3/8 in) (w/h/d)
 Mass: Approx. 1.3 kg (2 lb 14 oz)

Package contents:
 Main unit (1)
 Remote commander (1): RM-X231
 Microphone (1)
 Parts for installation and connections (1 set)
 Optional accessories/equipment:
 SiriusXM Connect Vehicle Tuner: SXV100
 Cable for steering wheel remote input: RC-SR1

Your dealer may not handle some of the above listed accessories. Please ask the dealer for detailed information.

Design and specifications are subject to change without notice.

Copyrights



SiriusXM Connect Vehicle Tuner and Subscription sold separately.

www.siriusxm.com

Sirius, XM and all related marks and logos are trademarks of Sirius XM Radio Inc. All rights reserved.

The Bluetooth® word mark and logos are registered trademarks owned by Bluetooth SIG, Inc. and any use of such marks by Sony Corporation is under license. Other trademarks and trade names are those of their respective owners.

The N-Mark is a trademark or registered trademark of NFC Forum, Inc. in the United States and in other countries.

Windows Media is either a registered trademark or trademark of Microsoft Corporation in the United States and/or other countries.

This product is protected by certain intellectual property rights of Microsoft Corporation. Use or distribution of such technology outside of this product is prohibited without a license from Microsoft or an authorized Microsoft subsidiary.

iPhone, iPod, iPod classic, iPod nano, iPod touch, and Siri are trademarks of Apple Inc., registered in the U.S. and other countries. App Store is a service mark of Apple Inc.

MPEG Layer-3 audio coding technology and patents licensed from Fraunhofer IIS and Thomson.

Pandora, the Pandora logo, and the Pandora trade dress are trademarks or registered trademarks of Pandora Media, Inc., used with permission.

Google, Google Play and Android are trademarks of Google Inc.

libFLAC

Copyright (C) 2000-2009 Josh Coalson

Copyright (C) 2011-2013 Xiph.Org Foundation

Redistribution and use in source and binary forms, with or without modification, are permitted provided that the following conditions are met:

- Redistributions of source code must retain the above copyright notice, this list of conditions and the following disclaimer.
- Redistributions in binary form must reproduce the above copyright notice, this list of conditions and the following disclaimer in the documentation and/or other materials provided with the distribution.

- Neither the name of the Xiph.org Foundation nor the names of its contributors may be used to endorse or promote products derived from this software without specific prior written permission.

THIS SOFTWARE IS PROVIDED BY THE COPYRIGHT HOLDERS AND CONTRIBUTORS "AS IS" AND ANY EXPRESS OR IMPLIED WARRANTIES, INCLUDING, BUT NOT LIMITED TO, THE IMPLIED WARRANTIES OF MERCHANTABILITY AND FITNESS FOR A PARTICULAR PURPOSE ARE DISCLAIMED. IN NO EVENT SHALL THE FOUNDATION OR CONTRIBUTORS BE LIABLE FOR ANY DIRECT, INDIRECT, INCIDENTAL, SPECIAL, EXEMPLARY, OR CONSEQUENTIAL DAMAGES (INCLUDING, BUT NOT LIMITED TO, PROCUREMENT OF SUBSTITUTE GOODS OR SERVICES; LOSS OF USE, DATA, OR PROFITS; OR BUSINESS INTERRUPTION) HOWEVER CAUSED AND ON ANY THEORY OF LIABILITY, WHETHER IN CONTRACT, STRICT LIABILITY, OR TORT (INCLUDING NEGLIGENCE OR OTHERWISE) ARISING IN ANY WAY OUT OF THE USE OF THIS SOFTWARE, EVEN IF ADVISED OF THE POSSIBILITY OF SUCH DAMAGE.

Troubleshooting

The following checklist will help you remedy problems you may encounter with your unit. Before going through the checklist below, check the connection and operating procedures. For details on using the fuse and removing the unit from the dashboard, see "Connection/Installation" (page 31). If the problem is not solved, visit the support site on the back cover.

General

No power is being supplied to the unit.

- If the unit is turned off and the display disappears, the unit cannot be operated with the remote commander.
 - Turn on the unit.

No sound or the sound is very low.

- The position of the fader control [FADER] is not set for a 2-speaker system.
- The volume of the unit and/or connected device is very low.
 - Increase the volume of the unit and connected device.

No beep sound.

- An optional power amplifier is connected and you are not using the built-in amplifier.

25GB

The contents of the memory have been erased.

- The reset button has been pressed.
 - Store again into the memory.
- The power supply lead or battery has been disconnected or not connected properly.

Stored stations and correct time are erased.**The fuse has blown.****Makes a noise when the position of the ignition is switched.**

- The leads are not matched correctly with the car's accessory power connector.

During playback or reception, the demonstration mode starts.

- If no operation is performed for 5 minutes with [DEMO-ON] set, the demonstration mode starts.
 - Set [DEMO-OFF] (page 21).

The display disappears from/does not appear in the display window.

- The dimmer is set to [DIM-ON] (page 21).
- The display disappears if you press and hold OFF.
 - Press OFF on the unit until the display appears.
- The connectors are dirty (page 23).

The operation buttons do not function.**The disc will not eject.**

- The connection is not correct.
 - Check the connection of the unit.
 - If the situation does not improve, press RESET (page 7).
 - The contents stored in memory are erased.
 - For your safety, do not reset the unit while you are driving.

Radio reception**Stations cannot be received.****The sound is hampered by noises.**

- The connection is not correct.
 - If your car has built-in radio antenna (aerial) in the rear/side glass, connect an REM OUT lead (blue/white striped) or accessory power supply lead (red) to the power supply lead of a car's antenna (aerial) booster.
 - Check the connection of the car antenna (aerial).
 - If the auto antenna (aerial) will not extend, check the connection of the power antenna (aerial) control lead.

Preset tuning is not possible.

- The broadcast signal is too weak.

RDS**PTY displays [- - - - -].**

- The current station is not an RDS station.
- RDS data has not been received.
- The station does not specify the program type.

26GB

CD playback**The disc does not play.**

- Defective or dirty disc.
- The CD-R/CD-RW is not for audio use (page 22).

MP3/WMA/AAC files cannot be played.

- The disc is incompatible with the MP3/WMA/AAC format and version. For details on playable discs and formats, visit the support site on the back cover.

MP3/WMA/AAC files take longer to play than others.

- The following discs take a longer time to start playback.
 - A disc recorded with a complicated tree structure.
 - A disc recorded in Multi Session.
 - A disc to which data can be added.

The sound skips.

- Defective or dirty disc.

USB device playback**You cannot play items via a USB hub.**

- This unit cannot recognize USB devices via a USB hub.

A USB device takes longer to play.

- The USB device contains files with a complicated tree structure.

The sound is intermittent.

- The sound may be intermittent at a high-bit-rate of more than 320 kbps.

Audio file cannot be played.

- USB device formatted with file systems other than FAT16 or FAT32 are unsupported.*

* This unit supports FAT16 and FAT32, but some USB device may not support all of these FAT. For details, refer to the operating instruction of each USB device or contact the manufacturer.

NFC function**One touch connection (NFC) is not possible.**

- If the smartphone does not respond to the touching.
 - Check that the NFC function of the smartphone is turned on.
 - Move the N-Mark part of the smartphone closer to the N-Mark part on this unit.
 - If the smartphone is in a case, remove it.
- NFC receiving sensitivity depends on the device. If One touch connection with the smartphone fails several times, make BLUETOOTH connection manually.

BLUETOOTH function

The connecting device cannot detect this unit.

- Before the pairing is made, set this unit to pairing standby mode.
- While connected to a BLUETOOTH device, this unit cannot be detected from another device.
 - Disconnect the current connection and search for this unit from another device.
- When the device pairing is made, set the BLUETOOTH signal output to on (page 9).

Connection is not possible.

- The connection is controlled from one side (this unit or BLUETOOTH device), but not both.
 - Connect to this unit from a BLUETOOTH device or vice versa.

The name of the detected device does not appear.

- Depending on the status of the other device, it may not be possible to obtain the name.

No ringtone.

- Adjust the volume by rotating the control dial while receiving a call.
- Depending on the connecting device, the ringtone may not be sent properly.
 - Set [RINGTONE] to [1] (page 21).
- The front speakers are not connected to the unit.
 - Connect the front speakers to the unit. The ringtone is output only from the front speakers.

The talker's voice cannot be heard.

- The front speakers are not connected to the unit.
 - Connect the front speakers to the unit. The talker's voice is output only from the front speakers.

A call partner says that the volume is too low or high.

- Adjust the volume accordingly using mic gain adjustment (page 16).

Echo or noise occurs in phone call conversations.

- Lower the volume.
- Set EC/NC Mode to [EC/NC-1] or [EC/NC-2] (page 16).
- If the ambient noise other than the phone call sound is loud, try reducing this noise.
 - E.g.: If a window is open and road noise, etc., is loud, shut the window. If an air conditioner is loud, lower the air conditioner.

The phone is not connected.

- When BLUETOOTH audio is played, the phone is not connected even if you press CALL.
 - Connect from the phone.

The phone sound quality is poor.

- Phone sound quality depends on reception conditions of cellular phone.
 - Move your car to a place where you can enhance the cellular phone's signal if the reception is poor.

The volume of the connected audio device is low (high).

- Volume level will differ depending on the audio device.
 - Adjust the volume of the connected audio device or this unit.

The sound skips during playback of a BLUETOOTH audio device.

- Reduce the distance between the unit and the BLUETOOTH audio device.
- If the BLUETOOTH audio device is stored in a case which interrupts the signal, remove the audio device from the case during use.
- Several BLUETOOTH devices or other devices which emit radio waves are in use nearby.
 - Turn off the other devices.
 - Increase the distance from the other devices.
- The playback sound stops momentarily when the connection between this unit and the cellular phone is being made. This is not a malfunction.

The connected BLUETOOTH audio device cannot be controlled.

- Check that the connected BLUETOOTH audio device supports AVRCP.

Some functions do not work.

- Check if the connecting device supports the functions in question.

A call is answered unintentionally.

- The connecting phone is set to answer a call automatically.

Pairing failed due to time out.

- Depending on the connecting device, the time limit for pairing may be short.
 - Try completing the pairing within the time.

BLUETOOTH function cannot operate.

- Turn off the unit by pressing OFF for more than 2 seconds, then turn the unit on again.

No sound is output from the car speakers during handsfree call.

- If the sound is output from the cellular phone, set the cellular phone to output the sound from the car speakers.

Siri Eyes Free is not activated.

- Perform the handsfree registration for an iPhone that supports Siri Eyes Free.
- Set the Siri function on the iPhone to on.
- Cancel the BLUETOOTH connection with the iPhone and the unit, and reconnect.

SongPal operation**Application name is mismatched with the actual application in "SongPal".**

- Launch the application again from the "SongPal" application.

While running the "SongPal" application via BLUETOOTH, the display automatically switches to [BT AUDIO].

- The "SongPal" application or BLUETOOTH function has failed.
- Run the application again.

While running the "SongPal" application, the display automatically switches to [IPD].

- The source of the unit automatically switches to [IPD] when an iPhone/iPod is connected to the USB port.
 - Make the BLUETOOTH connection and launch the "SongPal" application again.

Pandora® operation**Pandora® connection is not possible.**

- Shut down the Pandora® application on the mobile device, and then launch it again.

Error displays/Messages

CD ERROR: The disc cannot be played. The disc will be ejected automatically.

- Clean or insert the disc correctly, or make sure the disc is not blank or defective.

CD NO MUSIC: There is no playable file. The disc will be ejected automatically.

- Insert a disc or connect a USB device containing playable files (page 24).

CD PUSH EJT: The disc could not be ejected properly.

- Press ▲ (eject).

HUB NO SUPRT: USB hubs are not supported.

IPD STOP: iPod playback has finished.

- Operate your iPod/iPhone to start playback.

NO DEV: A USB device is not connected or recognized.

- Make sure the USB device or USB cable is securely connected.

OUTPUT ERROR: There may be an internal malfunction.

- Check the connection. If the error message still remains on in the display, consult your nearest Sony dealer.

OVERLOAD: The USB device is overloaded.

- Disconnect the USB device, then press SRC to select another source.
- The USB device has a fault, or an unsupported device is connected.

READ: Now reading information.

- Wait until reading is complete and playback starts automatically. This may take some time depending on the disc structure.

RESET: The unit cannot be operated due to the problem.

- Press RESET (page 7).

TEMP CAUTION: The thermal protector is activated.

- Reduce the volume.

USB ERROR: The USB device cannot be played.

- Connect the USB device again.

USB NO SUPRT: The USB device is not supported.

- For details on the compatibility of your USB device, visit the support site on the back cover.

⏪ ⏩ or ⏮ ⏭: The beginning or the end of the disc has been reached.

⏸: The character cannot be displayed.

For BLUETOOTH function:

BT BUSY: The BLUETOOTH device is busy.

- Wait for a while, then try again.

ERROR: The selected operation could not be performed.

- Wait for a while, then try again.

MEMORY BUSY: Now storing data.

- Wait for a while, then try again.

NO DEV: The BLUETOOTH device is not connected or recognized.

- Make sure the BLUETOOTH device is securely connected, or the BLUETOOTH connection is established with the BLUETOOTH device.

P EMPTY: No phone numbers are stored.

UNKNOWN: A name or phone number cannot be displayed.

WITHHELD: The phone number is hidden by the caller.

For SongPal operation:

APP DISCNCT: The application is disconnected.
→ Make the "SongPal" connection (page 16).

APP DISPLAY: A screen setting display of the application is open.
→ Exit the screen setting display of the application to enable button operation.

APP LIST: The contents list of the CD/USB/iPod is open.
→ Exit the list of the application to enable button operation.

APP MENU: A setting display of the application is open.
→ Exit the setting display of the application to enable button operation.

APP SOUND: A sound setting display of the application is open.
→ Exit the sound setting display of the application to enable button operation.

OPEN APP: The "SongPal" application is not running.
→ Launch the application.

For Pandora® operation:

CANNOT SKIP: Skipping tracks is not allowed.
→ Wait until the commercial ends, next track begins, or select another station on the list. Pandora® limits the number of skips allowed on their service.

NO NETWORK: The network connection is unstable or lost.
→ Make the network connection again on the device, or wait until the network connection is established.

NO STATION: No stations on your account.
→ Create the station on the mobile device.

NOT ALLOWED: The selected operation is not allowed.

- "Thumbs" feedback is not allowed.
 - Wait until the commercial ends.
 - Some functions, such as Shared Station, do not permit feedback. Wait until the next track begins, or select another station on the list.
- Bookmark is not allowed.
 - Wait until the commercial ends.
 - Select another track or station, then try it again.

PAN ERROR: The selected operation could not be performed.
→ Wait for a while, then try again.

PAN MAINT: The Pandora® server is under maintenance.
→ Wait for a while, then try again.

PAN NO SUPRT: Pandora® does not support the device.
→ For details on compatible devices, visit the support site.

PAN OPEN APP: Pandora® is not running.
→ Launch the Pandora® application on the iPhone.

PAN OPEN APP - PRESS PAUSE: Pandora® is not running.
→ Launch the Pandora® application on the mobile device, then press PAUSE.

PAN RESTRICT: Pandora® is not available outside your country.

PLEASE LOGIN - PANDORA APP: You are not logged into your Pandora® account.
→ Disconnect the device, log into your Pandora® account, then connect the device again.

UPDATE PAN: An old version of Pandora® is connected.
→ Update the Pandora® application to the latest version.

For SiriusXM operation:

CH LOCKED
→ The channel that you have requested is locked by the radio parental control feature. See "To set a parental control" (page 11) for more information on the parental control feature and how to access locked channels.

CH UNAVAIL

- The channel that you have requested is not a valid SiriusXM channel or the channel that you were listening to is no longer available.
- You may also see this message briefly when first connecting a new SiriusXM Connect Vehicle Tuner.
Visit www.siriusxm.com for more information about the SiriusXM channel lineup.

CHAN UNSUB

- The channel that you have requested is not included in your SiriusXM subscription package or the channel that you were listening to is no longer included in your SiriusXM subscription package.
Visit www.siriusxm.com or call 866-635-2349 if you have questions about your subscription package or would like to subscribe to this channel.

CHK ANT

- The radio has detected a fault with the SiriusXM antenna.
- The antenna cable may be either disconnected or damaged.
 - Verify that the antenna cable is connected to the SiriusXM Connect Vehicle Tuner.
 - Inspect the antenna cable for damage and kinks.
 - Replace the antenna if the cable is damaged.
SiriusXM products are available at your local car audio retailer or online at - www.shop.siriusxm.com

CHECK TUNER

- The radio is having difficulty communicating with the SiriusXM Connect Vehicle Tuner.
- The tuner may be disconnected or damaged.
 - Verify that the SiriusXM Connect Vehicle Tuner cable is securely connected to the radio.

MEM FAILURE

- This unit failed to store the channel in the preset dial.
 - Make sure that the channel you intend to store is correct.

NO SIGNAL

- SiriusXM Connect Vehicle Tuner is having difficulty receiving the SiriusXM satellite signal.
 - Verify that your vehicle is outdoors with a clear view of the sky.
 - Verify that the SiriusXM magnetic mount antenna is mounted on a metal surface on the outside of the vehicle.
 - Move the SiriusXM antenna away from any obstructions.
 - Inspect the antenna cable for damage and kinks.
 - Consult the SiriusXM Connect Vehicle Tuner installation manual for more information on antenna installation.
 - Replace the antenna if the cable is damaged.
SiriusXM products are available at your local car audio retailer or online at - www.shop.siriusxm.com

SUBSCRIPTION UPDATE - ENTER TO CONTINUE

- The radio has detected a change in your SiriusXM subscription status.
 - Press ENTER to clear the message.
Visit www.siriusxm.com or call 866-635-2349, if you have questions about your subscription.

If these solutions do not help improve the situation, consult your nearest Sony dealer.
If you take the unit to be repaired because of CD playback trouble, bring the disc that was used at the time the problem began.

Connection/Installation

Cautions

- Run all ground (earth) leads to a common ground (earth) point.
- Do not get the leads trapped under a screw, or caught in moving parts (e.g., seat raiting).
- Before making connections, turn the car ignition off to avoid short circuits.
- Connect the **yellow** and **red** power supply leads only after all other leads have been connected.
- Be sure to insulate any loose unconnected leads with electrical tape for safety.

Precautions

- Choose the installation location carefully so that the unit will not interfere with normal driving operations.
- Avoid installing the unit in areas subject to dust, dirt, excessive vibration, or high temperature, such as in direct sunlight or near heater ducts.
- Use only the supplied mounting hardware for a safe and secure installation.

Note on the power supply lead (yellow)

When connecting this unit in combination with other stereo components, the amperage rating of the car circuit to which the unit is connected must be higher than the sum of each component's fuse amperage rating.

Mounting angle adjustment

Adjust the mounting angle to less than 45°.

Parts List for Installation

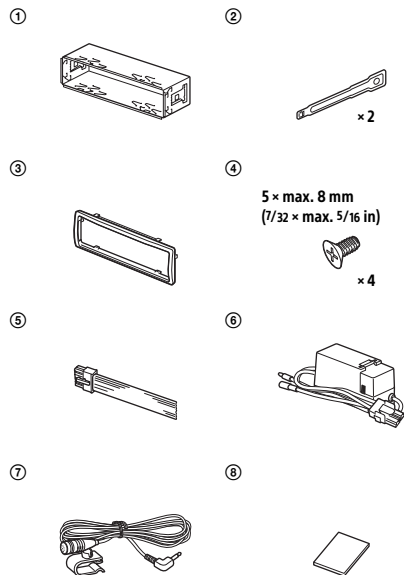

- This parts list does not include all the package contents.
- The bracket ① and the protection collar ③ are attached to the unit before shipping. Before mounting the unit, use the release keys ② to remove the bracket ① from the unit. For details, see "Removing the protection collar and the bracket" (page 34).
- Keep the release keys ② for future use as they are also necessary if you remove the unit from your car.

Connection

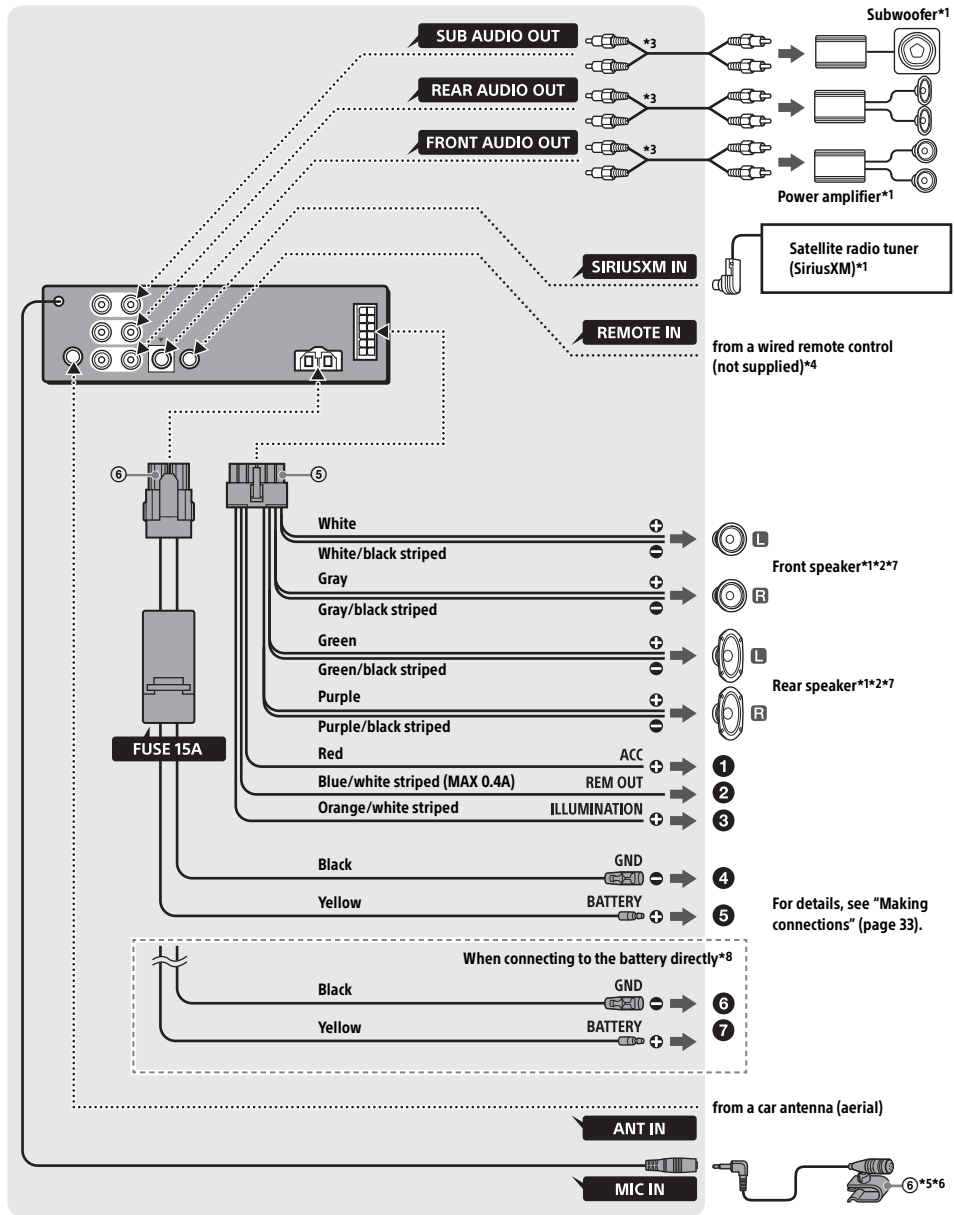

- *1 Not supplied
- *2 Speaker impedance: 4 – 8 Ω × 4
- *3 RCA pin cord (not supplied)
- *4 Depending on the type of car, use an adaptor for a wired remote control (not supplied).
For details on using the wired remote control, see “Using the wired remote control” (page 34).
- *5 Whether in use or not, route the microphone input cord such that it does not interfere with driving operations. Secure the cord with a clamp, etc., if it is installed around your feet.
- *6 For details on installing the microphone, see “Installing the microphone” (page 34).
- *7 Speakers with 100W RMS or higher power input capacity can be used to enhance the bass sounds without a subwoofer. Using Sony XB series full range speakers is recommended.
- *8 When the amperage rating of the fuse used on your car is 10 A, make power connection to the battery directly to avoid short circuits.

Making connections

- 1 To the +12 V power terminal which is energized when the ignition switch is set to the accessory position**
If there is no accessory position, connect to the +12 V power (battery) terminal which is energized at all times.
Be sure to first connect the black ground (earth) lead to a common ground (earth) point.
- 2 To the power antenna (aerial) control lead or the power supply lead of the antenna (aerial) booster**
It is not necessary to connect this lead if there is no power antenna (aerial) or antenna (aerial) booster, or with a manually-operated telescopic antenna (aerial).
To AMP REMOTE IN of an optional power amplifier
This connection is only for amplifiers and a power antenna (aerial). Connecting any other system may damage the unit.
- 3 To a car's illumination signal**
Be sure to first connect the black ground (earth) lead to a common ground (earth) point.
- 4 To a common ground (earth) point**
First connect the black ground (earth) lead, then connect the yellow and red power supply leads.
- 5 To the +12 V power terminal which is energized at all times**
Be sure to first connect the black ground (earth) lead to a common ground (earth) point.

When connecting to the battery directly

When the amperage rating of the fuse used on your car is 10 A, make power connection to the battery directly to avoid short circuits.

- 6 to a metal point of car**
- 7 to the positive battery terminal**

Notes

- All power wires connected to the positive battery post should be fused within 450 mm (18 in) of the battery post, and before they pass through any metal.
- Make sure that the car's battery wires connected to the car (ground to chassis)* are of a wire gauge at least equal to that of the main power wire connected from the battery to the head unit.
- During full-power operation, a current of more than 15 A will run through the system. Therefore, make sure that the wires to be connected to the +12 V and GND terminals of this unit are at least 14-Gauge (AWG14) or have a sectional area of more than 2mm² (3/32 in).

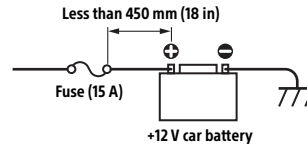

If you have any questions or problems concerning the connection, consult the dealer for details.

Subwoofer Easy Connection

You can use a subwoofer without a power amplifier when it is connected to a rear speaker cord.

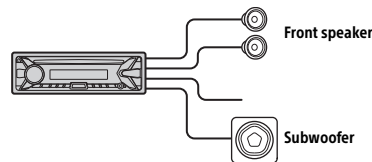

Note

Use a subwoofer with an impedance of 4 to 8 ohms, and with adequate power handling capacities to avoid damage.

Memory hold connection

When the yellow power supply lead is connected, power will always be supplied to the memory circuit even when the ignition switch is turned off.

Speaker connection

- Before connecting the speakers, turn the unit off.
- Use speakers with an impedance of 4 to 8 ohms, and with adequate power handling capacities to avoid damage.

Installing the microphone

To capture your voice during handsfree calling, you need to install the microphone ⑦.

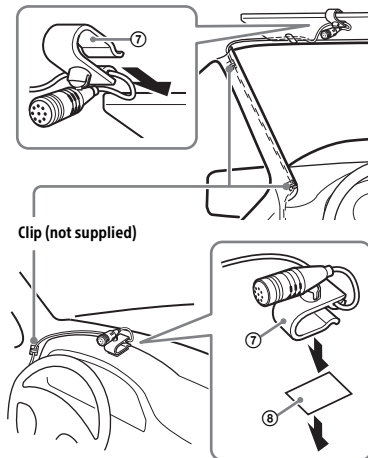

Cautions

- It is extremely dangerous if the cord becomes wound around the steering column or gearstick. Be sure to keep it and other parts from interfering with your driving operations.
- If airbags or any other shock-absorbing equipment is in your car, contact the store where you purchased this unit, or the car dealer, before installation.

Note

Before attaching the double-sided tape ⑧, clean the surface of the dashboard with a dry cloth.

Using the wired remote control

When using the steering wheel remote control

Installation of the connection cable RC-RS1 (not supplied) is required.

Notes on the connection cable RC-RS1 (not supplied)

- Refer to the support sites on the back cover for details, then connect each lead properly to the appropriate leads. Making an improper connection may damage the unit.
- Depending on the type of car, be sure to insulate the unused leads with electrical tape for safety.
- Do not connect this cable when the steering wheel remote control is not used.
- Consulting the dealer or an experienced technician for help is recommended.

- 1 To enable the steering remote, select [STEERING] → [STR EDIT] to make the registration (page 19). When the registration completes, the steering remote control becomes available.

When using the wired remote control (e.g., rotary commander) other than the steering remote

- 1 In the STEERING setting, set [STR CONTROL] to [EXTERNAL] (page 19).

Installation

Removing the protection collar and the bracket

Before installing the unit, remove the protection collar ③ and the bracket ① from the unit.

- 1 Pinch both edges of the protection collar ③, then pull it out.

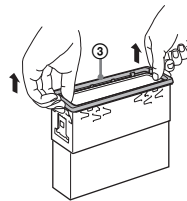

- 2 Insert both release keys ② until they click, and pull down the bracket ①, then pull up the unit to separate.

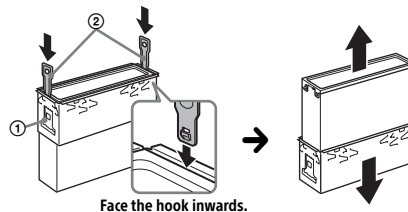

Mounting the unit in the dashboard

Before installing, make sure the catches on both sides of the bracket ① are bent inwards 2 mm (3/32 in). When mounting in a Japanese car, see "Mounting the unit in a Japanese car" (page 35).

- 1 Position the bracket ① inside the dashboard, then bend the claws outward for a tight fit.

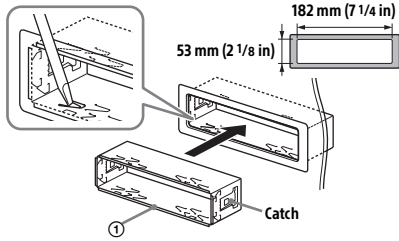

2 Mount the unit onto the bracket ①, then attach the protection collar ③.

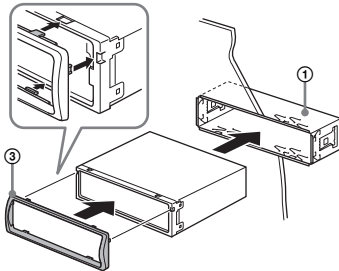

CAUTION

Do not touch the left side of the unit when removing from the dashboard. The heatsink on the left side of the unit is being heated immediately after use.

Notes

- If the catches are straight or bent outwards, the unit will not be installed securely and may spring out.
- Make sure the 4 catches on the protection collar ③ are properly engaged in the slots of the unit.

Mounting the unit in a Japanese car

You may not be able to install this unit in some makes of Japanese cars. In such a case, consult your Sony dealer.

TOYOTA

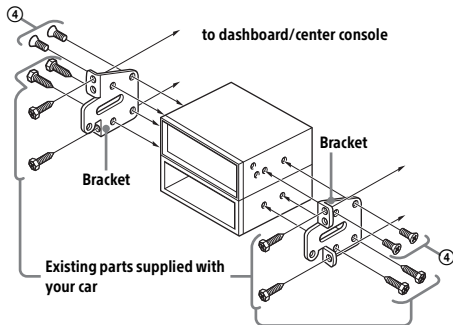

NISSAN

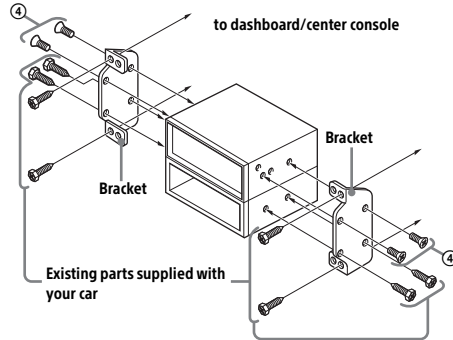

Note

To prevent malfunction, install only with the supplied screws ④.

Detaching and attaching the front panel

For details, see "Detaching the Front Panel" (page 7).

Resetting the unit

For details, see "Resetting the unit" (page 7).

Fuse replacement

When replacing the fuse, be sure to use one matching the amperage rating stated on the original fuse. If the fuse blows, check the power connection and replace the fuse. If the fuse blows again after replacement, there may be an internal malfunction. In such a case, consult your nearest Sony dealer.

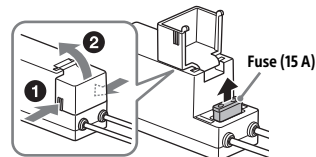

Note

Use an appropriate tool to replace a fuse.

This warranty is valid only in the United States.

SONY[®]

LIMITED WARRANTY Car Audio (U.S. Only)

Sony Electronics Inc. ("Sony") warrants this product against defects in material or workmanship for the time periods and as set forth below when purchased directly from Sony or a Sony Retailer. Pursuant to this Limited Warranty, Sony will, at its option, (i) repair the product using new or refurbished parts or (ii) replace the product with a new or refurbished product. For purposes of this Limited Warranty, "refurbished" means a product or part that has been returned to its original specifications. **In the event of a defect, these are your exclusive remedies.**

Labor: For a period of one (1) year from the original date of purchase of the product ("Labor Warranty"), Sony will, at its option, repair or replace with new or refurbished product, product determined to be defective. If Sony elects to replace the product after this Labor Warranty has expired but while the Parts Warranty below is still in effect, it will do so for the applicable labor charge.

Parts: For a period of one (1) year from the original date of purchase of product ("Parts Warranty"), Sony will supply new or refurbished replacement parts in exchange for parts determined to be defective.

This Limited Warranty covers only the hardware components packaged with the Product. It does not cover technical assistance for hardware or software usage and it does not cover any software products whether or not contained in the Product; any such software is provided "AS IS" unless expressly provided for in any enclosed software Limited Warranty. Please refer to the End User License Agreements included with the Product for your rights and obligations with respect to the software.

Instructions: To obtain warranty service, you must deliver the product, freight prepaid, in either its original packaging or packaging affording an equal degree of protection to the Sony authorized service facility specified. **It is your responsibility to backup any data, software or other materials you may have stored or preserved on your unit. It is likely that such data, software, or other materials will be lost or reformatted during service and Sony will not be responsible for any such damage or loss.** A dated purchase receipt from Sony or a Sony Retailer is required. For specific instructions on how to obtain warranty service for your product,

Visit Sony's Web Site:
www.sony.com/support

Or call the **Sony Customer Information Service Center**
1-800-222-SONY(7669)

For an accessory or part not available from your authorized dealer, call:

1-800-488-SONY (7669)

Repair / Replacement Warranty: This Limited Warranty shall apply to any repair, replacement part or replacement product for the remainder of the original Limited Warranty period or for ninety (90) days, whichever is longer. Any parts or product replaced under this Limited Warranty will become the property of Sony.

This Limited Warranty only covers product issues caused by defects in material or workmanship during ordinary consumer use; it does not cover product issues caused by any other reason, including but not limited to product issues due to commercial use, acts of God, misuse, limitations of technology, or modification of or to any part of the Sony product or product purchased from other than Sony or a Sony Retailer. To determine if a retailer is part of the Sony Retailer Network, please contact Sony's Customer Service Call Center or go to www.sony.com/support. This Limited Warranty does not cover Sony products sold AS IS or WITH ALL FAULTS or consumables (such as fuses or batteries). This Limited Warranty is invalid if the factory-applied serial number has been altered or removed from the product. This Limited Warranty is valid only in the United States.

LIMITATION ON DAMAGES: SONY SHALL NOT BE LIABLE FOR ANY INCIDENTAL OR CONSEQUENTIAL DAMAGES FOR BREACH OF ANY EXPRESS OR IMPLIED WARRANTY ON THIS PRODUCT.

DURATION OF IMPLIED WARRANTIES: EXCEPT TO THE EXTENT PROHIBITED BY APPLICABLE LAW, ANY IMPLIED WARRANTY OF MERCHANTABILITY OR FITNESS FOR A PARTICULAR PURPOSE ON THIS PRODUCT IS LIMITED IN DURATION TO THE DURATION OF THIS WARRANTY.

Some states do not allow the exclusion or limitation of incidental or consequential damages, or allow limitations on how long an implied warranty lasts, so the above limitations or exclusions may not apply to you. This Limited Warranty gives you specific legal rights and you may have other rights which vary from state to state.

W 444774702

36GB

This warranty is valid only in Canada.

SONY®

Consumer Warranty (Canada Only)

Sony of Canada Ltd. (hereinafter referred to as "Sony") hereby warrants, subject to the terms and conditions herein set forth, this product against defects in material and workmanship during the specified warranty period. In the event of a defect of material or workmanship during the specified warranty period, Sony will, without charge for parts or labour, either repair the product, effecting all necessary parts replacements with either new or refurbished parts, or at Sony's sole discretion, replace the product with a refurbished product of equal or better quality. **This limited warranty is valid only in Canada.**

The Warranty Period:

1. Labour: ONE YEAR from the date of original purchase at retail.
2. Parts: ONE YEAR (thermal head and projector lamp: 90 days) from the date of original purchase at retail.
3. Commercial or Rental Use: NINETY DAYS parts and labour from the date of original purchase.

Void or limited warranty:

This limited warranty is void if the product has been previously altered, modified, repaired or serviced by anyone other than the service facilities authorized by Sony, if the serial number on the product has been altered or removed, or if the product has been subject to accident, misuse, abuse, acts of God or operated contrary to the instructions contained in the Owner's Manual. This product is not intended for commercial or rental use. Should this product be used for commercial or rental use, Sony's standard ninety day commercial warranty will apply. The opinion of Sony with respect to these matters shall be final.

Proper Delivery for Service:

The product must be shipped, freight prepaid, or delivered to one of the nearest Sony service facilities in Canada in either its original package or similar package affording an equal degree of protection, and with instructions indicating a location within Canada to which the product should be returned. The repaired product will be returned to customer freight prepaid. Prior to shipping or delivering the product for repair, all accessories, media and other attachments should be removed from the product and all data and software must be backed up. It is likely that stored data and software will be lost, corrupted or reformatted in the course of service and Sony will not be liable for lost, corrupted or reformatted data or software. If more than the product is sent for repair, all items must be listed individually on the packing slip for the shipping documentation. Sony shall have no liability whatsoever for loss or damage to items that are not listed on the shipping documentation. Defective accessories should be returned to Sony as a separate repair item.

On-site service for televisions of certain dimensions may be available to a customer living within a 50km radius of an authorized Sony service facility, provided the residence can be accessed by an on-road service vehicle. Please go to www.fastracservice.ca or call 1-877-899-7669 to determine if on-site service applies to your television and residential location.

Proof of Original Purchase:

This limited warranty applies to the product from the date of original purchase. Therefore, the owner must furnish proof of original purchase at retail for the consumer warranty. For the commercial warranty, the owner must furnish proof of original purchase at retail or from a distributor. For subsequent purchasers, the date the first user acquired the product will apply as the original purchase.

This limited warranty does not extend to cosmetic damage, broken or damaged casing, accessories, exposed antennas and styluses, consumable items (such as batteries) provided with the product, parts wearing out due to normal wear and tear, damage caused by operation of the product with incompatible equipment or attachments, software issues (consult the End-User License Agreement for software terms and conditions, otherwise software is provided "AS IS") or to products sold "AS IS". This limited warranty does not cover regular product maintenance such as cleaning, lubrication or evaluation.

No Other Warranties; Limitation and Exclusion of Liability:

EXCEPT TO THE EXTENT PROHIBITED BY APPLICABLE LAW, ALL OTHER WARRANTIES AND CONDITIONS, EXPRESS OR IMPLIED, AND WHETHER ARISING BY LAW, BY STATUTE, BY COURSE OF DEALING OR USAGE OF TRADE, INCLUDING WITHOUT LIMITATION IMPLIED WARRANTIES OF MERCHANTABILITY, MERCHANTABILITY AND FITNESS FOR A PARTICULAR PURPOSE ARE DISCLAIMED. UNDER NO CIRCUMSTANCES SHALL SONY BE LIABLE FOR AN AMOUNT GREATER THAN THE ACTUAL PURCHASE PRICE OF THE UNIT, FOR ANY LOSS, DAMAGE OR CORRUPTION OF DATA, OR FOR ANY SPECIAL, INCIDENTAL OR CONSEQUENTIAL DAMAGES SUSTAINED IN CONNECTION WITH SAID UNIT AND SONY NEITHER ASSUMES NOR AUTHORIZES ANY REPRESENTATIVE OR OTHER PERSON TO ASSUME FOR IT ANY OBLIGATION OR LIABILITY OTHER THAN SUCH AS IS EXPRESSLY SET FORTH HEREIN.

Product Registration and Customer Support:

Thank you for choosing a Sony product. At Sony, we strive to create products of the highest quality to enhance your experience and enjoyment. To provide the best support for your product, we request that you complete a product registration form at www.Sony.ca/registration within ninety (90) days of purchase.

For service assistance, product information, product registration or to locate an authorized service facility please go to www.fastracservice.ca, or call: 1-877-899-7669.

For information about a Sony Care Extended Warranty, please call 1-800-773-9667.

For online product support and updates at any time, please visit: www.sony.ca/support, or call the Sony Customer Information Centre at 1-877-899-7669.

W 446022851

37GB

Support site

If you have any questions or for the latest support information on this product, please visit the web site below:

Site d'assistance

Si vous avez des questions ou si vous souhaitez consulter les toutes dernières informations techniques sur ce produit, rendez-vous sur le site Web suivant :

<http://esupport.sony.com/>

If you have any questions/problems regarding this product, try the following:

- 1 Read Troubleshooting in these Operating Instructions.**
- 2 Please contact (U.S.A. only);**
Call **1-800-222-7669**
URL **<http://www.SONY.com>**

<http://www.sony.net/>

©2015 Sony Corporation Printed in Thailand



* 4 5 6 3 8 0 0 1 1 * (1)