

# Personal Audio System

Operating Instructions

hear go



4-589-722-12(1)  
©2016 Sony Corporation Printed in Malaysia  
http://www.sony.net/

SRS-HG1

## Help Guide (web document for a PC/smartphone)

Explains details about the unit; network and BLUETOOTH® connection method with various devices, High-Resolution Audio playback method, etc.

[http://rd1.sony.net/help/speaker/srs-hg1/h\\_zz/](http://rd1.sony.net/help/speaker/srs-hg1/h_zz/)



- The Help Guide explains:
- Wi-Fi network connection details
  - How to link with the SongPal app
  - Network connections and playback methods for each computer OS
  - BLUETOOTH connections and playback methods for various devices
  - How to play High-Resolution Audio files
  - Software updates
  - How to connect the second and subsequent devices via Wi-Fi, etc.

## STEP 1: Charging the battery

- Without charging the battery, this unit cannot be turned on.
- If the battery power is low, the unit cannot be turned on immediately, even when connected to the supplied USB AC adaptor. Use this unit after charging the battery for at least one hour.
- If the unit is not charged for 30 hours after the unit is turned off, it will switch to power saving mode. In this case, it will take 15 to 30 seconds for the unit to turn on, and starting the unit by NFC will not connect the unit to BLUETOOTH. Touch the device to the N-Mark of the unit again.

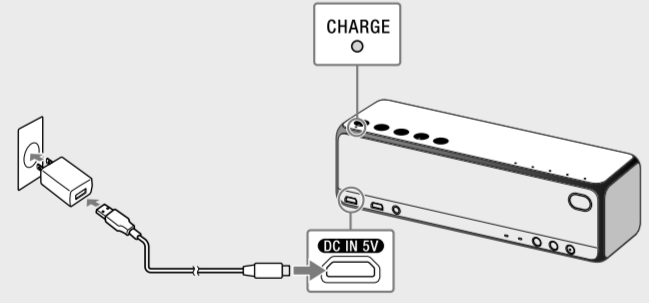

To charge the battery, connect the unit to an AC outlet by using the supplied USB AC adaptor and micro USB cable.

Go to STEP 2 for the wireless connection

## STEP 2: Connecting to your Wi-Fi network

A Wi-Fi network enables you to easily enjoy music stored in wireless devices in your home.

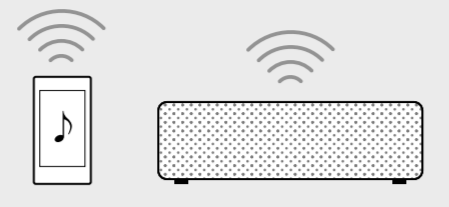

Using a Wi-Fi network, you can play music from online music streaming services, or play the music stored on your computer or smartphone, in high quality sound. Also, you can enjoy the music in multiple rooms at the same time.

### Choose how to connect the unit to your Wi-Fi network from the followings;

- **Connecting by SongPal**  
Set up this unit from the smartphone/iPhone installed with SongPal.
  - **Connecting by Wi-Fi Protected Setup™ (WPS)**  
Set up this unit by pressing the WPS button on the wireless router.
- 
- **Connecting by PC**  
You can also connect from your computer. For details, see Help Guide.

## Connecting by SongPal

Required items: Android smartphone or iPhone/iPod touch, the wireless router

Use an Android smartphone or iPhone in which SongPal is installed to configure Wi-Fi settings of the unit.

Install SongPal onto your smartphone or iPhone. Follow the application's onscreen instructions to connect the unit to a Wi-Fi network.



Search for SongPal on Google Play™ (Play Store) or App Store.

- Connect your smartphone or iPhone to this unit via BLUETOOTH. Before the connection, set the BLUETOOTH feature on your smartphone or iPhone.
- Some wireless routers have multiple SSIDs. Connect the unit and your smartphone or iPhone to the same SSID.

Go to STEP 3 for playing music

## Connecting by Wi-Fi Protected Setup™ (WPS)

Required item: Wireless router with the Wi-Fi Protected Setup™ (WPS) button

- Place the unit close to your wireless router, and then press the (power) button to turn on the unit.  
Before turning the unit on, connect the unit to the supplied USB AC adaptor.  
The (power) indicator starts flashing. Wait until the indicator stops flashing. It may take about 30 seconds.

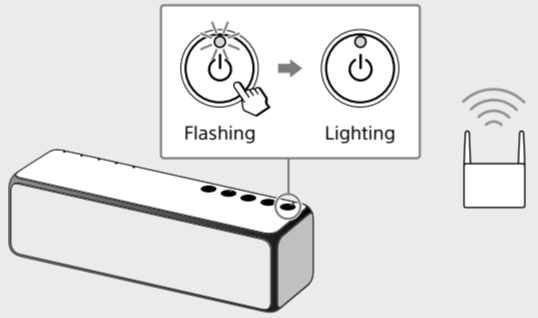

- Press and hold the UPDATE/WPS button of the unit until it beeps (about two seconds). While the UPDATE/WPS indicator is flashing, its button does not work for the WPS.

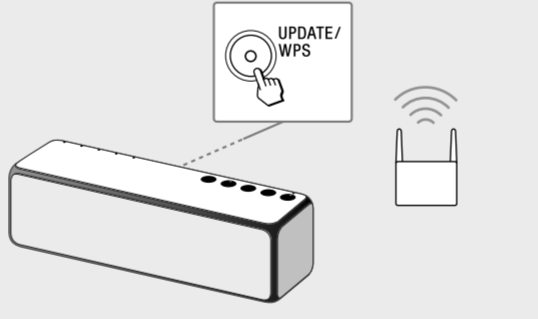

- Within 90 seconds, press the Wi-Fi Protected Setup™ (WPS) button of the router.

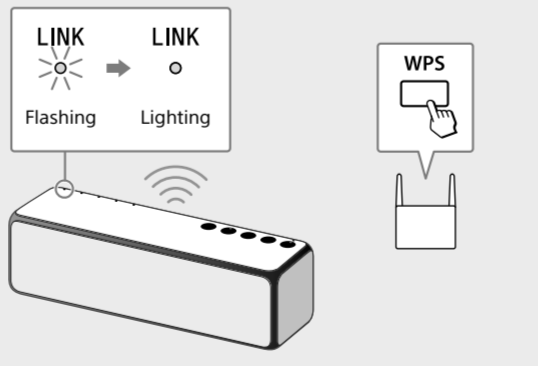

Depending on the wireless router, press and hold the Wi-Fi Protected Setup (WPS) button for a few seconds. For details, refer to the operating instructions of your router. When the LINK indicator lights up in orange, the Wi-Fi network connection is complete.

Go to STEP 3 for playing music

## STEP 3: Listening to music via Wi-Fi

To listen to music via Wi-Fi, SongPal is recommended to be used for your smartphone or iPhone.

### Installing SongPal on your smartphone/iPhone

If SongPal is already installed, skip this installing. See "Listening to music with the unit."

- Install SongPal on your smartphone/iPhone. Search for SongPal on Google Play (Play Store) or App Store.
- Tap [SongPal] on your smartphone/iPhone to start the app, and then follow the onscreen instructions.
- When the screen on the right is displayed, tap [h.ear go (SRS-HG1)].

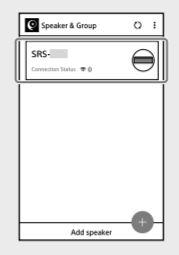

## Listening to music with the unit

Required item: Android smartphone or iPhone/iPod touch

- Tap your smartphone/iPhone to play music in your smartphone/iPhone by operating SongPal.

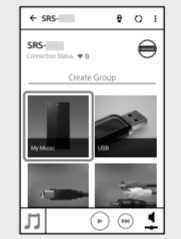

- After selecting music, start playback and adjust the volume.

## To play back music by Google Cast

- Set up Google Cast. If an application that corresponds with Google Cast is already installed, go to step 2.  
a Touch [Settings].  
b Touch [Google Cast].  
c Touch [Learn how to cast].  
d Check how to use the service and which application corresponds with Google Cast, and then select an application to install it.
- Start the installed application that corresponds with Google Cast.

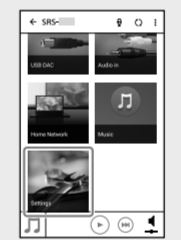

- Touch the Cast icon, and then select [h.ear go (SRS-HG1)].



- Start playback on the application, and adjust the volume.

## Other methods

### Other methods for listening to music via Wi-Fi

The Help Guide explains how to play music in other ways.



You can listen to the music stored on your Xperia by operating the Music app, or the music stored on your PC by using the free software, MediaGo.

## SongPal Link

You can listen to your favorite music with various styles by wireless speaker combinations.



### Wireless Multi-room

Enfold your rooms with music by a group of speakers simultaneously.



### Wireless Surround

Enjoy even greater surround sound with additional Sony's Sound BAR (not included).\*  
\* Please refer to the following URL for the compatible Sony's Sound BAR or AV Receiver.  
<http://sony.net/nasite/>



### Wireless Stereo

Pair two speakers together to create wider, stereo sound.

### Notes

- Two speakers of the same model are required for using the Wireless Surround function or Wireless Stereo function.
- Only music files on the server device of the home network can be played back. Sound from video files cannot be played back.
- To set a grouping with a sound bar, home theater system, etc., update the software of this unit and the device to the latest version.

For more details about the following connections, playback methods, and other information, refer to the Help Guide.

## BLUETOOTH

You can listen to music from BLUETOOTH device over a wireless connection. Before using the BLUETOOTH function, perform pairing to register your BLUETOOTH device.

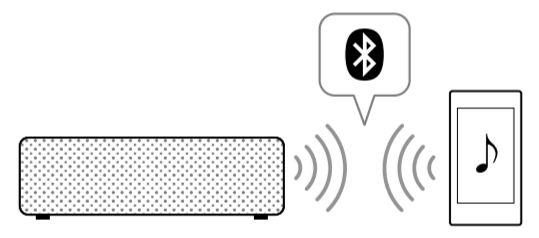

## Connected components

You can listen to music from your computer, smartphone, or USB flash drive by connecting to the USB port on this unit. Or, you can listen to music from your portable music player by connecting to the AUDIO IN jack on this unit.

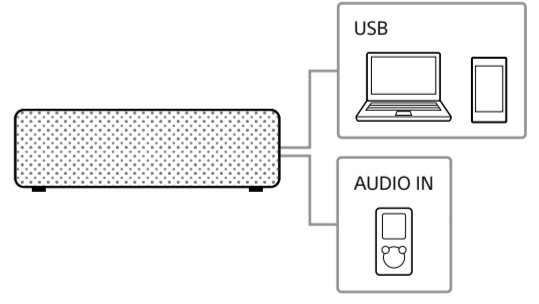

## To listen to music stored on a USB flash drive

You can play the music (MP3 only) stored on a USB flash drive.

- Connect the USB flash drive to the USB port on this unit.  
Depending on the USB flash drive, a commercially available USB conversion cable is necessary.
- Press the FUNCTION button, so that the USB indicator lights up. Music stored on the USB flash drive will automatically start playing back. If it does not, press the FUNCTION button to light another indicator, and then press the button to light the USB indicator again.

