

Home Audio System

GB Operating Instructions



* 4 4 6 4 2 7 3 1 1 * (1)

©2013 Sony Corporation Printed in China

CMT-SBT100

http://www.sony.net/



WARNING

To reduce the risk of fire or electric shock, do not expose this apparatus to rain or moisture.

To reduce the risk of fire, do not cover the ventilation opening of the appliance with newspapers, tablecloths, curtains, etc. Do not expose the appliance to naked flame sources (for example, lighted candles).

To reduce the risk of fire or electric shock, do not expose this appliance to dripping or splashing, and do not place objects filled with liquids, such as vases, on the appliance.

Do not install the appliance in a confined space, such as a bookcase or built-in cabinet.

As the main plug is used to disconnect the unit from the mains, connect the unit to an easily accessible AC outlet. Should you notice an abnormality in the unit, disconnect the main plug from the AC outlet immediately.

This symbol is intended to alert the user to the presence of uninsulated "dangerous voltage" within the product's enclosure that may be of sufficient magnitude to constitute a risk of electric shock to persons.

This symbol is intended to alert the user to the presence of important operating and maintenance (servicing) instructions in the literature accompanying the appliance.

Do not expose batteries or appliances with battery-installed to excessive heat, such as sunshine and fire.

The unit is not disconnected from the mains as long as it is connected to the AC outlet, even if the unit itself has been turned off.

CAUTION

The use of optical instruments with this product will increase eye hazard.

Owner's Record

The model and serial numbers are located on the rear exterior of the unit. Record these numbers in the space provided below. Refer to them whenever you call upon your Sony dealer regarding this product.

Model No. _____

Serial No. _____

Important Safety Instructions

- Read these instructions.
- Keep these instructions.
- Heed all warnings.
- Follow all instructions.
- Do not use this apparatus near water.
- Clean only with dry cloth.
- Do not block any ventilation openings. Install in accordance with the manufacturer's instructions.
- Do not install near any heat sources such as radiators, heat registers, stoves, or other apparatus (including amplifiers) that produce heat.
- Do not defeat the safety purpose of the polarized or grounding-type plug. A polarized plug has two blades with one wider than the other. A grounding type plug has two blades and a third grounding prong. The wide blade or the third prong are provided for your safety. If the provided plug does not fit into your outlet, consult an electrician for replacement of the obsolete outlet.

Operation is subject to the following two conditions:
(1) this device may not cause interference, and
(2) this device must accept any interference, including interference that may cause undesired operation of this device.

This equipment complies with IC radiation exposure limits set forth for an uncontrolled environment and meets RSS-102 of the IC radio frequency (RF) Exposure rules. This equipment has very low levels of RF energy that it deemed to comply without maximum permissive exposure evaluation (MPE). But it is desirable that it should be installed and operated keeping the radiator at least 20cm or more away from person's body (excluding extremities: hands, wrists, feet and ankles).

Note on DualDiscs

A DualDisc is a two sided disc product which mates DVD recorded material on one side with digital audio material on the other side. However, since the audio material side does not conform to the Compact Disc (CD) standard, playback on this product is not guaranteed.

Music discs encoded with copyright protection technologies

This product is designed to playback discs that conform to the Compact Disc (CD) standard. Recently, various music discs encoded with copyright protection technologies are marketed by some record companies. Please be aware that among those discs, there are some that do not conform to the CD standard and may not be playable by this product.

License and Trademark Notice

- Windows Media is either a registered trademark or trademark of Microsoft Corporation in the United States and/or other countries.
- MPEG Layer-3 audio coding technology and patents licensed from Fraunhofer IIS and Thomson.
- The BLUETOOTH® word mark and logos are registered trademarks owned by BLUETOOTH SIG, Inc. and any use of such marks by Sony Corporation is under license. Other trademarks and trade names are those of their respective owners.
- The N Mark is a trademark or registered trademark of NFC Forum, Inc. in the United States and in other countries.
- Android is a trademark of Google Inc.
- This product is protected by certain intellectual property rights of Microsoft Corporation. Use or distribution of such technology outside of this product is prohibited without a license from Microsoft or an authorized Microsoft subsidiary.
- The system names and product names indicated in this manual are generally the trademarks or registered trademarks of the manufacturer. ™ and ® marks are omitted in this manual.

The following FCC statement applies only to the version of this model manufactured for sale in the U.S.A. Other versions may not comply with FCC technical regulations.

NOTE:

This equipment has been tested and found to comply with the limits for a Class B digital device, pursuant to Part 15 of the FCC Rules. These limits are designed to provide reasonable protection against harmful interference in a residential installation. This equipment generates, uses and can radiate radio frequency energy and, if not installed and used in accordance with the instructions, may cause harmful interference to radio communications. However, there is no guarantee that interference will not occur in a particular installation. If this equipment does cause harmful interference to radio or television reception, which can be determined by turning the equipment off and on, the user is encouraged to try to correct the interference by one or more of the following measures:

- Reorient or relocate the receiving antenna.
- Increase the separation between the equipment and receiver.
- Connect the equipment into an outlet on a circuit different from that to which the receiver is connected.
- Consult the dealer or an experienced radio/TV technician for help.

CAUTION

You are cautioned that any changes or modifications not expressly approved in this manual could void your authority to operate this equipment.

This device complies with Part 15 of the FCC Rules. Operation is subject to the following two conditions: (1) this device may not cause harmful interference, and (2) this device must accept any interference received, including interference that may cause undesired operation.

This equipment must not be co-located or operated in conjunction with any other antenna or transmitter.

This equipment complies with FCC radiation exposure limits set forth for an uncontrolled environment and meets the FCC radio frequency (RF) Exposure Guidelines in Supplement C to OET65. This equipment has very low levels of RF energy that it deemed to comply without maximum permissive exposure evaluation (MPE). But it is desirable that it should be installed and operated keeping the radiator at least 20cm or more away from person's body (excluding extremities: hands, wrists, feet and ankles).

Location of Controls

Unit (Front)

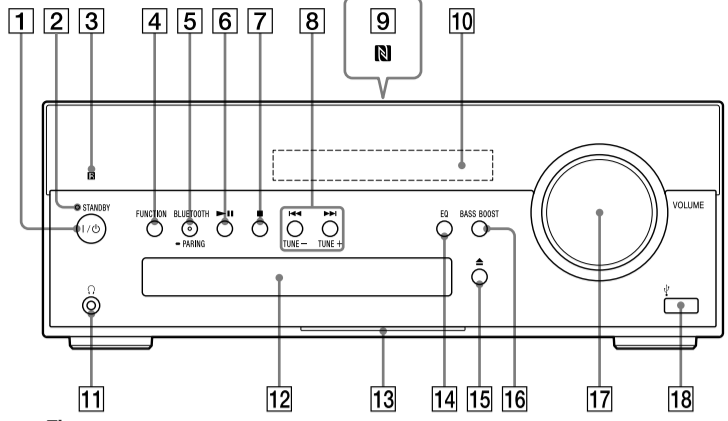

Tip
When you use headphones, connect to (1) (headphone) jack (11).

Remote

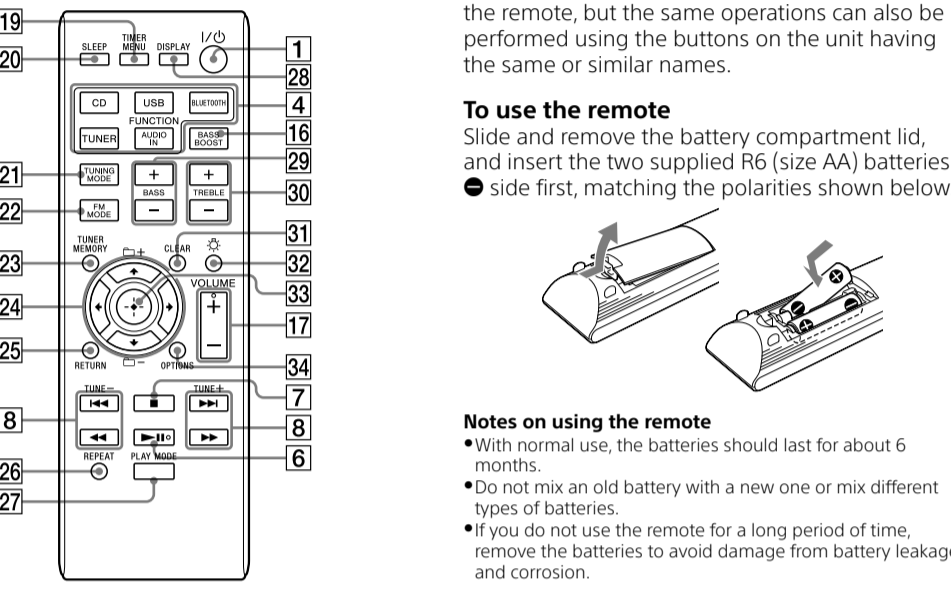

This manual mainly explains operations using the remote, but the same operations can also be performed using the buttons on the unit having the same or similar names.

To use the remote

Slide and remove the battery compartment lid, and insert the two supplied R6 (size AA) batteries, ● side first, matching the polarities shown below.

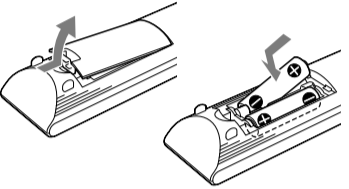

Notes on using the remote

- With normal use, the batteries should last for about 6 months.
- Do not mix an old battery with a new one or mix different types of batteries.
- If you do not use the remote for a long period of time, remove the batteries to avoid damage from battery leakage and corrosion.

Getting Started

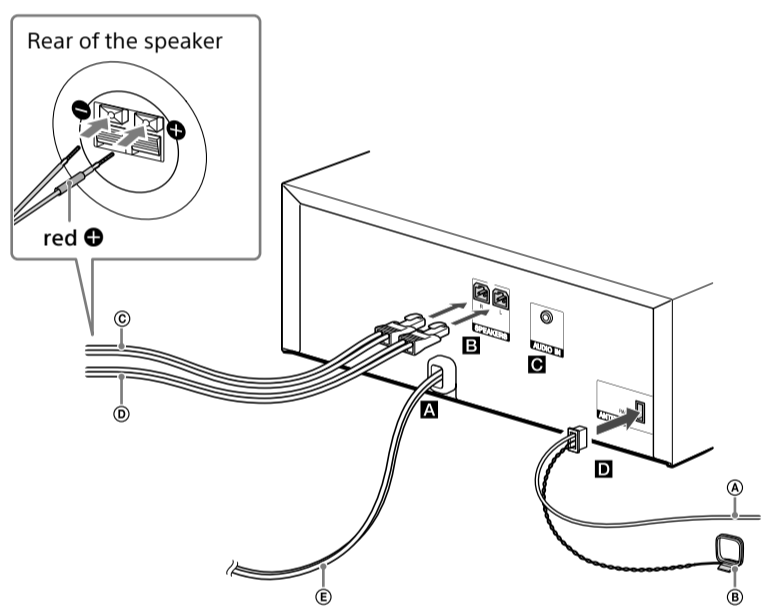

A Power input (AC IN)

After all equipments are connected, connect the power cord (6) to the wall outlet.

B Speakers (left/right) connectors

Firmly connect the right speaker cord (6) to R, and the left speaker cord (6) to L.

C AUDIO IN (external input) jack

Connect optional external equipment with an audio connecting cable (not supplied).

D Antennas

- ① FM lead antenna (supplied)
- ② AM loop antenna (supplied)

Find a location and an orientation that provide good reception, and then fix the antennas to a stable surface (window, wall, etc.). Keep the antennas away from the unit, power cord and other AV components to avoid picking noise.

Secure the end of the FM lead antenna with adhesive tape.

To prepare the AM loop antenna

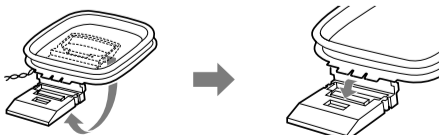

Rewind an antenna cord wound around the antenna and raise the antenna stand.

Stand the antenna and secure it to the slit until it clicks.

Operations

Playing a CD-DA/MP3 disc

- Press CD FUNCTION [4] on the remote or press FUNCTION [4] on the unit repeatedly until "CD" appears in the display (10).
- Press the ▲ (open/close) button (15) to open the disc tray (12).
- Load a disc with the label side facing up.

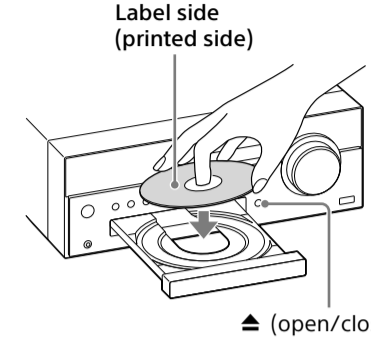

- Press the ▲ (open/close) button (15) to close the disc tray (12).
- Press the ▶▶ (play/pause) button (6).

Notes

- If you cannot remove the disc and "LOCKED" appears in the display (10), contact your nearest Sony dealer.
- Do not load a disc with non-standard shapes (e.g., heart, square, star). Doing this may cause irreparable damage to the system.
- Do not use a disc with tape, stickers or paste on it as this may cause malfunction.
- When you remove a disc, do not touch the surface of the disc.

Other operations

To	Do the following:
Pause playback	Press ▶▶ (6). To resume play, press the button again.
Stop playback	Press ■ (7).
Select a track or file	Press ◀▶▶ (8).
Find a point in a track or file	Hold down ◀▶▶ (8) (or ◀▶▶ (8) on the unit) during playback, and release the button at the desired point.
Select Repeat Play	Press REPEAT (26) repeatedly until "◀" (all tracks of files) or "▶" (single track or file) appears.
Select a folder on an MP3 disc	Press ◻ +/- (24) repeatedly.
Remove a disc	Press ▲ (15) on the unit.

To change the play mode

Press PLAY MODE (27) repeatedly while the player is stopped. You can select Normal Play mode (no indication or "FLDR" * appears), Shuffle Play mode ("SHUF" or "FLDR SHUF" * appears), or Program Play mode ("PGM" appears).

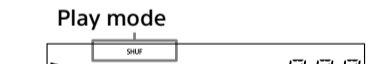

Setting the clock

- Press I/O (1) to turn on the system.
- Press TIMER MENU (19) to select the clock set mode.
- If "PLAY SET" flashes, press ▲/▼ (24) repeatedly to select "CLOCK," and then press (enter) (33).
- Press ▲/▼ (24) repeatedly to set the hour, then press (enter) (33).
- Use the same procedure to set the minutes.

Note on the play mode

If the power cord is disconnected when the system is on, the play mode returns to Normal Play.

Notes on Repeat Play

- ◀ indicates that all tracks or files will be repeated until you stop playback.
- ▶ indicates that a single track or file will be repeated until you stop playback.
- If the power cord is disconnected when the system is on, Repeat Play is cancelled.

Notes on Shuffle Play mode

- When Shuffle Play mode is set to "SHUF," the system shuffle-plays all tracks or files on the disc. When Shuffle Play mode is set to "FLDR SHUF," the system shuffle-plays all tracks or files in selected folder.
- When you turn off the system, the selected Shuffle Play mode ("SHUF" or "FLDR SHUF") is cleared and the play mode returns to Normal or FLDR Play mode.

Notes on playing MP3 discs

- Do not save unnecessary folders or files on a disc that has MP3 files.
- Folders that have no MP3 files are not recognized on the system.
- The system can only play MP3 files that have a file extension of ".mp3."
- Even when file name has the ".mp3" file extension, if it is not an audio MP3 file, playing this file may generate a loud noise, which could cause damage of the system.
- The maximum number of MP3 folders and files compatible with this system is:
 - 999+ folders (including the root folder)
 - 250 files in a single folder
 - 8 folder levels (in the tree structure of files)

- With some connected USB devices, it may take a long time to transmit signals from the system or to finish reading the USB device.
- Compatibility with all encoding/writing software cannot be guaranteed. Incompatible MP3 discs may produce noise or interrupted audio or may not play at all.

* This include folders that have no MP3 or other files. The number of folders that the system can recognize may be less than actual number of folders, depending on the folder structure.

Creating your own program (Program Play)

- Press CD FUNCTION [4] on the remote or press FUNCTION [4] on the unit repeatedly until "CD" appears in the display (10).
- Press PLAY MODE (27) repeatedly until "PGM" appears while the player is stopped.
- Select a folder (MP3 disc only). Press ◻ +/- (24) repeatedly to select the desired folder. If you want to program all files in the folder, press (33).
- Select the desired track or file number. Press ◀▶▶ (8) repeatedly until the desired track or file number appears.



Selected track or file number Total playing time of the selected track or file

- Press (33). "...-" appears when the total playing time exceeds 100 minutes for a CD-DA or when you program an MP3 files.
- Repeat steps 3 through 5 to program additional tracks or files, up to a total of 25 tracks or files.
- Press ▶▶ (6). Your program of tracks or files starts playback. The programmed files or tracks remain available until you remove the disc from the disc tray (12) or unplug the power cord. To play the same program again, press ▶▶ (6).

To cancel Program Play

Press PLAY MODE (27) repeatedly until "PGM" disappears while the player is stopped.

To delete the last track or file of the program

Press CLEAR (31) while the player is stopped.

Notes

- If the disc is ejected after programming, all the programmed tracks or files are deleted.
- If the power cord is disconnected when the system is on, the programmed tracks or files are deleted.

Listening to the radio

Tuning in a radio station

- Press TUNER FUNCTION [4] on the remote or press FUNCTION [4] on the unit repeatedly until "TUNER FM" or "TUNER AM" appears in the display.
- Perform tuning.

For automatic scanning
Press TUNING MODE (21) repeatedly until "AUTO" appears, and then press TUNE +/- (8). Scanning stops automatically when a station is tuned in, and "STEREO" (for stereo programs only) appears in the display (10).

If the scanning does not stop, press ■ (7) to stop scanning, then perform manual tuning (below).

When you tune in a station that provides RDS services, information such as the service name or station name is provided by broadcasts.

For manual tuning

Press TUNING MODE (21) repeatedly until "MANUAL" appears, and then press TUNE +/- (8) repeatedly to tune in the desired station.

Tip

To reduce static noise on a weak FM stereo station, press FM MODE (22) repeatedly until "MONO" appears to turn off stereo reception.

To change the AM tuning interval

The default setting for AM tuning interval is 9 kHz (or 10 kHz for some areas). Use the buttons on the unit to perform this operation.

- Press FUNCTION [4] on the unit repeatedly to select the AM station.
- Press I/O (1) to turn off the system.
- Press and hold FUNCTION [4] and press I/O (1) on the unit. "STEP 9K" or "STEP 10K" appears in the display (10). When you change the interval, all the AM preset stations are erased.

Presetting radio stations

- Tune in the desired station.

- Press TUNER MEMORY (23).

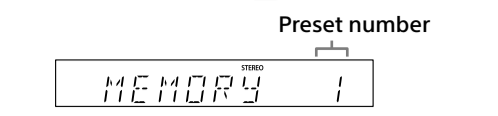

- Press TUNE +/- (8) repeatedly to select a preset number. If another station is already assigned to the selected preset number, the station is replaced by the new station.
- Press (33) to register the station. "COMPLETE" appears in the display (10).
- Repeat steps 1 through 4 to register other stations. You can preset up to 20 FM, 10 AM stations.

To tune in to a preset radio station

Press TUNING MODE (21) repeatedly until "PRESET" appears in the display (10), and then press TUNE +/- (8) to select the preset number to which the desired station is registered.

Playing a file on a USB device

You can play audio files stored on a USB device by connecting a USB memory or USB device to the system. The playable audio format is MP3/WMA*/AAC*.

- Check the websites below for the information about compatible USB devices. For customers in the United States: <http://support.sony.com/> For customers in Canada: <http://support.sony.com/CA/>
- Files with DRM (Digital Rights Management) copyright protection or files downloaded from an online music store cannot be played on this system. If you try to play one of these files, the system plays the next unprotected audio file.

- Press USB FUNCTION [4] on the remote or press FUNCTION [4] on the unit repeatedly until "USB" appears in the display (10).
- Connect the USB device directly or via the USB cable supplied with the USB device to the USB port (18) on the unit.
- Press ▶▶ (6) to start playback.

Other operations

To	Do the following:
Pause playback	Press ▶▶ (6). To resume play, press the button again.
Stop playback	Press ■ (7). To resume play, press ▶▶ (6) *. To cancel resume play, press ■ (7) again*.
Select a folder	Press ◻ +/- (24) repeatedly.
Select a file	Press ◀▶▶ (8).
Find a point in a file	Hold down ◀▶▶ (8) (▶▶▶ (8) on the unit) during playback, and release the button at the desired point.
Select Repeat Play	Press REPEAT (26) repeatedly until "▶" (all audio files) or "▶" (single audio file) appears.

- * When playing a VBR MP3/WMA file, the system may resume playback from a different point.
- * When resume play is canceled, the display returns to the number of folders.

To change the play mode

Press PLAY MODE (27) repeatedly while the player is stopped. You can select Normal Play mode (no indication or "FLDR" * appears), or Shuffle Play mode ("SHUF" or "FLDR SHUF" * appears).

- When no indication is selected, the system plays all files on the USB device. When "FLDR" is selected, the system plays all files in the selected folder on the USB device.
- When "SHUF" is selected, the system shuffle-plays all audio files on the USB device. When "FLDR SHUF" is selected, the system shuffle-plays all audio files in the selected folder.

Note on the play mode

If the power cord is disconnected when the system is on, the play mode returns to Normal Play.

Notes on Repeat Play

- ▶ indicates that all files will be repeated until you stop playback.
- ▶ indicates that a single file will be repeated until you stop playback.
- If the power cord is disconnected when the system is on, Repeat Play is cancelled.

Note on Shuffle Play mode

When you turn off the system, the selected Shuffle Play mode ("SHUF" or "FLDR SHUF") is cleared and the play mode returns to Normal Play mode (no indication or "FLDR").

- The playback order for the system may differ from the playback order of the connected digital music player.
- Be sure to turn off the system before removing the USB device. Removing the USB device while the system is turned on may corrupt the data on the USB device.
- When USB cable connection is necessary, connect the USB cable supplied with the USB device to be connected. For details on connection, refer to the operation manual of the USB device.
- It may take time before "READING" appears after connecting, depending on the type of USB device connected.
- Do not connect the USB device through a USB hub.
- When the USB device is connected, the system reads all the files on the USB device. If there are many folders or files on the USB device, it may take a long time to finish reading the USB device.

- With some connected USB devices, it may take a long time to transmit signals from the system or to finish reading the USB device.
- Compatibility with all encoding/writing software cannot be guaranteed. If audio files on the USB device were originally encoded with incompatible software, those files may produce noise or .may malfunction.
- The maximum number of folders and files on the USB device compatible with this system is:
 - 1000+ folders (including the root folder)
 - 3,000 files
 - 250 files in a single folder
 - 8 folder levels (in the tree structure of files)
- This includes folders that have no playable audio file and empty folders. The number of folders that the system can recognize may be less than actual number of folders, depending on the folder structure.

- The system does not necessarily support all the functions provided in a connected USB device.
- Folders that have no audio files are not recognized.
- The audio formats that you can listen to with this system are as follows:
 - MP3: file extension ".mp3"
 - WMA: file extension ".wma"
 - AAC: file extension ".m4a," ".mp4" or ".3gp"
- Note that even when file name has the correct file extension, if the actual file differs, the system may produce noise or may malfunction.

Charging a USB device or iPod/iPhone/iPad

If you connect a USB device or iPod/iPhone/iPad to the USB port (18) when the system is turned on, charging begins automatically.

To stop charging the USB device

Press I/O (1) to turn off the system, and then disconnect the USB cable.

Notes

- You cannot charge the USB device or iPod/iPhone/iPad when the system is off. Some USB devices and iPod/iPhone may not be charged owing to their characteristics.
- If the system enters Standby mode during charging of a USB device or iPod/iPhone/iPad, the charging stops in progress. Before charging, turn off the Automatic Standby function. For details, see "Setting the Automatic Standby function."

Using the BLUETOOTH function

You can listen to music from your iPod/iPhone/iPad or BLUETOOTH device over a wireless connection.

Before using the BLUETOOTH function, perform pairing to register your BLUETOOTH device.

The system supports registration and connection of the BLUETOOTH device and NFC, which enables data communication by just touching a specified location. For details on NFC, see "Connecting by one-touch action (NFC)."

What is pairing?

The BLUETOOTH devices to be connected must be registered with each other beforehand. Pairing is an operation of registering two devices. Once a pairing operation is performed, it does not have to be performed again. In the following cases, however, a pairing operation must be performed again:

- Pairing information was erased when the BLUETOOTH device was repaired.
- You attempt to pair the system with more than 10 BLUETOOTH devices. This system can pair with up to 9 BLUETOOTH devices. If you pair another BLUETOOTH device after pairing with 9 devices was performed, pairing information of the device that was connected with the system first is overwritten with that of the new device.
- Pairing registration information of this system is erased from the connected device.
- If you initialize the system or erase the pairing history with the system, all the pairing information will be erased.

About the BLUETOOTH indicator
The BLUETOOTH indicator in the center of the BLUETOOTH button (5) allows checking of the BLUETOOTH status.

System status	Indicator status
The system is in BLUETOOTH Standby (when the system is on).	Flashes slowly in blue.
During BLUETOOTH pairing	Flashes quickly in blue.
The system is attempting to connect with a BLUETOOTH device.	Flashes in blue.
The system has established in connection with a BLUETOOTH device.	Lit in blue.

NFC enables data one-touch action (NFC) by connecting NFC communication by just touching your device to a specified location.

Compatible smartphones are those equipped with the NFC function (compatible operating system: Android version 2.3.3 or later with the exception of Android 3.x).

Check the website below for information on compatible devices.

For customers in the United States:

http://esupport.sony.com/

For customers in Canada:

http://esupport.sony.com/CA/

Preparation on your smartphone (Android)

An NFC-compliant application must be installed on your smartphone. If not installed, you can download "NFC Easy Connect" from Google Play.

- In some countries and regions, NFC-compliant application may not be downloaded.
- For some smartphones, this function may be available without downloading "NFC Easy Connect." In this case, the operation and specifications of the smartphone may be different from the description in this manual.

1 Install the application.

If you access using 2D Code

Read the following 2D Code to access.



2 Set your smartphone to enable the NFC function.

For details, refer to the user's guide supplied with your smartphone.

About the "NFC Easy Connect" application

This is a free application especially used for Android. Search the internet for detailed information on "NFC Easy Connect" and download the application.

- In some countries and regions, NFC-compliant application may not be downloaded.

Making a connection with your smartphone by one-touch action

Just touch your smartphone to the system. The system is turned on automatically, and pairing and BLUETOOTH connection are established.

1 Start the "NFC Easy Connect" application on your smartphone.

Check that the application display appears.

2 Touch your smartphone to the unit.

Touch the smartphone to the N-Mark on the unit and maintain contact until the smartphone vibrates.

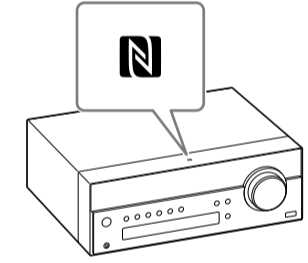

Complete the connection with your smartphone, following the instructions on the screen.

Refer to the user's guide of your smartphone for the part of your smartphone used as touch contact.

- To disconnect the established connection, touch your smartphone to the N-Mark on the unit.
- When you touch an NFC-compliant smartphone to the unit while another BLUETOOTH device is connected with this system, the BLUETOOTH device is disconnected and the system is connected with the smartphone.
- If you touch the smartphone connected with this system to another NFC-compliant BLUETOOTH headset or speaker, the smartphone is disconnected from the system and connected with the touched BLUETOOTH device.

Listening to music through a BLUETOOTH connection

You can operate a BLUETOOTH device by connecting the system and a BLUETOOTH device using AVRCP.

Check the following before playing music:

- The BLUETOOTH function of the BLUETOOTH device is enabled.

- Pairing has been completed.

1 Press BLUETOOTH FUNCTION [4] on the remote or press FUNCTION [4] on the unit repeatedly until "BT AUDIO" appears in the display [10].

2 Establish BLUETOOTH connection with the BLUETOOTH device.

Once the connection is established, "CONNECT" appears in the display [10] then the BLUETOOTH device name set with the BLUETOOTH device appears.

If the BLUETOOTH device has been connected with this system in the past, it may be connected automatically with no user operation required.

3 Press [6] to start playback.

Depending on the BLUETOOTH device, you may have to press [6] twice.

Depending on the BLUETOOTH device, you may have to start up the AV software of the BLUETOOTH device beforehand.

4 Press VOLUME +/− [17] on the remote or turn the VOLUME dial [17] on the unit left or right to adjust the volume.

To	Do the following:
Pause playback	Press [6] *.
Stop playback	Press [7].
Select a folder	Press +/− [24].
Select a file	Press [◀▶] [8].
Find a point in a file	Hold down [▶▶] [8] (or [◀◀] [8]) on the unit) during playback and release the button at the desired point.

* Depending on the BLUETOOTH device, you may have to press [6] twice.

Note
These operations may not be available for certain BLUETOOTH devices. In addition, the actual operations may differ depending on the connected BLUETOOTH device.

To check the address of a connected BLUETOOTH device

Press DISPLAY [28] while the BLUETOOTH device name set on the connected BLUETOOTH device is shown in the display [10]. The BLUETOOTH device address appears in two installments on the system display for 8 seconds.

To cancel the connection with a BLUETOOTH device

Press BLUETOOTH [5] on the unit. "DISCONNECT" appears in the display [10].

Depending on the BLUETOOTH device, the connection may be cancelled automatically when you stop playback.

Using optional audio components

1 Press VOLUME − [17] on the remote or turn the VOLUME dial [17] on the unit left to turn down the volume.

2 Connect additional audio component to the AUDIO IN jack [8] using an audio connecting cable (not supplied).

3 Press AUDIO IN FUNCTION [4] on the remote or press FUNCTION [4] on the unit repeatedly until "AUDIO IN" appears in the display [10].

4 Start playback of the connected component. Adjust the volume on the connected component during playback.

5 Press VOLUME +/− [17] on the remote or turn the VOLUME dial [17] on the unit left or right to adjust the volume.

Note
The system may enter Standby mode automatically if the volume level of the connected component is too low. Adjust the component's volume accordingly.

Setting the Automatic Standby function

With the Automatic Standby function, the system enters Standby mode automatically in about 15 minutes when there is no operation or audio signal output. "AUTO STBY" appears in the display [10] for 2 minutes before the system enters Standby mode. By default, the Automatic Standby function is turned on. You can turn off the function using the option menu.

- Press OPTIONS [34] to display the setting menu.
- Press +/• [24] repeatedly to select "AUTO STBY," then press [33].
- Press +/• [24] repeatedly to select "ON" or "OFF," then press [33].

Notes

- The Automatic Standby function is invalid for the tuner function (FM/AM), even when you have enabled it.
- The system may not enter Standby mode automatically in the following cases:
 - while an audio signal is being detected
 - during playback of audio tracks or files
 - while the preset Sleep Timer or Play Timer is in process
 - The system counts down the time (15 minutes) again until it enters Standby mode, even when Automatic Standby function is enabled when a USB device is connected or when a button on the remote or unit is pressed.

Setting the BLUETOOTH Standby mode

You can enable/disable BLUETOOTH Standby mode.

When BLUETOOTH Standby mode is enabled, the system enters Wait mode for BLUETOOTH connection even when the system is turned off. If the system receives a playback command from the connected BLUETOOTH device, it turns on and music is played back. The BLUETOOTH Standby mode is disabled by default.

1 Press OPTIONS [34] to display the setting menu.

2 Press +/• [24] repeatedly to select "BT STBY," then press [33].

3 Press +/• [24] repeatedly to select "ON" or "OFF," then press [33].

4 Press I/⏏ (power) [1] to turn off the system.

When "BT STBY" is set to "ON," the system turns on and you can listen to music by activating BLUETOOTH on the connected component.

Note
"BT STBY" does not appear in the setting menu, if the BLUETOOTH device is not registered on this system.

Adjusting the sound

Setting the bass boost

Press BASS BOOST [16] repeatedly to select "ON" or "OFF."

Adjusting the bass and treble

Press BASS +/− [29] to adjust bass or TREBLE +/− [30] to adjust treble. Or, press EQ [14] on the unit repeatedly to select "BASS" or "TREBLE," and adjust the selected item using TUNE +/− [8].

Tip

This system is equipped with the DSEE function to reproduce clear treble despite degradation caused by compression. The DSEE function is usually activated automatically by recognizing the sound source, but it may not be activated depending on the function in use.

Changing the display

To	Do the following:
View information on the display [10] ¹	Press DISPLAY [28] repeatedly when the system is on.
Display clock	Press DISPLAY [28] repeatedly when the system is off. ² The clock appears for about 8 seconds.

¹ You can view the information described below during playback of a CD-DA/MP3 disc.

² The information does not appear in BLUETOOTH mode.

CD-DA disc

—Remaining playing time of a track during playback

—total remaining playing time

MP3 disc

— track or file name

— artist name

— album name

Notes on the display information

•Characters that cannot be displayed appear as "...".

- The following are not displayed:
 - remaining playing time or total playing time for an MP3 disc
 - remaining playing time for an MP3 file
- The following are not displayed correctly:
 - elapsed playing time of an MP3 file encoded using VBR (Variable Bit Rate).
 - folder and file names that do not follow either the ISO9660 Level 1/Level 2 or Joliet in the expansion format.
- The following are displayed:
 - total playing time for a CD-DA disc (except when PGM mode is selected and the player is stopped)
 - remaining playing time for a track of CD-DA disc
 - remaining playing time for a CD-DA disc (only when Normal Play mode is selected during playback)
 - ID3 tag information for MP3 files. ID3 version 2 tag information display has priority when both ID3 version 1 and version 2 tags are used for a single MP3 file
 - up to 64 characters for an ID3 tag, where characters allowed are uppercase letters (A to Z), numbers (0 to 9), and symbols (" \$ % ' () * + , - . / < = > @ [\] ^ _ ' { | } ~ ^ ^ ^)

Using the timers

The system offers Sleep Timer and Play Timer. The Sleep Timer has priority over the Play Timer.

Setting the Sleep Timer

The system is turned off automatically after the time set for the Sleep Timer is elapsed. The Sleep Timer works even if the clock is not set.

- Press SLEEP [20] repeatedly to specify the time.
 - Select "30MIN" to turn off the system after 30 minutes.
 - To cancel the Sleep Timer, select "OFF."

Setting the Play Timer

You can listen to a CD-DA or MP3 disc or radio every day at a preset time. Make sure you have set the clock before setting the timer.

1 Prepare the sound source, and turn the VOLUME dial [17] on the unit left or right or press VOLUME +/− [17] on the remote to adjust the volume.

The available sound sources are: CD, USB, and TUNER (FM or AM) FUNCTION. To start from a specific CD track, audio file or radio station, create your own program.

2 Press TIMER MENU [19].

3 Press +/• [24] repeatedly to select "PLAY SET," then press [33].

The start time flashes in the display.

4 Set the time to start operation.

Press +/• [24] repeatedly to set the hour, then press [33].

The minute indication flashes. Use the procedure above to set the minutes.

When the start time is set, the system goes to the stop time setting.

5 Use the same procedure as in step 4 to set the time to stop the operation.

If "TIME NG" flashes in the display

The start time and the stop time are set to the same time. Change the stop time.

6 Select the sound source.

Press +/• [24] repeatedly until the desired sound source appears, then press [33].

For the available sound sources, see step 1. After the sound source selection is finished, the confirmation display for the Play Timer appears.

7 Press I/⏏ (power) [1] to turn off the system.

•When the Play Timer is set, the system automatically turns on about 15 seconds (for FM or AM) or about 90 seconds for a CD-DA disc or USB device) before the preset time.

•The Play Timer does not work if the system is on at the preset time. Be careful not to operate the system until it is turned on and starts play with the timer.

To check the setting

1 Press TIMER MENU [19].

2 Press +/• [24] repeatedly to select "TIMER SEL," and then press [33].

3 Press +/• [24] repeatedly to select "PLAY SEL," and then press [33].

The timer setting appears in the display.

To cancel the timer

Repeat the same procedure as "To check the setting" until "OFF" appears in step 3, and then press [33].

To change the setting

Start over from step 1.

Notes

- When the sound source for a Play Timer is set to a radio station that you set using Automatic Scanning (AUTO) or Manual Tuning (MANUAL) and you change the radio frequency or band after setting the timer, the radio station setting for the timer will also be changed.
- When the sound source for a Play Timer is set to a radio station tuned from a preset radio station (preset number 1 to 20), and if you change the frequency of the radio station or band after setting the timer, the radio station setting for the timer will not change. The radio station tuning for the timer is fixed at what you set for it.

Tip
The Play Timer setting remains as long as the setting is not cancelled manually.

Troubleshooting

1 Make sure the power cord is firmly connected.

2 Find your problem in the checklist below, and take the indicated corrective action.

If the issue persists, contact your nearest Sony dealer.

<p>If the STANDBY indicator [2] flashes</p> <p>Immediately unplug the power cord, and check the following item:</p> <ul style="list-style-type: none">Is the speaker cord shorted out? After the STANDBY indicator [2] stops flashing, reconnect the power cord, and turn on the system. If the issue persists, contact your nearest Sony dealer.
--

General

The system does not turn on.

- Is the power cord plugged in correctly?

The system has entered Standby mode unexpectedly.

- This is not a malfunction. The system enters Standby mode automatically in about 15 minutes when there is no operation or audio signal output. See "Setting the Automatic Standby function."

The clock setting or the Play Timer operation has been cancelled unexpectedly.

- If about a minute elapses with no operation, the clock setting or Play Timer setting is cancelled automatically. Perform the operation again from the beginning.

There is no sound.

- Make sure the speaker cords are connected correctly.
- Check the supplied speakers are used.
- Turn the VOLUME dial [17] on the unit clockwise or press VOLUME + [17] on the remote to turn up the volume.
- Make sure the headphones are disconnected from the headphone jack.
- Make sure an external component is connected correctly to the AUDIO IN jack [8] and set the function to AUDIO IN.
- The specified station may have temporarily stopped broadcast.

•The balance of left and right sound is false. Check the left and right speakers are connected correctly.

- Put the speakers symmetrically.
- Connect the supplied speakers.

Severe hum or noise occurs.

- Move the system away from sources of noise.
- Connect the system to a different wall outlet.
- Use of an AC power tap with a noise filter (not supplied) is recommended.

The remote does not function.

- Remove any obstacles between the remote and the remote sensor [3] on the unit, and position the unit away from fluorescent lights.

- Point the remote at the remote sensor on the unit.
- Move the remote closer to the system.

CD-DA/MP3 disc

"LOCKED" appears in the display [10] and the disc cannot be removed from the disc tray.

- Consult your nearest Sony dealer or local authorized Sony service facility.

The disc or file will not play.

•The disc that has not been finalized (a CD-R or CD-RW disc to which data can be added).

The sound skips, or the disc will not play.

- Wipe the disc clean, and replace it.
- Move the system to a location away from vibration (for example, on top of a stable stand).
- Oscillation of the speakers may be the cause of sound skips, depending on the volume level. Move the speakers away from the unit or change the location of the speakers.

Play does not start from the first track or file.

- Return to normal play by pressing PLAY MODE [27] repeatedly in stop mode until both "PGM" and "SHUF" in the display [10] disappear.

Starting playback takes more time than usual.

- The following discs can increase the time it takes to start playback:
 - a disc recorded with a complicated tree structure.
 - a disc recorded in multi-session format.
 - a disc that has many folders.

USB device

An unsupported USB device is connected.

•If you connect an unsupported USB device, the following problems may occur. Check the information on the websites about compatible USB devices with URLs listed under "Playing a file on a USB device."

—The USB device is not recognized.

—File or folder names are not displayed on this system.

—Playback is not possible.

—The sound skips.

—There is noise.

—A distorted sound is output.

There is no sound.

- The USB device is not connected correctly. Turn off the system, and then reconnect the USB device.

There is noise, skipping, or distorted sound.

- An unsupported USB device is connected.

- Connect a supported USB device.
- Turn off the system, and then reconnect the USB device and turn on the system.
- The music data itself contains noise, or the sound is distorted. Noise may have been entered when creating music data due to the conditions of the computer. In this case, delete the file and send the music data again.

- The bit rate used when encoding the files was low. Send files encoded with higher bit rates to the USB device.
- "**READING" is displayed for an extended time, or it takes a long time before playback starts.**"
 - The reading process may take a long time in the following cases:
 - There are many folders or files on the USB device.
 - The file structure is extremely complex.
 - Not enough free space in the memory.
 - The internal memory is fragmented.

The file or folder name (album name) is not displayed correctly.

- Send the music data to the USB device again, as the data stored in the USB device may have been corrupted.
- The character code that can be displayed by this system are as follows:
 - Upper cases (A to Z).
 - Numbers (0 to 9).
 - Symbols (<> * +, [] @ \ _).
 - Other characters appear as "..."

The USB device is not recognized.