

---

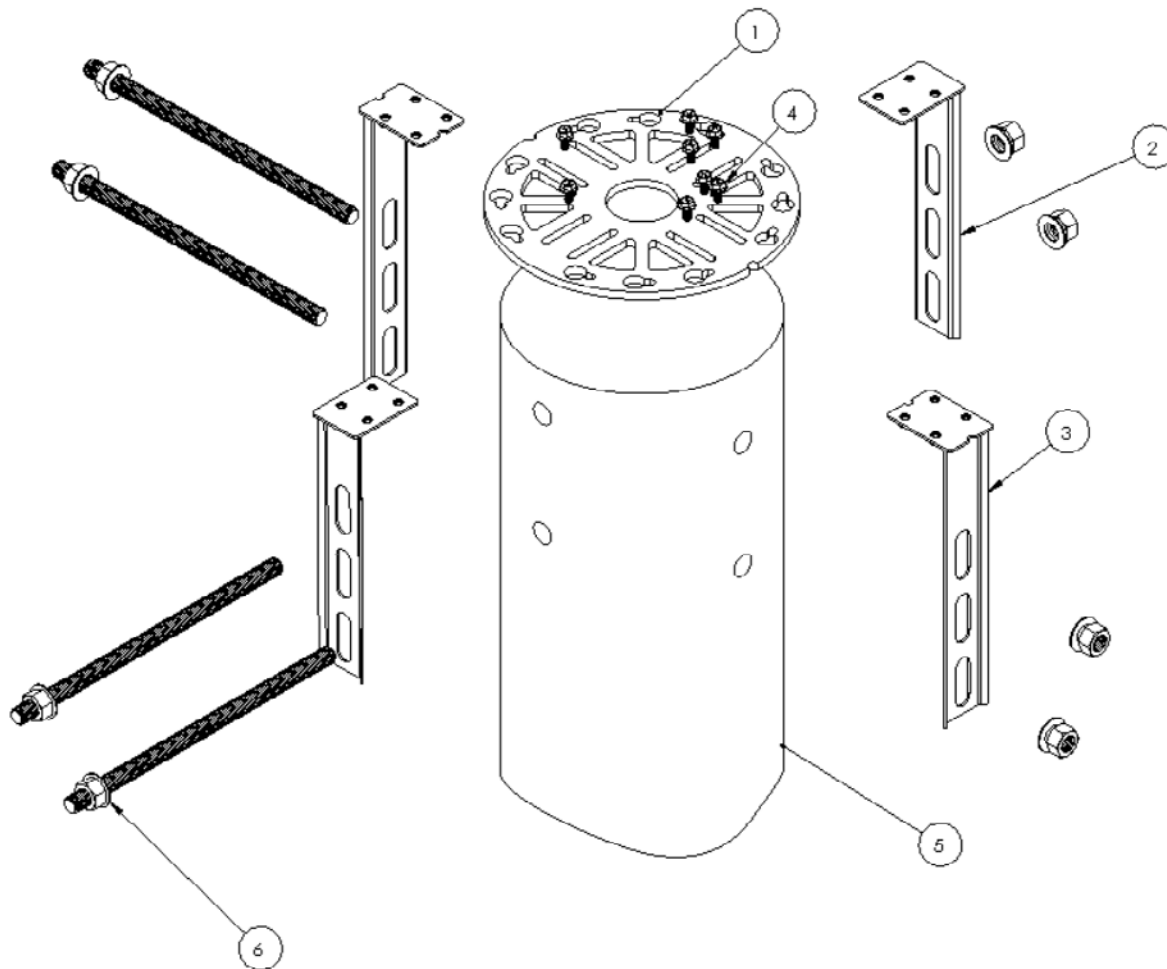

ITEM NO.	PART NO.	DESCRIPTION	QTY.
1	550-01740	POLETOP PLATE 24-360	1
2	550-01742	POLETOP SIDE ARM II 24-360	2
3	550-01741	POLETOP SIDE ARM 24-360	2
4	501-00469	BOLT, M8 X 16 FLANGE HEAD, GRADE 8 ZINC PLATED	8
5	REFERENCE	DUMMY POLE	1
6	REFERENCE	AEP SPECIFIED HARDWARE	4

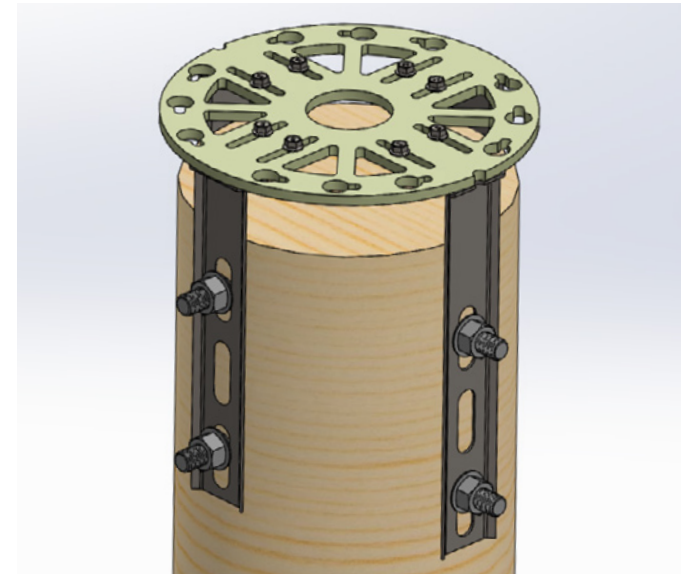

Mount is loosely assembled, all fasteners snugged. One axis levelled, tightened, second "tilt" corrected with mallet, all fasteners tightened

Tools: 13mm socket, socket for AEP-supplied pole bolts, mallet

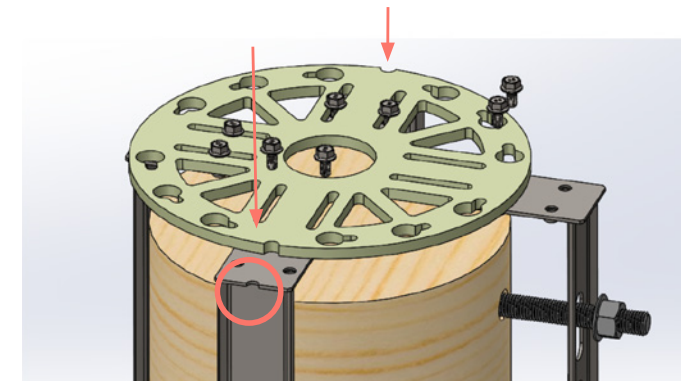

Note the difference between two types of Side Arm. One set is notched to be matched with notch on Poletop Plate.

## Starry Titan Poletop Mounting Radio

1. Complete radio head is preassembled with a lifting eye. Open crate top and secure to lift/cherry picker arm.

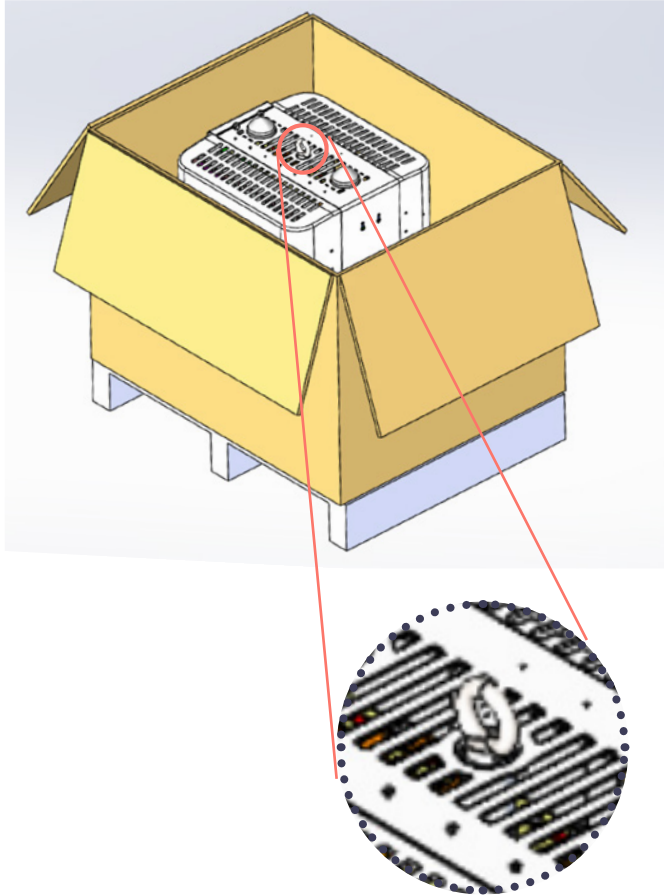

2. The 4 bolts (circled) drop through keyholes in the poletop mount. Rotate radio ~6° to lock into place.

Tool: 13mm combination wrench

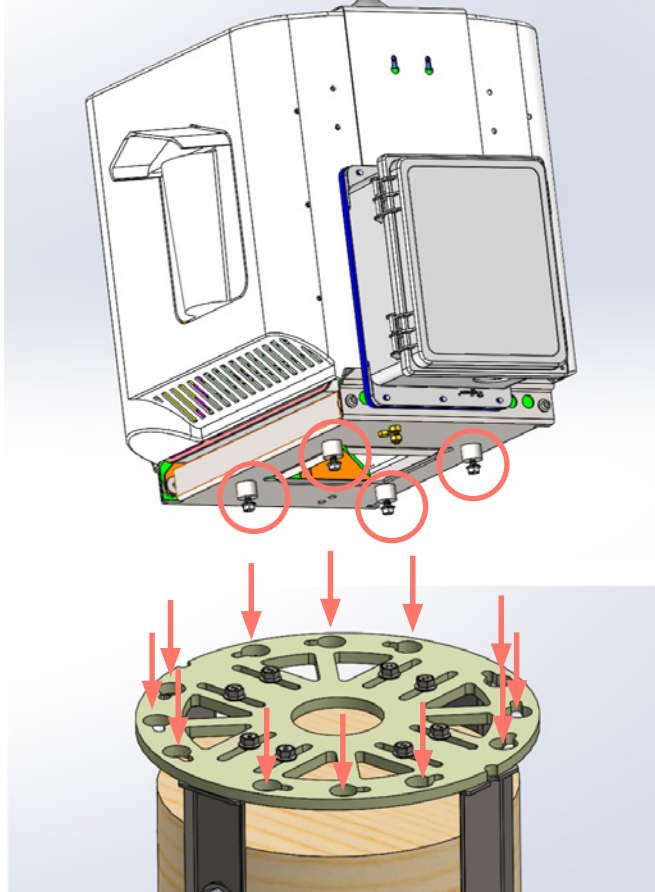

3. Attach conduits

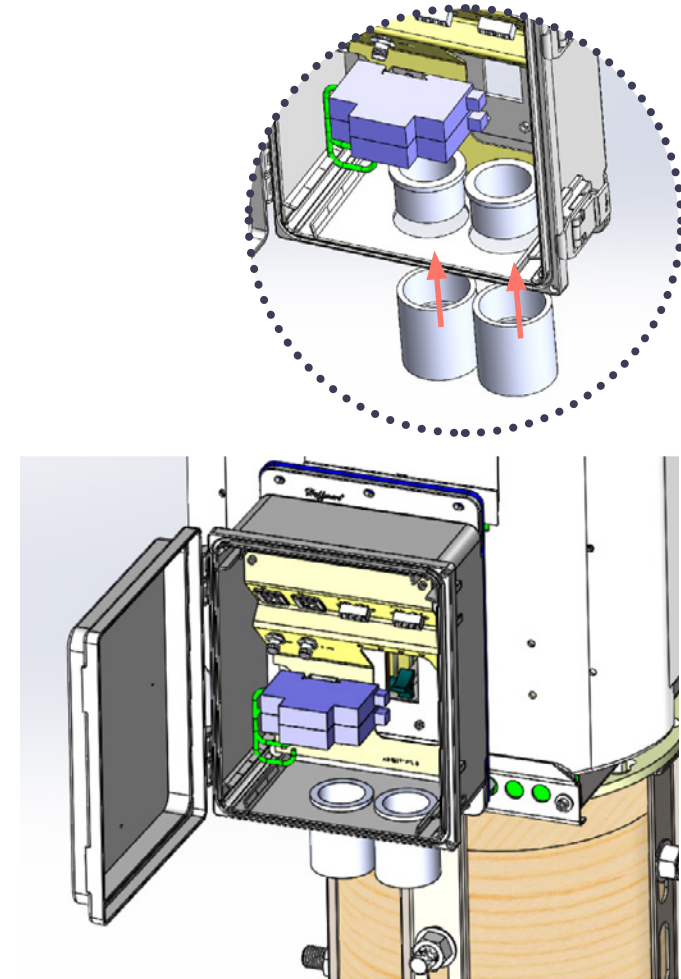

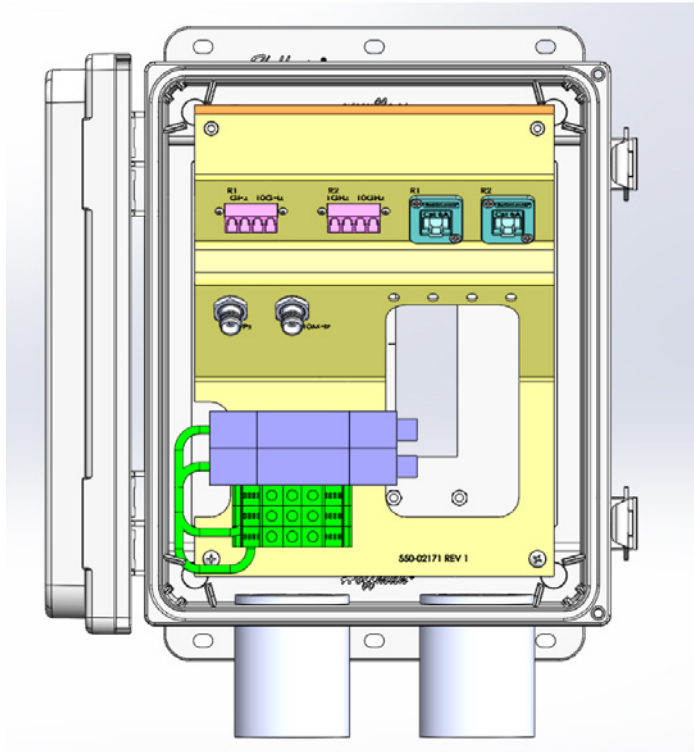

Radios are pre-wired into the service box.

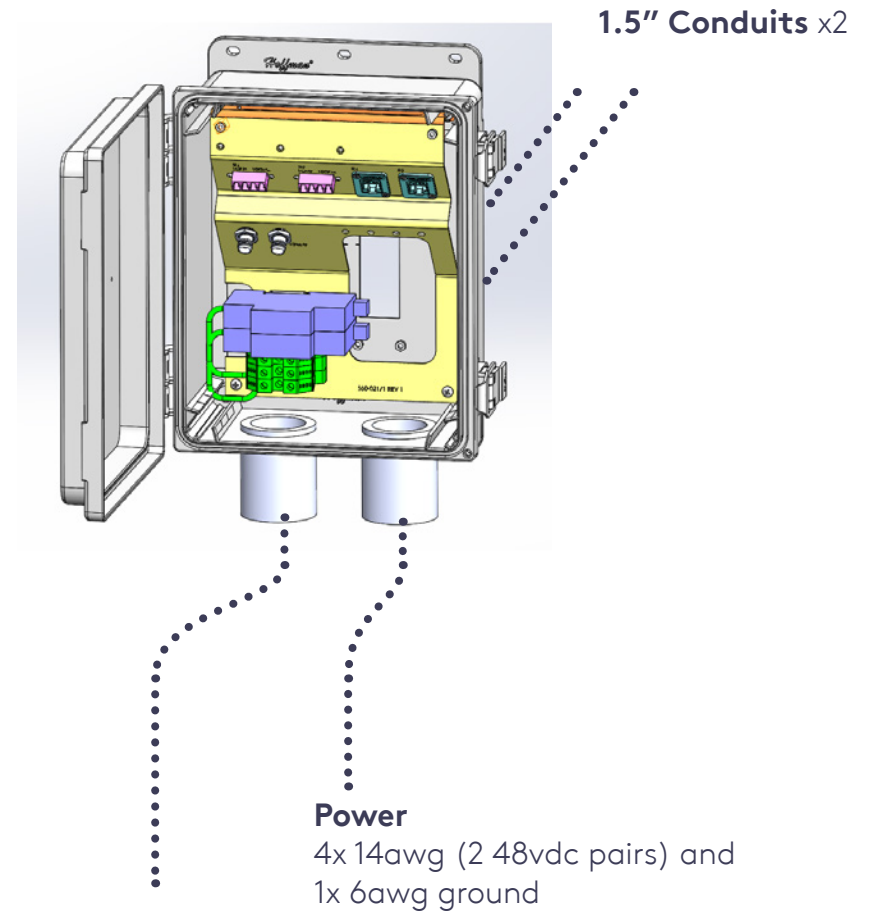

### Fiber

1gbps and 10gbps duplex per radio,  
10mhz and pps signals (tncs)



## Starry Titan Poletop SFP Replacement

1. Loosen top cover side screws and captive top screws. Slide up and off the unit.

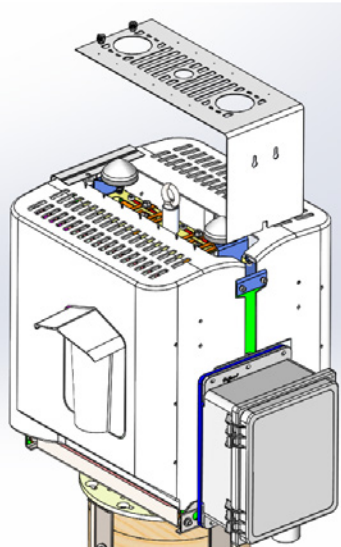

2. Unlock the side needing replacement: Loosen two bolts (13mm socket and extension)

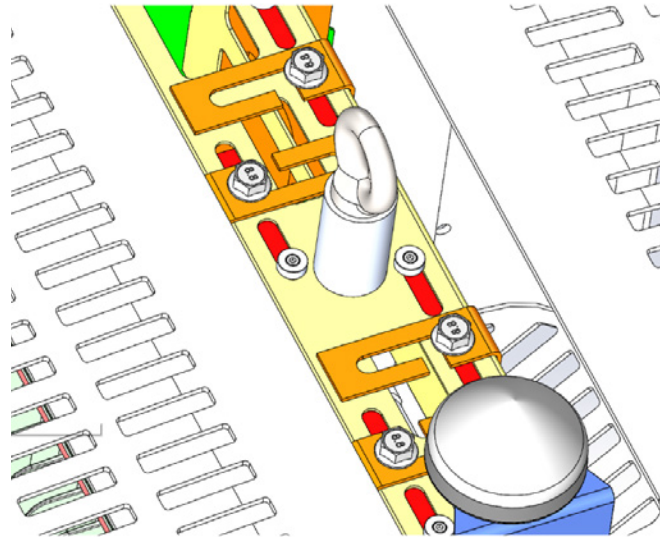

3. Tilt radio out slightly. Slide bolt carrier (red) out of engagement with radio frame (orange)

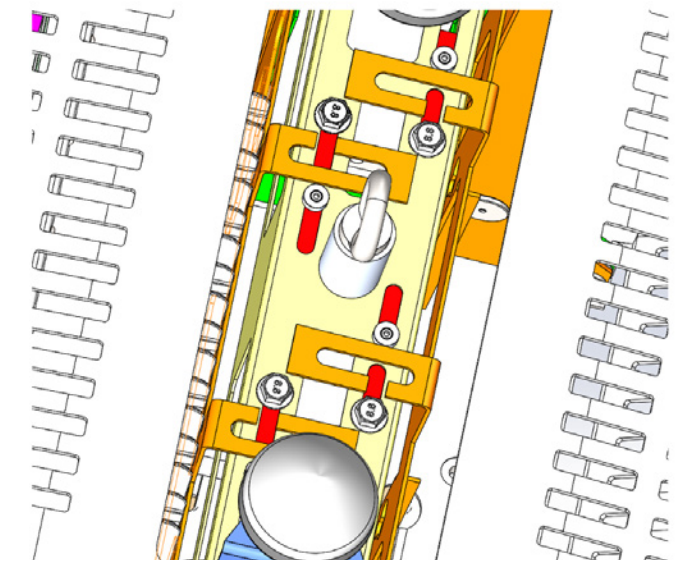

4. Gently lower radio to horizontal. Cable door is now accessible. Loosen lock knobs and swing down.

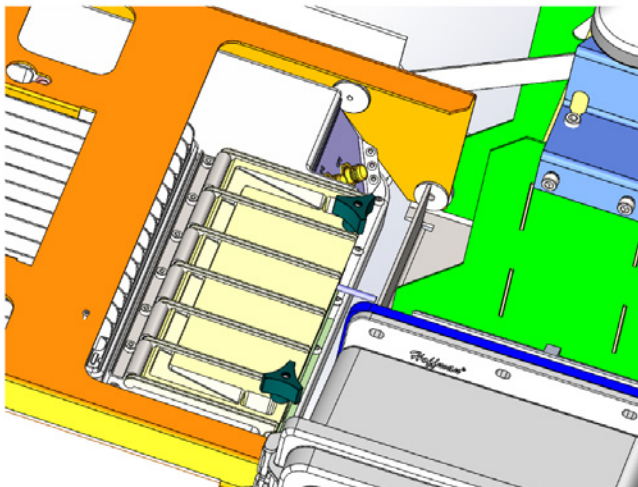

5. Swing locks down. Open cable door. Pull fiber. Unlock and remove SFP. Replace. Clean fiber and replace in socket.

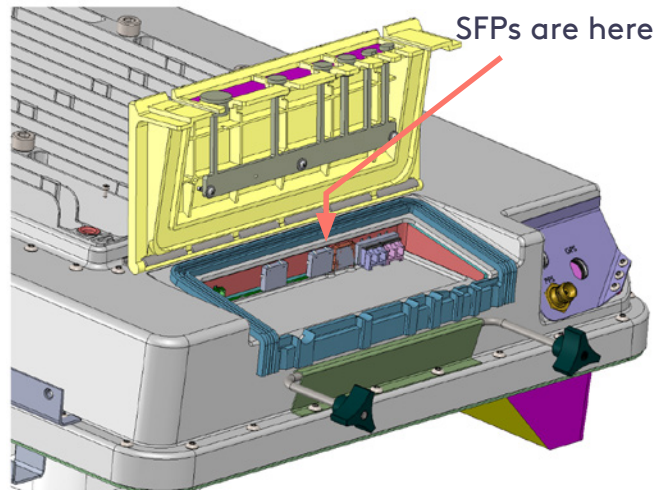

6. Close door. Ensure all cables and fibers are correctly seated in door slots. (Cables not shown)

