

## PROBLEM SOLVING:

Problem	Solution
No picture or sound on TV	<ul style="list-style-type: none"> <li>• Make sure the TV is turned on</li> <li>• Make sure the AC Adapters are plugged in</li> <li>• Make sure the outlets are working</li> <li>• Make sure the two Cameras are set on different channels. Toggle the TV between one channel or the other (try using the third channel to minimize interference if necessary)</li> <li>• Make sure the antenna on the TV is fully extended</li> </ul>
Sound but no picture on TV	<ul style="list-style-type: none"> <li>• Press the Quick View/Video On/Off Button once to turn on video mode</li> <li>• Try adjusting the Brightness, Contrast and Vertical Hold dials on the TV</li> <li>• Test reception by moving the TV and/or Camera to different locations</li> <li>• Make sure the two Cameras are set on different channels. Toggle the TV between one channel or the other (try using the third channel to minimize interference if necessary)</li> <li>• Make sure the antenna on the TV is fully extended</li> </ul>
Picture but no sound	<ul style="list-style-type: none"> <li>• Turn up the volume on the TV using the Volume Dial</li> <li>• Make sure the two Cameras are set on different channels. Toggle the TV between one channel or the other (try using the third channel to minimize interference if necessary)</li> <li>• Make sure the antenna on the TV is fully extended</li> </ul>
Picture not clear	<ul style="list-style-type: none"> <li>• Make sure the two Cameras are set on different channels. Toggle the TV between one channel or the other (try using the third channel to minimize interference if necessary)</li> <li>• Position the TV closer to the camera if necessary</li> <li>• Move TV away from other monitors, cordless phones, walk-talkies, etc.</li> <li>• Try adjusting the Brightness, Contrast and Vertical Hold dials on the TV</li> <li>• Test reception by moving the TV and/or Camera to different locations</li> <li>• Make sure the antenna on the TV is fully extended</li> </ul>
Squealing sound	<ul style="list-style-type: none"> <li>• Move the Camera and the TV further away from each other</li> </ul>

**If you experience a problem that is not noted in this manual, please do not return the product to the store. Our Customer Service Department may have a simple solution to your problem. Please contact us 1-800-268-6237 or e-mail us at customerservice@summerinfant.com.**

### FCC Information

This device complies with part 15 of the FCC Rules. Operation is subject to the following two conditions: (1) This device may not cause harmful interference, and (2) this device must accept any interference received, including interference that may cause undesired operation.

CAUTION: Changes or modifications not expressly approved by Summer Infant may void the users authority to operate this equipment.

NOTE: This equipment has been tested and found to comply with the limits for a Class B digital device, pursuant to part 15 of the FCC Rules. These limits are designed to provide reasonable protection against harmful interference in a residential installation. This equipment generates, uses and can radiate radio frequency energy and, if not installed and used in accordance with the instructions, may cause harmful interference to radio communications. However, there is no guarantee that interference will not occur in a particular installation. If this equipment does cause harmful interference to radio or television reception, which can be determined by turning the equipment off and on, the user is encouraged to try to correct the interference by one or more of the following measures:

- Reorient or relocate the receiving antenna
- Increase the separation between the equipment and the receiver
- Consult the dealer or an experienced radio/TV technician for help

We at Summer Infant stand behind all of our products. If you are not completely satisfied or have any questions, please contact our Customer Service Department at 1-800-268-6237 or e-mail us at customerservice@summerinfant.com

© 2002 Summer Infant, Inc.  
6 Blackstone Valley Place  
Suite 206  
Lincoln, RI 02865 USA  
1-800-268-6237  
www.summerinfant.com  
**MADE IN CHINA.**  
Colors and styles may vary.

10/02

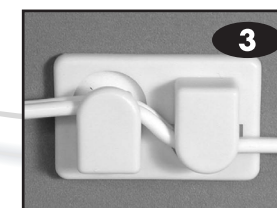
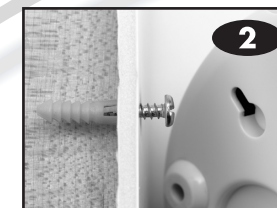

**02080**

Please read the following instructions carefully. Keep this instruction manual for future reference.

Phillips head screwdriver (not included).

**For Technical Support Call 1-800-268-6237 or E-Mail at customerservice@summerinfant.com**

### **WARNING:**

This product contains small parts. Adult assembly required. Exercise care when unpacking and assembling product.

## INSTRUCTION MANUAL

# BABY'S QUIET SOUNDS™ DUAL VIDEO MONITOR

Thank you for buying the 900 MHz Baby's Quiet Sounds™ Dual Video Monitor from Summer Infant. Now you can hear and see your baby! Ideal for older children too – monitor playroom activities! Two cameras allows parents to visually monitor 2 different locations in the home at the same time by switching channels

## QUICK SET UP:

Read the instruction manual for more detailed instructions and explanations.

- Place one Camera in nursery and position facing crib (do not place in crib or within child's reach). Tilt the Multi-Position Camera/Microphone so it is facing baby as much as possible. Use Security Clips included to secure Camera's cord away from baby's reach.
- Plug small AC Adapter into Camera's AC Adapter Jack and other end of cord into a standard electrical outlet.
- Turn Camera on and select channel by setting the Channel Selector (Off/A/B/C) to channel A.
- Position TV in the room from which you will monitor baby. Plug large AC Adapter into TV's AC Adapter Jack and plug the other end into a standard electrical outlet. Fully extend the TV's antenna.
- Turn TV on using Power On/Volume Dial. Set Channel Selector to channel A. You should now be able to see a view of the nursery and hear any sounds in the nursery. If you don't get a picture, press the Quick View/Video On/Off Button.
- If the picture is not clear, try switching both the Camera and the TV to channel B or channel C. Sometimes a slight adjustment to the Camera, TV and antenna can make a significant difference in reception.
- Adjust the volume on the TV as needed.
- To use the second Camera, set it up in another location, and ensure that the Channel Selector is set to channel B or C.

## ⚠️ WARNING:

THIS PRODUCT CANNOT REPLACE RESPONSIBLE ADULT SUPERVISION.

- Prevent cord entanglement – do not place Camera in crib or within arm's reach of baby. Use enclosed Security Clips to help secure cords away from baby's reach. Never use extension cords with AC adapters. Only use the AC Adapters provided.
- When an AC Adapter is plugged into an electrical outlet, do not touch the exposed end.
- Test monitor before first use, periodically, and when changing location of the Camera.

## ⚠️ CAUTION:

KEEP SMALL PARTS OUT OF CHILD'S REACH.

## FEATURES & COMPONENTS:

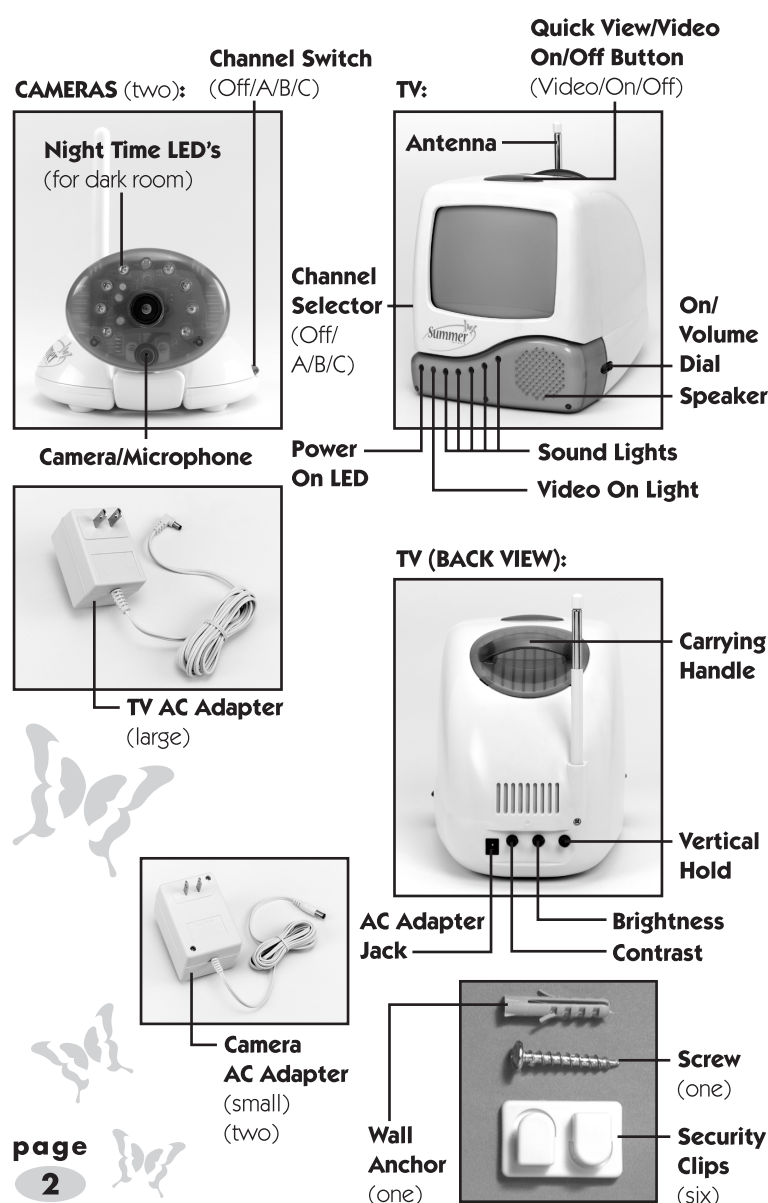

- Do not use monitor near water (such as bathtub, sink, etc)
- Keep monitor away from heat sources (such as stoves, radiators, etc) and make sure there is proper ventilation (not on sofas, cushions, beds, etc which may block ventilation)
- Nursery monitors use public airwaves to transmit signals. This monitor may pick up signals from other monitors or similar devices and vice versa.

## SET UP & USE:

### Camera

- 1 Table Top or Wall Mounting:** Tilt Camera/Microphone up, and pull up (see Figure A).

Determine a location for the Camera that will provide the best view of your baby in his crib. Place the Camera on a flat surface, such as a dresser, bureau, or shelf.

Or mount the Camera on a wall. **Be sure to test reception and Camera positioning before mounting to a wall (see "Testing Your Initial Set Up" section).**

### To Wall Mount:

- Pre-drill a hole in the wall (3/16", 4.8mm, drill bit). See Figure B.
- Insert the wall anchor (included) into the hole and with a hammer, tap gently on the end until the wall anchor is flush with the wall.
- Insert the screw (included) into the wall anchor and tighten screw until only 1/4" (6.2mm) of the screw is exposed.
- Insert smaller AC Adapter into the Camera's AC Adapter Jack.
- Slide the back of the Camera down onto the screw until the Camera is secure to the wall.
- Plug the AC Adapter into a standard electrical outlet.
- Secure the cord to the wall using the 6 Security Clips included to keep cord away from baby's reach (see Figure C).

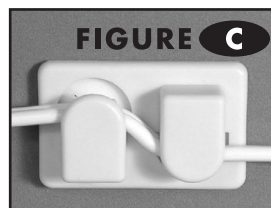
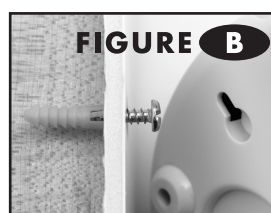

## SET UP & USE(continued):

### To Adjust Camera:

Place camera on a hard, well ventilated surface approximately 4 – 6 feet from the child or viewing object. Pivot camera lens upward until it is standing upright in the base. For additional height gently pull the camera lens up until you hear a click. For full extension, gently pull it up again until you hear another click. Adjust camera by turning left to right 180 degrees and tilting forward or backward for optimal viewing positions.

- 2** Set Channel Selector to channel A. The Power On LED will illuminate solid green.
- 3** Repeat for second Camera in another location, set to channel B or C.

### TV

- 1** Position TV in the room from which you will monitor your baby in the other location. Pull up the antenna until it is fully extended.
- 2** Plug the larger AC Adapter into the TV's AC Adapter Jack. Plug the other end into a standard electrical outlet.
- 3** Turn the TV on using the On/Volume Dial. The Power On LED will illuminate green. Set the Channel Selector to channel A. Press the Quick View/Video On/Off Button (labeled "Video ON/OFF") once for a view of the nursery. Switch to channel B or C to view the other location. When video mode is on, the Video On Light will illuminate green.

- 4** Adjust the volume as needed using the Volume Dial. Adjust picture using the Contrast, Brightness, and Vertical Hold Dials on the back of the TV.

- 5** For audio and no video, press the Quick View/Video On/Off Button again to shut off the video mode.

- 6** To turn the TV off completely, use the ON/Volume Dial.

### Testing Your Initial Setup:

Be sure to test your monitor's reception before initial use. We also recommend testing your monitor's reception periodically. Please keep in mind that the Baby's Quiet Sounds™ Video Monitor will not provide the same level of picture quality as your television with cable, satellite dish, or digital service.

To test reception you will need two adults. One adult should view the picture on the TV while the other is in the nursery to adjust the Camera. Often the quality of the reception can be improved by slightly repositioning the Camera, TV, or both. It may help to place a stuffed animal or doll in the crib to simulate the position and size of your baby. Adjust the picture quality on the TV as needed by using the Contrast, Brightness and Vertical Hold dials.

To test sound quality, have one adult speak in both a normal tone and a whisper near the crib. Adjust volume on the TV's Volume Dial as needed.

## TIPS FOR IMPROVING RECEPTION:

- Change the channel on both the TV and the Camera. Always make sure they are set to the same channel (both on A, both on B or both on C). Always make sure that each Camera is on a different Channel (i.e. one on Channel A, one on Channel B).
- Position the TV closer to the camera if necessary.
- Move TV away from other monitors, cordless phones, walk-talkies, etc.; even slightly could greatly improve reception.
- If you hear a feedback or squealing noise, move the Camera and the TV further away from each other.

## SPECIAL FEATURES:

- **Sound Lights:** The 5 Sound Lights will illuminate on the TV depending on the level of your baby's sounds. For example, if your child is just cooing, only one or two lights will illuminate. If your baby is crying, several will illuminate, depending on how loud she is crying. This feature is particularly helpful if you are in a noisy room.
- **Night Vision:** In a darkened room the monitor will automatically use its infrared LED's to transmit a clear image of baby, so you can see your child at night!
- **Multi-Position Camera/Microphone:** The Camera/Microphone should be positioned so it is facing baby as much as possible. This multi-position feature is unique to Summer Infant nursery monitors. It allows the microphone to focus on baby's voice while filtering out other household noises.
- **Quick View/Video On/Off Button:** This button turns the video mode on. If you only want to hear your baby, press the Quick View//Video On/Off Button again to shut off the video. The Quick View/Video On/Off Button is ideal for easily turning on the video option in the middle of the night.
- **Channel Switch:** Three channels allows parents to view two different locations, with the option of selecting channels that minimize interference.