

COBY



CSTV-130

WIRELESS TV SPEAKER

Safety Instructions & Warnings



WARNING: To reduce the risk of electric shock, do not remove cover (or back). No user-serviceable parts inside. Refer servicing to qualified service personnel.



The exclamation point within an equilateral triangle is intended to alert the user to the presence of important operating and maintenance (servicing) instructions in the literature accompanying the appliance.



The lightning flash with arrowhead symbol, within an equilateral triangle, is intended to alert the user to the presence of uninsulated "dangerous voltage" within the product's enclosure that may be of sufficient magnitude to constitute a risk of electric shock to persons.



This symbol indicates that this product incorporates double insulation between hazardous mains voltage and user accessible parts.

WARNING: DO NOT INGEST BATTERY, CHEMICAL BURN HAZARD.



WARNING: This product can expose you to chemicals including lead, which is known to the State of California to cause cancer and birth defects or other reproductive harm. For more information go to www.P65Warnings.ca.gov. **This product meets and complies with all Federal regulations.**

Important Safety Instructions

- Read these Instructions.
- Keep these Instructions.
- Heed all Warnings.
- Follow all instructions.
- Do not use this apparatus near water.
- Clean only with a dry cloth.
- Do not block any ventilation openings. Install in accordance with the manufacturer's instructions.
- Do not install near any heat sources such as radiators, heat registers, stoves, or other apparatus (including amplifiers) that produce heat.
- Do not defeat the safety purpose of the polarized or grounding - type plug. A polarized plug has two blades with one wider than the other. A grounding type plug has two blades and a third grounding prong. The wide blade or the third prong are provided for your safety. When the provided plug does not fit into your outlet, consult an electrician for replacement of the obsolete outlet.
- Protect the power cord from being walked on or pinched particularly at plugs, convenience receptacles, and the point where they exit from the apparatus.
- Only use attachments/accessories specified by the manufacturer.
- Unplug this apparatus during lightning storms or when unused for long periods of time.
- Refer all servicing to qualified service personnel. Servicing is required when the apparatus has been damaged in any way, such as power-supply cord or plug is damaged, liquid has been spilled or objects have fallen into the apparatus, the apparatus has been exposed to rain or moisture, does not operate normally, or has been dropped.
- Use only with a cart, stand, tripod, bracket, or table specified by the manufacturer, or sold with the apparatus. When a cart is used, use caution when moving the cart/apparatus combination to avoid injury from tip-over.



FCC Warnings

This device complies with part 15 of the FCC Rules. Operation is subject to the following two conditions: (1) This device may not cause harmful interference, and (2) this device must accept any interference received, including interference that may cause undesired operation.

Any Changes or modifications not expressly approved by the party responsible for compliance could void the user's authority to operate the equipment.

Note: This equipment has been tested and found to comply with the limits for a Class B digital device, pursuant to part 15 of the FCC Rules. These limits are designed to provide reasonable protection against harmful interference in a residential installation. This equipment generates uses and can radiate radio frequency energy and, if not installed and used in accordance with the instructions, may cause harmful interference to radio communications. However, there is no guarantee that interference will not occur in a particular installation. If this equipment does cause harmful interference to radio or television reception, which can be determined by turning the equipment off and on, the user is encouraged to try to correct the interference by one or more of the following measures:

- Reorient or relocate the receiving antenna.
- Increase the separation between the equipment and receiver.
- Connect the equipment into an outlet on a circuit different from that to which the receiver is connected.
- Consult the dealer or an experienced radio/TV technician for help.

FCC Radiation Exposure Statement

The device has been evaluated to meet general RF exposure requirement. The device can be used in portable exposure condition without restriction.

Additional Warnings and Precautions

- **CAUTION:** Danger of explosion if battery is incorrectly replaced. Replace only with the same or equivalent type.
 - Battery shall not be exposed to excessive heat such as sunshine, fire or the like.
 - Keep new and used batteries away from children. If the battery compartment does not close securely, stop using the product and keep it away from children.
 - If you think batteries might have been swallowed or placed inside any part of the body, seek immediate medical attention.
 - Do not mix old and new batteries.
 - Completely replace all old batteries with new ones.
 - Do not mix alkaline, standard (carbon-zinc), or rechargeable (ni-cad, ni-mh, etc) batteries.
 - Batteries should be recycled or disposed of as per state and local guidelines.
-
- **CAUTION:** TO PREVENT ELECTRIC SHOCK, MATCH WIDE BLADE OF PLUG TO WIDE SLOT, FULLY INSERT.
 - Mains plug is used as disconnect device and it should remain readily operable during intended use. In order to disconnect the apparatus from the mains completely, the mains plug should be disconnected from the mains socket outlet completely.
 - **WARNING:** Shock hazard - Do Not Open.
 - Caution and marking information is located at the rear or bottom of the apparatus.
 - **WARNING:** To reduce the risk of fire or electric shock, do not expose this apparatus to rain, moisture, dripping, or splashing.
 - Objects filled with liquids, such as vases, shall not be placed on the apparatus.
 - **CAUTION:** Use of controls or adjustments or performance of procedures other than those specified may result in hazardous radiation exposure.
 - **WARNING:** Changes or modifications to this unit not expressly approved by the party responsible for compliance could void the user's authority to operate the equipment.
 - **WARNING:** Do not place this unit directly onto furniture surfaces with any type of soft, porous, or sensitive finish. As with any rubber compound made with oils, the feet could cause marks or staining where the feet reside. We recommend using a protective barrier such as a cloth or a piece of glass between the unit and the surface to reduce the risk of damage and/or staining.
 - **WARNING:** Use of this unit near fluorescent lighting may cause interference regarding use of the remote. If the unit is displaying erratic behavior move away from any fluorescent lighting, as it may be the cause.
-

Setup

Features & Specifications

Supports Bluetooth range 60 ft

Line in (3.5mm audio input)

Optical audio input

UHF wireless connection between speaker and docking station

Built-in rechargeable battery (speaker)

Includes

- USB cable x1pc (1 meter)
- AC adapter x1pc
- User manual x1pc

Product Overview

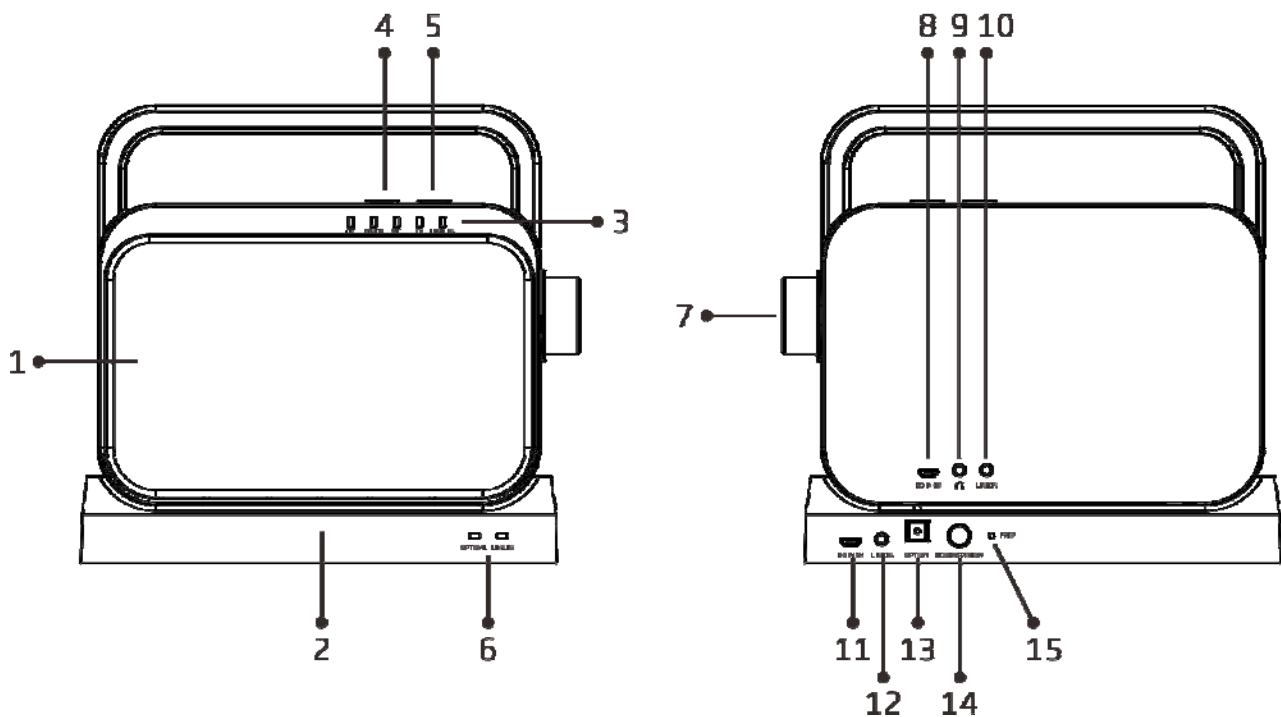

1. Speaker
2. Docking station
3. Speaker indicators
4. MUTE button - Press to mute the sound or resume the sound.
5. MODE button - Press MODE button repeatedly to switch between BT、TV and Line in function..
6. Docking station indicators
7. Knob – Twiddle the knob to turn on/off the speaker, and adjust the volume
8. DC power input of speaker
9. Earphone jack
10. Line in jack on speaker

11. DC power input of docking station
12. Line in jack on docking station
13. Optical in jack
14. MODE/STANDBY – Press Mode button on docking station repeatedly to choose your connection method.
Press and hold the button to standby the unit.
15. PAIR button – Press the Pair button to re-pair the speaker and the docking station.

LED Indicators

	Status	Indicator
Speaker	battery	Full charged : red light on Battery lower than 10%: green light blinking Battery ran out: unit off Charging battery : Red light on
	Mute	Red
	BT	Blue
	TV(optical mode)	Orange
	Line in	Green
Docking Station	Optical	Orange
	Line in	Green

SPEAKER CONNECTION & BLUETOOTH SETUP

Pairing a Bluetooth device

Refer to the user's manual for your specific device for instructions on pairing and connecting Bluetooth devices.

1. When pairing, the device should remain within 3 feet of the speaker.
2. Press the MODE button repeatedly to select the BT mode.
3. Using the native controls on your Bluetooth device, scan for and select CSTV-130 in your Bluetooth setting to pair.
4. If your device requests a password, enter 0000.
5. When successfully paired, a voice will announce "Bluetooth is connected". The blue pairing indicator will stop flashing and will remain solid. Your Bluetooth device will now be heard through the speaker.
6. After initial pairing, the unit will stay paired unless unpaired manually by the user or erased due to a reset of the device.

Previously Connected Devices

- The speaker can remember multiple Bluetooth devices and will always try to re-connect to the last device used.
- To re-connect to a different device, turn off Bluetooth on unwanted devices, and then access the Bluetooth settings menu on the device you wish to use and select CSTV-130.

Troubleshooting

If the speaker should become unpaired or will not connect normally, follow these steps in your device's Bluetooth

setting menu.

- Delete the speaker (“Forget This Device”).
- Turn Bluetooth off, then on again, and repeat the initial Bluetooth connection steps.

Line In

Requires a 3.5mm audio cable (not included).

1. Connect a 3.5mm audio cable to the Line in on the docking station and the audio output/headphone jack on an audio device.
2. Press Mode button repeatedly on both docking station and speaker to switch to Line in mode. A voice will announce the mode status and the indicators on both speaker and docking station will turn green.
3. Use the controls on the connected device to select and play audio, the audio you play will be transmitted to the speaker wirelessly. Be sure distance between docking station and speaker is within 33 feet.

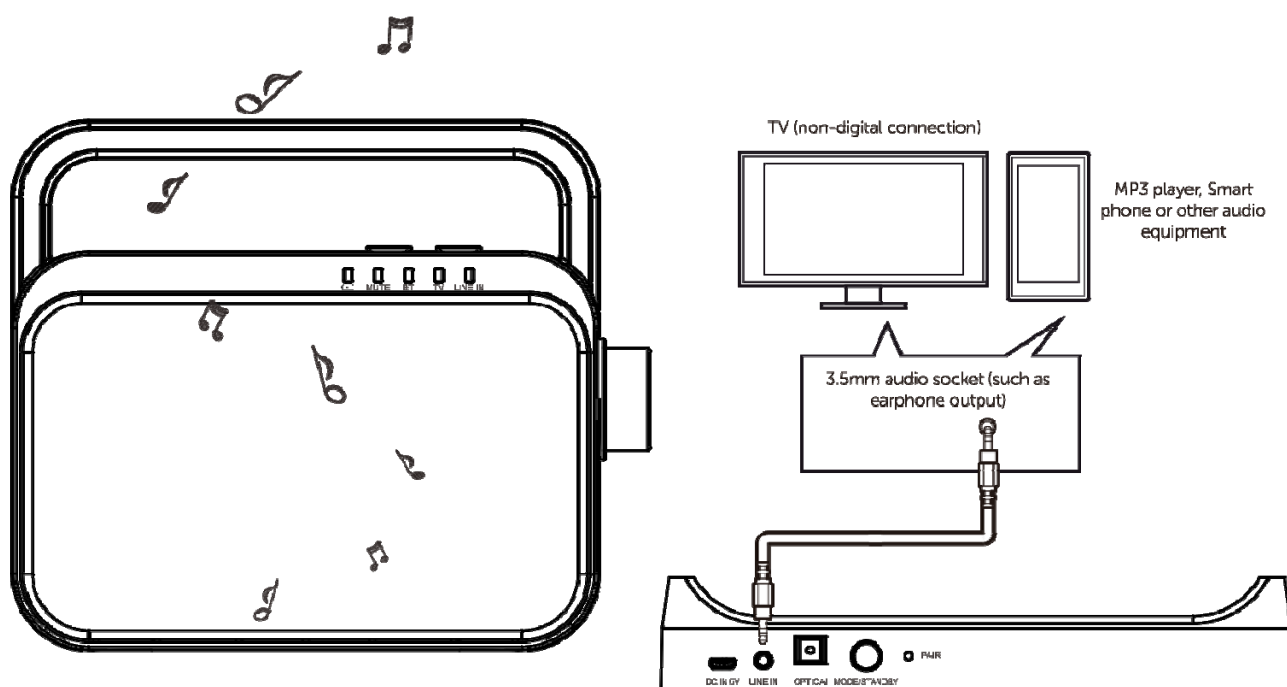

Or you can directly connect a 3.5mm cable to the line in on the speaker, use the controls on the connected device to select and play audio, now the audio you play can be heard from the speaker.

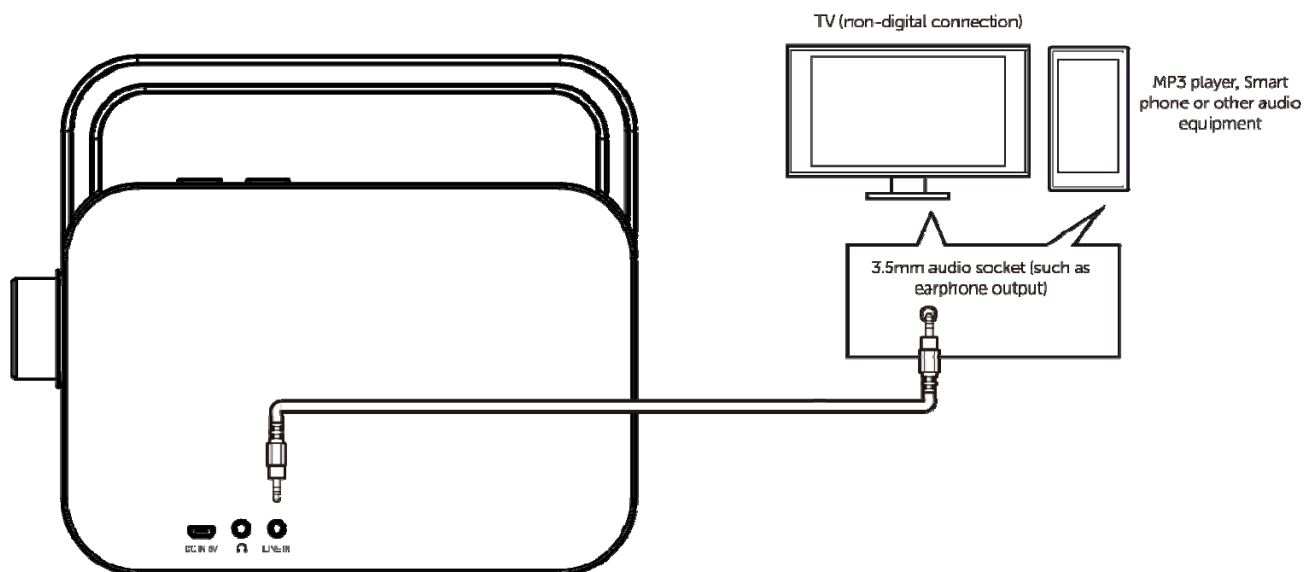

Optical Input

Requires an audio source with an optical audio output and a digital optical audio cable (not included).

1. Using a digital optical audio cable, connect the optical input on the speaker to the optical output on your audio source (TV, mobile etc.).
2. Power on the speaker and press mode button repeatedly on both docking station and speaker to select optical mode. A voice will announce the mode status from the speaker, the indicators on both speaker and docking station will turn orange.
3. On the connected audio source (TV, amplifier, etc.), be sure the audio settings are set to PCM or Optical audio.
4. Audio played through the connected audio source (TV, amplifier, etc.) should now be heard through the speaker.

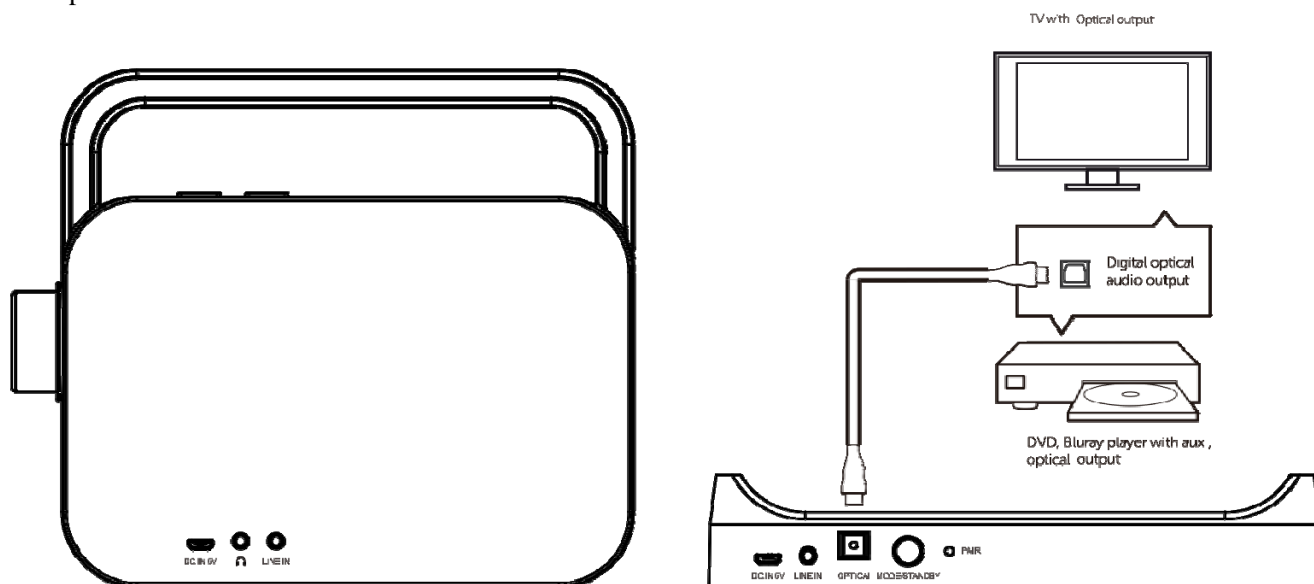

Earphone Input

1. To connect the external audio device with speaker via Bluetooth/ Line in /Optical in mode. (Please refer to above connection step)
2. After successfully connected, plug a 3.5mm earphone (not included) into the earphone jack.
3. Audio can be heard from your earphone now.

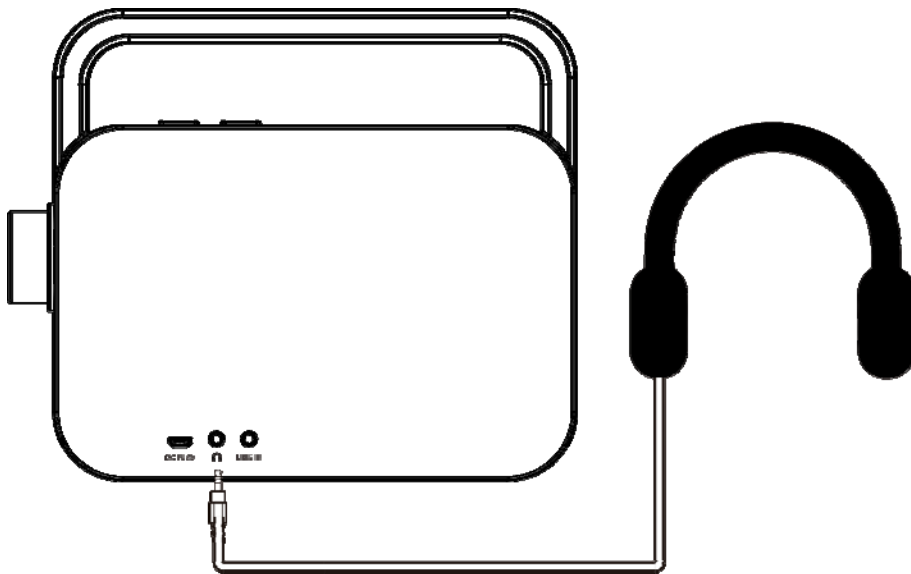

Pairing the speaker with docking station

The speaker should have been paired with docking station before use. This step should be done during manufacturing.

If you find the speaker not pairing with the docking station, please follow below step to re-pair the unit.

1. Turn off the speaker
2. Power on the docking station, press and hold the PAIR button for 3 seconds
3. Turn on the speaker and press the PAIR button again to re-pair the speaker and the docking station.
4. Now the speaker should be successfully paired with the docking station, audio can be heard from the speaker.

