



FPO

Sunbeam®

Rest & Relieve™
Therapeutic Mattress Pad
USER MANUAL



FPO



FPO

Sleep warm. Sleep well.™

www.sunbeam.com

WELCOME

Thank you for choosing the Sunbeam® Rest & Relieve™ Therapeutic Mattress Pad, the ultimate in sleeping comfort. It features adjustable heat zones that you can customize to suit your preferences, so you wake up well rested and refreshed.

Table of contents:

Step-by-Step Setup	3-4
Twin or Full Size Mattress Pad	5-6
Queen or King Size Mattress Pad	10-12
Care and Cleaning	17-18
Frequently Asked Questions	19-21
Warranty	22
How to Obtain Warranty Service	23

DO NOT RETURN THIS PRODUCT TO THE PLACE OF PURCHASE.

If you have any questions while setting up or using your Mattress Pad, please visit us at www.sunbeam.com or contact Sunbeam Consumer Care at (800) 892-7684.

IMPORTANT INSTRUCTIONS DO NOT DESTROY

Warnings and Safeguards

As with all electrical products, misuse of product or failure to properly follow the instructions may cause overheating, fire or personal injury. Please read the product label and all of the instructions before using your heated product.

- 1 DO NOT** use this heated product with an infant, a child, an incapacitated or immobile person, a paraplegic, a quadriplegic, a diabetic, one insensitive to heat such as a person with poor blood circulation, or anyone who cannot clearly understand the instructions and/or operate the controls.
- 2 DO NOT** route electrical cords between the mattress and box spring.
DO NOT allow cords to be pinched.
- 3 DO NOT** use with damaged cords. Damaged cords can lead to fire.
DO NOT tuck in, trap, fold, cross or pinch cords between bed slats, mattress or springs, or against walls, footboards or bed frame.
- 4 DO NOT** dry clean this heated product. Cleaning liquid may damage the insulation of the heating element. Improper laundering may cause problems with the heating wire which can lead to fire.
- 5 DO NOT** tuck in, pinch, flex or expose the heating wire to rubbing. A damaged heating wire may result in possible overheating or fire. **DO NOT** tuck the heated product or supply cord in a sofa or other furniture. All portions of the heated product and controller should be visible at all times.
- 6** Turn off or unplug the control for the heated product when not using.
- 7** Wrapping the cord around the controller may damage the cord.
Loop loosely when storing.
- 8** Keep the control away from drafty areas that may become damp or wet such as an open window.
- 9 DO NOT** use pins; they may damage the electric wiring.

IMPORTANT INSTRUCTIONS DO NOT DESTROY

- 10** Be sure this blanket/mattress pad/throw is used only on an AC supply current circuit of 110-120 volts. **DO NOT** use with an extension cord.
- 11** May experience increased heat in areas where heated product is bunched or folded while in use.
- 12** Keep all dogs, cats and other pets away from this heated product. This is an electrical appliance that they can damage or be injured by.
- 13 DO NOT** use blanket/mattress pad on a waterbed, sofa, bunk bed or mechanically adjustable bed and do not use throw on a waterbed, bunk bed or mechanically adjustable bed.
- 14** For throw blankets: **DO NOT** use with rocking chairs, recliners, chairs with casters or wheels, or other furniture subject to movement.
- 15 DO NOT** use another electronic heating device in conjunction with your heated product.
- 16** Use the proper size blanket/mattress pad for your bed. For example, use a Twin Size warming blanket on a Twin Size bed.
- 17** If the following Important Instructions are not followed, the heated product will not operate properly.
- 18** Not for hotel, motel or other institutional use.
- 19** If you see the heated product operating improperly, unplug it immediately and call Sunbeam Consumer Care at 800-892-7684.

STEP-BY-STEP SETUP

Your Sunbeam® Rest & Relieve™ Therapeutic Mattress Pad Includes:

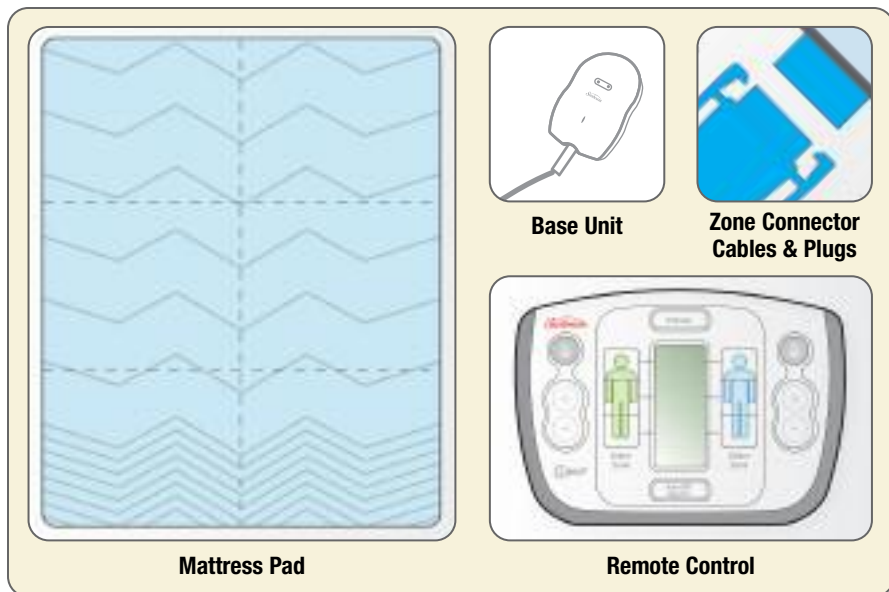

Installing the Batteries

- 1 Remove the battery compartment door from the back of the remote control.
- 2 Insert three AAA batteries, matching the + and – battery ends to the symbols in the battery compartment.
- 3 Replace the battery compartment door.



STEP-BY-STEP SETUP

Mattress Pad Setup

- 1 Place the Mattress Pad on the bed with the label at the foot of the bed facing outward. This puts the zones in the proper position to warm your body ergonomically.
- 2 Place the base unit on the floor under the bed, and run the Connector cable(s) along the floor to the foot of the bed. (DO NOT sandwich the cable(s) between the mattress and box spring. Avoid tangling or pinching.)
- 3 **TWIN OR FULL SIZE:** Connect the Blue plug to the Blue Connector until the plastic hinges click in place.
QUEEN OR KING SIZE: Connect the Blue plug to the Blue Connector, and connect the Green plug to the Green Connector until the plastic hinges click in place.
- 4 Plug the power cord into a 110–120 volt wall outlet.

CAUTION: Cables must be COMPLETELY CONNECTED.
A risk of fire could result from a loose connection.

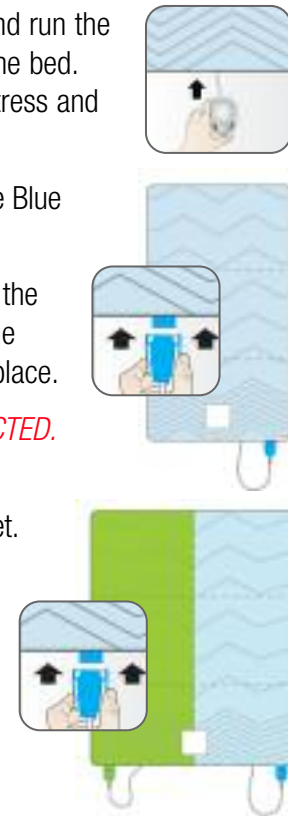

Important

CAUTION:

- **DO NOT** plug the power cord into the wall outlet until you have completely set up your Mattress Pad per the instructions.
- Disconnect power cord from wall before detaching the base unit from the Mattress Pad.
- **DO NOT** attempt to force the plug. This appliance has a polarized plug (one blade is wider than the other). To reduce the risk of electrical shock, this plug is intended to fit only one way into an outlet. If the plug does not fit in the outlet, reverse the plug. If it still does not fit, contact a qualified electrician.

TWIN OR FULL SIZE MATTRESS PAD

Features:

- Three adjustable heat zones for your individual total-body comfort
- 10 temperature settings per zone to create your ideal sleep experience
- Preheat setting to warm up your bed before bedtime
- Auto Off conveniently shuts off the Mattress Pad after 10 hours of operation
- Cordless remote control operation for easy use from bed
- Electronic display control with backlight for nighttime viewing

Heat Zones

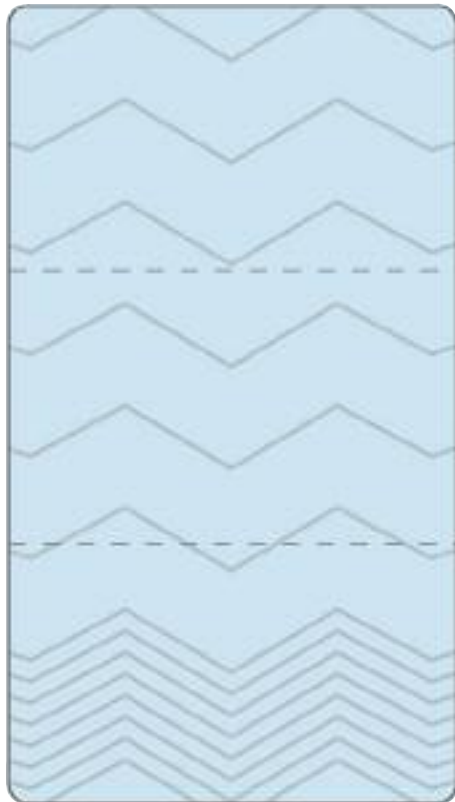

Blue Zone
Neck and Shoulders

Blue Zone
Lumbar

Blue Zone
Feet

TWIN OR FULL SIZE MATTRESS PAD

Remote Control At-a-Glance

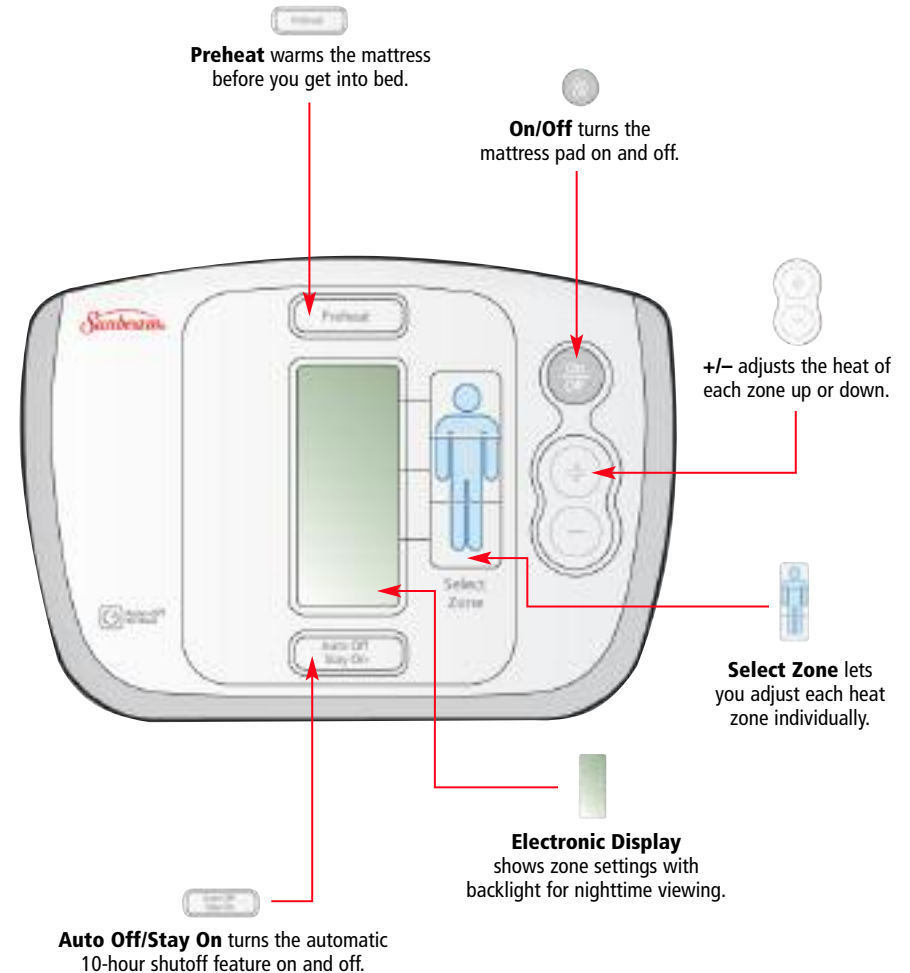

NOTE: To prevent accidental changing of your selections while the Mattress Pad is on, the remote control and display will lock during periods of inactivity. To reactivate the control, press any of the zones or the “+” or “-” buttons.

OPERATING INSTRUCTIONS

Turning the Mattress Pad ON and OFF

Turn on the Mattress Pad on or off by pressing the “On/Off” button on the remote control. When on, the base unit will beep once, the display will light up, and all zones will appear outlined.

NOTE: The backlight turns off after one minute to save battery power, but the Mattress Pad remains on. To turn the backlight on again, touch any button on the control other than the “On/Off” buttons.

Your customized heat settings are stored in memory so the next time you turn it on, the Mattress Pad returns to the same preferences as the last session.

CAUTION: Always turn the Mattress Pad “Off” when not in use.

Adjusting the Blue Zones at Once

Your Mattress Pad features 10 adjustable heat levels per zone that can be increased or decreased together or separately.

To adjust all the zones up or down from their current settings, press the “+” button to increase or the “-” button to decrease the heat. All the zones will change together in the same increments.

The display shows each zone’s heat setting: 1 through 9, and then H, which is the warmest setting. A “-” on the display indicates that the zone will not heat.

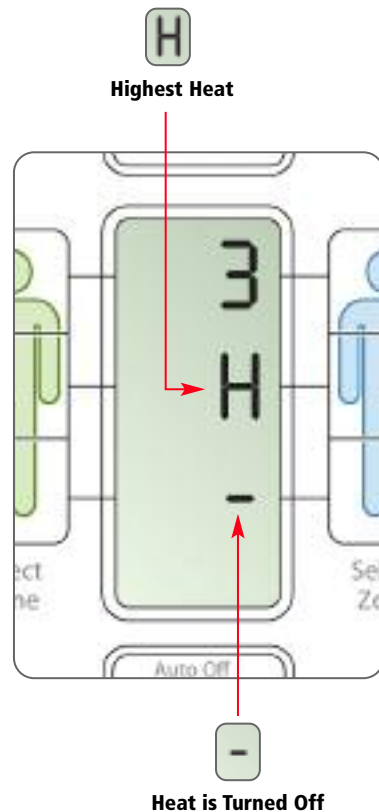

OPERATING INSTRUCTIONS

Adjusting Zones Individually

- 1 To adjust any zone individually, press the “Select Zone” button that corresponds to the zone you want to adjust. That zone will become outlined on the display and will be the only zone that changes when you press the “+” and “-” buttons.
- 2 Press the “+” or “-” button to adjust the heat of the selected zone.
- 3 To change another zone’s setting, repeat Steps 1 & 2.

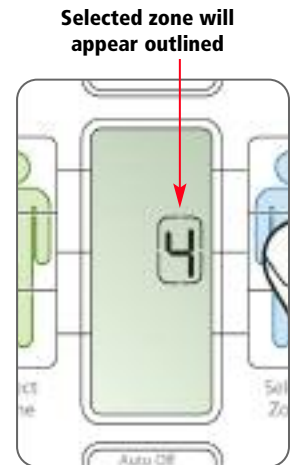

NOTE: To Change all zones at once turn off the Mattress Pad and turn it back on. Or you can wait 60 seconds until the zone’s outline disappears, then press the “+” or “-” button.

Preheating the Mattress Pad

Never get into a cold bed again during the Winter season. Preheat warms your Mattress Pad before you get in.

To preheat:

Turn Mattress Pad on. Press the “Preheat” button. All zones will show a “P” while they are preheating unless a zone is turned off.

The zones will heat for 30 minutes and then return to their previously programmed heat settings.

NOTE: Zones with no heat setting (-) will not preheat.

NOTE: To cancel preheat after activating it, press the “Preheat” button again. The Mattress Pad’s regular heat settings will resume.

NOTE: At least one zone must be selected for the preheat function to work.

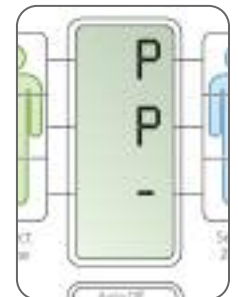
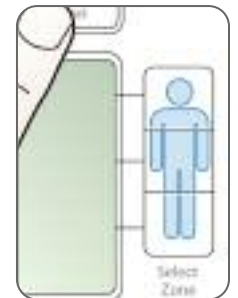

OPERATING INSTRUCTIONS

Auto Off

Auto Off conserves energy by automatically turning off the Mattress Pad after 10 hours of use. This is the factory default setting, and the display will read “Auto Off” when this feature is active.

To deactivate Auto Off: press the “Auto Off/Stay On” button.

The display will read “Stay On”, and the Mattress Pad will remain on until you turn it off manually using the “On/Off” button.

To reactivate Auto Off: press the “Auto Off/Stay On” button until the display shows “Auto Off”.

NOTE: After a power outage, turn the remote off then turn on again to turn the mattress pad back on. The timer of the Auto Off feature automatically resets.

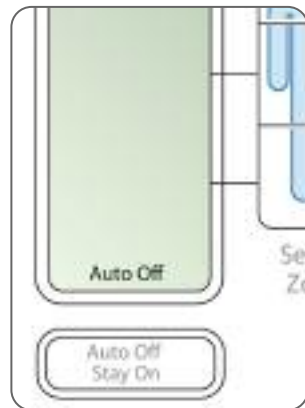
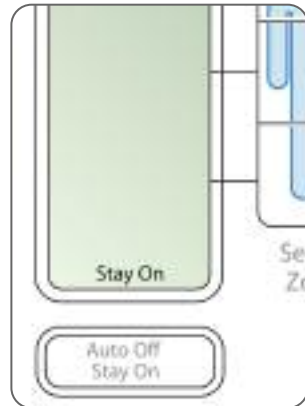

QUEEN OR KING SIZE MATTRESS PAD

Features:

- Three adjustable heat zones for your individual total-body comfort
- 10 temperature settings per zone to create your ideal sleep experience
- Preheat setting to warm up your bed before bedtime
- Auto Off conveniently shuts off the Mattress Pad after 10 hours of operation
- Cordless remote control operation for easy use from bed
- Electronic display control with backlight for nighttime viewing

Remote Control At-a-Glance

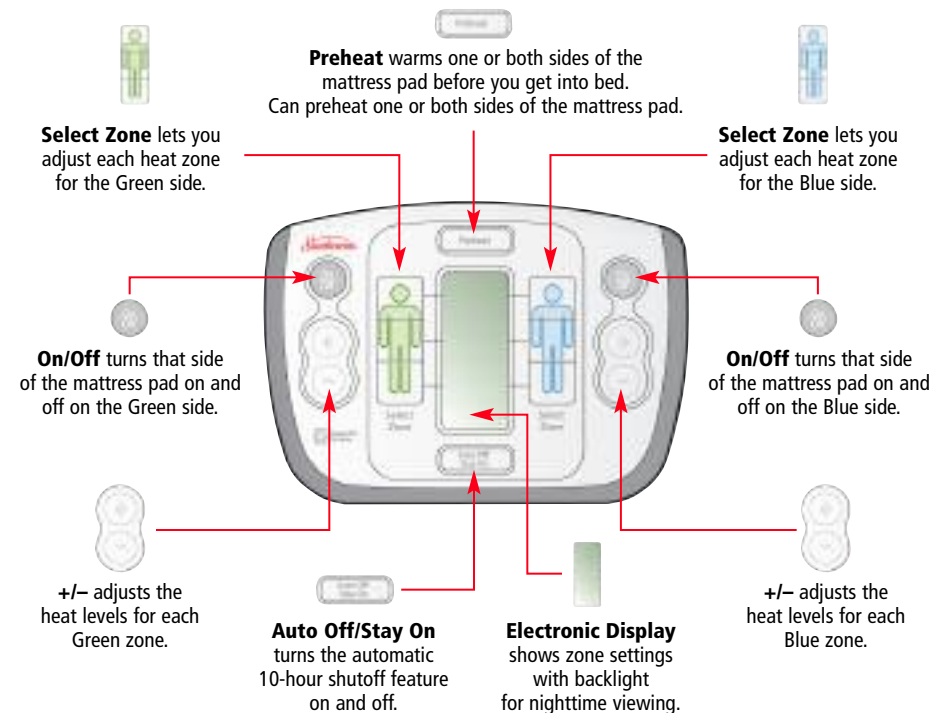

NOTE: To prevent accidental changing of your selections while the Mattress Pad is on, the remote control and display will lock during periods of inactivity. To reactivate the control, press any of the zones or the “+” or “-” buttons.

QUEEN OR KING SIZE MATTRESS PAD

For Dual Users with a Queen/King Mattress Pad

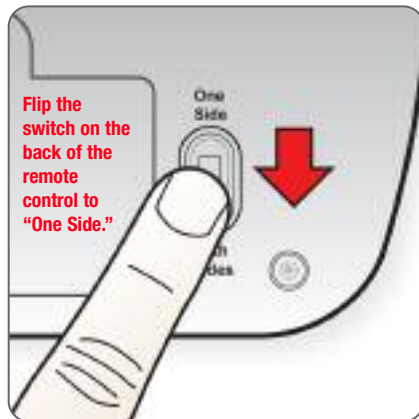
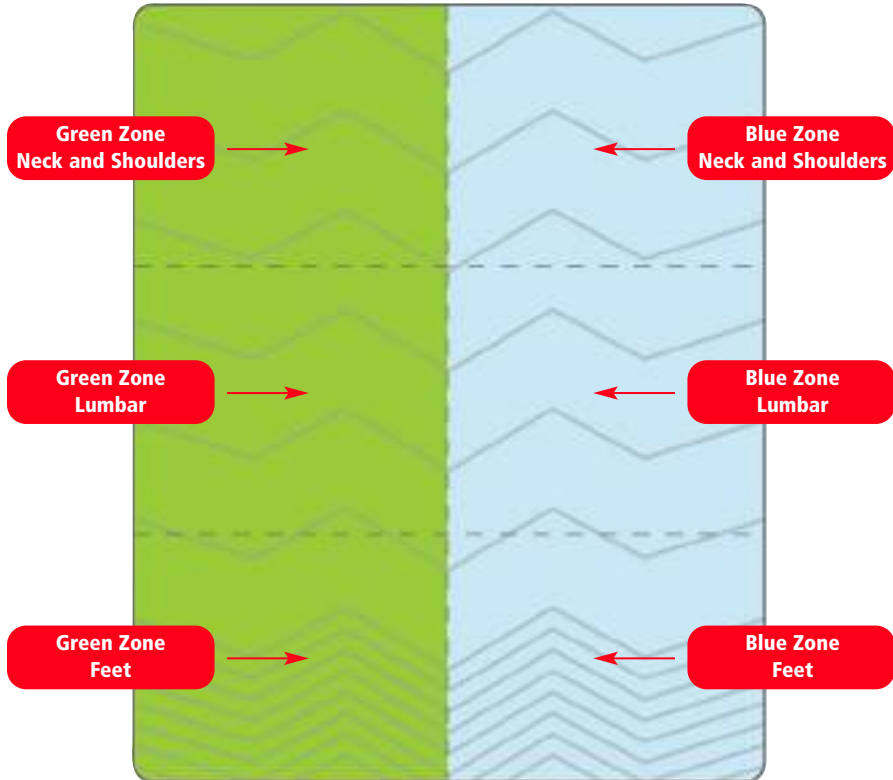

QUEEN OR KING SIZE MATTRESS PAD

For Single Users with a Queen/King Mattress Pad

For one-person use, you can set both sides of the queen or king size Mattress Pad to operate together as three wide zones.

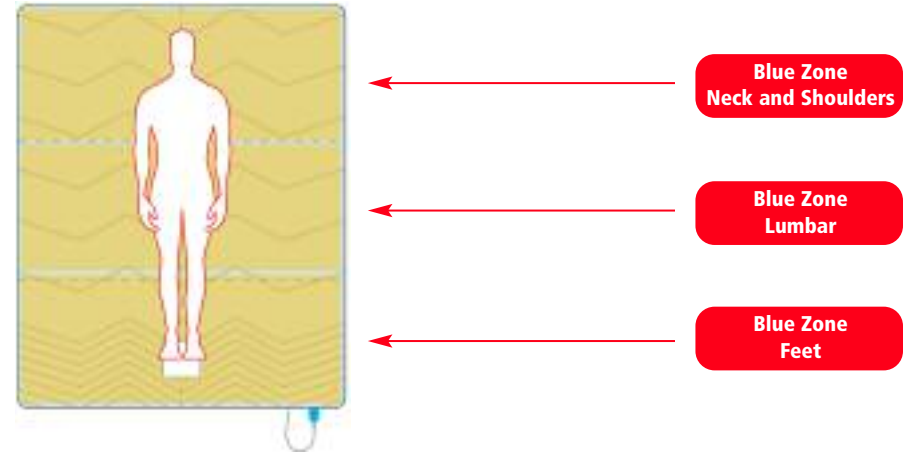

- 1 Turn remote control off.
- 2 To do this, flip the switch on the backside of the remote control from "One Side" to "Both Sides". ("One Side" is for two-person operation. "Both Sides" connects the sides for a single user.)
- 3 When the remote is set to "Both Sides" either side of the control operates the entire Mattress Pad as three side zones. For operating details, follow the "How to Use a Twin or Full Size Mattress Pad" instructions in this manual.
- 4 To return to dual-sided operation, flip the switch on the backside of the remote control to the "One Side" position.

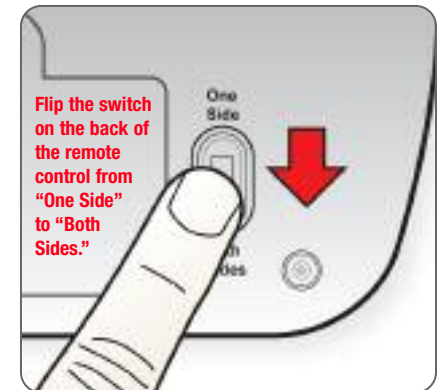

NOTE: As a precaution, if remote control was left on while flipping switch, the control will automatically turn off. Turn remote control back on.

OPERATING INSTRUCTIONS

Turning the Mattress Pad ON and OFF

To turn on each side of the Mattress Pad individually press the “On/Off” button on the Blue or Green side. When on, the base unit will beep once, the display for the selected side will light up, and all its zones will appear outlined.

NOTE: The backlight turns off after one minute to save battery power, but the Mattress Pad remains on. To turn the backlight on again, touch any button on the control other than the “On/Off” buttons.

Your customized heat settings are stored in memory so the next time you turn it on, the Mattress Pad returns to the same preferences as the last session.

CAUTION: Always turn the Mattress Pad “Off” when not in use.

Adjusting all Green or Blue Zones at Once

Your Mattress Pad features 10 adjustable heat levels per zone.

Press the “+” button on the Green or Blue side to adjust heat settings. That side’s zones will change together in the same increments.

The display shows each zone’s heat setting: 1 through 9, and then H, which is the warmest setting. A “-” on the display indicates that the heat for that zone is turned off.

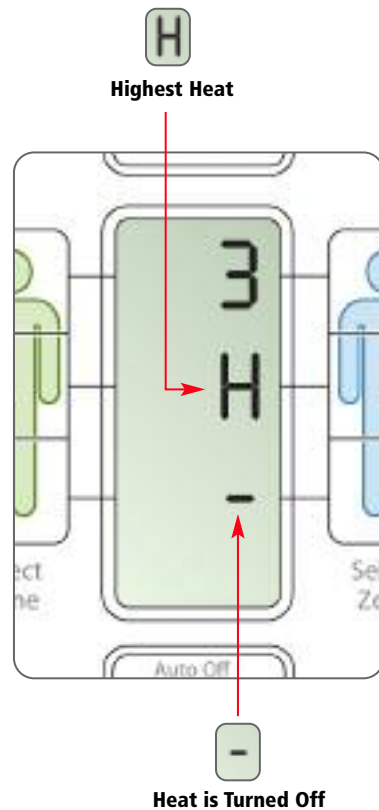

OPERATING INSTRUCTIONS

Adjusting Zones Individually

- 1 To adjust any zone individually, press the “Select Zone” button that corresponds to the zone you want to adjust. That zone will become outlined on the display and will be the only zone that changes when you press the “+” and “-” buttons.
- 2 Press the “+” button to increase or the “-” button to decrease the heat of the selected zone.
- 3 To change another zone's setting, simply select the zone and adjust its heat level up or down.

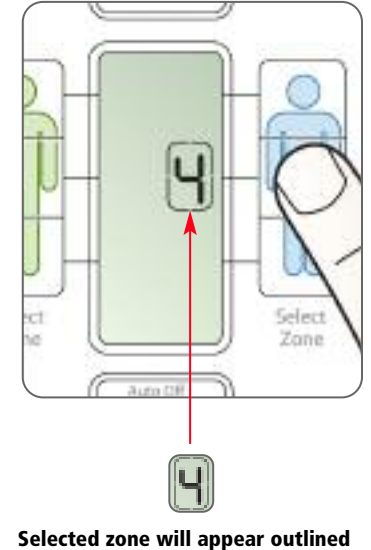

NOTE: After customizing each zone, you may want to reset the “+” and “-” buttons to again control all the zones of that side at once. To do this, turn off that side of the Mattress Pad, then turn it back on. Or you can wait 60 seconds until the zone’s outline disappears, then press the “+” or “-” button.

OPERATING INSTRUCTIONS

Preheating the Mattress Pad

Never get into a cold bed again during the Winter season. Preheat turns the heat up to warm your Mattress Pad before you get in. With this feature activated, each side starts preheating when it is turned on. This lets two people preheat their sides at different times.

- 1 To turn on preheat, after the Mattress Pad is on, press the “Preheat” button. All zones will show a “P” while they are preheating.

NOTE: Preheat will not work on zones selected to have heat turned off “-”. See adjusting Zones individually on page 14.

The zones will heat for 30 minutes at the highest setting “H” and then return to their previously programmed heat settings.

- 2 To cancel preheat after activating it, simply press the “Preheat” button again. The Mattress Pad’s regular heat settings for each zone will resume.

NOTE: At least one zone must be selected for the preheat function to work.

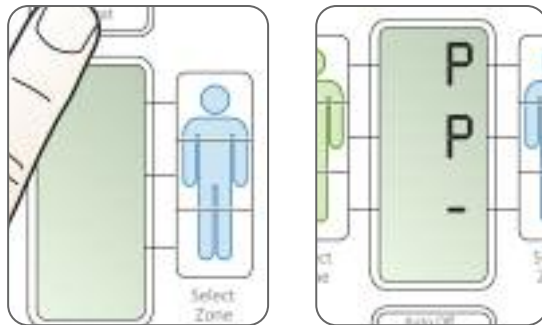
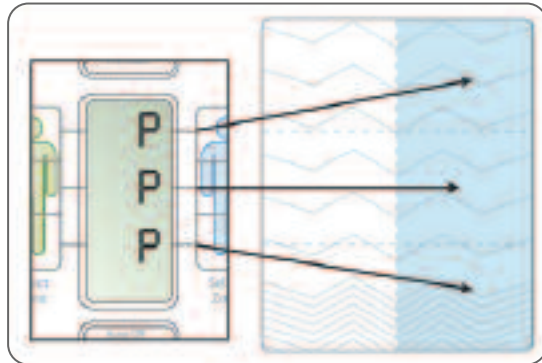

OPERATING INSTRUCTIONS

Auto Off

Auto Off conserves energy by automatically turning off each side of the Mattress Pad after 10 hours of use. This is the factory default setting, and the display will read “Auto Off” when this feature is active.

- 1 To deactivate Auto Off, press the “Auto Off/Stay On” button on the remote control. The display will then read “Stay On”, and the Mattress Pad will remain on until you turn it off using the “On/Off” buttons.

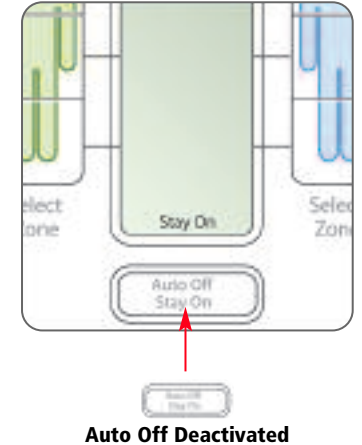

- 2 To reactivate Auto Off, press the “Auto Off/Stay On” button on the remote control.

NOTE: After a power outage, the timer of the Auto Off feature automatically resets to the full 10 hours, but the Auto Off/Stay On setting remains as selected.

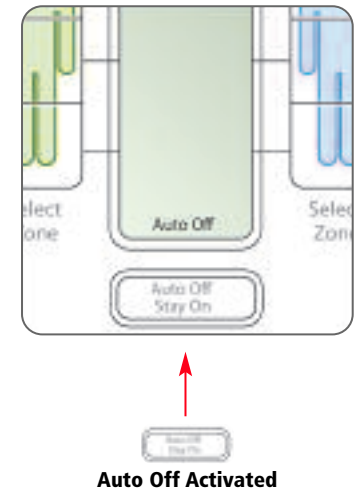

CARE AND CLEANING

Taking care of your Mattress Pad is easy and safe as long as you follow a few simple steps. We recommend washing before initial use.

Before Washing or Storing

- 1 Disconnect power cord from wall BEFORE detaching control cord from the Mattress Pad.
- 2 Ensure that no cords are still connected and none of the wires have worn through the fabric.
- 3 Carefully follow all washing instructions or your Mattress Pad may shrink and possibly cause a fire hazard.
 - **DO NOT** submerge control in water.
 - **DO NOT** dry clean your Mattress Pad. Dry-cleaning solvents may damage the wires.
 - **DO NOT** use bleach or cleaning fluids.
 - **DO NOT** use a wringer.
 - **DO NOT** iron your Mattress Pad.
 - **DO NOT** use mothballs or sprays of any kind.
 - **DO NOT** reconnect the Mattress Pad or use it until it is COMPLETELY dry.
 - **DO NOT** wash or put into water the power cord or any of the product's cords.

Machine Washing

- 1 Presoak the Mattress Pad for 15 minutes in mild soap and lukewarm water.
- 2 Wash in mild soap and lukewarm water on the “delicate” or “gentle” cycle in the washer for two minutes. Remember, do not use bleach.
- 3 Rinse in fresh, lukewarm water.
- 4 Spin dry in the washing machine. Then gently stretch to its original size.

CARE AND CLEANING

Machine Drying

CAUTION: Do not use commercial dryers or the dryers at your local Laundromat. They get too hot and would damage the wiring of the Mattress Pad.

- 1 Preheat the dryer on the “low” temperature setting for two minutes.
- 2 Place Mattress Pad into the dryer and tumble-dry for 10 minutes at a low temperature.
- 3 Remove the Mattress Pad while it is still damp and gently stretch it to its original size.
- 4 Drape the Mattress Pad over a clothesline or a shower rod. **DO NOT** use clothespins.
- 5 The Mattress Pad must be COMPLETELY dry before reconnecting the power plug or control plug.

Hand Washing

- 1 Presoak the Mattress Pad for 15 minutes in mild soap and lukewarm water.
- 2 Gently squeeze the soapsuds through a few times.
- 3 Rinse in fresh, lukewarm water.

Hand Drying

- 1 Gently stretch the Mattress Pad back to its original size.
- 2 Drape the Mattress Pad over a clothesline or hang over a shower rod. **DO NOT** use clothespins.
- 3 The Mattress Pad must be COMPLETELY dry before reconnecting the power plug or control plug.

FREQUENTLY ASKED QUESTIONS

Q Who should NOT use the Rest & Relieve™ Therapeutic Mattress Pad?

A The following people should NOT use the zoned Mattress Pad:

- An infant
- Anyone under 18 years of age
- An incapacitated person
- A paraplegic
- A quadriplegic
- A diabetic
- Anyone insensitive to heat such as a person with poor blood circulation
- Anyone who cannot clearly understand the instructions and/or operate the controls

Q My base unit feels warm to the touch. Is this a problem?

A No. The base unit may feel warm to the touch when functioning properly.

Q My Mattress Pad doesn't heat properly.

Troubleshooting checklist if your mattress pad doesn't heat:

- Are the cables securely connected to the base unit?
- Is the base unit plugged securely into a wall outlet?
- Is the wall outlet working properly?
- Is the remote control turned on?
- Are the correct zones turned on?
- Is the heat level set between 1-H?
- Did Auto Off turn off the power after 10 hours of use?
- If you experienced a power outage, did you turn the remote control off then turn it back on?
- Is the correct side of the mattress pad turned on (for queen and king size only)?

A Your heated product is not a heating pad. It will not feel hot to the touch when laid out flat in a normal manner. Try the following fold test to see if it is operating properly:

- 1 Fold the Mattress Pad over three times.
- 2 Make sure the Connector cable(s) are plugged into the Connector(s) at the foot of the Mattress Pad, and then plug the power cord into a wall outlet.
- 3 Turn on your heated product, then turn all zones to the highest settings and wait five to seven minutes.
- 4 Put your hand between the folds, and you should feel the Mattress Pad warming up. This means it is working properly.

CAUTION: *DO NOT continue the test for more than seven minutes. DO NOT attempt to make any internal adjustments to this appliance. If you have tried all of the solutions above and the heated product still doesn't work, stop using it immediately, disconnect the power cord and contact Sunbeam Consumer Care.*

FREQUENTLY ASKED QUESTIONS

Q My remote control doesn't work, and the display is blank.

A Check to make sure the batteries are installed properly, and that the + and – on the batteries match the diagram in the battery compartment.

Q My remote control doesn't work even though the display is on.

A Check to make sure the cable(s) are securely connected between the foot of the Mattress Pad and the base unit under the bed. If it still doesn't work, the remote may be too far from the base unit to send proper signals. Try moving them closer together. If that does not work, make sure the power cord is securely connected to the wall outlet. If it is, check the wall outlet to be sure it is working properly.

Q Preheat does not seem to work.

A Be sure all the zones you wish to preheat are turned on and set for heat. Zones that are set to “ – ” will not preheat.

Q How do I set Preheat for selected zones only?

A To skip preheating for any zone, first press its corresponding “Select Zone” button and lower its heat setting until a “ – ” appears on the display. Then press “Preheat”. Because the “ – ” indicates that heat is turned off, zones with this setting will not preheat and also will not heat once preheat is finished and the regular heat settings resume.

Q Will the Mattress Pad remember my settings between sessions?

A After you turn the Mattress Pad off, all of your settings will be remembered so that the next time you turn it on, the previously programmed settings will resume. However, when the batteries are removed from the battery compartment, this memory is cleared. Preheat must be started each time you wish to use this feature.

Q What does a periodic beep and blinking light on the base unit mean?

A The base unit is designed to notify you in the event that a problem has been discovered by beeping every 16 seconds and also flashing every 16 seconds when the control is on. (If you have a queen or king size Mattress Pad, your base unit has two lights, one for each side of the Mattress Pad. The blinking light will indicate which side of the pad has a problem.) First, check the heated product for visual damage. If no visual damage is found, unplug the system from wall outlet. Check that the control is well connected to the module. Plug the power cord into the wall outlet and turn the control On. If the product still does not operate after two or three times trying to reset, disconnect the power cord and contact Sunbeam Consumer Care.

FREQUENTLY ASKED QUESTIONS

- Q** How do I restart my Mattress Pad after a power failure?
- A** Press the “On/Off” button to turn the remote control off, then press “On/Off” to turn the remote control back on. The Mattress Pad will begin to warm.
- Q** I bought two Mattress Pads for different bedrooms, and they don’t seem to be operating correctly now.
- A** When you have two more Sunbeam® wireless remote-controlled devices in a home, there is a slight change their signals may interfere with each other. To solve this permanently, you can easily reset one of the remote controls and base units so they communicate using a different signal. Here’s how to do it:
- 1 Turn the remote control off.
 - 2 Unplug its base unit from the wall, then replug it into the wall while the remote control is off.
 - 3 Within two minutes, take the remote control and hold down “Preheat” and “Auto Off/Stays On” simultaneously for three seconds, until a number appears on the display. Once the base unit beeps, you may let go. The new settings will be remembered, even after a power failure.
- Q** What do I do if my pet chews the cord, I lose my control or the control does not operate properly?
- A** Please stop using the heated product immediately. Call our Consumer Service number listed under How to Obtain Warranty Service and ask for instructions on how and where to send the heated product.
- Q** I have heard that some heated products have EMFs. What is this?
- A** EMF stands for Electromagnetic Field. This is an electrical field that surrounds any wire that has current flowing along its length. Although several studies have been conducted to evaluate the impact, EMFs have not been proven to be harmful. In any event, Sunbeam® has reduced the strength of EMFs in its blankets/Mattress Pads/throws to very low levels.
- Q** What does the ETL label mean about safety of Sunbeam heated products?
- A** Intertek Testing Services (ETL) is a certified, independent testing organization that tests products in accordance with UL safety standards and issues the ETL label for those products that meet the relevant UL standards. All Sunbeam® products are tested to UL standards and bear either the UL or ETL label to indicate that the product meets or exceeds UL/ETL safety standards for heated products.

LIMITED WARRANTY

Sunbeam Products Inc. (“Sunbeam”) warrants that for a period stated below from the date of purchase, this product will be free from defects in material and workmanship.

- All heated products branded Arlington™ will carry a ONE-year limited warranty.
- All heated products branded Sunbeam® HomeChoice™, SlumberRest® Cuddler™ and Cuddle Up® will carry a TWO year limited warranty.
- All other heated products branded Sunbeam® and SlumberRest® will carry a FIVE year limited warranty. Sunbeam, at its option, will repair or replace this product or any component of the product found to be defective during the warranty period. Replacement will be made with a new or remanufactured product or component. If the product is no longer available, replacement may be made with a similar product of equal or greater value. This is your exclusive warranty. This warranty is valid for the original retail purchaser from the date of initial retail purchase and is not transferable. Keep the original sales receipt. Proof of purchase is required to obtain warranty performance. Sunbeam dealers, service centers or retail stores selling Sunbeam products do not have the right to alter, modify or any way change the terms and conditions of this warranty. This warranty does not cover normal wear of parts or damage resulting from any of the following: negligent use or misuse of the product, use on improper voltage or current, use contrary to the operating instructions, disassembly or repair or alteration by anyone other than Sunbeam or an authorized service center. Further, the warranty does not cover Acts of God, or Nature, such as fire, flood, hurricanes and tornadoes. Sunbeam shall not be liable for any incidental or consequential damages caused by the breach of any express or implied warranty. Except to the extent prohibited by applicable law, any implied warranty of merchantability or fitness for a particular purpose is limited in duration to the duration of the above warranty. Some states, provinces or jurisdictions do not allow the exclusion or limitation of incidental or consequential damages or limitations on how long an implied warranty lasts, so the above limitations or exclusion may not apply to you. This warranty gives you specific legal rights, and you may also have other rights that vary from state to state.

DO NOT RETURN THIS PRODUCT TO THE PLACE OF PURCHASE.

How to obtain warranty service:

We're Here to Help. For any questions you may have about your heated product, please visit our web site at: www.sunbeam.com or contact Sunbeam Consumer Care: 1-800-892-7684.

FCC CERTIFIED

This device complies with Part 15 of the FCC Rules. Operation is subject to the following two conditions: (1) This device may not cause harmful interference, and (2) This device must accept any interference received, including interference that may cause undesired operation.

Warning: Changes or modifications to this unit not expressly approved by the party responsible for compliance could void the user's authority to operate the equipment.

NOTE: This equipment has been tested and found to comply with the limits for a Class B digital device, pursuant to Part 15 of the FCC Rules. These limits are designed to provide reasonable protection against harmful interference in a residential installation. This equipment generates, uses and can radiate radio frequency energy and, if not installed and used in accordance with the instructions, may cause harmful interference to radio communications.

However, there is no guarantee that interference will not occur in a particular installation. If this equipment does cause harmful interference to radio or television reception, which can be determined by turning the equipment off and on, the user is encouraged to try to correct the interference by one or more of the following measures:

- Reorient or relocate the receiving antenna.
- Increase the separation between the equipment and receiver.
- Connect the equipment into an outlet on a circuit different from that to which the receiver is connected.
- Consult the dealer or an experienced radio/TV technician for help.

The Sunbeam logo features the word "Sunbeam" in a large, elegant, cursive script. A thin, dark arch is positioned above the letters, starting from the top of the 'S' and ending at the top of the 'm'. A registered trademark symbol (®) is located at the end of the word.

©2006 Jarden Consumer Solutions d/b/a/Sunbeam Products, Inc., All Rights Reserved. Sunbeam®, SlumberRest®, and Cuddle Up® are registered trademarks and Sleep warm. Sleep well.™, Arlington™, HomeChoice™, SimpliTouch™, SmartSense™, ChoicePlus™, StyleSmart™, ViewEasy™, EasySet™, SlimStyle™ and Cuddler™ are trademarks of Sunbeam Products, Inc., Boca Raton, FL 33431

Distributed by Jarden Consumer Solutions d/b/a Sunbeam Products, Inc., Boca Raton, FL 33431.

Printed in U.S.A.