



"SOLAR VISOR" TEXT TO SPEECH SPEAKERPHONE

User Manual

1. About Bluetooth Speakerphone

The Bluetooth TTS Speakerphone is compatible with most Bluetooth mobile phones. The Text-To-Speech system announces instructions for the users in 5 different languages and also indicates the status of the Bluetooth device. It also announces the name of the incoming caller (or phone number if the contact is not loaded into the Speakerphone's phonebook). Fully portable, it is an ideal wireless communication solution for in-car or office use within a maximum range of 10 meters. Built-in with Echo Cancellation and Noise Suppression, the Bluetooth Speakerphone provides you with impeccable sound quality in full duplex mode.

Make sure that your Speakerphone is fully charged before using it. Use only the charger provided - do not use chargers from any other devices as this might damage the device. A full charge is approximately 3 hours.

2. Charge Your TTS Speakerphone

Using the car charger

Connect to a mains charger or a USB charging cable to charge. Connect to the supplied cigar lighter.

When the charger is connected, the LED will flash red, the Speakerphone will turn off.

Normal full charge time is 3 hrs. (approx.)

When charge is completed, the LED will flash off.

Using solar power

Direct the solar panel on the back of the Speakerphone toward the sun. (Please refer to the recommended installation position, as mentioned above.)

If the car kit receives sufficient sunlight for 2 hours, you can talk for a duration of up to 1 h. Using solar power charge, the operation time (the talk time and the standby time) will be extended continuously without any additional charge required by the car charger.

WARNING: Do not attempt to charge the hands-free car kit with any charger other than the one provided. Using another charger may damage or destroy the speakerphone.

3. Appearance and Function

- | | |
|---------------------------------|--|
| (1) Speaker | (6) MFB Button (Multi-Function Button) |
| (2) Microphone | (7) Volume Increase (V+) |
| (3) LED | (8) Volume Decrease (V-) |
| (4) Charging Socket (5-pin USB) | (9) Solar Visor |
| (5) Mode Button (Privacy) | (10) Windows Mount |

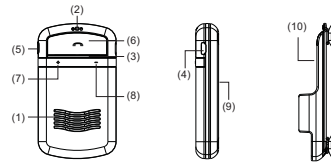

4. Recommend Installation Position

It is recommended that the Speakerphone be positioned and installed on the windshield in front of the driver's seat, as shown in the picture below:

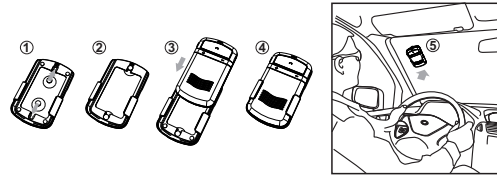

WARNING: Install the Speakerphone out of the way of any Air Bags for safety reason.

6. Powering Up

- To turn ON the Speakerphone
Press and hold the "MFB" button for four seconds and the flashing

blue LED light indicator comes on ("Power On" is announced).

Note: Do not hold the button down for more than 8 seconds when turning the Speakerphone on or else it may switch to its pairing mode. If this happens, turn off the Speakerphone and repeat the process for turning the Speakerphone on.

- To Turn OFF the Speakerphone

Press and hold the "MFB" button until the LED light indication goes off ("Power Off" is announced).

7. Pairing

- Pairing With Bluetooth Mobile Phone

Pairing is the process of connecting your Speakerphone with your mobile phone. Before using the Speakerphone with your mobile phone, you must pair both devices. If you wish to use your Speakerphone with a different mobile phone, you must reinitiate the pairing process with your intended Bluetooth mobile phone.

- Pairing Speakerphone to Mobile Phone

1. Ensure that Speakerphone is turned off, switch to pairing mode by holding onto the "MFB" button till both Blue/Red LED lights appear ("Pairing phone please put your phone in pairing mode and enter PIN code "0000" is announced).

2. The LED lights will blink simultaneously in pairing mode.

3. Turn on the mobile phone and place it within 10 meters to the Speakerphone.

4. Initiate the mobile discovery feature on your mobile phone. Refer to your mobile phone's user guide.

5. Enter the default pin code "0000", when prompted by your mobile phone system for pin code.

6. The blue LED blinks at a regular interval when both devices are successfully paired ("Pairing Successful" is announced).

8. Connection Link/Between Speakerphone And Mobile Phone

Your mobile phone will always indicate a connection icon whenever it is paired to the Speakerphone. If the icon not present, a reconnection can be established by manually selecting the Speakerphone from your mobile phone's Bluetooth menu. If your Speakerphone is set as an authorised Bluetooth device on your mobile phone, an automatic reconnection can

be established by pressing the Speakerphone's "MFB" button once.

Note: Your Speakerphone will be automatically switched off when it is disconnected from a paired device for more than 10 minutes. This special feature is incorporated to maximise your Speakerphone's standby/talk time. To reinstate the connection, simply repeat the process for turning Speakerphone on.

9. Using the Speakerphone (Most Ofunctions will be audibly announced)

- Making Call you can initiate calls from your mobile phone, or directly from your Speakerphone using voice dialing commands (if this feature is supported by your mobile phone)
- Making Calls from your mobile phone Dial directly from your mobile phone. The call is automatically connected to your Speakerphone.
- Receiving Calls
When your mobile phone rings, press the "MFB" button on the Speakerphone to connect the call.
- Ending Calls
When you have finished your call, press the "MFB" button on the receiver to disconnect the call.
- Rejecting Calls
Hold onto the "MFB" button for 3 seconds to reject an incoming call.
- Making calls using voice dialing(Dependent on mobile phone support) Press the "MFB" button once and call out the name of the person for the call to be placed.
- Redial Last Outgoing Call
Press the "MFB" button twice and the call is connected.
- Privacy Mode In the midst of a conversation, press the "Mode" button once and the speaker volumes are automatically decreased to minimal levels where you can use the Speakerphone in the same mannerism as using any handheld phone.
- Transferring Calls
Speakerphone to Mobile Phone - During a call, simply press both "V+" and "V-" buttons once and the call is routed to your mobile phone.
Mobile Phone to Speakerphone - Press the "MFB" button once and

the call is routed back to your mobile phone.

- Adjusting The Volume

To increase the volume - Press the "V+" symbol volume button to increase volume by one level, repeat this procedure until you have reached the desired level. To decrease the volume - Press "V-" symbol button to decrease the volume by one level, repeat this procedure until you have reached the desired level.

- Text-To-Speech Language Options

Press the "V+" button for 3 seconds and the Speakerphone announces "Select Language". Repeat the process to select the desired language in the following order of English, French, Italian, German and Spanish.

- Transferring Mobile Phone's Phonebook to Speakerphone

a. Using Speakerphone (For transferring the whole phonebook, and some mobile phone models may not be workable in this function.) In the connecting status, press th "Mode" button for 3 seconds and the Blue LED light indicator will be flashing 2 pulses per second. When the process is completed, the Speakerphone announces "Contacts Saved".

b. Using Mobile Phone (For transferring the contact person data one by one, and it is workable for all the mobile phone models.)

1. In the connecting status, press the "Mode" button for 6 seconds to enter the phonebook function, then the Speakerphone and mobile phone will be disconnected automatically, and the Speakerphone will be ready to receive the phonebook data from the mobile phone, and the Blue LED light indicator will flashing every second.

2. Select the contact person's data on the mobile phone's phonebook and transfer it to the Speakerphone via the mobile phone's Bluetooth manual. When the process is completed, the Speakerphone announces "Contacts Saved".

3. If the Speakerphone has not received any contacts data from the mobile phone within 2 minutes while in phonebook function, the Speakerphone will resume the speakerphone function and re-connect to the previous paired device automatically.

4. To resume speakerphone function, short press the "MFB" button, then the Speakerphone will exit the phonebook function and re-connect with the previous paired device automatically.

Note:

- The phonebook function varies from different mobile phone models, and not every mobile phone supports this feature.
- The phonebook data saved in the Visor Drive will be erased automatically when it paired with another mobile phone. Please repeat the procedures of Phonebook transfer whenever connected with a new mobile phone.
- Removing Phonebook Entries
During standby mode, hold on to both "V+" and "V-" buttons for 3 seconds ("Phonebook Deleted" is announced) and the entire phonebook memory in the Speakerphone will be deleted.
- Turning On/Off the Text-To-Speech Function
To toggle the TTS function On or Off, simply hold the "V-" for 3 seconds in standby mode ("Voice Prompt On" or "Voice Prompt Off" is announced to denote its current status).

10. Restore to Default Settings

To restore your Speakerphone to its original settings, press and hold both "V+" and "V-" buttons for 10 seconds until the blue LED light indication flashes rapidly. Press and hold both "V+" and "V-" buttons for a further 3 seconds and the Speakerphone will power off automatically. This process is complete when Speakerphone announces "Set Factory Default Complete".

11. Care and Maintenance

- Do not expose the speakerphone to liquid, moisture or humidity, as it is not waterproof.
- Do not use abrasive cleaning solvents to clean the speakerphone.
- Do not expose the speakerphone to extreme temperatures.
- Do not expose the speakerphone to contact with sharp objects as this will cause scratching and damage.
- Do not attempt to disassemble the speakerphone, as it does not contain serviceable components.
- If you do not use the speakerphone for long periods of time, be sure to store it in a dry place, free from extreme temperatures, humidity and dust.

12. Safety Information

- Check local laws regarding use of a mobile phone and speakerphone while driving. If you use the speakerphone while driving, ensure your attention and focus remains on your responsibility of driving safely.
- Never allow children to play with the speakerphone. Small parts may be a choking hazard.
- Observe all signs that require an electrical device or RF radio product to be switched off in the designated areas. These could include hospitals, blasting areas, and potentially explosive atmospheres.
- Turn off your speakerphone prior to boarding an aircraft. Do not use your speakerphone in an aircraft.
- Never place or store the speakerphone over the area of the automobile's safety airbag deployment, or it may cause serious injury when a safety airbag deploys.

13. Product Specifications

Bluetooth Compliance: Bluetooth 2.0+EDR specifications
Operating Frequency Band: 2.4GHz ~ 2.48GHz unlicensed ISM band
Output Power: Class 2 Power Output, up to 10 meters
Support Profiles: HSP and HFP 1.5
TTS Support Language: English, French, Italian, German, Spanish
Support Multiple paired Device: Up to 8 Bluetooth Phone can be paired
Stand-by Time: Up to 450 hour
Talk time: Up to 11-13 hours
Battery Charging Time: About 3 hours
Charger Voltage: DC5.0V 400mA
Battery Type: 550mA, (Rechargeable Lithium-ion Battery)

14.Changes or modifications not expressly approved by the party responsible for compliance could void the user's authority to operate the equipment."

15: About Battery

Caution

Risk of explosion if battery is replaced by an incorrect type.

Dispose of used battery according to the instructions.

16: Other information

Bluetooth Speakphone

Product name: BC900

Manufacturer: Sunitec

No.2, Qilin Road 2, Run Tang

Ind, Dan-Keng Village Fu Min

Community, Guan-Lan Town,

Bao An District, Shenzhen

Guangdong China

Lithium Battery

Manufacturer: szjngyou

Voltage : 3.7V

Current : 550mAh

Model : JY-M688

This device complies with Part 15 of the FCC Rules.

Operation is subject to the following two conditions:

- (1) this device may not cause harmful interference
- (2) this device must accept any interference received, including interference that may cause undesired operation.

To comply with FCC RF exposure requirements, the device and the antenna for this device must be installed to ensure a minimum separation distance of 20 cm or more from a person's body. Other operating configurations should be avoided.