

PowerBlue PBC10

User Manual

Introduction:

PBC10 is a portable Flashlight and Emergency power bank with Bluetooth Handsfree A2DP device, which is based on DSP with echo cancelation and noise reduction. PBC10 is handy in any environment such as office, home, or in the car. PBC10 is able to connect to any mobile cell phone that supports Bluetooth. New Bluetooth version impels stable and steady Wireless connection with high speed and high quality AD2P+AVRCP. PBC10 has a 2100mAh built-in chargeable ly-polymer battery with an USB Out-put port switching regulator 5V DC/DC. PBC10 is an efficient charger and bright LED flashlight.

Appearance and Function

- (1) Speaker
- (2) Microphone
- (3) LED
- (4) Charging Socket (USB)
- (5) On/Off LED Flashlight Button
- (6) MFB Button (Multi-Function Button)
- (7) Volume Increase (V+)
- (8) Volume Decrease (V-)
- (9) LED Flashlight

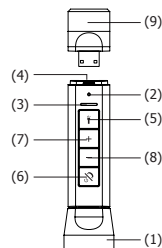

PBC10

Package content:

- PBC10 3-in-1 Device
- USB Cable
- Holder
- User Manual
- Sun Visor Clip



Power Bank Charging Instruction

Charge PBC10:

- (1) Split LED flashlight apart from PBC10
- (2) Put charger Jack into PBC10's in-input
- (3) Charging takes no longer than 3 hours

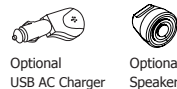

- (4) Red LED stays on when PBC10 is charging, Red LED turns off when Battery is fully charged.
- (5) Low Voltage Reminder: Red LED flashes every 3 seconds when Bluetooth is on, and Voltage Low. Please charge the battery to maintain battery efficiency.

Important:

PBC automatically turns off if device is not charged after Low Voltage Reminder indication shows up.

PBC10 Charges other devices:

- (1) Split LED flashlight apart from PBC10
- (2) Connect USB A type to PBC10, connect the other end to other devices(cell phone, iPod)
- (3) Press ON/OFF key to launch charging function. When Green light stays ON, cell phone and iPod are being charged via DC 5V.

Important:

1. Charging function is ended and Green light is OFF when PBC10 does not connect to anything.
2. In the Charging actions, PBC10 automatically stops out-put DC 5V when cell phone, iPod is either disconnected or fully charged, and Green light is OFF. (Some devices are programmed to choose being charged even if the battery is already fully charged, in that case, PBC10 will NOT stop charging and Green light will stay on until PBC10's battery is dead.)

Installing

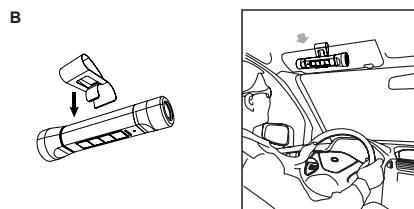
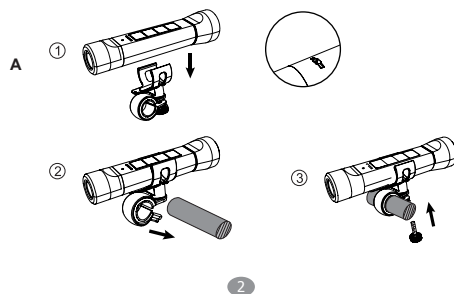

Flash light ON/OFF Instruction:

- (1) Make sure flashlight is completely mounted. (Head part)
- (2) Press ON/OFF to turn flashlight ON.
- (3) Press ON/OFF to turn flashlight OFF, or split flashlight apart from PBC10.

Bluetooth Handsfree Launch and A2DP+AVRCP Instruction

Press and hold MFB for 4 seconds until you hear a short beep, and then Blue LED will stay ON for 3 seconds.

PBC10 will automatically reconnect to the last mobile phone it paired.

Turn Off Bluetooth: PBC10 is under ON mode

Press and hold MFB for 3 seconds until you hear a short beep, and then Red LED will stay ON for 3 seconds.

Pair PBC10 to your mobile phone

Prior to using the speakerphone for the first time, you must pair it with a Bluetooth-enabled mobile:

- (1) Place the PCB10 and mobile handset no more than 1 meter away.
- (2) Ensure PBC10 is under OFF mode.
- (3) Press and hold the MFB for 6 seconds until you hear a long beep. The Red LED and Blue LED will flash alternately. It's now ready for pairing.
- (4) Activate your mobile handset's Bluetooth function by referring to your mobile handset user guide for details. Mean while, the handset will search for accessible Bluetooth devices.

- (5) Select "Speakerphone" from the list.
- (6) Enter the pre-programmed password "0000" and press "OK" to pair the PCB10 and the handset.
When pairing is completed, you may hear a long beep and LED will flash blue 3 times. Now the PCB10 is under standby mode with Blue LED flashes every 3 seconds.
- (7) Press "Return" to go back to your handset's main menu. (For most of the mobile handset models, a headset icon will be shown on the screen.) You should now be able to make and receive calls through the PCB10. Please place the mobile handset to the PCB10 no more than 10 meters. (Obstruction could cause shorter sensing distance.)

Important:

Under the pairing mode, if the pairing cannot be completed within 2 minutes, the PCB10's LED will flash off and PCB10 will be under off mode. Please repeat step (3) to (7) to pair the pcb10 and mobile handset again.

Connection/Link between Speakerphone and Mobile Handset

After pairing is completed, speakerphone is always under standby mode. Before you place or answer a call, if the headset ICON is not shown on phone screen, please follow the simple steps to activate the Bluetooth connection/link through your handset or speakerphone until the headset ICON is on the screen.

1. On Handset: Select "Speakerphone" from the paired list on your handset screen.
2. On Speakerphone: Short press MFB and select "Accept" on handset screen to accept connection.

Disconnection between Speakerphone and Mobile Handset

Please follow the steps below if you want to connect PCB10 to another cell phone.

- (a) Power off the PCB10.
- (b) Select "disconnecting" to remove previous connection from your mobile phone list.

Important:

To save energy, PCB10 automatically turns OFF 10 minutes after disconnection. Blue LED flashes 3 times every 2 seconds if PBC10 is not connected to any mobile.

Answer Incoming call:

To answer a call, wait for the speakerphone to ring, then short press the MFB to accept the call.

Hang Up call:

Press the MFB to end call.

Reject Incoming Call:

Press MFB for 3 seconds to reject incoming call.

Voice Dial:

In standby mode, press V+ twice quickly, when we hear the beep from PCB10, say the voice tags.

Important:

Please make sure to record voice tag into the mobile handset before using voice dialing function. This function is only applicable to mobile handset with Bluetooth Hands-Free Profile. Some phones, we may not hear the beep. Please refer to your mobile handset user guide for additional information.

Redial:

Press MFB twice quickly, PCB10 redials the last number it called out.

Volume Adjustment:

During a call activity or playing music, click V+ or V- to adjust volume.

Mute Microphone:

- A. Mute: Press and hold V- for 3 seconds to mute microphone, PCB10's Red LED stays ON
- B. Un-Mute: Press V+ for 3 seconds to un-mute.

Call Transfer:

- A. PCB10 to Mobile Phone: Press V+ and V- at the same time (during a call) to transfer voice from PCB10 to cell phone. Talk on the Mobile.
- B. Mobile phone to PCB10: Press V+ and V- at the same time (during a call) to transfer voice from cell phone to cell phone. Talk through PBC10.

Make call waiting:

During a call activity press MFB button twice quickly to Hold and Un-Hold call.

Answer incoming call during a call activity:

- A. During a call activity, press MFB button twice quickly to answer incoming call and meanwhile hold first line.
- B. Press MFB button once to end first line and answer second line.

Reject incoming call during a call activity:

During a call activity, press and hold MFB for 3 seconds to reject incoming call.

Switch Calls:

Press MFB twice quickly to switch between two lines.

Press MFB once to end call one line to continue with the other line.

Play and Pause Music:

Press MFB to Play and Pause music

Important:

Some cell phones do not play music in standby mode.

Select previous and next song:

During playing music, press V- or V+ on PBC10 to roll to previous or next song.

Reset:

Reset PBC10 will format pairing history.

1. Make sure PBC10 is in standby mode.
2. Press and hold V+ and V- for 10 seconds, Red and Blue LED flash 5 times together at the same time. After PBC10 is rested, PCB10 automatically restart and start pairing mode.

Maintenance:

Care and Maintenance

- (a) Do not expose the speakerphone to liquid, moisture or humidity, as it is not waterproof.
- (b) Do not use abrasive cleaning solvents to clean the speakerphone.
- (c) Do not place the speakerphone in high temperature, as it will result in an explosion.
- (d) Do not expose the speakerphone to contact with sharp objects as this will cause scratching and damage.

- (e) Do not stick anything inside the speakerphone as this may damage internal components.
- (f) Do not attempt to disassemble the speakerphone, as it does not contain serviceable components.
- (g) If you do not use the speakerphone for long periods, be sure to store it in a dry place, free from extreme temperature, humidity and dust.

Safety Information:

- (a) Check local laws regarding use of a mobile handset and speakerphone while driving. If you use the speakerphone while driving, ensure your attention and focus remains on your responsibility of driving safety.
- (b) Never allow children to play with the speakerphone. Small parts may be a choking hazard.
- (c) Observe all signs that require an electrical device or RF radio product to be switched off in the designated areas. These could include hospitals, blasting areas, and potentially explosive atmospheres.
- (d) Turn off your speakerphone prior to boarding an aircraft. Do not use your speakerphone in an aircraft.
- (e) Never mount or store your speakerphone over any air bag deployment area serious injury may result when an air bag deploys.

Product Specifications:

Bluetooth Specification: V2.1 + EDR
 Frequency Working Range: 2.402GHz ~ 2.480GHz unlicensed ISM band
 Output Power: Level 2, Maximum connection distance: 10 meter
 Supported Profile: HSP, HFP 1.5, A2DP and AVRCP Profiles
 Standby time: 152 days
 Talk time: 44 hours
 Music Play time: 25 hours
 Charge time: approximately 3 hours
 Flashlight last: 6 hours
 Charging input Voltage, electric current: DC 5.0V 2000mA
 Charging output Voltage, electric current: DC 5.0V 500mA
 Battery Capacity: 3.7V 2100 mAh
 Dimension: 113g
 Weight: L150*Ø35.6mm

FCC Information:

This device complies with Part 15 of the FCC Rules. Operation is subject to the following two conditions:

1. This device may not cause harmful interference, and
2. This device must accept any interference received, including interference that may cause undesired operation.

This equipment has been tested and found to comply with the limits for a Class B Digital Device, pursuant to Part 15 of the FCC Rules. These limits are designed to this equipment generates, uses, and can radiate radio frequency energy and, if not installed and used in accordance with the instructions, may cause harmful interference to radio communications. However, there is no guarantee that interference will not occur in a particular installation. If this equipment does cause harmful interference to radio or television reception, which can be determined by turning the radio or television off and on, the user is encouraged to try to correct interference by one or more of the following measures:

- Reorient or relocate the receiving antenna.
- Increase the separation between the equipment and receiver.
- Connect the equipment into an outlet on another circuit.
- Consult the dealer or an experienced radio/TV technician for help.

Caution: Any changes or modifications not expressly approved by the party responsible for compliance could void the user's authority to operate this equipment.