

Metal Glowing Weather Icon

Barometric Weather Station with
Wireless out-door sensors

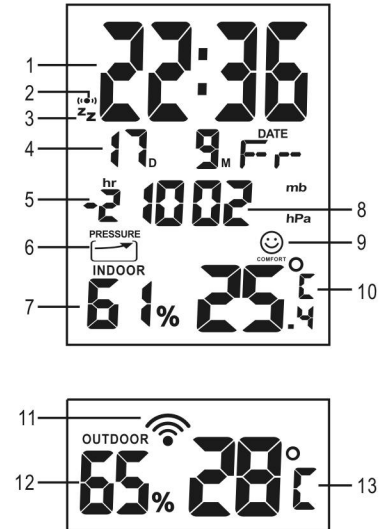

Display

1. Time
2. Alarm
3. Snooze
4. Calendar
5. Pressure tendency
6. Pressure tendency
7. Humidity
8. Air pressure readings
9. Comfort indicator
10. Temperature
11. RF indicator
12. Outdoor humidity
13. Outdoor temperature

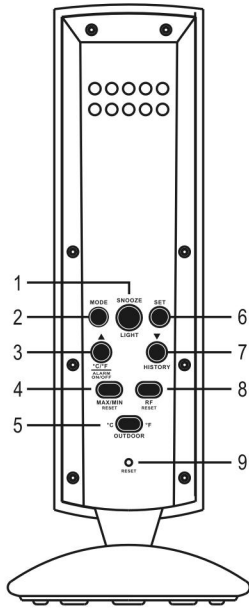

Features

1. Snooze/Light key
2. Mode key
3. Up key/°C or °F/ Alarm On/Off
4. Max/Min /Reset key(outdoor)
5. °C / °F (outdoor)
6. Setting key
7. Down key/Pressure history
8. RF reset key
9. Reset

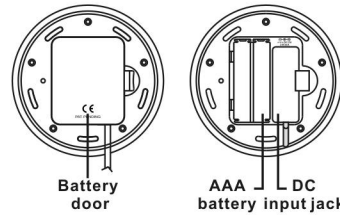

Wireless out-door Weather Sensors

Battery Installation

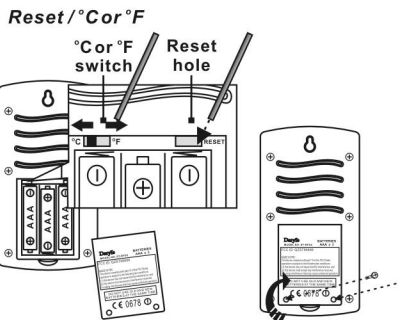
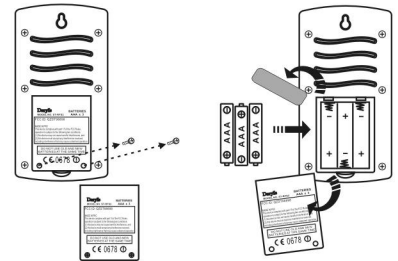

Display

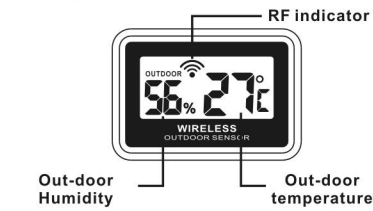

Wall mounted

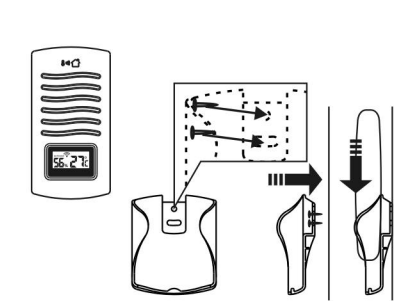

Transmitting

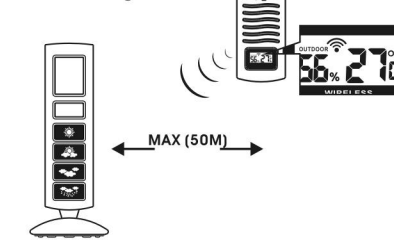

Battery Installation

1. Open the battery door on the underside of the unit.
2. Insert 2 AAA batteries into the battery compartment, observing proper +/- polarities.
3. Replace the battery door.
4. Insert a thin stick or paper clip into the RESET hole and press reset button.
5. The Barometric system will automatically start within 1 minute.

Setting the Clock and Calendar

1. To enter the setting mode, press the SET key. The clock mode flashes on the LCD.
2. To select 12- or 24-hour clock mode, press ▲ or ▼ key until the desired unit appears on the LCD.
3. To confirm the setting, press SET key. The hour flashes on the LCD.
4. To set the hour, press ▲ or ▼ key until the current hour appears on the LCD.
5. To confirm the setting, press SET key. The minutes flash on the LCD.
6. To set the minutes, press ▲ or ▼ key until the current minutes appear on the LCD.
7. To confirm the setting, press SET key. The calendar mode flashes on the LCD.
8. To set the calendar mode, press ▲ or ▼ key until the desired mode appears on the LCD. If today is 25th November (Friday). When the LCD shows "DM" means the calendar will be showed as 25D 11M Fr; When the LCD shows "MD" means the calendar will be showed as 11M 25D Fr.
9. To confirm the setting, press SET key. The month flashes on the LCD.
10. To set the month, press ▲ or ▼ key until the current month appears on the LCD.
11. To confirm the setting, press SET key. The day flashes on the LCD.
12. To set the day, press ▲ or ▼ key until the current day appears on the LCD.
13. To confirm the setting, press SET key. The date language flashes on the LCD.

Language	Day-of-the-week						
	Monday	Tuesday	Wed.	Thursday	Friday	Saturday	Sunday
English	E	M	T	W	T	F	S
German	D	M	D	M	D	F	S
French	F	L	M	M	J	E	S
Italian	I	L	M	M	G	E	S
Spanish	S	L	M	M	J	E	S

14. To set the date language, press ▲ or ▼ key until the desired language appears on the LCD.
15. To confirm the setting, press SET key. The year flashes on the LCD.
16. To set the year, press ▲ or ▼ key until the current year appears on the LCD.
17. To confirm all settings and exit the setting mode, press SET key.

Weather Forecast

The barometer automatically measures changes in the atmospheric pressure to forecast expected changes in the weather over the next 12~24 hours. The effective covering area is 30 to 50km (18 to 31 miles).

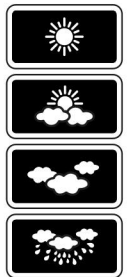

* Sunny icon also indicates expected clear skies at nighttime.

Fine-Tuning the Barometer

The unit monitoring the Sea Level barometric pressure then calculates and compares with a program inside the IC. If you want to fine-tuning the barometer and get a more precise forecast of your neighborhood. You may also need to enter the altitude readings into the unit. It makes the unit to take your home position into account with the Sea Level barometric pressure readings.

1. Press MODE keys twice to enter the Barometric Fine-Tuning Mode. "DM" appears on the LCD.
2. Press SET key to enter the setting mode. The measuring unit and the current atmospheric pressure reading flashes on the LCD.
3. To set the measuring unit, press ▲ or ▼ key until the desired unit appears on the LCD. If the LCD shows "mb/hPa" means the barometric system is using METER to analyze the weather; If the LCD shows "inHg" means the barometric system is using FEET to analyze the weather.
4. To confirm the setting, press SET key. "G" flashes on the LCD.
5. Press ▲ or ▼ key until the height of your home position appears on the LCD. The range of the altitude is between -99m~+2000m or -330ft~+6560ft.
6. To confirm the setting, press SET key. The current atmospheric pressure appears on the LCD.

* Please also take the height of the floor of your current building into account.

* To know your home altitude, please contact your local library, TV or radio weather forecaster. You can also get reference on the Internet, for example <http://www.worldatlas.com/aatlas/infopage/ elvation.htm>

Monitoring the Atmospheric Pressure

1. Back to the Normal Time Keeping Mode, press MODE key once. The current atmospheric pressure readings appear on the LCD. If the LCD shows "1020" means the atmospheric pressure readings is 1020 now.
2. To check the atmospheric pressure records, press HISTORY key. If the LCD shows "-1 hr 1023" means 1 hour ahead the atmospheric pressure was 1023.

3. Press ▼ key. If the LCD shows "-2 hr 1023" means 2 hour ahead the atmospheric pressure was 1024.
4. Maximum call up record of atmospheric pressure is 8 hours.

* If you have just replace the batteries or reset the unit, "-1 hr ---" appears on the display, means no record at the moment.

* If the readings go above or below the specified range, "HI" or "LO" appears on the LCD.

Atmospheric Pressure Trend Icons

The atmospheric pressure trend icons will let you know the trend of the collected atmospheric pressure readings. It gives you more information about the coming weather.

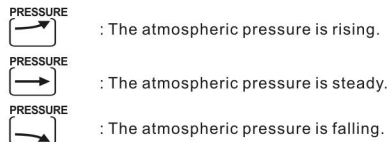

* If the icon flashes, means the pressure sensor is detecting the atmospheric pressure.

Comfort level indicators

The comfort level indicator will let you know if your current environment is comfortable, too wet or too dry. The indicator will appear in the following condition:

- Comfort: Humidity is between 40~70% and temperature is between 20~25°C (68~77°F)
- Dry: Humidity is under 40%
- Wet: Humidity is over 70%

No indicator: Humidity is between 40~70% and temperature is over 25°C (77°F) or under 20°C (68°F)
* The current humidity lower than 20% or over than 95%,
* --- appears on the LCD.

Setting the Temperature

To select Fahrenheit or Celsius, press C°/F° key in the Normal Time Keeping Mode until the desired unit appears on the LCD.

Setting The Radio Frequency Out-door Sensor (RF Sensor)

1. Unscrew to open the battery door of the out-door sensor.
2. Removing the isolating sheet
3. Replacing the batteries into the battery compartment, observing proper +/- polarities.
4. Insert a thin stick or paper clip into the RESET hole and press rest button.
5. Insert a thin stick or paper clip into the °C/ °F hole and slide the switch until the desired unit appears on the LCD.
6. Replace battery door.
7. Screw to close the battery door
8. Press the RF RESET key on the backside of the main unit. The RF indicator is on. Means the main unit is waiting for the weather data from the out-door sensor. Please wait for 5 minutes.
9. The readings are showing on the LCD and the RF indicator is off. Means the main unit received the weather data and start to keep contact with the out-door sensor.

* In some instances, you may also reset the out-door sensor after you press the RF RESET key while the RF indicator are still on. The main unit can receive the weather data faster at the first time.

* Position the RF sensor and the main unit within effective transmission range, which, in usual circumstances, is 20 to 50 meters.

* Though the RF sensor is weather proof, it should be placed away from direct sunlight, rain or snow.

Out-door Weather Records

1. To check the highest out-door temperature records, press the MAX/MIN key once.
2. To check the lowest out-door temperature records, press the MAX/MIN key again.
3. To return to the current temperature, press the MAX/MIN key again.
4. If you want to reset out-door weather records, press and hold the MAX/MIN key for 3 seconds.

Setting the Out-door Temperature

To select Fahrenheit or Celsius, press C°/F° OUTDOOR key until the desired unit appears on the LCD.

Setting the Daily Alarm

1. To enter the Alarm Mode, press MODE key once. "AL" appears on the LCD.
2. Press SET key to enter the Alarm Set Mode. The hour flashes and "●●" appears on the LCD.
3. To set the alarm hour, press ▲ or ▼ key until the desired hour appears on the LCD.
4. To confirm the alarm hour, press SET key. The minutes flash on the LCD.
5. To set the alarm minutes, press ▲ or ▼ key until the desired minutes appear on the LCD.
6. To confirm the alarm setting, press SET key.
7. To disable or enable the daily alarm, press ALARM ON/OFF key. If "-:--" appears, the alarm is disabled and "●●" disappears from the LCD.
8. To return to the Normal Time Keeping Mode, press MODE key twice.

Alarm Stop

1. When the current time matches the alarm time, the alarm sounds.
2. Press keys (MODE / SET/ ▲ / ▼) to stop the alarm.

* The alarm sounds for 1 minute if you do not press any key.

Snooze Function

1. When the current time matches the alarm time, the alarm sounds.
2. To temporarily stop the alarm for 4 minutes, press the SNOOZE key. The alarm sound turns off and will turn on again after 4 minutes.
3. To turn off the alarm completely, press keys (MODE / SET/ ▲ / ▼). "Zz" disappears from the LCD.

Display Back Light

1. Press the LIGHT key to turn on the display back light.

AC Adapter

1. To operate the unit using the included AC adapter, insert the power plug firmly into the power jack located inside of the battery door.

Changing the Battery

1. If the display begins to dim and the alarm will not sound, means the main unit is out of battery.
2. Replace the batteries 2 AAA.
3. If the outdoor temperature and outdoor humidity readings flash on the main unit, means the outdoor sensor is out of battery.
4. Replace the batteries 3 AAA.

Reset

1. After replacing the battery please press RESET once.
2. If your clock does not respond when you press any keys or if you would like to clear all prior settings, please press RESET once.
3. To reset unit, insert a thin stick or paper clip into the RESET hole and press reset button.

-Hereby, declares that this equipment is in compliance with the essential requirements and other relevant provisions of Directive 1999/5/EC."

-The Manufacturer is not responsible for any radio or TV interference caused by unauthorized modifications to this equipment. Such modifications could void the user's authority to operate the equipment.

-No naked flame sources, such as lighted candles, should be placed on the apparatus;
-Attentions should be drawn to the environmental aspects of battery disposal;(e.g. Before scrapping the appliance, remove the batteries and places them in the appropriate battery connect station.)

M-ST-971-2 ver.1
Certified to comply with Class B limit, part 15 of FCC rules

