

MC3000 Series Quick Start Guide

<http://www.symbol.com/mc3000>

See User Guide for more information

This guide is applicable to all MC30XX series products

POST IN WORK AREA

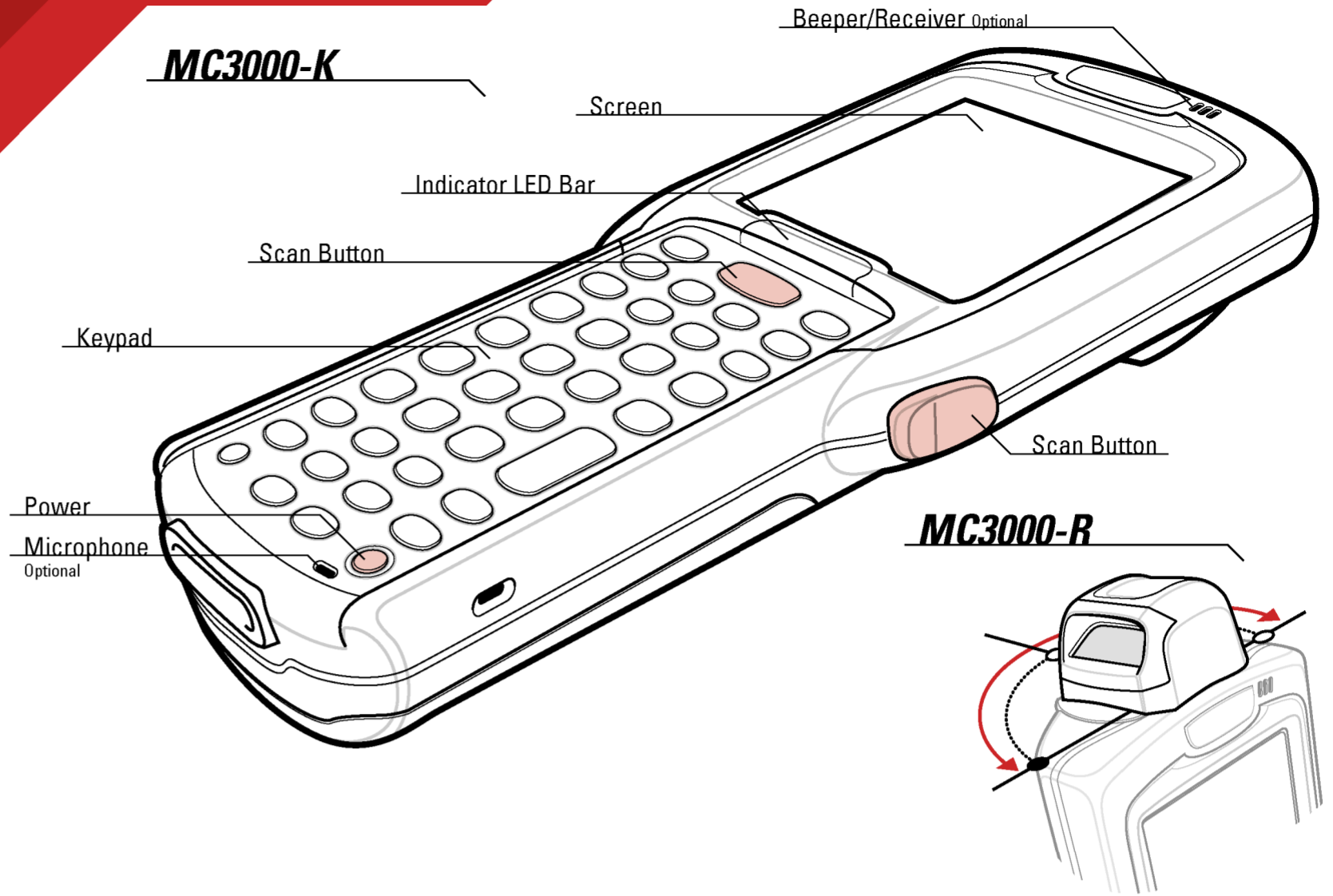
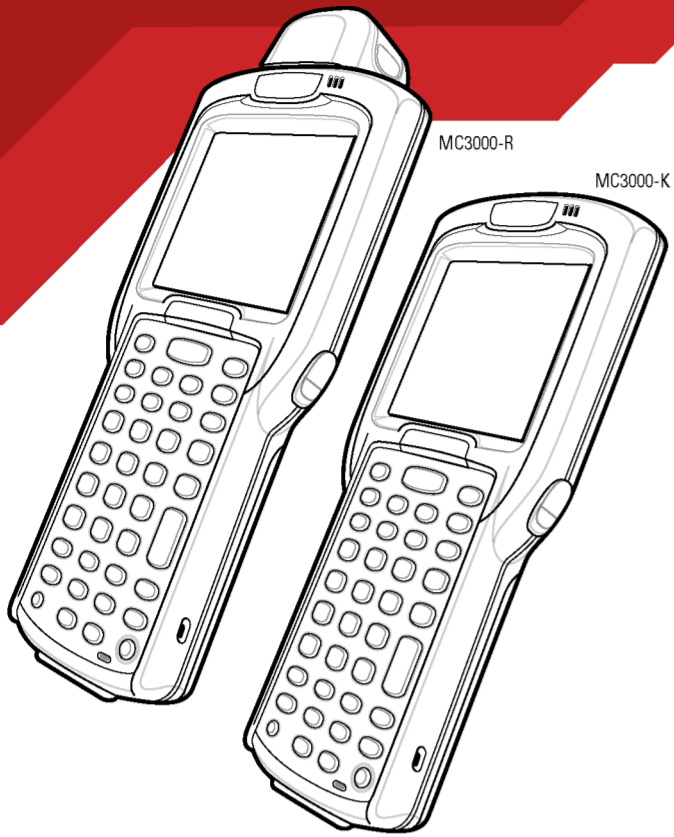

MC3000-R

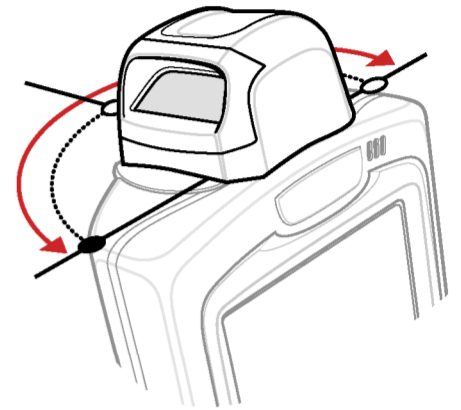

Battery Installation

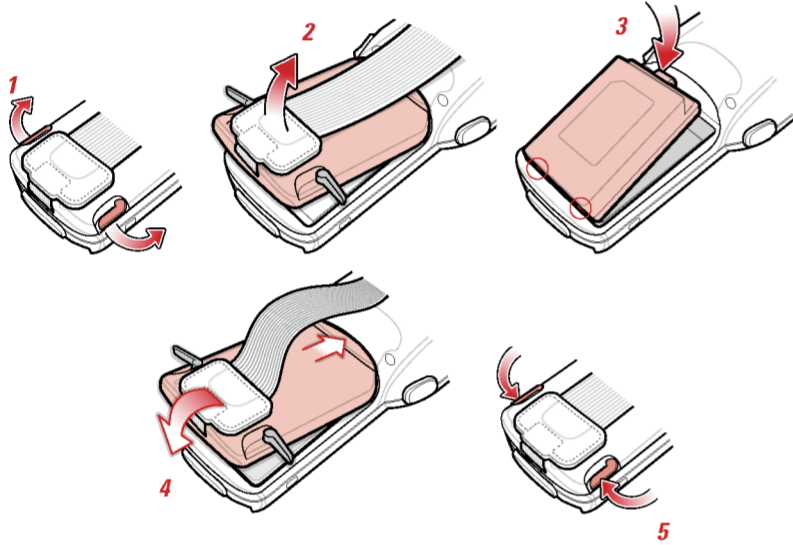

MC3000-K Back View

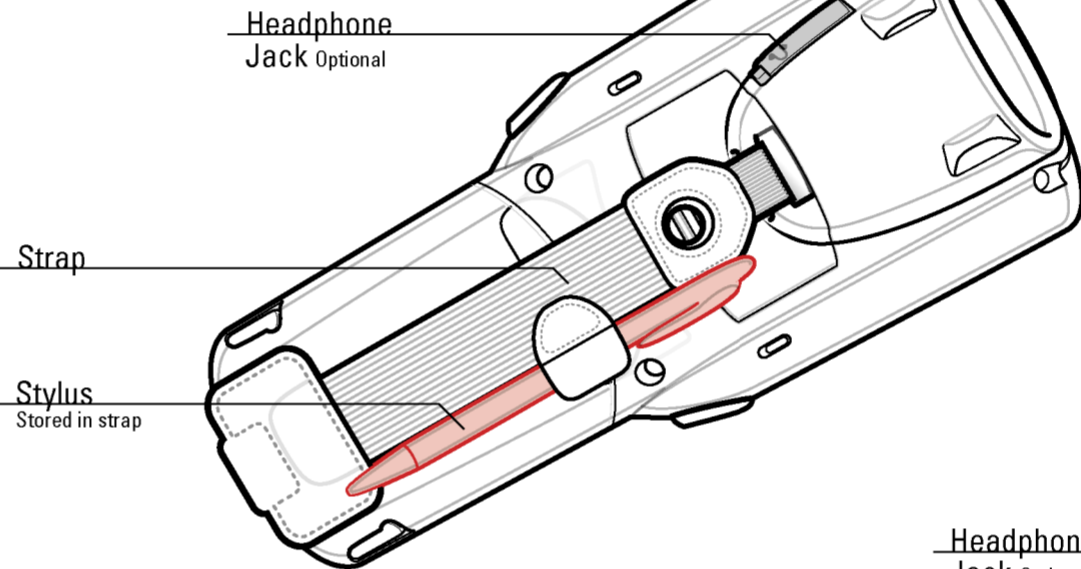

MC3000-R Back View

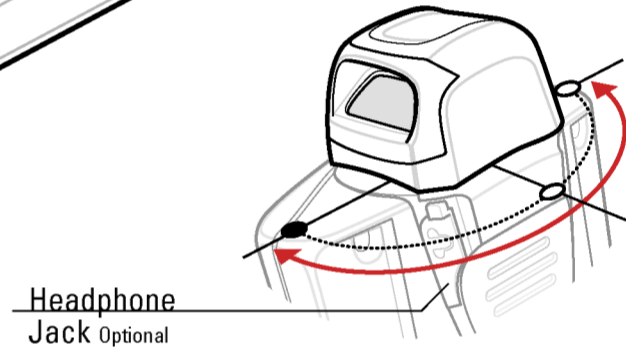

Accessory Installation

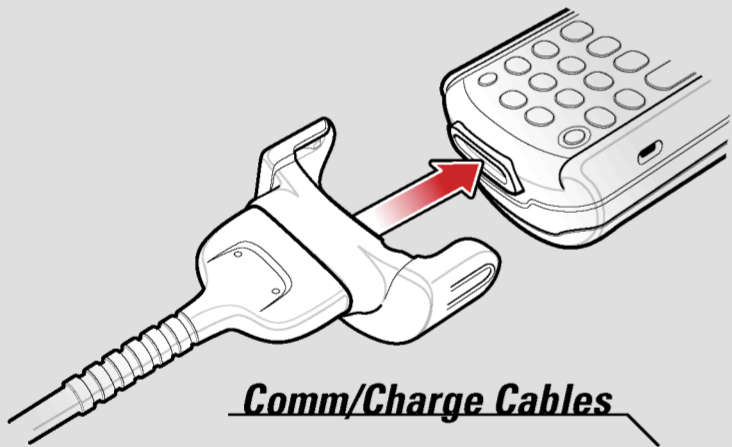

Comm/Charge Cables

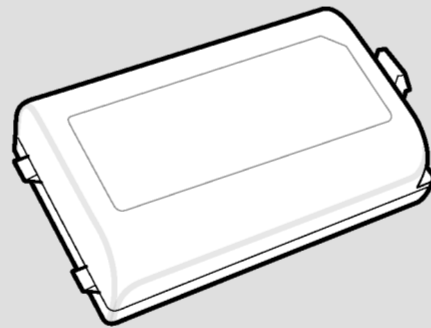

Extended Life Battery

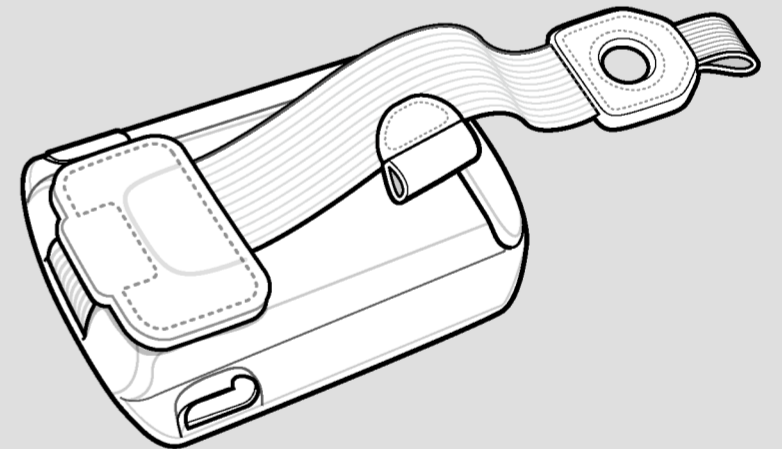

Extended Life Battery Strap/Door Assembly

Charging Instructions

● = LED Indicator Location
 Slow Flash = Normal Charge | Solid Amber = Full Charge | Fast Flash = Charging Error

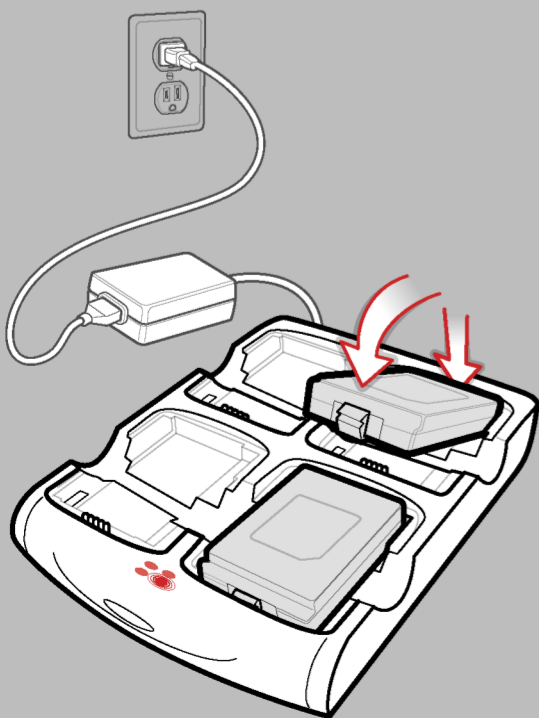

Four Slot Spare Battery Charger

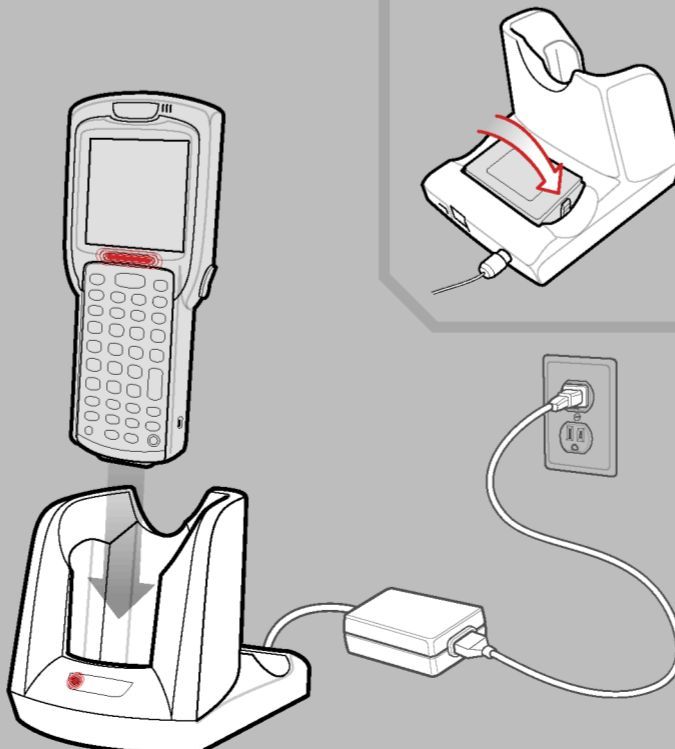

Single Slot Serial/USB Cradle

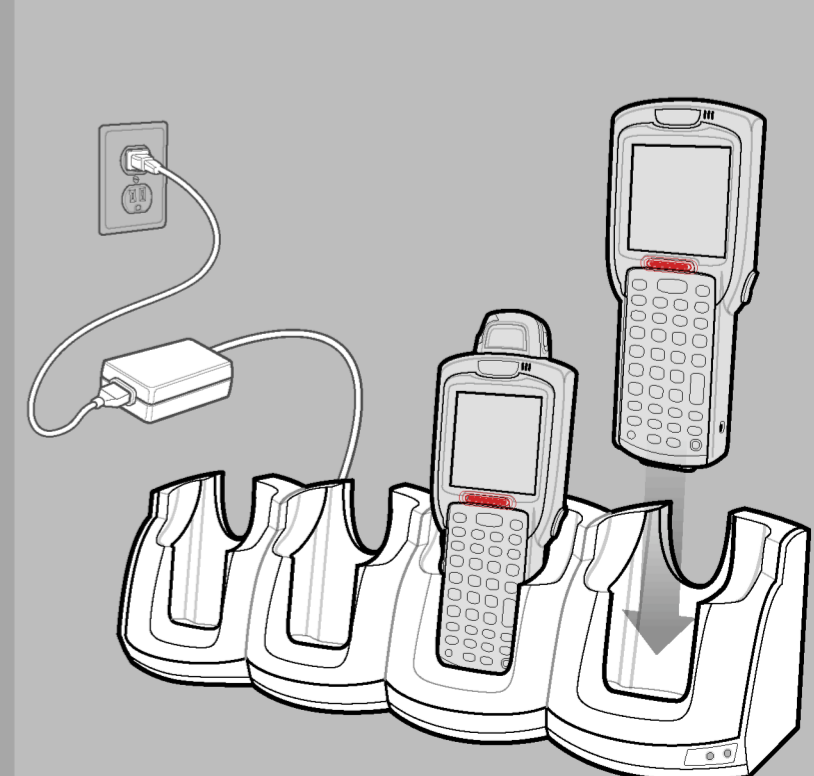

Four Slot Cradles

Charge-Only Cradle and Ethernet Cradle

Optimum Imaging and Scanning Positions

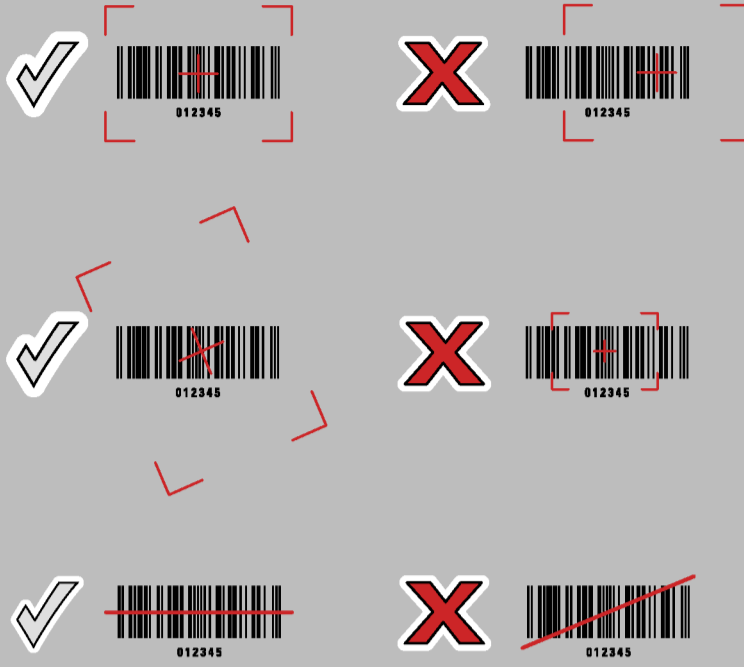
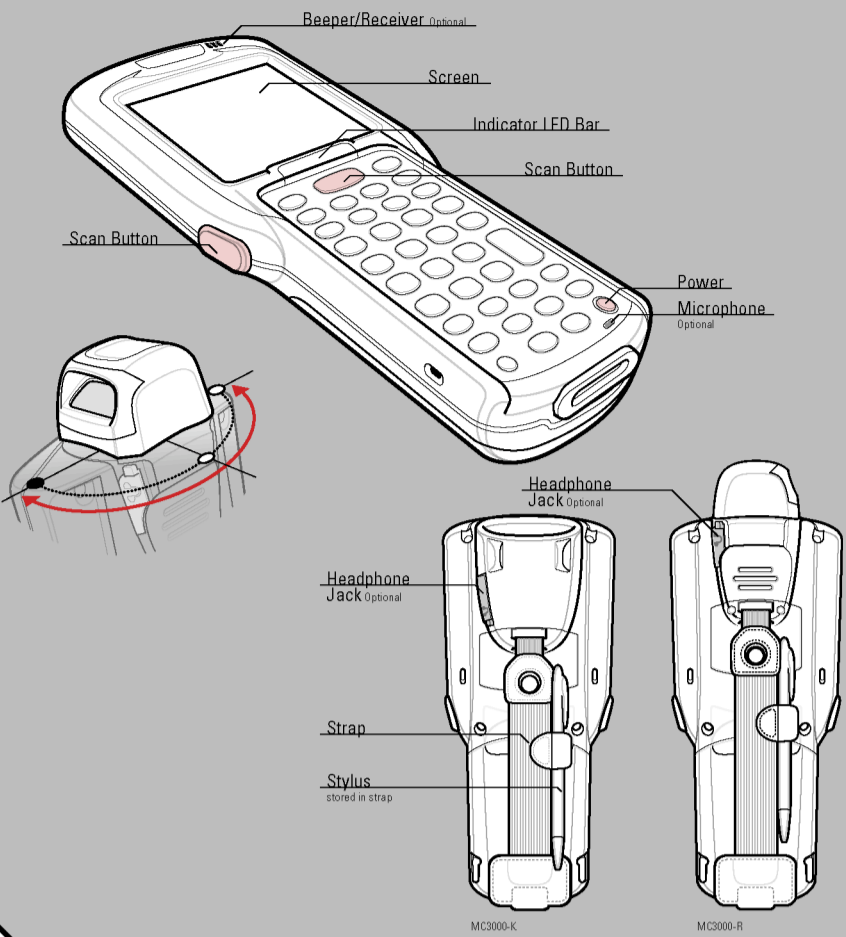

MC3000-K Scanning

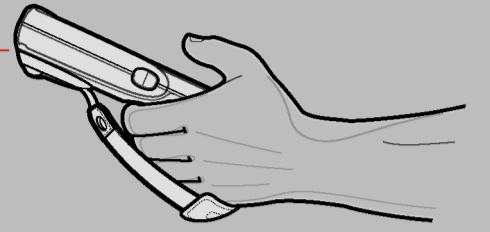

MC3000-R Scanning

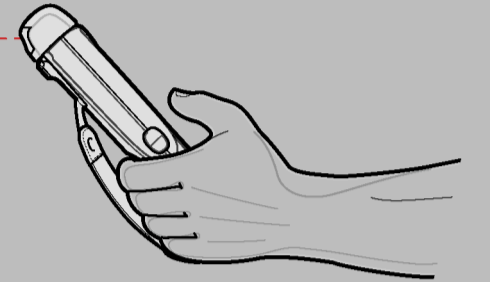

Optimum Upright Body Postures



Avoid Extreme Wrist Angles

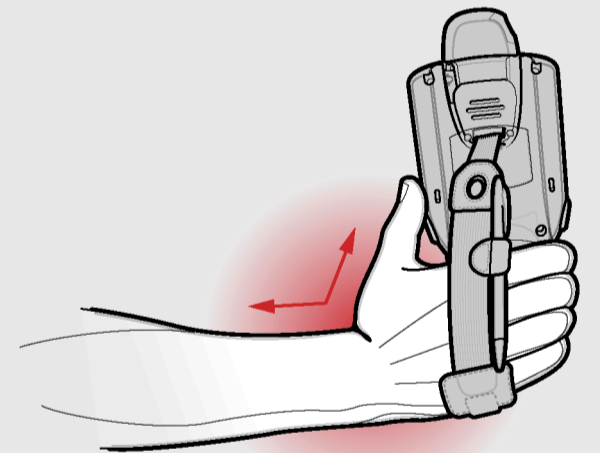
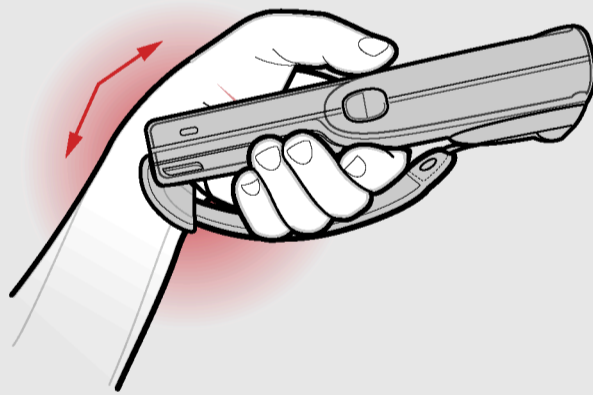

Optimum Body Posture for Low Scanning

ALTERNATE LEFT AND RIGHT KNEES

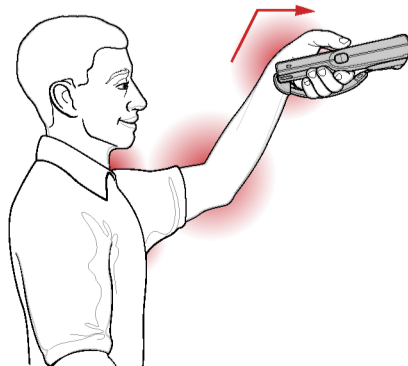

Optimum Body Posture for High Scanning

USE A LADDER

