

P D T 8 0 0 0

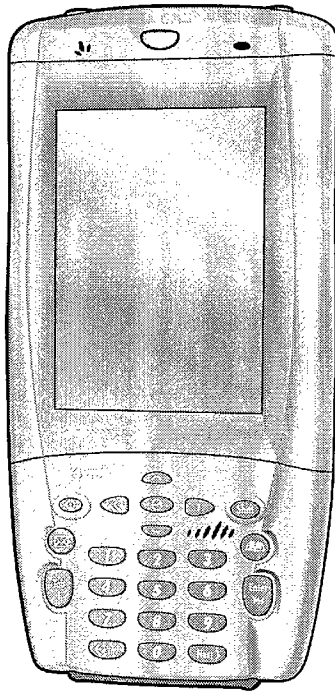

symbol[®]

P D T 8 0 0 0 T e r m i n a l

© 2002 SYMBOL TECHNOLOGIES, INC. All rights reserved.

Symbol reserves the right to make changes to any product to improve reliability, function, or design.

Symbol does not assume any product liability arising out of, or in connection with, the application or use of any product, circuit, or application described herein.

No license is granted, either expressly or by implication, estoppel, or otherwise under any patent right or patent, covering or relating to any combination, system, apparatus, machine, material, method, or process in which Symbol products might be used. An implied license only exists for equipment, circuits, and subsystems contained in Symbol products.

Symbol and the Symbol logo are registered trademarks of Symbol Technologies, Inc. Other product names mentioned in this manual may be trademarks or registered trademarks of their respective companies and are hereby acknowledged.

Symbol Technologies, Inc.

One Symbol Plaza

Holtville, N.Y. 11742-1300

<http://www.symbol.com>

Patents

This product is covered by one or more of the following U.S. and foreign Patents:

U.S. Patent No. 4,593,186; 4,603,262; 4,607,156; 4,652,750; 4,673,805; 4,736,095; 4,758,717; 4,760,248; 4,806,742; 4,816,660; 4,845,350; 4,896,026; 4,897,532; 4,923,281; 4,933,538; 4,992,717; 5,015,833; 5,017,765; 5,021,641; 5,029,183; 5,047,617; 5,103,461; 5,113,445; 5,130,520; 5,140,144; 5,142,550; 5,149,950; 5,157,687; 5,168,148; 5,168,149; 5,180,904; 5,216,232; 5,229,591; 5,230,088; 5,235,167; 5,243,655; 5,247,162; 5,250,791; 5,250,792; 5,260,563; 5,262,627; 5,262,628; 5,266,787; 5,278,398; 5,280,162; 5,280,163; 5,280,164; 5,280,498; 5,304,786; 5,304,788; 5,306,900; 5,324,924; 5,337,361; 5,367,151; 5,373,148; 5,378,882; 5,396,053; 5,396,055; 5,399,846; 5,408,081; 5,410,139; 5,410,140; 5,412,198; 5,418,812; 5,420,411; 5,436,440; 5,444,231; 5,449,891; 5,449,893; 5,468,949; 5,471,042; 5,478,998; 5,479,000; 5,479,002; 5,479,441; 5,504,322; 5,519,577; 5,528,621; 5,532,469; 5,543,610; 5,545,889; 5,552,592; 5,557,093; 5,578,810; 5,581,070; 5,589,679; 5,589,680; 5,608,202; 5,612,531; 5,619,028; 5,627,359; 5,637,852; 5,664,229; 5,668,803; 5,675,139; 5,693,929; 5,698,835; 5,705,800; 5,714,746; 5,723,851; 5,734,152; 5,734,153; 5,742,043; 5,745,794; 5,754,587; 5,762,516; 5,763,863; 5,767,500; 5,789,728; 5,789,731; 5,808,287; 5,811,785; 5,811,787; 5,815,811; 5,821,519; 5,821,520; 5,823,812; 5,828,050; 5,848,064; 5,850,078; 5,861,615; 5,874,720; 5,875,415; 5,900,617; 5,902,989; 5,907,146; 5,912,450; 5,914,478; 5,917,173; 5,920,059; 5,923,025; 5,929,420; 5,945,658; 5,945,659; 5,946,194; 5,959,285; 6,002,918; 6,021,947; 6,029,894; 6,031,830; 6,036,098; 6,047,892; 6,050,491; 6,053,413; 6,056,200; 6,065,678; 6,067,297; 6,082,621; 6,084,528; 6,088,482; 6,092,725; 6,101,483; 6,102,293; 6,104,620; 6,114,712; 6,115,678; 6,119,944; 6,123,265; 6,131,814; 6,138,180; 6,142,379; 6,172,478; 6,176,428; 6,178,426; 6,186,400; 6,188,681; 6,209,788; 6,209,789; 6,216,951; 6,220,514; 6,243,447; 6,244,513; 6,247,647; 6,308,061; 6,250,551; 6,295,031; 6,308,061; 6,308,892; 6,321,990; 6,328,213; 6,330,244; 6,336,587; 6,340,114; 6,340,115; 6,340,119; 6,348,773; D305,885; D341,584; D344,501; D359,483; D362,453; D363,700; D363,918; D370,478; D383,124; D391,250; D405,077; D406,581; D414,171; D414,172; D418,500; D419,548; D423,468; D424,035; D430,158; D430,159; D431,562; D436,104.

Invention No. 55,358; 62,539; 69,060; 69,187 (Taiwan); No. 1,601,796; 1,907,875; 1,955,269 (Japan); European Patent 367,299; 414,281; 367,300; 367,298; UK 2,072,832; France 81/03938; Italy 1,138,713

rev. 03/02

Q u i c k R e f e r e n c e

Introduction

Congratulations on your purchase of Symbol Technologies' PDT 8000 Terminal! Its unique combination of features make this product superior for use in a wide range of applications. These features include:

- Microsoft® Windows® Pocket PC 2002 operating system
- RF communication via Symbol's Spectrum24® wireless network
- 3.9 inch 1/4 VGA Color LCD
- 1-dimensional barcode scanning capability
- Touch screen
- Printing support
- Compact flash card slot
- IrDA-compliant interface for printing and communications.

About This Guide

This guide describes how to set up and use the terminal. The term PDT 8000 refers to the batch 1D scanning terminal, and the Spectrum24 terminal. Specific topics covered include:

- *Accessories* on page 2
- *Parts of the PDT 8000* on page 3
- *Installing Batteries* on page 5
- *Charging the Battery* on page 6
- *Starting the PDT 8000* on page 7
- *Adjusting the Backlight* on page 8
- *Using the Keyboard* on page 8
- *Using the Stylus* on page 10
- *Today Screen* on page 11
- *Navigation Bar and Command Bar* on page 12
- *Input Methods* on page 13
- *Scanning with the PDT 8000* on page 16
- *Resetting Your PDT 8000 Terminal* on page 16
- *Host Communications* on page 17
- *LED Indicators* on page 19

P D T 8 0 0 0 T e r m i n a l

- *Troubleshooting* on page 19
- *Maintaining the PDT 8000* on page 23
- *Regulatory Information* on page 27.

The *PDT 8000 Product Reference Guide* (p/n 72E-55893-xx) details the applications available for the PDT 8000.

Accessories

Each PDT 8000 requires one 7.4 volt 1200 mAh prismatic lithium-ion battery. The following optional accessories are available from Symbol Technologies:

- Additional lithium-ion battery (p/n 21-54882-01)
- Cables:
 - DEX cable (p/n CBL-8000-100-DEX)
 - Autocharge cable (p/n VCA8000-00)
 - Snap-on printer cable (p/n CBL-8000-100-INT1)
 - AC Wall Adaptor (p/n CBL8000-100U)
- Modem Module (p/n MDM8000-100)
- PSRI 8000 Cradle (p/n PSRI8000-00).

Q u i c k R e f e r e n c e

Parts of the PDT 8000

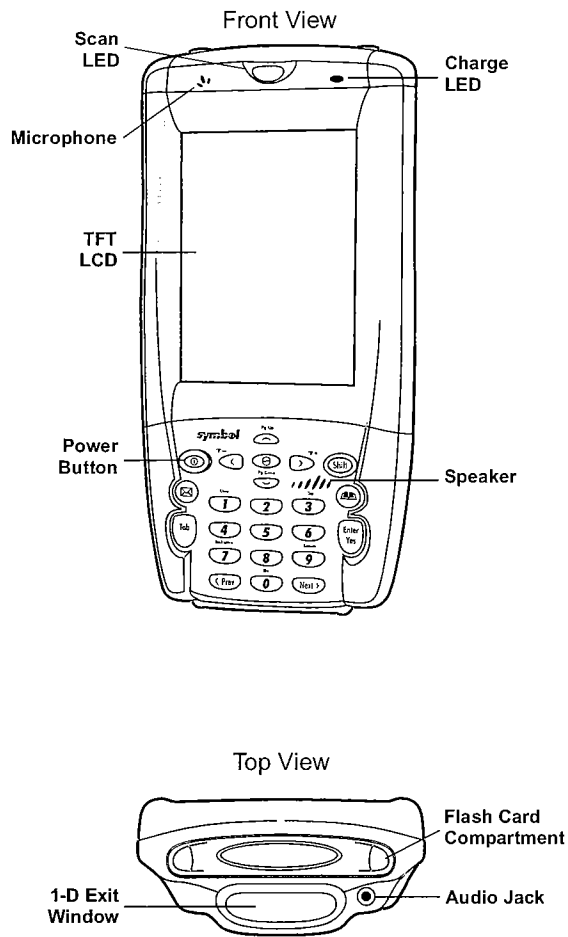

P D T 8 0 0 0 T e r m i n a l

Parts of the PDT 8000 (continued)

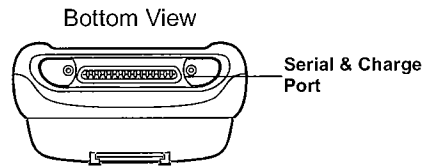
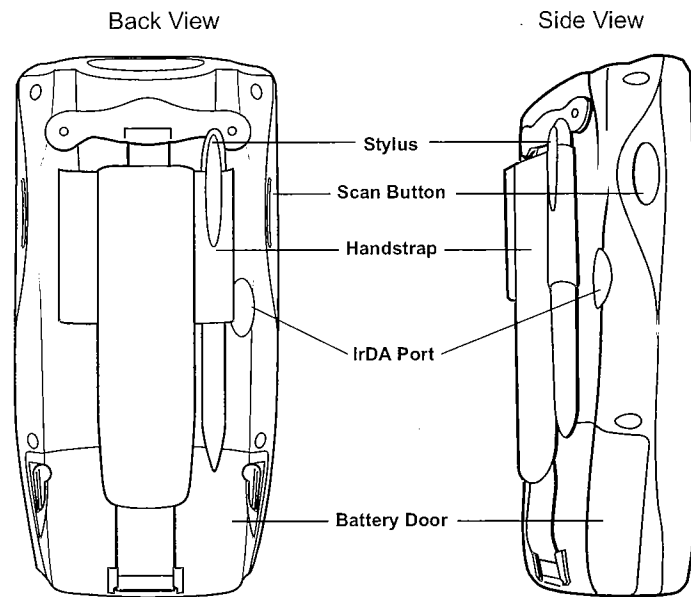

Q u i c k R e f e r e n c e

Installing Batteries

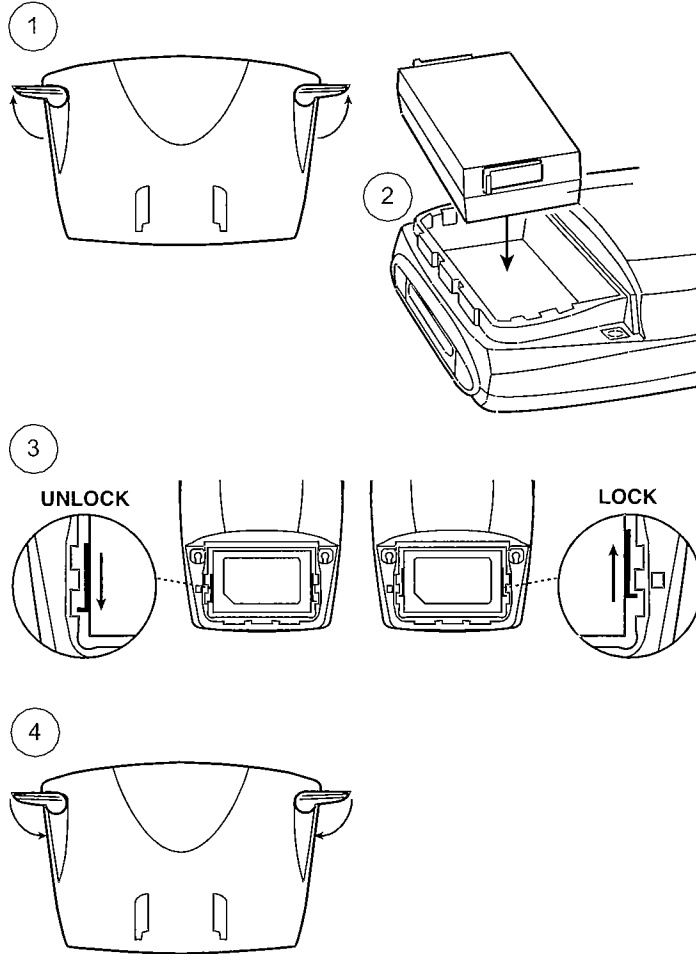

Charging the Battery

Before using your terminal for the first time, charge the lithium-ion battery in the terminal for approximately three hours. When battery voltage is low, a warning message appears indicating the battery needs to be charged.

Your terminal is equipped with a memory backup battery which automatically charges from the fully-charged lithium-ion battery. This backup battery retains data in memory when the terminal's battery is removed, and takes several hours to charge when you first use your terminal.

Note: If you remove your lithium-ion battery before the back-up battery is fully charged, data may be lost. For this reason, DO NOT remove the battery before the backup battery is fully charged, which can take up to 20 hours.

To charge the battery using the PSRI 8000:

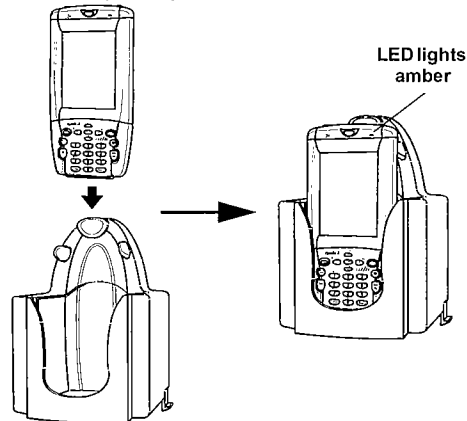

For more information on the LED, see *LED Indicators* on page 19. You can also charge the battery using the MDM 8000 Modem Module with a cable assembly, or the VCA 8000 Autocharge Cable with the MDM 8000. For more information, see the set up instructions in the respective Quick Reference Guides.

Q u i c k R e f e r e n c e

Starting the PDT 8000

Press the red power button to turn the PDT 8000 on. If the terminal does not power on see *Troubleshooting* on page 19.

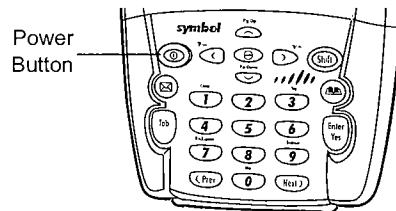

As the terminal initializes its unique Flash File system, the Symbol splash screen displays for about 30 seconds. When the Welcome screen appears, tap anywhere on the screen to continue to the Align screen. Note that these screens also appear every time you perform a hard reset.

Aligning the Screen

To align your PDT 8000 so the cursor on the touch screen aligns with the tip of your stylus:

1. If necessary, adjust the contrast on the PDT 8000 so the screen is readable (see *Adjusting the Backlight* on page 8).
2. Remove the stylus from the handstrap of the PDT 8000.
3. Tap the center of each target that appears on the Calibration screen with the tip of the stylus.

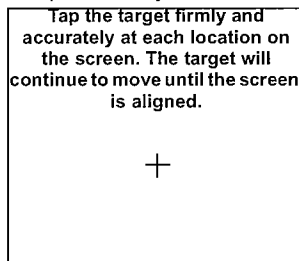

P D T 8 0 0 0 T e r m i n a l

4. Follow the directions on the screen which explains how to use the stylus and pop-up menus, and allows you to set your city and time zone.

Note: To align your screen at anytime, press **Shift + 2** to launch the calibration screen.

Adjusting the Backlight

Use the key combinations below to adjust the backlight.

Keys	Description
Shift + Pepsi App Key 2/3	Turn backlight on or off.
Shift + Left Arrow	Decrease backlight (decrease brightness)
Shift + Right Arrow	Increase backlight (increase brightness)

Using the Keyboard

Note: Key functions can be changed by an application. Your keyboard may not function exactly as described. For more detailed keyboard information, refer to the *PDT 8000 Product Reference Guide* (p/n 72E-55893-xx).

The keyboard uses a numeric keypad that produces the numbers (0-9) and assorted functions. The keyboard is color-coded to indicate particular actions that are produced when the modifier (**Shift**) key is pressed. The keyboard default is numeric, producing numbers.

Q u i c k R e f e r e n c e

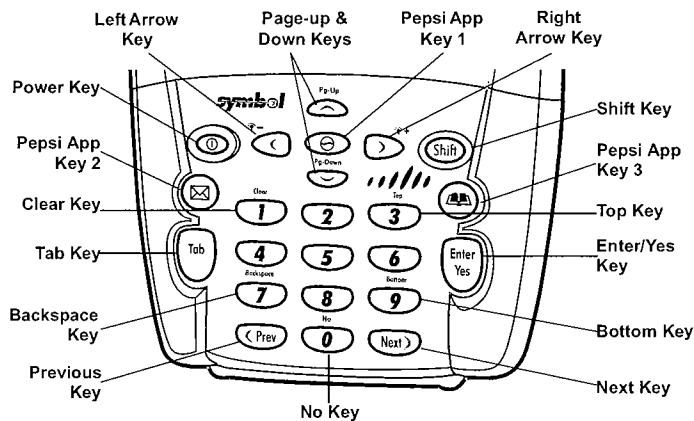

Key	Action
Backspace	Press Shift + 7 to erase information entered on the display, one character at a time.
Bottom	Press Shift + 9 . Action is application dependent.
Clear	Press Shift + 1 . Action is application dependent.
Enter/Yes	Press Enter after entering data or a command.
Left Arrow	See <i>Adjusting the Backlight</i> on page 8.
Next	Action is application dependent.
No	Press Shift + 0 . Action is application dependent.
Page-up and Down	Press Shift + Up Arrow . Action is application dependent. Press Shift + Down Arrow . Action is application dependent.
Pepsi App Key 1	Action is application dependent.
Pepsi App Key 2	Press the Pepsi App Key 2 key to launch the Inbox application. See <i>Adjusting the Backlight</i> on page 8.
Pepsi App Key 3	See <i>Adjusting the Backlight</i> on page 8.
Power	Press Power to suspend/resume the terminal. See <i>Starting the PDT 8000</i> on page 7.

P D T 8 0 0 0 T e r m i n a l

Key	Action
Previous	Action is application dependent.
Right Arrow	See <i>Adjusting the Backlight</i> on page 8.
Shift	Press Shift , then another key to produce the function above that key (shown in blue). See individual key descriptions in this table for additional Shift key usage.
Tab	Press Tab to move from field to field.
Top	Press Shift + 3 . Action is application dependent.

Using the Stylus

The stylus selects items and enters information. The stylus functions as a mouse.

- **Tap:** Touch the screen once with the stylus to open items and select options.
- **Drag:** Hold the stylus on the screen and drag across the screen to select text and images. Drag in a list to select multiple items.
- **Tap-and-hold:** Tap and hold the stylus on an item to see a list of actions available for that item. On the pop-up menu that appears, tap the action you want to perform.

Q u i c k R e f e r e n c e

Today Screen

When you turn on your terminal for the first time each day (or after 4 hours of inactivity), the Today screen appears. You can also display it by tapping *Start - Today*. On the Today screen, you can see important information for the day.

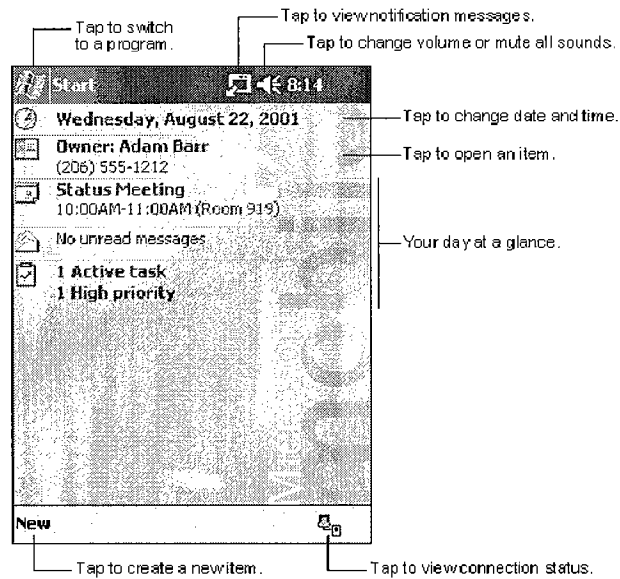

Navigation Bar and Command Bar

The navigation bar at the top of the screen displays the active program and current time, and allows you to switch to programs and close screens. The command bar at the bottom of the screen contains menus and buttons to perform tasks in programs.

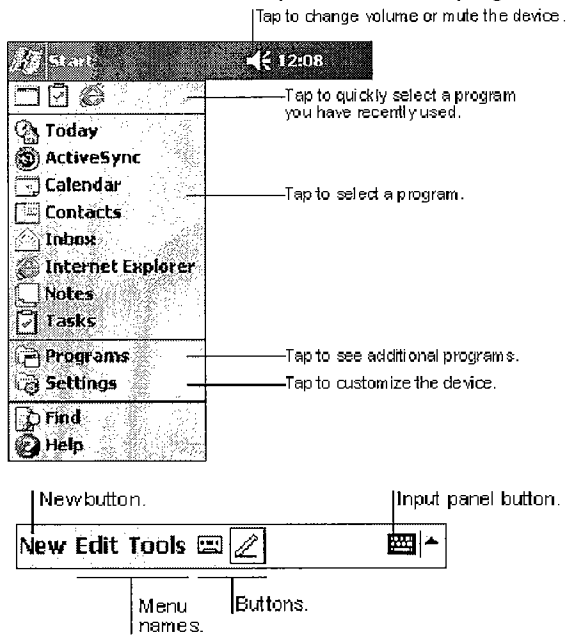

Q u i c k R e f e r e n c e

Input Methods

Enter information in any program by typing with the keyboard, or use the input panel to type with the soft keyboard, write using Block Recognizer, Letter Recognizer or Transcriber. In any case, the characters appear as typed text on the screen.

To show or hide the input panel, tap the Input Panel button. Tap the arrow next to this button to view input methods.

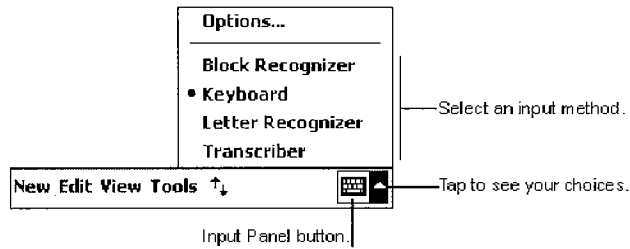

When you use the input panel, your terminal anticipates the word you are typing or writing and displays it above the input panel. When you tap the displayed word, it is inserted into your text at the insertion point. The more you use your terminal, the more words it learns to anticipate.

Using the Soft Keyboard

1. Tap the arrow next to the Input Panel button, then *Keyboard*.
2. On the soft keyboard, tap the keys with your stylus.

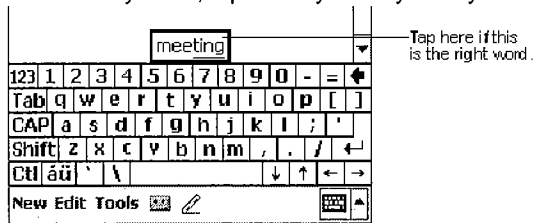

Using the Block Recognizer

1. Tap the arrow next to the Input Panel button, then *Block Recognizer*.
2. Write a letter in the left side of the box, or a number in the right side, using special character strokes.

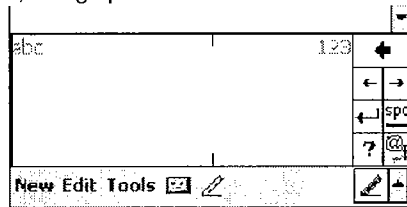

When you write a letter, it is converted to typed text on the screen. For instructions on entering Block Recognizer characters, with Block Recognizer open, tap the question mark next to the writing area, or see *Block Recognizer Characters* on page 15.

Using the Letter Recognizer

1. Tap the arrow next to the Input Panel button, then *Letter Recognizer*.
2. Write letters or numbers in the writing area, just as you would on paper. Write capital letters in the left side of the box, numbers in the right side, and lower case letters in the center.

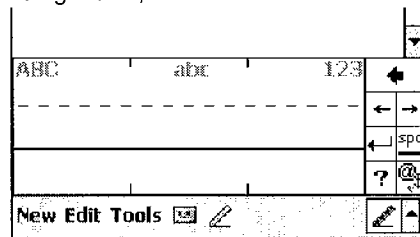

Q u i c k R e f e r e n c e

When you write a letter, it is converted to typed text on the screen. For instructions on using Letter Recognizer, with Letter Recognizer open, tap the question mark next to the writing area.

Using the Transcriber

1. Tap the arrow next to the Input Panel button, then *Transcriber*.
2. Write anywhere on the screen. What you write on the screen will be converted to text.

Block Recognizer Characters

The following chart is a partial display of the characters you can write while using the Block Recognizer (the dot on each character is the starting point for writing).

Letter Area				Number/Punctuation Area							
A	a	ā		N	n			0))
B	b	ḃ		O	o	o		1	1	+	+
C	c	ċ		P	p	p		2	2	*	* x ∞
D	d	ḏ		Q	q	q		3	3	/	/
E	e	ē		R	r	r		4	4	\	\
F	f	f		S	s	s		5	5	?	? 7 ?
G	g	ḡ		T	t	t	v f	6	6	!	!
H	h	ḥ		U	u	u		7	7	@	@
I	i	ī		V	v	v		8	8	&	& 4
J	j	ĵ		W	w	w		9	9	<	< €
K	k	ḱ	ḱ	X	x	x	∞	>	>	“	“
L	l	l	l	Y	y	y		.	.	-	-
M	m	m		Z	z	z		((

space	←
back space	→

enter	↑
back space	→

P D T 8 0 0 0 T e r m i n a l

Scanning with the PDT 8000

The PDT 8000 has an integrated scanner which collects data by scanning bar codes. Refer to the *PDT 8000 Product Reference Guide* (p/n 72E-55893-xx) for information on configuring your terminal for scanning.

To scan bar codes with the PDT 8000:

1. Launch the terminal's scanning application.
2. Aim the scanner at the bar code.
3. Press the scan trigger. Ensure the red scan beam covers the entire bar code. The green scan LED lights and a beep sounds to indicate a successful decode.

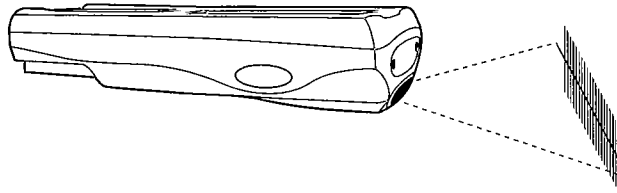

Resetting Your PDT 8000 Terminal

If your PDT 8000 terminal stops responding to input, reset it.

Performing a Soft Reset

A soft reset restarts the terminal and saves all stored records and entries.

Caution: Files that remain open during a soft reset may not be retained.
DO NOT perform a soft reset if the terminal is suspended. Press the Power button to wake the terminal.

Q u i c k R e f e r e n c e

To perform a soft reset press and hold the power key (for approximately ten seconds) and release it as soon as the screen changes and the terminal begins to reboot.

Performing a Hard Reset

A hard reset also restarts your terminal, but erases all stored records and entries in RAM. *Therefore, never perform a hard reset unless a soft reset does not solve your problem.*

Note: With a hard reset, Formats, Preferences, Date and time, and other settings are restored to their factory default settings.

You can restore any data previously synchronized with your computer during the next ActiveSync operation. Refer to the *PDT 8000 Product Reference Guide* (p/n 72E-55893-xx).

1. Remove the battery door.
2. Press and release Power Key + Scan Button.
3. Replace the battery door.
4. As the terminal reboots, the Symbol splash screen displays for about 30 seconds.
5. Realign the screen as described on page 7.

Host Communications

The PDT 8000 terminal can communicate with a host computer either directly through its communications port using the cradle, or wirelessly via the Spectrum24® wireless LANs. For more information on setting up and performing wireless communications with your PDT 8000 terminal, refer to the *PDT 8000 Product Reference Guide* (p/n 72E-55893-xx).

P D T 8 0 0 0 T e r m i n a l

Using the Cradle

To communicate through the cradle:

1. Ensure all connections between the cradle and the host computer are secure. Refer to the *PSRI 8000 Installation Instructions* (p/n 72-55948-xx) for instructions on setting up the cradle.
2. Power on the host computer, the cradle, and the terminal.
3. Insert the terminal into the cradle.
4. Begin host communications as specified by your application.

Communicating with Printers

To print from a standard printer:

1. Attach the snap-on-printer cable to the serial port in the bottom of the PDT 8000.
2. Attach the other end of the cable to the Data Communications Connector on the printer.
3. Run your application's print function.

To print from an IrDA-compliant printer:

1. Point the IrDA port on the back of the PDT 8000 at the IrDA port on the printer, at a maximum distance of 39 inches (1 meter).
2. Run the application's print function.

Note: The PDT 8000 must have software configured to communicate with the printer you are using.

Q u i c k R e f e r e n c e

LED Indicators

LED	Indicator
Charge LED - Amber	
Off	Not connected to charger.
Slow blinking amber	Terminal is charging.
Fast blinking amber	Error in charging.
Solid amber	Charging is complete.
Scan LED	
Off	Not scanning.
Solid Red	Laser enabled. Scanning in process.
Solid green	Successful decode.

Troubleshooting

Problem	Cause	Solution
PDT 8000 does not turn on.	Lithium-ion battery not charged.	Charge or replace the lithium-ion battery in the PDT 8000.
	Battery not installed properly.	Ensure battery is installed properly. See <i>Installing Batteries</i> on page 5.
	System crash.	Perform a hard reset. See <i>Resetting Your PDT 8000 Terminal</i> on page 16.
Rechargeable lithium-ion battery did not charge.	Battery failed.	Replace battery. If your PDT 8000 terminal still does not operate, try a soft reset, then a hard reset; see <i>Resetting Your PDT 8000 Terminal</i> on page 16.
	PDT 8000 removed from cradle while battery was charging.	Insert PDT 8000 in cradle and begin charging. The lithium-ion battery requires up to 3 hours to recharge fully.
Cannot see characters on display.	PDT 8000 not powered on.	Press the Power key.

P D T 8 0 0 0 T e r m i n a l

Problem	Cause	Solution
Fail to communicate with IrDA printer.	Distance from printer is more than 1 meter (39 inches).	Bring the terminal closer to the printer and attempt communications again.
	Obstruction interfered with communication.	Check the path to ensure no objects were in the way.
	Application is not enabled to run IrDA printing.	Printer support must be included with the application to run IrDA printing on the terminal. See your System Administrator.
During data communication, no data was transmitted, or transmitted data was incomplete.	Terminal removed from cradle during communications.	Replace the terminal in the cradle and re-transmit.
	Incorrect cable configuration.	See your System Administrator.
	Communication software was incorrectly installed or configured.	Perform setup as described in the <i>PDT 8000 Product Reference Guide</i> (p/n 72E-55893-xx).
No sound is audible.	Volume setting is low or turned off.	Check the System Volume slider in the Sounds & Notifications properties dialog box (under Start/Settings) to ensure the volume is set to an adequate level.
PDT 8000 turns itself off.	PDT 8000 is inactive.	Your PDT 8000 turns off after a period of inactivity. This period can be set from one to five minutes, in one-minute intervals. Check the Power dialog box (in the System tab under Start/Settings), and change the setting if you need a longer delay before the automatic shutoff feature activates.

Q u i c k R e f e r e n c e

Problem	Cause	Solution
PDT 8000 doesn't recognize my handwriting.	Character strokes written incorrectly with the stylus.	For your PDT 8000 to recognize handwriting input with the stylus, characters must be written a certain way. See the <i>PDT 8000 Product Reference Guide</i> (p/n 72E-55893-xx) for information about how to write character strokes.
	Character strokes written on the wrong part of the LCD screen.	Make the character strokes in the lower character entry area on the screen — not on the display part of the screen.
	Lower-case and upper-case letters, and numbers written on the wrong parts of the LCD screen.	Ensure you are writing letters and numbers in the correct part of the LCD screen. See <i>Using the Block Recognizer</i> on page 14 or <i>Using the Letter Recognizer</i> on page 14 depending on what input method you are using.
Terminal does not respond to a hard reset.	Battery door is attached.	You must remove the battery door before performing a hard reset.
	Battery is not charged.	Charge the terminal. See <i>Charging the Battery</i> on page 6.
Tapping the screen buttons or icons does not activate the corresponding feature.	LCD screen not aligned correctly.	Align the screen. See <i>Aligning the Screen</i> on page 7.
A message appears stating that your PDT 8000 terminal memory is full.	Too many files stored on the terminal.	Delete unused memos and records. You can save these records on your computer.
	Memory allocation too low.	Adjust the memory allocation. Select Start , then Settings , and select the System tab. Tap Memory and adjust the slider.
	Too many applications installed on the terminal.	If you have installed additional applications on your PDT 8000, remove them to recover memory. Select Start , then Settings , and select the System tab. Tap Remove Programs , select the unused program and tap Remove .

P D T 8 0 0 0 T e r m i n a l

Problem	Cause	Solution
Beamed data does not transmit.	PDT 8000 terminals too close together.	Confirm that the PDT 8000 terminals are 5" apart, and there is a clear path between the two devices.
	Insufficient room lighting.	Adjust the room lighting or move to a different location.
When receiving beamed data an out of memory message appears.	Not enough free memory available for receiving data.	Your PDT 8000 terminal requires at least twice the amount of memory available as the data you are receiving. For example, if you are receiving a 30K application, you must have at least 60K free.
Your PDT 8000 terminal does not accept scan input.	Scanning application is not loaded.	Verify that the unit is loaded with a scanning application. See your System Administrator.
	Unreadable bar code.	Ensure the symbol is not defaced.
	Distance between exit window and bar code is incorrect.	Ensure you are within proper scanning range.
	Terminal is not programmed for the bar code.	Ensure the terminal is programmed to accept the type of bar code you are scanning.
	Terminal is not programmed to generate a beep.	If you are expecting a beep on a good decode and don't hear one, check that the application is set to generate a beep on good decode.
	Battery is low.	If the scanner stops emitting a laser beam when you press the trigger, check your battery level. Note: If the scanner is still not reading symbols, contact your distributor or Symbol Technologies.

Q u i c k R e f e r e n c e

Maintaining the PDT 8000

- Do not scratch the screen. Use the supplied stylus or plastic-tipped pens intended for use with a touch-sensitive screen. Never use a pen or pencil or other sharp object on the screen.
- Although your PDT 8000 is water and dust resistant, do not expose it to rain or moisture for an extended period of time.
- The touch-sensitive screen of your PDT 8000 contains glass. Do not drop your PDT 8000 or subject it to strong impact.
- Protect your PDT 8000 from temperature extremes. Do not leave it on the dashboard of a car on a hot day, and keep it away from heat sources.
- Do not store or use your PDT 8000 in any location that is extremely dusty, damp or wet.
- If the surface of the PDT 8000 screen becomes soiled, clean it with a soft cloth moistened with a diluted window-cleaning solution.

END-USER LICENSE AGREEMENT

MICROSOFT WINDOWS FOR POCKET PC

DATA EXCHANGE COMPONENT: MICROSOFT ACTIVESYNC, VERSION 3.1

IMPORTANT-READ CAREFULLY: This End-User License Agreement ("EULA") is a legal agreement between you (either an individual or a single entity) and the manufacturer ("Manufacturer") of the special purpose computing device ("SYSTEM") with which you acquired the Microsoft software product(s) identified above ("SOFTWARE"). The SOFTWARE includes computer software, the associated media, any printed materials, and any "online" or electronic documentation. Any software provided along with the SOFTWARE that is associated with a separate end-user license agreement is licensed to you under the terms of that license agreement. By installing, copying, downloading, accessing, or otherwise using the SOFTWARE, you agree to be bound by the terms of this EULA. If you do not agree to the terms of this EULA, Manufacturer and Microsoft Licensing, Inc. ("MS") are unwilling to license the SOFTWARE to you. In such event, you may not use or copy the SOFTWARE, and you should promptly contact Manufacturer for instructions on return of the unused product(s) in accordance with Manufacturer's return policies.

SOFTWARE LICENSE

The SOFTWARE is protected by copyright laws and international copyright treaties, as well as other intellectual property laws and treaties. The SOFTWARE is licensed, not sold.

1. **GRANT OF LICENSE.** SOFTWARE includes software already installed on the SYSTEM ("SYSTEM Software") and, if included in the SYSTEM package, software contained on the CD-ROM disc labeled "Desktop Software for Microsoft Windows CE Microsoft ActiveSync 3.1" ("Desktop Software"). This EULA grants you the following rights to the SOFTWARE:
 - **SYSTEM Software.** You may use the SYSTEM Software as installed on the SYSTEM.
 - **Desktop Software.** If Desktop Software is included with your SYSTEM, you may install and use the Data Exchange component identified above on one (1) or more computers to exchange information with one (1) or more computing devices that contain a compatible version of the Microsoft Windows CE operating system. For other software component(s) contained in the Desktop Software, you may install and use such components only in accordance with the terms of the printed or online end-user license agreement(s) provided with such component(s). In the absence of an end user license agreement for particular component(s) of the Desktop Software, you may install and use only one (1) copy of such component(s) on the SYSTEM or a single computer with which you use the SYSTEM.
 - **Backup Copy.** If Manufacturer has not included a backup copy of the SYSTEM Software with the SYSTEM, you may make a single backup copy of the SYSTEM Software. You may use the backup copy solely for archival purposes.
 - **Microsoft Outlook 2000.** The following terms apply to your use of Microsoft Outlook 2000 (i) regardless of the information contained in the "Software Installation and Use" section of the online EULA you may install one (1) copy of Microsoft Outlook 2000 on one (1) computer to use, exchange data, share data, access, and interact with the SYSTEM, and (ii) the EULA is between Manufacturer (as defined above) and the end user-not between the PC Manufacturer and end user.

Q u i c k R e f e r e n c e

2. DESCRIPTION OF OTHER RIGHTS AND LIMITATIONS.

- **Speech/Handwriting Recognition.** If the SOFTWARE includes speech and/or handwriting recognition component(s), you should understand that speech and handwriting recognition are inherently statistical processes; that recognition errors are inherent in the processes; that it is your responsibility to provide for handling such errors and to monitor the recognition processes and correct any errors. Neither Manufacturer nor its suppliers shall be liable for any damages arising out of errors in the speech and handwriting recognition processes.
- **Limitations on Reverse Engineering, Decompilation, and Disassembly.** You may not reverse engineer, decompile, or disassemble the SOFTWARE, except and only to the extent that such activity is expressly permitted by applicable law notwithstanding this limitation.
- **Single SYSTEM.** The SYSTEM Software is licensed with the SYSTEM as a single integrated product. The SYSTEM Software installed in read-only memory ("ROM") of the SYSTEM may only be used as part of the SYSTEM.
- **Single EULA.** The package for the SYSTEM may contain multiple versions of this EULA, such as multiple translations and/or multiple media versions (e.g., in the user documentation and in the software). Even if you receive multiple versions of the EULA, you are licensed to use only one (1) copy of the SYSTEM Software.
- **Rental.** You may not rent or lease the SOFTWARE.
- **Software Transfer.** You may permanently transfer all of your rights under this EULA only as part of a sale or transfer of the SYSTEM, provided you retain no copies, you transfer all of the SOFTWARE (including all component parts, the media and printed materials, any upgrades or backup copies, this EULA and, if applicable, the Certificate(s) of Authenticity), and the recipient agrees to the terms of this EULA. If the SOFTWARE is an upgrade, any transfer must include all prior versions of the SOFTWARE.
- **Termination.** Without prejudice to any other rights, Manufacturer or MS may terminate this EULA if you fail to comply with the terms and conditions of this EULA. In such event, you must destroy all copies of the SOFTWARE and all of its component parts.

3. UPGRADES AND RECOVERY MEDIA.

- **SYSTEM Software.** If the SYSTEM Software is provided by Manufacturer separate from the SYSTEM on media such as a ROM chip, CD-ROM disc(s) or via Web download or other means, and is labeled "For Upgrade Purposes Only" or "For Recovery Purposes Only," you may install one copy of such SYSTEM Software onto the SYSTEM as a replacement copy for the existing SYSTEM Software and use it in accordance with Section 1 of this EULA.
- **Desktop Software.** If any Desktop Software component(s) is provided by Manufacturer separate from the SYSTEM on CD-ROM disc(s) or via Web download or other means, and labeled "For Upgrade Purposes Only" or "For Recovery Purposes Only", you may (i) install and use one copy of such component(s) on the computer(s) you use to exchange data with the SYSTEM as a replacement copy for the existing Desktop Software component(s).

P D T 8 0 0 0 T e r m i n a l

4. **COPYRIGHT.** All title and intellectual property rights in and to the SOFTWARE (including, but not limited to, any images, photographs, animations, video, audio, music, text, and "applets" incorporated into the SOFTWARE), the accompanying printed materials, and any copies of the SOFTWARE, are owned by MS or its suppliers (including Microsoft Corporation). You may not copy the printed materials accompanying the SOFTWARE. All title and intellectual property rights in and to the content which may be accessed through use of the SOFTWARE is the property of the respective content owner and may be protected by applicable copyright or other intellectual property laws and treaties. This EULA grants you no rights to use such content. All rights not specifically granted under this EULA are reserved by MS and its suppliers (including, Microsoft Corporation).
5. **EXPORT RESTRICTIONS.** You agree that you will not export or re-export the SOFTWARE to any country, person, or entity subject to U.S. export restrictions. You specifically agree not to export or re export the SOFTWARE: (i) to any country to which the U.S. has embargoed or restricted the export of goods or services, which as of May 1999 include, but are not necessarily limited to, Cuba, Iran, Iraq, Libya, North Korea, Sudan, Syria, and the Federal Republic of Yugoslavia (including Serbia, but not Montenegro), or to any national of any such country, wherever located, who intends to transmit or transport the products back to such country; (ii) to any person or entity who you know or have reason to know will utilize the SOFTWARE or portion thereof in the design, development, or production of nuclear, chemical, or biological weapons; or (iii) to any person or entity who has been prohibited from participating in U.S. export transactions by any federal agency of the U.S. government.
6. **NOTE ON JAVA SUPPORT.** The SOFTWARE may contain support for programs written in Java. Java technology is not fault tolerant and is not designed, manufactured, or intended for use or resale as online control equipment in hazardous environments requiring fail-safe performance, such as in the operation of nuclear facilities, aircraft navigation or communication systems, air traffic control, direct life support machines, or weapons systems, in which the failure of Java technology could lead directly to death, personal injury, or severe physical or environmental damage. Sun Microsystems, Inc. has contractually obligated Microsoft Corporation to make this disclaimer.
7. **PRODUCT SUPPORT.** Product support for the SOFTWARE is not provided by MS, its parent corporation, Microsoft Corporation, or their affiliates or subsidiaries. For product support, please refer to Manufacturer's support number provided in the documentation for the SYSTEM. Should you have any questions concerning this EULA, or if you desire to contact Manufacturer for any other reason, please refer to the address provided in the documentation for the SYSTEM.

FOR THE LIMITED WARRANTIES AND SPECIAL PROVISIONS PERTAINING TO YOUR PARTICULAR JURISDICTION, PLEASE REFER TO YOUR WARRANTY BOOKLET INCLUDED WITH THIS PACKAGE OR PROVIDED WITH THE SOFTWARE PRINTED MATERIALS.

Q u i c k R e f e r e n c e

Regulatory Information

All Symbol devices are designed to be compliant with rules and regulations in locations they are sold and will be labeled as required.

Any changes or modifications to Symbol Technologies equipment, not expressly approved by Symbol Technologies, could void the user's authority to operate the equipment.

Ergonomic Recommendations

Caution: In order to avoid or minimize the potential risk of ergonomic injury follow the recommendations below. Consult with your local Health & Safety Manager to ensure that you are adhering to your company's safety programs to prevent employee injury.

- Reduce or eliminate repetitive motion
- Maintain a natural position
- Reduce or eliminate excessive force
- Keep objects that are used frequently within easy reach
- Perform tasks at correct heights
- Reduce or eliminate vibration
- Reduce or eliminate direct pressure
- Provide adjustable workstations
- Provide adequate clearance
- Provide a suitable working environment
- Improve work procedures.



Laser Devices

Symbol devices using lasers comply with US 21CFR1040.10, and IEC825-1:1993, EN60825-1:1994+A11:1996. The laser classification is marked on one of the labels on the device.

Class 1 Laser devices are not considered to be hazardous when used for their intended purpose. The following statement is required to comply with US and international regulations:

Caution: Use of controls, adjustments or performance of procedures other than those specified herein may result in hazardous laser light exposure.

Class 2 laser scanners use a low power, visible light diode. As with any very bright light source, such as the sun, the user should avoid staring directly into the light beam. Momentary exposure to a Class 2 laser is not known to be harmful.

Q u i c k R e f e r e n c e

In accordance with Clause 5, IEC 825 and EN60825, the following information is provided to the user:



ENGLISH		HEBREW	
CLASS 1	CLASS 1 LASER PRODUCT		רמה 1
CLASS 2	LASER LIGHT DO NOT STARE INTO BEAM CLASS 2 LASER PRODUCT		רמה 2
			מוצר לייזר רמה 1
			אור לייזר
			אין לתבויט אל תוך הזרם
			מוצר לייזר רמה 2
DANISH / DANSK		ITALIAN / ITALIANO	
KLASSE 1	KLASSE 1 LASERPRODUKT	CLASSE 1	PRODOTTO AL LASER DI CLASSE 1
KLASSE 2	LASERLYF SE IKKE IND I STRÅLEN KLASSE 2 LASERPRODUKT	CLASSE 2	LUCE LASER NON FISSARE IL RAGGIOPRODOTTO AL LASER DI CLASSE 2
DUTCH / NEDERLANDS		NORWEGIAN / NORSK	
KLASSE 1	KLASSE-1 LASERPRODUKT	KLASSE 1	LASERPRODUKT, KLASSE 1
KLASSE 2	LASERLICHT NIET IN STRAAL STAREN KLASSE-2 LASERPRODUKT	KLASSE 2	LASERLYS IKKE STIRR INN I LYSSTRÅLEN LASERPRODUKT, KLASSE 2
FINNISH / SUOMI		PORTUGUESE / PORTUGUÉS	
LUOKKA 1	LUOKKA 1 LASERTUOTE	CLASSE 1	PRODUTO LASER DA CLASSE 1
LUOKKA 2	LASERVALO ÄLÄ TUJOTA SÄDETTÄ LUOKKA 2 LASERTUOTE	CLASSE 2	LUZ DE LASER NÃO FIXAR O RAI0 LUMINOSO PRODUTO LASER DA CLASSE 2
FRENCH / FRANÇAIS		SPANISH / ESPAÑOL	
CLASSE 1	PRODUIT LASER DE CLASSE 1	CLASE 1	PRODUCTO LASER DE LA CLASE 1
CLASSE 2	LUMIÈRE LASER NE PAS REGARDER LE RAYON FIXEMENT PRODUIT LASER DE CLASSE 2	CLASE 2	LUZ LASER NO MIRE FJAJAMENTE EL HAZ PRODUCTO LASER DE LA CLASE 2
GERMAN / DEUTCH		SWEDISH / SVENSKA	
KLASSE 1	LASERPRODUKT DER KLASSE 1	KLASS 1	LASERPRODUKT KLASS 1
KLASSE 2	LASERSTRAHLEN NICHT DIREKT IN DEN LASERSTRAHL SCHAUEN LASERPRODUKT DER KLASSE 2	KLASS 2	LASERLJUS STIRRA INTE MOT STRÅLEN LASERPRODUKT KLASS 2



FCC RF Exposure Guidelines

This device was tested for typical body-worn operations with the holster providing a minimal spacing of 2.0 cm from the body to the back of the terminal/antenna. To maintain compliance with FCC RF exposure compliance requirements, use only belt-clips, holsters, or similar accessories that maintain a 2.0 cm separation distance between the user's body and the back of the terminal, including the antenna. The use of third-party belt-clips, holsters, and similar accessories should not contain metallic components in its assembly. The use of these accessories that do not satisfy these requirements may not comply with FCC RF exposure compliance requirements, and should be avoided.

Radio Frequency Interference Requirements

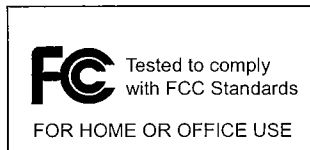

Note: This equipment has been tested and found to comply with the limits for a Class B digital device, pursuant to Part 15 of the FCC rules. These limits are designed to provide reasonable protection against harmful interference in a residential installation. This equipment generates, uses, and can radiate radio frequency energy and, if not installed

and used in accordance with the instructions, may cause harmful interference to radio communications. However there is no guarantee that interference will not occur in a particular installation. If this equipment does cause harmful interference to radio or television reception, which can be determined by turning the equipment off and on, the user is encouraged to try to correct the interference by one or more of the following measures:

- Reorient or relocate the receiving antenna
- Increase the separation between the equipment and receiver
- Connect the equipment into an outlet on a circuit different from that to which the receiver is connected
- Consult the dealer or an experienced radio/TV technician for help.

Radio Frequency Interference Requirements - Canada

This Class B digital apparatus complies with Canadian ICES-003.
Cet appareil numérique de la classe B est conforme à la norme NMB-003 du Canada.

Devices with integrated radios

This device complies with RSS 210 of Industry & Science Canada. Operation is subject to the following two conditions: (1) this device may not cause harmful interference and (2) this device must accept any interference received, including interference that may cause undesired operation.

Q u i c k R e f e r e n c e

P D T 8 0 0 0 T e r m i n a l

Q u i c k R e f e r e n c e

Warranty

Symbol Technologies, Inc. ("Symbol") manufactures its hardware products in accordance with industry-standard practices. Symbol warrants that for a period of two (2) years from date of shipment, products will be free from defects in materials and workmanship.

This warranty is provided to the original owner only and is not transferable to any third party. It shall not apply to any product (i) which has been repaired or altered unless done or approved by Symbol, (ii) which has not been maintained in accordance with any operating or handling instructions supplied by Symbol, (iii) which has been subjected to unusual physical or electrical stress, misuse, abuse, power shortage, negligence or accident or (iv) which has been used other than in accordance with the product operating and handling instructions. Preventive maintenance is the responsibility of customer and is not covered under this warranty.

Wear items and accessories having a Symbol serial number will carry a 90-day limited warranty. Non-serialized items will carry a 30-day limited warranty.

Warranty Coverage and Procedure

During the warranty period, Symbol will repair or replace defective products returned to Symbol's manufacturing plant in the US. For warranty service in North America, call the Symbol Support Center at 1-800-653-5350. International customers should contact the local Symbol office or support center. If warranty service is required, Symbol will issue a Return Material Authorization Number. Products must be shipped in the original or comparable packaging, shipping and insurance charges prepaid. Symbol will ship the repaired or replacement product freight and insurance prepaid in North America. Shipments from the US or other locations will be made F.O.B. Symbol's manufacturing plant.

Symbol will use new or refurbished parts at its discretion and will own all parts removed from repaired products. Customer will pay for the replacement product in case it does not return the replaced product to Symbol within 3 days of receipt of the replacement product. The process for return and customer's charges will be in accordance with Symbol's Exchange Policy in effect at the time of the exchange.

Customer accepts full responsibility for its software and data including the appropriate backup thereof.

Repair or replacement of a product during warranty will not extend the original warranty term.

Symbol's Customer Service organization offers an array of service plans, such as on-site, depot, or phone support, that can be implemented to meet customer's special operational requirements and are available at a substantial discount during warranty period.

General

Except for the warranties stated above, Symbol disclaims all warranties, express or implied, on products furnished hereunder, including without limitation implied warranties of merchantability and fitness for a particular purpose. The stated express warranties are in lieu of all obligations or liabilities on part of Symbol for damages, including without limitation, special, indirect, or consequential damages arising out of or in connection with the use or performance of the product. Seller's liability for damages to buyer or others resulting from the use of any product, shall in no way exceed the purchase price of said product, except in instances of injury to persons or property. Some states (or jurisdictions) do not allow the exclusion or limitation of incidental or consequential damages, so the preceding exclusion or limitation may not apply to you.

Service Information

Before you use the unit, it must be configured to operate in your facility's network and run your applications.

If you have a problem running your unit or using your equipment, contact your facility's Technical or Systems Support. If there is a problem with the equipment, they will contact the Symbol Support Center:

United States ¹	1-800-653-5350 1-631-738-2400	Canada	905-629-7226
United Kingdom	0800 328 2424	Asia/Pacific	337-6588
Australia	1-800-672-906	Austria/Österreich	1-505-5794-0
Denmark/Danmark	7020-1718	Finland/Suomi	9 5407 580
France	01-40-96-52-21	Germany/Deutschland	6074-49020
Italy/Italia	2-484441	Mexico/México	5-520-1835
Netherlands/Nederland	315-271700	Norway/Norge	+47 2232 4375
South Africa	11-8095311	Spain/España	+913244000
Sweden/Sverige	84452900		
Latin America Sales Support	1-800-347-0178 Inside US +1-561-483-1275 Outside US		
Europe/Mid-East Distributor Operations	Contact local distributor or call +44 118 945 7360		

¹Customer support is available 24 hours a day, 7 days a week.

For the latest version of this guide go to:<http://www.symbol.com/manuals>.



72-55780-01
Revision A — April 2002

Symbol Technologies, Inc. One Symbol Plaza Holtsville, NY 11742-1300