

# Quick Start



Need more help? Go to [Apps > Device Help](#)



AT&T Tint8

# AT&T Ready2Go

Set up your device quickly and easily by using Ready2Go to help you:

- Set up email
- Sync your contacts and calendar
- Connect to Wi-Fi
- Sign up for AT&T Locker

You can use Ready2Go when you first activate your tablet, or open it later from the App tray. The wizard will guide you through the setup process.



## AT&T Ready2Go

Easy setup of your device  
including Wi-Fi, contacts, email  
and other accounts!

By tapping "get started" below you confirm that you  
have read and agree to the [Terms of Service](#) and  
[Privacy Policy](#).

not now



get started

Essex



# Home Screen

## Add Apps

- ① Touch  from home screen to access the apps interface.
- ② Touch and hold an icon, drag it to the right place you want.
- ③ Touch the Play Store icon  to get more apps.

## Add Widgets and change wallpapers

- ① Touch and hold an empty area in the home screen.
- ② Tap **WIDGETS** or **WALLPAPERS**.
  - **WIDGETS**: Add widgets for a quick view of your calendar, maps, and more.
  - **WALLPAPERS**: Change your tablet's wallpaper.

## Remove apps, widgets

- ① Touch and hold the item to be removed.
- ② Drag the item up to **Remove**.
- ③ Release the item after **Remove** turns red.

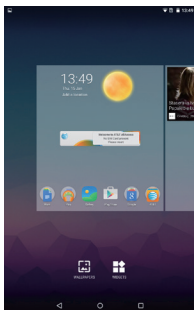
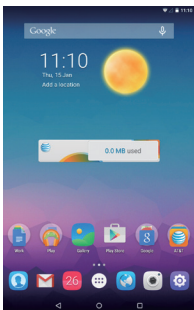

# AT&T AllAccess

If your AT&T service was activated at the time of purchase, you will automatically connect to the mobile network.

## To activate service:

- ① From the home screen, tap **Activate** on the AT&T AllAccess widget.



- ② Follow the on-screen steps to activate a data plan.

Once service is activated, the AT&T AllAccess widget displays data used while you're connected to the mobile network.

## To monitor data usage:

- View plan and data usage details\*
- Enable mobile hotspot to share your Internet connection\*\*
- View free AT&T Wi-Fi Hot Spots in your vicinity

\* Actual billed usage can be higher than estimated data usage displayed on the usage meter. For example, actual billed usage may be higher when: part of a shared data plan such as Mobile Share; multiple users with different login credentials using the same device; travelling internationally or outside AT&T's network; using the SIM card with another device. Unlimited Wi-Fi usage on AT&T's entire national Wi-Fi network is included at no additional charge with a qualifying data plan. Access includes AT&T Wi-Fi Basic. Restrictions apply. See [www.attwifi.com](http://www.attwifi.com) for details. **The name "attwifi" will appear in the Wi-Fi network list when available.**

\*\* **Req's Mobile Share Value or a min. DataPro 5GB plan.** Devices connected to a Mobile Hotspot use data from your plan. Overage charges apply if exceed monthly data allowance. Number of devices you can connect depends on your device. Performance varies based on number of devices connected and other factors. If you do not use a password, others will be able to use your Mobile Hotspot. Visit a store or [att.com](http://att.com) to learn more.

# Notification and Quick settings

The Notifications panel provides quick access to alerts including new messages, e-mails and software updates.

Swipe down from the top of the screen to open notification panel; swipe up to close notification panel.

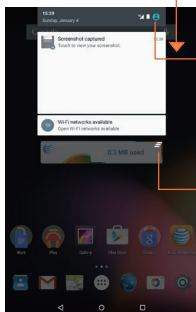

Touch to open quick setting panel; touch again to open user panel for choosing/adding an account.

Touch to clear all event-based notifications (other ongoing notifications will remain)

Touch to access **Settings**.

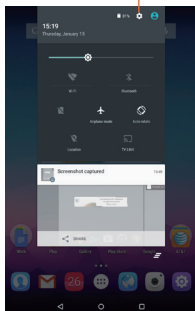

## Install micro SIM/SD cards

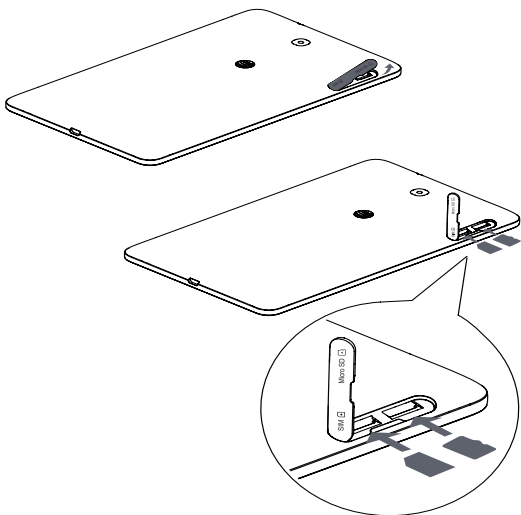

- Open the SIM/micro SD card compartment.
- Insert the SIM card into the SIM slot with the gold-plated contacts facing upward. Insert the micro SD card into the micro SD card slot.
- Push them all the way until they are firmly in place.
- Close the compartment.

# AT&T Services



**AT&T Ready2Go:** Set up your device quickly and easily.



**myAT&T:** Track your usage, review and pay your bill, and update your data plan services.



**AT&T Locker™:** Store, sync, and share photos, videos, and documents in one place.



**AT&T Mail:** Get 1TB of free space and manage your att.net with the AT&T Mail app.



**Keeper™:** Manage and secure your passwords and other private information.



**DeviceHelp:** View helpful videos and tutorials.



**AT&T FamilyMap:** Get peace of mind by being able to conveniently locate a family member's wireless device on a map from your mobile device or PC.



**YP:** Quickly search nearby for a business, by type or name or choose from popular categories like restaurants, banks and gas stations.

# Find More Information

## *On your tablet*

- Tutorials and videos: **Apps > Device Help**
- Access your account: **Apps > myAT&T**

## *On the web*

- Tutorials and videos: **att.com/DeviceHowTo**
- Manage your wireless account, including suspending service if your tablet is stolen: **att.com/MyATT**

## *Give us a Call*

- **1.800.331.0500**
- **611** from any AT&T wireless phone

## *Accessories*

- **att.com/Wireless Accessories**
- Visit your AT&T store

Package Contents: Device, SIM, charger and cable

**Note:** Use only the included charger and cable with your device.

4G LTE not available in all areas. Learn more at [att.com/network](http://att.com/network). Mobile broadband access requires a DataConnect Plan for Tablets. For information on DataConnect Plans for Tablets see (<http://www.wireless.att.com/learn/articles-resources/wireless-terms.jsp>) and for information on **Prepaid Session Based DataConnect Pass Plans** see [att.com/buyasession](http://att.com/buyasession). © 2015 AT&T Intellectual Property. All rights reserved. AT&T, the AT&T logo and all other AT&T marks contained herein are trademarks of AT&T Intellectual Property. All other marks contained herein are the property of their respective owners.