

alcatel 3x

QUICK START GUIDE

SAVE
PAPER
SAVE
TREES

PLEASE CONSIDER THE
ENVIRONMENT BEFORE PRINTING



English - CJB1L81ALAAA
Printed in China

5058J

Your Mobile

Keys and connectors

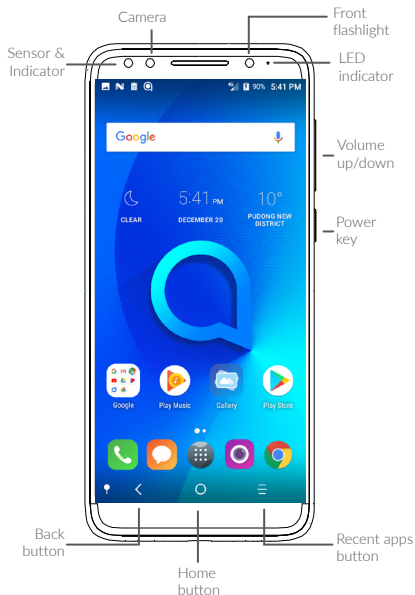

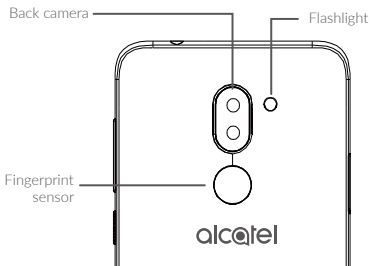

Navigation bar

- ① Touch to hide navigation bar.
- ② Swipe up to display navigation bar.

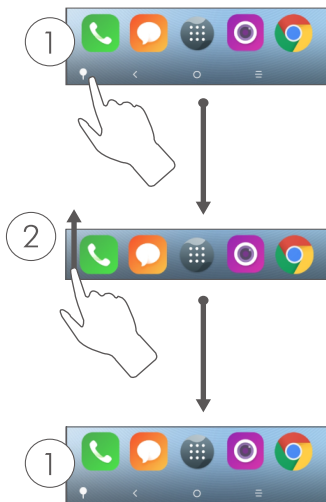

Getting started

- ① Charge the battery

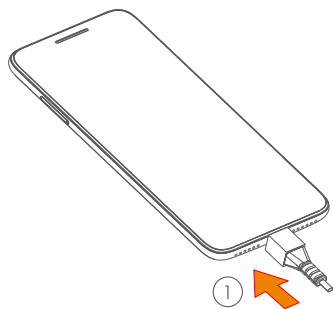

- ② Insert the pin into the hole and pull out the tray
- ③ Insert or remove your SIM card or microSD card

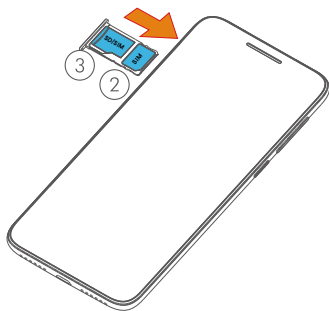

Home screen

You can bring all of the items (applications, shortcuts, folders, and widgets) that you use most frequently to your Home screen for quick access.

Touching the **Home** button always takes you back to the main Home screen.

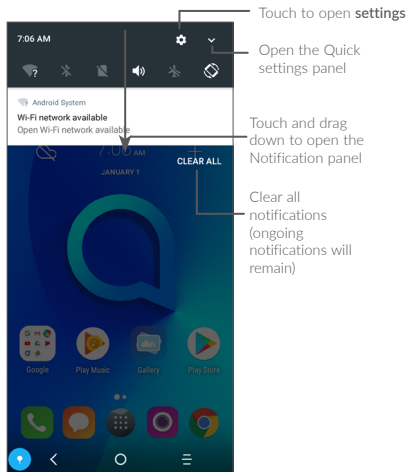

Phone call



Making a call

Enter the desired number from the keyboard and touch  to make a call.

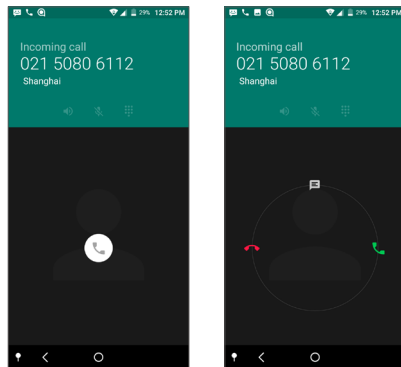
Answering a call



When you receive a call:

- Slide the  icon right to answer;
- Slide the  icon left to reject;

- Slide the  icon upwards to reject the call by sending a preset message.

Contacts

You can view and create contacts on your phone and synchronize these with your Gmail contacts or other applications on the web or on your phone.

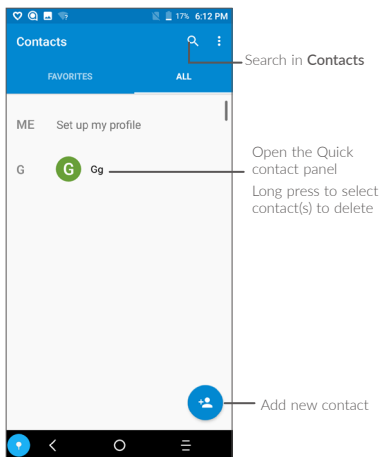

8

Messaging

You can create, edit, and receive SMS and MMS.

An SMS will be converted to MMS automatically when media files (image, video, audio, slides, etc.) are attached or subject or email addresses are added.

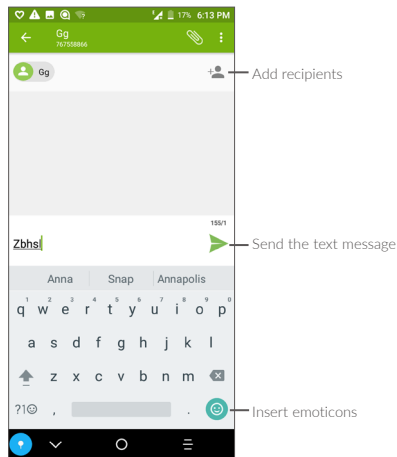

9

Email

The first time you set up your phone, you can select to use an existing Email account or to create a new one.

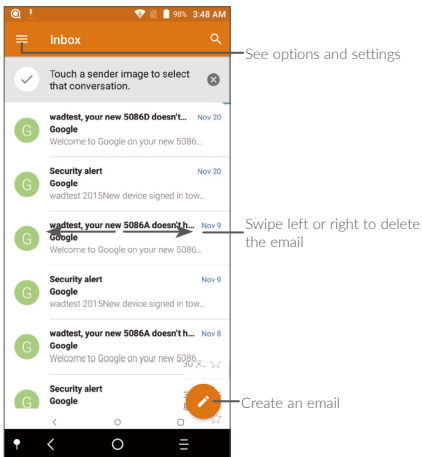

Help

To get help:

- View user manual and FAQ
Visit <http://www.alcatelmobile.com>
- Update your phone's software
Go to **Settings > About phone > System updates**
- Back up your personal data
Go to **Settings > Backup & reset > Back up my data** and turn it on.
- Reset your phone
Go to **Settings > Backup & reset > Factory data reset**, and then touch **RESET PHONE**.

To get more info, you can access the **Support Center** application.