

Quick Start Guide

LIFE CONNECT

Home Bridge



CJB1H1002AAA

TCL

What's In The Box?



LIFECONNECT x 1



Charger x 1



USB cable x 1 (1 meter)



Quick start guide x 1

Specification

Product name	LIFECONNECT
Model name	HB01
Operating frequency	2.4 GHz
Transmitted power	<ul style="list-style-type: none">• Zigbee: 8 ± 2dbm• Wi-Fi: 17 ± 2dbm (Mode: 11b, Rate: 1Mbps)

Getting to Know Your LIFECONNECT

Your LIFECONNECT is the control centre of your smart home. It allows you to monitor and remotely control your home from anywhere, using a range of connected smart devices. You can also create customized scenarios using the LIFE App.

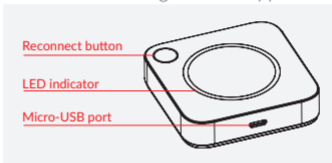

Reconnect button	<ul style="list-style-type: none">• Short press: Turn on LED• Long press: 5s to reconnect to Wi-Fi
LED indicator	<ul style="list-style-type: none">• Flashing Blue: Configuring Wi-Fi• Constant Blue: Wi-Fi connected• Flashing Red: Wi-Fi disconnected• Constant Purple: Zigbee Radio on
Micro USB port	For charging

Your LIFECONNECT: Quick Set Up Guide

1. Download LIFE Application

Download the App using either of the QR codes shown below. Both QR codes are also printed on the box. Alternatively, you can also search for “LIFE” in the Apple Store or in Google Play Store.



Apple Store



Google Play

2. Connecting Devices

- 1) Connect your LIFECONNECT to the power supply as shown in the following figure. LIFECONNECT can only be added to the App when it is powered on with the LED flashing blue.

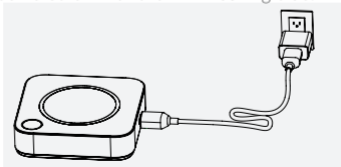

- 2) Ensure your smartphone and your LIFECONNECT are in the same Wi-Fi zone.
- 3) Open the LIFE App and create an account.
- 4) Log in your account, select “+” in the LIFE App, and follow the on-screen instructions to continue.
- 5) If the connection fails, long press the Reconnect button until the blue LED turns on, then retry.

Note:

- Keep some distance between your LIFECONNECT and router. 2~6 metres is ideal.
- This device does not support 5 GHz Wi-Fi.

Resetting Your LIFECONNECT

Open the back cover of your LIFECONNECT, and press the “R” button to reset it.

Warning: Resetting the LIFECONNECT will disconnect all previously connected devices. You will need to reconnect them later.

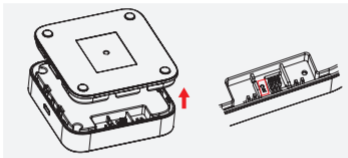

FAQ

1. Q: Does the LIFECONNECT have a battery inside?

A: No, the LIFECONNECT does not have a battery inside, but it supports a 1A/5V or 2A/5V charger power supply. It also supports a 1A~2A/5V power bank to power supply via the USB cable.

2. Q: What's the connectivity capacity of my LIFECONNECT? How wide is the coverage?

A: For Zigbee devices, connectivity of over 60,000 devices is theoretically possible. The coverage range is up to 100 metres (without obstructions).

3. Q: Does the LIFECONNECT work via a SIM card or only through the router's Wi-Fi?

A: LIFECONNECT only works with Wi-Fi from a router. No SIM or internet cable (RJ45) connections are supported.

4. Q: Why is my LIFECONNECT offline again?

A: Make sure your smartphone and your LIFECONNECT are both connected to the same Wi-Fi network. If the Wi-Fi network password has been changed, reconnect the LIFECONNECT to your smartphone as follows:

- 1) Long press the Reconnect button for about 5 seconds until the blue LED turns on.
- 2) Open the LIFE App on your smartphone and go to LIFECONNECT.
- 3) Touch "Switch Wi-Fi" and follow the setup process.

5. **Q: Does my LIFECONNECT support any 3rd party devices?**

A: LIFECONNECT works with Zigbee HA1.2 standard, so any products that support Zigbee HA1.2 and have passed HA1.2 certification can usually be connected to your LIFECONNECT.

Safety and Use

Electronic Devices

Turn off your device near high-precision electronic devices. The wireless device may affect the performance of these devices. Such devices include hearing aids, pacemakers, fire alarm systems, automatic gates, and other automatic devices. If you are using an electronic medical device, consult the device manufacturer to confirm whether radio waves affect its operation.

Hospitals

Pay attention to the following points in hospitals or health care facilities:

- Do not take your wireless device into the operating room, intensive care unit, or coronary care unit.
- Do not use your wireless device at places for medical treatment where wireless device use is prohibited.

Storage Environment

- Do not place magnetic storage media such as magnetic cards and floppy disks near the wireless device. Radiation from the wireless device may erase the information stored on them.
- Do not put your wireless device and other accessories in containers with strong magnetic fields, such as an induction cooker or a

microwave oven. Otherwise, circuit failure, fire, or explosion may occur.

- Do not leave your wireless device in a very hot or cold place. Otherwise, malfunction of the product, fire, or explosion may occur.
- Do not subject your wireless device to serious collision or shock. Otherwise, wireless device malfunction, overheating, fire, or explosion may occur.

Child Safety

- Put your wireless device in places beyond the reach of children. Do not allow children to use the wireless device without guidance.
- Do not allow children to put the device in their mouths.
- Do not allow children to touch small fittings. Otherwise, suffocation or choking could occur if they are swallowed.

Operating Environment

- The wireless device is not water-resistant. Keep it dry. Protect the wireless device from water or vapour. Do not touch the wireless device with a wet hand. Otherwise, short-circuit, malfunction of the product or electric shock may occur.
- Do not use the wireless device in dusty, damp and dirty places

or within magnetic fields. Otherwise, malfunction of the circuitry may occur.

- The wireless device may interfere with nearby TV sets, radios and PCs.
- In accordance with international standards for radio frequency and radiation, use wireless device accessories approved by the manufacturer only.

Traffic Safety

When driving, do not use the wireless device.

- When switched on, this device emits electromagnetic waves that can interfere with the vehicle's electronic systems such as ABS anti-lock brakes or airbags. To ensure that there is no problem, do not place this device on top of the dashboard or within an airbag deployment area.
- Check with your car dealer or the car manufacturer to make sure that the dashboard is adequately shielded from this device RF energy.

Conditions of Use

- Indoor use only.
- Do not allow your device to be exposed to adverse weather or environmental conditions (moisture, humidity, rain, infiltration of

liquids, dust, sea air, etc.).

- When this device is switched on, it should be kept at least 20 cm from the body.
- When this device is switched on, it should be kept at least 15 cm from any medical device such as a pacemaker, a hearing aid or insulin pump, etc.
- When replacing the cover, please note that this device may contain substances that could create an allergic reaction.
- Do not paint it.
- The manufacturer's recommended operating temperature range is 0°C to +45°C.
- Always handle this device with care and keep it in a clean and dust-free place.
- Clean this device with a dry cloth only.
- Do not attempt to disassemble or repair this device or its accessories.
- Do not drop, throw or bend this device.
- Do not let children use this device and/or play with the this device and accessories without supervision.

Certification



This symbol on the device means that these products must be taken to collection points at the end of their life:

- Municipal waste disposal centres with specific bins for these items of equipment.

- Collection bins at points of sale.

They will then be recycled, preventing substances being disposed of in the environment and allowing their components to be reused

In European Union countries:

These collection points are accessible free of charge.

All products with this sign must be brought to these collection points.

In non European Union jurisdictions:

Items of equipment with this symbol are not to be thrown into ordinary bins if your jurisdiction or your region has suitable recycling and collection facilities; instead they are to be taken to collection points for them to be recycled.

CHARGERS

Mains powered chargers will operate within the temperature range of: 0°C (32°F) to 40°C (104°F).

The chargers designed for your device meet the standard for safety of information technology equipment and office equipment use. They are also compliant with the ecodesign directive 2009/125/EC. Due to different applicable electrical specifications, a charger you purchased in one jurisdiction may not work in another jurisdiction. They should be used for this purpose only.

Characteristics of power supply (depending on the country):

Charger: Input: 100-240 V, 50/60 Hz, 500 mA

Output: 5V, 2A

Radio Waves

THIS DEVICE MEETS THE GOVERNMENT'S REQUIREMENTS FOR EXPOSURE TO RADIO WAVES.

Your device is a radio transmitter and receiver. It is designed and manufactured not to exceed the emission limits for exposure to radio-frequency (RF) energy. These limits are part of comprehensive guidelines and establish permitted levels of RF energy for the general population. The guidelines are based on standards that were developed by independent scientific organizations through periodic and thorough evaluation of scientific studies. These guidelines include a substantial safety margin designed to ensure the safety of all persons, regardless of age and health.

The World Health Organization (WHO) considers that present scientific information does not indicate the need for any special precautions for use of wireless devices. If individuals are concerned, they might choose to limit their own or their children's RF exposure by limiting the length of use to keep device away from the head and body. Additional WHO information about electromagnetic fields and public health are available on the following website: <http://www.who.int/peh-emf>.

Note: This equipment has been tested and found to comply with the limits for a Class B digital device pursuant to part 15 of the FCC Rules. These limits are designed to provide reasonable protection against harmful interference in a residential installation. This equipment generates, uses and can radiate radio frequency energy and, if not installed and used in accordance with the instructions, may cause harmful interference to radio communications. However, there is no guarantee that interference to radio or television reception, which can be determined by turning the equipment off and on, the user is encouraged to try to correct the interference by one or more of the following measures:

- Reorient or relocate the receiving antenna;
- Increase the separation between the equipment and receiver;
- Connect the equipment into an outlet on a circuit different from that to which the receiver is connected;

- Consult the dealer or an experienced radio/ TV technician for help. Changes or modifications not expressly approved by the party responsible for compliance could void the user's authority to operate the equipment.

For the receiver devices associated with the operation of a licensed radio service (e.g. FM broadcast), they bear the following statement: This device complies with Part 15 of the FCC Rules and Innovation, Science and Economic Development Canada licence-exempt RSS standard(s).

Operation is subject to the following two conditions:

- This device may not cause harmful interference;
- This device must accept any interference received, including interference that may cause undesired operation.

Your device is equipped with a built-in antenna. For optimal operation, you should avoid touching it or degrading it.

Please note by using the device some of your personal data may be shared with the main device. It is under your own responsibility to protect your own personal data, not to share with it with any unauthorized devices or third party devices connected to yours. For products with Wi-Fi features, only connect to trusted Wi-Fi networks. These precautions will help prevent unauthorized access to your device. Choose your apps and updates carefully, and install from trusted sources only. Note that any data shared with TCL

Communication Ltd. is stored in accordance with applicable data protection legislation. For these purposes TCL Communication Ltd. implements and maintains appropriate technical and organizational measures to protect all personal data, for example against unauthorized or unlawful processing and accidental loss or destruction of or damage to such personal data whereby the measures shall provide a level of security that is appropriate having regard to

- The technical possibilities available;
- The costs for implementing the measures;
- The risks involved with the processing of the personal data, and;
- The sensitivity of the personal data processed.

You can access, review and edit your personal information at any time by logging into your user account, visiting your user profile or by contacting us directly. Should you require us to edit or delete your personal data, we may ask you to provide us with evidence of your identity before we can act on your request.

Innovation, Science and Economic Development Canada (ISED)
Notice

This device complies with Innovation, Science and Economic Development Canada license-exempt RSS standard(s). Operation is subject to the following two conditions:

- This device may not cause interference, and;

- This device must accept any interference, including interference that may cause undesired operation of the device.

This Class B digital apparatus complies with Canadian ICES-003.
Innovation, Science and Economic Development Canada (ISED)
Radiation Exposure Statement

Lisense

FCC ID: 2ACCJBC01

Warranty

The device is warranted against any deviation from technical specifications for a period of twelve (12)⁽¹⁾ months from the date specified on your original invoice.

Batteries and accessories sold with your device are also warranted against any defect which may occur during the first six (6) months from the date of purchase as shown on your original invoice. Under the terms of this warranty, you must immediately inform your vendor in case of a conformity defect on this device, and present a proof of purchase.

The vendor or repair centre will decide whether to replace or repair this device, as appropriate.

⁽¹⁾ The warranty period may vary depending on your country.

Repaired or replaced versions of this device are warranted for ONE (1) month unless there are statutory provisions to the contrary.

This warranty shall not apply to damage or defects to this device due to:

- 1) Not following the instructions for use or installation.
- 2) Not being compliant with technical and safety standards applicable in the geographical area where this device is used.
- 3) Improper maintenance of sources of energy, and of the overall electric installation.
- 4) Accidents or consequences of theft of the vehicle in which this device is transported, acts of vandalism, lightning, fire, humidity, infiltration of liquids, inclement weather.
- 5) Connecting to or integrating into this device any equipment not supplied or not recommended by the manufacturer.
- 6) Any servicing, modification or repair performed by individuals not authorised by the manufacturer, the vendor or the approved maintenance centre.
- 7) Use of this device for a purpose other than that for which it was designed.
- 8) Malfunctions caused by external causes (e.g., radio interference from other equipment, power voltage fluctuations).

9) Faulty connections resulting from unsatisfactory radio transmission or caused by the absence of radio relay coverage.

Warranty is also excluded for this device on which markings or serial numbers have been removed or altered.

This device is also warranted against hidden defects (defects inherent in the design, manufacture, etc.).

There are no other express warranties other than this printed limited warranty, expressed or implied, of any nature whatsoever.

In no event shall the manufacturer be liable for incidental or consequential damages of any nature whatsoever, including but not limited to trading loss, commercial loss, to the full extent those damages can be disclaimed by law. Some countries/states do not allow the exclusion or limitation of incidental or consequential damages, or limitation of the duration of implied warranties, so the preceding limitations or exclusions may not apply to you.

All rights reserved © 2017 TCL Communication LTD.

Address: Room 1910-12A, Tower 3, China HK City, 33 Canton Road, Tsimshatsui, Kowloon, Hong Kong