

Quick Start Guide

LIFE
CAM
IP Camera



CJB1HC004AAA

TCL

What's In The Box?



LIFECAM x 1

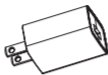

Charger x 1



Screw x 2



USB cable x 1 (1.8 meter)



Quick start guide x 1



Wall plug x 2



Metal mounting bracket

Specification

Product name	LIFECAM
Model name	IC01
Operating frequency	2.4 GHz
Transmitted power	17±2dbm (Mode: 11b, Rate: 1Mbps)

Getting to Know Your LIFECAM

The LIFECAM is a Wi-Fi IP camera which provides remote viewing and broadcasting features when used in combination with the LIFE App.

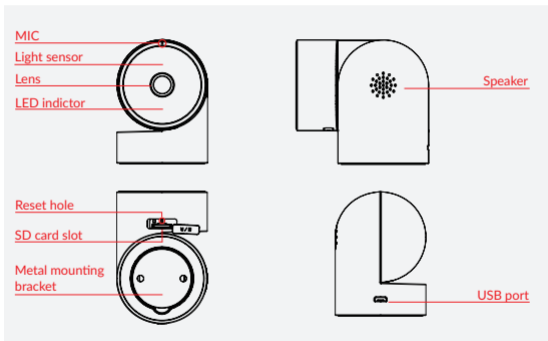

Note:

You can adjust your LIFECAM angle by manually rotating the camera head.

Your LIFECAM: Quick Setup Guide

1. Download the LIFE Application

Download the App using either of the QR codes shown below. Both QR codes are also printed on the box. Alternatively, you can also search for "LIFE" in the Apple Store or in Google Play Store.



Apple Store



Google Play

2. Installing a Micro-SD Card

Insert the Micro-SD card according to the illustration.

Note: In order to enable video recording, you will first need to insert a Micro-SD card. The system will automatically save the video in the SD card when the alarm is triggered.

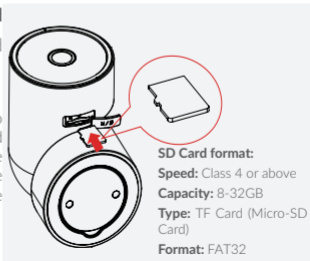

3. Connecting Your LIFECAM

- 1) Ensure that your LIFECAM is located in your Wi-Fi signal coverage zone. For optimal performance, the Wi-Fi uploading bandwidth should be at least 0.6 Mbps.
- 2) Ensure that your smartphone and your LIFECAM are in the same Wi-Fi signal coverage zone.

Note: This device does not support 5GHz Wi-Fi. Please connect to a 2.4GHz Wi-Fi router.

- 3) Connect your LIFECAM to the power supply as shown in the following figure.

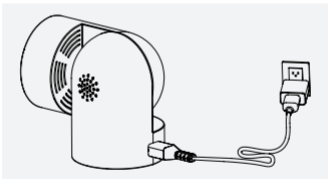

Note: When the LIFECAM is connected to the power supply, the LED indicator light will turn red, and it will take about 20 seconds to boot up.

- 4) Open the LIFE App, create an account and log in.

- 5) When you hear "Ready to configure LIFECAM" from the audio prompt and the LED flashes red, select "+" in the LIFE App, and follow the on-screen instructions to add and configure your LIFECAM. Once your LIFECAM connects to the Wi-Fi network successfully, the LED will turn off.

Note: Please reset your LIFECAM If the LED continues to flash, or you hear "Sorry, adding LIFECAM failed, please try again" from the audio prompt.

Resetting Your LIFECAM

If you want to change the LIFECAM Wi-Fi settings, or your LIFECAM connection fails, please long press the reset button using the reset pin for 5 seconds. An audio guide will notify you if the reset has succeeded.

Note: Please add your LIFECAM again in the App after you reset it.

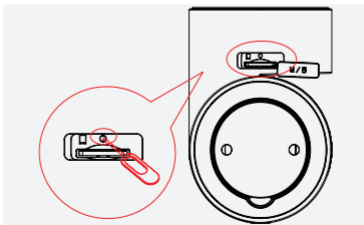

Installing Your LIFECAM

You can place your LIFECAM on a desk or install it on a wall.

Note:

- Please place your LIFECAM in an area with an unobstructed view.
- Please do not place your LIFECAM behind furniture or near a microwave oven.
- Please do not place your LIFECAM in areas prone to high humidity or where condensation might form.

Desktop Installation

Place your LIFECAM on a desk in an area which is clean and dry, with an unobstructed view, and which is beyond the reach of children.

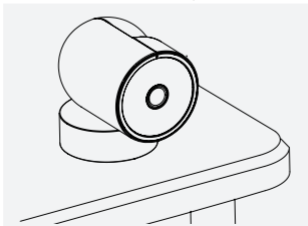

Wall Installation

1. Find a suitable place to install your LIFECAM.
2. Separate the metal mounting bracket from the base of your LIFECAM.
3. Use the metal mounting bracket with its two holes as a template to mark the mounting position of your LIFECAM on your wall (the distance between the two holes is 28 mm). Drill two holes into the wall.
4. Insert the wall plugs into the holes.
5. Fix the metal mounting bracket onto the wall using the screws.
6. Reattach your LIFECAM to the metal mounting bracket which is now fixed to the wall.

Note:

- Don't install your LIFECAM outdoors.
- Avoid direct or strong sunlight.
- Avoid installing your LIFECAM near water vapour or in areas of high humidity.
- Please don't install your LIFECAM in an unstable or vibration prone area.
- Please don't place your LIFECAM vertical to frequently moving objects, such as curtains and windows.

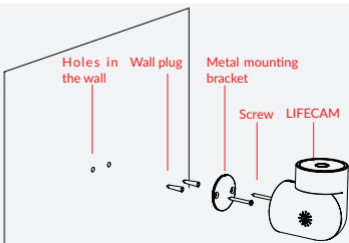

FAQ

1. **Q: Which OS version is compatible with the App?**

A: iOS 7.0 and above versions, Android 4.0 and above versions.

2. **Q: What should I do if I am unable to add my LIFECAM?**

A: 1) Use the reset pin to reset your LIFECAM. Wait until you hear the audio guide and then try to add it again.

2) Please check that you have entered the correct Wi-Fi SSID and password, then try again.

3) Please check if your router is appearing in your Wi-Fi black list or the option to prevent loitering on your network has been enabled.

4) Please check if your Wi-Fi router has been set to the 5 GHz frequency band. Currently, LIFECAM does not support the 5 GHz Wi-Fi frequency, so please set the Wi-Fi router to the 2.4 GHz band.

5) Please check if your smartphone permission settings are preventing the LIFE App from using Wi-Fi and GPS.

6) Please check if your Wi-Fi router has been set to bridge mode. Bridge mode can cause the Wi-Fi signal to become unstable so

we do not recommend that you connect your LIFECAM to your Wi-Fi this way.

3. Q: What should I do when my LIFECAM is offline?

A: 1) Please check your LIFECAM's power supply and Wi-Fi connection.

2) Reconnect and reset your LIFECAM, and add it again in the App.

4. Q: Does my LIFECAM only work with the LIFE App within the same WLAN?

A: No. If your LIFECAM and LIFE app can connect to the internet, there are no limits to the distance which can be between them.

5. Q: Can my LIFECAM work from a battery?

A: No, the LIFECAM does not contain a battery, it supports a 1A/5V or 2A/5V charger power supply.

6. Q: Are the materials used in the product harmful to pets or children?

A: All materials have passed the related safety testing for children so as to ensure their safety.

7. **Q: Is it normal to hear a “snip-snap” sound inside the camera when it switches to night mode?**

A: Yes, it's normal. LIFECAM will switch its internal IR-CUT filter on or off when it changes between day and night modes.

8. **Q: Is it normal for the housing of my LIFECAM to feel warm?**

A: Yes. It's normal when the LIFECAM switches to night mode.

9. **Q: Can the camera still record, even when it is offline?**

A: The camera can still record to the local SD card, even when it is offline. However, when you want to view the recorded file, your camera and smartphone will need to be connected via the internet.

10. **Q: How many days of recording can be stored on my SD Card?**

A: 8GB: 4days 16GB: 8days 32GB: 16days

11. **Q: If the SD Card storage is full, will it stop recording?**

A: No. It will continue by overwriting the oldest file on the card.

12. Q: What do I do if my SD card can't be read?

- A:** 1) Please check that you have inserted the SD card correctly.
2) Please make sure the SD card format is FAT32 or EXFAT.
3) Sometimes, restarting the camera will solve this issue.
4) Please try to reinsert the SD card.

13. Q: How many accounts can my LIFECAM be linked with?

A: In order to protect the user's account security, only one LIFECAM can be linked with one account. That account holder will then be the administrator. Other users can be invited only by the administrator. They will have the same rights as the administrator except they will not be able to manage other users.

14. Q: How can I be sure my LIFECAM is securely protected?

- A:** 1) Your LIFECAM, app and cloud are secured with two-way authentication interactions to protect user identification.
2) Video streaming uses a private encryption protocol for transfer.
3) User identification and video stream identification are kept separate so that security is twice as strong.

Safety and Use

Electronic Devices

Turn off your device near high-precision electronic devices. The wireless device may affect the performance of these devices. Such devices include hearing aids, pacemakers, fire alarm systems, automatic gates, and other automatic devices. If you are using an electronic medical device, consult the device manufacturer to confirm whether radio waves affect its operation.

Hospitals

Pay attention to the following points in hospitals or health care facilities:

- Do not take your wireless device into the operating room, intensive care unit, or coronary care unit.
- Do not use your wireless device at places for medical treatment where wireless device use is prohibited.

Storage Environment

- Do not place magnetic storage media such as magnetic cards and floppy disks near the wireless device. Radiation from the wireless device may erase the information stored on them.
- Do not put your wireless device and other accessories in contain-

ers with strong magnetic fields, such as an induction cooker or a microwave oven. Otherwise, circuit failure, fire, or explosion may occur.

- Do not leave your wireless device in a very hot or cold place. Otherwise, malfunction of the product, fire, or explosion may occur.
- Do not subject your wireless device to serious collision or shock. Otherwise, wireless device malfunction, overheating, fire, or explosion may occur.

Child Safety

- Put your wireless device in places beyond the reach of children. Do not allow children to use the wireless device without guidance.
- Do not allow children to put the device in their mouths.
- Do not allow children to touch small fittings. Otherwise, suffocation or choking could occur if they are swallowed.

Operating Environment

- The wireless device is not water-resistant. Keep it dry. Protect the wireless device from water or vapour. Do not touch the wireless device with a wet hand. Otherwise, short-circuit, malfunction of the product or electric shock may occur.

- Do not use the wireless device in dusty, damp and dirty places or within magnetic fields. Otherwise, malfunction of the circuitry may occur.
- The wireless device may interfere with nearby TV sets, radios and PCs.
- In accordance with international standards for radio frequency and radiation, use wireless device accessories approved by the manufacturer only.

Traffic Safety

When driving, do not use the wireless device.

- When switched on, this device emits electromagnetic waves that can interfere with the vehicle's electronic systems such as ABS anti-lock brakes or airbags. To ensure that there is no problem, do not place this device on top of the dashboard or within an airbag deployment area.
- Check with your car dealer or the car manufacturer to make sure that the dashboard is adequately shielded from this device RF energy.

Conditions of Use

- Indoor use only.
- Do not allow your device to be exposed to adverse weather or

environmental conditions (moisture, humidity, rain, infiltration of liquids, dust, sea air, etc.).

- When this device is switched on, it should be kept at least 20 cm from the body.
- When this device is switched on, it should be kept at least 15 cm from any medical device such as a pacemaker, a hearing aid or insulin pump, etc.
- When replacing the cover, please note that this device may contain substances that could create an allergic reaction.
- Do not paint it.
- The manufacturer's recommended operating temperature range is 0°C to +45°C.
- Always handle this device with care and keep it in a clean and dust-free place.
- Clean this device with a dry cloth only.
- Do not attempt to disassemble or repair this device or its accessories.
- Do not drop, throw or bend this device.
- Do not let children use this device and/or play with the this device and accessories without supervision.

Certification



This symbol on the device means that these products must be taken to collection points at the end of their life:

- Municipal waste disposal centres with specific bins for these items of equipment.
- Collection bins at points of sale.

They will then be recycled, preventing substances being disposed of in the environment and allowing their components to be reused.

In European Union countries:

These collection points are accessible free of charge.

All products with this sign must be brought to these collection points.

In non European Union jurisdictions:

Items of equipment with this symbol are not to be thrown into ordinary bins if your jurisdiction or your region has suitable recycling and collection facilities; instead they are to be taken to collection points for them to be recycled.

CHARGERS

Mains powered chargers will operate within the temperature range of: 0°C (32°F) to 40°C (104°F).

The chargers designed for your device meet the standard for safety of information technology equipment and office equipment use. They are also compliant with the ecodesign directive 2009/125/EC. Due to different applicable electrical specifications, a charger you purchased in one jurisdiction may not work in another jurisdiction. They should be used for this purpose only.

Characteristics of power supply (depending on the country):

Charger: Input: 100-240 V, 50/60 Hz, 500 mA

Output: 5V, 2A

Radio Waves

THIS DEVICE MEETS THE GOVERNMENT'S REQUIREMENTS FOR EXPOSURE TO RADIO WAVES.

Your device is a radio transmitter and receiver. It is designed and manufactured not to exceed the emission limits for exposure to radio-frequency (RF) energy. These limits are part of comprehensive guidelines and establish permitted levels of RF energy for the general population. The guidelines are based on standards that were developed by independent scientific organizations through periodic and thorough evaluation of scientific studies. These guidelines include a substantial safety margin designed to ensure the safety of all persons, regardless of age and health.

The World Health Organization (WHO) considers that present scientific information does not indicate the need for any special precautions for use of wireless devices. If individuals are concerned, they might choose to limit their own or their children's RF exposure by limiting the length of use to keep device away from the head and body. Additional WHO information about electromagnetic fields and public health are available on the following website: <http://www.who.int/peh-emf>.

Note: This equipment has been tested and found to comply with the limits for a Class B digital device pursuant to part 15 of the FCC Rules. These limits are designed to provide reasonable protection against harmful interference in a residential installation. This equipment generates, uses and can radiate radio frequency energy and, if not installed and used in accordance with the instructions, may cause harmful interference to radio communications. However, there is no guarantee that interference to radio or television reception, which can be determined by turning the equipment off and on, the user is encouraged to try to correct the interference by one or more of the following measures:

- Reorient or relocate the receiving antenna;
- Increase the separation between the equipment and receiver;
- Connect the equipment into an outlet on a circuit different from that to which the receiver is connected;

- Consult the dealer or an experienced radio/ TV technician for help. Changes or modifications not expressly approved by the party responsible for compliance could void the user's authority to operate the equipment.

For the receiver devices associated with the operation of a licensed radio service (e.g. FM broadcast), they bear the following statement: This device complies with Part 15 of the FCC Rules and Innovation, Science and Economic Development Canada licence-exempt RSS standard(s).

Operation is subject to the following two conditions:

- This device may not cause harmful interference;
- This device must accept any interference received, including interference that may cause undesired operation.

Your device is equipped with a built-in antenna. For optimal operation, you should avoid touching it or degrading it.

Please note by using the device some of your personal data may be shared with the main device. It is under your own responsibility to protect your own personal data, not to share with it with any unauthorized devices or third party devices connected to yours. For products with Wi-Fi features, only connect to trusted Wi-Fi networks. These precautions will help prevent unauthorized access to your device. Your product can store personal information in various locations including a memory card, and built-in memory. Be

sure to remove or clear all personal information before you recycle, return, or give away your product. Choose your apps and updates carefully, and install from trusted sources only. Note that any data shared with TCL Communication Ltd. is stored in accordance with applicable data protection legislation. For these purposes TCL Communication Ltd. implements and maintains appropriate technical and organizational measures to protect all personal data, for example against unauthorized or unlawful processing and accidental loss or destruction of or damage to such personal data whereby the measures shall provide a level of security that is appropriate having regard to

- The technical possibilities available;
- The costs for implementing the measures;
- The risks involved with the processing of the personal data, and;
- The sensitivity of the personal data processed.

You can access, review and edit your personal information at any time by logging into your user account, visiting your user profile or by contacting us directly. Should you require us to edit or delete your personal data, we may ask you to provide us with evidence of your identity before we can act on your request.

Innovation, Science and Economic Development Canada (ISED)
Notice

This device complies with Innovation, Science and Economic Development Canada license-exempt RSS standard(s). Operation is subject to the following two conditions:

- This device may not cause interference, and;
- This device must accept any interference, including interference that may cause undesired operation of the device.

This Class B digital apparatus complies with Canadian ICES-003.
Innovation, Science and Economic Development Canada (ISED)
Radiation Exposure Statement

Lisense

FCC ID: 2ACCJBC02

Warranty

The device is warranted against any deviation from technical specifications for a period of twelve (12)⁽¹⁾ months from the date specified on your original invoice.

Batteries and accessories sold with your device are also warranted against any defect which may occur during the first six (6) months from the date of purchase as shown on your original invoice.

⁽¹⁾ The warranty period may vary depending on your country.

Under the terms of this warranty, you must immediately inform your vendor in case of a conformity defect on this device and present a proof of purchase.

The vendor or repair centre will decide whether to replace or repair this device, as appropriate.

Repaired or replaced versions of this device are warranted for ONE (1) month unless there are statutory provisions to the contrary.

This warranty shall not apply to damage or defects to this device due to:

- 1) Not following the instructions for use or installation.
- 2) Not being compliant with technical and safety standards applicable in the geographical area where this device is used.
- 3) Improper maintenance of sources of energy, and of the overall electric installation.
- 4) Accidents or consequences of theft of the vehicle in which this device is transported, acts of vandalism, lightning, fire, humidity, infiltration of liquids, inclement weather.
- 5) Connecting to or integrating into this device any equipment not supplied or not recommended by the manufacturer.
- 6) Any servicing, modification or repair performed by individuals not authorised by the manufacturer, the vendor or the approved maintenance centre.

- 7) Use of this device for a purpose other than that for which it was designed.
- 8) Malfunctions caused by external causes (e.g., radio interference from other equipment, power voltage fluctuations).
- 9) Faulty connections resulting from unsatisfactory radio transmission or caused by the absence of radio relay coverage.

Warranty is also excluded for this device on which markings or serial numbers have been removed or altered.

The LIFECONNECT serial number (SN) should be reported together with this device for repairs. The serial number (SN) can be found on the label on the back of the device.

This device is also warranted against hidden defects (defects inherent in the design, manufacture, etc.).

There are no other express warranties other than this printed limited warranty, expressed or implied, of any nature whatsoever.

In no event shall the manufacturer be liable for incidental or consequential damages of any nature whatsoever, including but not limited to trading loss, commercial loss, to the full extent those damages can be disclaimed by law. Some countries/states do not allow the exclusion or limitation of incidental or consequential damages, or limitation of the duration of implied warranties, so the preceding limitations or exclusions may not apply to you.

All rights reserved © 2017 TCL Communication LTD.

Address: Room 1910-12A, Tower 3, China HK City, 33 Canton Road,
Tsimshatsui, Kowloon, Hong Kong