



**T-Mobile REVVL 2  
USER MANUAL**



# About this Manual .....

Thank you for choosing the **REVL 2 5052W**. In order to keep your device in its best condition, please read this manual and keep it for future reference.

# Table of Contents

<b>About this Manual .....</b>	<b>1</b>
<b>1 Getting Started.....</b>	<b>4</b>
1.1 Overview.....	4
1.2 Setup.....	6
1.3 Home Screen.....	8
1.4 Status Bar.....	9
<b>2 About Your Phone.....</b>	<b>10</b>
2.1 Power On/Off.....	10
2.2 Battery.....	11
<b>3 Application .....</b>	<b>12</b>
3.1 Call .....	12
3.2 Contacts .....	15
3.3 Messages .....	18
3.4 Email .....	20
3.5 Chrome.....	22
3.6 Calendar.....	23
3.7 Camera.....	25
3.8 Gallery.....	27
3.9 Clock.....	29
3.10 Music.....	30
<b>4 Personalize Your Phone.....</b>	<b>32</b>
4.1 Language .....	32
4.2 Date & time.....	32

4.3	Sound .....	33
4.4	Wallpaper, brightness and screen timeout.....	34
<b>5</b>	<b>Security.....</b>	<b>35</b>
5.1	Screen lock.....	35
5.2	SIM security.....	35
<b>6</b>	<b>Account.....</b>	<b>36</b>
6.1	Software Update .....	36
<b>7</b>	<b>Safety and Use .....</b>	<b>37</b>
<b>8</b>	<b>Troubleshooting .....</b>	<b>54</b>

# 1 Getting Started .....

## 1.1 Overview

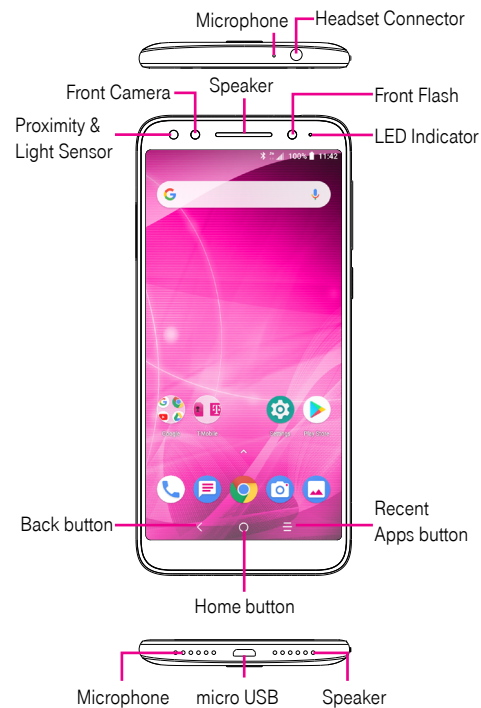

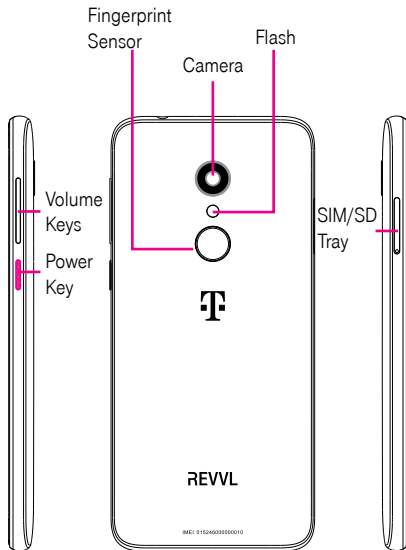

### Recent Apps button

- Touch to open a card view of applications you've worked with recently.



### Home button

- From any application or screen, touch to return to the Home screen.
- Long press to turn on Google Now. You can get help such as getting directions and restaurant information based on the content detected on the screen.



### Back button

- Touch to go back to the previous screen, or close a dialog box, options menu, the Notification panel, etc.



### Power Key

- Press: Lock the screen/Light up the screen.
- Press and hold: Show the popup menu to select from Power off/Restart.
- Press and hold the **Power** key and **Volume** key to make a screenshot.
- Press and hold the **Power** key for at least 10 seconds to force reboot.





### Volume Keys

- In call mode, adjusts the earpiece or headset volume.
- In Music/Video/Streaming mode, adjusts the media volume.
- In general mode, adjusts the ringtone volume.
- Mutes the ringtone of an incoming call.
- In camera preview mode, press **Volume** key to take a photo or press and hold to make burst shot.

## 1.2 Setup

### Setup your phone for the first time

The first time you power on the phone, you should set the following options:

- Touch  to select the phone's language, then touch .
- Select an enabled Wi-Fi, then touch **Next**, otherwise touch **Skip**.
- Set up date and time if needed, then touch **Next**.
- Enter the name to allow the phone to personalize some applications, then touch **Next**.
- **Set up Fingerprint to unlock the screen by touching Next, otherwise touch Skip.**
- **Set up Face recognition to unlock screen by touching Add face data, otherwise touch Skip.**

- Set up Google Services by marking the corresponding checkboxes, touch **MORE** to learn more about Google Services, then touch **NEXT**.

**Note:** Even if no SIM card is installed, your phone will still power on and you will be able to connect to a Wi-Fi network and use some of the phone's features.

### Inserting Nano SIM card

You must insert your Nano SIM card to make phone calls using your network.

-  Your phone only supports Nano SIM card. Do not attempt to insert other SIM types like Mini or Micro cards, otherwise you may damage your phone.

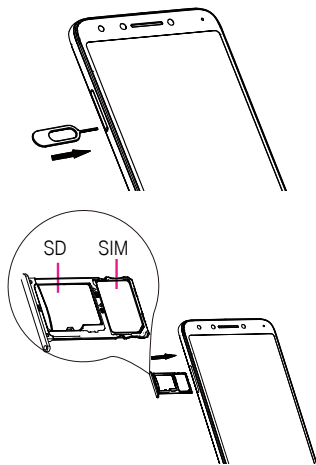

## 1.3 Home Screen

**Status bar**

- Status/Notification indicators
- Touch and drag down to open the Notification panel.

**Search bar**

- 1 Enter text search screen.
- 2 Enter voice search screen.

**Swipe left or right to view more screens**

- Touch an icon to open an application, folder, etc.

- Touch to enter the applications list.

**Favorite tray applications**

- Enter the application.
- Long press to move or remove applications.

## 1.4 Status Bar

From the status bar, you can view both phone status (to the right side) and notification information (to the left side). Here is a list of the icons you might see and their meanings:



Icon	Status
	Bluetooth® active
	Wi-Fi® active
	Network (full signal)
	Network (roaming)
	4G LTE data service
	4G data service
	Airplane mode
	Alarm set
	Battery (charging)
	Battery (fully charged)
	New message

# 2 About Your Phone .....

## 2.1 Power On/Off

Hold down the **Power** key until the phone powers on, unlock your phone (Slide, PIN, password, pattern) if necessary, once unlocked, Home screen is displayed.

If you don't know your PIN code or if you have forgotten it, contact your service provider. Do not store PIN code within your phone, instead store PIN in a location that is accessible without using phone.

Hold down the **Power** key from the Home screen until the phone options appear, select **Power off**.

## Charging

Insert the small end of the charging cable into the charge port, and plug the charger into an electrical outlet.

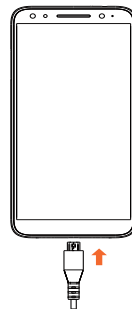

## 2.2 Battery

To optimize your battery life, you may do the following:

### Turn on power saving mode

- Go to **Settings > Battery > Battery saver**
- Turn on the switch to enable battery saving mode.

### Lower screen brightness

- Go to **Settings > Display > Brightness level**
- Lower the brightness by sliding  to the left.

### Screen timeout

- Go to **Settings > Display > Advanced > Sleep**
- Select the screen timeout duration.

# 3 Application .....

## 3.1 Call.....

### Making a call

To make a call, touch .

View the contact's detailed information. You can also edit, delete, share the contact, or send a message to the contact.

