

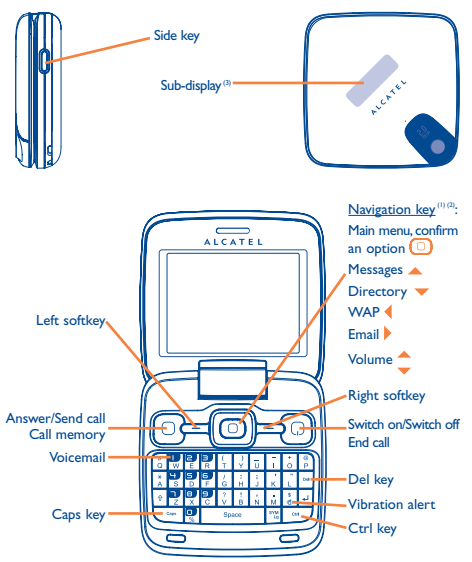

Your cellphone



- ### 1.1 Keys
- Navigation key
 - Confirm an option (press the middle of the key)
 - Answer
 - Send a call
 - Access call memory (Redial) (short keypress)
 - Switch on/Switch off the telephone (long keypress)
 - End a call
 - Return to the main screen
 - Left softkey
 - Right softkey
 - Access your voicemail (long keypress)
 - Side key
 - Short keypress:
 - Scroll up/down "Home Screen" menus (Home Screen is on)
 - Confirm an option
 - Backlight on
 - Access "Music player"
 - Play/pause music (in music playing mode)
 - Long keypress:
 - Scroll up/down "Home Screen" menus quickly (Home Screen is on)
 - Exit "Music player"
 - Ctrl + B: Activate/Deactivate Bluetooth
 - Ctrl + M: Access Music player
 - Ctrl + P: Access Profiles
 - Ctrl + J: Access Java applications

- ### 1.2 Main screen icons (1)
- Battery charge level
 - Vibrate alert:** Your phone vibrates, but does not ring or beep with the exception of the alarm.
 - Bluetooth status (Blue - Activated).
 - Bluetooth status (Connected to an audio device).
 - Headset connected.
 - Call forwarding activated: your calls are forwarded.
 - Alarm.
 - Level of network reception.
 - Voicemail message arrived.
 - Missed calls.
 - Radio is on.

- Stopwatch is active.
- WAP alerts (1).
- Roaming.
- Memory card scanning in progress.
- Memory card scanning completed.
- SIM card missing.
- Line switching (2); indicates the selected line.
- GPRS connection status (Blue - Activated).
- EDGE attached.
- EDGE connecting.
 - Shown only in no ciphering mode while calling, sending/receiving SMS.
- Music player active.
- Message receipt in progress.
- Sending a message.
- Silence mode: your phone neither rings, beeps nor vibrates except for the alarms.
- Message unread.
- Message list is full: your terminal cannot accept any new messages. You must access the message list and delete at least one message on your SIM card.
- Flight mode.
- A2DP connected.

2 Getting started

- ### 2.1 Set-up
- #### Removing or installing the back cover
- #### Installing or removing the battery
- #### Inserting or removing the SIM card
- ### 2.2 Power on your phone
- ### 2.3 Power off your phone

3 Calls

- ### 3.1 Making a call
- #### Making an emergency call
- #### Change the order
- #### Show/Hide
- #### Restore default settings

5 Messages

- ### 5.1 Create message
- ### 5.2 Inbox
- #### Group unread message
- #### Timer send
- #### Multi-mark

6 Email

Your phone has an email client with the settings pre-defined for a few popular email services like - GoogleMail, Windows live, Yahoo, AOL, etc. Besides this, you can set up other POP3 or IMAP4 email accounts that you may be using.

7 Instant messaging (1)

Palringo Instant messaging (IM) allows you to chat with other people using Palringo account. You can also connect to other popular IM services through Palringo, like Yahoo, AIM, GG, ICQ, Google talk, iChat and etc. Please note that the services may be upgraded upon your client version.

8 Directory

- ### 8.1 Consulting your directory
- ### 8.2 Adding a contact

9 Call register

- ### 9.1 Call memory

9.2 Billing (1)

You can access different items with this option: **Amount, Duration, GPRS counter, Beep duration.**

9.3 Call settings

You can access a number of items with this option: **Call waiting, Call forwarding, Call barring, Caller ID, Line switching, Auto redial.**

10 Media applications

- ### 10.1 Music player
- ### 10.2 Image Viewer
- ### 10.3 Video player
- ### Mark/Unmark
- ### Streaming URL

10.4 Radio

Your phone is equipped with a Radio (1) with RDS functionality. You can use the application as a traditional Radio with saved channels or with parallel visual information related to the radio program on the display, if you tune to stations that offer Visual Radio service. You can listen to it while running other applications.

11 Internet (2)

- ### 11.1 My friends
- ### 11.2 Opera
- ### 11.3 Web
- ### 11.4 News
- ### 11.5 Weather

12 Entertainment

- ### 12.1 Fun
- #### 12.1.1 Stopwatch
- #### 12.1.2 Games 12.2 Ebook (1)12.3 Java

13 Camera

Your cellphone is fitted with a camera for taking photos and shooting videos that you can use in different ways:

- store them in your "File manager/My creations".
- send them in a multimedia message (MMS) to a cellphone or an email address.
- send them directly by Email or Bluetooth.
- customize your main screen.
- select them as incoming call image to a contact in your directory.
- transfer them by data cable or microSD card to your computer.
- modify your photos by adding frames (only available to size 320x240).

14 Profiles

With this menu, you may personalize ringtones for different events and environments.

15 File manager

- ### 15.1 Memory card
- ### Insert the memory card
- ### 15.2 Formats and compatibility (1)

16 Bluetooth

Access this feature by pressing the (2) key to enter the main menu, then selecting "Bluetooth".

17 Others

- ### 17.1 Calendar
- ### 17.2 Calculator
- ### 17.3 Notes
- ### 17.4 Tasks
- ### 17.5 Clock
- #### 17.5.1 Alarm

17.5.2 Clock

Allows you to have settings of date and time, including 12/24h format.

17.5.3 World clock

The World clock shows current local time and the time zone in different cities.

ALCATEL is a trademark of Alcatel-Lucent
and is used under license by
TCT Mobile Limited.

All rights reserved © Copyright 2010
TCT Mobile Limited.

TCT Mobile Limited reserves the right to alter
material or technical specification without prior notice.

Prolonged exposure to music at full volume on the music player may damage the listener's hearing. Set your phone volume safely. Use only headphones recommended by TCT Mobile Limited and its affiliates.

