

Your cellphone.....

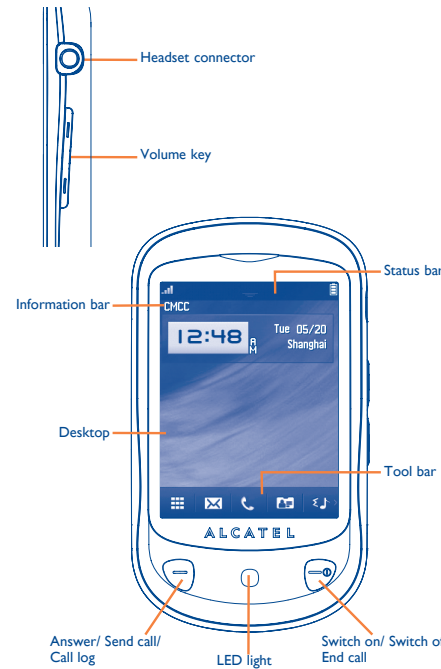

- Answer
- Send a call
- Access call log (Redial) (press)
- Switch on/Switch off the cellphone (hold down)
- End call
- Return to the main screen
- Lock the screen from the main screen (press)
- Volume key: Volume up/down, Zoom in/out, Calibration of LCD (hold down from the main screen)
- Flashes when a new event occurs (Missed call, Voice mail, Message).
- Flashes with breath effect when an incoming call arrives.
- Remains lit when charging until disconnected.

1.1 Status bar icons ⁽¹⁾

- Battery charge level**
- Vibrate alert:** your cellphone vibrates, but does not ring or beep with the exception of the alarm.
- Bluetooth status (Activated).**
- Bluetooth status (Connected to an audio device).**
- Headset connected.**
- Keypad & LCD touch locked.**
- Call forwarding activated:** your calls are forwarded.
- Alarm or appointments programmed.**

⁽¹⁾ The icons and illustrations in this guide are provided for information purposes only.

- Level of network reception.**
- Voice mail message arrived.**
- Missed calls.**
- Stopwatch is active.**
- Radio is on.**
- WAP alerts ⁽¹⁾.**
- Roaming.**
- Memory card scanning completed.**
- SIM card missing.**
- Line switching ⁽¹⁾:** indicates the selected line.
- GPRS connection status (Activated).**
- GPRS connecting.**
- Music player active.**
- Message receipt in progress.**
- Sending a SMS.**
- Sending a MMS.**
- Silence mode:** your cellphone does not ring, beep or vibrate with the exception of the alarm.
- SMS unread.**

⁽¹⁾ Depending on your network operator.

- (In red) Message list is full:** your cellphone cannot accept any new messages. You must access the message list and delete at least one message on your SIM card.
- Flight mode.**
- A2DP connected.**
- Broadcast is on.**

1.2 Status list

Touch status bar and drag it downward to open it; To hide it, tap or drag it upwards. To open an application, tap a menu when a list is open.

1.3 Desktop

Adding items.
To add an item from the main menu, press and hold its icon in the main menu list. To add a widget, press from tool bar or long press a blank area on the main screen, tap "Add widgets" to access widget lists and select the item you wish to add.

Editing/Removing/Re-organizing items

Long press the application on the desktop to edit/remove/re-organize it, touch to edit (only for my favourites), touch to remove. Touch and hold the application until a location frame shows up on the desktop, drag it to the location you desire, and then confirm by tapping "Done".

Wallpaper

To personalize your wallpaper, press from tool bar or long press blank area from the main screen, tap "Wallpaper". You will be directed to "My images" with this option.

1.4 Tool bar

Tool bar with menu items as a shortcut for quick access.

2 Getting started

2.1 Set-up

Removing or installing the back cover

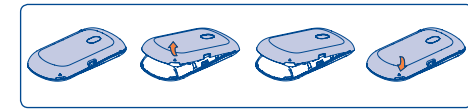

Inserting or removing the SIM card

You must insert your SIM card to make phone calls. Please power off your cellphone before inserting or removing the SIM card.

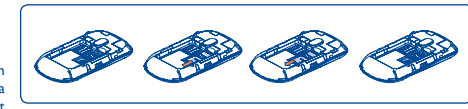

Place the SIM card with the chip facing downwards and slide it into its housing. Make sure that it is correctly inserted. To remove the card, press and slide it out.

Installing or removing the battery

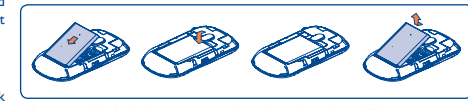

- Insert and click the battery into place, then close the cellphone cover.
- Unclip the cover, then remove the battery.

2.2 Power on your cellphone

Hold down the key until the cellphone powers on.

2.3 Power off your cellphone

Hold down the key from the main screen.

2.4 Using the touchscreen

- Tap** To access an application, tap it with your finger.
- Drag** Place your finger on the screen to drag the object to the destination.
- Scroll** Slide the screen to scroll up and down the applications, images, web pages... at your convenience.

3 Dialer

Enter the desired number from keypad directly or select a contact from Directory by tapping , then press key or tap to place the call. The number you entered can be saved to Directory by selecting . If you make a mistake, you can delete the incorrect digits by tapping . To hang up the call, press the key.

4 Menu arrange

The main menu is designed to vary according to your preference. To access this function, select to enter the main menu, then tap . **Change the order**
Access "Menu arrange", focus on the main menu item you want to move, and then tap "OptionsMove", it will go to the main menu screen and tick "✓" will be shown on the main menu you selected, then release it to your favourite destination.

Show/Hide

Access "Menu arrange", tap the left check box of the selected menu once to show/hide, then tap "OptionsSave" to save the operation.

Restore default

From main menu, select "Menu arrange", then tap "OptionsRestore default" to return to the default menu display.

5 Messages

5.1 Conversational mode and conventional mode

In conversational view mode, you can view chat history in chronological order. In conventional view mode, you may have access to the following folders: **Inbox, Outbox, Sent, Broadcast SMS, Voicemail, Drafts, Empty folder, Templates, Settings.** Conversational view mode is set as default. You may switch to conventional view mode by selecting "OptionsSettingsConversational modeOn(Off)".

5.2 Create message

Press from tool bar on the main screen or select "MessagesWrite msg" from main menu to create text/multimedia message. An SMS will be converted to MMS automatically when: images, videos, audio, slides or attachments are inserted; Subject, CC/BCC/email address is added; or the message contains more than 8 pages of text.

Timer send

Schedule a SMS/MMS to be sent out at predefined time (select "Timer send" through .

OT-710A
ALCATEL
mobile phones
English - CJB31D1ALAA

6 Email

Your cellphone has an email client with the settings predefined for a few popular email services like – GoogleMail, Windows live, Yahoo, AOL, etc. Besides this, you can set up other POP3 or IMAP4 email accounts that you may be using.

7 Palringo ⁽¹⁾

Palringo Instant messaging (IM) allows you to chat with other people using Palringo account. You can also connect to other popular IM services through Palringo, like Yahoo, AIM, GG, ICQ, Google talk, iChat etc. Please note that the services may be upgraded depending on your client version.

8 Directory

8.1 Consulting your directory
To access the Directory, tap from tool bar on main screen, or select "Directory" from main menu.

8.2 Birthday reminder

You can set a birthday reminder when editing contact information. This will remind you at regular intervals during the day prior to the set date.

9 Call log

- 9.1 Access**
You may access this function from the main menu "Call log" or by pressing .
- 9.2 Available options**
When you tap , you may have access to Delete, Send message, Save to directory, Edit before call, etc.
- 9.2.1 Billing ⁽¹⁾**
You can access different items with this option: Last call cost, Total cost, Max cost, Reset cost, Price per unit, Duration, GPRS counter, Beep duration.
- 9.2.2 Call settings ⁽¹⁾**
You can access a number of items with this option: Call waiting, Call forwarding, Call barring, Caller ID, Line switching, Auto redial.

10 Media applications

10.1 Music
Access this feature from the main menu by selecting "Music". You will have full flexibility of managing music both on your cellphone and memory card.
Broadcast
You may share music with others when you tune in the same frequency.

10.2 Image

A library links to the images in "My creations" in cellphone to be shown in list, slide, or thumbnail, set as Wallpaper, Screen saver, Power on/off display, and Contact ID, or sent by MMS, Email, Bluetooth.

10.3 Video

"My videos" album contains video clips recorded, received or downloaded. All video clips in this folder can be played, set as contact ID, send, deleted, renamed, sorted.

10.4 Radio

Your cellphone is equipped with a radio ⁽¹⁾ with RDS functionality. You can use the application as a traditional radio with saved channels or with parallel visual information related to the radio program on the display if you tune to stations that offer Visual Radio service. You can listen to it while running other applications.

11 Internet ⁽²⁾

- 11.1 My friends**
It migrates self-contained sub-trees of the websites to let you stay in touch with your friends by flicking through Bebo, Facebook, Friendster, Hi5, Myspace, etc.
- 11.2 Opera**
Not only does Opera Mini give you the full Web experience where you stay in touch with your friends, obtain information, do your online banking etc., but it is also designed to save time by using compressed web pages.

⁽¹⁾ The quality of the radio depends on the coverage of the radio station in that particular area.

⁽²⁾ Depending on your network operator. May cause additional network charges for data flow to provide this service. Extra fees might also be charged in roaming states.

11.3 Wap

Access Wap options: Homepage, Bookmarks, Go to URL, Recent pages, Offline pages, Service inbox, Settings.

11.4 News

It is a huge time saver providing news updates from a website in a simple form. Once subscribed to a channel, it gives you the ability to track and manage all your favourite RSS content on your cellphone at anytime, anywhere!

11.5 Weather

Your cellphone is equipped with a weather function for consulting up to 3-day forecasts of favourite cities.

11.6 Facebook

Facebook is a social utility that connects people with friends and others who work, study and live around them. It provides a number of features with which users may interact: Wall, a space on every user's profile page that allows friends to post messages for the user to see; Pokes, which allow users to send a virtual "poke" to each other; Gifts, a feature allowing users to send virtual gifts which appear on the recipient's profile; Market places, which lets users post free classified goods, etc.
To open an account online, please go to: <http://www.facebook.com/>.

11.7 mTweet

Twitter is a social networking and microblogging service that has gained notability and popularity worldwide. This feature enables cellphone users to exchange news updates and ideas with a community in the form of messages or posts. Posts are displayed on the author's profile page and delivered to the author's subscribers or followers.
To open an account online, please go to: <http://twitter.com/>.

12 Entertainment

- 12.1 Stopwatch**
The stopwatch is a simple application for measuring time with the possibility to register several results and suspend/resume measurement.
- 12.2 Ebook**
A bookshelf contains the electronic books (.txt and .pdb file only). While reading the book, you may add bookmarks, or reach the text by searching words, phrases (OptionsFind, OptionsJump to).
- 12.3 Java**
Your Alcatel cellphone may include ⁽¹⁾ some Java™ applications and games. You can also download new applications and games to your cellphone.

13 Camera

Your cellphone is fitted with a camera for taking photos and shooting videos that you can use in different ways:

- store them in your "File managerMy creations".
- send them in a multimedia message (MMS) to a cellphone or an email address.
- send them directly by Email or Bluetooth.
- customize your main screen.
- select them as incoming call image to a contact in your directory.
- transfer them by data cable or microSD card to your computer.

14 Profiles

With this menu, you may personalize ringtones for different events and environments.

15 File manager

You will have access to all audio and visual files stored in cellphone or memory card in File manager. You can access a number of items with this option: My audios, My images, My videos, Ebook, My creations, Other files, Phone and Memory card.

Inserting the memory card:



To release the microSD card holder, slide it in the direction of the arrow and lift it. Then insert the microSD card with the golden contact downward. Finally, turn down the microSD holder and slide it in the opposite direction to lock it.

16 Bluetooth™

Access this feature by pressing to enter the main menu, then selecting "Bluetooth".

17 Others

- 17.1 Calendar**
Once you enter this menu from the main menu, there is a monthly-view calendar for you to keep track of important meetings, appointments, etc. Days with events entered will be marked in color.
- 17.2 Calculator**
Access this feature by selecting "Calculator" from the main menu. Enter a number, select the type of operation to be performed, and enter the second number, then press "=" to display the result.
- 17.3 Notes**
You can create a note in text or voice format by accessing "Notes" from the main menu.
- 17.4 Tasks**
Enables you to easily manage and track the progress of a task with priorities. All the tasks will be sorted by due date.
- 17.5 Clock**
 - 17.5.1 Alarm**
Your cellphone has a built-in alarm clock with a snooze feature.
 - 17.5.2 World clock**
The World clock shows current local time and the time zone in different cities.
 - 17.5.3 Clock**
Allows you to have settings of date and time, including 12/24h format.

⁽¹⁾ Depending on your network operator.

⁽¹⁾ Contact your network operator to check service availability.

⁽¹⁾ Depending on your network operator.

