

# Quick Start Guide

For more information about how to use the cellphone, please go to [www.alcatelonetouch.com](http://www.alcatelonetouch.com) to download complete user manual. Moreover, from the website you can also consult FAQ, realize software upgrade via PC suite, etc.

Prolonged exposure to music at full volume on the music player may damage the listener's hearing. Set your cellphone volume safely. Use only headphones recommended by TCT Mobile Limited and its affiliates.

ALCATELone touch

English - CJB31TIALAAA

## Your cellphone.....

### 1.1 Keys and connectors

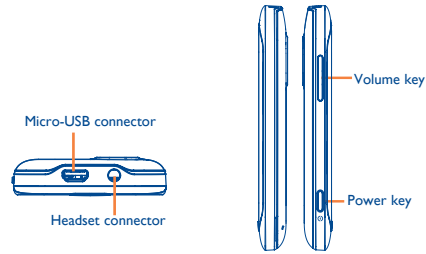
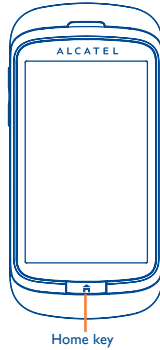

- Return to the previous Home screen
- Press: Reject a call  
Lock/unlock the screen
- Press and hold: Power on/off
- Press: Volume up/down  
Zoom in/out
- Press and hold: Launch touch screen calibration

### 1.2 Home screen

You can bring all the items (shortcuts and widgets) you love or use most frequently to your Home screen for quick access.



The Home screen is provided in an extended format to provide you with more space for adding widgets and shortcuts. Slide the Home screen horizontally left and right to get a complete view of the Home screen. Small dots at the bottom of the screen indicate which screen you are viewing.

#### 1.2.1 Status bar icons<sup>(1)</sup>

- Battery charge level**
- Vibrate alert:** your cellphone vibrates, but does not ring or beep with the exception of the alarm.
- Silence mode:** your cellphone does not ring, beep or vibrate with the exception of the alarm.
- Flight mode.**
- Bluetooth status (Activated).**
- Bluetooth status (Connected to an audio device).**
- Java status (Activated).**
- Headset connected.**
- LCD touch locked.**
- LCD touch unlocked.**
- Voicemail message arrived.**
- Missed calls.**
- Call in progress.**
- Call forwarding activated:** your calls are forwarded.
- Stopwatch is active.**

<sup>(1)</sup> The icons and illustrations in this guide are provided for information purposes only.

- Radio is on.**
- Alarm or appointments programmed.**
- Music player active.**
- Email unread.**
- WAP messages<sup>(1)</sup>.**
- SD card scanning completed.**
- SIM card unavailable.**
- Line switching<sup>(1)</sup>:** indicates the selected line.
- Level of network reception.**
- Roaming.**
- GPRS connection status (Activated).**
- GPRS connecting**
- EDGE connecting.**
- EDGE attached.**
- Sending message.**
- Receiving message.**
- SMS unread.**
- MMS unread.**
- (Flickering) Message list is full:** your cellphone cannot accept any new messages. You must access the message list and delete at least one message on your SIM card.

- 1.2.2 Status list**  
Touch the status bar and drag down to open, drag up to close. To open an application, touch it from the list.

<sup>(1)</sup> Depending on your network operator.

### 1.2.3 Toolbar

Toolbar with 4 fixed shortcuts to access main menu, making a call (Call log/Contacts), Messaging, edit the Home screen.

### 1.2.4 Personalize the Homescreen

You can customize your Home screen by adding/editing/removing/re-organizing widgets & shortcuts and personalize your wallpaper.

## 2 Getting started .....

### 2.1 Set-up

#### Removing or installing the back cover

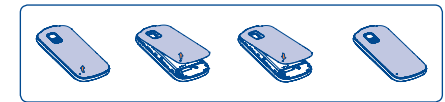

#### Inserting or removing the SIM card

You must insert your SIM card to make phone calls. Please power off your cellphone and remove battery before inserting or removing the SIM card.



After removing the back cover, insert your SIM card according to the graphics shown on the back of the cellphone. To remove the card, press and slide it out.

<sup>(1)</sup> Depending on your network operator.

### 4.2 Conversational On (Off) mode

In conversational on mode, you can view chat history in chronological order. In conversational off mode, you can access the following folders: **Inbox, Outbox, Sent, Drafts, Broadcast SMS, Voicemail and Templates.** You can switch between these two modes by selecting "Switch view mode" via Conversational on mode is set as the default mode and the following instructions are based on this mode.

### 4.3 Write message

Touch to create text/multimedia messages. Specific letters (accent) will increase the size of the SMS, this may cause multiple SMS to be sent to your recipient.

An SMS will be converted to MMS automatically when: images, videos, audio, slides or attachments are inserted; Subject, CC/BCC/email address is added; or the message contains more than 8 pages of text.

## 5 Email .....

Your cellphone has an email client with the settings predefined for a few popular email services like - GoogleMail, Yahoo, AOL, etc. Besides this, you can set up other POP3 or IMAP4 email accounts that you may be using.

## 6 Palringo<sup>(1)</sup> .....

Palringo Instant message (IM) allows you to chat with other people using Palringo account. You can also connect to other popular IM services through Palringo, like Yahoo, AIM, GG, ICQ, GTalk, iChat etc. Please note that the services accessible to you will depend on your client version and dynamic Palringo server options.

<sup>(1)</sup> Depending on your network operator.

## 7 Contacts.....

### 7.1 Consulting your Contacts

To access the Contacts, touch from toolbar to enter the main menu, and select "Contacts".

### 7.2 Adding a contact

You can add a new contact by touching .

## 8 Call log.....

### 8.1 Access

You may access this function from the main menu "Call log".

- Missed calls/Call rejected by SMS
- Outgoing calls (Redial)
- Answered calls/Rejected calls

### 8.2 Available options

When you touch , you can have access to **Delete, Send message, Edit before call,** etc.

#### 8.2.1 Call settings<sup>(1)</sup>

You can access a number of items with this option: **Call waiting, Call forwarding, Call barring, Caller ID, Line switching, Auto redial and Reject by SMS.**

<sup>(1)</sup> Depending on your network operator.

## 9 Media applications .....

### 9.1 Music player .....

To access this function, touch to enter the main menu and select . You will have full flexibility of managing music both on your cellphone and SD card.

### 9.2 Image viewer.....

A library links to the images stored in your cellphone or SD card to be shown in list, or slide, set as wallpaper, power on/off display and incoming call image or sent by MMS, Email, Bluetooth.

### 9.3 Video player .....

"My videos" album contains video clips recorded, received or downloaded. All supported video clips in this folder can be played, set as power on/off display, sent, deleted, renamed, sorted.

### 9.4 Radio .....

Your cellphone is equipped with a radio<sup>(1)</sup> with RDS<sup>(2)</sup> functionality. You can use the application as a traditional radio with saved channels or with parallel visual information related to the radio program on the display if you tune to stations that offer Visual Radio service. You can listen to it while running other applications.

<sup>(1)</sup> The quality of the radio depends on the coverage of the radio station in that particular area.

<sup>(2)</sup> Depending on your network operator and market.

## 10 Internet<sup>(1)</sup> .....

### 10.1 My friends .....

It migrates self-contained sub-trees of the websites to let you stay in touch with your friends by flicking through Bebo, Friendster, Hi5, Myspace and Flickr.

### 10.2 Opera .....

Not only does Opera Mini give you the full Web experience where you stay in touch with your friends, obtain information, do your online banking etc., but it is also designed to save time by using compressed web pages.

### 10.3 Wap.....

Access Wap options: **Homepage, Bookmarks, Go to URL, Open file, Last web address, Recent pages, Offline pages, Service inbox and Settings.**

### 10.4 News .....

It is a huge time saver providing news updates from a website in a simple form. Once subscribed to a channel, it gives you the ability to track and manage all your favorite RSS content on your cellphone at anytime, anywhere!

### 10.5 Weather .....

Your cellphone is equipped with a weather function for consulting up to 3-day forecasts of favorite cities.

<sup>(1)</sup> Depending on your network operator. May cause additional network charges for data flow to provide this service. Extra fees might also be charged in roaming states.

## 11 Entertainment.....

### 11.1 Stopwatch.....

The stopwatch is a simple application for measuring time with the possibility to register several results and suspend/resume measurement.

### 11.2 Ebook .....

A bookshelf contains the electronic books (.txt file only). While reading the book, you may add bookmark by touching or go to bookmark by touching , or reach the text by searching words, phrases (Options)Find, (Options)Jump to).

### 11.3 Java .....

Your Alcatel cellphone may include<sup>(1)</sup> some Java™ applications and games. You can also download new applications and games to your cellphone.

<sup>(1)</sup> Depending on your network operator.

## 12 Camera .....

To access the function from the Home screen, touch from the toolbar to access the main menu and select the icon.

Your cellphone is fitted with a camera for taking photos and shooting videos.

## 13 Profiles .....

With this menu, you may personalize ringtones for different events and environments.

## 14 File manager.....

You will have access to all audio and visual files stored in cellphone or SD card in File manager. You can access a number of items with this option: **My audios, My images, My videos, Ebook, My creations, Others, Phone, SD card and Memory status.**

#### Inserting and removing the SD card:



Place the MicroSD card with the chip facing downwards and slide it into its housing. Make sure that it is correctly inserted. To remove the card, press and slide it out.

<sup>(1)</sup> Depending on your network operator.

### Installing or removing the battery



- Insert and click the battery into place, then close the cellphone cover.
- Unclip the cover, then remove the battery.

### Charging the battery

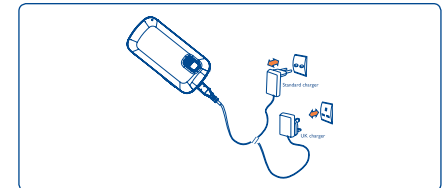

Connect the battery charger to your cellphone and outlet respectively.

- To reduce power consumption and energy waste, when battery is fully charged, disconnect your charger from the power socket; switch off Bluetooth or background-running applications when not in use; reduce the backlight time, etc.

### 2.2 Power on your cellphone

Hold down the key until the cellphone powers on.

### 2.3 Power off your cellphone

Hold down the key until the cellphone powers off.

<sup>(1)</sup> Depending on your network operator.

## 2.4 Using the touchscreen

- Touch** To access an application, touch it with your finger.
- Drag** Place your finger on the screen to drag the object to the destination.
- Scroll** Slide the screen to scroll up and down the applications, images, web pages... at your convenience.

## 3 Making a call.....

Touch on the toolbar to place a call.

Enter the desired number on the on-screen keypad directly or select a contact from Call log or Contacts by touching or respectively, then touch to place the call. Press to return to the Home screen. If you want to return to the call screen, touch . The number you entered can be saved to Contacts by selecting . If you make a mistake, you can delete the incorrect digits by touching .

To hang up the call, press the key.

## 4 Messaging.....

### 4.1 Access

You may access this menu using the following options:

- Touch to enter the main menu screen, and then select .
- Access from toolbar by selecting .

### 16.5.3 Date and time

Allows you to have settings of date and time, including 12/24h format.

### 16.6 Converter .....

You can use the Weight and Length conversion by selecting the unit you wish to convert via , then touch to input the digits. Finally confirm with .

### 16.7 Voice recorder .....

Accessing "Voice recorder" from the main menu allows you to make voice or sound recordings.

## 17 Settings .....

From the main menu, select the menu icon and select the function of your choice in order to customize your cellphone: **Phone settings, Call settings, Security, Network, Connectivity and Default Browser.**

## 18 Making the most of your cellphone.....

#### PC suite

You can download PC suite for free from the website. The PC suite includes:

- **Backup/restore**  
You can backup the important data in your cellphone and restore them when needed.
- **Multimedia Personalization**  
Customize your cellphone with images, animations and melodies.

<sup>(1)</sup> Depending on your network operator.





### • Messaging

You can compose SMS/MMS easily on your PC and transfer them to your cellphone.

### Supported Operating Systems

Windows XP/Vista/Windows 7.

### One Touch Upgrade

Using One Touch Upgrade tool you can update your cellphone's software from your PC. Download One Touch Upgrade from ALCATEL website (www.alcatelonetouch.com) and install it on your PC. Launch the tool and update your cellphone by following the step by step instructions (refer to the User Guide provided together with the tool). Your cellphone's software will now have the latest software.



All personal information will be permanently lost following the update process. We recommend you backup your personal data using PC Suite before upgrading.

### Webcam <sup>(1)</sup>

You can use your cellphone as a webcam for instant messaging on your PC.

- Connect your cellphone to PC via USB cable.
- Go to "My computer" folder on your PC and find USB video device (Under Scanners & Cameras).

## 9 Latin input mode ....

There are two text entry methods that can be used to write messages.

- Normal: this mode allows you to type a text by choosing a letter or a sequence of characters associated with a key.
- Predictive mode: This mode can perform predictive input in virtual keypad and supports multi-language input.

<sup>(1)</sup> The using of webcam may vary according to the operating system of your PC.

### Touch inputting

(Slide horizontally to switch between the two types of keypad)

- Switch mode of input method.
- Switch between ABC/abc/Abc.
- Access to the symbol and number table.
- Access to all symbols.
- Touch once to delete one by one.
- Long touch to delete all.
- Options for more operations.
- Press and hold 0-9 to input number.
- Switch to a new line (in SMS, Email, etc.).
- Close input keypad.
- Switch between 3\*4 virtual keypad and Qwerty virtual keypad.

## Safety and use.....

We recommend that you read this chapter carefully before using your cellphone. The manufacturer disclaims any liability for damage, which may result as a consequence of improper use or use contrary to the instructions contained herein.

### • TRAFFIC SAFETY:

Given that studies show that using a cellphone while driving a vehicle constitutes a real risk, even when the hands-free kit is used (car kit, headset...), drivers are requested to refrain from using their cellphone when the vehicle is not parked. Check the laws and regulations on the use of wireless cellphones and their accessories in the areas where you drive. Always obey them. The use of these devices may be prohibited or restricted in certain areas.

When driving, do not use your cellphone and headphone to listen to music or to the radio. Using a headphone can be dangerous and forbidden in some areas. When switched on, your cellphone emits electromagnetic waves that can interfere with the vehicle's electronic systems such as ABS anti-lock brakes or airbags. To ensure that there is no problem:

- do not place your cellphone on top of the dashboard or within an airbag deployment area,
- check with your car dealer or the car manufacturer to make sure that the car's electronic devices are shielded from cellphone RF energy.

### • CONDITIONS OF USE:

You are advised to switch off the cellphone from time to time to optimize its performance.

Remember to abide by local authority rules of cellphone use on aircrafts. Operational Warnings: Obey all posted signs when using mobile devices in public areas.

Follow Instructions to Avoid Interference Problems: Turn off your mobile device in any location where posted notices instruct you to do so. In an aircraft, turn off your mobile device whenever instructed to do so by airline staff. If your mobile device offers an airplane mode or similar feature, consult airline staff about using it in flight.

Switch the cellphone off when you are in health care facilities, except in designated areas. As with many other types of equipment now in regular use, cellphones can interfere with other electrical or electronic devices, or equipment using radio frequency. Switch the cellphone off when you are near gas or flammable liquids. Strictly obey all signs and instructions posted in a fuel depot, gas station, or chemical plant, or in any potentially explosive atmosphere.

When the cellphone is switched on, it should be kept at least 15 cm from any medical device such as a pacemaker, a hearing aid or insulin pump. In particular when using the cellphone you should hold it against the ear on the opposite side to the device, if any.

## Alcatel Mobile Phones Limited Warranty.....

Defects in appearance, cosmetic, decorative or structural items such as framing and non-operative parts. There are no express warranties, whether written, oral or implied, other than this printed limited warranty or the mandatory warranty provided by your jurisdiction. In no event shall TCT Mobile or any of its affiliates be liable for incidental or consequential damages of any nature whatsoever, including but not limited to commercial loss, to the full extent those damages can be disclaimed by law. Some states do not allow the exclusion or limitation of incidental or consequential damages, or limitation of the duration of implied warranties, so the preceding limitations or exclusions may not apply to you.

How to obtain Support: Contact the customer care center by calling (877-702-3444) or going to www.alcatelonetouch.com. We have placed many self-help tools that may help you to isolate the problem and eliminate the need to send your wireless device in for service. In the case that your wireless device is no longer covered by this limited warranty due to time or condition we have other options that you may utilize our out of warranty repair options.

To obtain hardware repairs or replacement within the terms of this warranty, contact TCT Mobile to get an RMA number, include a copy of the original proof of warranty coverage (e.g. original copy of the dated bill of sale, invoice), the consumer's return address, your wireless carrier's name, alternate daytime cellphone number, and email address with a complete problem description. Only ship the wireless device. Do not ship the SIM card, memory cards, or any other accessories such as the power adapter. You must properly package and ship the wireless device to the repair center. TCT Mobile is not responsible for wireless devices that do not arrive at the service center. Upon receipt, the service center will verify the warranty conditions, repair, and return your wireless device to the address provided.

- Non-compliance with the instructions for use or installation, or with technical and safety standards applicable in the geographical area where your cellphone is used;
- Connection to any equipment not supplied or not recommended by TCT Mobile;
- Modification or repair performed by individuals not authorized by TCT Mobile or its affiliates;
- Acts of god such as Inclement weather, lightning, power surges, fire, humidity, infiltration of liquids or foods, chemical products, download of files, crash, high voltage, corrosion, oxidation;
- Removal or altering of the wireless devices event labels or serial numbers (IMEI);
- Damage from exposure to water or other liquids, moisture, humidity, excessive temperatures or extreme environmental conditions, sand, excess dust and any condition outside the operating guidelines;

Read and follow the directions from the manufacturer of your implantable medical device. If you have any questions about using your mobile device with your implantable medical device, consult your healthcare provider. To avoid hearing impairment, answer the call before holding your cellphone to your ear. Also move the handset away from your ear while using the "hands-free" option because the amplified volume might cause hearing damage. It is recommended to have proper supervision while small children use your cellphone. When replacing the cover please note that your cellphone may contain substances that could create an allergic reaction. Always handle your cellphone with care and keep it in a clean and dust-free place. Do not allow your cellphone to be exposed to adverse weather or environmental conditions (moisture, humidity, rain, infiltration of liquids, dust, sea air, etc.). The manufacturer's recommended operating temperature range is -10°C (14°F) to +55°C (131°F) (the max value depends on device, materials and housing paint/texture).

Over 55°C (131°F) the legibility of the cellphone's display may be impaired, though this is temporary and not serious. Do not open or attempt to repair your cellphone yourself. Do not drop, throw or try to bend your cellphone. Do not paint it.

Use only batteries, battery chargers, and accessories which are recommended by TCT Mobile Limited and its affiliates and are compatible with your cellphone model. TCT Mobile Limited and its affiliates disclaim any liability for damage caused by the use of other chargers or batteries. Your cellphone should not be disposed of in a municipal waste. Please check local regulations for disposal of electronic products.

Remember to make back-up copies or keep a written record of all important information stored in your cellphone.

Some people may suffer epileptic seizures or blackouts when exposed to flashing lights, or when playing video games. These seizures or blackouts may occur even if a person never had a previous seizure or blackout. If you have experienced seizures or blackouts, or if you have a family history of such occurrences, please consult your doctor before playing video games on your cellphone or enabling a flashing-lights feature on your cellphone. Parents should monitor their children's use of video games or other features that incorporate flashing lights on the cellphones. All persons should discontinue use and consult a doctor if any of the following symptoms occur: convulsion, eye or muscle twitching, loss of awareness, involuntary movements, or disorientation. To limit the likelihood of such symptoms, please take the following safety precautions:

- Play at the farthest distance possible from the screen.
- When you play games on your cellphone, you may experience occasional discomfort in your hands, arms, shoulders, neck, or other parts of your body. Follow these instructions to avoid problems such as tendonitis, carpal tunnel syndrome, or other musculoskeletal disorders:

- Take a minimum of a 15-minute break every hour of game playing.
- If your hands, wrists, or arms become tired or sore while playing, stop and rest for several hours before playing again.
- If you continue to have sore hands, wrists, or arms during or after playing, stop the game and see a doctor.



Prolonged exposure to music at full volume using the music player may damage your hearing. Set your cellphone's volume to it's lowest setting prior to inserting headphones in your ears and adjust the volume to your preference. Only use headphones that are recommended by TCT Mobile Limited and it's affiliates.

### • PRIVACY:

Please note that you must respect the laws and regulations in force in your jurisdiction or other jurisdiction(s) where you will use your cellphone regarding taking photographs and recording sounds with your cellphone. Pursuant to such laws and regulations, it may be strictly forbidden to take photographs and/or to record the voices of other people or any of their personal attributes, and reproduce or distribute them, as this may be considered to be an invasion of privacy.

It is the user's sole responsibility to ensure that prior authorization be obtained, if necessary, in order to record private or confidential conversations or take a photograph of another person, the manufacturer, the seller or vendor of your cellphone (including the operator) disclaim any liability which may result from the improper use of the cellphone.

### • BATTERY AND ACCESSORIES:

Before removing the battery from your cellphone, please make sure that the cellphone is switched off.

Observe the following precautions for battery use:

- Do not attempt to open the battery (due to the risk of toxic fumes and burns).
- Do not puncture, disassemble or cause a short-circuit in a battery.
- Do not burn or dispose of a used battery in the garbage or store it at temperatures above 60°C (140°F).

Batteries must be disposed of in accordance with locally applicable environmental regulations. Only use the battery for the purpose for which it was designed. Never use damaged batteries or those not recommended by TCT Mobile Limited and/or its affiliates.

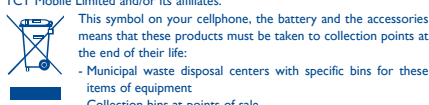

This symbol on your cellphone, the battery and the accessories means that these products must be taken to collection points at the end of their life:

- Municipal waste disposal centers with specific bins for these items of equipment
- Collection bins at points of sale.

They will then be recycled, preventing substances being disposed of in the environment, so that their components can be reused.

**In European Union countries:** These collection points are accessible free of charge. All products with this sign must be brought to these collection points.

**In non European Union jurisdictions:** Items of equipment with this symbol are not to be thrown into ordinary bins if your jurisdiction or your region has suitable recycling and collection facilities; instead they are to be taken to collection points for them to be recycled.

In the United States you may learn more about CTIA's Recycling Program at www.recyclewirelessphones.com

**CAUTION: RISK OF EXPLOSION IF BATTERY IS REPLACED BY AN INCORRECT TYPE. DISPOSE OF USED BATTERIES ACCORDING TO THE INSTRUCTIONS**

### • CHARGERS

Home A.C./ Travel chargers will operate within the temperature range of 0°C (32°F) to 40°C (104°F).

The chargers designed for your cellphone meet with the standard for safety of information technology equipment and office equipment use. Due to different applicable electrical specifications, a charger you purchased in one jurisdiction may not work in another jurisdiction. They should be used for this purpose only.

**Characteristics of power supply** (depending on the country):  
Travel charger: Input: 100-240 V, 50/60 Hz, 0.15 A  
Output: 5 V, 400/550 mA

Lithium 1000 mAh

### Battery:

#### • RADIO WAVES:

THIS CELLPHONE MEETS THE GOVERNMENT'S REQUIREMENTS FOR EXPOSURE TO RADIO WAVES.

Your cellphone is a radio transmitter and receiver. It is designed and manufactured not to exceed the emission limits for exposure to radio-frequency (RF) energy. These limits are part of comprehensive guidelines and establish permitted levels of RF energy for the general population. The guidelines are based on standards that were developed by independent scientific organizations through periodic and thorough evaluation of scientific studies. These guidelines include a substantial safety margin designed to ensure the safety of all persons, regardless of age and health. The exposure standard for cellphones employs a unit of measurement known as the Specific Absorption Rate, or SAR. The SAR limit set by public authorities such as the Federal Communications Commission of the US Government (FCC), or by Industry Canada, is 1.6 W/kg averaged over 1 gram of body tissue. Tests for SAR are conducted using standard operating positions with the cellphone transmitting at its highest certified power level in all tested frequency bands.

Although the SAR is determined at the highest certified power level, the actual SAR level of the cellphone while operating can be well below the maximum value. This is because the cellphone is designed to operate at multiple power levels.

### Unable to receive incoming calls

- Make sure your cellphone is switched on and connected to a network (check for overloaded or unavailable network)
- Check your subscription status with your operator (credit, SIM card valid, etc.)
- Make sure you have not forwarded incoming calls
- Make sure that you have not barred certain calls
- Make sure that your cellphone is not in flight mode

**The caller's name/number does not appear when a call is received**

- Check that you have subscribed to this service with your operator
- Your caller has concealed his/her name or number

### I cannot find my contacts

- Make sure your SIM card is not broken
- Make sure your SIM card is inserted properly
- Import all contacts stored in SIM card to cellphone

### The sound quality of the calls is poor

- You can adjust the volume during a call by pressing the key
- Check the network strength
- Make sure that the receiver, connector or speaker on your cellphone is clean

### I am unable to use the features described in the manual

- Check with your operator to make sure that your subscription includes this service
- Make sure this feature does not require an Alcatel accessory

### When I select a number from my contacts, the number cannot be dialed

- Make sure that you have correctly recorded the number in your file
- Make sure that you have selected the country prefix when calling a foreign country

### I am unable to add a contact in my contacts

- Make sure that your SIM card contacts are not full: delete some files or save the files in the cellphone contacts (i.e. your professional or personal directories)

levels so as to use only the power required to reach the network. In general, the closer you are to a wireless base station antenna, the lower the power output of the cellphone. Before a cellphone model is available for sale to the public, compliance with national regulations and standards must be shown. The highest SAR value for this model cellphone when tested is 0.694 W/Kg for use at the ear and 0.67 W/Kg, for use close to the body.

While there may be differences between the SAR levels of various cellphones and at various positions, they all meet the government requirement for RF exposure. For body-worn operation, the cellphone meets FCC RF exposure guidelines provided that it is used with a non-metallic accessory with the handset at least 1.5 cm from the body. Use of other accessories may not ensure compliance with FCC RF exposure guidelines.

Additional information on SAR can be found on the Cellular Telecommunications & Internet Association (CTIA) Web site: <http://www.phonefacts.net>

The World Health Organization (WHO) considers that present scientific information does not indicate the need for any special precautions for use of cellphones. If individuals are concerned, they might choose to limit their own or their children's RF exposure by limiting the length of calls, or using "hands-free" devices to keep cellphones away from the head and body, (fact sheet n°193). Additional WHO information about electromagnetic fields and public health are available on the following website: <http://www.who.int/peh-emf>.

Note: This device has been tested and found to comply with the limits for a Class B digital device pursuant to part 15 of the FCC Rules. These limits are designed to provide reasonable protection against harmful interference in a residential installation. This equipment generates, uses and can radiate radio frequency energy and, if not installed and used in accordance with the instructions, may cause harmful interference to radio communications. However, there is no guarantee that interference to radio or television reception, which can be determined by turning the equipment off and on, the user is encouraged to try to correct the interference by one or more of the following measures:

- Reorient or relocate the receiving antenna.
  - Increase the separation between the equipment and receiver.
  - Connect the equipment into an outlet on a circuit different from that to which the receiver is connected.
  - Consult the dealer or an experienced radio/ TV technician for help.
- Changes or modifications not expressly approved by the party responsible for compliance could void the user's authority to operate the equipment. For the receiver devices associated with the operation of a licensed radio service (e.g. FM broadcast), they bear the following statement: This device complies with Part 15 of the FCC Rules. Operation is subject to the condition that this device does not cause harmful interference. For other devices, they bear the following statement: This device complies with Part 15 of the FCC Rules. Operation is subject to the following two conditions: (1) this device may not cause harmful interference (2) this device must accept any interference received, including interference that may cause undesired operation.

Your cellphone is equipped with a built-in antenna. For optimal operation, you should avoid touching it or degrading it. As mobile devices offer a range of functions, they can be used in positions other than against your ear. In such circumstances the device will be compliant with the guidelines when used with headset or usb data cable. If you are using another accessory ensure that whatever product is used is free of any metal and that it positions the cellphone at least 1.5 cm away from the body.

### • LICENCES

Obigo® is a registered trademark of Obigo AB.



microSD Logo is a trademark.



The Bluetooth word mark and logos are owned by the Bluetooth SIG, Inc. and any use of such marks by TCT Mobile Limited and its affiliates is under license. Other trademarks and trade names are those of their respective owners.

TouchPal™ and CooTek™ are trademarks of Shanghai HanXiang (CooTek) Information Technology Co., Ltd. and/or its Affiliates.



Java™ and all Java™ based trademarks and logos are trademarks or registered trademarks of Sun Microsystems, Inc. in the U.S. and other countries.



Opera Mini™ is a registered trademark of Opera Mini.



Facebook and the f Logo are trademarks of Facebook, Inc., and are used under license.



Twitter and the T Logo are trademarks of Twitter, Inc., and are used under license.

### How to make your battery last longer

- Make sure you follow the complete charge time (minimum 3 hours)
- After a partial charge, the battery level indicator may not be exact. Wait for at least 20 minutes after removing the charger to obtain an exact indication
- Switch on the backlight upon request.
- Extend the email auto-check interval for as long as possible.
- Update news and weather information on manual demand, or increase their auto-check interval.
- Exit background-running Java applications if they are not being used for a long time.
- Deactivate Bluetooth when not in use.

ALCATEL is a trademark of Alcatel-Lucent and is used under license by TCT Mobile Limited.

© Copyright 2011 TCT Mobile Limited  
All rights reserved

TCT Mobile Limited reserves the right to alter material or technical specification without prior notice.

Prolonged exposure to music at full volume on the music player may damage the listener's hearing. Set your cellphone volume safely. Use only headphones recommended by TCT Mobile Limited and its affiliates.

<sup>(1)</sup> Contact your network operator to check service availability.