

# Quick Start Guide

For more information about how to use the cellphone, please go to [www.alcatelone-touch.com](http://www.alcatelone-touch.com) to download complete user manual. Moreover, from the website you can also consult FAQ, realize software upgrade via PC suite, etc.

Table of contents	
1	Your cellphone..... 3
2	Getting started..... 8
3	Making a call..... 10
4	Message..... 10
5	Email..... 11
6	Palringo..... 12
7	Contacts..... 12
8	Call log..... 13
9	Media applications..... 13
10	Internet..... 14
11	Entertainment..... 16
12	Camera..... 17
13	Profiles..... 17
14	File manager..... 17
15	Bluetooth..... 18
16	Others..... 18
17	Settings..... 20
18	Making the most of your cellphone..... 21
19	Latin input mode..... 22

## Your cellphone.....

### 1.1 Keys and connectors

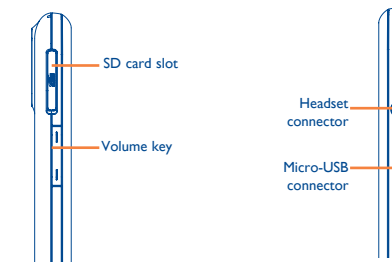
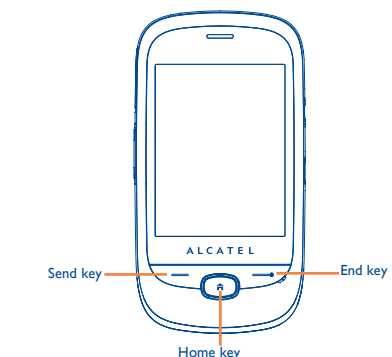

- Answer/Send a call
- Enter Call log
- Press to light up the cellphone screen
- Press: End a call
- Lock the screen
- Return to the previous Home screen
- Press to light up the cellphone screen
- Press and hold: Power on/off
- Press to return to the middle Home screen
- Press to light up the cellphone screen
- Volume up/down
- Zoom in/out
- Scroll up/down
- Press to light up the cellphone screen

### 1.2 Home screen

You can bring all the items (shortcuts and widgets) you love or use most frequently to your Home screen for quick access.



The Home screen is provided in an extended format to provide you with more space for adding widgets and shortcuts. Slide the Home screen horizontally left and right to get a complete view of the Home screen. Small dots at the bottom of the screen indicate which screen you are viewing.

### 1.2.1 Status bar icons<sup>(1)</sup>

#### Battery charge level

**Vibrate alert:** your cellphone vibrates, but does not ring or beep with the exception of the alarm.

**Bluetooth status (Activated).**

**Bluetooth status (Connected to an audio device).**

**Java status (Activated).**

**Headset connected.**

**Call forwarding activated:** your calls are forwarded.

**Alarm or appointments programmed.**

**Level of network reception.**

**Voicemail message arrived.**

**Missed calls.**

**Call in progress.**

**Stopwatch is active.**

**Radio is on.**

**Email unread.**

<sup>(1)</sup> The icons and illustrations in this guide are provided for information purposes only.

### WAP messages<sup>(1)</sup>.

**Roaming.**

**SD card scanning in progress.**

**SD card scanning completed.**

**SIM card unavailable.**

**Line switching<sup>(1)</sup>:** indicates the selected line.

**GPRS connection status (Activated).**

**GPRS connecting.**

**EDGE connecting.**

**EDGE attached.**

**2G network available.**

**3G network available.**

**Music player active.**

**MMS receipt in progress.**

**Sending a SMS.**

**Sending a MMS.**

**Silence mode:** your cellphone does not ring, beep or vibrate with the exception of the alarm.

**SMS unread.**

**MMS unread.**

**(Flickering) Message list is full:** your cellphone cannot accept any new messages. You must access the message list and delete at least one message on your SIM card.

**Flight mode.**

<sup>(1)</sup> Depending on your network operator.

## 3 Making a call.....

To place a call, you may touch from tool bar.

Enter the desired number on the on-screen keypad directly or select a contact from Call log or Contacts by touching or respectively, then touch or press key to place the call. The number you entered can be saved to Contacts by selecting . If you make a mistake, you can delete the incorrect digits by touching .

To hang up the call, press the key.

When making, receiving or during a call, press to return to the middle Home screen, and then touch or press to retrieve the call.

### Muting the ringtone

You may mute ringtone of current incoming call by touching .

Answer the call by pressing the key.

### Rejecting a call

Press the key once to reject the call, or reject call with SMS by touching .

## 4 Message.....

### 4.1 Access

You may access this menu using the following options:

- Touch to enter the main menu screen, and then select .
- Access from tool bar by selecting .

### 4.2 Conversational On (Off) mode

In conversational on mode, you can view chat history in chronological order. In conversational off mode, you can access the following folders: **Inbox, Outbox, Sent, Broadcast SMS, Voicemail, Drafts**, etc. You can switch between these two modes by selecting "Switch view mode" via . Conversational on mode is set as the default mode and the following instructions are based on this mode.

### 4.3 Write message

Touch to create text/multimedia messages. Specific letters (accent) will increase the size of the SMS, this may cause multiple SMS to be sent to your recipient.

An SMS will be converted to MMS automatically when: images, videos, audio, slides or attachments are inserted; Subject, CC/BCC/email address is added; or the message contains more than 8 pages of text.

### Timer send

Schedule an SMS/MMS to be sent out at predefined time (select "Timer send" via .

## 5 Email.....

Your cellphone has an email client with the settings predefined for a few popular email services like - GoogleMail, Yahoo, AOL, etc. Besides this, you can set up other POP3 or IMAP4 email accounts that you may be using.

## 6 Palringo<sup>(1)</sup>.....

Palringo Instant message (IM) allows you to chat with other people using Palringo account. You can also connect to other popular IM services through Palringo, like Yahoo, AIM, GG, ICQ, GTalk, iChat, etc. Please note that the services accessible to you will depend on your client version and dynamic Palringo server options.

## 7 Contacts.....

### 7.1 Consulting your Contacts

To access the Contacts, touch from tool bar to enter the main menu, and select "Contacts".

### 7.2 Adding a contact

You can add a new contact by touching .

### Birthday reminder

You can set a birthday reminder when editing contact information. This will remind you at regular intervals during the day prior to the set date.

### 7.3 Importing, exporting and sharing contacts

From the cellphone contacts screen, select "More" via and touch "Import from SIM card" or "Export to SIM card".

From the SIM contacts screen, select "More" via and touch "Copy to phone".

From a detailed Contact view screen, you can share the contact information with others by selecting "Share contact" via and then send it by Bluetooth, MMS, Email, etc.

<sup>(1)</sup> Depending on your network operator.

## 8 Call log.....

### 8.1 Access

You may access this function from the main menu "Call log" or by pressing from the Home screen.

### 8.2 Available options

When you touch , you may have access to **Delete, Send message, Save to Contacts, Edit before call**, etc.

#### 8.2.1 Billing<sup>(1)</sup>

You can access different items with this option: **Last call cost, Total cost, Max cost, Reset cost, Price per unit, Duration, GPRS counter, Beep duration**.

#### 8.2.2 Call settings<sup>(1)</sup>

You can access a number of items with this option: **Call waiting, Call forwarding, Call barring, Caller ID, Line switching, Auto redial**, etc.

## 9 Media applications.....

### 9.1 Music player.....

To access this function, touch to enter the main menu and select . You will have full flexibility of managing music both on your cellphone and SD card.

<sup>(1)</sup> The quality of the radio depends on the coverage of the radio station in that particular area.

<sup>(2)</sup> Depending on your network operator and market.

<sup>(3)</sup> Depending on your network operator. May cause additional network charges for data flow to provide this service. Extra fees might also be charged in roaming states.

## 9.2 Image viewer.....

A library links to the images in "My creations" in cellphone to be shown in list, slide, or thumbnail, set as Wallpaper, Power on/off display, and Contact ID, or sent by MMS, Email, Bluetooth.

### 9.3 Video player.....

"My videos" album contains video clips recorded, received or downloaded. All video clips in this folder can be played, set as Power on/off display, sent, deleted, renamed, sorted.

### 9.4 Radio.....

Your cellphone is equipped with a radio<sup>(1)</sup> with RDS<sup>(2)</sup> functionality. You can use the application as a traditional radio with saved channels or with parallel visual information related to the radio program on the display if you tune to stations that offer Visual Radio service. You can listen to it while running other applications.

## 10 Internet<sup>(3)</sup>.....

### 10.1 Opera.....

Not only does Opera Mini give you the full Web experience where you stay in touch with your friends, obtain information, do your online banking etc., but it is also designed to save time by using compressed web pages.

<sup>(1)</sup> The quality of the radio depends on the coverage of the radio station in that particular area.

<sup>(2)</sup> Depending on your network operator and market.

<sup>(3)</sup> Depending on your network operator. May cause additional network charges for data flow to provide this service. Extra fees might also be charged in roaming states.

## 10.2 Wap.....

Access Wap options: **Homepage, Bookmarks, Go to URL, Last web address, Recent pages, Offline pages, Service inbox, Settings**.

### 10.3 News.....

It is a huge time saver providing news updates from a website in a simple form. Once subscribed to a channel, it gives you the ability to track and manage all your favorite RSS content on your cellphone at anytime, anywhere!

### 10.4 Weather.....

Your cellphone is equipped with a weather function for consulting up to 3-day forecasts of favorite cities.

### 10.5 Facebook.....

Facebook is a social utility that connects people with friends and others who work, study and live around them. It provides a number of features with which users may interact: Wall, a space on every user's profile page that allows friends to post messages for the user to see; Pokes, which allow users to send a virtual "poke" to each other; Gifts, a feature allowing users to send virtual gifts which appear on the recipient's profile; Market places, which lets users post free classified goods, etc. To open an account online, please go to: <http://www.facebook.com/>.

### 10.6 mTweet.....

Twitter is a social networking and microblogging service that has gained notability and popularity worldwide. This feature enables cellphone users to exchange news updates and ideas with a community in the form of messages or posts. Posts are displayed on the author's profile page and delivered to the author's subscribers or followers. To open an account online, please go to: <http://twitter.com/>.

### 1.2.2 Status list

Touch the status bar and drag down to open, drag up to close.

To open an application, touch it from the list.

### 1.2.3 Toolbar

Toolbar with 4 fixed shortcuts to access **Main menu, Calls, Message, Edit Home screen**.

### 1.2.4 Personalize your home screen

#### Adding items

To add an item, touch and hold an empty area of the Home screen or select from the toolbar.

**Add shortcuts** To add a shortcut to the Home screen, such as Alarm, Bookmarks, Contacts, etc.

**Add widgets** To add a widget to the Home screen, such as the World clock, Music player, etc.

#### Editing/Removing/Re-organizing items

Press and hold the application on the Home screen to edit/remove/re-organize it, touch to edit (only for my favorites), touch to remove. Touch and hold the application and drag it to the location you desire, and then confirm by touching "Done".

#### Customizing wallpaper

To personalize your wallpaper, you can select one of the following two ways:

• Touch and hold an empty area from the Home screen, select "Wallpaper", then touch a folder to select an image as your wallpaper.

• Touch from the tool bar, select "Wallpaper", then touch a folder to select an image as your wallpaper.

## 2 Getting started.....

### 2.1 Set-up

#### Removing or installing the back cover



#### Inserting or removing the SIM card

You must insert your SIM card to make phone calls. Please power off your cellphone and remove battery before inserting or removing the SIM card.



Place the SIM card with the chip facing downwards and slide it into its housing. Make sure that it is correctly inserted. To remove the card, press and slide it out.

#### Installing or removing the battery

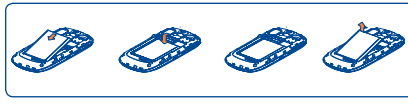

- Insert and click the battery into place, then close the cellphone cover.
- Unclip the cover, then remove the battery.

### Charging the battery

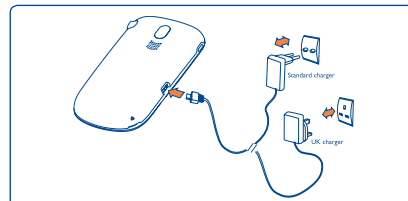

Connect the battery charger to your cellphone and outlet respectively.

To reduce power consumption and energy waste, when battery is fully charged, disconnect your charger from the plug; switch off Bluetooth or background-running applications when not in use; reduce the backlight time, etc.

### 2.2 Power on your cellphone

Hold down the key until the cellphone powers on.

### 2.3 Power off your cellphone

Hold down the key from the Home screen.

### 2.4 Using the touchscreen

**Touch** To access an application, touch it with your finger.

**Drag** Place your finger on the screen to drag the object to the destination.

**Scroll** Slide the screen to scroll up and down the applications, images, web pages... at your convenience.

### Inserting the SD card:



- Unclip the cover and insert the MicroSD card into the slot.
- Unclip the cover and gently push the SD card until unlocked. Take out your MicroSD card and clip the cover closed.

## 15 Bluetooth™.....

Access this feature by touching to enter the main menu, then selecting "Bluetooth".

## 16 Others.....

### 16.1 Calendar.....

Once you enter this menu from the main menu, there is a monthly-view calendar for you to keep track of important meetings, appointments, etc. Days with events entered will be marked in color.

### 16.2 Calculator.....

Access this feature by selecting "Calculator" from the main menu. Enter a number, select the type of operation to be performed, and enter the second number, then press "=" to display the result.

<sup>(1)</sup> Depending on your network operator.

<sup>(2)</sup> Depending on your model.



### 16.3 Notes.....

You can create a note in text or voice format by accessing "Notes" from the main menu.

### 16.4 Tasks .....

Enables you to easily manage and track the progress of a task with priorities. All the tasks will be sorted by due date.

### 16.5 Clock .....

#### 16.5.1 Alarm

Your cellphone has a built-in alarm clock with a snooze feature.

#### 16.5.2 World clock

The World clock shows current local time and the time zone in different cities.

#### 16.5.3 Date and time

Allows you to have settings of date and time, including 12/24h format.

### 16.6 Converter .....

You can use the Weight and Length conversion by selecting the unit you wish to convert via <img alt="arrow icon"/>, then touch to input the digits. Finally confirm with "OK".

## 17 Settings .....

From the main menu, select the menu icon <img alt="gear icon"/> and select the function of your choice in order to customize your cellphone: **Phone settings, Call settings, Security, Network, Connectivity.**

#### Touch settings

- **LCD touch calibration** To calibrate the touch screen, touch anywhere on the screen to start calibration.
- **Touch vibration** When "On", the cellphone vibrates when the screen is touched.

#### Screen lock during call

Select "On"/"Off" to activate/deactivate screen lock during call.

#### Service selection <sup>(1)</sup>

- **GSM/GPRS** Only GSM/GPRS network service is available.
- **WCDMA** Only WCDMA network service is available.
- **Dual mode** Both GSM/GPRS and WCDMA network service are available, with priority to WCDMA.

19

<sup>(1)</sup> Only for 3G network.

## 18 Making the most of your cellphone.....

#### PC suite

You can download software upgrade for free from the website. The PC suite includes:

- **Backup/restore** You can backup the important data in your cellphone and restore them when needed.
- **3G (WCDMA)/EDGE/GPRS modem** Use your cellphone to connect PC to the internet.
- **Multimedia Personalization** Customize your cellphone with images, animations and melodies.
- **Message**

#### Supported Operating Systems

Windows 2000/XP/Vista/Windows 7.

#### One Touch Upgrade

Using One Touch Upgrade tool you can update your cellphone's software from your PC.

Download One Touch Upgrade from ALCATEL website (www.alcatelonetouch.com) and install it on your PC. Launch the tool and update your cellphone by following the step by step instructions (refer to the User Guide provided together with the tool). Your cellphone's software will now have the latest software.



All personal information will be permanently lost following the update process. We recommend you backup your personal data using PC Suite before upgrading.

20

#### Webcam <sup>(1)</sup>

You can use your cellphone as a webcam for instant message on your PC.

- Connect your cellphone to PC via USB cable.
- Go to "My computer" folder on your PC and find USB video device (Under Scanners & Cameras).

## 19 Latin input mode .....

There are two text entry methods that can be used to write messages

- Normal: this mode allows you to type a text by choosing a letter or a sequence of characters associated with a key.
- TouchPal mode: This mode can perform predictive input in virtual keypad and supports multi-language input.

#### Touch inputting

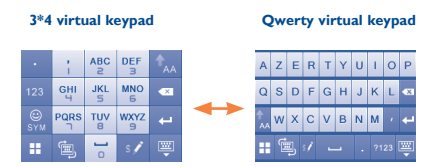

(Slide horizontally to switch between the two types of keypad)

<sup>(1)</sup> The using of webcam may vary according to the operating system of your PC.

21

## General information .....

- **Website:** www.alcatelonetouch.com
- **Facebook:** www.facebook.com/alcatelmobilephones
- **Twitter:** http://www.twitter.com/alcatel1touch
- **Hot Line Number:** In the United States, call 877-702-3444 for technical support.

On our Internet site, you will find our FAQ (Frequently Asked Questions) section. You can also contact us by e-mail to ask any questions you may have.

An electronic version of this user guide is available in English and other languages according to availability on our server: www.alcatelonetouch.com. Your cellphone is a transceiver that operates on GSM/GPRS/EDGE in quad-band with 850/900/1800/1900 MHz or UMTS in dual-band with 850/1900 MHz.

#### Protection against theft <sup>(1)</sup>

Your cellphone is identified by an IMEI (cellphone serial number) shown on the packaging label and in the product's memory. We recommend that you note the number the first time you use your cellphone by entering \*#06# and keep it in a safe place. It may be requested by the police or your operator if your cellphone is stolen.

#### Disclaimer

There may be certain differences between the user manual description and the cellphone's operation, depending on the software release of your cellphone or specific operator services.

TCT Mobile shall not be held legally responsible for such differences, if any, nor for their potential consequences, which responsibility shall be borne by the operator exclusively.

<sup>(1)</sup> Contact your network operator for service availability.

## Alcatel Mobile Phones Limited Warranty .....

TCT Mobile North America LTD warrants to the original retail purchaser of this wireless device, that should this product or part thereof during normal consumer usage and condition, be proven to be defective in material or workmanship that results in product failure within the first twelve (12) months from the date of purchase as shown on your original sales receipt. Such defect(s) will be repaired or replaced (with new or rebuilt parts) at the company's option without charge for parts or labor directly related to the defect(s).

Batteries, power adapters, and other accessories sold as in box items are also warranted against defects and workmanship that results in product failure within the first six (6) months period from the date of purchase as shown on your original sales receipt. Such defect(s) will be repaired or replaced (with new or rebuilt parts) and the company's option without charge for parts or labor directly related to the defect(s).

The limited warranty for your wireless device will be voided if any of the following conditions occur:

- Non-compliance with the instructions for use or installation, or with technical and safety standards applicable in the geographical area where your cellphone is used;
- Connection to any equipment not supplied or not recommended by TCT Mobile;
- Modification or repair performed by individuals not authorized by TCT Mobile or its affiliates;
- Acts of god such as Inclement weather, lightning, power surges, fire, humidity, infiltration of liquids or foods, chemical products, download of files, crash, high voltage, corrosion, oxidation;
- Removal or altering of the wireless devices event labels or serial numbers (IMEI);
- Damage from exposure to water or other liquids, moisture, humidity, excessive temperatures or extreme environmental conditions, sand, excess dust and any condition outside the operating guidelines;
- Defects in appearance, cosmetic, decorative or structural items such as framing and non-operative parts.

There are no express warranties, whether written, oral or implied, other than this printed limited warranty or the mandatory warranty provided by your jurisdiction. In no event shall TCT Mobile or any of its affiliates be liable for incidental or consequential damages of

22

any nature whatsoever, including but not limited to commercial loss, to the full extent those damages can be disclaimed by law. Some states do not allow the exclusion or limitation of incidental or consequential damages, or limitation of the duration of implied warranties, so the preceding limitations or exclusions may not apply to you.

How to obtain Support: Contact the customer care center by calling (877-702-3444) or going to www.alcatelonetouch.com. We have placed many self-help tools that may help you to isolate the problem and eliminate the need to send your wireless device in for service. In the case that your wireless device is no longer covered by this limited warranty due to time or condition we have other options that you may utilize out of warranty repair options.

To obtain hardware repairs or replacement within the terms of this warranty, contact TCT Mobile to get an RMA number, include a copy of the original proof of warranty coverage (e.g. original copy of the dated bill of sale, invoice), the consumer's return address, your wireless carrier's name, alternate daytime cellphone number, and email address with a complete problem description. Only ship the wireless device. Do not ship the SIM card, memory cards, or any other accessories such as the power adapter. You must properly package and ship the wireless device to the repair center. TCT Mobile is not responsible for wireless devices that do not arrive at the service center. Upon receipt, the service center will verify the warranty conditions, repair, and return your wireless device to the address provided.

My cellphone will not switch on

- Press <img alt="power key icon"/> until the screen comes on
- Check the battery charge level
- Check the battery contacts, remove and reinstall your battery, then turn your cellphone back on

My cellphone has not responded for several minutes

- Press <img alt="power key icon"/> key
- Remove the battery and re-insert it, then switch the cellphone back on

My screen is difficult to read

- Clean your screen
- Use your cellphone in accordance with the recommended conditions of use

My cellphone turns off by itself

- Check that your keypad is locked when you are not using your cellphone
- Check the battery charge level

My cellphone will not charge properly

- Make sure that your battery is not completely discharged; If the battery is flat, it may take around 20 minutes to display the battery charger indicator on the screen
- Make sure charging is carried out under normal conditions (0°C (32°F) +40°C (104°F))
- Make sure your battery is inserted. It must be inserted before plugging in the charger
- Make sure you are using an Alcatel battery and charger in the box
- When abroad, check that the electrical current is compatible

Prolonged exposure to music at full volume on the music player may damage the listener's hearing. Set your cellphone volume safely. Use only headphones recommended by TCT Mobile Limited and its affiliates.

23

## Safety and use.....

We recommend that you read this chapter carefully before using your cellphone. The manufacturer disclaims any liability for damage, which may result as a consequence of improper use or use contrary to the instructions contained herein.

#### TRAFFIC SAFETY:

Given that studies show that using a cellphone while driving a vehicle constitutes a real risk, even when the hands-free kit is used (car kit, headset...), drivers are requested to refrain from using their cellphone when the vehicle is not parked. Check the laws and regulations on the use of wireless cellphones and their accessories in the areas where you drive. Always obey them. The use of these devices may be prohibited or restricted in certain areas.

When driving, do not use your cellphone and headphone to listen to music or to the radio. Using a headphone can be dangerous and forbidden in some areas. When switched on, your cellphone emits electromagnetic waves that can interfere with the vehicle's electronic systems such as ABS anti-lock brakes or airbags. To ensure that there is no problem:

- do not place your cellphone on top of the dashboard or within an airbag deployment area,
- check with your car dealer or the car manufacturer to make sure that the car's electronic devices are shielded from cellphone RF energy.

#### CONDITIONS OF USE:

You are advised to switch off the cellphone from time to time to optimize its performance.

Remember to abide by local authority rules of cellphone use on aircrafts. Operational Warnings: Obey all posted signs when using mobile devices in public areas.

Follow Instructions to Avoid Interference Problems: Turn off your mobile device in any location where posted notices instruct you to do so. In an aircraft, turn off your mobile device whenever instructed to do so by airline staff. If your mobile device offers an airplane mode or similar feature, consult airline staff about using it in flight.

Switch the cellphone off when you are in health care facilities, except in designated areas. As with many other types of equipment now in regular use, cellphones can interfere with other electrical or electronic devices, or equipment using radio frequency. Switch the cellphone off when you are near gas or flammable liquids. Strictly obey all signs and instructions posted in a fuel depot, gas station, or chemical plant, or in any potentially explosive atmosphere.

When the cellphone is switched on, it should be kept at least 15 cm from any medical device such as a pacemaker, a hearing aid or insulin pump. In particular when using the cellphone you should hold it against the ear on the opposite side to the device, if any.

Switch mode of input method.

Switch between ABC/abc/Abc.

Access to the symbol and number table.

Access to all symbols.

- Touch once to delete one by one.

- Long touch to delete all.

Options for more operations.

Press and hold 0-9 to input number.

- Confirm an option.

- Switch to a new line (in SMS, Email, etc.).

Close input keypad.

Switch between 3\*4 virtual keypad and Qwerty virtual keypad.

Switch between 3\*4 virtual keypad and Qwerty virtual keypad.

Switch between 3\*4 virtual keypad and Qwerty virtual keypad.

Switch between 3\*4 virtual keypad and Qwerty virtual keypad.

Switch between 3\*4 virtual keypad and Qwerty virtual keypad.

Switch between 3\*4 virtual keypad and Qwerty virtual keypad.

Switch between 3\*4 virtual keypad and Qwerty virtual keypad.

Switch between 3\*4 virtual keypad and Qwerty virtual keypad.

24

Read and follow the directions from the manufacturer of your implantable medical device. If you have any questions about using your mobile device with your implantable medical device, consult your healthcare provider. To avoid hearing impairment, answer the call before holding your cellphone to your ear. Also move the handset away from your ear while using the "hands-free" option because the amplified volume might cause hearing damage. It is recommended to have proper supervision while small children use your cellphone. When replacing the cover please note that your cellphone may contain substances that could create an allergic reaction. Always handle your cellphone with care and keep it in a clean and dust-free place. Do not allow your cellphone to be exposed to adverse weather or environmental conditions (moisture, humidity, rain, infiltration of liquids, dust, sea air, etc.). The manufacturer's recommended operating temperature range is -10°C (14°F) to +55°C (131°F) (the max value depends on device, materials and housing paint/texture). Over 55°C (131°F) the legibility of the cellphone's display may be impaired, though this is temporary and not serious. Do not open or attempt to repair your cellphone yourself. Do not drop, throw or try to bend your cellphone. Do not paint it.

Use only batteries, battery chargers, and accessories which are recommended by TCT Mobile Limited and its affiliates and are compatible with your cellphone model. TCT Mobile Limited and its affiliates disclaim any liability for damage caused by the use of other chargers or batteries.

Your cellphone should not be disposed of in a municipal waste. Please check local regulations for disposal of electronic products. Remember to make back-up copies or keep a written record of all important information stored in your cellphone.

Some people may suffer epileptic seizures or blackouts when exposed to flashing lights, or when playing video games. These seizures or blackouts may occur even if a person never had a previous seizure or blackout. If you have experienced seizures or blackouts, or if you have a family history of such occurrences, please consult your doctor before playing video games on your cellphone or enabling a flashing-lights feature on your cellphone. Parents should monitor their children's use of video games or other features that incorporate flashing lights on the cellphones. All persons should discontinue use and consult a doctor if any of the following symptoms occur: convulsion, eye or muscle twitching, loss of awareness, involuntary movements, or disorientation. To limit the likelihood of such symptoms, please take the following safety precautions:

- Play at the farthest distance possible from the screen.
- When you play games on your cellphone, you may experience occasional discomfort in your hands, arms, shoulders, neck, or other parts of your body. Follow these instructions to avoid problems such as tendonitis, carpal tunnel syndrome, or other musculoskeletal disorders:

Take a minimum of a 15-minute break every hour of game playing.

If your hands, wrists, or arms become tired or sore while playing, stop and rest for several hours before playing again.

If you continue to have sore hands, wrists, or arms during or after playing, stop the game and see a doctor.

Prolonged exposure to music at full volume using the music player may damage your hearing. Set your cellphone's volume to its lowest setting prior to inserting headphones in your ears and adjust the volume to your preference. Only use headphones that are recommended by TCT Mobile Limited and its affiliates.

Privacy: Please note that you must respect the laws and regulations in force in your jurisdiction or other jurisdiction(s) where you will use your cellphone regarding taking photographs and recording sounds with your cellphone. Pursuant to such laws and regulations, it may be strictly forbidden to take photographs and/or to record the voices of other people or any of their personal attributes, and reproduce or distribute them, as this may be considered to be an invasion of privacy.

It is the user's sole responsibility to ensure that prior authorization be obtained, if necessary, in order to record private or confidential conversations or take a photograph of another person; the manufacturer, the seller or vendor of your cellphone (including the operator) disclaim any liability which may result from the improper use of the cellphone.

BATTERY AND ACCESSORIES: Before removing the battery from your cellphone, please make sure that the cellphone is switched off.

Observe the following precautions for battery use:

- Do not attempt to open the battery (due to the risk of toxic fumes and burns).
- Do not puncture, disassemble or cause a short-circuit in a battery.
- Do not burn or dispose of a used battery in the garbage or store it at temperatures above 60°C (140°F).

Batteries must be disposed of in accordance with locally applicable environmental regulations. Only use the battery for the purpose for which it was designed. Never use damaged batteries or those not recommended by TCT Mobile Limited and/or its affiliates.

This symbol on your cellphone, the battery and the accessories means that these products must be taken to collection points at the end of their life:

- Municipal waste disposal centers with specific bins for these items of equipment
- Collection bins at points of sale.

They will then be recycled, preventing substances being disposed of in the environment, so that their components can be reused.

My cellphone will not connect to a network

- Try connecting in another location
- Verify the network coverage with your operator
- Check with your operator that your SIM card is valid
- Try selecting the available network(s) manually
- Try connecting at a later time if the network is overloaded

SIM card error

- Make sure the SIM card has been correctly inserted
- Verify with your operator that your SIM card is 3V or 1,8V compatible; the old 5V SIM cards cannot be used
- Make sure the chip on your SIM card is not damaged or scratched

Touch screen does not respond

- Make sure your cellphone is not locked.
- Launch LCD touch calibration (Settings>Phone settings>Touch settings>LCD touch calibration)

Unable to make outgoing calls

- Make sure you have dialled a valid number and press the <img alt="call key icon"/> key
- For international calls, check the country and area codes
- Make sure your cellphone is connected to a network, and that the network is not overloaded or unavailable
- Check your subscription status with your operator (credit, SIM card valid, etc.)
- Make sure you have not barred outgoing calls

Unable to receive incoming calls

- Make sure your cellphone is switched on and connected to a network (check for overloaded or unavailable network)
- Check your subscription status with your operator (credit, SIM card valid, etc.)
- Make sure you have not forwarded incoming calls
- Make sure that you have not barred certain calls

The caller's name does not appear when a call is received

- Check that you have subscribed to this service with your operator
- Your caller has concealed his/her number

The sound quality of the calls is not optimal

- You can adjust the volume during a call by means of the Volume key
- Check the network strength <img alt="signal strength icon"/>

25

Take a minimum of a 15-minute break every hour of game playing.

If your hands, wrists, or arms become tired or sore while playing, stop and rest for several hours before playing again.

If you continue to have sore hands, wrists, or arms during or after playing, stop the game and see a doctor.

Prolonged exposure to music at full volume using the music player may damage your hearing. Set your cellphone's volume to its lowest setting prior to inserting headphones in your ears and adjust the volume to your preference. Only use headphones that are recommended by TCT Mobile Limited and its affiliates.

Privacy: Please note that you must respect the laws and regulations in force in your jurisdiction or other jurisdiction(s) where you will use your cellphone regarding taking photographs and recording sounds with your cellphone. Pursuant to such laws and regulations, it may be strictly forbidden to take photographs and/or to record the voices of other people or any of their personal attributes, and reproduce or distribute them, as this may be considered to be an invasion of privacy.

It is the user's sole responsibility to ensure that prior authorization be obtained, if necessary, in order to record private or confidential conversations or take a photograph of another person; the manufacturer, the seller or vendor of your cellphone (including the operator) disclaim any liability which may result from the improper use of the cellphone.

BATTERY AND ACCESSORIES: Before removing the battery from your cellphone, please make sure that the cellphone is switched off.

Observe the following precautions for battery use:

- Do not attempt to open the battery (due to the risk of toxic fumes and burns).
- Do not puncture, disassemble or cause a short-circuit in a battery.
- Do not burn or dispose of a used battery in the garbage or store it at temperatures above 60°C (140°F).

Batteries must be disposed of in accordance with locally applicable environmental regulations. Only use the battery for the purpose for which it was designed. Never use damaged batteries or those not recommended by TCT Mobile Limited and/or its affiliates.

This symbol on your cellphone, the battery and the accessories means that these products must be taken to collection points at the end of their life:

- Municipal waste disposal centers with specific bins for these items of equipment
- Collection bins at points of sale.

They will then be recycled, preventing substances being disposed of in the environment, so that their components can be reused.

My cellphone will not connect to a network

- Check with your operator to make sure that your subscription includes this service
- Check that your feature does not require an Alcatel accessory

When I select a number from my contacts, the number is not dialed

- Make sure that you have correctly recorded the number in your file
- Make sure that you have selected the country prefix when calling a foreign country

I am unable to add a contact in my contacts

- Make sure that your SIM card contacts is not full; delete some contacts or save the contacts in the cellphone contacts (i.e. your professional or personal directories)

My callers are unable to leave messages on my voicemail

- Contact your network operator to check service availability

I cannot access my voicemail

- Make sure your operator's voicemail number is correctly entered in "My numbers"
- Try later if the network is busy

I am unable to send and receive MMS

- Check your cellphone memory available as it might be full
- Contact your network operator to check service availability and check MMS parameters
- Verify the server center number or your MMS profile with your operator
- The server center may be swamped; try again later

The flickering <img alt="flickering icon"/> icon is displayed on my standby screen

- You have saved too many short messages on your SIM card; delete some of them or archive them in the cellphone memory

"No service" is displayed

- You are outside of the network coverage area

I have already entered 3 incorrect PIN codes

- Contact your network operator to obtain the PUK code (Personal Unlocking Key)

26

In European Union countries: These collection points are accessible free of charge. All products with this sign must be brought to these collection points.

In non European Union jurisdictions: Items of equipment with this symbol are not to be thrown into ordinary bins if your jurisdiction or your region has suitable recycling and collection facilities; instead they are to be taken to collection points for them to be recycled.

In the United States you may learn more about CTIA's Recycling Program at www.recyclewrelessphones.com

CAUTION: RISK OF EXPLOSION IF BATTERY IS REPLACED BY AN INCORRECT TYPE. DISPOSE OF USED BATTERIES ACCORDING TO THE INSTRUCTIONS

CHARGERS: Home A.C./Travel chargers will operate within the temperature range of 0°C (32°F) to 40°C (104°F). The chargers designed for your cellphone meet with the standard for safety of information technology equipment and office equipment use. Due to different applicable electrical specifications, a charger you purchased in one jurisdiction may not work in another jurisdiction. They should be used for this purpose only.

Characteristics of power supply (depending on the country):

Travel charger: Input: 100-240 V, 50/60 Hz, 0.15 A Output: 5 V, 400/550 mA Lithium 850 mAh

Battery: RADIO WAVES: THIS CELLPHONE MEETS THE GOVERNMENT'S REQUIREMENTS FOR EXPOSURE TO RADIO WAVES.