

Quick Start Guide

For more information about how to use the phone, please go to www.alcatelonetouch.com to download complete user manual (English version only). Also on our website you can find helpful FAQs (English version only).

Prolonged exposure to music at full volume on the music player may damage the listener's hearing. Set your phone volume safely. Use only headphones recommended by TCT Mobile Limited and its affiliates.

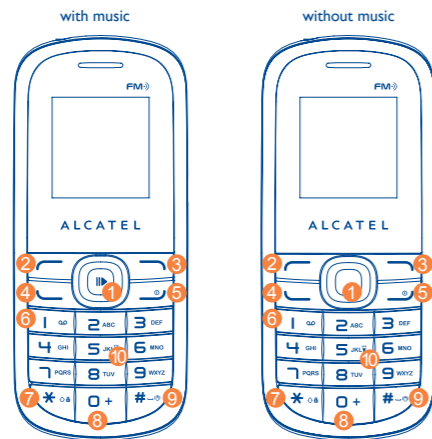

1.1 Keys

- 1 Navigation key
 - Central / :
 - Confirm an option (press)
 - Access main menu (press in idle screen)
 - Access Music (press and hold in idle screen) ⁽¹⁾
 - Left ⁽²⁾ :
 - Alarm (press in idle screen)
 - Right ⁽³⁾ :
 - File manager (press in idle screen)
 - Up ⁽⁴⁾ :
 - Messaging (press in idle screen)
 - Down ⁽⁵⁾ :
 - Calendar (press in idle screen)
- 2 Left softkey ⁽²⁾: Menu (press in idle screen)
- 3 Right softkey ⁽³⁾: Contacts (press in idle screen)
- 4 Send a call
 - Answer a call
 - Access call log
 - Access fake call settings (press and hold in idle screen)
- 5 Power on/off the handset (press and hold)
 - End call
 - Return to idle screen
- 6 In idle screen:
 - Press: input "I"
 - Press and hold: access your voicemail
 - In edit mode:
 - Press: insert a smart punctuation
 - Press and hold: input "I"

⁽¹⁾ Only available for the handset with music.
⁽²⁾ Could be personalized.

- 7 In idle screen:
 - Press: input "*"#
 - Press and hold: lock the keypad
 - In edit mode:
 - Press: switch input method
 - Press and hold: switch languages
- 8 In idle screen:
 - Press: input "0"
 - Press and hold: switch among "+" "P" "W"
 - In edit mode:
 - Press: access symbol table (words mode)
 - Press and hold: input "0"
- 9 In idle screen:
 - Press: input "#"
 - Press and hold: activate/deactivate the vibrator
 - In edit mode:
 - Press: input a space
 - Press and hold: add a word
- 10 In idle screen:
 - Press: dial "5"
 - Press and hold: switch on/off the torch

1.2 Main screen icons ⁽¹⁾

- Battery charge level**
- Vibrate alert:** your phone vibrates, but does not ring or beep.
- Headset connected.**
- Keypad locked.**
- Alarm or appointments programmed.**
- Missed calls.**

⁽¹⁾ The icons and illustrations in this guide are provided for information purposes only.

- Radio is on.**
- WAP alert ⁽¹⁾.**
- MicroSD Card available.**
- Roaming.**
- SIM card missing.**
- Sending a MMS.**
- MMS receiving.**
- Silence mode:** your phone does not ring, beep or vibrate.
- SMS unread.**
- MMS unread.**
- Flight mode.**
- Call forwarding activated:** your calls are forwarded.
- Level of network reception.**
- Voicemail message arrived.**
- GPRS connection status (Activated).**
- GPRS connecting.**
- Stopwatch is active.**

⁽¹⁾ Depending on your network operator.

Inserting the memory card:

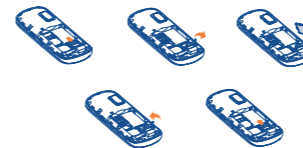

To release the microSD holder, slide it in the direction of the arrow and lift it. Then insert the microSD card with the golden contact downward. Finally, turn down the microSD holder and slide it in the opposite direction to lock it.

Do not support hot plugging for microSD card.

11.3 Games

Your phone includes some games. Select "Game settings", it allows you to manage settings, in which you may set background audio and vibrate alert.

11.4 Alarm

Your mobile phone has a built-in alarm clock with a snooze feature.

11.5 Voice reminder

After accessing **Voice reminder** from the main menu by selecting "ToolsVoice reminder", you may select **Create voice reminder** to record a sound file. Then you may set the date, time, mode, etc. If you select **Directly play** mode, the recorded sound file will play automatically as the voice reminder at the very time and date you have set.

⁽¹⁾ The quality of the radio depends on the coverage of the radio station in that particular area.

2 Getting started.....

2.1 Set-up

Removing and installing the back cover



Removing and installing the battery



Inserting and removing the SIM card



Place the SIM card with the chip facing downwards and slide it into its housing. Make sure that it is correctly inserted. To remove the card, press it and slide it out.

Charging the battery ⁽¹⁾

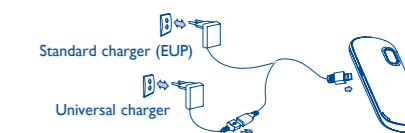

Connect the battery charger to your phone and outlet respectively.

- The charging may take about 20 minutes to start if the battery is flat.
- Be careful not to force the plug into the socket.
- Make sure the battery is correctly inserted before connecting the charger.
- The outlet must be near to the phone and easily accessible (avoid electric extension cables).
- When using your telephone for the first time, charge the battery fully (approximately 3 hours). You are advised to fully charge the battery ().
- To reduce power consumption and energy waste, when battery is fully charged, disconnect your charger from the plug; reduce the backlight time, etc.

The charge is complete when the animation stops.

2.2 Power on your phone

Hold down the key until the phone powers on.

2.3 Power off your phone

Hold down the key from the main screen.

⁽¹⁾ Depending on your country.

3 Calls.....

3.1 Making a call

Dial the desired number then press the key to place the call. If you make a mistake, you can delete the incorrect digits by pressing the right softkey.

To hang up the call, press the key.

Making an emergency call

If your phone is covered by the network, dial emergency number and press the key to make an emergency call. This works even without a SIM card and without typing the PIN code or unlocking the keypad.

3.2 Calling your voicemail ⁽¹⁾

To access your voicemail, hold down the key.

3.3 Receiving a call

When you receive an incoming call, press the key to talk and then hang up using the key.

3.4 Available functions during the call

During a call, you can use your directory, your calendar, text messages, etc. without hanging up or dropping the call.

⁽¹⁾ Contact your network operator to check service availability.
English - CJB24B1ALAAA

4 Contacts.....

4.1 Consulting your contacts

To access the **contacts** from the main screen, press the / key and select the icon from the menu.

4.2 Adding a contact

Select the directory in which you wish to add contact, press the "Options" softkey, select "Add contact".

5 Messaging.....

5.1 Create message

From the main menu select "Messaging" to create text/multimedia message. You can type a message and you can also modify a predefined message in **Templates** or customize your message by adding pictures, photos, sounds, titles, etc (only available while editing a MMS). While writing a message, select "Options" to access all the messaging options. You can save your messages that you often send to **Draft** or **Templates** (MMS only).

Specific letters (accent) will increase the size of the SMS, this may cause multiple SMS to be sent to your recipient.

6 Call log.....

You can access your call memory by pressing from the idle screen, and you will see **Outgoing call(s)**, **Missed call(s)** and **Answered call(s)**.

7 Torch.....

To activate Torch by below operations: Press and hold key to deactivate/activate it (in idle screen); Access to the main menu and select "Torch".

8 Profiles.....

With this menu, you may personalize ringtones for different events and environments.

9 Music ⁽¹⁾.....

Access this feature from the main menu by selecting "Music". You will have full flexibility of managing music both on your mobile and memory card.

⁽¹⁾ Only available for the handset with music.

10 Camera.....

Your mobile phone is fitted with a camera for taking photos that you can use in different ways:

- store them in your "ToolsFile managerMy creations".
- send them in a multimedia message (MMS) to a mobile phone.
- customize your main screen.
- select them as incoming call image to a contact in your directory.

11 Tools.....

11.1 FM Radio

Your phone is equipped with a radio ⁽¹⁾ with RDS functionality. You can use the application as a traditional radio with saved channels or with parallel visual information related to the radio program on the display if you tune to stations that offer Visual Radio service. You can listen to it while running other applications.

11.2 File manager

You will have access to all audio and visual files stored in phone or memory card in **File manager**. You can access a number of items with this option: **My audios**, **My images**, **My creations**, **Other files**, **Memory card** and **Memory status**.

⁽¹⁾ The quality of the radio depends on the coverage of the radio station in that particular area.

