

User manual



VF-895N

© Vodafone Group 2015. Vodafone and the Vodafone logos are trade marks of Vodafone Group. Any product or company names mentioned herein may be the trade marks of their respective owners.

DCA6197ALAAA

Table of Contents

1	Your phone	4
1.1	Keys and connectors	4
1.2	Getting started	7
1.3	Home screen	10
2	Text input	20
2.1	Using the onscreen keyboard	20
2.2	Text editing	21
3	Phone call, Call log & People	22
3.1	Phone call	22
3.2	Recents	29
3.3	People	29
4	Messaging & Email	36
4.1	Messaging	36
4.2	Gmail/Email	42
5	Calendar , Alarm clock & Calculator	45
5.1	Calendar	45
5.2	Clock	47
5.3	Calculator	48
6	Getting connected	50
6.1	Connecting to the Internet	50
6.2	Chrome	53
6.3	Connecting to Bluetooth devices	53

6.4	Connecting to a computer via USB	54
6.5	To safely remove the microSD card from your phone	55
6.6	Sharing your phone's mobile data connection	56
6.7	Connecting to virtual private networks	57
7	Google Play Store	58
8	Multimedia applications	59
8.1	Camera	59
8.2	Gallery	61
8.3	Play music	64
8.4	Videos	65
9	Google Maps	66
9.1	Get My Location	66
9.2	Search for a location	67
9.3	Save a location	67
9.4	Open Street View for a location	68
9.5	Get driving, public transportation or walking directions	68
10	Others	69
10.1	File Manager	69
10.2	Sound Recorder	69
10.3	Radio	70
11	Settings	72
11.1	Wireless & networks	72

11.2	Device.....	75
11.3	Tap & pay	79
11.4	Personal.....	79
11.5	System.....	84
12	Update your phone's software	87
13	Product safety information	88
14	Telephone warranty	101
15	Accessories	103
16	Specifications.....	104

1 Your phone

1.1 Keys and connectors

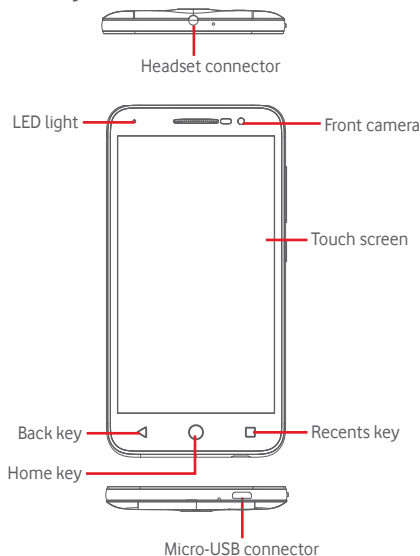

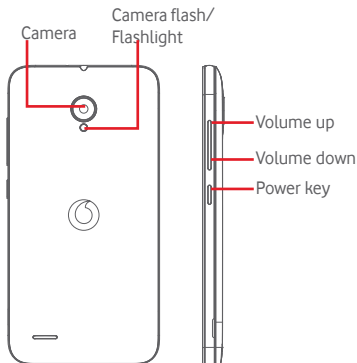

Recents key

- Touch: this shows you images of your recently-used apps. Touch an image to open the associated app, or swipe it left or right to remove it from the list.

Home key

- While on any app or screen, touch the Home key to return to the main Home screen.
- Touch & hold this key to access Google Now & Voice Search.

Back key

- Touch to go back to the previous screen, or to close a dialogue box, options menu, the Notification panel, etc.

These keys are visible once you touch the key position when the screen lights up.

Power key

- Press: activate the lock screen/wake up the screen.
- Press and hold: show the pop-up menu to select from **Shut down, Restart, Airplane mode**. Press and hold: power on.
- Press and hold the **Power** key and the **Volume down** key to capture a screenshot.

Volume keys

- During a call, they adjust the earpiece or headset volume.
- In Music/Video/Streaming mode, they adjust the media volume.
- In general mode, they adjust the ringtone volume.
- Mute the ringtone of an incoming call.

1.2 Getting started

1.2.1 Set-up

Removing or installing the back cover

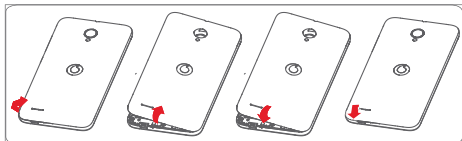

Inserting or removing the SIM card

You must insert your SIM card to make phone calls.

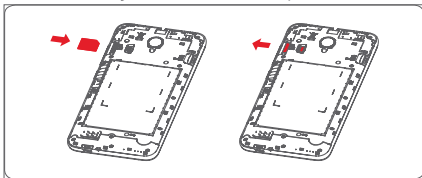

Place the SIM card with the chip facing downwards and slide it into its housing. Make sure that it is correctly inserted. To remove the SIM card, press and slide it out.



Your phone only supports micro-SIM card. Do not attempt to insert other SIM types like mini and nano cards, otherwise you may damage your phone.

Installing the microSD card

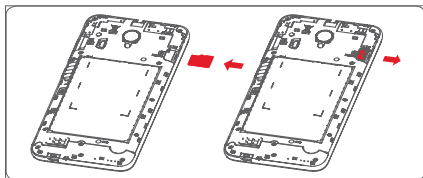

Place the microSD card with the chip facing downwards and slide it into its housing. Make sure that it is correctly inserted. To remove the microSD card, press and slide it out.

Charging the battery

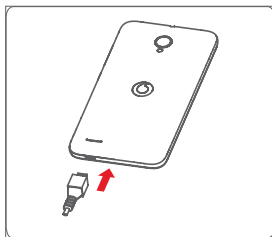

To charge the battery, connect the charger to your phone and mains socket. You can also charge your phone via a USB cable.



To reduce energy wastage, disconnect your charger from the plug when the battery is fully charged.

To reduce your phone's power consumption, switch off Wi-Fi, GPS, Bluetooth or apps running in the background when not needed. In Settings you can also lower the brightness of the screen, and shorten the length of time before the screen goes to sleep.

1.2.2 Power on your phone

Hold down the **Power** key until the phone powers on. It will take a few seconds before the screen lights up. Unlock your phone (Swipe, PIN, password or pattern) if necessary and confirm. The Home screen will display.

If you do not know your PIN code or if you have forgotten it, contact your network operator. Do not leave your PIN code with your phone. Store this information in a safe place when not in use.

Set up your phone for the first time

The first time you power on the phone you will be asked to set the following options: language, mobile data, Google account, date & time, etc.

- 1 Select the phone's language, then touch **Next**.
- 2 Select **Wi-Fi**, then touch **Skip**.
3. Select **Date & time**, then touch **Next**.
4. Select **Name**, then touch Next.
5. Select **Google services**, then touch **Next**.
6. Select a **home screen**, then touch **Next**.
7. Select **Help tips**, then touch **Next**.

Then your phone is setup and ready to use.

If you power on your phone with no SIM card inserted, you will still be able to connect to a Wi-Fi network to sign into your Google account and to use some features.

1.2.3 Power off your phone

Hold down the **Power** key from the Home screen until the Phone options appear, then select **Shut down**.

1.3 Home screen

The device provides two kinds of home screen style, standard home screen and simple home screen for your choices.

You could set at the first time you start the device or always set by touching **Settings > Home**.

In simple home screen, all the features you need, presented in an intuitive and attractive design.

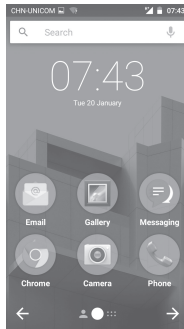

You can bring all your favourite items (apps, shortcuts, folders and widgets) to your Home screen for quick access. Touch the **Home** key to switch to the Home screen.

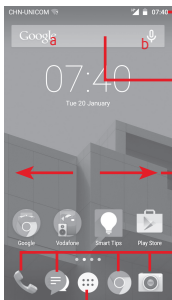

Status bar

- Status/Notification indicators
- Touch and drag down to open the Notification panel

Google Search bar

- Touch **a** to enter text search screen
- Touch **b** to enter voice search screen

Slide left or right to view other panels on the Home screen

Favourite tray apps

- Touch to enter the app
- Touch and hold to move or change apps

Application tab

- Touch to open All apps

The Home screen extends on either side of the screen to allow more space for adding apps, shortcuts, etc. Slide the Home screen horizontally left and right to get a complete view of the Home screen. The white spot in the lower part of the screen indicates which screen you are viewing. In standard home screen, slide right to access flipboard and your favourite apps. Flipboard allows you to quick access to your personalized news and social networks, You could set by touching **Settings > Display > Favourite applications**.

1.3.1 Using the touchscreen

Touch

To access an app, touch it with your finger.

Touch and hold

Touch and hold the Home screen to access the available options for setting the wallpaper.

Drag

Touch and hold an item to be able to drag it to another location.

Slide/Swipe

Slide the screen to scroll up and down lists, screens of apps, images, web pages, etc.

Flick

Similar to swiping, but flicking makes it move quicker.

Pinch/Spread

Place your fingers of one hand on the screen surface and draw them apart or together to scale an element on the screen.



















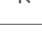



Rotate

Automatically change the screen orientation from portrait to landscape by turning the phone sideways.



























1.3.2 Status bar

From status bar, you can view both phone status (on the right side) and notification information (on the left side).

Status icons

	GPRS connected		No SIM card inserted
	EDGE connected		Vibrate mode
	3G connected		Ringer is silenced
	HSDPA (3G) connected		Phone microphone is mute
	HSPA (3G) connected		Battery is very low
	4G connected		Battery is low
	Connected to a Wi-Fi network		Battery is partially drained
	Bluetooth is on		Battery is full
	Connected to a Bluetooth device		Battery is charging
	Airplane mode		Headset connected
	Alarm is set		Roaming
	GPS is on		Signal strength

Notification icons

	New Gmail™ message		Call in progress
	New text or multimedia message		Missed call
	Problem with SMS or MMS delivery		Call on hold
	New Hangouts message		Call forwarding is on
	New voicemail		Uploading data
	Upcoming event		Download finished
	Data is synchronising		Carrier data use threshold approaching or exceeded
	No microSD card installed		An open Wi-Fi network is available
	Song is playing		Phone is connected via USB cable
	Screenshot error		Radio is on
	USB tethering is on		System update available
	Portable Wi-Fi hotspot is on		Connected to VPN
	Screenshot captured		International Roaming is enabled
	More notifications are hidden		International Roaming is disabled

Notification panel

Touch and drag down the Status bar to open the Quick setting panel and drag down again to open the Quick setting panel. Touch and drag up to close it. From the Notification panel, you can open items and other reminders indicated by notification icons or view wireless service information.

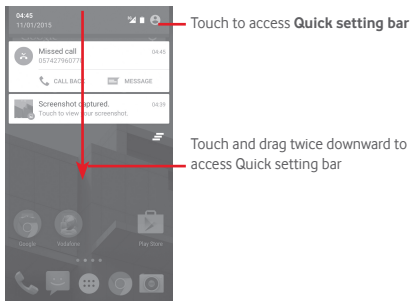

Touch a notification and slide it sideways to delete it.

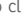
Touch the icon  to clear all event-based notifications (other ongoing notifications will remain).

Touch  and then the Settings icon  to access **Settings**.

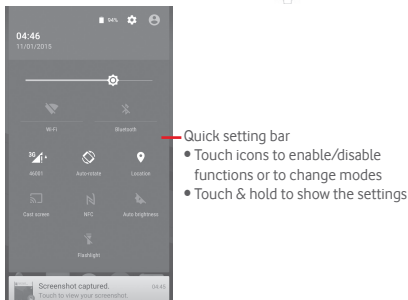

1.3.3 Search bar

The phone provides a Search function which can be used to locate information within applications, the phone or the web.

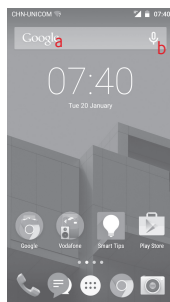

a Search by text

- Touch Search bar from the Home screen.
- Enter the text/phrase you want to search for.
- Touch  on the keyboard if you want to search on the web.

b Search by voice

- Touch  from Search bar to display a dialog screen.
- Speak the word/phrase you want to search for. A list of search results will display for you to select from.

1.3.4 Lock/Unlock your screen

To protect your phone and privacy, you can lock your phone screen with a variety of patterns, PIN or password, etc. through **Settings > Security > Screen lock**.

To create a screen unlock pattern (Follow onscreen instructions)

- Touch **Settings > Security > Screen lock > Pattern**.
- Draw your own pattern.

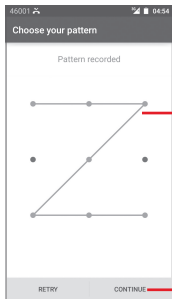

Draw your unlock pattern

Touch to confirm by drawing pattern again

To create a screen unlock PIN/Password

- Touch **Settings > Security > Screen lock > PIN or Password**.
- Set your PIN or password.

To lock phone screen

Press the **Power** key once to lock the screen.

To unlock phone screen

Press the **Power** key once to light up the screen or double tap to wake⁽¹⁾ the screen, draw the unlock pattern you have created or enter PIN or password to unlock the screen.

If you have chosen Swipe as the screen lock, slide upward to unlock the screen, slide left to access Camera and slide right to access Phone.

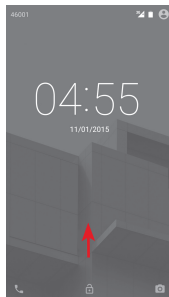

1.3.5 Personalise your Home screen

Add an app or widget

Touch the Application tab (⋮), then touch and hold the app or widget to activate the Move mode, and drag the item to any Home screen.

Reposition an app or widget

Touch and hold the item to be repositioned to activate the Move mode, drag the item to the desired position and then release. You can move items both on the Home screen and the Favourites tray. Hold the icon on the left or right edge of the screen to drag the item to another Home screen.

⁽¹⁾ The function must be enable first by touching **Settings > Display** and then enable **Double tap to wake**.

Remove

Touch and hold the item to be removed to activate the Move mode, drag the item up to the top of **Remove** icon, and release after the item turns red.

Create folders

To make it easier to organise apps and shortcuts on the Home screen and the Favourite tray, you can add them to a folder by stacking one item on top of another. To rename a folder, open it and touch the folder's title bar to input the new name.

Wallpaper customisation

Touch and hold an empty area on the Home screen or go to **Settings > Display > Wallpaper** to customise your wallpaper.

1.3.6 Volume adjustment

Using volume key

Press **Volume** key to adjust the volume. To activate the vibrate mode, press the **Volume down** key until the phone vibrates. Press the **Volume down** key once more to activate the silent mode.

Using Settings menu

Drag down twice from the notification panel and touch the settings icon  to enter **Settings**, then touch **Sound & notification**, you can set the volume of calls, notification, system and etc. to your preference.

2 Text input

2.1 Using the onscreen keyboard

Onscreen keyboard settings

Touch the Application tab from the Home screen, select **Settings > Language & input**.

Adjust the onscreen keyboard orientation



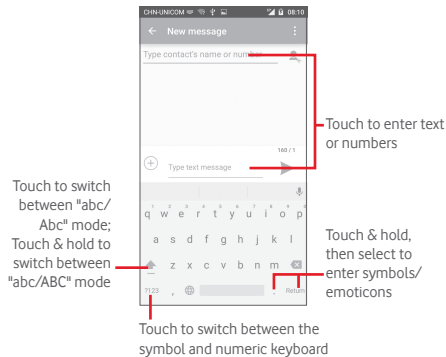

Turn the phone sideways or upright to adjust the Onscreen Keyboard orientation. You can also adjust it by changing the settings (go to **Settings > Display > When device is rotated>Rotate contents of the screen**).

2.1.1 Android keyboard



2.2 Text editing

You can edit the text you have entered.

- Touch and hold or double-tap on the text you would like to edit.
- Drag the tabs to change the highlighted selection.
- The following options will show: **Select all** , **Cut** , **Copy**  and **Paste** .
- Touch the icon  to confirm.

You can also insert new text

- Touch where you want to type, or touch and hold a blank space, the cursor will blink and the tab will show. Drag the tab to move the cursor.
- If you have selected any text, touch the tab to show **PASTE** icon which allows you to paste any text you have previously copied.

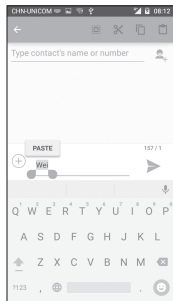

3 Phone call, Call log & People



3.1 Phone call

3.1.1 Placing a call

You can easily make a call using **Phone**. Touch the Application tab from the Home screen and select **Phone**.

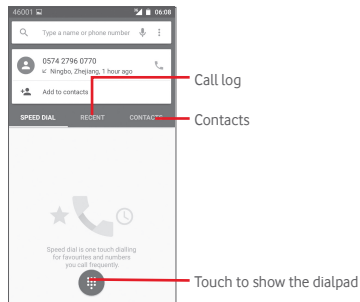

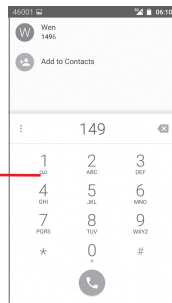

Touch and hold to access voicemail





Enter the number you want from the dialpad directly or select a contact from **People** or **Recents** by touching tabs, then touch  to place the call.

The number you entered can be saved to **People** by touching  key or **Add to contacts**.

If you make a mistake, you can delete the incorrect digits by touching .

To hang up a call, touch .

International call

To dial an international call, touch and hold  to enter "+", then enter the international country prefix followed by the full phone number and finally touch .

Emergency call

If your phone has network coverage, dial emergency number and touch  to make an emergency call. This works even without a SIM card and without typing the PIN code.

3.1.2 Answering or rejecting a call

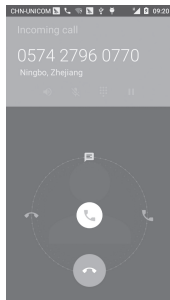

When you receive a call, touch .

- Slide the icon right to answer the call;
- Slide the icon left to reject the call;
- Slide the icon up to reject the call by sending a preset message.

To mute incoming calls, press the **Volume up/down** key directly

3.1.3 Calling your voicemail

Your voicemail is provided by your network to avoid missing calls. It works like an answering machine that you can consult at any time.

To access your voicemail, touch and hold  on **Phone** tab.

To set your voicemail number, touch  key and touch **Settings > Call settings > Voicemail**.

If you receive a voicemail, a voicemail icon  appears on the Status bar. Open the Notification panel, touch **New voicemail**.

3.1.4 During a call

To adjust the volume during a call, press the **Volume up/down** key.

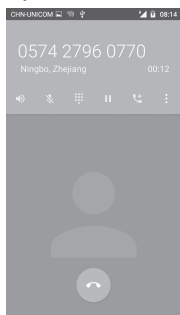



 Touch to hold the current call. Touch this icon again to retrieve the call.

 Touch to display Dialpad.

 Touch to end the current call.

 Touch to mute the current call. Touch this icon again to unmute the call.

 Touch to activate the speaker during the current call. Touch this icon again to deactivate the speaker.

 Touch to add the number to new contact.









To avoid misoperation on touchscreen during a call, screen will be locked automatically when you put the cellphone close to your ear; and it will be unlocked when the cellphone is taken away from your ear.

3.1.5 Managing multiple calls

With this phone you can handle multiple calls at the same time.

Conference calls ⁽¹⁾

You can set up a conference call.

- Place a call to the first participant of the conference call.
- Touch .
- Enter the phone number of the person you want to add to conference and touch . You can also add participants from **People** or **Recents**.
- Touch icon  to start a conference call.
- During a conference call, touch  to drop a participant or to talk privately to one of the participants. Touch  to drop the participant from the conference, touch  to talk privately to the participant and hold on other participants.
- Touch  to end the conference call and disconnect all callers.

⁽¹⁾ Depending on your network operator.

3.1.6 Call settings

Touch  key and select **Settings** from Phone screen, the following options are available:

General settings

• Contacts display options

- Sort by** Touch to set the contacts display by First name or Last name.
- Name format** Touch to set the name format by First name first or Last name first.

• Sounds and vibrate

- Phone ringtone** Touch to set the ringtone of phone.
- Dialpad tones** Mark the checkbox to activate the dialpad tones.
- Also vibrate for calls** Mark the checkbox to activate vibration when the call is connected.

• Other

- Quick responses** Touch to edit quick responses which will be used when you reject a call with messages.

Call settings

• Voicemail

- Service** Opens a dialog box where you can select your carrier's voicemail service or another service.
- Setup** If you are using your carrier's voicemail service, this opens a dialog box where you can enter the phone number to use for listening to and managing your voicemail.
- Sound** Touch to select the notification sound.
- Vibrate** Mark the check box to enable vibration when the call is connected.

• Fixed Dialling Numbers

Fixed Dialling Number (FDN) is a service mode of SIM, where outgoing calls are restricted to a set of phone numbers. These numbers are added to the FDN list. The most common practical application of FDN is for parents to restrict the phone numbers which their children can dial.

For security reasons, you'll be prompted to enable FDN by entering SIM PIN2 which is usually acquired from your service provider or SIM maker.

• Service Dialling Numbers

You can place a call from the SDN list.

• TTY mode

TTY mode can be used by people who are deaf, have poor hearing or speech impairments. Touch to set TTY mode.

• DTMF tones

Dual Tone Multi-Frequency, or DTMF is a method for instructing a telephone switching system of the telephone number to be dialed, or to issue commands to switching systems or related telephony equipment. Touch to enable DTMF tones. Touch to set the length of DTMF tones.

• GSM call settings

Additional GSM only call settings:

- Call forwarding** Touch to configure how your calls are always forwarded or when you are busy, unanswered or unreachable.

Additional settings

- Caller ID** Opens a dialog box where you can set whether your phone number is displayed when making calls.
- Call waiting** Mark the check box to notify you of a new incoming call.

- **CDMA call settings**

Additional GSM only call settings:

Voice privacy Mark the checkbox to enhance privacy mode.



3.2 Recents

You can view your call history by touching **RECENTS** from the Phone screen to view call history.

Touch a contact or number to view information or further operations.

You can view detailed information of a call, launch a new call or send messages to a contact or number, or add numbers to **People** (only available for unsaved phone numbers), etc.

Touch the photo  to open the Quick Contact panel.

To clear the entire call memory, touch  key from the phone screen and touch **Call history**, then touch  and then touch **Clear call log**.

3.3 Contacts



You can view and create contacts on your phone and synchronise these with your Gmail contacts or other apps on the web or on your phone.



When using People for the first time you are asked to add new contacts, import contacts from your SIM card or synchronise contacts from other app accounts to your phone.

3.3.1 View your contacts

To access **People** app, touch the Application tab on the Home screen, then select **People**.

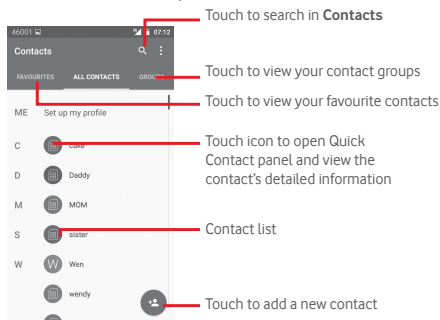



Touch  key to display contacts list option menu.

Following actions are enabled:

- **Contacts to display** Choose contacts to display.
- **Import/Export** Import or export contacts between phone, SIM card, and microSD card, or share contacts.
- **Accounts** Manage the synchronisation settings for different accounts.
- **Settings** Access to contact display settings.
- **Delete contact** Select and delete unwanted contacts.

3.3.2 Managing contact groups

The contact group helps you to improve the organisation of your contacts. You can add, remove and view groups in the **Contact group** screen.

Touch **GROUPS** to view local groups. To create a new group, touch the icon , enter the new name and touch  to confirm. If you have added accounts to your phone, touch the icon  to view groups in accounts.

3.3.3 Adding a contact

Touch the Application tab on the Home screen, select the **People**, then touch the icon  in the contact list to create a new contact.

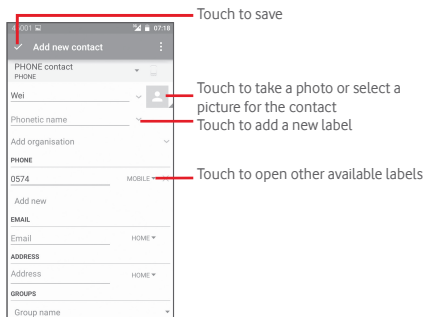

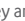

If you want to add more information, touch **Add another field** to add a new category.

When finished, touch  to save.

To exit without saving, you can touch  key and then **Discard**.

Add to/remove from Favourites



To add a contact to favourites, you can touch a contact to view details then touch  to add the contact to favourites.

To remove a contact from favourites, touch  on contact details screen.



Only phone and account contacts can be added to favourites.

3.3.4 Editing your contacts

To edit contact information, touch  key in the contact details screen. When finished, touch .



Change a contact's default phone number

The default phone number (the number which has priority when making a call or sending a message) will always be displayed under the contact name.

To change the default phone number, touch and hold the number you want to set as the default number from the contact's details screen, then select **Set default**. A  appears after the number.

This choice is only available when the contact has more than one number.

Delete a contact

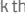
To delete a contact, touch  key from the phone screen and touch **Delete**. Select the contact(s) you want to remove and touch  to confirm. Touch **All** and then  to delete all contacts, mark the checkbox again to exit.



The contact you have deleted will also be removed from other applications on the phone or web the next time you synchronise your phone.

3.3.5 Communicating with your contacts

From contact details screen, you can communicate with your contacts by making a call or exchanging messages.

To launch a call, touch the phone number.

To send a message, touch the icon  on the right side of the number.

Use Quick Contact for Android

Touch a contact's picture to open Quick Contact for Android, then you can touch the number or the icon  for the way you want to connect.

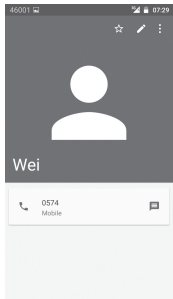

The icons available on Quick Contact panel depend on the information you have for the contact and the applications/accounts on your phone.

3.3.6 Importing, exporting and sharing contacts

From the Contacts screen, touch  key to open the options menu, touch **Import/export**, then select to import/export contacts from/to your SIM card, Phone, microSD card, Phone storage, Accounts, etc.

To import/export a single contact from/to your SIM card, choose an account and target SIM card, select the contact you want to import/export, and touch  to confirm.

To import/export all contacts from/to your SIM card, choose an account and target SIM card, touch **All** and touch  to confirm.

You can share a single contact or contacts with others by sending the contact's vCard to them via Bluetooth, Gmail, etc.

To do this, touch a contact you want to share, touch  key and **Share** from contact details screen, then select the app to perform this action.



3.3.7 Displaying contacts

You can configure which group of contacts, for each account, you want to display in the People list. Touch  key and then **Contacts to display** from contacts list screen, then you can choose contacts to display.



Touch  key and then **Settings**, you can **Sort by** First name or Last name, as well as **Name format** as First name first or Last name first.

3.3.8 Joining/Discarding contacts

To avoid duplication, you can add any new contact information to existing contacts in a single action.

Touch the contact which you want to add information to, touch  key, then touch  key in edit screen and touch **Join**.

At this time, you are required to select the contact whose information you want to join with the first contact. The information from the second contact is added to the first one, and the second contact will no longer be displayed in the contacts list.

To separate contact information, touch the contact whose information you want to separate, touch  key, then touch  key in edit screen and touch **Separate**, touch  to confirm.

3.3.9 Synchronising contacts in multiple accounts

Contacts, data or other information can be synchronised from multiple accounts, depending on the apps installed on your phone.

To add an account, touch  on Quick setting bar to get to **Settings**, then touch **Account > Add account**.

You are required to select the kind of account you are adding, like Google, Corporate, etc.

As with other account set-ups, you need to enter detailed information, like username, password, etc.

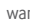
You can remove an account and all associated information from the phone. Open the **Settings** screen, touch the account you want to delete, touch  key and then select **Remove account**, then confirm.

Sync

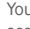
You can synchronise an account on **Accounts** screen, touch an account in the list, then touch  key and select **Sync now**.

4 Messaging & Email



4.1 Messaging

Your phone can create, edit and receive SMS and MMS messages. Touch the Application tab from the Home screen, then select **Messaging**.

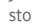

All messages you receive or send out can be saved in your phone memory or SIM card. To view SMS messages stored on your SIM card, touch  key from Messaging screen, then touch **Settings > Manage SIM card messages**.

4.1.1 Create a new message

On the message list screen, touch the new message icon  to write new text/multimedia messages.

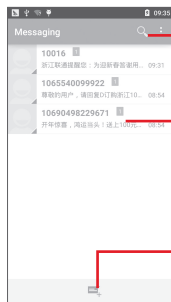



Touch to search in all messages

- Touch to view the whole message thread
- Touch & hold message threads to delete messages or to add shortcut

Touch to create a new message

Sending a text message

Enter the mobile phone number of the recipient on the **Type contact's name or number** bar or touch  to add recipients, then touch the **Type text message** bar to enter the text of the message. When you've finished, touch  to send the text message.





An SMS of more than 160 characters will be charged as several SMS. Specific letters (like accents, for example) will also increase the size of the SMS, so this may cause multiple SMS to be sent to your recipient.

Sending a multimedia message

MMS enables you to send video clips, images, photos, animations, slides and audio to other compatible phones and e-mail addresses.

An SMS will be converted to MMS automatically when media files (image, video, audio, slides, etc.) are attached or Subject or email addresses are added.

To send a multimedia message, enter the recipient's phone number in the **Type contact's name or number** bar, touch **Type text message** bar to enter the text of the message, touch  key to open the option menu, touch **Add subject** to insert a subject, and touch  to attach picture, video, audio and so on.

When finished, touch  to send the multimedia message.

Attach options:

- **Pictures** Access Gallery or File manager to select a picture as attachment.
- **Videos** Access Gallery or File manager to select a video as attachment.
- **Audio** Access music from **Ringtone** or **Audio**.
- **Contact vCard** Access **People** to select one or more contact(s) to attach.
- **Slideshow** Enter Edit slide show screen, touch **Add slide** to create a new slide, and touch currently existing slide to edit it (see following picture). Touch  to get more options, like slide duration setting, music adding, etc.
- **Events** Access **Calendar** to select one or more event(s) to attach.

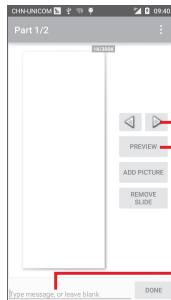

Touch to go to previous or next slide

Touch to preview current slide

Touch to edit the title of this slide

4.1.2 Manage messages

When a new message comes, an icon  will appear on status bar as notification. Drag down the status bar to open the Notification panel, touch the new message to open it. You can also access **Messaging** and touch the new message to open it.

Messages are displayed in conversational order.

To reply to a message, touch the current message to enter message-composing screen, enter the text, then touch .

Touch and hold a message in message details screen, the following options will be available:

- **Copy text** This option only available for SMS. Touch to copy current message content and past it to **Type text message** bar of the new message you are going to compose.
- **Forward** Touch to forward the message to another recipient.
- **Lock/Unlock** Touch to lock/unlock message.
- **View details** Touch to view details of the message.
- **Delete** Delete the current message.

4.1.3 Adjust message settings

In message list screen, touch  key and select **Settings**.

SMS Enabled

Touch to change your default SMS app.

SMS bearer

Touch to set the type of bearer.

Storage

- **Delete old messages** Mark to delete old messages when the maximum number of stored messages is reached.
- **Text message limit** Touch to set the number of text messages to be saved per conversation.
- **Multimedia message limit** Touch to set the number of multimedia messages to be saved per conversation.

Text (SMS) messages

- **Delivery reports** Mark to request a delivery report for each text message you send.
- **Manage SIM card messages** Touch to view or manage messages on your SIM card.
- **Alphabet management** Touch to select the Alphabet mode.

Multimedia (MMS) messages

- **Delivery reports** Select to request a delivery report for each multimedia message you send.
- **Read reports** Select to request a report on whether each recipient has read a multimedia message sent by you.
- **Send read report** Select to request a report on whether the multimedia message is sent out.

- **Auto-retrieve** Select to download full MMS message (including message body and attachment) automatically to your phone. Otherwise, download only the MMS message header.
- **Roaming auto-retrieve** Select to download full MMS message (including message body and attachment) automatically when roaming. Otherwise, download only the MMS message header to avoid extra charges.

Notifications

- **Notifications** Select to display message notifications in status bar.
- **Sound** Touch to select a ringtone as a new message notification tone.
- **Vibrate** Select to vibrate when receiving a new message.

4.2 Gmail/Email

The first time you set up your phone, you can select to use an existing Gmail account or to create a new Email account.

4.2.1 Gmail







As Google's web-based email service, Gmail is configured when you first set up your phone. Gmail on your phone can be automatically synchronised with your Gmail account on the web. Unlike other kinds of email account, each message and its replies in Gmail are grouped in your inbox as a single conversation; all emails are organised by labels instead of folders.

To access Gmail

From the Home screen, touch the Application tab to enter the applications list, then touch **Gmail**.

Gmail displays messages and conversations from one single Gmail account at a time, if you own more than one account, you can add an account by touching  icon and select **Settings** from Inbox screen, then touch **ADD ACCOUNT**. When finished, you can switch to another by touching the account name from Inbox screen, then select the account you want to view.

To create and send emails

- 1 Touch  from Inbox screen.
- 2 Enter recipient(s)'s email address in **To** field.
- 3 If necessary, touch the popup menu icon  **Add Cc/Bcc** to add a copy or a blind copy to the message.
- 4 Enter the subject and the content of the message.
- 5 Touch  icon and select **Attach file** to add an attachment.
- 6 Finally, touch the icon  to send.



7 If you do not want to send the mail out right away, you can touch and then **Save draft** or touch the **Back** key to save a copy. To view the draft, touch your account name to display all labels, then select **Drafts**.

If you do not want to send or save the mail, you can touch and then touch **Discard**.

To add a signature to emails, touch icon and then touch **Settings** from inbox screen, choose an account, then touch **Signature**.

To receive and read your emails

When a new email arrives, you will be notified by a ringtone or vibration, and an icon will appear on Status bar.

Touch and drag down the Status bar to display the Notification panel, touch the new email to view it. Or you can also access the Gmail Inbox label and touch the new mail to read it.

You can search for an email by sender, recipient, subject, etc.

- Touch the icon from Inbox screen.
- Enter the keyword you want to search for in the searching box and touch on the software keyboard.

To reply or forward emails

- **Reply** When viewing an email, touch to reply this mail.
- **Reply all** Touch and select **Reply all** to send message to all people in a mail loop.
- **Forward** Touch and select **Forward** to forward the received mail to other people.

4.2.2 Email

Besides your Gmail account, you can also set-up external email accounts on your phone.

Touch the Application tab from the Home screen, then select **Email**.

An email wizard will guide you through the steps to set up an email account.

- 1 Enter the email address and password of the account you want to set up.
- 2 Touch Next. If the account you entered is not provided by your service provider in the phone, you will be prompted to go to the email account settings screen to enter settings manually. Or you can touch **Manual setup** to directly enter the incoming and outgoing settings for the email account you are setting up.
- 3 Enter the account name and display name in outgoing emails.
- 4 To add another email account, you can touch key and **Settings**. Touch **ADD ACCOUNT** to create a new account.

To create and send emails

- 1 Touch the icon on Inbox screen.
- 2 Enter recipient(s) email address(es) in the **To** field.
- 3 If necessary, touch key and touch **Add Cc/Bcc** to add a copy or a blind copy to other recipients.
- 4 Enter the subject and the content of the message.
- 5 Touch key, then touch **Attach file** to add an attachment.
- 6 Finally, touch to send.
- 7 If you do not want to send the mail right away, you can touch key and **Save draft** or touch the **Back** key to save a copy.

5 Calendar, Alarm clock & Calculator

5.1 Calendar



Use Calendar to keep track of important meetings, appointments, etc.

To access this function, touch the Application tab from the Home screen, then touch **Calendar**.

5.1.1 Multimode view

You can display the Calendar in daily, weekly, monthly, or agenda view.

To change your Calendar view, touch the date title to open a drop-down menu for your options. Touch the icon to return to Today's view.

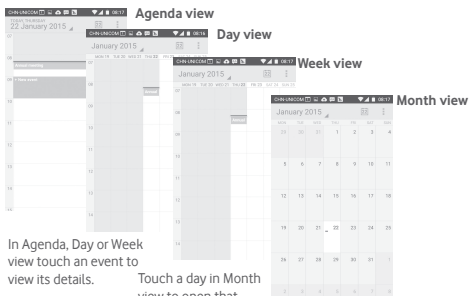

In Agenda, Day or Week view touch an event to view its details.

Touch a day in Month view to open that day's events.

5.1.2 To create new events

You can add new events from any Calendar view.

- Touch in calendar view and select **New event**.
- Fill in all required information for this new event. If it is a whole-day event, you can select **All day**.

When finished, touch **DONE** from the top of the screen.



Before you can add an event, you must add at least one Calendar account and make a calendar visible.

To delete or edit an event

To share, delete or edit an event, touch the event to enter details screen, touch the icon to share the event to other people by Bluetooth, Email and messaging, etc., touch the icon to edit the event, and touch the icon to delete.

5.1.3 Event reminder

If a reminder is set for an event, the upcoming event icon will appear on Status bar as a notification when the reminder time arrives.

Touch and drag down the status bar to open the Notification panel, touch event name to view Calendar notification list.

Touch **Snooze** to turn off all event reminders for 5 minutes.

Touch **Back** key to keep the reminders pending in the status bar and the Notification panel.

Important options by touching  icon from Calendar main screen:

- **Refresh** To refresh the calendar.
- **Search** To search in the calendar.
- **Calendars to display** To show or hide the synchronised calendars.
- **Clear events** To clear events in the calendar.
- **Go to** Select to go to specific date.
- **Settings** To set a series of Calendar settings.

5.2 Clock





Your mobile phone has a built-in clock.

To access this function, touch the Application tab from the Home screen, then touch **Clock**.

Touch  to add or set an alarm.

5.2.1 To set an alarm

From **Clock** screen, touch  to enter **Alarms** screen, touch  to add a new alarm. Following options will show:

- **Time** Touch numbers to set the time for your alarm.
- **Label** Touch to set a name for the alarm.
- **Repeat** Touch to select days you want alarm to work.
- **Ringtone** Touch to select an alarm ringtone.
- **Vibrate** Select to activate vibration.

Touch an already existing alarm and touch  to delete the selected alarm.

5.2.2 To adjust alarm settings

Touch  key from **Alarms** screen. The following options will be available under **Settings**:

Clock

- **Style** Touch to set **Analog** or **Digital** style.
- **Automatic home clock** Touch to set home clock while travelling outside.
- **Home time zone** Touch to set home time zone.

Alarms

- **Silence after** Touch to set time silence.
- **Snooze length** Touch to choose length of snooze.
- **Alarm volume** Touch to set alarm volume.
- **Volume buttons** Touch to choose **Snooze**, **Dismiss** or **Do nothing** as volume buttons.

5.3 Calculator



With Calculator, you can solve many mathematical problems.

To access this function, touch the Application tab from the Home screen, then touch **Calculator**.

There are two panels available: Basic panel and Advanced panel.

To switch between panels, select one of the following two ways:

- Touch and drag the basic screen to the left to open the Advanced panel.
- Or turn the device to the landscape mode from the basic panel to open the Advanced panel⁽¹⁾.

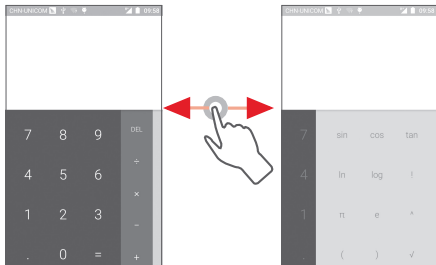

6 Getting connected

Your phone can connect to the Internet using either GPRS/EDGE/3G or Wi-Fi.

6.1 Connecting to the Internet



6.1.1 GPRS/EDGE/3G/4G

The first time you turn on your phone with the SIM card inserted, it will automatically configure a mobile network service: GPRS, EDGE, 3G or 4G. If the network is not connected, you can touch  on the Quick setting bar.

To check the network connection you are using, touch the Application tab on the Home screen, then touch **Settings > More... > Mobile networks > Access Point Names** or **Network operators**.

To create a new access point



A new mobile network connection can be added to your phone with the following steps:

- 1 Touch  on Quick setting bar to get to **Settings**.
- 2 Touch **More... > Mobile networks > Access Point Names**.
- 3 Then touch  key to add new APN.
- 4 Enter the required APN information.
- 5 When finished, touch  key and **Save**.

⁽¹⁾ If "Settings\Display\When device is rotated\Stay in portrait view" is on, this item will not display.

To activate/deactivate Data roaming



When roaming, you can decide to connect/disconnect to a data service.

- 1 Touch  on Quick setting bar to get to **Settings**.
- 2 Touch **More... > Mobile networks**.
- 3 Touch the switch  to activate or deactivate data roaming.
- 4 When Data roaming is deactivated, you can still perform data exchange with a Wi-Fi connection (refer to "6.1.2 Wi-Fi").

6.1.2 Wi-Fi



You can connect to the Internet when your phone is within range of a wireless network. Wi-Fi can be used on your phone even without a SIM card inserted.

To turn Wi-Fi on and connect to a wireless network

- 1 Touch  on Quick setting bar to get to **Settings**.
- 2 Touch the switch  beside Wi-Fi to turn on/off Wi-Fi.
- 3 Touch **Wi-Fi**: detailed information of all detected Wi-Fi networks is displayed in the Wi-Fi networks section.
- 4 Touch a Wi-Fi network to connect to it. If the network you selected is secured, you are required to enter a password or other credentials (contact network operator for details). When you're finished, touch **Connect**.



To activate notification when a new network is detected

When Wi-Fi is on and the network notification is activated, the Wi-Fi icon will appear on the status bar whenever the phone detects an available wireless network within range. The following steps activate the notification function when Wi-Fi is on:

- 1 Touch  on Quick setting bar to get to **Settings**.
- 2 Touch **Wi-Fi**, then  and select **Advanced**.
- 3 Touch the switch  to activate/deactivate this function.

To add a Wi-Fi network

When Wi-Fi is on, you may add new Wi-Fi networks according to your preference.

- 1 Touch  on Quick setting bar to get to **Settings**.
- 2 Touch **Wi-Fi**, and then touch  and select **Add network**.
- 3 Enter the name of the network and any required network information.
- 4 Touch **CONNECT**.

When successfully connected, your phone will be connected automatically the next time you are within range of this network.

To forget a Wi-Fi network

The following steps prevent automatic connections to networks which you no longer wish to use.

- 1 Turn on Wi-Fi, if it's not already on.
- 2 In the Wi-Fi screen, touch & hold the name of the saved network.
- 3 Touch **Forget network** in the dialogue that opens.

6.2 Chrome



Using the Browser you can enjoy surfing the Web.

To get onto the Web, touch the Application tab from the Home screen, then touch **Chrome**.

To go to a web page

On Browser screen, touch the URL box at the top, enter the address of the web page, then touch  to confirm.



 Touch to delete all contents

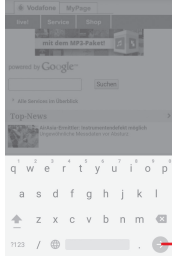



 Touch to search and go to this address

6.3 Connecting to Bluetooth devices



Bluetooth is a short-range wireless communication technology that you can use to exchange data, or connect to other Bluetooth devices for various uses.

To access this function, touch  on Quick setting bar to get to **Settings**, then touch **Bluetooth**, your device and other available ones will show on the screen.

To turn on Bluetooth

- 1 Touch  on Quick setting bar to get to **Settings**.
- 2 Touch  to activate/deactivate this function.

To make your phone more recognizable, you can change your phone name which is visible to others.

- 1 Touch  on Quick setting bar to get to **Settings**.
- 2 Touch **Bluetooth**.
- 3 Touch  key and select **Rename this device**.
- 4 Enter a name, and touch **Rename** to confirm.

To pair/connect your phone with a Bluetooth device

To exchange data with another device, you need to turn Bluetooth on and pair your phone with the Bluetooth device with which you want to exchange data.

- 1 Touch  on Quick setting bar to get to **Settings**.
- 2 Touch **Bluetooth**.
- 3 Touch a Bluetooth device you want to be paired with in the list.
- 4 A dialog will popup, touch **Pair** to confirm.
- 5 If the pairing is successful, your phone connects to the device.

To disconnect/unpair from a Bluetooth device

- 1 Touch  after the device name you want to unpair.
- 2 Touch **Forget**.

6.4 Connecting to a computer via USB

With the USB cable, you can transfer media files and other files between your phone and computer.

To connect:

- Use the USB cable that came with your phone to connect the phone to a USB port on your computer. You will receive a notification that the USB is connected.
- Open the Notification panel and touch **Connected as a media device**, then, in the next dialog, choose the way in which you want to transfer files.



Before using MTP, make sure that the driver (Windows Media Player 11 or higher version) has been installed.

To locate data you have transferred or downloaded in the internal storage:

- 1 Touch the Application tab from the Home screen to open the apps list.
- 2 Touch **File Manager**.

All data you have downloaded is stored in **File Manager**, where you can view media files (videos, photos, music and others), rename files, install apps onto your phone, etc.

6.5 To safely remove the microSD card from your phone



The microSD card can be removed from your phone any time the phone is powered off. To remove the microSD card while the phone is on, you must unmount the storage card from the phone first, to prevent corrupting or damaging the storage card.

To format a microSD card

- 1 Touch  on Quick setting bar to get to **Settings**.
- 2 Touch **Storage**.
- 3 Touch **Unmount SD card**.

You can now safely remove the microSD card from the phone.

To format a microSD card

- 1 Touch  on Quick setting bar to get to **Settings**.
- 2 Touch **Storage**.
- 3 Touch **Erase SD card**, a popup message appears to warn you that the microSD card will erase its contents.
- 4 Touch  to confirm.

6.6 Sharing your phone's mobile data connection



You can share your phone's mobile data connection with a single computer via a USB cable (USB tethering) or with up to eight devices at once by turning your phone into a portable Wi-Fi hotspot or via Bluetooth.





Sharing data may incur additional charges from your network operator. Extra fees may also be charged in roaming areas.

To share your phone's data connection via USB

Use the USB cable that along with your phone to connect the phone to a USB port on your computer.

- 1 Touch  on Quick setting bar to go to **Settings**.
- 2 Touch **More... > Tethering & portable hotspot**.
- 3 Touch the switch  beside **USB tethering** to activate/deactivate this function.

To share your phone's data connection as a portable Wi-Fi hotspot

- 1 Touch  on Quick setting bar to go to **Settings**.
- 2 Touch **More... > Tethering & portable hotspot**.
- 3 Touch the switch  beside **Portable Wi-Fi hotspot** to activate/deactivate this function.

To share your phone's data connection via Bluetooth

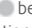
- 1 Touch  on Quick setting bar to go to **Settings**.
- 2 Touch **More... > Tethering & portable hotspot**.
- 3 Touch the switch  beside **Bluetooth tethering** to activate/deactivate this function.

To rename or secure your portable hotspot



When Portable Wi-Fi hotspot is activated, you could change the name of your phone's Wi-Fi network (SSID) and secure its Wi-Fi network.

- 1 Touch  on Quick setting bar to go to **Settings**.
- 2 Touch **More... > Tethering & portable hotspot**.
- 3 Touch **Set up Wi-Fi hotspot** to change the network SSID or set your network security.
- 4 Touch **Save**.

6.7 Connecting to virtual private networks

Virtual private networks (VPNs) allow you to connect to the resources inside a secured local network from outside that network. VPNs are commonly deployed by corporations, schools, and other institutions so that their users can access local network resources when not inside that network, or when connected to a wireless network.

To add a VPN

- 1 Touch  on Quick setting bar to get to **Settings**.
- 2 Touch **More... > VPN** and then touch .
- 3 In the screen that opens, follow the instructions from your network administrator to configure each component of the VPN settings.
- 4 Touch **Save**.

The VPN is added to the list on the VPN settings screen.



Before adding a VPN, you should set a lock screen pattern, PIN code or password for your phone.

To connect/disconnect to a VPN

To connect to a VPN:

- 1 Touch  on Quick setting bar to get to **Settings**.
- 2 Touch **More... > VPN**.
- 3 VPNs you have added are listed; touch the VPN you want to connect with.
- 4 In the dialog that opens, enter any requested credentials and touch **Connect**.

To disconnect:

- Open the Notification panel and touch the resulting notification for VPN disconnection.

To edit/delete a VPN

To edit a VPN:

- 1 Touch  on Quick setting bar to get to **Settings**.
- 2 Touch **More... > VPN**.
- 3 VPNs you have added are listed; touch & hold the VPN you want to edit.
- 4 Touch **Edit profile**.
- 5 After finished, touch **Save**.

To delete:

- Touch and hold the VPN you want to delete, in the dialog that opens, touch **Delete profile**.

7 Google Play Store ⁽¹⁾



Google Play Store is an online software store, where you can download and install applications and games to your Android Powered Phone.

To open Google Play Store:

- Touch the Application tab from the Home screen, then touch **Google Play Store**.
- For the first time you access Google Play Store, a screen with terms of service pops up for your attention, touch **Accept** to continue.

Touch  key and then select **Help** to enter Google Play Store help page for more information on this function.

⁽¹⁾ Depending on your country and operator.

8 Multimedia applications

8.1 Camera



Your mobile phone is fitted with a Camera for taking photos and shooting videos.

Before using the Camera, please be sure to open the protective lens cover before use to avoid it affecting your picture quality.

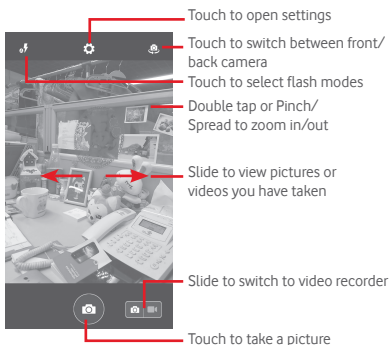

To access this function, touch the Application tab from the Home screen and then touch **Camera**.





To take a picture

The screen acts as the viewfinder. First position the object or landscape in the viewfinder, touch  icon to take the picture which will be automatically saved.

To shoot a video

First position the object or landscape in the viewfinder, and touch  icon to start recording. Touch  to stop recording. The video will be automatically saved.

Further operations when viewing a picture/video you have taken

- Slide left to quick view the picture you taken.
- Touch the  icon then Gmail, Bluetooth, MMS, etc to share the photo or video you have taken.
- Touch the  icon to access the Gallery.
- Touch the Back key to return to the Camera or Camcorder.

8.1.1 Settings in framing mode

Before taking a photo/shooting a video, touch the  icon to adjust a number of settings in framing mode.

Back camera shooting mode

Touch the  icon to access camera settings and below options will display for you to choose from:

- **Panorama** Touch to turn on panorama function. Press the **Shutter** button to start taking panoramic photo and move the phone towards your capture direction and overlap the two lines. Once the nine slots below the screen are filled, the phone will automatically save the photo.
- **Manual** Touch to set the white balance.
- **HDR** Touch to turn on HDR (high-dynamic range) function. HDR photos can better reflect the visual effects people have in the real environment by synthesizing images under different exposure time. The phone will then automatically save the original photos and HDR ones.
- **Sports** Touch to turn on/off sports mode.
- **Night** Touch to turn on/off night mode.

- **Photo size** Touch to set the picture size to Small, Medium or Large.
- **Timer** Set the time to take the picture.
- **Advanced settings** Touch to turn on/off Aspect ratio, GPS tag, Shutter sound, Face detection and etc.

Front camera shooting mode

Switch to front camera, touch the  icon to access camera settings and the following options will display for your choice:

- **Collage** Press the shutton button to take four pictures and format one photo..
- **Aspect ratio** Touch to set the ratio to 16:9 or 4:3.

8.2 Gallery



Gallery acts as a media player for you to view photos and playback videos. In addition, a set of further operations to pictures and videos are available for your choice.

To access this function, touch the Application tab from the Home screen, then touch **Gallery**.

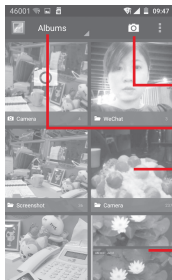

Touch to Switch to **camera**

Touch to select categories:
Albums, Locations, Times

Touch the album to spread it apart

Slide left or right to view
more albums

To view a picture/play a video

Pictures and videos are displayed by albums in **Gallery**.







Touch to return to gallery's main
screen

Slide left or right to view
more pictures

- Touch an album and all pictures or videos will spread the screen.
- Touch the picture/video directly to view or play it.
- Slide left/right to view previous or next pictures/videos.

Working with pictures

You can work with pictures by rotating or cropping them, sharing them with friends, setting them as contact photo or wallpaper, etc.

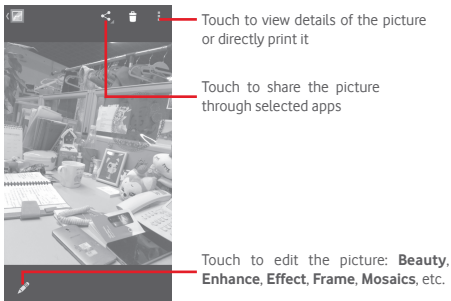

Locate the picture you want to work on, touch the picture from full-screen picture view. Slide the icon bar below left and right to select one, touch icon  to share the picture, edit icon  to edit the picture and touch  icon then select  to delete the picture.



Touch  from full-screen picture view to edit a picture.



- Effect** Touch to set effect of **Lomo, Portrait, Fashion** or **Art**.
- Border** Touch to add border.
- Edit** Touch to **Crop, Rotate** or **Sharpen** the picture.
- Enhance** Touch to open **Toning color** and **Smart fill light**.

 After activating the crop mode, the cropping square appears in the middle of the picture. Select the portion to crop, touch  to confirm and Save, touch  icon to exit without saving.

8.3 Play music



Using this menu, you can play music files stored on the microSD card in your phone. Music files can be downloaded from computer to microSD card using a USB cable.

To access this function, touch the Application tab from the Home screen, then touch **Play Music**.

You will find four categories in which all songs are classified: **GENRES, ARTISTS, ALBUMS** and **SONGS**. Slide left and right to view all. Touch **Shuffle all** to shuffle all songs.

8.3.1 Playing music

Touch a song to play the song.

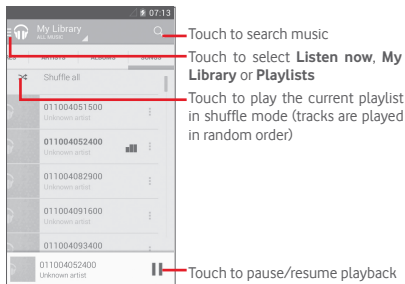

Touch  key to get to **Settings**

GENERAL

Google Account Touch to choose account.
My device Touch to access your music from up to 10 devices.

Equaliser Touch to get to audio settings.

DEVELOPER

Open-source licences Touch to read licences.

Music version Check version of Music.



While playing songs with Music, the operation of pause, play or skip is still available even if the screen is locked.

Touch  from songs to get available options:

Add to queue Touch to add the song into playing queue.

Add to playlist Touch to add to playlist.

Go to artist Touch to go to artist.

Go to album Touch to go to album.

Delete Touch to delete the song.

8.4 Videos



To access this function, touch the Application tab from the Home screen, then touch **Videos**

Videos is a small built-in video player that lists all your videos.

Touch an item from the list to play. While playing, touch a point on the timeline to jump to and play from.

9 Google Maps



9.1 Get My Location

9.1.1 Turn on GPS

To turn on your phone's global positioning system (GPS) satellite receiver:

1 Touch  on Quick setting bar to go to **Settings**.

2 Touch **Location**.

3 Touch the switch beside **Location** and choose location mode you preferred.

9.1.2 Open Google Maps and view My Location

Touch the Application tab from the Home screen, then touch **Maps**.

Touch  icon on the map to view **My Location**.

The map will then center on a blue dot. Your actual position will be at the blue dot.



To move the map, drag the map with your finger.

To zoom in and out of a map, pinch or spread your fingers, or you can also zoom in by double-tapping a location on screen.

9.2 Search for a location

While viewing a map, touch the search icon  to activate search function.

In the search box, enter an address, a city or a local business.

Touch the search icon to search, and in a while your search results will appear on the map as red dots. You can touch one to show a label.

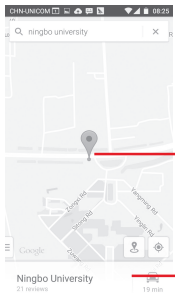

Touch to show more information

Slide left or right to view more search results

9.3 Save a location

Just like bookmarking a web address on the Internet, you can star any position on the map for later use.

9.4 Open Street View for a location

1 Touch and hold a location to display its address at the bottom of the maps screen.

2 Drag up the details screen to sign in to save offline.

3 Touch  icon to display a Street View thumbnail.

9.5 Get driving, public transportation or walking directions

9.5.1 Get suggested routes for your trip

Touch icon  from Maps screen.

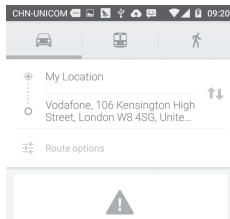

1 Touch enter bar to edit your start point by entering an address or selecting a saved item.

2 Do likewise for your end point.

3 To reverse directions, touch .

4 Then select a transport mode: driving by car, using public transportation, or walking directions.

5 Touch **Route options** to select **Avoid motorways**, **Avoid tolls** or **Avoid ferries**.

6 A couple of suggested routes will appear in a list. Touch any route to view its respective detailed direction.

10 Others

10.1 File Manager



To access this function, touch the Application tab from the Home screen, then touch **File Manager**.

File Manager works with both microSD card and phone storage.

File Manager displays all data stored on both microSD card and phone storage, including applications, media files; videos, pictures or audios you have captured; other data transferred via Bluetooth, USB cable, etc.

When you download an application from PC to microSD card, you can locate the application on File Manager, then touch it to install it in your phone.

File Manager allows you to perform and be really efficient with the following common operations: create (sub) folder, open folder/file, view, rename, move, copy, delete, play, share, etc.

10.2 Sound Recorder



To access this function, touch the Application tab from the Home screen, then touch **Sound Recorder**.

Sound Recorder allows you to record voice/sound for seconds/ hours.

10.3 Radio



Your phone is equipped with a radio ⁽¹⁾. You can use the application as a traditional radio with saved channels or with parallel visual information related to the radio program on the display if you turn to stations that offer Visual Radio service.

To access this function, touch the Application tab from the Home screen, then touch **Radio**.

Please insert a headset to improve the FM Radio reception quality.

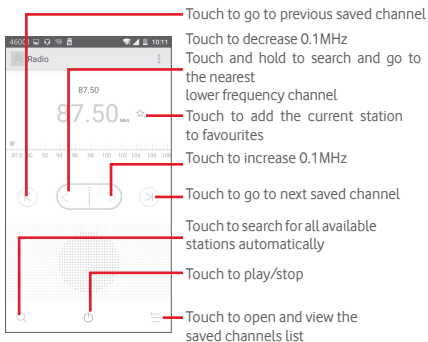

⁽¹⁾ The quality of the radio depends on the coverage of the radio station in that particular area.

Available options:

- **Save channel** Save the current tuned station to the channels list.
- **Audio mode** Listen to the radio using loudspeaker or headset.
- **Delete** Delete the channel.
- **Enter frequency** Enter the frequency manually.
- **Station info** Mark the checkbox to view the station info.
- **Exit** Turn off the radio.

11 Settings



Drag down twice from the Notification panel and touch the Settings icon  to access **Settings**.

11.1 Wireless & networks

11.1.1 Wi-Fi

Using Wi-Fi you can now surf the Internet without using your SIM card whenever you are in range of a wireless network. The only thing you have to do is to enter the **Wi-Fi** screen and configure an access point to connect your phone to the wireless network.

For detailed instructions on using Wi-Fi, please refer to "**6.1.2 Wi-Fi**".

11.1.2 Bluetooth

Bluetooth allows your phone to exchange data (videos, images, music, etc.) in a small range with another Bluetooth supported device (phone, computer, printer, headset, car kit, etc.).

For more information on Bluetooth, please refer to "**6.3 Connecting to Bluetooth devices**".

11.1.3 Data usage

To enable/disable mobile data by touching the switch .

Touch the switch of **Set mobile data limit**, then you can drag the limit line and the warning line according to your limitation. Your mobile data connection will be disabled when the specified limit is reached. You can also choose a data usage cycle to view the statistics and related applications of used data by your phone.

Touch  icon, and you can view more settings related to your data usage.



Data usage is measured by your phone, and your carrier may count differently. Please consider using a conservative limit.

11.1.4 More... \Airplane mode

Through **More... > Airplane mode** to simultaneously disable all wireless connections including Wi-Fi, Bluetooth and more.

You can also open Airplane mode in phone options when pressing **Power** key.

11.1.5 More... \Default SMS app

Choose default app for SMS functions.

11.1.6 More... \NFC

Touch the switch  to allow data exchange when the device touches another device.

11.1.7 More... \Android Beam

When NFC is enabled, it can transmit app content to another device.

11.1.8 More... \Tethering & portable hotspot

This function allows you to share your phone's mobile data connection via USB or as a portable Wi-Fi access point (Please refer to "**6.6 Sharing your phone's mobile data connection**")

11.1.9 More... \VPN

A mobile virtual private network (mobile VPN or mVPN) provides mobile devices with access to network resources and software applications on their home network, when they connect via other wireless or wired networks. Mobile VPNs are used in environments where workers need to keep application sessions open at all times, throughout the working day, as the user connects via various wireless networks, encounters gaps in coverage, or suspend-and-resumes their devices to preserve battery life. A conventional VPN cannot survive such events because the network tunnel is disrupted, causing applications to disconnect, time out, fail, or even the computing device itself to crash.

For more information on VPN, please refer to "**6.7 Connecting to virtual private networks**"

11.1.10 More... \Mobile networks

- **Data roaming**

Touch the switch to connect to data services when roaming.

- **Preferred network mode**

Touch to select preferred network mode.

- **Enhanced 4G LTE Mode**

Touch the switch to enable/disable 4G enhanced function.

- **Access Point Names**

You can select your preferred network with this menu.

- **Network operators**

You can select a network operator.

11.1.11 More... \Emergency broadcasts

Emergency Alert Settings

- **Show extreme threats**

Mark the checkbox to display alerts for extreme threats to life and property.

- **Show severe threats**

Mark the checkbox to display alerts for severe threats to life and property.

- **Show AMBER threats**

Mark the checkbox to display child abduction emergency bulletins.

- **Alert reminder**

Touch to set the alert reminder

- **Vibrate**

Mark the checkbox to activate vibration when alert incoming.

- **Speak alert message**

Mark the checkbox to use text-to-speech to speak emergency alert message.

ETWS Settings

- **Show ETWS test broadcasts**

Mark the checkbox to display test broadcasts for Earthquake Tsunami Warning System.

11.2 Device

11.2.1 Home

Touch to set the home screen style to Standard Home screen or Simple Home screen. Please refer to "**1.3 Home screen**"

11.2.2 Display

- **Home screen** Touch to switch to activate the function of launching favourite app by swiping right.
- **Favourite applications** Touch to set your favourite your application .
- **Double tap to wake** Touch to activate the function of tapping twice to wake when the screen is off.
- **Brightness level** Touch to adjust the brightness of the screen.
- **Adaptive brightness** Touch to optimise brightness level for available light.
- **Wallpaper** Touch to set the wallpaper.
- **Touch key light duration** Touch to set key light duration.
- **Sleep** Touch to set screen timeout.
- **Daydream** Touch to set the daydream.
- **Pulse notification light** Touch to turn on pulse notification light.
- **Font size** Touch to set the font size.
- **When device is rotated** Touch to set whether rotate the contents of the screen or stay in portrait view.
- **Screen share** Touch to activate screen share function.

11.2.3 Sound & notification

Use the Sound settings to configure ringtones for different events and environments.

Sound

- **Also vibrate for calls** Touch to vibrate phone for incoming calls.
- **Interruptions** Touch to set whether interrupt and priority interruptions.
- **Phone ringtone** Touch to set your default incoming call ringtone.

- **Default notification ringtone** Touch to set your default notification ringtone.
- **Other sounds** Touch to set dial pad tones, Screen locking sounds, Touch sounds and Vibrate on touch.

Notification

- **When device is locked** Touch to select whether show all notification content or don't show notification at all when device is locked.
- **App notifications** Touch to set app notifications.
- **Notification access** Touch to view the notification listeners.

11.2.4 Storage

Use these settings to monitor the total and available space on your phone and on your microSD card; to manage your microSD card; and if necessary, to reset the phone, erasing all of your personal information.

If an SD has been detected, the system will remind you that if you want to set the SD card as the preferred storage space for day-to-day use, you can always change the storage location by touch Settings\Storage\Default storage location.

Internal storage

This menu displays the amount of internal phone storage in different colours. The available space will be shown in grey, which shows the amount of internal phone storage used by the operating system, its components, applications (including those you downloaded), permanent and temporary data.



Switching the internal storage location may prevent running applications from accessing data, causing them to malfunction. If a warning message comes up saying that phone memory is limited, you are required to free up space by deleting some unwanted applications, downloaded files, etc.

SD card

Lists the amount of space on any microSD card installed in your phone and the amount you can use to store photos, videos, music, and other files. You can touch one category to access the function and learn more details.

Unmount SD card

You must mount the microSD card before using applications and files in it, or format the microSD card. Unmount the microSD card from your phone so that you can safely remove it when the phone is on.

Erase SD card

Permanently erases everything on a microSD card and prepares it for use with your phone.

11.2.5 Battery

In battery screen you can view the battery usage data since you last connected the phone to a power source. The screen also shows your battery status and how long it has been used since last charging. Touch one category, then you can learn its specific power consumption.

You can adjust power use via the screen brightness or screen timeout in Display screen.

11.2.6 Applications

You use the Applications settings to view details about the applications installed on your phone, to manage their data and force them to stop, and to set whether you want to permit installation of applications that you obtain from web sites and emails.

11.3 Tap & pay

The device allows you to pay with just a tap without worry no cash at hand.

11.4 Personal

11.4.1 Location

Mode

Choose mode for location access.

- **High accuracy** Use GPS, Wi-Fi and mobile networks to determine location.
- **Battery saving** Use Wi-Fi and mobile networks to determine location.
- **Device only** Mark the check box to use GPS to determine your location.

11.4.2 Security

Screen lock

- **None** Touch to disable screen unlock security.
- **Swipe** Touch to enable slide unlock mode.
- **Pattern** Touch to draw pattern to unlock screen.
- **PIN** Touch to enter a numeric PIN to unlock screen.
- **Password** Touch to enter a password to unlock screen.

Owner info

Touch to input owner information which will display on the lock screen.

Smart lock

You must set a screen lock first when you enable this function,

Encrypt phone

You can encrypt your accounts, settings, download apps and their data, media and other files by touching Encrypt phone.

Set up SIM card lock

Choose a SIM card you want to configure.

Mark the checkbox of **Lock SIM card** to lock the SIM card with PIN code.

Touch **Change SIM PIN** to change the PIN code.

Make passwords visible

Mark the checkbox to show passwords as you type.

Device administrators

Touch to view or deactivate device administrators.

App permission

Touch to view or change app permission.

Unknown sources

Mark the checkbox to permit installation of applications that you obtain from web sites, emails, or other locations other than Android Market.

To protect your phone and personal data, download applications only from trusted sources, such as Android Market.

Storage type

Touch to choose storage type for credentials.

Trusted credentials

Touch to display trusted CA certificates.

Install from SD card

Touch to install encrypted certificates from the microSD card.

Clear credentials

Touch to remove all credentials.

Trusted agents

Touch to view or deactivate trusted agents.

Screen pinning

Touch to set screen pinning.

Apps with usage access

Touch to set the app access.

11.4.3 Accounts

Use the settings to add, remove, and manage your Email and other supported accounts. You can also use these settings to control how and whether all applications send, receive, and synchronise data on their own schedules, and whether all applications can synchronise user data automatically.

Add account

Touch to add an account for selected app.

11.4.4 Language & input

Use the Language & input settings to select the language for the text on your phone and for configuring the onscreen keyboard. You can also configure voice input settings and the pointer speed.

Language

Touch to select the language and the region you want.

Spell checker

Mark the checkbox to enable the system to show suggested words.

Personal dictionary

Touch to open a list of the words you've added to the dictionary. Touch a word to edit or delete it. Touch the add button (+) to add a word.

Current Keyboard

Touch to select a default input method.

Voice input

Touch to view settings about voice input

Text-to-speech output

- **Preferred engine**

Touch to choose a preferred text-to-speech engine, touch the Settings icon  to show more choices for each engine.

- **Speech rate**

Touch to open a dialog where you can select how quickly you want the synthesiser to speak.

- **Listen to an example**

Touch to play a brief sample of the speech synthesiser, using your current settings.

Default language status

Touch to show status of default language.

Pointer speed

Touch to open a dialog where you can change the pointer speed, touch **OK** to confirm.

11.4.5 Backup and reset

Back up my data

Mark the checkbox to back up your phone's settings and other application data to Google Servers, with your Google Account. If you replace your phone, the settings and data you've backed up are restored onto the new phone for the first time you sign in with your Google Account. If you mark this option, a wide variety of settings and data are backed up, including your Wi-Fi passwords, bookmarks, a list of the applications you've installed, the words you've added to the dictionary used by the onscreen keyboard, and most of the settings that you configure with the Settings application. If you unmark this option, you stop backing up your settings, and any existing backups are deleted from Google Servers.

Backup account

Touch to back up your account.

Automatic restore

Mark the checkbox to restore your backed up settings or other data when you reinstall an application.

Factory data reset

Erase all of your personal data from internal phone storage, including information about your Google Account, any other accounts, your system and application settings, and any downloaded applications. Resetting the phone does not erase any system software updates you've downloaded or any files on your microSD card, such as music or photos. If you reset the phone in this way, you're prompted to re-enter the same kind of information as when you first started Android.

When you are unable to power on your phone, there is another way to perform a factory data reset by using hardware keys. Press the Volume up key and the Power key at same time until the screen lights up.

11.5 System

11.5.1 Date & time

Use Date & Time settings to customise your preferences for how date and time are displayed.

Automatic date & time

Touch to select Use network/GPS provided time or Off.

Mark the checkbox to use network provided time or use GPS provided time.

Automatic time zone

Mark the checkbox to use network-provided time zone. Or unmark to set all values manually.

Set date

Touch to open a dialog where you can manually set the phone's date.

Set time

Touch to open a dialog where you can manually set the phone's time.

Select time zone

Touch to open a dialog where you can set the phone's time zone.

Use 24-hour format

Mark the checkbox to display the time using 24-hour clock format.

Choose date format

Touch to open a dialog where you can select the format for displaying dates.

11.5.2 Accessibility

You use the Accessibility settings to configure any accessibility plug-ins you have installed on your phone.

TalkBack

Touch to turn on/off TalkBack.

Switch Access

Touch to turn on/off switch access.

Captions

Touch to activate/deactivate captions for phone screen.

Magnification gestures

Touch to turn on/off to activate/deactivate zoom in/out function by triple-tapping the screen.

Large text

Mark the checkbox to enlarge the screen text.

High contrast text

Mark the checkbox to activate high contrast text.

Power button ends call

Mark the check box to enable Power button ends call.

Auto-rotate screen

Mark the checkbox to activate auto-rotate screen.

Speak passwords

Mark the checkbox to speak passwords while typing.

Accessibility shortcut

Touch to turn on/off to enable/disable accessibility features.

Text-to-speech output

Please refer to "Preferred engine/Speech rate/Listen to an example" setting before.

Touch & hold delay

Touch to adjust the duration of touch and hold delay. This function enables your phone to differ touch and touch & hold, which may avoid incorrect operations.

Colour inversion

Touch the switch to turn on/off colour inversion.

Colour correction

Touch to turn on/off colour correction.

11.5.3 Printing

The device provides the printing service which support the file and pictures to print directly after connecting with printer.

11.5.4 Regulatory & Safety

Touch to view Regulatory & Safety information, including Product model, Manufacturer name, etc.

11.5.5 About phone

This contains information about things ranging from Legal information, Model number, Firmware version, Baseband version, Kernel version, Build number to those listed below:

Software updates

Touch to check for system updates.

Software updates (storage)

Touch to check for system updates (from storage).

Status

This contains the status of the Battery status, Battery level, My phone number, Network, Signal strength, etc.

Legal information

Touch to view legal information.

12 Update your phone's software

Using the FOTA (Firmware Over The Air) Upgrade tool you can update your phone's software.

To access **Software Updates**, touch **Settings > About phone > Software updates**. Touch **Check for updates**, and the phone will search for the latest software. If you want to update the system, please touch **Download**, and when that's finished, touch **Install** to complete the upgrade. Now your phone will have the latest version of the software.

You should turn on data connection before searching for updates. Settings for auto-check intervals and reminders about upgrades are also available once you restart the phone.

If you have chosen auto-check, when the system discovers the new version, the icon  will appear in the status bar. Touch the notification to access the **Software Updates** directly.



During FOTA downloading or updating, to avoid errors in locating the correct update packages, do not change your default storage location.

13 Safety and use

We recommend that you read this chapter carefully before using your mobile phone. The manufacturer disclaims any liability for damage, which may result as a consequence of improper use or use contrary to the instructions contained herein.

• TRAFFIC SAFETY:

Given that studies show that using a mobile phone while driving a vehicle constitutes a real risk, even when the hands-free kit is used (car kit, headset...), drivers are requested to refrain from using their mobile phone when the vehicle is not parked. Check the laws and regulations on the use of wireless mobile phones and their accessories in the areas where you drive. Always obey them. The use of these devices may be prohibited or restricted in certain areas.

When driving, do not use your mobile phone and headphone to listen to music or to the radio. Using a headphone can be dangerous and forbidden in some areas.

When switched on, your mobile phone emits electromagnetic waves that can interfere with the vehicle's electronic systems such as ABS anti-lock brakes or airbags. To ensure that there is no problem:

- do not place your mobile phone on top of the dashboard or within an airbag deployment area,
- check with your car dealer or the car manufacturer to make sure that the car's electronic devices are shielded from mobile phone RF energy.

• CONDITIONS OF USE:

You are advised to switch off the mobile phone from time to time to optimize its performance.

Remember to abide by local authority rules of mobile phone use on aircrafts.

Operational Warnings: Obey all posted signs when using mobile devices in public areas.

Follow Instructions to Avoid Interference Problems: Turn off your mobile device in any location where posted notices instruct you to do so. In an aircraft, turn off your mobile device whenever instructed to do so by airline staff. If your mobile device offers an airplane mode or similar feature, consult airline staff about using it in flight.

Switch the mobile phone off when you are in health care facilities, except in designated areas. As with many other types of equipment now in regular use, mobile phones can interfere with other electrical or electronic devices, or equipment using radio frequency.

Switch the mobile phone off when you are near gas or flammable liquids. Strictly obey all signs and instructions posted in a fuel depot, gas station, or chemical plant, or in any potentially explosive atmosphere.

When the mobile phone is switched on, it should be kept at least 15 cm from any medical device such as a pacemaker, a hearing aid or insulin pump. In particular when using the mobile phone you should hold it against the ear on the opposite side to the device, if any. Read and follow the directions from the manufacturer of your implantable medical device. If you have any questions about using your mobile device with your implantable medical device, consult your healthcare provider.

To avoid hearing impairment, answer the call before holding your mobile phone to your ear. Also move the handset away from your ear while using the "hands-free" option because the amplified volume might cause hearing damage.

It is recommended to have proper supervision while small children use your mobile phone.

When replacing the cover please note that your mobile phone may contain substances that could create an allergic reaction.

Always handle your mobile phone with care and keep it in a clean and dust-free place.

Do not allow your mobile phone to be exposed to adverse weather or environmental conditions (moisture, humidity, rain, infiltration of liquids, dust, sea air, etc.). The manufacturer's recommended operating temperature range is -10°C (14°F) to +55°C (131°F) (the max value depends on device, materials and housing paint/texture).

Over 55°C (131°F) the legibility of the mobile phone's display may be impaired, though this is temporary and not serious.

Do not open or attempt to repair your mobile phone yourself.

Do not drop, throw or try to bend your mobile phone.

Do not use the mobile phone if the glass made screen, is damaged, cracked or broken to avoid any injury.

Do not paint it.

Use only batteries, battery chargers, and accessories which are recommended by TCT Mobile Limited and its affiliates and are compatible with your mobile phone model. TCT Mobile Limited and its affiliates disclaim any liability for damage caused by the use of other chargers or batteries.

Your mobile phone should not be disposed of in a municipal waste. Please check local regulations for disposal of electronic products.

Remember to make back-up copies or keep a written record of all important information stored in your mobile phone.

Some people may suffer epileptic seizures or blackouts when exposed to flashing lights, or when playing video games. These seizures or blackouts may occur even if a person never had a previous seizure or blackout. If you have experienced seizures or blackouts, or if you have a family history of such occurrences, please consult your doctor before playing video games on your mobile phone or enabling a flashing-lights feature on your mobile phone. Parents should monitor their children's use of video games or other features that incorporate flashing lights on the mobile phones.

All persons should discontinue use and consult a doctor if any of the following symptoms occur: convulsion, eye or muscle twitching, loss of awareness, involuntary movements, or disorientation. To limit the likelihood of such symptoms, please take the following safety precautions:

- Play at the farthest distance possible from the screen.

When you play games on your mobile phone, you may experience occasional discomfort in your hands, arms, shoulders, neck, or other parts of your body. Follow these instructions to avoid

problems such as tendonitis, carpal tunnel syndrome, or other musculoskeletal disorders:

-Take a minimum of a 15-minute break every hour of game playing.

-If your hands, wrists, or arms become tired or sore while playing, stop and rest for several hours before playing again.-

-If you continue to have sore hands, wrists, or arms during or after playing, stop the game and see a doctor.



PROTECT YOUR HEARING

To prevent possible hearing damage, do not listen at high volume levels for long periods. Exercise caution when holding your device near your ear while the loudspeaker is in use.

• CHARGERS

Home A.C./ Travel chargers will operate within the temperature range of: 0°C (32°F) to 40°C (104°F).

The chargers designed for your mobile phone meet with the standard for safety of information technology equipment and office equipment use. Due to different applicable electrical specifications, a charger you purchased in one jurisdiction may not work in another jurisdiction. They should be used for this purpose only.

Characteristics of power supply (depending on the country):

Travel charger: Input: 100-240 V, 50/60 Hz, 200 mA

Output: 5 V, 1A

Battery: Lithium 2000 mAh

• RADIO WAVES:

THIS MOBILE PHONE MEETS THE GOVERNMENT'S REQUIREMENTS FOR EXPOSURE TO RADIO WAVES.

Your mobile phone is a radio transmitter and receiver. It is designed and manufactured not to exceed the emission limits for exposure to radio-frequency (RF) energy. These limits are part of comprehensive guidelines and establish permitted levels of RF energy for the general population. The guidelines are based on standards that were developed by independent scientific organizations through periodic and thorough evaluation of scientific studies. These guidelines include a substantial safety margin designed to ensure the safety of all persons, regardless of age and health.

The exposure standard for mobile phones employs a unit of measurement known as the Specific Absorption Rate, or SAR. The SAR limit set by public authorities such as the Federal Communications Commission of the US Government (FCC), or by Industry Canada, is 1.6 W/kg averaged over 1 gram of body tissue. Tests for SAR are conducted using standard operating positions with the mobile phone transmitting at its highest certified power level in all tested frequency bands.

Although the SAR is determined at the highest certified power level, the actual SAR level of the mobile phone while operating can be well below the maximum value. This is because the mobile phone is designed to operate at multiple power levels so as to use only the power required to reach the network. In general, the closer you are to a wireless base station antenna, the lower the power output of the mobile phone. Before a mobile phone model is available for sale to the public, compliance with national regulations and standards must be shown.

The highest SAR value for this model mobile phone when tested is 0.80 W/Kg for use at the ear and 1.52 W/Kg for use close to the body.

While there may be differences between the SAR levels of various mobile phones and at various positions, they all meet the government requirement for RF exposure. For body-worn operation, the mobile phone meets FCC RF exposure guidelines provided that it is used with a non-metallic accessory with the handset at least 10 mm from the body. Use of other accessories may not ensure compliance with FCC RF exposure guidelines. Additional information on SAR can be found on the Cellular Telecommunications & Internet Association (CTIA) Web site: <http://www.ctia.org/>

The World Health Organization (WHO) considers that present scientific information does not indicate the need for any special precautions for use of mobile phones. If individuals are concerned, they might choose to limit their own or their children's RF exposure by limiting the length of calls, or using "hands-free" devices to keep mobile phones away from the head and body. Additional WHO information about electromagnetic fields and public health are available on the following website: <http://www.who.int/peh-emf>.

Note: This equipment has been tested and found to comply with the limits for a Class B digital device pursuant to part 15 of the FCC Rules. These limits are designed to provide reasonable protection against harmful interference in a residential installation. This equipment generates, uses and can radiate radio frequency energy and, if not installed and used in accordance with the instructions, may cause harmful interference to radio communications. However, there is no guarantee that interference to radio or television reception, which can be determined by turning the equipment off and on, the user is encouraged to try to correct the interference by one or more of the following measures:

- Reorient or relocate the receiving antenna.
- Increase the separation between the equipment and receiver.
- Connect the equipment into an outlet on a circuit different from that to which the receiver is connected.

-Consult the dealer or an experienced radio/ TV technician for help.

Changes or modifications not expressly approved by the party responsible for compliance could void the user's authority to operate the equipment.

For the receiver devices associated with the operation of a licensed radio service (e.g. FM broadcast), they bear the following statement:

This device complies with Part 15 of the FCC Rules. Operation is subject to the condition that this device does not cause harmful interference.

For other devices, they bear the following statement: This device complies with Part 15 of the FCC Rules. Operation is subject to the following two conditions:

- (1) this device may not cause harmful interference
- (2) this device must accept any interference received, including interference that may cause undesired operation.

Your mobile phone is equipped with a built-in antenna. For optimal operation, you should avoid touching it or degrading it. As mobile devices offer a range of functions, they can be used in positions other than against your ear. In such circumstances the device will be compliant with the guidelines when used with headset or usb data cable. If you are using another accessory ensure that whatever product is used is free of any metal and that it positions the mobile phone at least 10 mm away from the body.



microSD Logo is a trademark.



The Bluetooth® word mark and logos are owned by the Bluetooth SIG, Inc. and any use of such marks by TCL Mobile Ltd. and its affiliates is under license. Other trademarks and trade names are those of their respective owners.

VF_895N Bluetooth Declaration ID D025403



The Wi-Fi Logo is a certification mark of the Wi-Fi Alliance.

Google, the Google logo, Android, the Android logo, Google Search™, Google Maps™, Gmail™, YouTube, Google Play Store, Google Latitude™ and Hangouts™ are trademarks of Google Inc.

The Android robot is reproduced or modified from work created and shared by Google and used according to terms described in the Creative Commons 3.0 Attribution License (the text will show when you touch and hold Google legal in Settings\About phone\Legal information).

You have purchased a product which uses the open source (<http://opensource.org/>) programs mtd, msdosfs, netfilter/iptables and initrd in object code and other open source programs licensed under the GNU General Public License and Apache License.

We will provide you with a complete copy of the corresponding source codes upon request within a period of three years from the distribution of the product by TCT.

You may download the source codes from <http://sourceforge.net/projects/alcatel/files/>. The provision of the source code is free of charge from internet.

FCC ID: RAD543

14 General information

- Website: www.alcatelonetouch.com
- Facebook: <http://www.facebook.com/alcatelonetouchusa>
- Twitter: <http://www.twitter.com/alcatel1touch>
- Hot Line Number: In the United States, call 877-702-3444 for technical support.

On our Internet site, you will find our FAQ (Frequently Asked Questions) section. You can also contact us by e-mail to ask any questions you may have.

An electronic version of this user guide is available in English and other languages according to availability on our server:

www.alcatelonetouch.com

Your telephone is a transceiver that operates on GSM in quad-band with 850/900/1800/1900 MHz, UMTS in Tri-band with 850/900/2100 MHz or LTE in Six-band with B1/B3/B5/B7/B8/B20.

Protection against theft⁽¹⁾

Your mobile phone is identified by an IMEI (mobile phone serial number) shown on the packaging label and in the product's memory. We recommend that you note the number the first time you use your mobile phone by entering *#06# and keep it in a safe place. It may be requested by the police or your operator if your mobile phone is stolen.

Disclaimer

There may be certain differences between the user manual description and the mobile phone's operation, depending on the software release of your mobile phone or specific operator services.

⁽¹⁾ Contact your network operator to check service availability.

TCT Mobile shall not be held legally responsible for such differences, if any, nor for their potential consequences, which responsibility shall be borne by the operator exclusively.

14 TCT Mobile (US), Inc Warranty

TCT Mobile (US), Inc. warrants to the original retail purchaser of this wireless device that should this product or part thereof during normal consumer usage and condition be proven to be defective in material or workmanship that results in product failure within the first twelve (12) months from the date of purchase as shown on your original sales receipt from an authorized sales agent. Such defect(s) will be repaired or replaced (with new or rebuilt parts) at the company's option without charge for parts or labor directly related to the defect(s).

Batteries, power adapters, and other accessories sold as in box items are also warranted against defects and workmanship that results in product failure within the first six (6) months period from the date of purchase as shown on your original sales receipt. Such defect(s) will be repaired or replaced (with new or rebuilt parts) at the company's option without charge for parts or labor directly related to the defect(s).

The limited warranty for your wireless device will be voided if any of the following conditions occur:

- Non-compliance with the instructions for use or installation, or with technical and safety standards applicable in the geographical area where your phone is used;
- Connection to any equipment not supplied or not recommended by TCT Mobile (US), Inc.;
- Modification or repair performed by individuals not authorized by TCT Mobile (US), Inc. or its affiliates;
- Changes to the device operating system by the user or third party applications;

- Acts of god such as inclement weather, lightning, power surges, fire, humidity, infiltration of liquids or foods, chemical products, download of files, crash, high voltage, corrosion, oxidation;
- Removal or altering of the wireless device's event labels or serial numbers (IMEI);
- Damage from exposure to water or other liquids, moisture, humidity, excessive temperatures or extreme, environmental conditions, sand, excess dust and any condition outside the operating guidelines;
- Defects in appearance, cosmetic, decorative or structural items such as framing and non-operative parts;
- Damage as result of physical abuse regardless of cause.

There are no express warranties, whether written, oral or implied, other than this printed limited warranty or the mandatory warranty provided by your jurisdiction. In no event shall TCT Mobile (US), Inc. or any of its affiliates be liable for incidental or consequential damages of any nature whatsoever, including but not limited to commercial loss, to the full extent those damages can be disclaimed by law. Some states do not allow the exclusion or limitation of incidental or consequential damages, or limitation of the duration of implied warranties, so the preceding limitations or exclusions may not apply to you.

How to obtain Support: Contact the customer care center by calling (877-702-3444) or going to (<http://www.alcatelonetouch.com/usa/>). We have placed many self-help tools that may help you to isolate the problem and eliminate the need to send your wireless device in for service. In the case that your wireless device is no longer covered by this limited warranty due to time or condition, you may utilize our out of warranty repair options.

How to obtain Hardware Service within the terms of this warranty: Create a user profile (alcatel.finetw.com) and then create an RMA for the defective device. Ship the device with a copy of the original proof of purchase (e.g. original copy of the dated bill of sale, invoice) with the owner's return address (No PO Boxes accepted), wireless carrier's name, alternate daytime phone number, and email address with a complete problem description.

Only ship the device. Do not ship the SIM card, memory cards, or any other accessories such as the power adapter. You must properly package and ship the wireless device to the repair center. TCT Mobile (US), Inc. is not responsible for devices that do not arrive at the service center or are damaged in transit. Insurance is recommended with proof of delivery. Upon receipt, the service center will verify the warranty conditions, repair, and return your device to the address provided in the RMA. Check the warranty repair status by going online with the RMA number on web portal.

15 Troubleshooting

Before contacting the service centre, you are advised to follow the instructions below:

- You are advised to fully charge () the battery for optimal operation.
- Avoid storing large amounts of data in your phone as this may affect its performance.
- Use **Factory data reset** and the upgrade tool to perform phone formatting or software upgrading (to reset factory data, hold down the **Power** key and the **Volume up** key at the same time). ALL User phone data: contacts, photos, messages, files, and downloaded applications will be permanently lost. It is strongly advised to fully backup the phone data and profile via Smart Suite before doing formatting or upgrading.

and carry out the following checks:

My phone cannot be switched on or is frozen

- Check the battery contacts, remove and reinstall your battery, then turn your phone on.

- When the phone cannot be switched on, charge for at least 20 minutes to ensure the minimum battery power needed, then try to switch on again.
- When the phone falls into a loop during power on-off animation and the user interface cannot be accessed, press and hold the Volume down key to enter Safe Mode. This eliminates any abnormal OS booting issues caused by 3rd party APKs.
- If neither method is effective, please reset the phone using the Power key and the Volume up key, (holding both together).

My phone has not responded for several minutes

- Restart your phone by pressing and holding the **Power** key for more than 9s.
- Remove and re-install the battery, then restart the phone.

My phone turns off by itself

- Check that your screen is locked when you are not using your phone, and make sure the **Power** key is not mis-contacted due to unlocked screen.
- Check the battery charge level.

My phone cannot charge properly

- Make sure you are using the ALCATTEL ONETOUCH charger included in the box.
- Make sure your battery is inserted properly and clean the battery contact if it's dirty. It must be inserted before plugging in the charger.
- Make sure that your battery is not completely discharged; if the battery power is empty for a long time, it may take around 20 minutes to display the battery charger indicator on the screen.
- Make sure charging is carried out under normal conditions (0°C to +40°C).
- When abroad, check that the voltage input is compatible.

My phone cannot connect to a network or "No service" is displayed

- Try connecting in another location.

- Verify the network coverage with your operator.
- Check with your operator that your SIM card is valid.
- Try selecting the available network(s) manually.
- Try connecting at a later time if the network is overloaded.

My phone cannot connect to the Internet

- Check that the IMEI number (press *#06#) is the same as the one printed on your warranty card or box.
- Make sure that the internet access service of your SIM card is available.
- Check your phone's Internet connecting settings.
- Make sure you are in a place with network coverage.
- Try connecting at a later time or another location.

Invalid SIM card

- Make sure the SIM card has been correctly inserted (see **"Inserting or removing the SIM card"**).
- Make sure the chip on your SIM card is not damaged or scratched.
- Make sure the service of your SIM card is available.

Unable to make outgoing calls

- Make sure you have dialed a valid number and have touched .
- For international calls, check the country and area codes.
- Make sure your phone is connected to a network, and the network is not overloaded or unavailable.
- Check your subscription status with your operator (credit, SIM card valid, etc.).
- Make sure you have not barred outgoing calls.
- Make sure that your phone is not in flight mode.

Unable to receive incoming calls

- Make sure your phone is switched on and connected to a network (check for overloaded or unavailable network).
- Check your subscription status with your operator (credit, SIM card valid, etc.).
- Make sure you have not forwarded incoming calls.
- Make sure that you have not barred certain calls.
- Make sure that your phone is not in flight mode.

The caller's name/number does not appear when a call is received

- Check that you have subscribed to this service with your operator.
- Your caller has concealed his/her name or number.

I cannot find my contacts

- Make sure your SIM card is not broken.
- Make sure your SIM card is inserted properly.
- Import all contacts stored in SIM card to phone.

The sound quality of the calls is poor

- You can adjust the volume during a call by pressing the **Volume Up/Down** key.
- Check the network strength .
- Make sure that the receiver, connector or speaker on your phone is clean.

I am unable to use the features described in the manual

- Check with your operator to make sure that your subscription includes this service.
- Make sure this feature does not require an ALCATEL ONETOUCH accessory.

When I select a number from my contacts, the number cannot be dialed

- Make sure that you have correctly recorded the number in your file.
- Make sure that you have selected the country prefix when calling a foreign country.

I am unable to add a contact in my contacts

- Make sure that your SIM card contacts are not full; delete some files or save the files in the phone contacts (i.e. your professional or personal directories).

My callers are unable to leave messages on my voicemail

- Contact your network operator to check service availability.

I cannot access my voicemail

- Make sure your operator's voicemail number is correctly entered in "Voicemail number".

- Try later if the network is busy.

I am unable to send and receive MMS

- Check your phone memory availability as it might be full.
- Contact your network operator to check service availability and check MMS parameters.
- Verify the server centre number or your MMS profile with your operator.
- The server centre may be busy, try again later.

SIM card PIN locked

- Contact your network operator to obtain the PUK code (Personal Unblocking Key).

I am unable to connect my phone to my computer

- Install Smart Suite.
- Check that your USB driver is installed properly.
- Open the Notification panel to check if the Smart Suite Agent has activated.
- Check that your computer meets the requirements for Smart Suite Installation.
- Make sure that you're using the cable included in the box.

I am unable to download new files

- Make sure there is sufficient phone memory for your download.
- Select the microSD card as the location to store downloaded files.
- Check your subscription status with your operator.

The phone cannot be detected by others via Bluetooth

- Make sure that Bluetooth is turned on and your phone is visible to other users .
- Make sure that the two phones are within Bluetooth's detection range.

How to make your battery last longer

- Make sure you follow the complete charge time (minimum 2.5 hours).
- After a partial charge, the battery level indicator may not be exact. Wait for at least 20 minutes after removing the charger to obtain an exact indication.

- Adjust the brightness of screen as appropriate.
- Extend the email auto-check interval for as long as possible.
- Update news and weather information on manual demand, or increase their auto-check interval.
- Exit background-running applications if they are not being used for a long time.
- Deactivate Bluetooth, Wi-Fi, or GPS when not in use.

16 Accessories

The latest generation of Vodafone GSM mobile phones offers a built-in handsfree feature that allows you to use the telephone from a distance, placed on a table for example. For those who prefer to keep their conversations confidential, an earpiece is also available known as the headset.

1. Vodafone Smart prime 6,
2. Charger
3. Data cable
4. Headset
5. Quick Start Guide



Only use your telephone with the batteries, chargers and accessories in your box.

17 Specifications

Processor	Qualcomm MSM8916+1.2GHz Quad Core
Platform	Android™ L
Memory	8GB + 1GB RAM
Dimensions (LxWxT)	141.65x71.9x8.95mm
Weight	Around 155 grams with battery
Display	5.0-inch touchscreen with 1280×720 HD Capacity resolution
Network	GSM: Quad-band 850/900/1800/1900 MHz UMTS: Tri-band 850/900/2100 MHz LTE: Penta-band B1/B3/B5/B7/B8/B20 (Band frequency and data speed are operator dependent.)
GPS	Assisted GPS/Internal GPS antenna
Connectivity	Bluetooth V4.0 Wi-Fi IEEE 802.11 b/g/n 3.5 mm audio jack Micro-USB
Camera	8 megapixel back camera 2MP FF front camera
Audio supported formats	AAC LC/LTP, AAC+, enhanced AAC+, AMR-NB, AMR-WB, FLAC, MP3, MIDI, Vorbis, PCM/WAVE

Video supported formats	H.263, H.264 AVC, MPEG-4 SP, VP8
Battery	Rechargeable Lithium battery Capacity: 2500 mAh
Expansion Slot	microSD™ memory card (Maximum 64GB)
Special Features	G-sensor Proximity Sensor Light sensor

Note: Specifications are subject to change without prior notice.