

User Manual

Mobile Phone
FCCID: 2ADYY-M6

TECNO MOBILE LIMITED

ROOMS 05-15, 13A/F., SOUTH TOWER, WORLD
FINANCE CENTRE, HARBOUR CITY,
17 CANTON ROAD, TSIM SHA TSUI,
KOWLOON, HONG KONG

Please read these instructions for use and have a good look at the illustration before using.



Warning :

This device complies with Part 15 of the FCC Rules. Operation is subject to the following two conditions: (1) this device may not cause harmful interference, and (2) this device must accept any interference received, including interference that may cause undesired operation. Changes or modifications not expressly approved by the party responsible for compliance could void the user's authority to operate the equipment.

NOTE: This equipment has been tested and found to comply with the limits for a Class B digital device, pursuant to Part 15 of the FCC Rules. These limits are designed to provide reasonable protection against harmful interference in a residential installation. This equipment generates, uses and can radiate radio frequency energy and, if not installed and used in accordance with the instructions, may cause harmful interference to radio communications. However, there is no guarantee that interference will not occur in a particular installation.

If this equipment does cause harmful interference to radio or television reception, which can be determined by turning the equipment off and on, the user is encouraged to try to correct the interference by one or more of the following measures:

- Reorient or relocate the receiving antenna.
- Increase the separation between the equipment and receiver.
- Connect the equipment into an outlet on a circuit different from that to which the receiver is connected.
- Consult the dealer or an experienced radio/TV technician for help.

Changes or modifications to this unit not expressly approved by the party responsible for compliance could void the user's authority to operate the equipment.

RF Exposure Information:

The SAR limit of USA (FCC) is 1.6 W/kg averaged over one gram of tissue. Device Types Mobile Phone (FCC ID: 2ADYY-M6) has also been tested against this SAR limit.

This device was tested for typical body worn operations with the back of the handset kept 10mm from the body.

To maintain compliance with FCC RF exposure requirements, use accessories that maintain a 10mm separation distance between the user's body and the back of the handset. The use of belt clips, holsters and similar accessories should not contain metallic components in its assembly. The use of accessories that do not satisfy these requirements may not comply with FCC RF exposure requirements, and should be avoided.

Note: The SAR values meet the limit of FCC.

Please refer to the FCC database([https://apps.fcc.gov/oetcf/eas/reports/Generic Search.cfm](https://apps.fcc.gov/oetcf/eas/reports/GenericSearch.cfm)) to search for FCC ID: 2ADYY-M6 to get detailed information about RF Exposure(SAR).

1 Know Your Phone



1. Volume Up/Down
2. Front Camera
3. USB connector
4. Earphone Jack

5. On/Off
6. Main Camera
7. Speaker

2 Insert SIM Card & Memory Card

1. Turn off the phone before the rear cover and battery are removed.
2. Insert the SIM card(s) & memory card into the card slot(s) correctly.
3. Insert the battery and put back the rear cover of the phone finally.

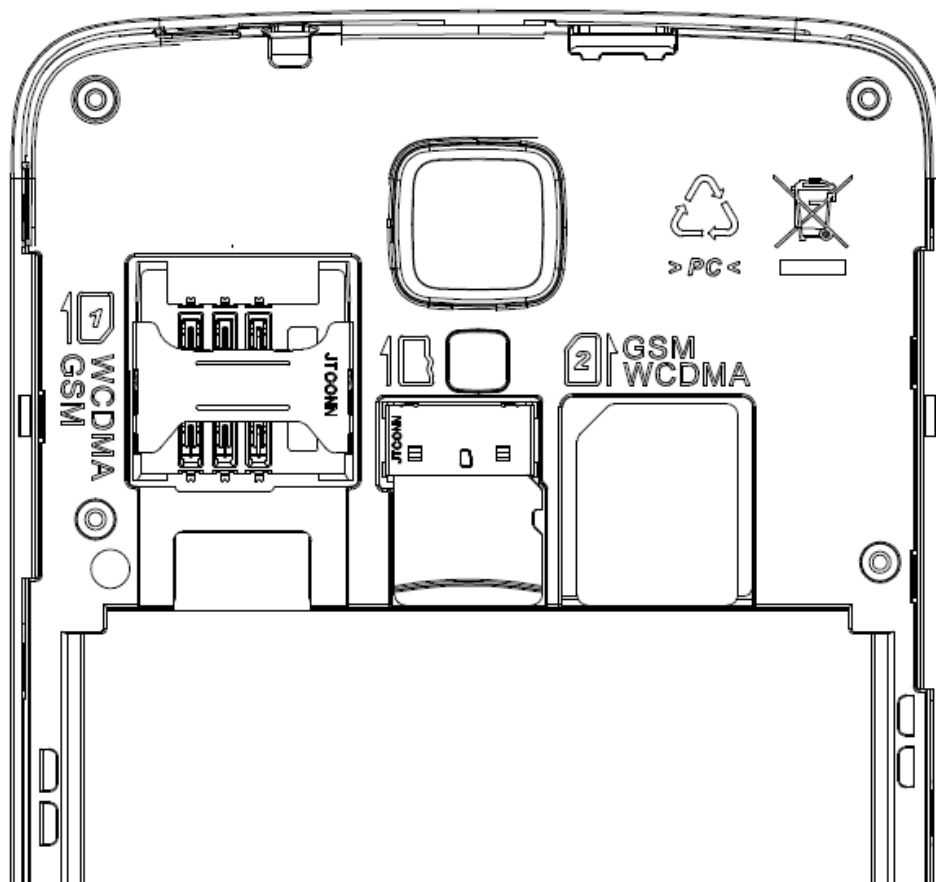

3 Main Screen

Main screen contains the commonly used applications and it also shows you the daily information such as the time, the weather (need third-party applications), date, etc.

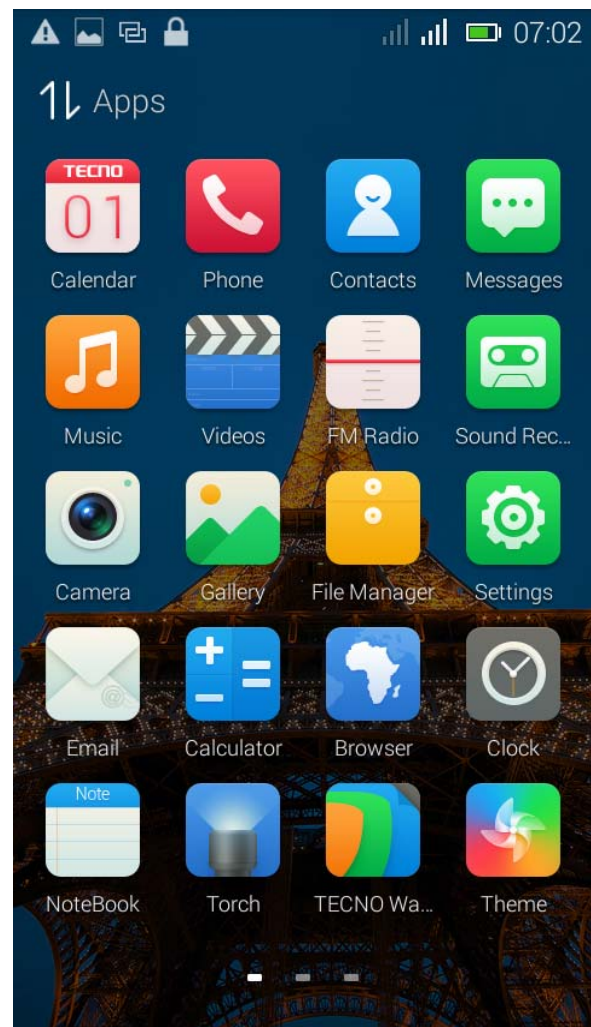
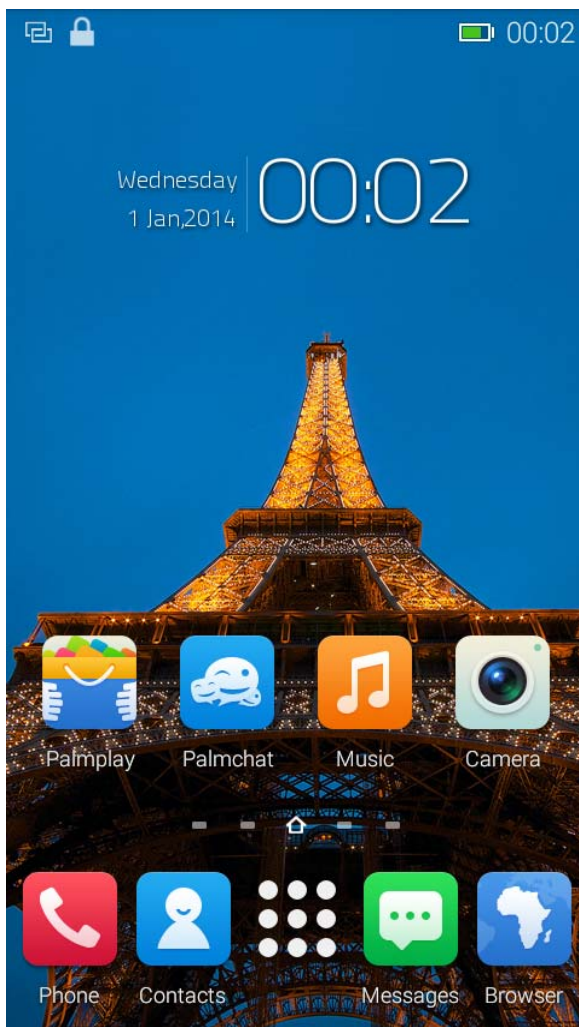

4 Make Calls

Enter dial interface and input a complete phone number to make a call.

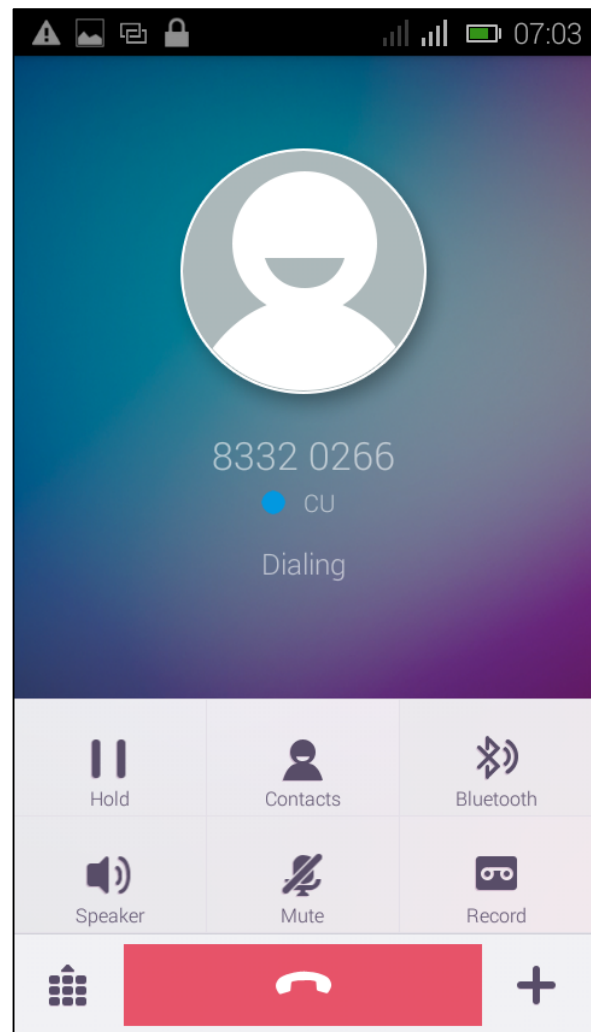
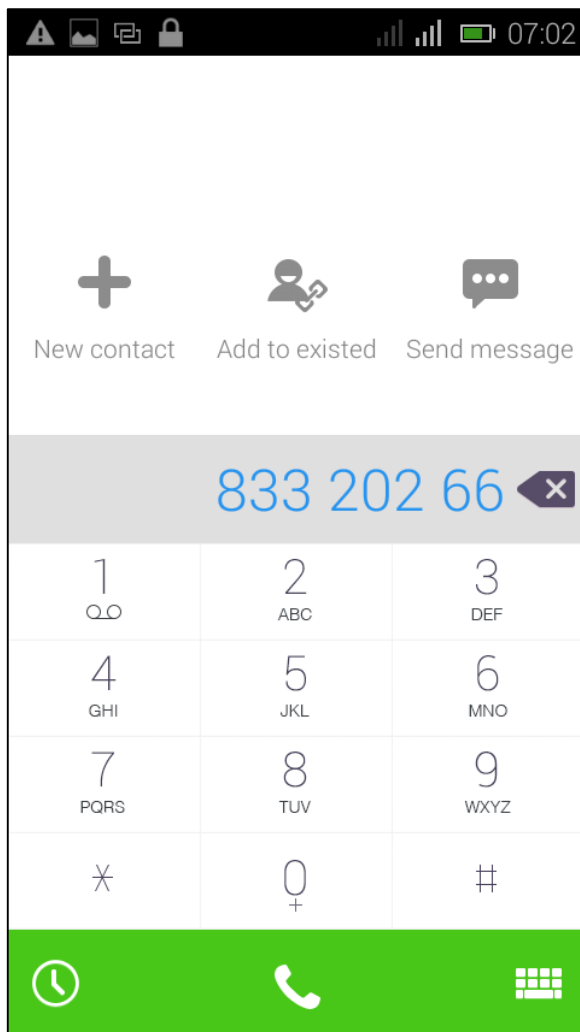

5 Notification

Notification icons inform you of new messages and events. When you receive a notification, its icon appears in the status bar, along with a summary that appears only briefly.

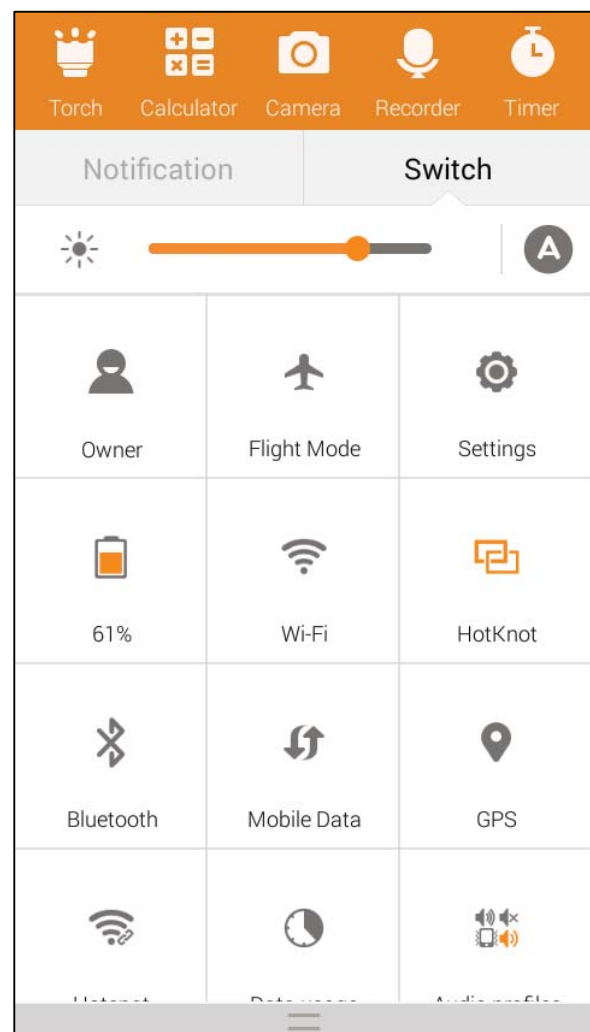
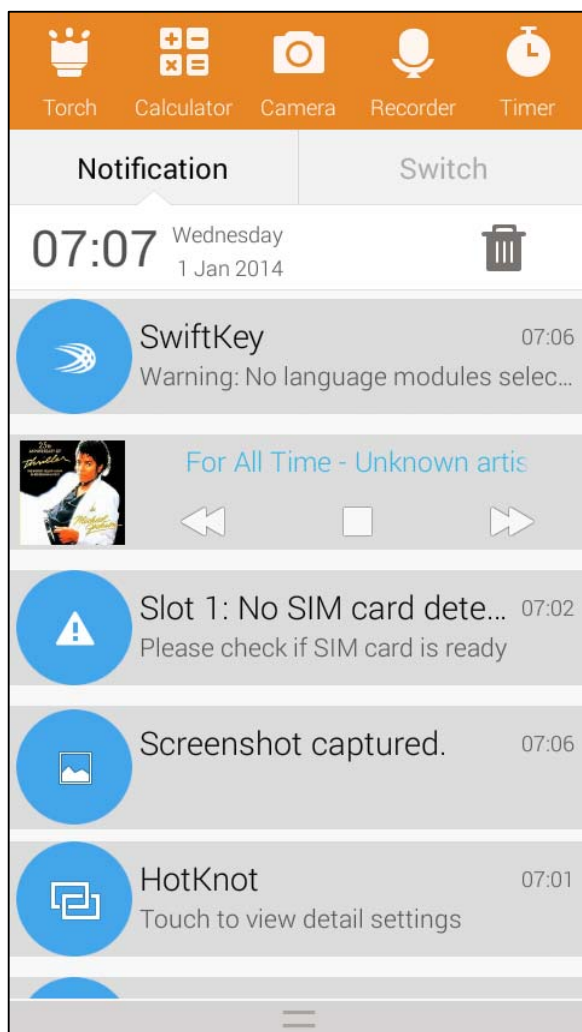

6 Messages

You can use Messaging to exchange text and multimedia messages with your friends.

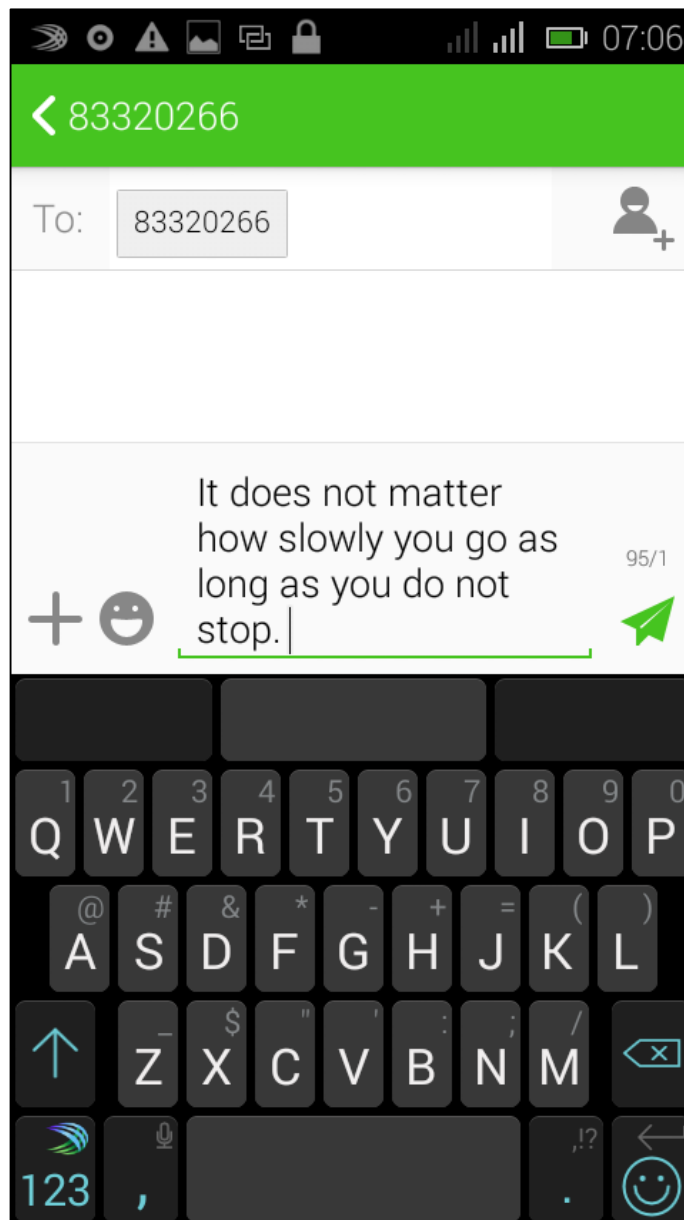

7 Camera

Your camera pictures and videos can be stored in SD card. You can copy pictures and videos from the SD card to other devices and vice versa.

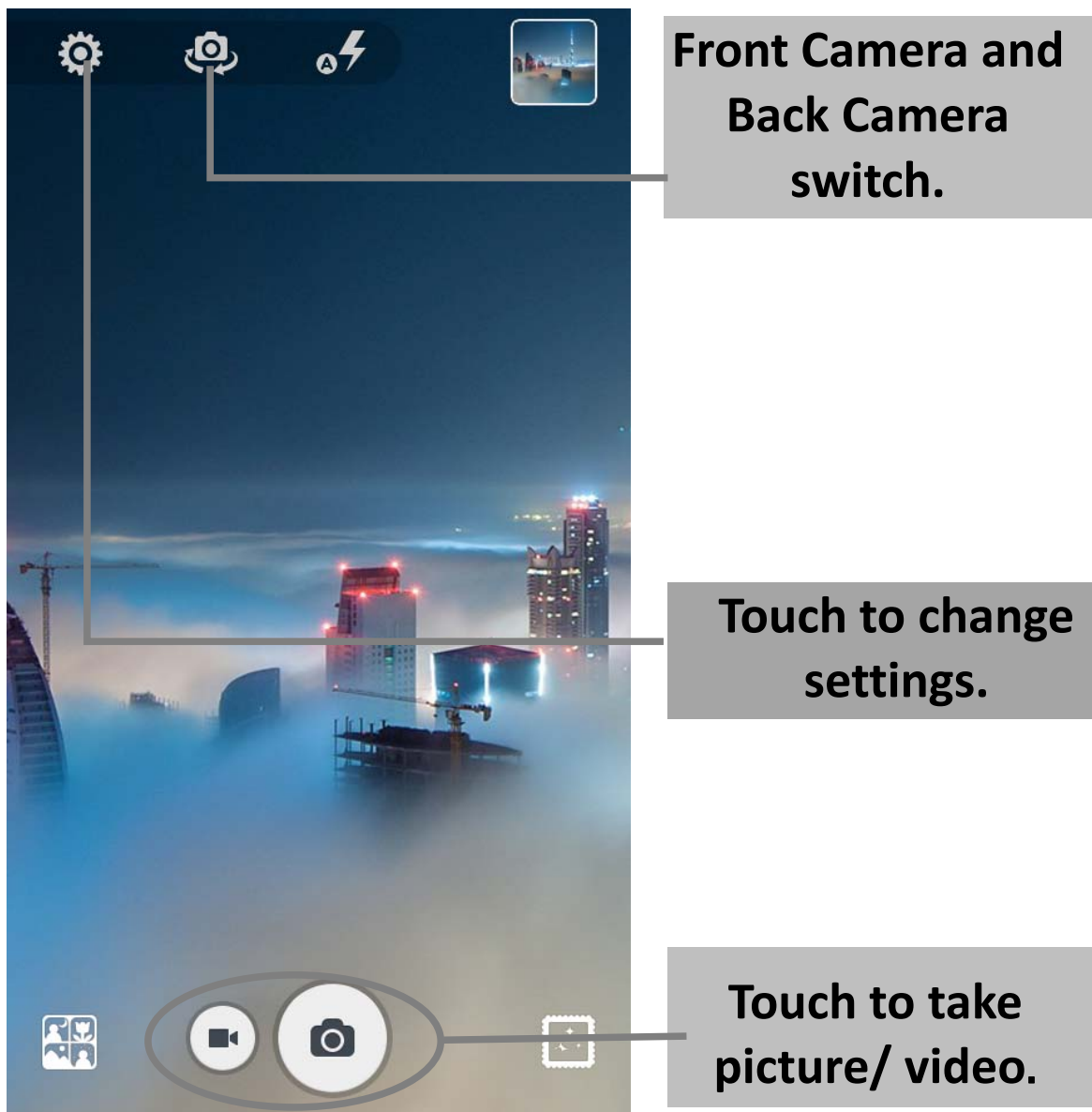

8 Gallery

You can view pictures that you've taken with camera, downloaded, copied, etc. In the Gallery or in Picasa Web Album. You can also edit pictures and set them as your wallpaper or contact picture, share your pictures with friends via email or messaging, upload them to Picasa and YouTube web sites.

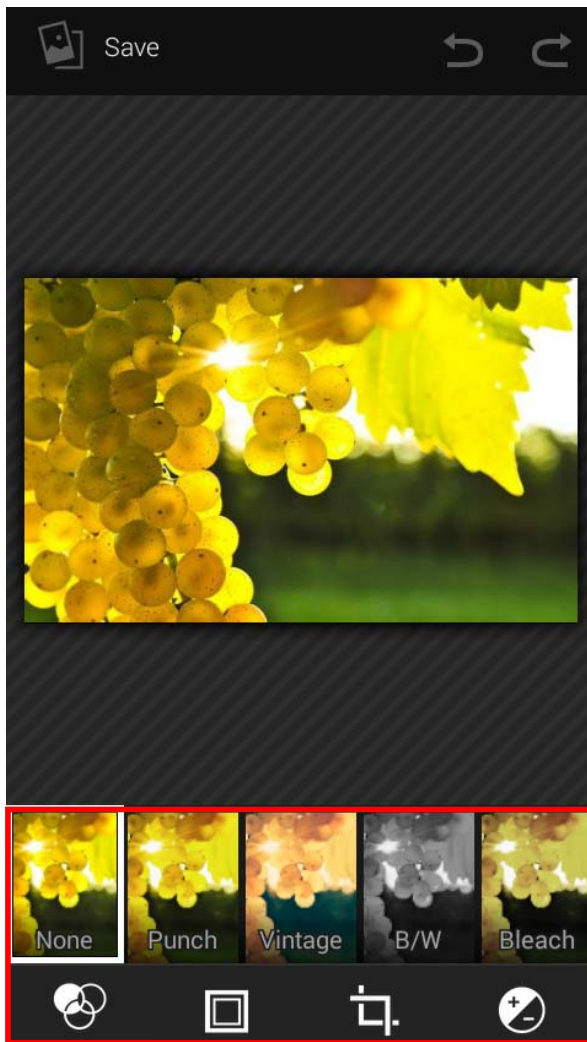

**Various
image
processing
effects**

9 BT

Bluetooth Pairing, You need to turn on Bluetooth. The Search You need Paired equipment, Select the device Pairing

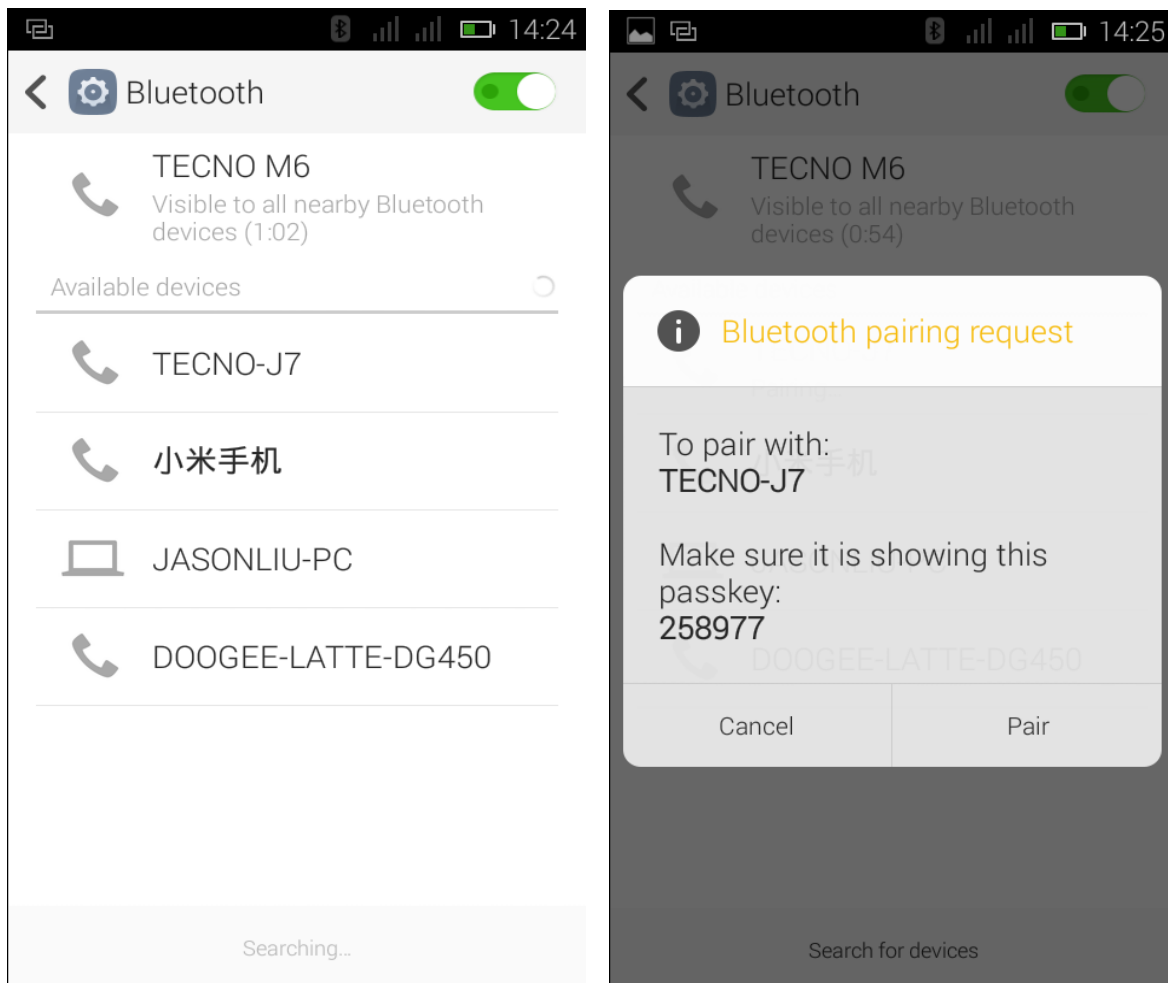

10 Wi-Fi

To browse the web, you need switch on Data connection. If there is Wi-Fi around, you can switch on Wi-Fi to use it browse the web. Some may need password.

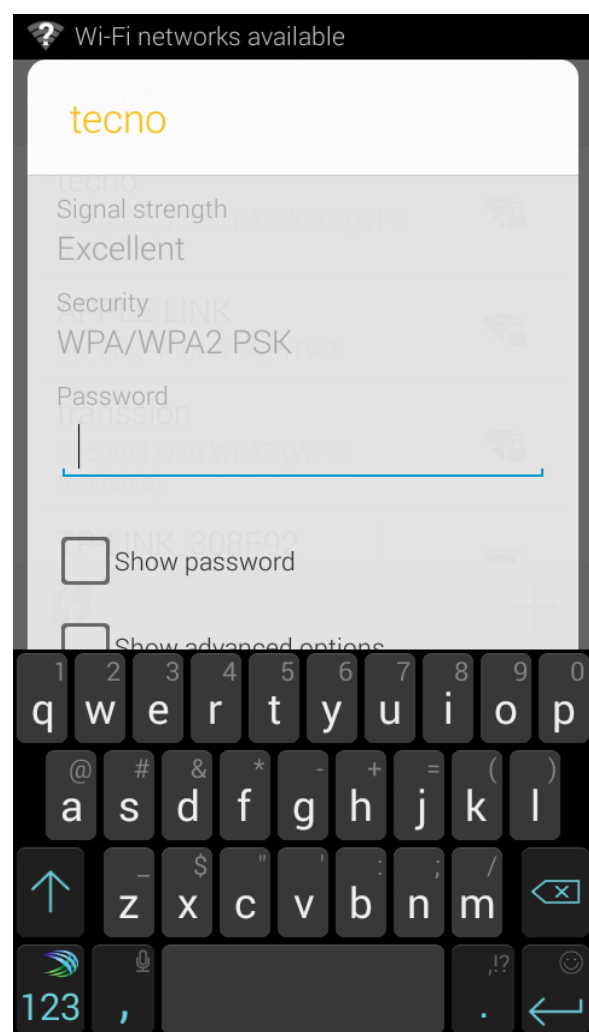
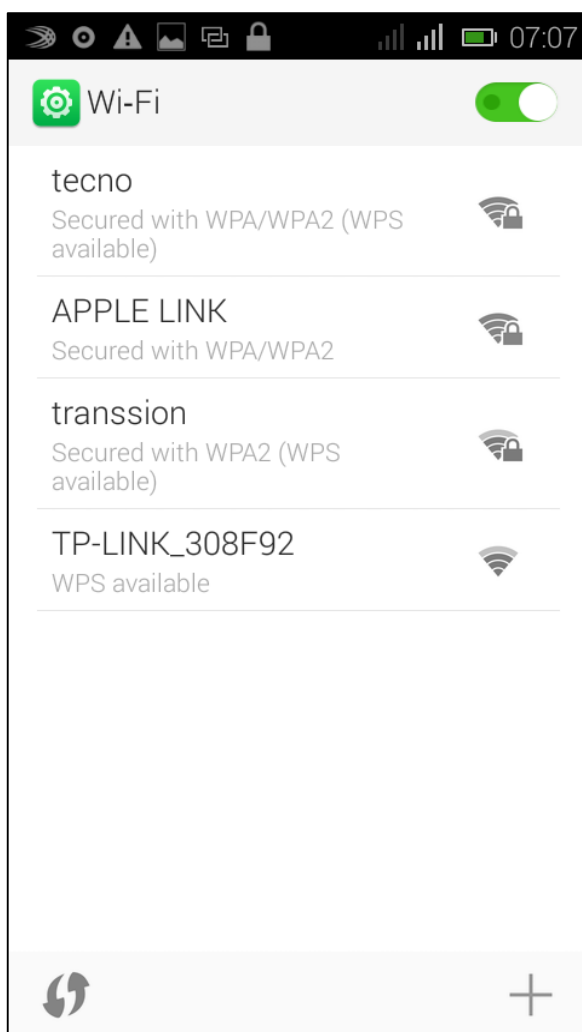

11 HotKnot

When using the HotKnot, open the HotKnot in the phone, and then make pairing of the HotKnot between two phones to establish a data transmission channel for data transmission.

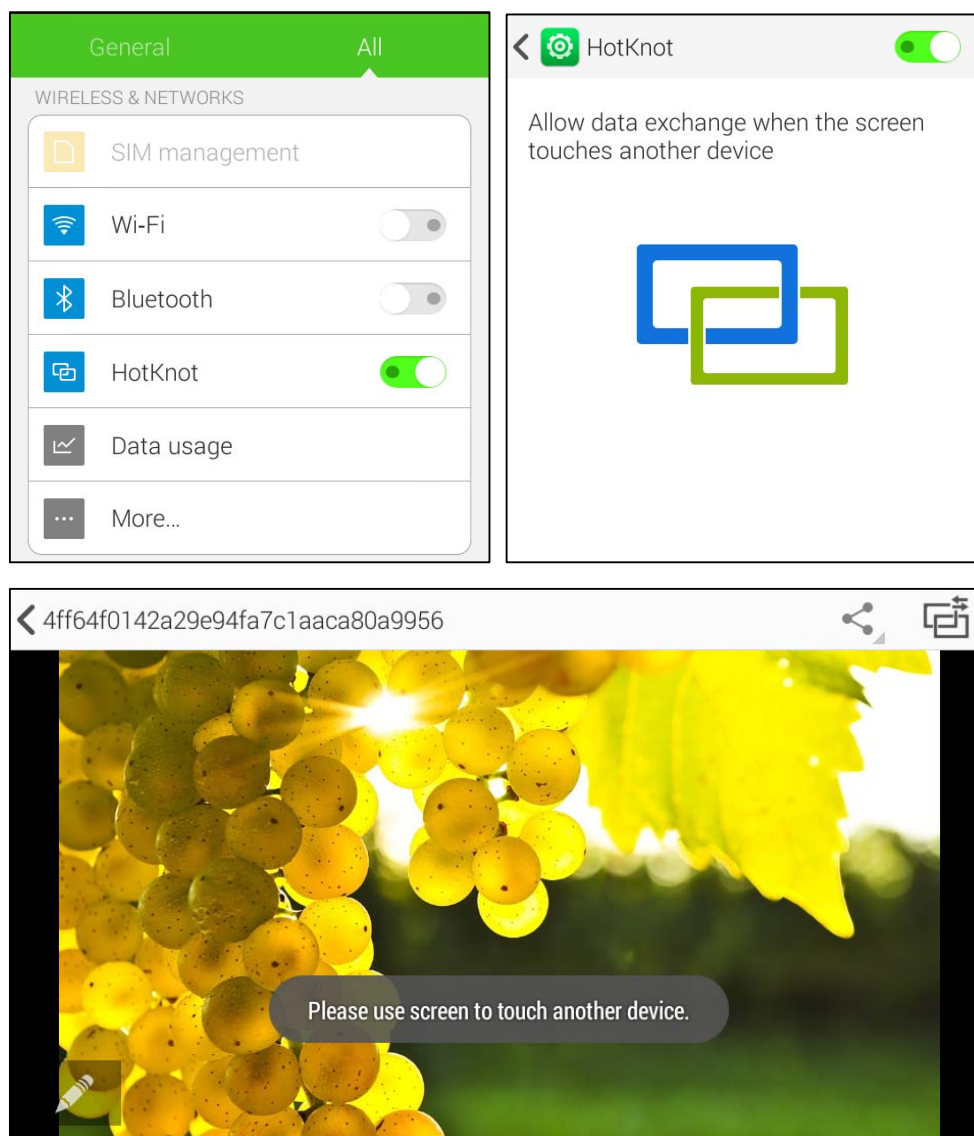

12 Music

When you copy music to your SD card, the Music Player detects the SD card to find out music files in it. The music is sorted and stored in different music files.

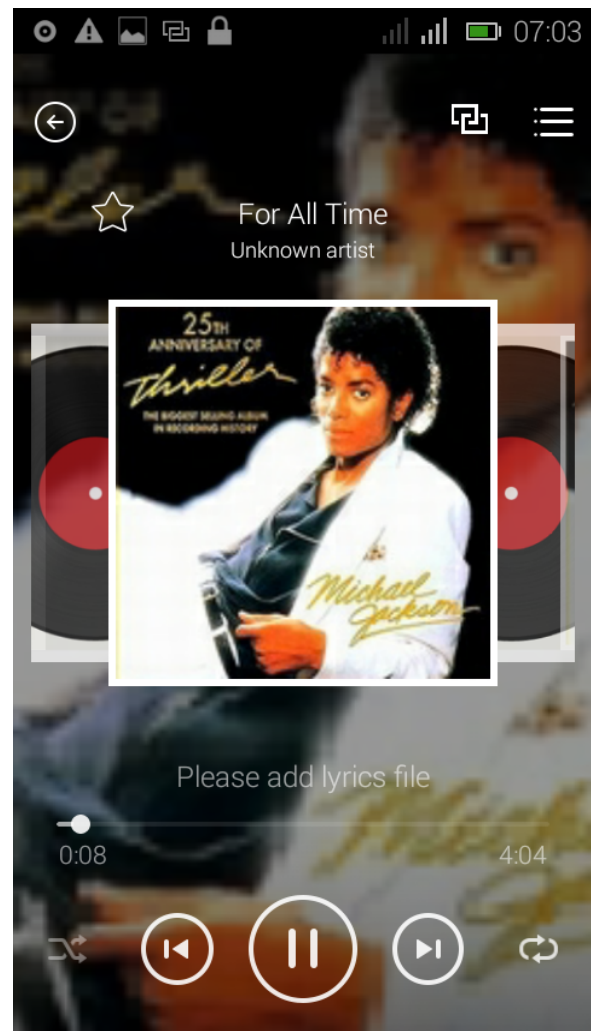
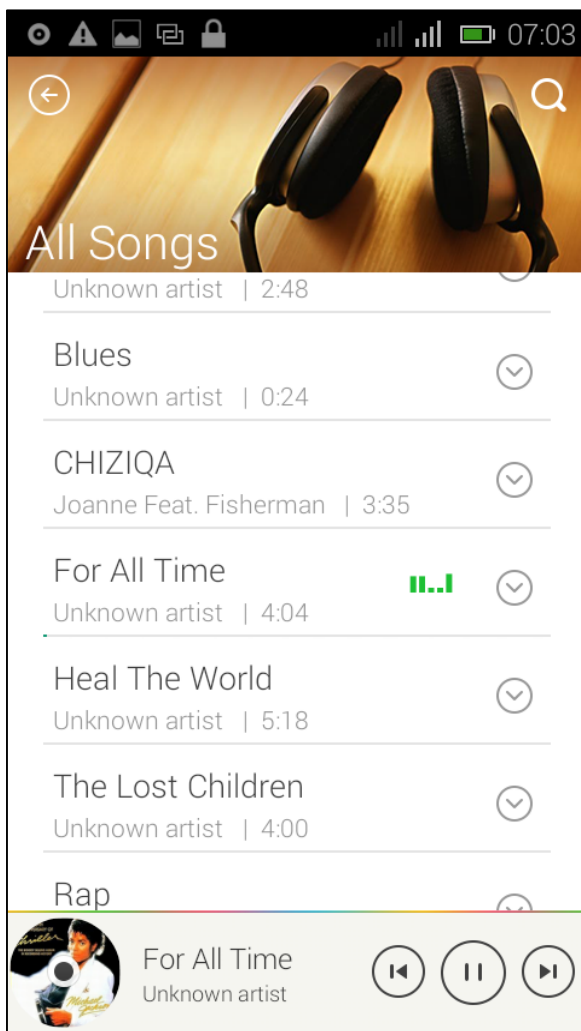

13 Palmplay

Palmplay contains many Android Package (APK) files. Click a APK icon to install the application quickly, you can also install applications by computer. Convenient and quick.

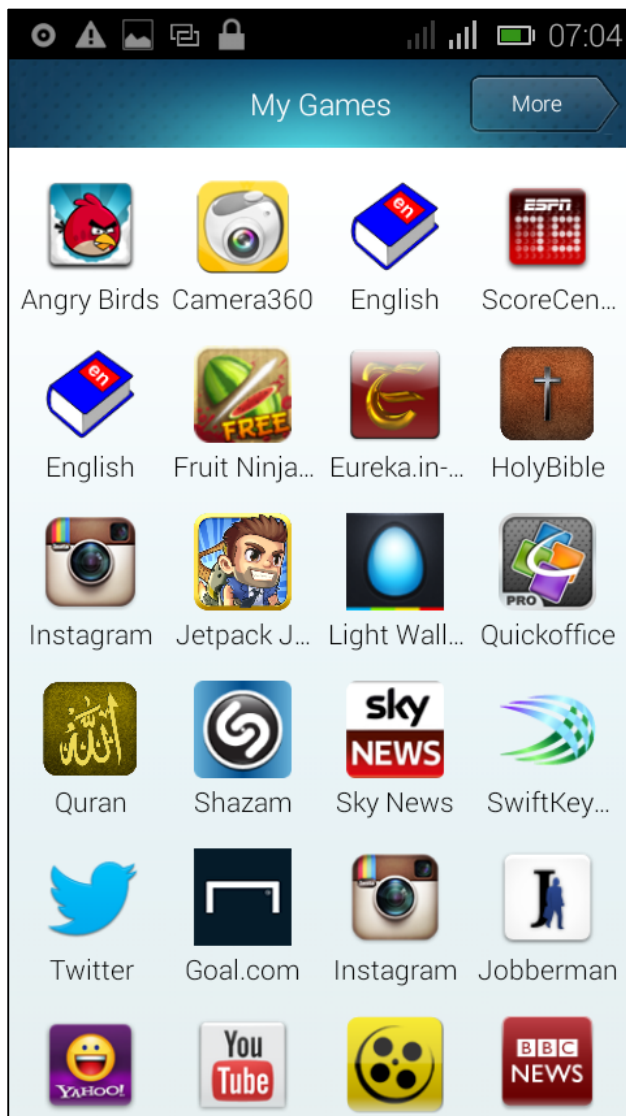

Click to install Apps
quickly

14 Taking Care of Your Device

Your device is a product of superior design and craftsmanship and should be handled with care: The following suggestions will help you protect your phone:

- Keep the device dry. Precipitation, humidity, and all types of liquid or moisture can contain minerals that will rust electronic circuits. If your device gets wet, remove the battery and refrain from turning on the device, wipe it with dry cloth and take it to the service center.
- Do not store the device in high or cold temperature. High temperature can shorten the life of electronic devices and damage batteries.
- Do not use or store the device in dusty or dirty areas. Its moving parts and electronic components may be damaged.
- Do not attempt to open the device other than as instructed in this guide. Repairing of phone by yourself and others than our authorized service agent/center is against the warranty rules.
- Do not drop, knock, or shake the device. Rough handling can break internal circuit boards and fine mechanics.
- Do not use harsh chemicals, cleaning solvents, or strong detergents to clean the device. Use a soft, clean and dry

cloth to clean the surface of the device.

Battery& Chargers Safety:

- Do not place the battery in fire; follow local laws and ordinances in disposing used battery.
- Check the model number of the charger before using it to charge the mobile.
- Only use **original** battery, charger and accessories applicable to the specific mobile model. Using other types of battery, charger and accessories may violate the certification or warranty terms of the equipment and may result in danger.
- Return waste and used batteries to the supplier or specified recovery site.

CAUTION!

- There are risks of explosion if battery is replaced by a non-original one.
- Dispose of used batteries according to the instructions.

***Note:** The socket-outlet shall be installed near the equipment and shall be easily accessible.