

Mobile Explode picture

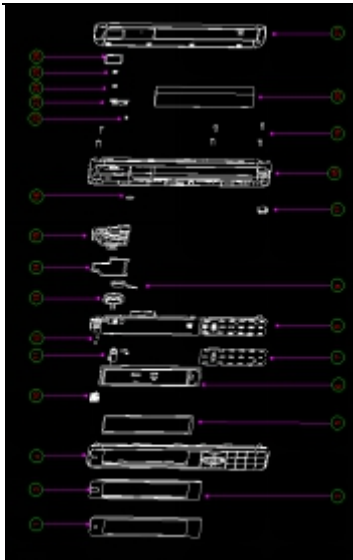

| Item | Description | Item | Description |
|------|---------------|------|---------------|
| 1 | LCD_Lens | 2 | LCD_Lens glue |
| 3 | REC_Net | 4 | Front_Housing |
| 5 | LCD_Foam | 6 | LCD_QQVGA_2.8 |
| 7 | DOME_21K | 8 | PCBA |
| 9 | MOT | 10 | REC |
| 11 | REAR_CAM | 12 | Screw |
| 13 | SPK | 14 | SPK_Foam |
| 15 | SPK_Frame | 16 | REAR_CAM_RUB |
| 17 | MIC-RUB | 18 | REAR_Housing |
| 19 | Screw | 20 | Battery_19C |
| 21 | Battery_cover | 22 | Flash_Shield |
| 23 | CAM_DEC | 24 | CAM_Lens_glue |
| 25 | CAM_Lens | 26 | SPK_Foam |

Foreword

Valuable mobile phone user, thank you for choosing our mobile phone!

Our mobile phones reply to the People's Republic of China communication industry standards and the European standards and are approved for GSM networks. Your phone may be used internationally with various networks depending on your roaming arrangements with your service provider.

To use this phone you must subscribe to a GSM service from a provider. We have included many features in this device but their function depends on the features available on your subscribed wireless network. Please contact your service provider for more information.

We strongly recommend you to carefully read and understand this manual before using your phone in order to keep it under best conditions for your effective usage and utmost satisfaction.

1. Quick start

Install SIM card

This phone supports two GSM SIM cards. Find SIM card's groove in the back of the phone and slide it completely there. During installation, please make sure insert the SIM card into slot completely and pay attention to slot direction.

Installing T-flash card

1. First switch off the phone and remove the battery.
2. Place the memory card into the SD card slot with the metal contacts facing down.

Installing Battery

Align the battery chip with the metallic salient point in battery jar; insert the battery until it is inserted into the battery jar. Install the back cover into the back of the phone until it is locked.

Battery Charging

Check the model number of any charger before use with the device. Connect the charger to a wall outlet, and connect the plug from the charger into the USB port on the bottom of your phone. If we charge it with electricity, the phone's battery icon will move. After charging is finished, just pull out the plug.

Switching on/off

Long press the power on/off key to switch on or off.

Phone password

Phone password prevents others from using your phone without authorization; in order to ensure the safety of your personal information, please change the original phone password.

2. Call function

Dialing

1. Direct dial

In standby mode, press the corresponding numeric keys to enter the phone number that you want to dial, including necessary area codes. Short press the right soft key to delete one character, and long press to delete all inputs, if only one SIM card is inserted, press the dial/receive key to dial, if two SIM cards are inserted, the phone displays select SIM card page, if you select SIM1 then use SIM1 to dial, you select SIM2, then use SIM2 to dial.

2. Making an international call

To make an international call, long press 0 key until the prefix symbol "+" of international call displays in screen.

3. Dialing from phonebook

Enter the phonebook via the menu, use the up/down navigator keys to scroll to the desired contact, or press the first letter of the name of the desired contact as saved in your phonebook for quick access to names beginning with the letter then scroll to the desired, press the dial/receive key to dial.

4. Dialing from call history

Enter the call center (press the dial/receive key from standby or via the menu), use the up/down navigator keys to scroll to the desired contact, press the dial/receive key to dial.

5. Dial emergency service

You can directly dial the emergency service number without SIM card. Different networks use different emergency service numbers, so for details please inquire

the network operation company.

Receiving calls

When there is an incoming call, the phone will give corresponding alert, if your network supports caller ID, the screen will display caller's name or number (depending on whether there is information of the caller in your phonebook).

3. Menu functions

Contacts

You can use the phone's contacts feature to save the contact name, number. The phone can save contacts on the phonebook, the number of contacts that can be stored in a SIM card varies according to their capacity.

Enter the contacts screen, you can add new contact, view contacts list and select the contacts to call or other operations.

SMS

Message service is a network dependent function, which allows you to send, receive and edit all kinds of messages. Please contact the network operator for more details.

Write message

Edit a new message, save or send it to the recipient.

Inbox

Received messages can be stored either in phone or in SIM card memory, and are accessed here.

When you have received a message, the tones or vibration will alert you and message mark will also be shown on the screen. you can also access the inbox to read the new message.

If the message memory is full, the indication "Memory full" and the message icon will be shown and flashed on the screen. Before you receive new messages, delete some of your old messages in the inbox folder. If the capacity of new messages is beyond the capacity of the inbox, the information will be lost and incomplete.

Outbox

The SMS that failed to be sent, will be stored in the

box, the operation is the same with inbox.

Sent messages

If SMS is sent successfully, then it will be stored in the sent messages box. But automatically save messages need to select, other operation is the same with inbox.

SMS Settings

SIM settings: you can choose either of modes, custom different parameters, including set short message center number, set delivery report, reply path, voicemail server.

Memory status: can view the memory storage status.

Save sent message: open the function, after the SMS is successfully sent it will be automatically saved in the Outbox.

Preferred storage: you can choose to give priority to messages stored in SIM card or mobile phone.

Calls

This phone can record received, dialed and missed as well as their call time. Only when related function is supported by network and phone is switched on and in network service area. Pressing the dial/receive key from standby or accessing through the menu may access call records.

In the call history list, press the left/right navigation key, switch to display list of all /dialed/received/missed calls.

Once on the call records list, press the dial/receive key to make a call; press the OK key to view the details of current call record; press the left soft key into the options to operations.

Palmchat

Palmchat is a free application launched by TECNO, providing instant communication service to MTK platform mobile phone users. Palmchat has online-chatting function, which connects mobile phones in different mobile networks. You can send free text messages instantly through Internet via Palmchat (generating a small data flow). Online chat can be realized in various ways with Palmchat

Palmchat is a free application, with all its features free of charge. Operator will charge the data traffic fee generated by Palmchat.

Facebook

Your phone has built-in Facebook web link, use the function to chat with friends or others by connecting to internet.

Lifestyle

Your phone has a built lifestyle service functions, ringtones, video and other files to download based on your needs, and you can choose the service use that maybe paying specific network operators an appropriate fee.

Settings

Phone settings

Time and date: in this function, you can choose menu to set the current time and date in idle screen, include set home city, set time/date and format etc.

Language: in this function, you can choose the language provided by the phone.

Dedicated keys: you can change the navigation keys function corresponding to the shortcut in the idle screen.

Display: in this function, you can choose menu to set the idle screen display, include wallpaper, screen auto lock, power on/off display etc.

Flight mode: this optional mode in which the phone is normal mode or flight mode, if you choose the flight mode, the phone can only use some of the functions of non-communications.

Power saving management: for your battery long standby, you can turn on the power saving mode, it will automatically switch to the lowest state in this mode.

Security settings

SIM security: PIN code can prevent your SIM card from unauthorized use, you can turn on and off this feature, but you need to enter the correct PIN code. After the function is enabled, the phone will prompt you to enter the PIN code, when turned on every time. You can also change the PIN, PIN2. But the original password is required to support your network operator

Phone security: you can on or off the phone password, phone password on or off are required to enter the correct password. Once opened this feature, the phone will prompt you to enter password, when turned on every time. You can make changes on the phone password.

Network settings

You can automatically or manually select the network, the phone SIM card will be based on the network where the first selection was done, select Manual, you need to select the SIM card registered with the network operator that can use the same network.

Call settings

SIM call settings: in this function, you can choose menu to set the SIM call function, including call waiting, call divert etc.

Advanced settings: in this function, you can choose menu to set the call function, include Auto redial, Answer mode etc. Please refer to the actual function of your phone.

Connectivity

Data accounts: you can choose the Internet account. You can add Internet accounts by yourself.

Restore settings

Restore settings password is 1234, when you enter the password and confirm, the phone will restore to the factory settings.

Images

This feature is convenient for users to view the photos stored in albums, you can view image information, send images by BT, set the image use as wallpaper, delete and more operation.

Camera

Your phone fitted with camera allows you to take photos whenever possible. You can store the pictures in phone or SD card.

Into the camera preview screen, press the OK key to take photo, press the right soft key to return, press the left soft key to get access to the camera settings, you can set Scene mode, Image size, White balance and more operation.

After taking pictures, press the back button to return to camera preview screen, press the left soft key to enter

options, can take pictures to send and delete.

Recorder

Your phone is fitted with sound recorder. Enter the recording screen, you can choose new record, or view the recorder list, or settings recorder storage and audio quality.

Torch

Into the torch interface, select on, torch light; select off, torch dark.

In the idle screen, long press the OK key, torch on or off quickly.

Media player

Play the audio and video files saved in the phone or memory card.

In audio playing interface, press the OK key to start/pause the current song, press the left/right navigation key to switch previous/next song; long press the left/right navigation key to pull the progress bar forward or backward, press the */# key to adjust the volume. In playing interface, press the power on/off key or the right soft key to exit player interface, the phone background-playing mode, while the idle screen shows the name of the music.

In video playing interface, press the OK key to start/pause the current video, press the left/right navigation key to switch previous/next video, Long press the left/right navigation key to pull the progress bar forward or backward; press "1" key or the up navigation key to switch full screen, press the */# key to

adjust the volume, press the down navigation key to stop playing.

FM radio

The phone supports FM radio. in FM radio interface, press the OK key to open/close FM. when open this feature, press the left / right navigation key to move forward / backward auto search until the search to the channel so far. when close the automatic search function, you can use the manual to search for the channel, press the left / right navigation key to move forward /backward 0.1MHZ. press the */# key to adjust play volume. Press the right soft key or power on/off key to exit FM radio, and FM radio plays in the background. And into the option menu, you can view the channel list, manual input channel, auto search channel etc.

Profiles

The phone provides kinds of profiles. It helps you according to the different events and environments in different customer ring tones. According to different scenarios, choose a different profile, then you only need to personalize your profile and activate.

Browser

The internet is the combination of wireless communications and Internet application platform that enables you to get more information by phone and e-commerce and other Internet information resources application.

Files

In document management, you can open files in the phone or memory card, into the option, you can open the file or folder, create new folder, rename, delete files etc. Different file operations are also different, depending on the specific operation by the file.

Bluetooth

The phone supports bluetooth, users can turn the feature on according to the demand.

Bluetooth technology can connect electronic devices wirelessly. Because bluetooth communicates by radio, so in your phone and another bluetooth device do not need to be in the opposite direction, please maintain a maximum distance between two devices that is not more than 10 meters during communication. In some countries or regions may be developed within a number of provisions restricting the use of bluetooth devices, please contact your local authorities.

Calendar

Choose to enter the calendar, the screen will display the system date on the calendar month, and have a background box marking the current date. Press the navigation key to select the date, calendar information on the screen will be updated accordingly.

Alarm

You can use the phone as alarm clock, this feature allows you to set time, make the phone ring or vibrate to remind events.

Calculator

To get access to the calculator, the calculator interface:

Press 0 - 9 numeric keys to enter the number to be calculated, press the navigation key to select the location on the screen corresponding to add, subtract, multiply and divide symbols.

Description:

For mobile specific features, in case of version upgrade without notice, the company has the final interpretation of this description.

4. Input methods

This phone provides diversified input modes for you, when you are editing SMS and adding contacts on the phonebook.

Use the # key to switch between different input methods.

When editing the key controls:

The Right soft key: press to clear one character, long press to clear all.

The Power on/off key: return to the idle screen.

The * Key: in every input status, press this key to call out punctuation and symbol input frame.

ABC (abc) input method

Each key is used to input several characters. Fast and repeatedly press key until your required character appears.

When you need to input English punctuation and some special signs, press the * key to call out special sign input box in English input status.

Press the 0 key to input blank once.

The Numeric input method

To input numerical values, press the respective numeric keys.

5. Warning

Changes or modifications to this unit not expressly approved by the party responsible for compliance could void the user's authority to operate the equipment.

This device complies with Part 15 of the FCC Rules. Operation is subject to the following two conditions: (1) this device may not cause harmful interference, and (2) this device must accept any interference received, including interference that may cause undesired operation. changes or modifications not expressly approved by the party responsible for compliance could void the user's authority to operate the equipment.

RF Exposure Information:

The SAR limit of USA (FCC) is 1.6 W/kg averaged over one gram of tissue. Device Types T472 (FCC ID: 2ADYY-T472) has also been tested against this SAR limit. The highest SAR value reported under this standard during product certification for use when properly worn on the body is 0.792 W/kg and for head is 0.614 W/kg. Simultaneous RF exposure is 0.941 W/Kg.

This device was tested for typical body - worn operations with the back of the handset kept 10mm from the body. To maintain compliance with FCC RF exposure requirements, use accessories that maintain a 10mm separation distance between the user's body and the back of the handset.

The use of belt clips, holsters and similar accessories should not contain metallic components in its assembly.

The use of accessories that do not satisfy these

requirements may not comply with FCC RF exposure requirements, and should be avoided.

NOTE:

This equipment has been tested and found to comply with the limits for a Class B digital device, pursuant to Part 15 of the FCC Rules. These limits are designed to provide reasonable protection against harmful interference in a residential installation. This equipment generates, uses and can radiate radio frequency energy and, if not installed and used in accordance with the instructions, may cause harmful interference to radio communications. However, there is no guarantee that interference will not occur in a particular installation. If this equipment does cause harmful interference to radio or television reception, which can be determined by turning the equipment off and on, the user is encouraged to try to correct the interference by one or more of the following measures:

- Reorient or relocate the receiving antenna.
- Increase the separation between the equipment and receiver.
- Connect the equipment into an outlet on a circuit different from that to which the receiver is connected.
- Consult the dealer or an experienced radio/TV technician for help.

This device and its antenna(s) must not be co-located or operation in conjunction with any other antenna or transmitter.