



Quick Installation Guide

AC1200 Smart Dual-Band WiFi Router
Model: ACS

This Quick Installation Guide is for installation instruction only. For more product or function details, please go to www.tendacn.com

Packing List

- Wireless Router *1
- Power Adapter *1
- Ethernet Cable *1
- Quick Installation Guide *1

If any item is missing, or damaged, please keep the original package and contact the local reseller or distributor immediately.



Set Up the Router

If you want to replace your original router connected to the internet with a PPPoE user name and password, start from **Step 1**. Otherwise, start from **Step 2**.

Step 1: Connect the new router to the internet with a PPPoE user name and password

1. Power on your original and new routers.
2. Connect the WAN port of the original router to a LAN port (1/2/3) of the new router using an Ethernet cable, from blinking, your PPPoE user credentials will be copied.
3. When the LAN an

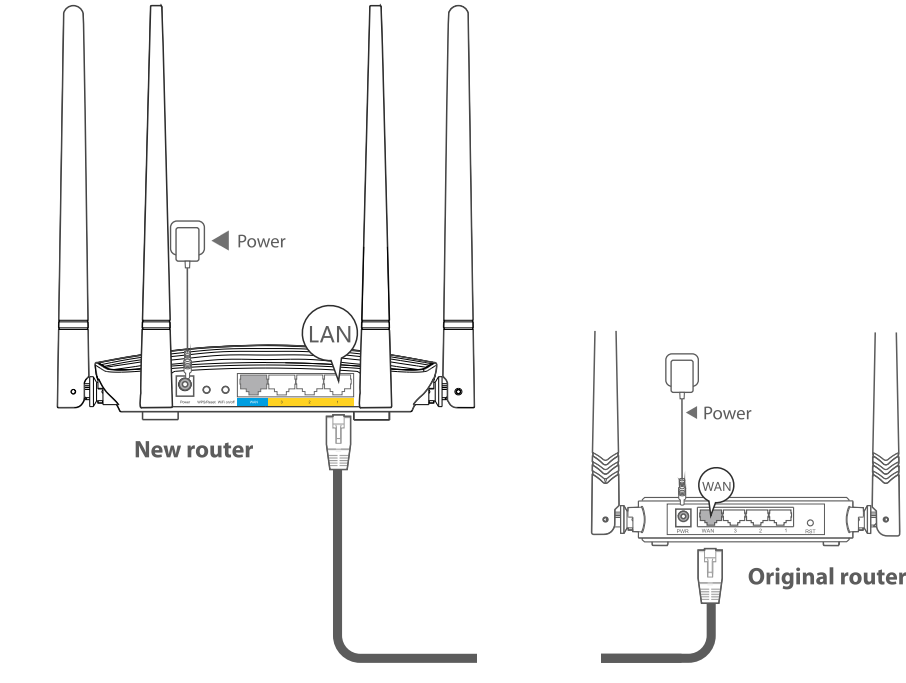

Step 2: Connect the new router to the internet

Use either of the following methods to connect your new router to the internet based on your actual situation.

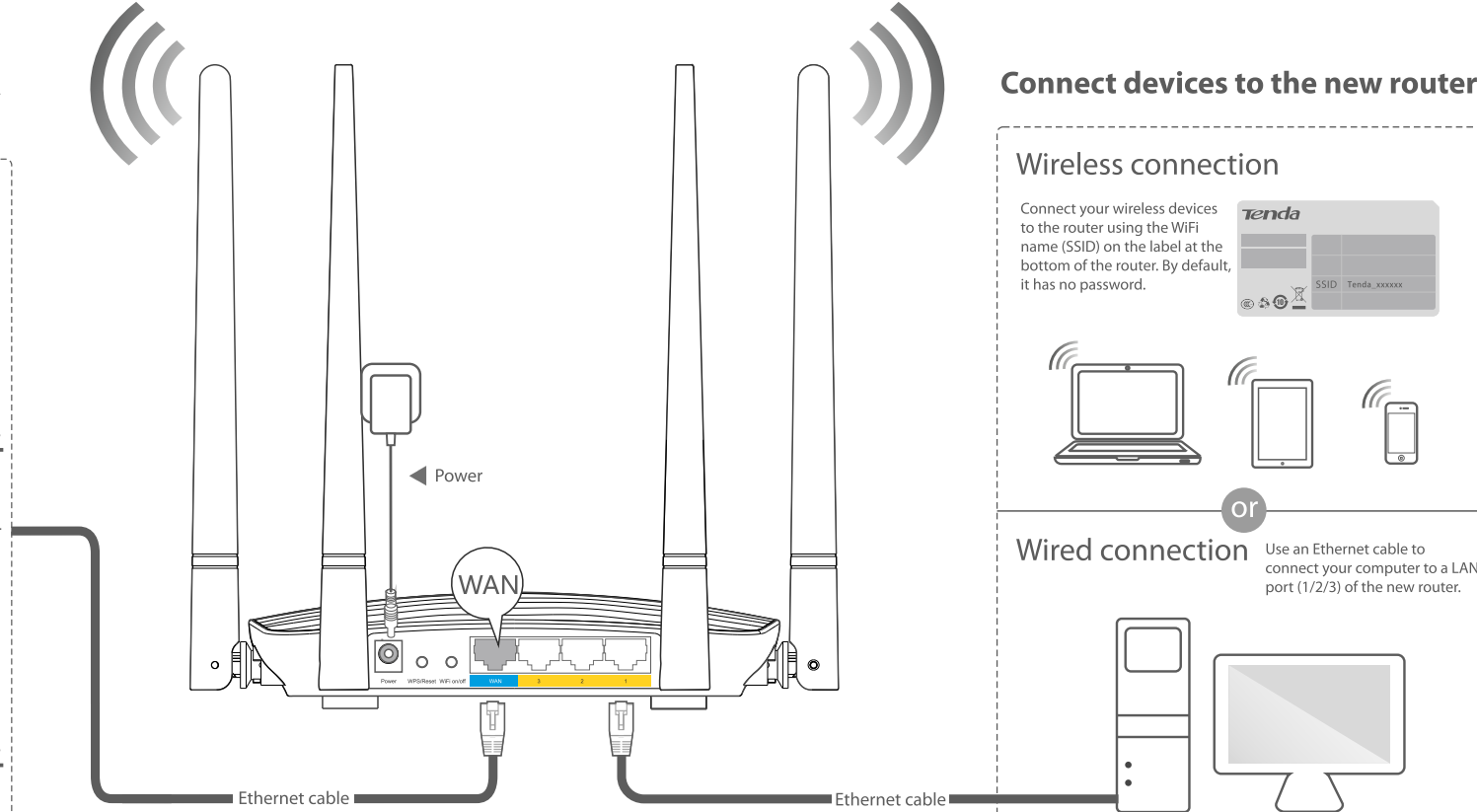
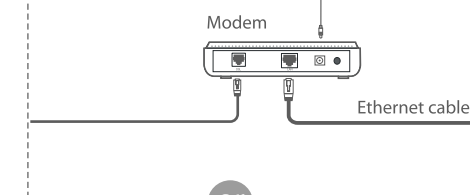
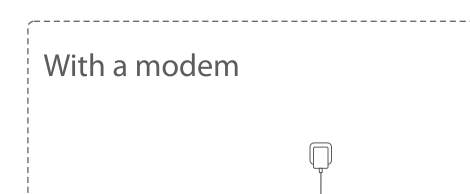

Connect devices to the new router

Wireless connection
Connect your wireless devices to the router using the WiFi name (SSID) on the label at the bottom of the router. By default, it has no password.

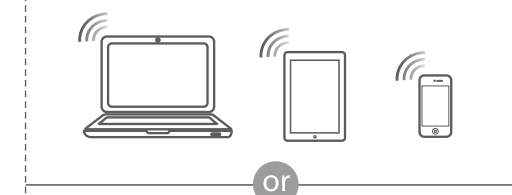

Wired connection
Use an Ethernet cable to connect your computer to a LAN port (1/2/3) of the new router.



Step 3: Set the new router

* You are recommended to use a Google Chrome, Firefox, or Internet Explorer 8 (or later) browser.

1. Start a web browser on the device that has connected to the new router. Enter tendawifi.com or 192.168.0.1 in the address bar and press **Enter**.



2. Click **Start**. (If the following page does not appear, refer to **Q1** in **FAQ**.)



3. The system automatically detects your internet connection type. If you have not imported PPPoE user name and password, select your internet connection type, set the related parameters, and click **Next**.

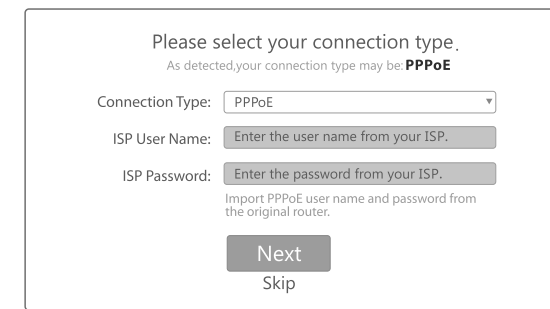

The **ISP User Name** and **ISP Password** are populated automatically if you have migrated them. Click **Next**.

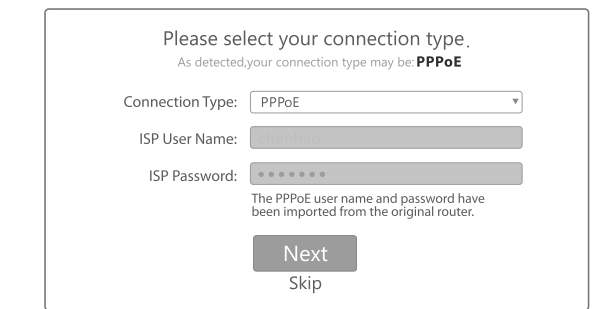

4. Set your SSID, WiFi password, and login password. Then click **Next**.
Note: The WiFi password is used to connect to the WiFi of the router, and the login password is used to login to the web UI of the router.



Connected. You can access the internet through WiFi or connecting wired devices to the router by Ethernet cable. The WiFi name is shown on the screen. The WiFi password is what you set.

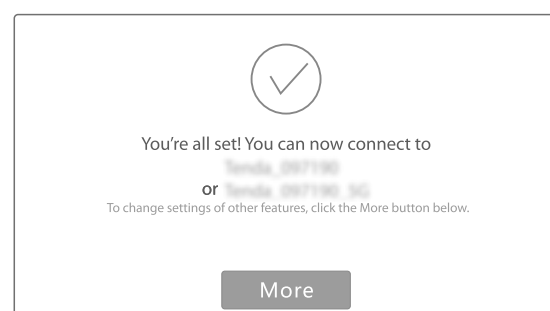

Tip: If the internet is inaccessible after configuration, or the figure **You're all set!** does not appear, please refer to **Q2** in **FAQ**.

Producto	NOMBRE DEL PRODUCTO: Router inteligente de banda dual WiFi AC1200 MODELO: ACS
Alimentador de Energía	Alimentación: 100-240V ca 50Hz/60Hz, 0.3 A Salida: 5V x1.0A
PAIS DE ORIGEN: CHINA	

LA OPERACION DE ESTE DISPOSITIVO ESTA SUJETA A LAS SIGUIENTES CONDICIONES:
a) Es posible que este equipo o dispositivo no cause interferencia perjudicial.
b) Este equipo o dispositivo debe aceptar cualquier tipo de interferencia, incluyendo la que pueda causar su operacion no deseada.

Technical Support
Shenzhen Tenda Technology Co., Ltd.
6-8 Floor, Tower E3, No. 1001, Zhongshanyuan Road, Nanshan District, Shenzhen, China. 518052
United States Hotline: 1-800-570-5892
Canada Hotline: 1-888-998-8966
HongKong Hotline: 00852-81931998
Skype: Tendaz
Website: <http://www.tendacn.com>
E-mail: support@tenda.com

Copyright
© 2017 Shenzhen Tenda Technology Co., Ltd. All rights reserved.
Tenda is a registered trademark legally held by Shenzhen Tenda Technology Co., Ltd. Other brand and product names mentioned herein are trademarks or registered trademarks of their respective holders. Specifications are subject to change without notice.

Join Your WiFi

iPhone/iPad



1. Click the **Settings** icon.

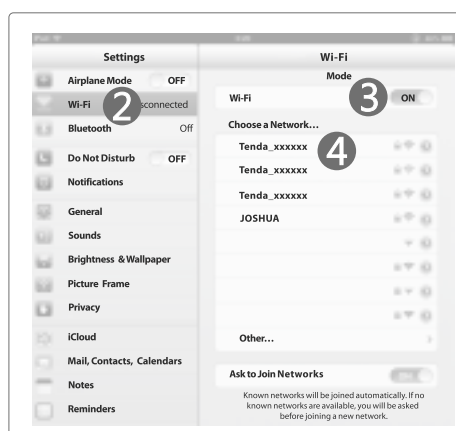

2. Click **Wi-Fi**.
3. Click **ON/OFF** button to open Wi-Fi.
4. Find the name of the network you wish to connect and click it.

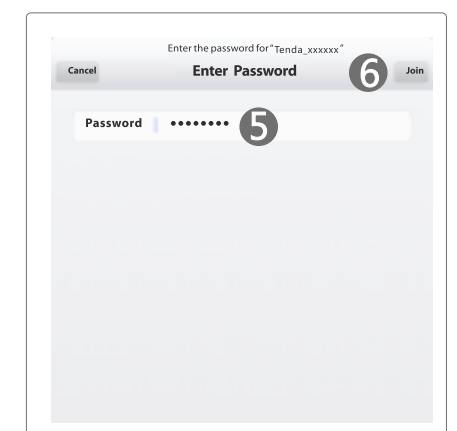

5. Enter the WiFi password.
6. Click **Join** to join the wireless network.

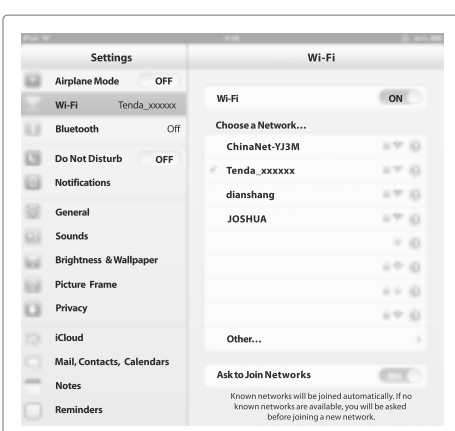

Connected successfully!

Windows 8

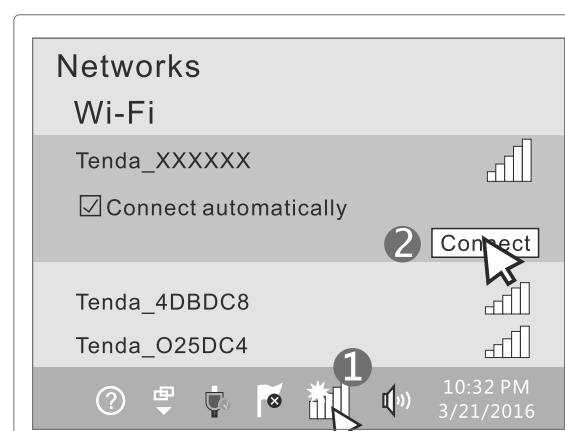

1. Click the icon in the lower-right corner of your desktop.
2. Select your WiFi name from the list, and click **Connect**.

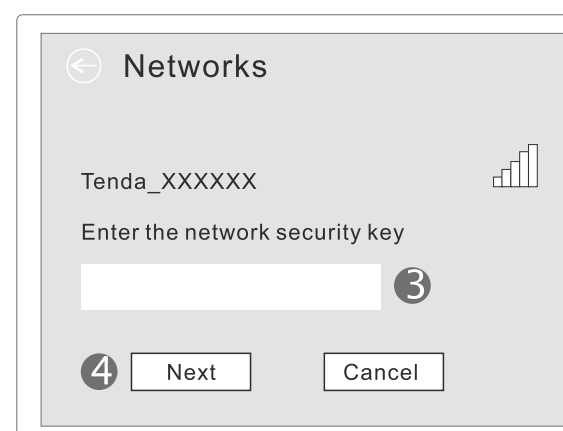

3. Enter the WiFi password (network security key) of your WiFi.
4. Click **Next**.



Connected successfully!

LED Indicator	Status	Description
SYS	Solid on	The router is starting.
	Blinking	The system is faulty after startup.
	Solid on	The 2.4 GHz and/or 5 GHz wireless network is enabled.
WiFi	Blinking	Data is transmitting wirelessly.
	Slow Blinking	The router is performing WPS negotiation.
	Off	Both the 2.4 GHz and 5 GHz wireless networks are disabled.
1/2/3	Solid on	The LAN port is connected properly.
	Off	The LAN port is unconnected or connected improperly.
WAN	Solid on	The WAN port is connected properly.
	Off	The WAN port is unconnected or connected improperly.
T	Reserved	

Port / Button	Description
Power	It is a power port used to connect to the power adapter included with the package.
WPS/Reset	It is a button used to start the WPS negotiation process of the router, or to reset the router. • WPS: Press the button of the router, and enable the WPS function of another device within 2 minutes. Then a WPS connection between them is established. • Reset: Hold the button down for 8 seconds. Reset succeeds when all LED indicators blink once.
WiFi on/off	This button is used to turn on/off the WiFi of the router.
WAN	It is a WAN port used to connect this router to the internet. By default, it functions as a LAN port. After the IP/V function of the router is enabled, it functions only as an IP/V port used to connect with a set-top box.
1	They are LAN ports used to connect with devices such as computers or switches.

FAQ

Q1: If I cannot login to the web UI of the router after entering tendawifi.com or 192.168.0.1, what should I do?
A1: Try the following solutions:
• If entering the IP address 192.168.0.1 does not work, try logging again by entering tendawifi.com.
• Ensure that the connection between your device and the router is correct. If you connect the client to this router in a wireless manner, make sure the client connects to the router's SSID. If you connect the client to the router by Ethernet cable, ensure that it has been connected to a LAN port (1/2/3) of the router. For detailed connection instructions, refer to **Step 2**.
• Clear the cache of your web browser or replace the web browser.
• Replace the computer or wireless device.
• Reset the router and try logging again.
Method to reset: Power on the router. When the SYS indicator blinks, you can hold down the WPS/Reset button for 8 seconds. Reset succeeds when all LED indicators blink once.

Q2: If the page "You're all set!" does not appear or I cannot access the internet after configuring internet settings, what should I do?

A2: Try the following methods:
• A countdown page may appear in advance if you use PPPoE or Static IP address to access the internet since the remote server needs time to authenticate your internet information, which does not affect the internet connection. You can try accessing the internet directly.
• If the problem persists, check if the hardware connection is proper. Ensure that the Ethernet cable plugged into the WAN port of ACS has been connected to the internet, and the connection between the WAN port and the cable has no loosening as well.
• Refer to the following table to check if your connection type and login credentials are correct.

Information provided by your ISP	Connection type
ISP user name and ISP password	PPPoE
None	Dynamic IP Address
IP Address, subnet mask, gateway, DNS server and other parameters.	Static IP Address

• If your wireless devices cannot access the internet, ensure that you connect to the proper SSID. Or you can change your WiFi name and password on the web UI of the router, and try connecting again.
• If your computer connected to a LAN port (1/2/3) of the router via an Ethernet cable cannot access the internet, consult your ISP.
Q3: Why cannot my phone search for 5 GHz signal?
A3: Only devices supporting 5 GHz signal can scan and connect to the 5 GHz network.



RECYCLING
This product bears the selective sorting symbol for Waste electrical and electronic equipment (WEEE). This means that this product must be handled pursuant to European directive 2012/19/EU in order to be recycled or dismantled to minimize its impact on the environment.
User has the choice to give his product to a competent recycling organization or to the retailer when he buys a new electrical or electronic equipment.



CE Mark Warning

This is a Class B product. In a domestic environment, this product may cause radio interference. In which case the user may be required to take adequate measures. Operations in the 5.15-5.25GHz band are restricted to indoor use only. This equipment should be installed and operated with minimum distance 20cm between the radiator & your body.
-For PLUGGABLE EQUIPMENT, the socket-outlet shall be installed near the equipment and shall be easily accessible.
NOTE: (1) The manufacturer is not responsible for any radio or TV interference caused by unauthorized modifications to this equipment. (2) To avoid unnecessary radiation interference, it is recommended to use a shielded RJ45 cable.

Declaration of Conformity

Hereby, SHENZHEN TENDA TECHNOLOGY CO., LTD. declares that the radio equipment type ACS is in compliance with Directive 2014/53/EU.
The full text of the EU declaration of conformity is available at the following internet address: <http://www.tendacn.com/en/service/download-cata-101.html>
Operate Frequency:
2.4G EU / 2400-2483.5 MHz (CH1-CH13)
5G EU / 5150-5250 MHz (CH36-CH48)
ERP Power (Max.):
2.4 GHz: 19.8 dbm
5 GHz: 22.5 dbm
Software Version: V1.03.06.XX



Caution:
Adapter Model: BN052-A0909E
Manufacturer: SHENZHEN HEWEISHUN NETWORK TECHNOLOGY CO., LTD.
Input: 100-240V AC 50/60 Hz 0.3 A
Output: 5V 1.0 A
--- DC Voltage
Operating Temperature: 0°C - 40°C
Operating Humidity: 10% - 90% RH, non-condensing



FCC Statement

This equipment has been tested and found to comply with the limits for a Class B digital device, pursuant to Part 15 of the FCC Rules. These limits are designed to provide reasonable protection against harmful interference in a residential installation. This equipment generates, uses and can radiate radio frequency energy and, if not installed and used in accordance with the instructions, may cause harmful interference to radio communications. However, there is no guarantee that interference will not occur in a particular installation. If this equipment does cause harmful interference to radio or television reception, which can be determined by turning the equipment off and on, the user is encouraged to try to correct the interference by one or more of the following measures:
-Reorient or relocate the receiving antenna.
-Increase the separation between the equipment and receiver.
-Connect the equipment into an outlet on a circuit different from that to which the receiver is connected.
-Consult the dealer or an experienced radio/TV technician for help.
This device is restricted to be used in the indoor.
This device complies with Part 15 of the FCC Rules.
Operation is subject to the following two conditions: (1) this device may not cause harmful interference, and (2) this device must accept any interference received, including interference that may cause undesired operation.

Radiation Exposure Statement

This device complies with FCC radiation exposure limits set forth for an uncontrolled environment.
This equipment should be installed and operated with minimum distance 20cm between the radiator & your body.

Caution:

Any changes or modifications not expressly approved by the party responsible for compliance could void the user's authority to operate this equipment.
This transmitter must not be co-located or operating in conjunction with any other antenna or transmitter.
NOTE: (1) The manufacturer is not responsible for any radio or TV interference caused by unauthorized modifications to this equipment. (2) To avoid unnecessary radiation interference, it is recommended to use a shielded RJ45 cable.

