

Quick Installation Guide

AX1800 Dual Band Gigabit Wi-Fi 6 Router

Package contents

- Wireless router x 1
- Power adapter x 1
- Ethernet cable x 1
- Quick installation guide x 1



Scan QR code to download Tenda WiFi App

For product or function details, please go to www.tendacn.com to download the user guide.

I. Connect the router

The "new router" and "router" in this guide refer to the router in the package.

Step 1: Import your PPPoE user name and password into the new router (Optional)

Tips
This function is only applicable when the connection type of the original router is PPPoE, except for PPPoE of some special ISPs or PPPoE connection set up manually with VLAN information.

1. Power on your original and new routers.
2. Connect the WAN port of the original router to a LAN port of the new router using an Ethernet cable. After the LED indicator of the new router blinks fast for 8 seconds, the PPPoE user name and password are imported to your new router.
3. Remove the original router.

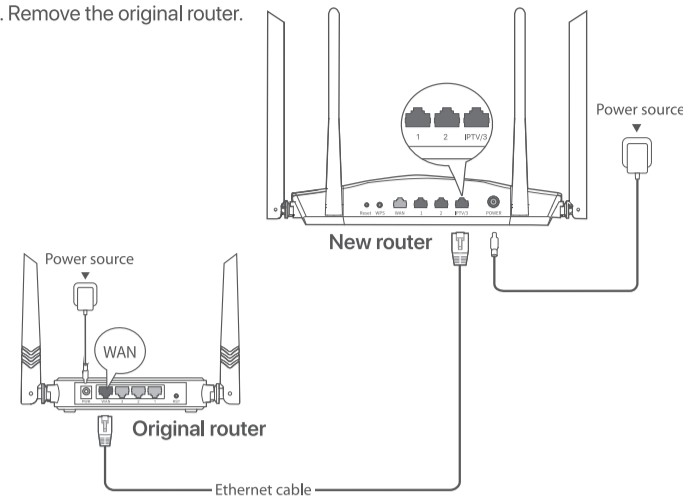

Step 2: Connect the WAN port of the router

1. Ensure that the router is powered on.
2. Connect the WAN port of the router to the LAN port of your modem or the Ethernet jack using an Ethernet cable. The LED indicator blinks fast for 3 seconds.

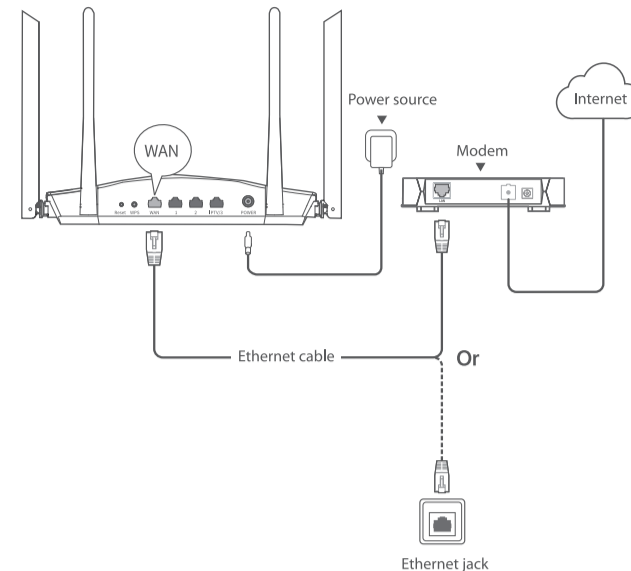

II. Connect your device to the router

Option A: Connect your WiFi-enabled device, such as a smartphone, to the wireless network of the router. You can find the default WiFi network information on the bottom label of the router.

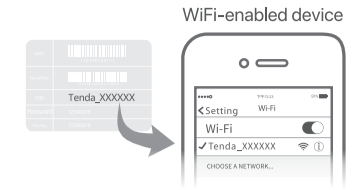

Option B: Connect your wired device, such as a computer, to a LAN port of the router using an Ethernet cable. The LED indicator blinks fast for 3 seconds.

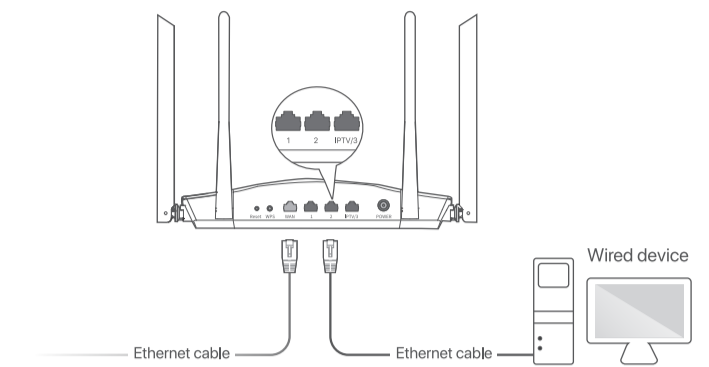

III. Set up the router

1. Start a web browser on the device connected to the router, and visit tendawifi.com. Click **Start**.

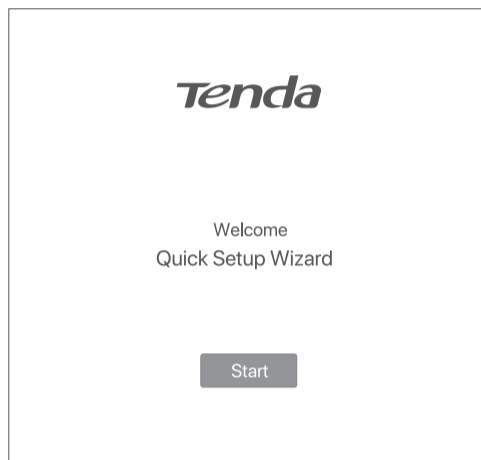

2. The router detects your connection type automatically. Select the **ISP Type** based on your region and ISP and enter required parameters (if any). Click **Next**.

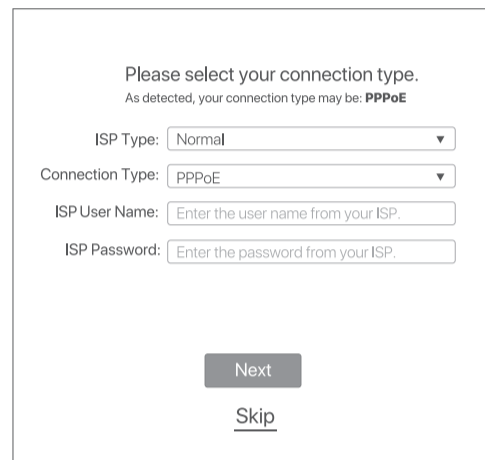

3. Set the WiFi name, WiFi password and Login password for the router. Click **Next**.

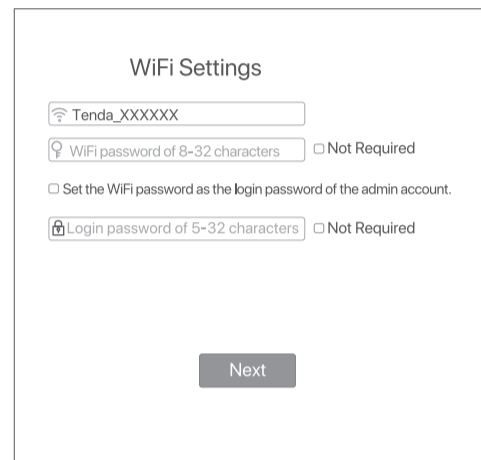

Done.

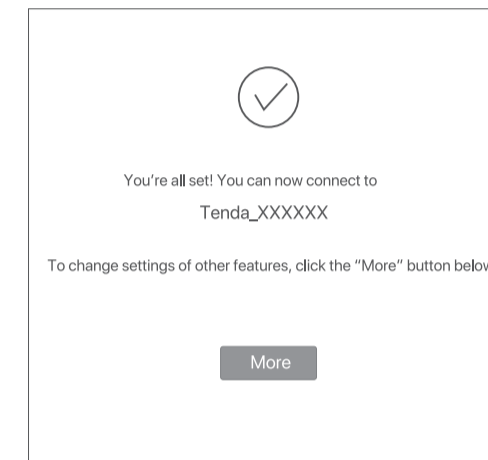

To access the internet with:

- WiFi-enabled devices: Connect to the WiFi network using the WiFi name and password you set.
- Wired devices: Connect to a LAN port of the router using an Ethernet cable.

Tips
- By default, the WiFi name for both 2.4 GHz and 5 GHz are the same. If you need to modify the WiFi name and WiFi password, see **Q3** in **FAQ**.
- If you still cannot access the internet after the configuration, refer to **Q2** in **FAQ**.

Tips
If the above page does not appear, refer to **Q1** in **FAQ**.

Tips
The WiFi password is used to connect to the WiFi network, while the login password is used to log in to the web UI of the router.

LED indicators

LED indicator	Status	Description
LED indicator	Solid on	The system is starting up, or the router is already connected to the internet.
	Blink slow	The router fails to connect to the internet.
	Blink fast for 3 seconds	A device is connected to or disconnected from an Ethernet port of the router.
	Blink fast for 2 minutes	The router is pending for or performing WPS negotiation.
	Off	The system is faulty, or the router is not powered on properly.

Jack, ports and buttons

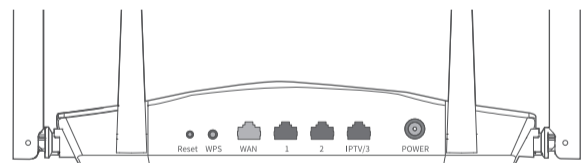

Jack/Port/Button	Description
POWER	Power jack. Please use the included power adapter to connect this jack to a power source for power supply.
Reset	Used to restore the factory settings of the router. Method: When the router is working normally, hold the button down with a needle-like object for about 8 seconds, and then release it when the LED indicator blinks fast. The router is reset.
WPS	Used to start the WPS negotiation of the router. Method: Press the button, and the LED indicator blinks fast. Within 2 minutes, enable the WPS function of the other WPS-supported device to establish a WPS connection.
WAN	10/100/1000 Mbps auto-negotiation WAN port. Used to connect to a modem or the Ethernet jack using an Ethernet cable for internet access.
1, 2	10/100/1000 Mbps auto-negotiation LAN port. Used to connect to computers, switches or game machines, etc.
IPTV/3	10/100/1000 Mbps auto-negotiation Ethernet port. It is a LAN port by default. When the IPTV function is enabled, it can only serve as an IPTV port to connect to a set top box.

FAQ

Q1: I cannot log in to the web UI of the router by visiting tendawifi.com. What should I do?

- A1:** Try the following solutions:
- If you are using a WiFi-enabled device, such as a smartphone:
 - Ensure that it connects to the WiFi network of the router.
 - Ensure that the cellular network (mobile data) of the device is disabled.
 - If you are using a wired device, such as a computer:
 - Ensure that tendawifi.com is entered correctly in the address bar, rather than the search bar of the web browser.
 - Ensure that the computer is connected to a LAN port of the router properly using an Ethernet cable.
 - Ensure that the computer is set to obtain an IP address automatically and obtain DNS server address automatically.
- If the problem persists, reset the router, and try again.

Q2: I cannot access the internet after the configuration. What should I do?

- A2:** Try the following solutions first:
- Check whether the WAN port of the router is connected to a modem or Ethernet jack properly.
 - Log in to the web UI of the router and navigate to the **Internet Settings** page. Follow the instructions on the page to solve the problem.
- If the problem persists, try the following solutions:
- For WiFi-enabled devices:
 - Check whether your WiFi-enabled devices are connected to the WiFi network of the router.
 - Visit tendawifi.com to log in to the web UI and change your WiFi name and WiFi password on the **WiFi Settings > WiFi Name & Password** page. Then try again.
 - For wired devices:
 - Check whether your wired devices are connected to a LAN port properly.
 - Check whether wired devices are set to obtain an IP address automatically and obtain DNS server address automatically.

Q3: How to change the WiFi names and passwords?

- A3:** Follow the steps below:
- 1 Connect your WiFi-enabled device to the WiFi network of the router, or connect your computer to a LAN port using an Ethernet cable.
 - 2 Start a web browser and visit tendawifi.com to log in to the web UI of the router.
 - 3 Navigate to the **WiFi Settings > WiFi Name & Password** page to change and save the settings.

Q4: How to reset the router?

- A4:** Try the following methods:
- Method A: When the router is working normally, hold down the **Reset** button with a needle-like object for about 8 seconds and release it when the LED indicator blinks fast. The router is reset.
- Method B: Log in to the web UI of the router and navigate to **System Settings > Backup/Restore**.

Q5: I cannot find the WiFi network of the router on my WiFi-enabled device. What should I do?

- A5:** Connect your computer to a LAN port of the router to log in to the web UI. Navigate to **WiFi Settings > WiFi Name & Password** and ensure that:
- The WiFi networks are enabled.
 - The **Hide** function is disabled.

Q6: I cannot find the 5 GHz WiFi network of the router on my WiFi-enabled device. What should I do?

- A6:** Try the following solutions:
- Check whether your WiFi-enabled device supports 5 GHz WiFi network.
 - Only devices supporting 5 GHz network can find and connect to the 5 GHz WiFi network.
 - Check whether the **Unify 2.4 GHz & 5 GHz** function is disabled. If it is disabled, refer to **Q5** to find a solution.



CE Mark Warning
This is a Class B product. In a domestic environment, this product may cause radio interference, in which case the user may be required to take adequate measures. Operations in the 5.15-5.25GHz band are restricted to indoor use only. This equipment should be installed and operated with minimum distance 20cm between the device and your body. The mains plug is used as disconnect device, the disconnect device shall remain readily operable.
NOTE: (1) The manufacturer is not responsible for any radio or TV interference caused by unauthorized modifications to this equipment. (2) To avoid unnecessary radiation interference, it is recommended to use a shielded RJ45 cable.

Declaration of Conformity
Hereby, SHENZHEN TENDA TECHNOLOGY CO., LTD. declares that the radio equipment type RX3/TX3 is in compliance with Directive 2014/53/EU. The full text of the EU declaration of conformity is available at the following internet address: <http://www.tendacn.com/en/service/download-cata-101.html>

Operating Frequency:
2.4 GHz: EU/2400-2483.5 MHz (CH1-CH13)
5 GHz: EU/5150-5250 MHz (CH36-CH48)
EIRP Power (Max.):
2.4 GHz: 19.86 dBm
5 GHz: 22.96 dBm
Software Version: V16.03.13.X (RX3/TX3)

For EU/EFTA, this product can be used in the following countries:

BE	BG	CZ	DK	DE	EE	IE	EL	ES	FR	HR	IT	CY	LV
LT	LU	HU	MT	NL	AT	PL	PT	RO	SI	SK	FI	SE	UK



FCC Statement
This equipment has been tested and found to comply with the limits for a Class B digital device, pursuant to Part 15 of the FCC Rules. These limits are designed to provide reasonable protection against harmful interference in a residential installation. This equipment generates, uses and can radiate radio frequency energy and, if not installed and used in accordance with the instructions, may cause harmful interference to radio communications. However, there is no guarantee that interference will not occur in a particular installation. If this equipment does cause harmful interference to radio or television reception, which can be determined by turning the equipment off and on, the user is encouraged to try to correct the interference by one or more of the following measures:
- Reorient or relocate the receiving antenna.
- Increase the separation between the equipment and receiver.
- Connect the equipment into an outlet on a circuit different from that to which the receiver is connected.
- Consult the dealer or an experienced radio/TV technician for help.
The device is for indoor usage only.
Operation is subject to the following two conditions: (1) this device may not cause harmful interference, and (2) this device must accept any interference received, including interference that may cause undesired operation.
Radiation Exposure Statement
This device complies with FCC radiation exposure limits set forth for an uncontrolled environment and it also complies with Part 15 of the FCC RF Rules.
This equipment should be installed and operated with minimum distance 20cm between the device and your body.
Caution:
Any changes or modifications not expressly approved by the party responsible for compliance could void the user's authority to operate this equipment.
This transmitter must not be co-located or operating in conjunction with any other antenna or transmitter.
Operating frequency: 2412-2462MHz, 5150-5250MHz, 5725-5850MHz
NOTE: (1) The manufacturer is not responsible for any radio or TV interference caused by unauthorized modifications to this equipment. (2) To avoid unnecessary radiation interference, it is recommended to use a shielded RJ45 cable.

Caution(RX3/TX3):

Adapter Model: BN073-A12012E/BN073-A12012B
Manufacturer: SHENZHEN HEWEISHUN NETWORK TECHNOLOGY CO., LTD.
Input: 100 - 240V AC, 50/60Hz, 0.4A
Output: 12V \pm 1A
DC Voltage



RECYCLING
This product bears the selective sorting symbol for Waste electrical and electronic equipment (WEEE). This means that this product must be handled pursuant to European directive 2012/19/EU in order to be recycled or dismantled to minimize its impact on the environment.
User has the choice to give his product to a competent recycling organization or to the retailer when he buys a new electrical or electronic equipment.

Operating Temperature: 0°C - 40°C
Operating Humidity: (10% - 90%) RH, non-condensing

Wall Mounting

This router can be installed on the wall with two screws. The specifications of recommended screws are as follows:
PA3*14mm, head diameter: 5.2mm, head height: 1.8mm.

Technical Support

Shenzhen Tenda Technology Co., Ltd.
6-8 Floor, Tower E3, NO.1001, Zhongshanyuan Road, Nanshan District, Shenzhen, China.
518052
USA hotline: 1-800-570-5892
Toll Free: 7 x 24 hours
Canada hotline: 1-888-998-8966
Toll Free: Mon - Fri 9 am - 6 pm PST
Hong Kong hotline: 00852-81931998
Global hotline: +86 755-2765 7180 (China Time Zone)
Website: www.tendacn.com
E-mail: support@tenda.com.cn

Copyright

© 2020 Shenzhen Tenda Technology Co., Ltd. All rights reserved.
Tenda is a registered trademark legally held by Shenzhen Tenda Technology Co., Ltd. Other brand and product names mentioned herein are trademarks or registered trademarks of their respective holders. Specifications are subject to change without notice.