



INSTRUCTION MANUAL

UHF WIRELESS MICROPHONE

WM-5225
WM-5265

Thank you for purchasing TOA's UHF Wireless Microphone.
Please carefully follow the instructions in this manual to ensure long, trouble-free use of your equipment.

1. SAFETY PRECAUTIONS

- Be sure to read the instructions in this section carefully before use.
- Make sure to observe the instructions in this manual as the conventions of safety symbols and messages regarded as very important precautions are included.
- We also recommend you keep this instruction manual handy for future reference.

Safety Symbol and Message Conventions

Safety symbols and messages described below are used in this manual to prevent bodily injury and property damage which could result from mishandling. Before operating your product, read this manual first and understand the safety symbols and messages so you are thoroughly aware of the potential safety hazards.

	WARNING	Indicates a potentially hazardous situation which, if mishandled, could result in death or serious personal injury.
	CAUTION	Indicates a potentially hazardous situation which, if mishandled, could result in moderate or minor personal injury, and/or property damage.

WARNING

- To prevent the electromagnetic wave from badly influencing medical equipment, make sure to switch off the unit's power when placing it in close proximity to the medical equipment.

When the Unit is in Use

- Use TOA's Battery Charger when recharging.
- The wireless microphone can be powered by any available Ni-MH Batteries.
But, if use of any other than the counter specified battery into the TOA Battery Charger, it may cause the fire, personal injury or environmental contamination due to battery rupture or leakage.
- The use of any other than the specified charger could result in fire, personal injury or environmental contamination due to battery rupture or leakage.
- Stop charging if the batteries are not fully charged within 3 hours. Failure to do so may cause the batteries to fire, explode, leak, or heat.
- Never short-circuit the charging terminals on the bottom of the microphone with metal objects. Doing so could result in electric shocks or burns.

CAUTION

- When the unit is not in use for 10 days or more, be sure to take the battery out of the unit because battery leakage may cause personal injury or contamination of environment.
- Make sure to observe the following handling precautions so that a fire or personal injury does not result from leakage or explosion of the battery.
 - Do not short, disassemble, heat nor put the battery into a fire.
 - Never charge batteries of the type which are not rechargeable.
 - Do not solder a battery directly.
 - Be sure to use the specified type of battery.
 - Note correct polarity (positive and negative orientation) when inserting a battery in the unit.
 - Avoid locations exposed to the direct sunlight, high temperature and high humidity when storing batteries.

CAUTION TO USER: Changes or modifications not expressly approved by the party responsible for compliance could void the user's authority to operate the equipment.

CAUTION

Do not place the dry cell battery into charger

Placing non-rechargeable batteries in the charger may cause the battery to crack resulting in a fire and/or harm to the body.

When recharging, please only use the designated battery charger and designated battery. Do not use other battery types.

When the battery becomes inflated or leaks, discontinue use and replace with new one immediately.

If there's any burning and/or peculiar smell when battery is charging, please switch off the power immediately.

License requirement

The term "IC:" before the radio certification number only signifies that Industry Canada Technical specifications were met. Operation is subject to the following two conditions:

(1) This device may not cause harmful interference, and (2) this device must accept any interference received, including interference that may cause undesired operation.

Le présent appareil est conforme aux CNR d'Industrie Canada applicables aux appareils radio exempts de licence. L'exploitation est autorisée aux deux conditions suivantes : (1) l'appareil ne doit pas produire de brouillage, et (2) l'utilisateur de l'appareil doit accepter tout brouillage radioélectrique subi, même si le brouillage est susceptible d'en compromettre le fonctionnement.

IMPORTANT NOTE: To comply with the FCC RF exposure compliance requirements, no change to the antenna or the device is permitted. Any change to the antenna or the device could result in the device exceeding the RF exposure requirements and void user's authority to operate the device.

2. GENERAL DESCRIPTION

The TOA's WM-5225 Wireless Microphone employs an electret condenser microphone element of high sensitivity and intelligible sound quality, and is suitable for speech use.

WM-5265 is a vocal microphone, employs a fine, powerful dynamic microphone unit.

3. FEATURES

- One frequency can be selected from 64 frequencies (16 channels x 4 banks) of 576-865 MHz.
- An optimized PLL-synthesizer minimizes the oscillation frequency drift resulting from the ambient temperature or voltage fluctuation.
- Power/Battery lamps indicate battery consumption to prevent the unit from malfunctioning when the battery level remarkably decreases.
- Operates on a single AA battery.
- Employs a built-in antenna.
- The state of battery consumption can be displayed on the tuner's indicator when the unit is used in conjunction with the optional WT-5800, WT-5805 or WT-5810 Wireless Tuner.

4. HANDLING PRECAUTIONS

- Do not expose the unit to rain or an environment where it may be splashed by water or other liquids, as doing so may result in unit failure.
- Never open nor remove the unit case to modify the unit. Refer all servicing to your nearest TOA dealer.
- Take care not to drop the unit onto the floor nor bump it against a hard object as the unit could fail.
- Do not place the unit in locations of high temperature (ex. in an ill-ventilated car in summer) or high humidity as the unit could fail.
- Do not use the unit in locations where it is exposed to seawater.
- To clean, use a dry cloth. When the unit gets very dirty, wipe lightly with a cloth dampened in a dilute neutral cleanser, then wipe with a dry cloth. Never use benzine, thinner, or chemically-treated cleaning towel.
- Avoid using a mobile telephone near the wireless microphone in use. Noise could be picked up.
- When using two or more wireless microphones, keep them at least 50 cm away from each other to avoid malfunctions or noise.
- Keep the wireless microphone at least 3 m away from the receiving antenna. Using the microphone in close proximity to the antenna could result in malfunctions or noise.

5. NOMENCLATURE

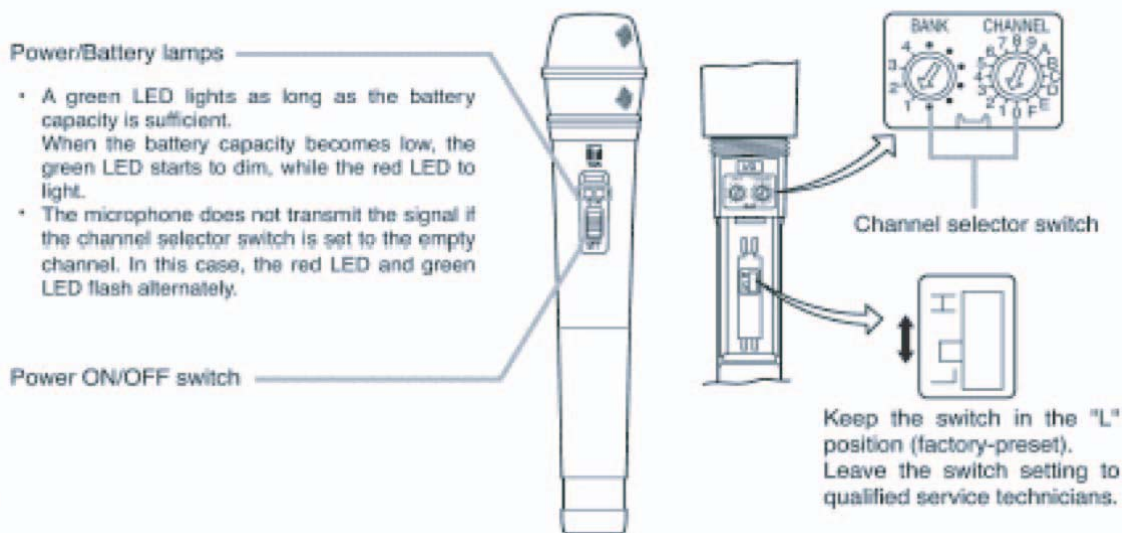

6. BATTERY INSERTION

- Step 1.** Turn off the power switch.
- Step 2.** Hold the microphone body and rotate the microphone grip counterclockwise to remove it.
- Step 3.** Insert an AA battery according to (+) and (-) indications on the battery compartment.
- Step 4.** Replace the microphone grip by sliding and rotating it clockwise.

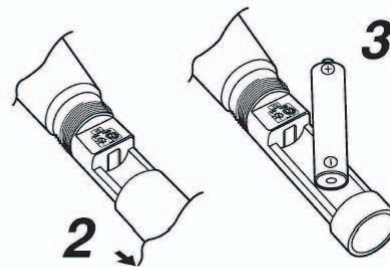

Battery replacement

- A brand-new AA alkaline battery will continuously operate the unit for about 10 hours.
- When the battery capacity becomes low, the green LED of the Power/Battery lamps starts to dim, while the red LED to light. When only the red LED lights, replace the battery with a new one. In this condition, the unit transmits the remaining battery capacity information to the tuner, causing the tuner's BATT indicator to light.

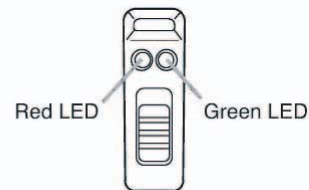

7. CHANNEL NUMBER SETTING

- Step 1.** Switch off the power. Rotate the microphone grip counterclockwise to remove it.
- Step 2.** Using the supplied screwdriver, set the Channel selector switch pointer to the desired channel number.
- Step 3.** Replace the microphone grip.

Note: Make sure that the wireless microphone is identical to the wireless tuner in the channel number. Should the microphone's setting differ from that of the tuner, the tuner does not receive the microphone signal.

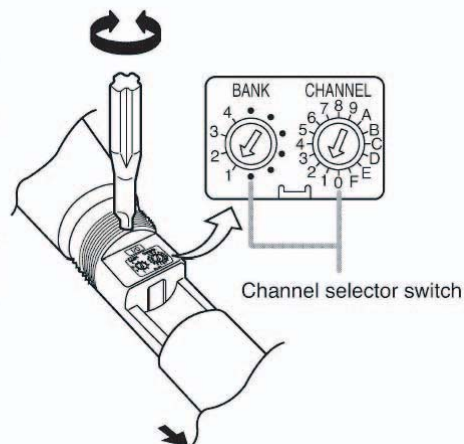

8. OPERATION

- Step 1.** Confirm that the wireless microphone and the wireless tuner are identical in the channel number. If not identical, turn the power ON/OFF switch to the OFF position, then set the channel number to the same channel number as the tuner.
- Step 2.** Turn the Power ON/OFF switch to the ON position. Then, confirm the green LED of the Power/Battery lamps will light.
- Step 3.** Turn the Power ON/OFF switch to the OFF position after use.

9. OPERATIONAL HINTS

- The microphone's service distance is 3 – 120 m. When the microphone user moves in a facility, signal dropouts (momentary losses of signal reception) may be encountered. These dropouts are caused by the building's architectural designs or materials which block the travel of or reflect the radio signal. If this occurs, the user needs to change locations for better signal reception.
- The proper operation of your wireless system may be interfered with by other system operating on the same frequency. In such cases, change the operating frequency of your system. (As to dealing with the interference, refer to the operating instructions of the wireless tuner.)
- Should you have any questions regarding the use or availability of TOA wireless products, please contact your local TOA dealer.

10. SPECIFICATIONS

	WM-5225	WM-5265
Microphone Element	Electret condenser type ; cardioid pattern	dynamic microphone unit, cardioid pattern
Modulation	Frequency modulation	
Frequency Range	576 – 865 MHz * .UHF	
Channel Selectable	64 channel	
RF Carrier Power	less than 50 mW	
Tone Frequency	32.768 kHz	
Oscillator	PLL synthesized	
Maximum Input Level	126 dB SPL	132 dB SPL
Maximum Deviation	± 40 kHz	
Audio Frequency Response	100 Hz – 15kHz	
Dynamic Range (AF circuit)	95 dB or more (with WT – 5800)	
Battery	Rechargeable battery or LR6(AA)	
Battery Life	12 hours and more (Rechargeable Ni-MH battery)	
Indicator	Power/Battery lamps	
Antenna	Built – in type	
Operating Temperature	–10 °C to +50 °C	
Finish	Resin. coating	
Dimensions	φ 43.6 x 231.5 mm	φ 50.0 x 229.0 mm
Weight	180g (with battery)	205g (with battery)
Accessory	Microphone holder (with stand adapter)···1, Screw driver···1, Storage case···1	

* APPEARANCE

Type	Frequency Range
A01	692 – 722 MHz,UHF
B01,B02	722 – 752 MHz,UHF
C01 – C07	794 – 830 MHz,UHF
D01 – D05	830 – 865 MHz,UHF
E01	668 – 697.925 MHz,UHF
F01	636 – 666 MHz,UHF
G01	606 – 636 MHz,UHF
H01	576 – 606 MHz,UHF

Note: The design and specifications are subject to change without notice for improvement.

• Accessories

Microphone holder (with stand adapter) 1 Storage case 1
Screwdriver (for setting) 1