

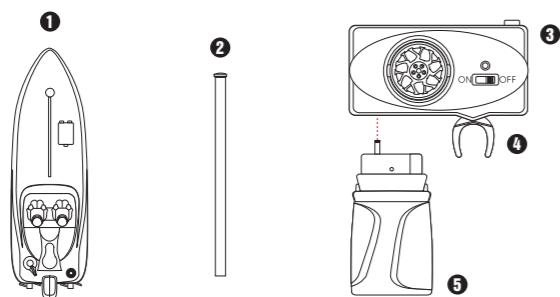

# Mini POWER BOAT

8+



**Included:**

- ① Boat
- ② Antenna
- ③ Controller
- ④ Control Trigger
- ⑤ Charger

**Included:**

- ① Boat
- ② Antenna
- ③ Controller
- ④ Control Trigger
- ⑤ Charger

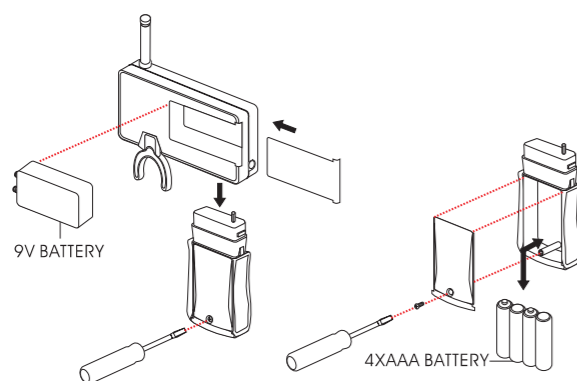

Loosen the screw on the battery compartment door of the charger with a Phillips® screwdriver. Remove the battery compartment door and insert 4 x AAA batteries following the + / - markings which indicated inside the battery compartment. Replace the battery compartment door and re-secure the screw. Insert 1x 9v battery into the controller following the + / - markings.

Loosen the screw on the battery compartment door of the charger with a Phillips® screwdriver. Remove the battery compartment door and insert 4 x AAA batteries following the + / - markings which indicated inside the battery compartment. Replace the battery compartment door and re-secure the screw. Insert 1x 9v battery into the controller following the + / - markings.

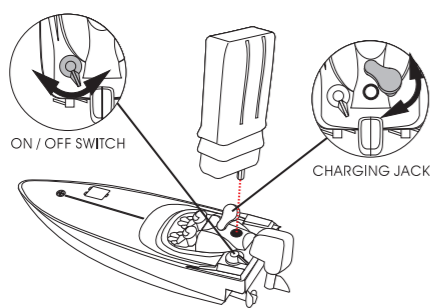

- Set the switch on the Boat to OFF.
- Insert charger into base of Boat chassis.
- When red light on charger goes out, boat is charged.
- Set the switch on the boat to ON/OFF.
- DO not over charge the boat.
- Set the switch on the Boat to OFF.
- Insert charger into base of Boat chassis.
- When red light on charger goes out, boat is charged.
- Set the switch on the boat to ON/OFF.
- DO not over charge the boat.

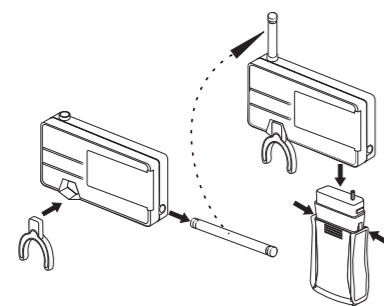

- Insert antenna and screw in place.
- Attach control trigger.
- Push the charger into the controller until it clicks.
- Set the switch on controller to ON/OFF.
- Insert antenna and screw in place.
- Attach control trigger.
- Push the charger into the controller until it clicks.
- Set the switch on controller to ON/OFF.

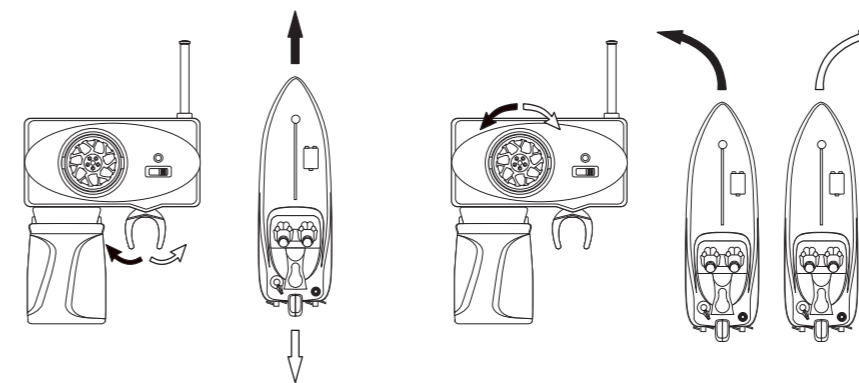

Trigger moves the car forward and reverse. Steering wheel turns the car left and right.

Trigger moves the car forward and reverse. Steering wheel turns the car left and right.

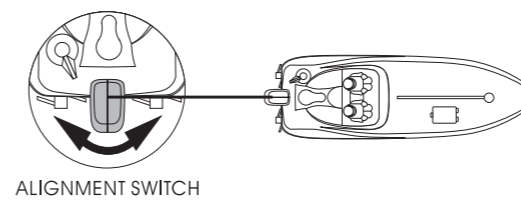

Use the lever at the boat rear to align the steering. If your boat is driving to the left, then move the lever to the right until corrected. If your boat is driving right, move the lever to the left.

Use the lever at the boat rear to align the steering. If your boat is driving to the left, then move the lever to the right until corrected. If your boat is driving right, move the lever to the left.

**Helpful Hints :**

- If the boat's motor does not respond to the transmitter, move closer to the boat and try again.
- If someone uses a CB nearby, it might interfere with control of the boat. If this happens, move the boat and transmitter away from the CB.
- You cannot operate your boat near devices with transmitters that use the same frequency. Check the packaging to see which frequency your boat uses.
- If the boat moves slowly, recharge the battery, and check the wheel mechanisms for lint, thread, hair or dust.
- If the boat is not operating correctly, try changing the batteries. Remember the 9V in the controller will last longer than the 4xAAA in the charger.
- When the transmitter range decreases, replace the battery in the controller.
- Do not charge non-rechargeable batteries.
- Charger must be operated by an adult only.
- Do not short the supply terminals.

**CARE :**

- The following suggestions will help you care for your boat so you can enjoy it for years:
- Do not operate the boat in sea water, waves, strong winds, strong currents or dirty water.
  - Never swim out to retrieve your boat.
  - Never take the boat out of the water when the propeller is turning.
  - Keep fingers, hair and loose clothing away from the propeller when the boat is switched on.
  - Ensure the boat and controller is switched off before attempting to clean the propeller.
  - To avoid accidental operation always switch the controller on first, and then the boat. After use, always switch the boat off first, followed by the controller.
  - Remove batteries from boat and controller when not in use.
  - Do not drop or attempt to crash the boat.
  - Warning! Never leave a child unattended near water. Adult supervision required at all times.

Modifying or tampering with the boat or the transmitter's internal components can cause a malfunction and void your FCC authorization to operate them.

**THE FCC WANTS YOU TO KNOW :**  
Your boat or transmitter might cause TV or radio interference even when it is operating properly. To determine whether your boat or transmitter is causing the interference, turn off your boat and release the transmitter's control levers. If the interference goes away, your boat or transmitter is the cause.

**Try to eliminate the interference by:**

- Moving your boat and transmitter away from the TV or radio.

If you cannot eliminate the interference, the FCC requires that you stop using your boat.

**FCC NOTE :**  
The antenna provided is a unique antenna. By installation of

unauthorized antenna to this equipment. Such unauthorized installation could void the user's authority to operate the equipment. The manufacturer is not responsible for any radio or TV interference caused by unauthorized modifications to this equipment. Such modifications could void the user's authority to operate the equipment.

**BATTERY PACK CARE/CAUTIONS:**

- If you do not plan to use the boat for several days, remove the batteries from the transmitter and charger.
- Do not mix old and new batteries. Do not mix alkaline, standard (carbon zinc), or rechargeable (nickel-cadmium) or Ni-MH batteries.
- Dispose of old batteries promptly and properly; do not bury or burn them.
- Insert batteries with the correct polarity.
- Keep the package and owner's manual since it contains important information.

This device complies with Part 15 of the FCC Rules. Operation is subject to the following two conditions:  
(1) This device may not cause harmful interference, and  
(2) This device must accept any interference received, including interference that may cause undesired operation.

**Helpful Hints :**

- If the boat's motor does not respond to the transmitter, move closer to the boat and try again.
- If someone uses a CB nearby, it might interfere with control of the boat. If this happens, move the boat and transmitter away from the CB.
- You cannot operate your boat near devices with transmitters that use the same frequency. Check the packaging to see which frequency your boat uses.
- If the boat moves slowly, recharge the battery, and check the wheel mechanisms for lint, thread, hair or dust.
- If the boat is not operating correctly, try changing the batteries. Remember the 9V in the controller will last longer than the 4xAAA in the charger.
- When the transmitter range decreases, replace the battery in the controller.
- Do not charge non-rechargeable batteries.
- Charger must be operated by an adult only.
- Do not short the supply terminals.

**CARE :**  
The following suggestions will help you care for your boat so you can enjoy it for years:

- Do not operate the boat in sea water, waves, strong winds, strong currents or dirty water.
- Never swim out to retrieve your boat.
- Never take the boat out of the water when the propeller is turning.
- Keep fingers, hair and loose clothing away from the propeller when the boat is switched on.

- Ensure the boat and controller is switched off before attempting to clean the propeller.
- To avoid accidental operation always switch the controller on first, and then the boat. After use, always switch the boat off first, followed by the controller.
- Remove batteries from boat and controller when not in use.
- Do not drop or attempt to crash the boat.
- Warning! Never leave a child unattended near water. Adult supervision required at all times.

Modifying or tampering with the boat or the transmitter's internal components can cause a malfunction and void your FCC authorization to operate them.

**THE FCC WANTS YOU TO KNOW :**  
Your boat or transmitter might cause TV or radio interference even when it is operating properly. To determine whether your boat or transmitter is causing the interference, turn off your boat and release the transmitter's control levers. If the interference goes away, your boat or transmitter is the cause.

**Try to eliminate the interference by:**

- Moving your boat and transmitter away from the TV or radio.

If you cannot eliminate the interference, the FCC requires that you stop using your boat.

**FCC NOTE :**  
The antenna provided is a unique antenna. By installation of unauthorized antenna to this equipment. Such unauthorized installation could void the user's authority to operate the equipment. The manufacturer is not responsible for any radio or TV interference caused by unauthorized modifications to this equipment. Such modifications could void the user's authority to operate the equipment.

- BATTERY PACK CARE/CAUTIONS:**
- If you do not plan to use the boat for several days, remove the batteries from the transmitter and charger.
  - Do not mix old and new batteries. Do not mix alkaline, standard (carbon zinc), or rechargeable (nickel-cadmium) or Ni-MH batteries.
  - Dispose of old batteries promptly and properly; do not bury or burn them.
  - Insert batteries with the correct polarity.
  - Keep the package and owner's manual since it contains important information.

This device complies with Part 15 of the FCC Rules. Operation is subject to the following two conditions:  
(1) This device may not cause harmful interference, and  
(2) This device must accept any interference received, including interference that may cause undesired operation.