

1:16 Incredible Instruction  
Prints 1 Color Process Black

Folded size: 65mm x 121mm  
Extended size: 392mm x 121mm



## RADIO CONTROL INCREDIBLE

© Disney / Pixar  
FAST LANE is a mark of Geoffrey, Inc.  
© Geoffrey, Inc.  
Distributed by Toys"R"Us, Inc.,  
Wayne, NJ 07470  
Made in China  
www.toysrus.com

AGE  
**6+**

**ATTENTION PARENTS:**  
**IT IS RECOMMENDED THAT THIS TOY  
AND ALL ACCESSORIES BE  
PERIODICALLY EXAMINED FOR  
POTENTIAL HAZARDS AND THAT ANY  
POTENTIALLY HAZARDOUS PARTS  
BE REPAIRED OR REPLACED.**

### OPERATING INSTRUCTIONS

#### BATTERY PACK CARE / CAUTIONS:

- Use only a fresh battery and/or battery pack of the required size and type.
- If you do not plan to use the vehicle for several days, remove the battery from the transmitter and the battery pack from the vehicle.
- Do not mix old and new batteries. Do not mix alkaline, standard (carbon zinc), or rechargeable (nickel-cadmium) or Ni-MH batteries.
- Never leave dead or weak batteries in the vehicle.
- Dispose of old batteries promptly and properly; do not bury or burn them.
- Do not charge non-rechargeable batteries.
- Insert batteries with the correct polarity.
- Do not short the supply terminals.
- Remove rechargeable batteries from the vehicle before being charged.
- Keep the package and owner's manual since it contains important information.

### BATTERY INSTALLATION:

#### TRANSMITTER:

The transmitter requires one 9-volt battery (not included). For the best performance and longest life, we recommend an alkaline battery. Follow these steps to install the battery in the transmitter:

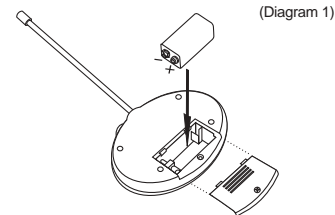

1. Remove battery compartment cover by sliding it in the direction of the arrow shown on the compartment cover.
2. Place battery in the compartment according to the polarity symbols (+ and -) marked inside. (See diagram 1)
3. Replace the cover and snap it shut.

When the transmitter's range decreases, replace battery.

#### CAR:

Your vehicle requires a 6-volt rechargeable battery pack (not included) or 4 x AA batteries (not included).

### USING 6V BATTERY PACK:

Battery compartment latch (Diagram 2)

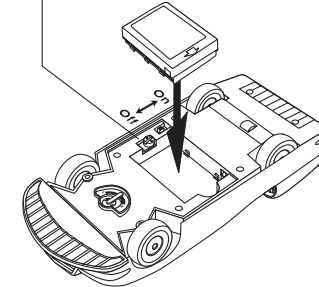

1. Slide **ON/OFF** switch on the bottom of the vehicle to **OFF**.
2. Insert battery pack into the battery compartment as shown. (See diagram 2)
3. Push battery pack forward in direction of arrow engraved on battery pack.
4. Use a coin to turn the battery compartment latch counterclockwise until it stops to lock the battery pack in position.

When the vehicle slows down, recharge the battery pack. When the battery pack will no longer hold a charge, replace it.

**Note:** To remove, use a coin to turn the battery compartment latch clockwise until it stops, slide the battery pack up and remove it from the battery compartment.

### USING 4 X AA BATTERIES:

1. You can use 4 x AA batteries (Alkaline, Rechargeable NiMH, or Rechargeable NiCd) to power your vehicle by using the AA Battery Adaptor provided.

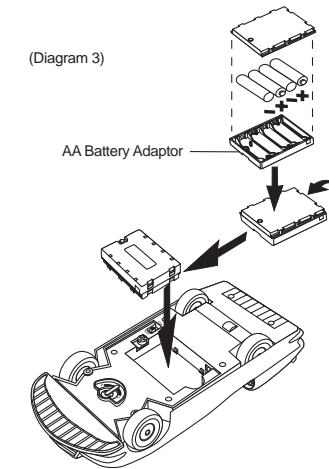

2. Insert 4 x AA batteries in the AA Battery Adaptor according to the polarity symbols (+ and -) marked inside. (See diagram 3)
3. Insert AA Battery Adaptor, as battery pack with AA batteries facing down into the battery compartment as shown. Follow steps 2, 3 and 4 of USING 6V BATTERY PACK.

### DRIVING THE CAR:

**Warning:** Never play with your vehicle in the street.

1. Slide **ON/OFF** switch on the side of the vehicle to **ON**. (See diagram 5)

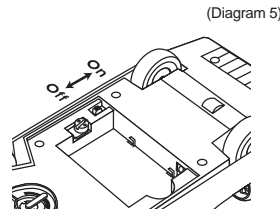

2. Use the transmitter's control levers as follows: (See diagram 6)

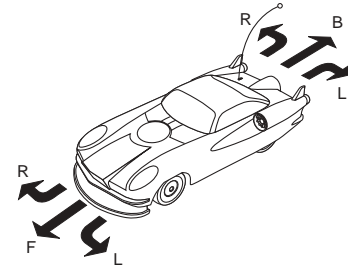

(Diagram 6)

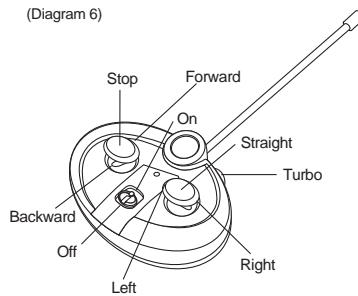

#### Left Control Lever:

- Push forward to move forward (F).
- Pull back to move backward (B).
- Release to stop.

#### Right Control Lever:

- Push left to move left (L).
- Push right to move right (R).
- Release to go straight.

#### TURBO:

- Press "Turbo" button for maximum power.

**Caution:** If the vehicle gets stuck under an object, immediately release the control levers on the transmitter, then retrieve the vehicle.

3. When you finish driving, slide the **ON/OFF** switch on the vehicle to **OFF**.

### HOW TO OPERATE:

1. If the vehicle does not go in a straight line when you release the right control lever, adjust the wheel alignment control on the bottom of the vehicle. Turn the wheel alignment control toward L if the vehicle is pulling to the right, or toward R if the vehicle is pulling to the left. (See diagram 7)

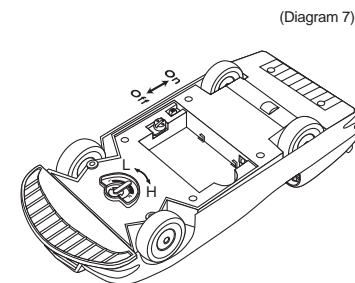

### HELPFUL HINTS:

The following hints can help you get the most enjoyment from your vehicle:

- Running your vehicle continuously for long periods generates high heat levels. Heat causes wear and tear on the motor. When your vehicle's battery dies, let the vehicle cool at least 10 minutes before installing a newly charged battery pack. This helps keep heat levels down.
- If the vehicle's motor runs but does not respond to the transmitter, move closer to the vehicle and try again.
- If someone uses a CB nearby, it might interfere with control of the vehicle. If this happens, move the vehicle and transmitter away from the CB.
- You cannot operate your vehicle near devices with transmitters that use the same frequency, (27 MHz or 49 MHz). Check the packaging to see which frequency your vehicle uses.
- If the vehicle moves slowly, and you have installed a recharged battery pack, check the wheel mechanisms for lint, thread, hair or dust.

### CARE:

The following suggestions will help you care for your vehicle so you can enjoy it for years:

- Never drive the vehicle on a wet floor, on sand, or in mud, rain, or snow. These can damage it.
  - Do not expose the vehicle to extreme temperatures.
  - To protect the vehicle's wheel mechanisms from lint and hair, do not drive it on carpet.
  - Occasionally wipe the vehicle with a damp cloth to keep it looking new. Do not use harsh chemicals to clean the vehicle.
- Modifying or tampering with the vehicle or the transmitter's internal components can cause a malfunction and void your FCC authorization to operate them.

### THE FCC WANTS YOU TO KNOW:

Your vehicle or transmitter might cause TV or radio interference even when it is operating properly. To determine whether your vehicle or transmitter is causing the interference, turn off your vehicle and release the transmitter's control levers. If the interference goes away, your vehicle or transmitter is the cause.

Try to eliminate the interference by:

- Moving your vehicle and transmitter away from the TV or radio.

If you cannot eliminate the interference, the FCC requires that you stop using your vehicle.

This device complies with Part 15 of the FCC Rules. Operation is subject to the following two conditions:

- (1) this device may not cause harmful interference, and
- (2) this device must accept any interference received, including interference that may cause undesired operation.