

Band C 27.095 Mhz  
80169/80080 Asst.

Band D 27.145 Mhz  
80171/80080 Asst.

# RICOCHET

## OPERATION MANUAL



### BATTERIES REQUIRED

- 12x 1.5v "AA"    1x 1.5v "C"  
 1x 9.6v rechargeable

Alkaline batteries required. Nitro XRC Power Pack includes all batteries required. (sold separately)

### **WARNING:**

This vehicle is not intended to be operated by persons under the age of 16. Death or serious bodily injury can result if fuel is not used properly with this vehicle. Follow all directions on vehicle and fuel container. For outdoor use only. Do not operate vehicle near people. Fuel vapors are flammable. Never use near a flame or other source of ignition, including lit cigarettes.

# IMPORTANT SAFETY INFORMATION

Thank you for purchasing this NITRO XRC™ vehicle. This manual contains all the information you need to maintain, modify and run your vehicle safely. Please read it carefully before operating the vehicle.

## WARNING:

- NITRO XRC fuel is poisonous. Read all precautionary labeling on your fuel bottle before use.
- NITRO XRC fuel is flammable. If ignited, it burns clear — meaning you may not be able to see the flame. Never refuel or operate the vehicle near sparks or open flame. In the case of a fire, use a chemical fire extinguisher — NOT water — to put out the fire.

## CAUTION:

- Any spectators should remain behind the driver. Never run your vehicle into a person or animal.
- Know your surroundings and where you're driving. Distractions can lead to accidents.
- Always turn on the transmitter (remote), before turning on the receiver.
- Be certain that anyone else operating an RC vehicle nearby is operating on a different frequency than you (see page 25).
- The engine and exhaust can become very hot during operation. Always allow the engine to cool before touching it or refueling.
- Do not operate this vehicle indoors, at night, or on public roadways.

### IMPORTANT NOTES:

- Operate your vehicle only in wide-open areas. Crashing into curbs, walls, or parked cars can damage the vehicle and any objects with which it collides.
- The powerful I.C.E. engine can generate a lot of noise. Do not operate this vehicle where the engine noise may disturb others.

**HobbyTown USA**

For parts, fuel and technical support, call Tiger Consumer Affairs at 1-800-844-3733 or visit [www.nitroxrc.com](http://www.nitroxrc.com) or [www.hobbytown.com](http://www.hobbytown.com). Keep your NITRO XRC vehicle running at peak performance. Visit your local HobbyTown USA, or go to [www.hobbytown.com](http://www.hobbytown.com) for more information.



## KIT INCLUDES:

Air filter  
4 extra body pins  
Transmitter Crystal  
(not shown)

Electric  
Starter



Transmitter



Glow Plug Igniter



RICOCHET\*\*  
(each sold separately)



Band C 27.095 Mhz  
80169/80080 Asst.



Band D 27.145 Mhz  
80171/80080 Asst.

## BEFORE YOU FACE & UNLEASH :



**NITRO XRC™ Power Pack,**  
including batteries (C, 9.6v NiCAD, AA's), wrench  
for glow plug & tires, 9.6v battery charger



Wildcat Fuel for NITRO  
XRC with unique fuel  
delivery system



<b>SAFETY INFORMATION</b>	<i>PAGE 1</i>
<b>ABOUT THE NITRO XRC™** RICOCHET®*</b>	<i>PAGE 4</i>
<b>BEFORE YOU START</b>	<i>PAGE 5</i>
<b>INSTALLING AND CHARGING BATTERIES</b>	<i>PAGE 6</i>
<b>QUICK START GUIDE</b>	<i>PAGE 10</i>
<b>GETTING TO KNOW YOUR XRC RICOCHET</b>	<i>PAGE 11</i>
<b>FILLING THE FUEL TANK</b>	<i>PAGE 14</i>
<b>PRIMING AND STARTING THE ENGINE</b>	<i>PAGE 17</i>
<b>MAINTENANCE INFORMATION</b>	<i>PAGE 19</i>
▶ THROTTLE TRIM	<i>PAGE 20</i>
▶ STEERING TRIM	<i>PAGE 21</i>
▶ BODY	<i>PAGE 22</i>
▶ AIR FILTER	<i>PAGE 22</i>
▶ GLOW PLUG	<i>PAGE 23</i>
▶ FUEL-AIR MIXTURE	<i>PAGE 24</i>
<b>RACE CRYSTALS</b>	<i>PAGE 25</i>
<b>CHECKLISTS</b>	<i>PAGE 26</i>
<b>PULLING TRICKS</b>	<i>PAGE 27</i>
<b>TROUBLESHOOTING</b>	<i>PAGE 28</i>
<b>GLOSSARY</b>	<i>PAGE 29</i>
<b>WARRANTY</b>	<i>PAGE 30</i>

# XRC RICOCHET®\*

## ABOUT THE NITRO XRC™\* RICOCHET®\*

The RICOCHET is built for stunts. It's constructed to be easy to jump, flip, spin and tumble. Even though the RICOCHET is built to take a lot of punishment, you should avoid crashing it on purpose. Still, the sicker the trick is, the higher the probability you'll wreck the first time you try it. Use your best judgment before taking a jump or trying a flip.

When racing more than one NITRO XRC™\* vehicle (you can race up to 6 at a time), you'll need to be certain that each vehicle is operating on a different frequency band. The band of your vehicle is printed on the cover of this manual. There are four stock bands – two for the NITRO REVOLUTION MT™\* and two for the RICOCHET®\* vehicles. Radio crystals for additional bands are available from the store at which you purchased this vehicle or from your local HobbyTown USA. Check out [www.nitroxc.com](http://www.nitroxc.com) and [www.hobbytown.com](http://www.hobbytown.com) for more information.



### TECH SPECS

Length.....	19.5"
Front Track.....	15.625"
Rear Track.....	15.625"
Height.....	7.87"
Wheelbase.....	11.5"
Wheel Diameter.....	7.87"
Tires.....	SUPER TRACTION STUNT TIRES
Engine.....	XRC 2.5 Racing Engine Powered by I.C.E.
Radio System.....	XRC Band C 27.095 Mhz / Band D 27.145 Mhz

# BEFORE YOU START

## INSTALLING THE AIR FILTER

It is vital that you always keep your air filter clean and dry. A dirty air filter will affect the performance of your vehicle, and can damage the engine. Replacement air filters are available from your local Hobby Town USA ([www.hobbytown.com](http://www.hobbytown.com)). For cleaning instructions, see page 22.

### To install your air filter:

1. Remove vehicle body (page 22).
2. Remove protective cover from carburetor.
3. Snap plastic air filter housing into engine.

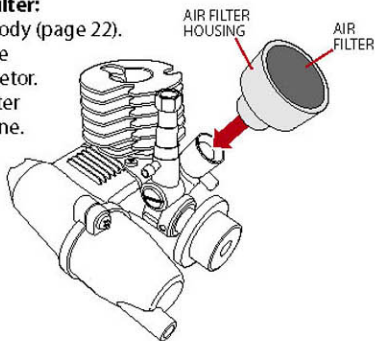

## INSTALLING THE FREQUENCY MODULE

**To install your frequency Module:**  
Snap the Module into your Transmitter as shown.

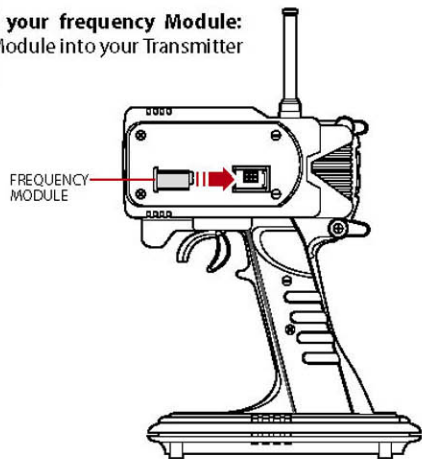

# BATTERY INFORMATION

## INSTALLING & CHARGING THE BATTERIES



### **CAUTION:** TO AVOID BATTERY LEAKAGE

- 1) Be sure to insert the batteries correctly and always follow the vehicle and battery manufacturers' instructions;
- 2) Do not mix old and new batteries or alkaline, standard (carbon-zinc) or rechargeable (nickel-cadmium) batteries;
- 3) Always remove weak or dead batteries from the product.

All of the required batteries  
are available in the NITRO XRC™  
Power Pack (sold separately).



Glow Plug  
Igniter

Remove battery compartment door. Insert  
1 x 1.5v "C" or LR14 alkaline battery, as  
shown. Replace battery compartment door.

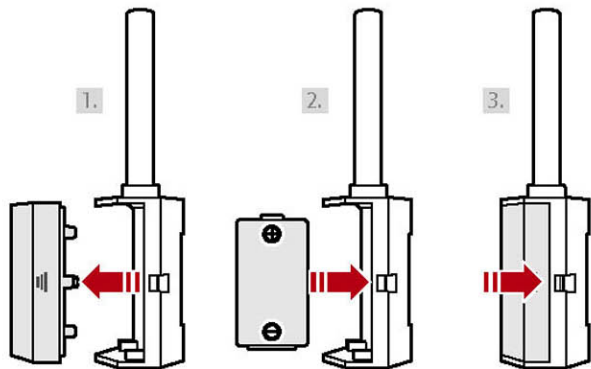

Transmitter

Remove battery compartment door. Insert  
8 x 1.5v "AA" or R6 size battery, as shown.  
Alkaline batteries recommended. Replace  
battery compartment door.

