

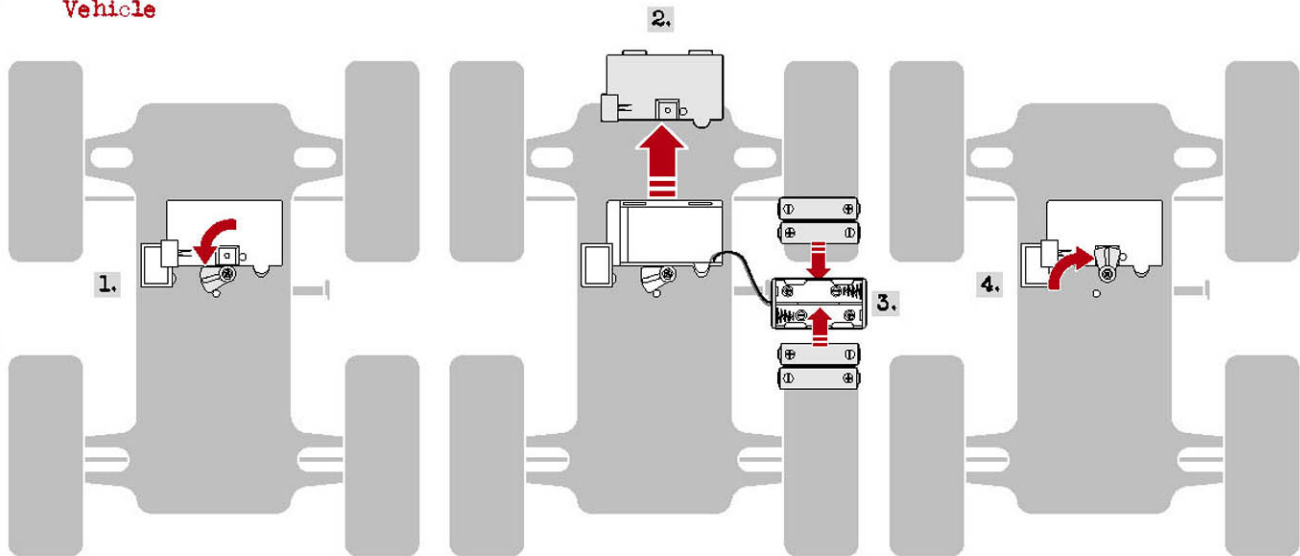

Vehicle

Start out with the car side up. Pull out the pins that secure the body to the chassis. Carefully remove the body. Remove battery compartment door. Insert 4 x 1.5v "AA" or R6 size batteries, as shown. Alkaline batteries recommended. Replace battery compartment door. Reattach the body and snap pins back into place to secure.

Removing pins.

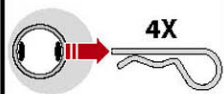



## Electric Starter

**Charge battery fully (about 4 hours) before inserting.** Remove battery compartment door. Insert the 9.6v rechargeable battery, as shown. Replace battery compartment door.

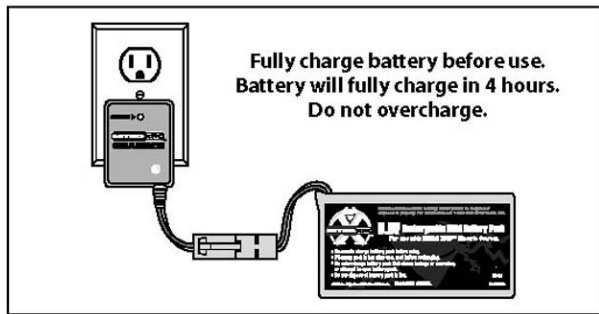

- Be sure to charge battery pack before using.
- If battery pack is hot after use, cool before recharging.
- Do not recharge battery pack that shows leakage or corrosion, or attempt to open the battery pack.
- Do not dispose of battery pack in fire.

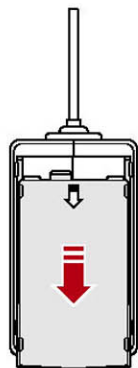

1.

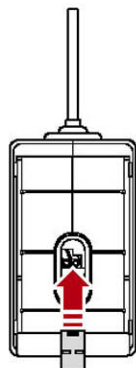

2.



3.



# QUICK START GUIDE

## ⚠ CAUTION:

- Do not operate the vehicle near people. Bodily injury can occur from moving vehicle. Spectators should stand behind the driver and maintain a safe distance from the vehicle.
- The engine and exhaust can become very hot during operation. Always allow the engine to cool before touching it or refueling.
- Vehicle, transmitter, and starter are not water resistant. Do not use in wet environments.
- Always turn on the transmitter (remote), before turning on the receiver. Make sure no one else is using the same frequency before turning on.

## REQUIRED ITEMS



Transmitter



Glow Plug Igniter



Electric Starter



Vehicle



Wildcat Fuel  
for NITRO XRC  
with unique fuel  
delivery system  
(sold separately)

## START YOUR ENGINES!

Always follow this step-by-step procedure when starting your NITRO XRC™ vehicle:

1. Top off your fuel tank (page 15).
2. Turn on your transmitter (page 17).
3. Turn on the receiver (located on side of vehicle) (page 17).
4. Adjust Steering Trim switch to the neutral (center) position (page 21).
5. Prime the engine (page 17).
6. Attach glow plug igniter (page 18). If you're running in cold weather, leave the igniter in for 15 seconds or so to warm up the engine before starting.
7. Insert starter and crank engine for about 15 seconds (page 18).
8. Adjust Throttle Trim (page 20).

To shut down the vehicle, either run it until the fuel tank is empty (this is the course we recommend, as it's the most fun), or plug the exhaust using the attached exhaust plug.

If you have any problems,  
check out the Troubleshooting  
section on page 28.

Plug the exhaust pipe to  
shut down the vehicle.

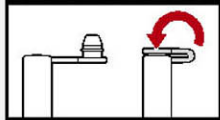

# GETTING TO KNOW YOUR VEHICLE



Attach the antenna by screwing it into the hole on the top of the transmitter. Make sure it is fully attached before operating.

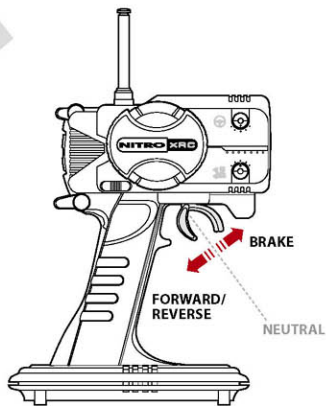
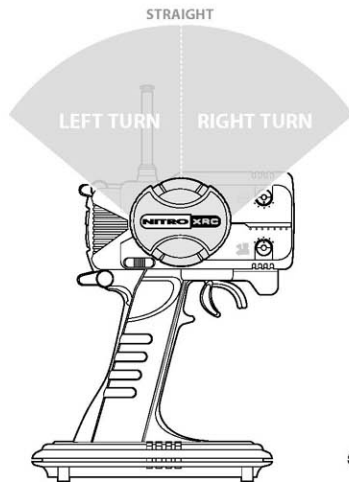
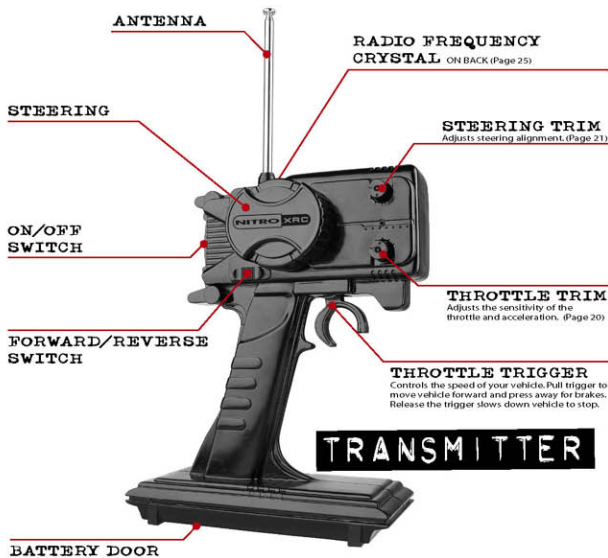

# YOUR VEHICLE

**BATTERY BOX**  
UNDER VEHICLE

**CRYSTAL**  
UNDER VEHICLE (Page 25)

**FUEL TANK CAP**

**FUEL TANK** (Page 15)

**EXHAUST PIPE**

**AIR FILTER** (Page 22)  
Always keep this clean!

**FUEL-AIR  
MIXTURE VALVE** (Page 24)

**GLOW PLUG** (Page 23)

**STARTER**

**ON/OFF**

YOUR

TOOLS



WRENCH

for changing glow plugs and  
wheel nuts (sold separately).



GLOW PLUG  
IGNITER

ELECTRIC  
STARTER



STARTER  
BUTTON



# FUELING YOUR VEHICLE



POISON



FLAMMABLE

**DANGER: POISON. FLAMMABLE. MAY BE FATAL OR CAUSE BLINDNESS IF SWALLOWED. VAPOR HARMFUL. EYE IRRITANT.**

## **WARNING:**

- Do not alter the bottle's fuel delivery system, or the vehicle's fuel tank in any way. Do not use any other fuel or fuel delivery system with NITRO XRC™\* vehicles.
- Contains Methanol, Nitromethane and non-petroleum lubricants. Cannot be made non-poisonous. Do not use near heat, sparks, flames or lit cigarettes. Avoid contact with eyes and prolonged contact with skin. Do not take internally. Avoid breathing of vapors. Use only with adequate ventilation.
- This product contains a chemical known to the state of California to cause cancer.
- Use only Wildcat Fuel for Nitro XRC. Do not alter the fuel bottle or vehicle fuel tank in any way.
- Fuel the vehicle outdoors away from any ignition source, including lit cigarettes.
- Store fuel in well ventilated areas.
- If ignited, NITRO XRC fuel burns clear. You may not be able to see the flames.
- Always have a halon or carbon-dioxide fire extinguisher nearby when fueling. Dirt or sand can also be used to smother the flames. **DO NOT ATTEMPT TO DOUSE A FUEL FIRE WITH WATER.**

### • IN CASE OF SPILL:

- For small spills cover and remove with sand or other non-combustible absorbent material and place into containers for later disposal.
- Observe all local, state and federal regulations when disposing of waste.
- In case of skin contact, wash affected areas immediately with soap and water. Remove clothing affected and launder before reuse.
- Never leave vehicle parts sitting in fuel. Keep all vehicle parts clean and dry.

### ATTENTION!

This product is hazardous. Use only as a model engine fuel. Buyer assumes all risk and liability for loss, damage, or injury to persons or property resulting from its misuse, storage, etc.

### FIRST AID!

In case of eye contact, flush with water for 15 minutes and get medical attention. For skin contact, wash with soap and water. If ingested, drink one or two glasses of water and immediately contact physician, hospital emergency room or poison control center for instructions to induce vomiting.

## FUELING YOUR VEHICLE!

Your Wildcat Fuel comes in a two-stage bottle designed to prevent spilling or overfilling your tank. Read all instructions and warnings on the bottle before you start fueling. **Never fill your fuel tank while the engine is running.** Always wash your hands thoroughly as soon as possible after fuelling.

1. Unscrew and remove the white cap from the neck of the fuel bottle and set it aside. DO NOT lose it. If your fuel is exposed to the air for too long, it will degrade over time. **A.**  
(Red cap is permanently sealed. Do not attempt to remove.)
2. Pierce foil seal with reverse side of plug. Remove and discard seal.
3. Push attached plug onto valve while squeezing bottle until fuel reaches desired level. **B.**
4. Remove plug from fuel bottle. Open cap on vehicle fuel tank.
5. Attach the bottle to the tank.
6. Squeeze the bottle until fuel has reached the top of the tank. **Never overfill your tank!** **C.**
7. Remove the bottle. Securely cap both the Fuel Bottle and your fuel tank before priming and starting your vehicle.

### REQUIRED ITEMS



Wildcat Fuel  
for NITRO XRC  
with unique fuel  
delivery system  
(sold separately)



Vehicle

