

Product Detail

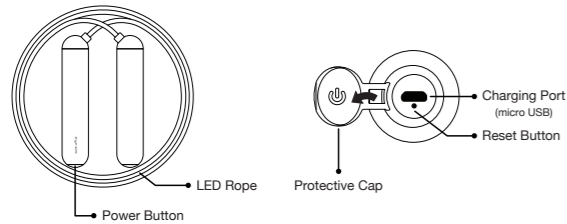

Turning Smart Rope on and off



Power ON / OFF



Press 1 second

(After 5 min of inactivity, Smart Rope powers off automatically)

Pairing Smart Rope with your smartphone

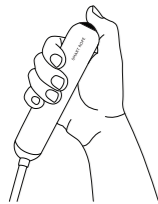

1. Turn on Smart Rope
2. Activate Bluetooth on your smartphone
3. Open Smart Gym app

Searching



Blink

Connected



Slowly blink

If multiple Bluetooth-enabled smartphones are nearby, Smart Rope will pair with the closest device. To connect to a different device, disable Bluetooth on the paired smartphone. Then pair the desired device using the Smart Gym app.

IMPORTANT NOTICE - Before you jump with Smart Rope

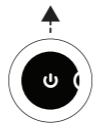
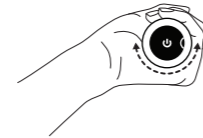
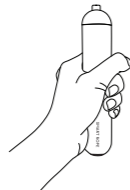

The angle at which you grip the handle of Smart Rope will determine your viewing angle of the LED display. **It's important that you hold the handle with the Smart Rope logo (the handle with the Power Button) in your LEFT hand.** Holding the handle in your hand, ensure the Power Button is facing upwards. If the LEDs display too high or too low from your field of vision, simply adjust the angle of your grip.

LED status light

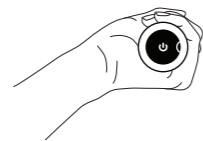

Bluetooth
Lost connection



White

Bluetooth
Connected



Blue

Battery lower
than 20%



Red

Charging Smart Rope

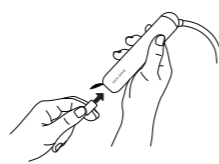
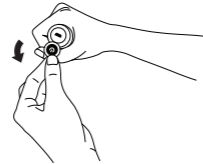

1. Open the Protective Cap with mark
2. Plug in your micro USB power cable
(a typical smartphone charger should work) and connect to your power source. (wall socket, powered USB port on your computer, etc.)
(Recharging : Red LED / Complete : Green LED)

Smart Rope will be fully charged in 2 hours, and a full charge lasts 36 hours (results may vary)

Downloading the Smart Gym app

Smart Gym app supports both iOS and Android OS. It is compatible with iOS 7 and higher, Android Jelly Bean 4.1 and higher, and can be downloaded free of charge from App Store and Google Play.

Important Safety Warnings

- Do not touch Smart Rope or the power plug with wet hands. You may be electrocuted.
- Do not bend or yank the power cord/plug from the electrical outlet. This may result in a fire or electric shock, causing personal injury.
- Do not use damaged cord/plug or loose outlet. Unstable inter-connection may result in a fire or electric shock.
- Using Smart Rope where there are strong radio waves – near a speaker, large motor, strong magnetic material, high-tension wire, transmission tower, etc. – may cause Smart Rope to break down due to electromagnetic waves.
- If Smart Rope is damaged, do not continue use. Consult the service center for repairs before using the product again.
- Upon seeing any abnormal conditions of Smart Rope – strange smell, noise, smoke, etc. – immediately stop using Smart Rope and contact the service center.

Important Safety Instructions

- Use Smart Rope in a dry area. Any liquid component, including water and humidity, may damage the parts and circuitry of Smart Rope.
- Keeping Smart Rope in a magnetic area or a magnet-influenced space may result in the malfunction of Smart Rope and battery loss.
- If Smart Rope heats up excessively, unplug the power cord and stop using it.
- Bending or twisting Smart Rope may break the external and/or internal parts of the product.
- Do not use or store Smart Rope in a place significantly lower or higher than room temperature.
- If Smart Rope is altered or disassembled by the user, the warranty is voided and no longer qualifies for free service/maintenance.
- Using Smart Rope for something other than its intended use may result in the breaking down of the product.
- Using strong chemical agents or cleaner to clean Smart Rope may cause discoloring or corrosion of Smart Rope's exterior.
- User editing or tampering with the operating system may cause Smart Rope to malfunction.
- User editing or tampering with registry settings and/or the operating system of Smart Rope may cause it to malfunction or become incompatible, voiding the product warranty.
- User downloading and installing firmware from unauthorized provider may cause Smart Rope to malfunction or become incompatible, voiding the product warranty.

Resetting Smart Rope

Open the Protective Cap and press the small hole below the Charging Port, with a small pin or a clip.

U.S.A [FCC ID : 2AFDASR1000]

FCC Part 15.19

This device complies with part 15 of the FCC Rules. Operation is subject to the following two conditions: (1) This device may not cause harmful interference, and (2) this device must accept any interference received, including interference that may cause undesired operation.

FCC Part 15.21

Any changes or modifications (including the antennas) to this device that are not expressly approved by the manufacturer may void the user's authority to operate the equipment.

FCC RF Radiation Exposure Statement: FCC RF Radiation Exposure Statement: This equipment complies with FCC RF Radiation exposure limits set forth for an uncontrolled environment. This device and its antenna must not be co-located or operating in conjunction with any other antenna or transmitter.

Part 15.105 (B)

Note : This equipment has been tested and found to comply with the limits for a Class B digital device, pursuant to part 15 of the FCC Rules. These limits are designed to provide reasonable protection against harmful interference in a residential installation. This equipment generates, uses and can radiate radio frequency energy and, if not installed and used in accordance with the instructions, may cause harmful interference to radio communications. However, there is no guarantee that interference will not occur in a particular installation. If this equipment does cause harmful interference to radio or television reception, which can be determined by turning the equipment off and on, the user is encouraged to try to correct the interference by one or more of the following measures:

- Reorient or relocate the receiving antenna.
 - Increase the separation between the equipment and receiver.
 - Connect the equipment into an outlet on a circuit different from that to which the receiver is connected.
 - Consult the dealer or an experienced radio/TV technician for help.
- Modifications not expressly approved by the manufacturer could void your authority to operate the equipment under FCC rules.

Industry Canada [IC ID : 20399-SR1000]

"This device complies with Industry Canada licence-exempt RSS standard(s)."

Operation is subject to the following conditions: (1) this device may not cause interference, and (2) this device must accept any interference, including interference that may cause undesired operation of the device.

Le présent appareil est conforme aux CNR d'Industrie Canada applicables aux appareils radio exempts de licence. L'exploitation est autorisée aux deux conditions suivantes : (1) l'appareil ne doit pas provoquer de brouillage, et (2) l'appareil doit accepter tout brouillage radioélectrique subi, même si le brouillage est susceptible d'en compromettre le fonctionnement.

CMIT ID: 2015DJ3707



006-000338



For more information, please visit our website

<http://tangramfactory.com>

E-mail : Help@tangramfactory.com

Designed by Tangram, Made in Korea

Copyright 2015 Tangram Factory, Inc. All rights Reserved.



Limited Warranty (Proof of purchase from an authorized retailer is required.)

Thank you for purchasing a Tangram Factory product.

This product was manufactured under strict quality assurance and inspection standards by Tangram Factory. This warranty is effective for 60 days from the date of purchase. For any issues arising from product defects under normal usage conditions, you may exchange or return the product, or have it repaired free of charge. For any issues under normal usage conditions arising past the warranty period, all repairs and maintenance are provided for a fee.

Product Information

Product : SMART ROPE

Model : SR1000

Company : Tangram Factory Inc.

Manufacturer : Tangram Factory Inc. / South Korea

KC no. : MSIP-CRM-TFD-SR1000

"This is a Class B electromagnetic device, intended primarily for home use. It can be used in all regions." and "Due to the possibility of radio interference, this device cannot be used in occasions related to personal safety."

Operating Specifications

Maximum/ Minimum Voltage : 4.07 V ~ 3.33 V

Basic Voltage : 3.7 V (Typical)

Maximum / Minimum Temperature : - 20 ~ 55°C

Smart Rope is an electronic device with high technology. Excess pressure / Repetition of bending / Overuse on rough, solid area may cause damage to the product's surface or inner parts and shorten the product's life. Bluetooth range between Smart Rope and a smart phone can be vary according to the smart phone's performance and environment.