

The instruction manual contains important information, please keep it for further reference.

MOTION CONTROLLING
QUADCOPTER

Model: TB-802
Ages: 8+
Manufacturer: Zhong Shan Lasy Electronic Technology Co.,Ltd

Product information
Length: 160mm, width: 160mm, height: 45mm.

Battery information
Product include 1 x 3.7V, 300mAh battery, installed inside of product, it is replaceable.
Controller: 3xAAA battery required.1.5V, it is replaceable. not included

Parameter information
Charging time: about 30 minutes.
Working time: about 5-8 minutes.
Control distance: 20 m.

Product list
TB-802 Drone 1 pc, Controller 1 pc, Manual 1 pc, USB cable 1 pc, Propellers 4 Pcs Finger holder 2 pcs.
Repair and maintenance

Please keep it far away from direct sunlight or heat.
The quadcopter and controller contain electrical parts. Please keep it far way from water or wet environment. Please use dry clean cloth to clean product if it is get dirty. Do not wash it.

Design and specifications are subject to change without notice. The photograph and the actual product may differ in appearance.

Warning: Changes or modifications to this unit not expressly approved by the party responsible for compliance could void the user's authority to operate the equipment.

NOTE: This equipment has been tested and found to comply with the limits for a Class B digital device, pursuant to Part 15 of the FCC Rules. These limits are designed to provide reasonable protection against harmful interference in a residential installation. This equipment generates, uses and can radiate radio frequency energy and, if not installed and used in accordance with the instructions, may cause harmful interference to radio communications. However, there is no guarantee that interference will not occur in a particular installation. If this equipment does cause harmful interference to radio or television reception, which can be

determined by turning the equipment off and on, the user is encouraged to try to correct the interference by one or more of the following measures:

- Reorient or relocate the receiving antenna.
- Increase the separation between the equipment and receiver.
- Connect the equipment into an outlet on a circuit different from that to which the receiver is connected.
- Consult the dealer or an experienced radio/TV technician for help.

This device complies with Part 15 of the FCC Rules. Operation is subject to the following two conditions : (1) this device may not cause harmful interference, and (2) this device must accept any interference received, including interference that may cause undesired operation.

NB:
Hereby, Techboy Electronic Technology Co.,Ltd], declares that this [Motion Controlling Quadcopter] is in compliance with the essential requirements and other relevant provisions of Directive 2014/53/EU. frequency band: 2412-2471 MHz the maximum RF Power: -3.84dBm

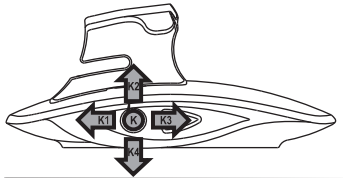

- K Auto take off/landing(please refer operation details)
- K1 Speed adjustment (please refer operation details)
- K2 Stunt (please refer operation details)
- K3 Turning (please refer operation details)
- K4 Height adjustment (please refer operation details)

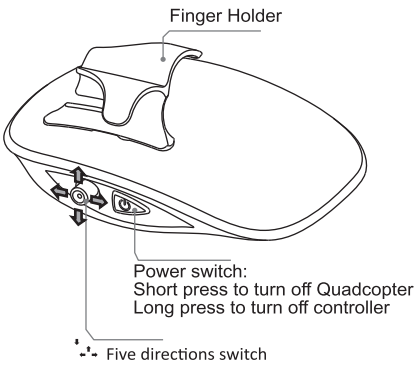

3*AAA/1.5V
Battery not included

Battery charging

Take out the USB charging wire, connect one end to the quadcopter, then insert the USB port of the USB charging wire to the USB port of the computer (or the USB port of the power adapter) to charge the battery. During the time of charging, the red indicator of the USB will be ON. When it is fully charged, the red indicator of the USB will be OFF.

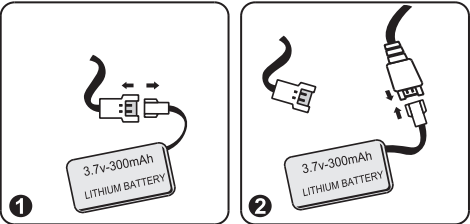

Caution:

When using the computer for charging, please remember to pull out the charging line before shutting down the computer. Please pay attention to aim correctly to the

correct polarity when connecting the USB wire with the battery. Please make sure the polarity should not be upside down. You can take battery out of quadcopter to charge.

Controller installing the battery

- Use screwdriver or other objects , press the battery cover button. and take off battery cover at same time. (refer picture 3).
- Install 3*AAA batteries according battery polarity. (refer picture 4)
- re-install battery cover. it install well when you hear "DA" sound.
- Remove batteries according above steps .

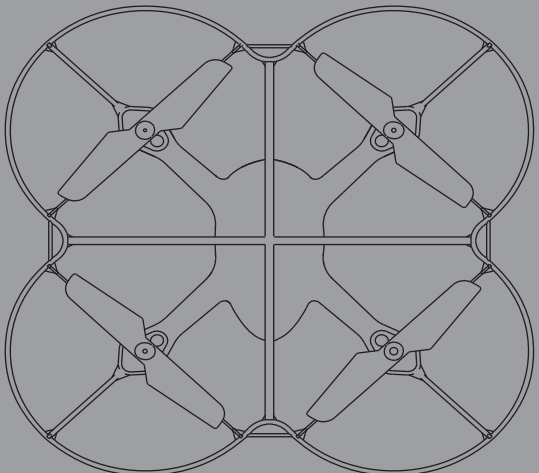
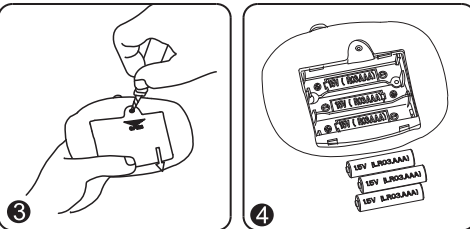

INSTRUCTION
MANUAL

Model: TB-802

Trouble shooting

- Problem: Led indicator flash, no response.
Reason A: Matching code is not successfully made.
Trouble shooting: Re-match controller code to quadcopter.
Reason B: insufficient power with the controller or quadcopter
Trouble shooting: replace the battery of the controller or charge quadcopter
Reason A: propeller deformed.
Troubleshooting: replace propeller.
Reason B: insufficient power with quadcopter
Trouble shooting: charge quadcopter
3. Problem:quadcoptershake a lot.
Reason: propeller deformed. Troubleshooting: replace propeller.
4. Problem: quadcopter fly out of control after crash.
Reason: quadcopter loose balance after crash.
Trouble shooting: re-start quadcopter after 5-10 seconds.
Manufacturer name:TECHBOY INTERNATIONAL (HONGKONG)LIMITED
Address: NO.48,Changguan Road,Western District,Zhongshan City, Guangdong Province, China
Web: www.mylasy.com
Tel:0086-760-8795 4455



IMPORTANT SAFETY
PRECAUTIONS

NOTE: The flying unit contains a Lithium Polymer Battery which is built in to the quadcopter. do not disassembly the flying unit as this may result in permanent damage or hazardous operation.

DO NOT modify this product in any way.
DO NOT launch at people or animals.
DO NOT use near overhead cables, vents, fans or any other obstacles.

☆Keep propeller away from eyes, faces, hands, hair, and loose clothing.
☆Make sure people around you are aware you are playing quadcopter

☆If thequadcopter gets stuck in high places, ask an adult to retrieve it for you. DO NOT attempt to retrieve yourself.
☆Before recharging, when not in use or before storage, always allow your quadcopter to deplete its charge (by allowing the propeller to spin freely until it stops),and switch OFF when not in use.

☆Only use the charger provided in this pack to charge quadcopter and only under adult supervision.

ADULT SUPERVISION IS RECOMMENDED AT ALL TIMES!

IMPORTANT BATTERY
INFORMATION

DO NOT mix old and new batteries .
DO NOT mix alkaline. Carbon-zinc or rechargeable (nikel-cadium) batteries.
DO NOT try to charge non-rechargeable batteries.
DO NOT dispose of batteries in fire.
DO NOT short circuit the supply terminals.
DO NOT use near water.
Ensure that the contact surfaces are clean before installing new batteries.
Batteries should always be replaced by adults.
Replace batteries of the same type and brand at the same time.
1 pc Lithium battery included. Please retain packaging for further reference.

Please check the plug, the socket, the shell and other parts of the product for damage regularly. You should not use until it is repaired.

The flying ground we required should be the local field and legal for remote control flying.

FLIGHT PREPARATION

- Connect the battery to copter correctly , put the copter on the flat groud(The copter head with lights in front of you) the light flashing from high speed to low speed.
- Install batteries into controller correctly.
- Press ON/OFF, transparent button of controller.(refer picture1) Drone LED turn to keep lighting,indicate code match successfully ,Re-press button if failed.
- Please replace new batteries if controller LED do not light.
- Throw flying, Tum on drone, hold drone steadily,LED flash, then throw drone up/down, the drone start flying. (Note: Please do not throw flying when wing LED flashing, you can throw fling at any time after code match.)

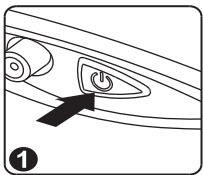

OPERATION & CONTROL

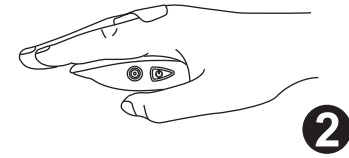

Please hold controller horizontally. (refer picture 2)

- Press K ,the Quadcopter take off automatically, and keep in a certain height hovering. (refer picture 3)

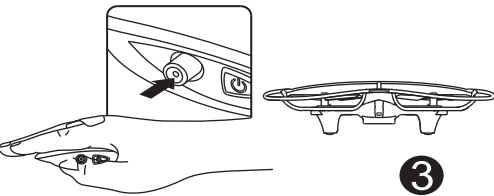

- Lean forward/backward/left/right slowly (with angle over 15)controller.

To control copter fly forward/backward/left/right. (refer picture 4)

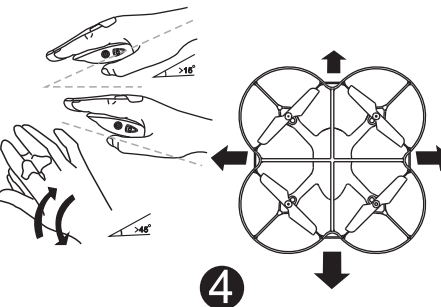

- Press to K3direction, move hand to left or right . the copter turn left or right. (refer picture 5)

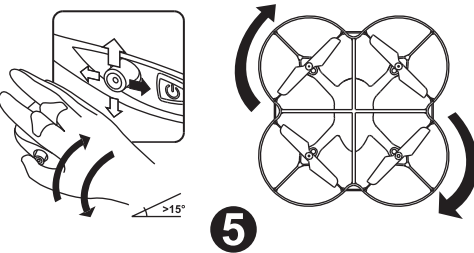

- Press to K1 direction. adjust speed. press once to medium speed. press once again to high speed. press third time to low speed (copter keep in low speed at very beginning) (refer picture 6)

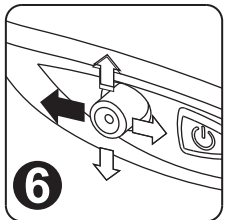

- Fly higher/lower ,press K4 and at same time move your wrist up and down slowly, the Quadcopter fly higher or lower altitude, release K4, Quadcopter keep in current altitude ,hovering. (refer picture 7)

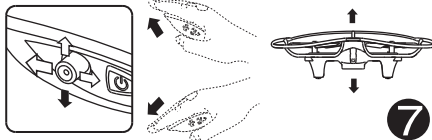

- Landing , press K button , the Quadcopter stop flying and begin to landing slowly.

7. Stop immediatly in case emgerency. Press turn on/off button again to turn off Quadcopter immediatly if any emgerency or Quadcopter could not landing sucessfully or propellers keep rotating.

3D EVERSION & THROWING
FLIGHT INSTRUCTIONS

Stunt feature:

- Make sure flying height is over 2meters and copter is in full charged status when do stunt operation.
- Press K2, Lean rightward/leftward/forward/backward(with angle over 75)controller. To control copter do leftward/rightward/forward/backward stunt operation. (refer picture 8)

